

ASI 18

Hybrid™ folded horn/reflex loaded bass system

features

- ▶ High SPL capability
- ▶ Very high efficiency
- ▶ Hybrid™ horn/reflex loaded bass system
- ▶ Powerful 18" (460mm) LF driver

applications

- ▶ Dedicated bass for Stadium Series horns
- ▶ Sports Stadia
- ▶ Arenas
- ▶ Exhibition halls

The ASI 18 has been specifically designed to be used with the AM404, AM604 and AM906 Stadium Series mid/high horn systems in applications where full-range music reproduction is required. Its Hybrid™ design combines the high efficiency and impact of a bass horn with the low frequency extension of a reflex enclosure.

overall dimensions

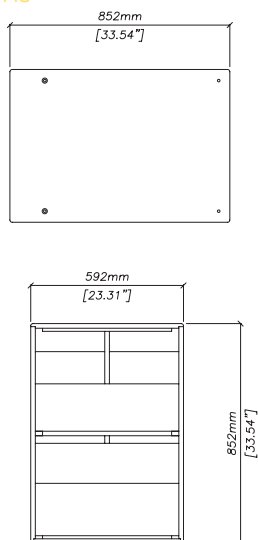

ASI18

architectural



technical specifications

TYPE	Hybrid™ horn and reflex loaded bass enclosure
FREQUENCY RESPONSE (1)	50Hz-300Hz ± 3dB 30Hz @ -10dB
DRIVERS	18" (460mm) / 4" (100mm) coil long excursion bass driver
RATED POWER (2)	1000W AES, 4000W peak
SENSITIVITY (3)	108dB
MAXIMUM SPL (calculated)	138dB continuous, 144dB peak
NOMINAL IMPEDANCE	8 ohms
CROSSOVER	150Hz active (via DX1 controller)
CONSTRUCTION	Multi-laminate birch ply
FINISH	Textured high-density polyurethane coating applied externally and internally
PROTECTIVE GRILLE	18 gauge punched steel, heavy galvanised and powder-coated, with integral water barrier
CONNECTORS	3m flying lead
MOUNTING	14 x M10 inserts
DIMENSIONS	(W) 592mm x (H) 852mm x (D) 852mm (W) 23.3ins x (H) 33.6ins x (D) 33.6ins
WEIGHT	76kg (168lbs)
OPTIONS	

Century Point, Halifax Road, Cressex Business Park,
High Wycombe, Buckinghamshire HP12 3SL, England.
Telephone: +44 (0)1494 535312 Facsimile: +44 (0)1494 438669
E-mail: info@martin-audio.com
All information is Copyright © 2003 Martin Audio Ltd.



www.martin-audio.com