

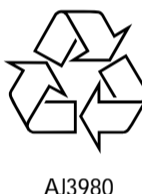

**PHILIPS**

**AJ3980 CD Clock radio**  
**PHILIPS CONSUMER ELECTRONICS NORTH AMERICA**  
 Knoxville, Tennessee 37914-1810, U.S.A.

- English
- Français
- Español



AJ3980



Meet Philips at the Internet  
<http://www.philips.com>



Printed in China

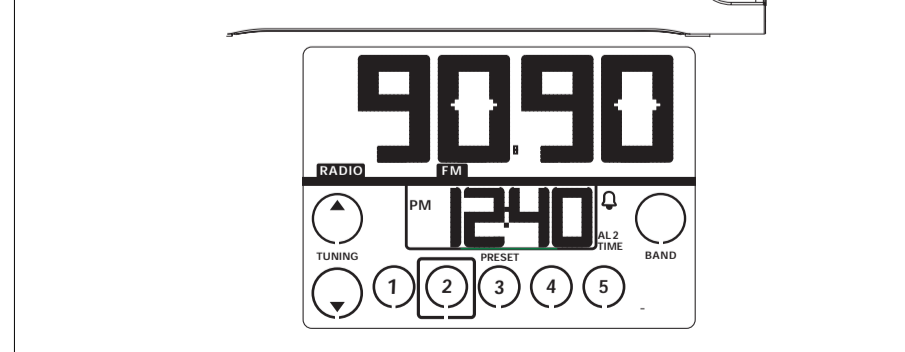
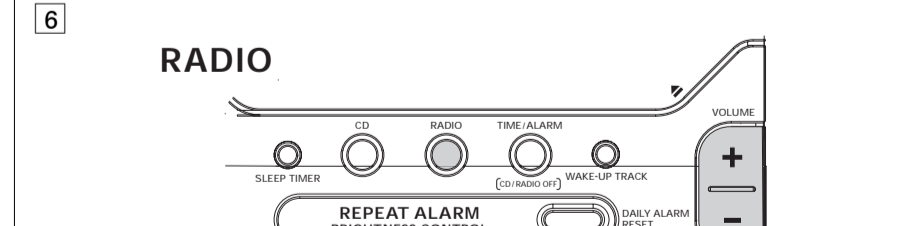
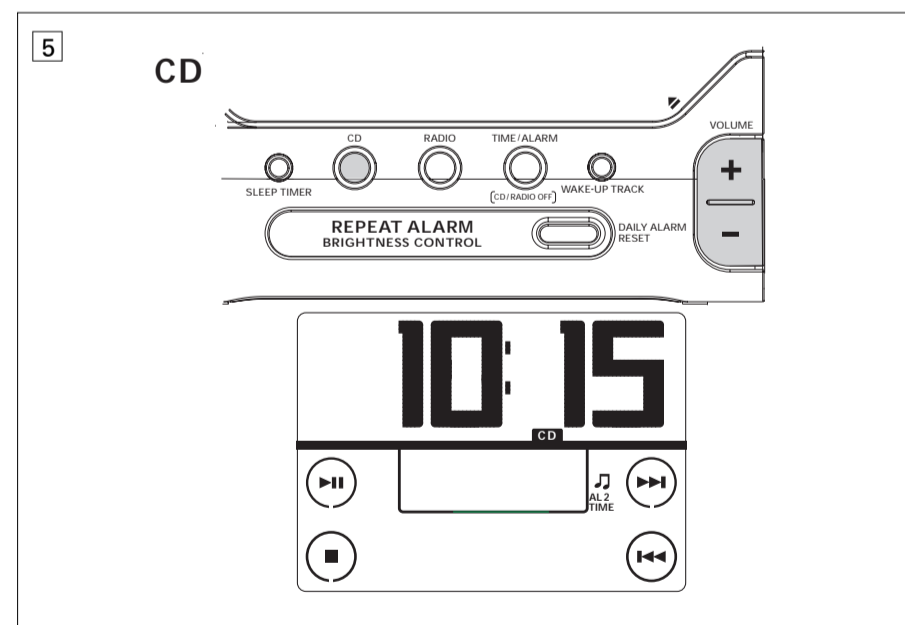
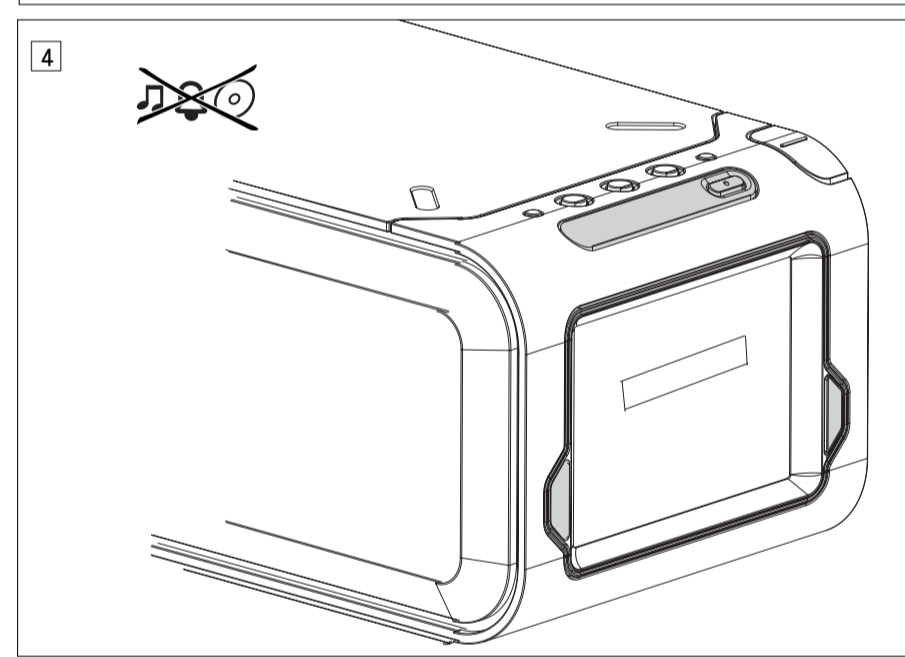
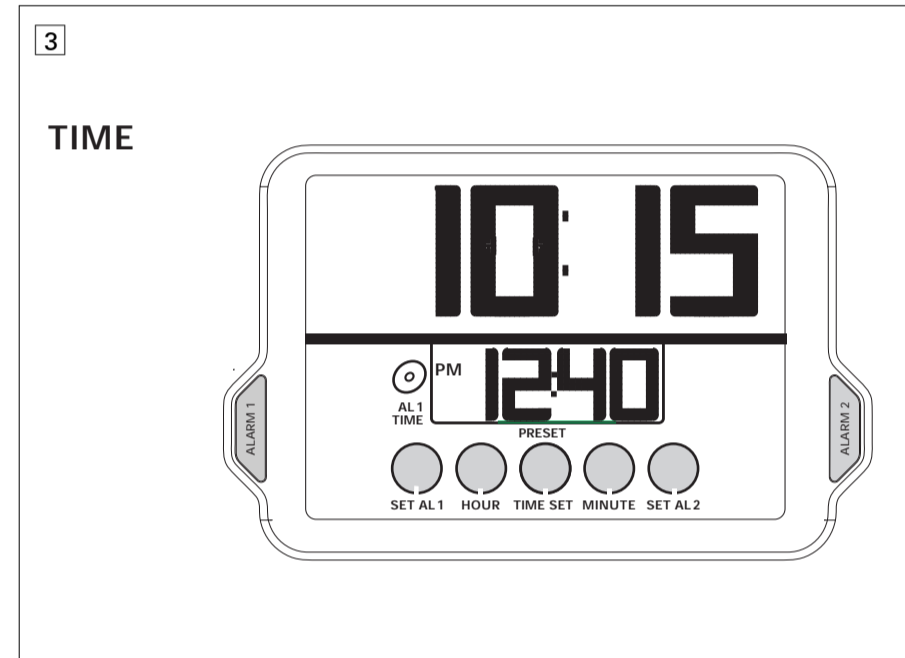
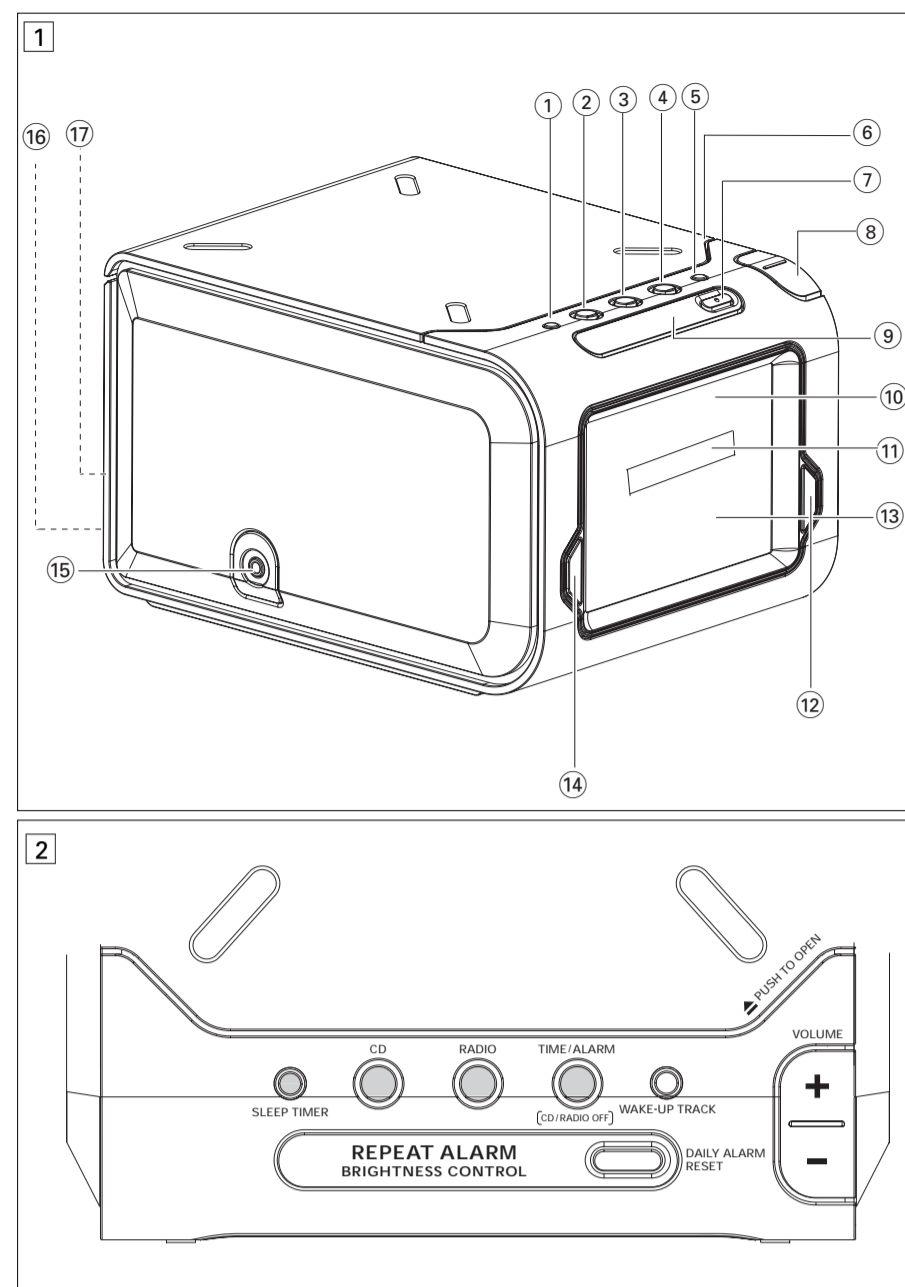
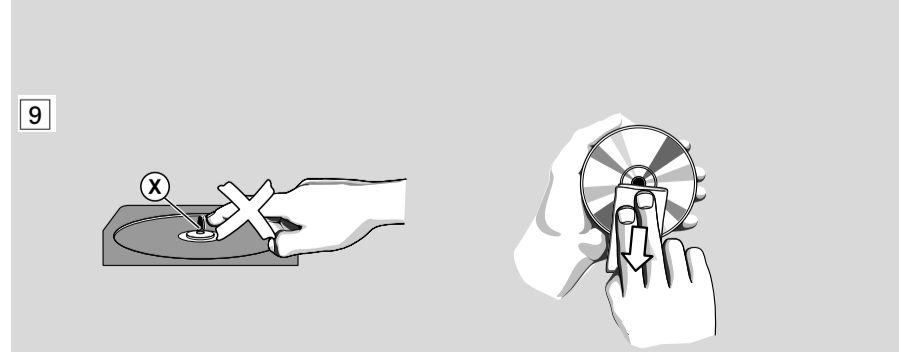
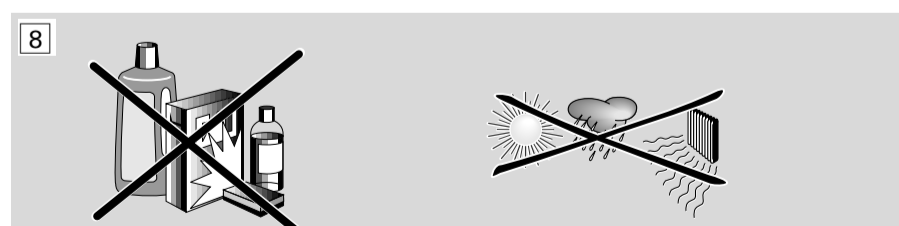
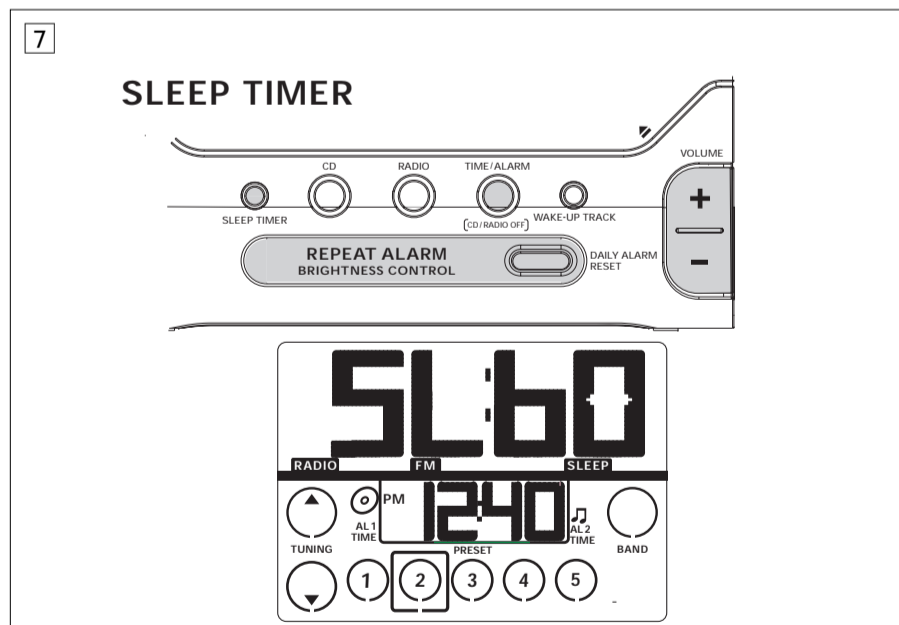

**English**

**CONTROLS (see figure 1)**

- 1 **SLEEP TIMER** - adjusts timer options for CD / radio switches CD / radio on.
- 2 **CD** - starts CD playback
- 3 **RADIO** - switches on radio
- 4 **TIME / ALARM** (with power on) - switches off CD / radio - selects clock display
- 5 **WAKE-UP TRACK** - programs your favorite CD track for wake-up track alarm.
- 6 **DAILY ALARM RESET** - stops the active alarm for 24 hours
- 7 **+ / - VOLUME** - adjusts the volume
- 8 **REPEAT ALARM BRIGHTNESS CONTROL** - switches off the alarm for a 9 minute period - switches off timer function - changes the brightness of the display window
- 9 **Main display** - shows clock time and function status - shows radio frequency and CD track number briefly when respective function is in use
- 10 **Alarm time display** - shows the alarm time and the chosen alarm activated: - **CD (AL 1 TIME)**, radio / buzzer (AL 2 TIME)
- 11 **ALARM 2** - selects radio / buzzer alarm - switches radio / buzzer alarm on / off
- 12 **Touch Screen Controls** - Clock controls shown in standby mode. The radio / CD controls appear when the radio / CD is switched on.

**ALARM**

**Helpful Tip:** If you want the alarm to wake you up, **FIRST CHECK:** - you have disconnected the headphones. - radio alarm - make sure you have tuned properly to a station.

**SELECTING CD WAKE-UP ALARM MODE**  
 You can program and select a CD track number between 1-99, when the set is in the standby or radio playback mode.  
 However, if the track number programmed does not exist on your CD, the CD will start playback from the first track during the alarm call.  
 1. Set the alarm time for **AL1 TIME**.  
 2. Insert a CD into the CD compartment.  
 3. Press **ALARM 1** to select CD alarm mode.  
 4. Press **WAKE-UP TRACK** to activate favorite track programming.  
 5. Press **CD** or **CD** until the desired track number is shown.  
 6. Press **WAKE-UP TRACK** to confirm the selected track number.  
 → The display returns to standby clock time.  
 7. If you want to review your programmed track number, press **WAKE-UP TRACK**.

**IMPORTANT!**  
 The buzzer alarm will automatically replace the CD alarm if you have:  
 - inserted a CD incorrectly,  
 - forgotten to insert any CD,  
 - not closed the CD door properly.

**SWITCHING OFF THE ALARM (see figure 1)**  
 There are three ways of switching off the alarm. Unless you cancel the alarm completely, the **DAILY ALARM RESET** option will be automatically selected after 9 minutes, from the time your alarm time first sounds.

**Helpful Tip:** During an alarm call/ repeat alarm, only the **DAILY ALARM RESET**, **REPEAT ALARM BRIGHTNESS CONTROL** and **ALARM 1 or ALARM 2** and **+ / - VOLUME** controls on the set will operate.

**CONTROLS/ INSTALLATION**

- 11 **CD**: - starts / pauses CD playback - stops CD playback - skips to the next / previous CD tracks - fast search within a track
- 12 **Radio TUNING** (up/down) - tunes to radio stations automatically/ manually
- 13 **PRESET** (0-9) - to select / store a radio preset station
- 14 **BAND** (CD) - selects waveband (FM/AM)
- 15 **ALARM 1** - selects CD alarm - switches CD alarm on/off
- 16 **ALARM 2** - selects CD alarm - switches CD alarm on/off
- 17 **Coil antenna** - improves FM reception
- 18 **Power cord**

**INSTALLATION (see figure 2)**

- AC Power Supply**  
 1. Check if the power voltage, shown on the type plate on the bottom of the set, corresponds to your power supply. If it does not, consult your dealer or service center.  
 2. Connect the plug to the wall outlet.  
 → **PHILIPS** scrolls across the display continuously. To exit the demo mode, press any button on the set.  
 Eg: **TIME / ALARM** (CD/RADIO OFF)
- 3. To disconnect the set completely from the power supply, withdraw the plug from the wall outlet.
- Standby power consumption (clock mode) ... 1.5W**  
 The serial and production number are located on the bottom of the set.

**CD**

**DAILY ALARM RESET**  
 If you want the alarm mode to be stopped immediately but also wish to retain the same alarm setting for the following day:  
 - Press and hold **DAILY ALARM RESET** → You will hear a beep tone to confirm that the alarm reset has been activated.

**REPEAT ALARM**  
 This will repeat your alarm call at 9 minute intervals. During the alarm call, press **REPEAT ALARM BRIGHTNESS CONTROL**.  
 → Repeat as often as desired.  
 → Your alarm mode indication (AL1, AL2) will flash throughout the time the repeat alarm is active.

**CANCELING THE ALARM COMPLETELY**  
 When an alarm is cancelled this is shown by the selected alarm indication and symbol disappearing from the display.  
 To cancel the set alarm time, before it goes off:  
 - Press **ALARM 1 or ALARM 2** until the alarm icons (AL 1 / 2) disappear from the display.

**CD PLAYBACK (see figure 3)**  
 1. Insert a CD with the printed side facing up, and close the door.  
 2. Press the **CD** button to start playback.  
 → Display shows 'CD' and the total number of tracks, then your current track number, before returning to clock time.  
 → CD touch screen controls appears throughout CD operation.

**Other possible CD indications before returning to clock time:**  
 - **CD** is shown if the CD door is not closed.  
 - **CD** is shown if no CD has been inserted / inserted incorrectly.  
 - **CD** is shown if the CD (RW) is non-finalized.  
 - **CD** indicates a general error in operation of the set.  
 3. Adjust the sound with **+ / - VOLUME**.  
 → To interrupt, press **CD**.  
 → **CD** flashes.

- 4. Press **CD** again to resume playback.
- 5. Press **CD** to stop playback. Or press **TIME / ALARM** (CD/RADIO OFF) to return to standby mode.

**MAINTENANCE**

- If you do not intend to use the set for a long time, withdraw the plug from the wall outlet.
  - Do not expose the set, to humidity, rain, sand or excessive heat caused by heating equipment or direct sunlight.
  - To clean the set, use a soft, dry cloth. Do not use any cleaning agents containing alcohol, ammonia, benzene or abrasives as these may harm the product's surface.
- CD player and CD handling (see figure 7)**
- The lens of the CD player should never be touched!
  - Sudden changes in the surrounding temperature can cause condensation to form and the lens of your CD player to cloud over. Playing a CD is then not possible. Do not attempt to clean the lens but leave the set in a warm environment until the moisture evaporates.
  - Always shut the CD door to keep the CD compartment dust-free. To clean, dust the compartment with a soft dry cloth.
  - To clean the CD, wipe in a straight line from the center towards the edge using a soft, lint-free cloth. Do not use cleaning agents as they may damage the disc.
  - Never write on a CD or attach any stickers to it.

**TROUBLESHOOTING**

**Continuous crackling/ hiss disturbance during AM broadcast**  
 - Electrical interference from TVs, computers, fluorescent lamps, etc.  
 - Move set away from other electrical equipment  
 The alarm does not function  
 - Alarm mode not selected  
 - See chapter on SETTING THE ALARM  
 - Alarm time not set  
 - See chapter on SETTING THE ALARM.

**No sound**  
 - Volume not adjusted  
 - Adjust the **VOLUME**  
 - Headphones are connected  
 - Disconnect headphones

**No reaction to any operation of the buttons**  
 - Electrostatic discharge  
 - Disconnect the set from the power supply and reconnect the set after 5 minutes.

**CD playback does not work**  
 - CD badly scratched or dirty  
 - Replace/ clean CD  
 - Laser lens steam up  
 - Wipe until lens has adjusted to room temperature  
 - Laser lens dirty  
 - Clean lens by playing a CD lens cleaning disc  
 - CD (RW) is non-finalized  
 - Use a finalized CD (RW)

**Occasional crackling sound during FM broadcast**  
 - Weak signal  
 - Extend coil antenna fully

**SETTING THE CLOCK AND ALARM TIMES**

**MEMORY BACKUP**  
 The memory backup conveniently allows your clock, alarm and radio presets to be stored for up to 3 minutes when there is a power interruption e.g. AC power failure. The complete CD clock radio and display will be switched off. As soon as the power supply returns, the display will indicate the correct time.  
 • If power supply returns after 3 minutes, you will need to re-enter the clock and alarm time settings.

**CONNECTING HEADPHONES**  
 Connect headphones with a 3.5 mm plug into the CD jack. → The built-in speaker will now be muted on the set.

**DISPLAY BRIGHTNESS**  
 In the dim / medium setting, the backlight is interactive and gently fades in and out whenever you press a touch screen control.  
 There are 3 settings: **bright → medium → dim**  
 • Press **REPEAT ALARM BRIGHTNESS CONTROL**, once or more.

**SETTING THE CLOCK TIME (see figure 3)**  
 The time is displayed using the 12 hour clock when the PM indicator lights up (on - PM, off - AM).  
 1. In the standby mode, press **TIME SET** to activate the clock setting mode.  
 → The current clock time in the main display flashes.

2. Press **HOUR / MINUTE** to adjust the hours and minutes respectively.  
 • With your finger held down on **HOUR / MINUTE**, the display will increase the hours / minutes rapidly and continuously.

• Press **HOUR / MINUTE** briefly and repeatedly to adjust the time slowly.  
 3. Press **TIME SET** again when you have reached the correct time.  
 → You will hear a double beep to confirm the time setting.

**SETTING THE ALARM (see figure 3)**  
**GENERAL**  
 Two different alarm times: **ALARM 1** and **ALARM 2** can be set in the CD / radio / buzzer / alarm modes.

**SETTING THE ALARM TIME**  
**1. In the standby mode, press ALARM 1 / ALARM 2** to select the alarm mode. Check the respective icon appears in the display: CD / radio / buzzer / alarm.  
 Either press briefly:  
 • **ALARM 1** once for CD alarm. → This enables CD playback from the first track as your alarm call.  
 • **ALARM 2** once or more for radio / buzzer / alarm.  
 2. Press **SET AL 1** or **SET AL 2** to activate the alarm setting mode.  
 → The current alarm time display flashes.

3. Press **HOUR / MINUTE** to adjust the hours and minutes respectively.  
 • With your finger held down on **HOUR / MINUTE**, the display will increase the hours / minutes rapidly and continuously.  
 • Press **HOUR / MINUTE** briefly and repeatedly to adjust the time slowly.  
 4. Press **SET AL 1** or **SET AL 2** again when you have reached the correct time.  
 → You will hear a double beep to confirm the time setting.

**Alarm time display**  
 If you have set both alarms, the standby alarm time display will show the alarm time which is ready to go off first, according to the current clock time.  
 Eg. if current clock time = 7:30  
**AL1 TIME** = 7:30  
**AL2 TIME** = 8:00  
**AL1 TIME** = 7:45,  
 the standby alarm display shows the alarm time: 7:45.

**GENIE WAKE VOLUME**  
 A sure way of getting up in the mornings, the **gentle wake volume** for the alarm begins from a fixed gentle volume (1) and gradually increases to a maximum higher setting of (2, 5).  
 • The default low volume is: 1, 2, and the maximum volume is: 1, 2, 5.  
 • During the alarm call, if you press **+ / - VOLUME**, the volume stops automatically getting louder.

**SETTING THE ALARM (see figure 3)**  
**GENERAL**  
 Two different alarm times: **ALARM 1** and **ALARM 2** can be set in the CD / radio / buzzer / alarm modes.

**CD / RADIO**

**Helpful Tip:** In the CD stop position, the **CD touch screen display** remains active for 2 minutes.  
 • Press **CD** to start playback again if you have stopped briefly e.g. to change a CD.

**SELECTING A DIFFERENT TRACK DURING PLAYBACK**  
 The track number appears briefly in the display when you press **CD** or **CD** to skip tracks.  
 • Press **CD** once or more to skip to the next track(s).  
 • Press **CD** more than once to skip to previous tracks.  
 • Press **CD** once and playback will return to the beginning of the current track.  
**FINDING A PASSAGE WITHIN A TRACK**  
 1. During playback, press and hold **CD** or **CD**.  
 → The CD is played at high speed and low volume: the display will show 'C' and your current track number.  
 2. Release **CD** or **CD** when you recognize the passage you want.  
 → Normal CD playback and standby clock time resumes.

**RADIO RECEPTION (see figure 6)**  
 1. Press the **RADIO** button to switch on the radio.  
 → Radio touch screen controls appears throughout radio operation.  
 → The radio frequency and waveband appears in the display for 10 seconds before reverting back to the clock display.  
 2. Press the **BAND** button to select your waveband (FM/AM).  
 3. Tune to your station manually or automatically by using **CD** (up/down).

**To improve reception:**  
 - **FM**: extend the coil antenna fully at the back of the set for optimum reception.  
 - **AM**: uses a built-in antenna. Direct the antenna by adjusting the position of your set.  
 4. Adjust the sound using the **+ / - VOLUME**.  
 5. To switch off the radio, press the **TIME/ALARM** (CD/RADIO OFF) button.

**Return your Warranty Registration card today to ensure you receive all the benefits you're entitled to**

**Warranty Verification**  
 Registering your product within 10 days confirms your rights to maximum protection under the terms and conditions of your Philips warranty.

**Owner Confirmation**  
 Your completed Warranty Registration Card serves as verification of ownership in the event of product theft or loss.

**Model Registration**  
 Returning your Warranty Registration Card right away guarantees you'll receive all the information and special offers which you qualify for as the owner of your model.

**CAUTION**  
 This 'bolit of lightning' indicates uninsulated material within your unit may cause an electrical shock. For the safety of everyone in your household, please do not remove product covering.  
 The 'exclamation point' calls attention to features for which you should read the enclosed literature closely to prevent operating and maintenance problems.

**IMPORTANT SAFETY INSTRUCTIONS**

1. Read these instructions.
2. Keep these instructions.
3. Heed all warnings.
4. Follow all instructions.
5. Do not use this apparatus near water.
6. Clean only with dry cloth.
7. Do not block any ventilation openings.
8. Do not install near any heat sources such as radiators, heat registers, stoves, or other apparatus (including amplifiers) that produce heat.
9. Do not defeat the safety purpose of the polarized or grounding-type plug. A polarized plug has two blades with one wider than the other. A grounding-type plug has two blades and a third grounding prong. The wide blade or the third prong are provided for your safety. If the provided plug does not fit into your outlet, consult an electrician for replacement of the obsolete outlet.
10. Protect the power cord from being walked on or pinched, particularly at plugs, convenience receptacles, and the point where they exit from the apparatus.
11. Only use attachments/accessories specified by the manufacturer.
12. Use only with the cart, stand, tripod, bracket, or table specified by the manufacturer or sold with the apparatus. When a cart is used, use caution when moving the cart/apparatus combination to avoid injury from tip-over.
13. Unplug this apparatus during lightning storms or when unused for long periods of time.
14. Refer all servicing to qualified service personnel. Servicing is required when the apparatus has been damaged in any way such as power-supply cord or plug is damaged, liquid has been spilled or objects have fallen into the apparatus, the apparatus has been exposed to rain or moisture, does not operate normally or has been dropped.
15. Battery usage **CAUTION** - To prevent battery leakage which may result in bodily injury property damage, or damage to the unit:  
 • Install all batteries correctly + and - as marked on the unit.  
 • Do not mix batteries (old and new or carbon and alkaline, etc.)  
 • Remove batteries when the unit is not used for a long time.

**Class II equipment symbol**  
 This symbol indicates that the unit has a double insulation system

**LIMITED WARRANTY**

**PORTABLE AUDIO**  
 One Year Free Exchange  
 This product must be carried in for an exchange.

**WHO IS COVERED?**  
 You must have proof of purchase to exchange the product. A sales receipt or other document showing that you purchased the product is considered proof of purchase. Attach it to this owner's manual and keep both nearby.

**WHAT IS COVERED?**  
 Warranty coverage begins the day you buy your product for one year thereafter. A defective or inoperative product will be replaced with a new, renewed or comparable product at no charge to you. A replacement product is covered only for the original warranty period. When the warranty on the original product expires, the warranty on the replacement product also expires.

**WHAT IS EXCLUDED?**  
 Your warranty does not cover:  
 • labor charges for installation or setup of the product, adjustment of customer controls on the product, and installation or repair of antenna systems outside of the product.  
 • product repair and/or part replacement because of misuse, accident, unauthorized repair or other cause not within the control of Philips.  
 • a product that requires modification or adaptation to enable it to operate in any country other than the country for which it was designed, manufactured, approved and/or authorized for repair of products damaged by these modifications.  
 • incidental or consequential damages resulting from the product. Some states do not allow the exclusion of incidental or consequential damages, so the above exclusion may not apply to you. This includes, but is not limited to, pre-recorded material, whether copyrighted or not copyrighted.  
 • a product used for commercial or institutional purposes.

**WHERE IS EXCHANGE AVAILABLE?**  
 You may exchange the product in all countries where the product is officially distributed by Philips. In countries where Philips does not distribute the product, the local Philips service organization will attempt to provide a replacement product (although there may be a delay if the appropriate product is not readily available).

**EXCHANGING A PRODUCT IN U.S.A., PUERTO RICO, OR U.S. VIRGIN ISLANDS.**  
 Contact 1-800-531-0039 to arrange an exchange. Or, ship the product, insured and freight prepaid and with proof of purchase enclosed, to the address listed below:  
 Philips Exchange Program  
 Suite A  
 406 North Irish Street  
 Greenville TN 37745  
 (In U.S.A., Puerto Rico, and U.S. Virgin Islands, all limited warranties, including implied warranties of merchantability and fitness for a particular purpose, are limited in duration to the duration of this express warranty. But because some states do not allow limitations on how long an implied warranty may last, this limitation may not apply to you.)

**EXCHANGING A PRODUCT IN CANADA...**  
 Please contact Philips at:  
 1-800-661-6162 (French Speaking)  
 1-800-531-0039 (English or Spanish Speaking)  
 (In Canada, this warranty is given in lieu of all other warranties. No other warranties are expressed or implied, including any implied warranties of merchantability or fitness for a particular purpose. Philips is not liable under any circumstances for any direct, indirect, special, incidental or consequential damages, however incurred, even if notified of the possibility of such damages.)

**REMEMBER...**  
 Please record below the model and serial numbers found on the product. Also, please fill out and mail your warranty registration card promptly. It will be easier for us to notify you if necessary.

MODEL # \_\_\_\_\_  
 SERIAL # \_\_\_\_\_

Philips, P.O. Box 520890, Miami, FL 33152, USA, (402) 536-4171  
 EL609511004 / B-02

This product complies with the FCC-Rules, Part 15 and with 21 CFR 1040.10. Operation is subject to the following two conditions:  
 1. This device may not cause harmful interference, and  
 2. This device must accept any interference received, including interference that may cause undesired operation.

L'appareil répond aux normes FCC, Part 15 et 21 CFR 1040.10. Fonctionnement soumis aux deux conditions suivantes:  
 1. Cet appareil ne doit pas provoquer d'interférences nuisibles, et  
 2. Cet appareil doit accepter toute interférence reçue, y compris les interférences susceptibles de provoquer un fonctionnement peu satisfaisant.

El aparato cumple las normas FCC, Parte 15 y 21 CFR 1040.10. Funcionamiento dependiente de dos condiciones siguientes:  
 1. Este aparato no puede provocar interferencia dañina, y  
 2. Este aparato debe aceptar cualquier interferencia recibida, incluyendo las interferencias que pueden provocar un funcionamiento insuficiente.

**Canada**  
**English:**  
 This digital apparatus does not exceed the Class B limits for radio noise emissions from digital apparatus as set out in the Radio Interference Regulations of the Canadian Communications Commission.  
**Français:**  
 Cet appareil numérique n'émet pas de bruits radioélectriques dépassant les limites applicables aux appareils numériques de Classe B prescrites dans le Règlement sur le Bruitage Radioélectrique édicté par le Ministère des Communications du Canada.

**NOTES**



**NOTES**

