

Shark

www.sharkclean.com

VAC-OR-STEAM™

MV3010

OWNER'S GUIDE



IMPORTANT SAFETY INSTRUCTIONS

For Household Use Only

WHEN USING YOUR **SHARK®** **VAC-OR-STEAM™**, BASIC SAFETY PRECAUTIONS SHOULD ALWAYS BE FOLLOWED, INCLUDING THE FOLLOWING:

WARNING: TO REDUCE THE RISK OF FIRE, ELECTRIC SHOCK OR INJURY READ ALL INSTRUCTIONS BEFORE USING YOUR **VAC-OR-STEAM™**.



DANGER OF SCALDING.

Please use caution when using the steam function. The steam emitted from the appliance is very hot.

1. Use the system only for its intended use.
2. **DO NOT** use outdoors. Use only on dry, indoor surfaces.
3. **DO NOT** leave the appliance unattended when plugged in. Always unplug the power cord from the electrical outlet when not in use and before servicing.
4. **DO NOT** allow the appliance to be used by children. Close attention is necessary when used by or near children, pets or plants.
5. **DO NOT** operate the appliance with a damaged plug or cord, or if the unit has been dropped, damaged, left outdoors or dropped into water. To avoid the risk of electric shock, do not disassemble or attempt to repair the appliance on your own. Return the appliance to EURO-PRO Operating LLC (see warranty) for examination and repair. Incorrect re-assembly or repair can cause a risk of electrical shock or injury to persons when the appliance is used.
6. Use only as described in this manual.
7. Use only manufacturer's recommended accessories and replacement pads.
8. To protect against a risk of electric shock, **DO NOT** immerse the appliance into water or any other liquids.
9. **DO NOT** use for space heating purposes.
10. **DO NOT** handle plug or appliance with wet hands or operate appliance without shoes.
11. **DO NOT** pull or carry by power cord, use power cord as a handle, close a door on the power cord, or pull the power cord around sharp edges or corners. Do not run appliance over cord. Keep power cord away from heated surfaces.
12. **DO NOT** unplug by pulling on power cord. To unplug, grasp the plug not the power cord. Do not use extension cords or outlets with inadequate current carrying capacity.
13. **DO NOT** put any objects into the unit openings. Do not use the unit if any opening is blocked; keep free of dust, lint, hair and anything that may reduce airflow.
14. **DO NOT** put hands or feet under the **Vac-OR-Steam™**. Unit gets very hot and may burn.
15. Use **ONLY** on flat, horizontal surfaces. Do not use on walls, counters or windows.
16. **DO NOT** use on leather, wax polished furniture and floors, synthetic fabrics, velvet or other delicate, steam sensitive materials.
17. **DO NOT** add cleaning solutions, scented perfumes, oils or any other chemicals to the water used in this appliance as this may damage the unit or make it unsafe for use and void the warranty. If you live in a hard water area, we recommend using distilled water in your **Vac-OR-Steam™**.
18. When in use, **NEVER** turn the appliance over or on its side. **NEVER DIRECT STEAM TOWARDS PEOPLE, ANIMALS OR PLANTS.**
19. **NEVER LEAVE THE CLEANING UNIT IN ONE SPOT ON ANY SURFACE FOR ANY PERIOD OF TIME WHEN MULTI-PURPOSE PAD IS ATTACHED.**
20. Carefully remove the multi-purpose pad immediately after you have unplugged and allowed the appliance to cool.



TOLL FREE: 1-800-798-7398

21. When cleaning the appliance, unplug the power cord from the electrical outlet and clean with a dry or damp cloth. Do not pour water or use alcohol, benzene or paint thinner on the unit.
 22. Extreme caution should be exercised when using this appliance to clean stairs.
 23. Never use the steam function without the multi-purpose pad attached.
 24. Keep your work area well lit.
 25. Store appliance indoors in a cool, dry place.
 26. To avoid circuit overload, do not operate another appliance on the same socket (circuit) as the cleaning unit.
 27. If an extension cord is absolutely necessary, an extension cord rated a minimum of 15 ampere, 14 gage cord should be used. Cords rated for less amperage may overheat. Care should be taken to arrange cord so that it cannot be pulled or tripped over.
 28. **DO NOT** store unit with damp/wet multi-purpose cleaning pad attached.
 29. **DO NOT** use the vacuum function without dust cup and filter in place.
 30. **DO NOT** vacuum up any liquids.
 31. **DO NOT** pick up anything that is burning or smoking such as cigarettes, matches or hot ashes.
 32. To reduce the risk of fire **DO NOT** use to pick up flammable or combustible liquids such as gasoline or use vacuum in areas where flammable or combustible fumes may be present.
 33. **DO NOT** pick up toxic solutions such as chlorine bleach, ammonia or drain cleaner with the cleaning unit.
 34. **DO NOT** use in an enclosed space where vapors are present from paint, paint thinner, mothproofing substances, flammable dust or other explosive or toxic materials.
 35. **DO NOT** run the cleaning unit over large-sized objects.
 36. **DO NOT** pick up hard or sharp objects such as glass, nails, screws or coins that could damage the cleaning unit.
 37. **DO NOT** place appliance on unstable surfaces such as chairs or tables.
 38. **DO NOT** allow the cleaning unit to be used as a toy.
 39. Close attention is necessary when used near children.
 40. Keep hair, loose clothing, fingers and all parts of the body away from openings and moving parts.
 41. Turn off all controls before plugging or unplugging your **Vac-OR-Steam™**.
- ⚠ WARNING:** Your appliance is designed to clean non-carpeted, sealed hard floor surfaces that will withstand high heat. Do not use on unsealed wood or unglazed ceramic floors, on surfaces that have been treated with wax or on some no wax floors. The sheen may be removed by the heat and steam action. It is always recommended to test an isolated area of the surface to be cleaned before proceeding. We also recommend that you check the use and care instructions provided by the floor manufacturer.
- ⚠ POLARIZED PLUG TO REDUCE THE RISK OF ELECTRIC SHOCK,** this appliance has a polarized plug (one blade is wider than the other). As a safety feature, this plug will fit into a polarized outlet only one way. If the plug does not fit fully into the outlet, reverse the plug. If it still does not fit, contact a qualified electrician. **DO NOT ATTEMPT TO DEFEAT THIS SAFETY FEATURE.**

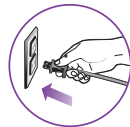

SAVE THESE INSTRUCTIONS

Steam Technology

Thank you for purchasing the Shark® Vac-OR-Steam™, the complete bare floor and carpet cleaning system.

The unique steam technology, turns simple tap water into super-heated steam that infuses the multi-purpose pads for chemical free cleaning. Only this method creates and delivers 212°F steam that is effective enough to clean and sanitize all your hard floor surfaces. The Shark® Vac-OR-Steam™ can help you achieve a truly clean and healthy environment for you and your family.

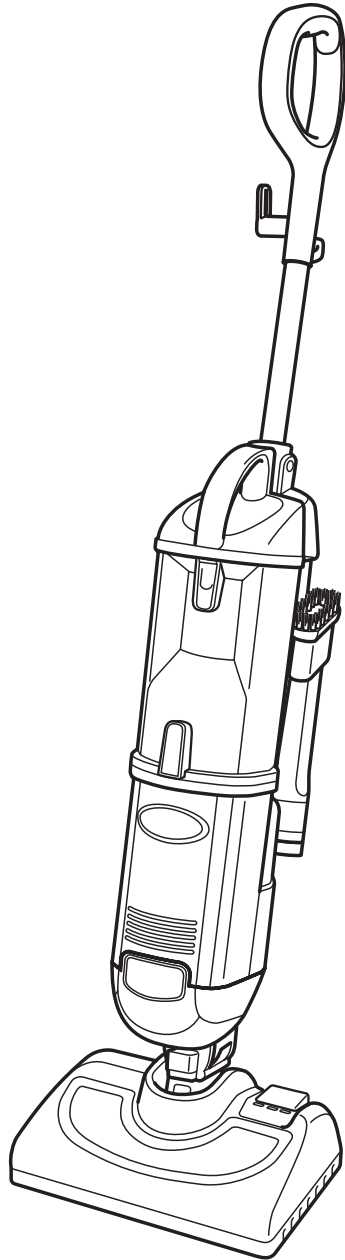

THIS BOOK COVERS MODEL NUMBER:

MV3010 40

TECHNICAL SPECIFICATIONS

Voltage: 120V., 60Hz.

Power: 1200 Watts

Water
Capacity: 500 ml (16.9 oz.)



TOLL FREE: 1-800-798-7398

Contents

Getting Started: Assembly	2
Vacuum Mode: Assembly	3
Vacuum Mode.....	4
Vacuum Mode: Storage.....	7
Steam Mode: Assembly	8
Steam Mode.....	9
Steam Mode: Storage.....	11
Troubleshooting Guide.....	12
Warranty and Registration	15

Getting Started

The **Vac-OR-Steam™** has two operating modes:

VACUUM MODE:

When assembling your **Vac-OR-Steam™** there may be a little water in or around the water tank of the steam nozzle. This is because we quality test all our **Shark®** products before distributing them, so you get a quality **Shark® Vac-OR-Steam™**.

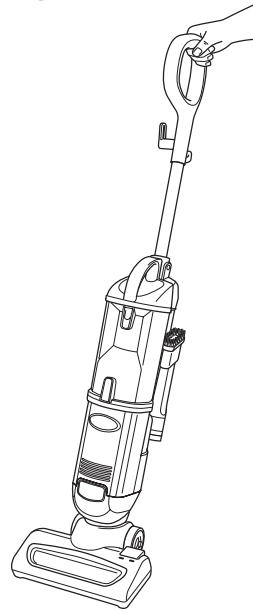
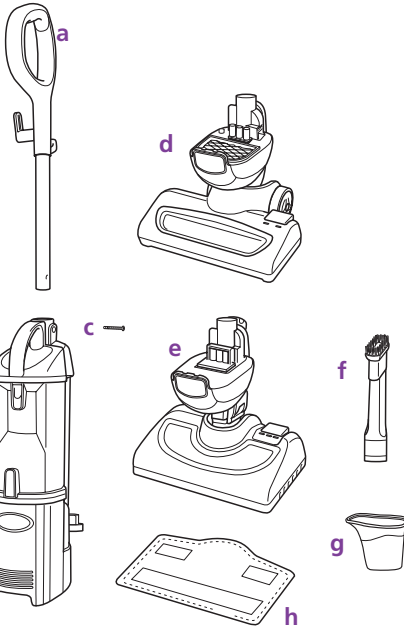

STEAM MODE:

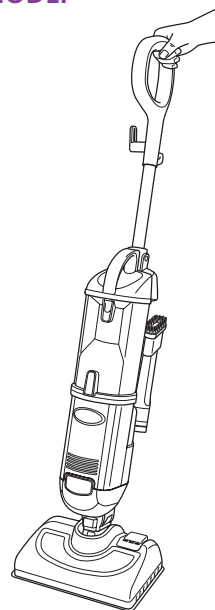

- a Mop Handle
- b Main Body with Dust Cup
- c Screw
- d Vacuum Nozzle
- e Steam Nozzle
- f Crevice/Brush Combo Tool
- g Filling Flask
- h Multi-Purpose Steam Pads (x2)



Vacuum Mode: Assembly

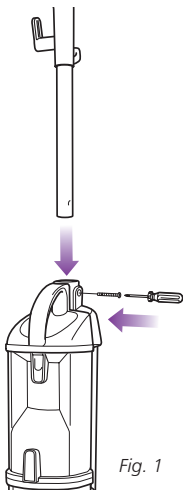

Fig. 1

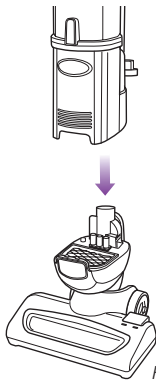

Fig. 2



Fig. 3

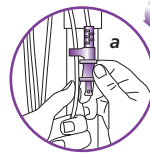
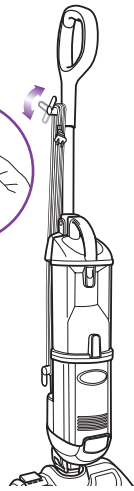

Fig. 4



ASSEMBLY

- 1 Insert the handle into the body. Use a screwdriver (not included) to secure the handle assembly in place with the screw provided. (Fig. 1)

ATTACHING THE VACUUM NOZZLE

- 1 Place the main unit on top of the vacuum nozzle and press down to make sure that the vacuum nozzle is firmly secure to the vacuum body. (Fig. 2) You will hear an audible click when the two parts are attached correctly.
- 2 Place the crevice/brush combo tool on the tool holder on the main body of the unit. (Fig. 3)
- 3 Wrap the power cord around the cord holders and secure the plug to the cord (a). (Fig. 4)

Vacuum Mode

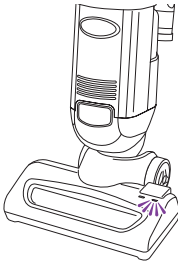

Fig. 5

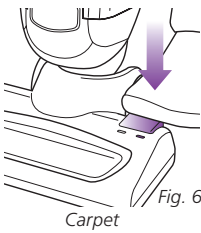

Fig. 6

Carpet

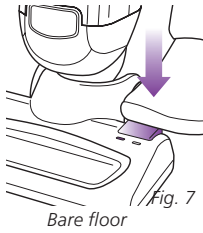

Fig. 7

Bare floor

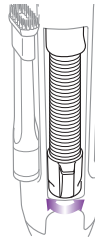

Fig. 8

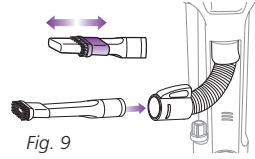

Fig. 9



Fig. 10

USING VACUUM MODE

- 1 When the vacuum nozzle head is firmly in place, twist the quick release cord holder to unwrap the power cord completely. Plug in the unit. The carpet light (on the left hand side of the floor nozzle when standing behind the unit) will begin to blink blue. (Fig. 5) The vacuum is in standby mode.
- 2 To begin vacuuming, step on the foot pedal and the carpet light on the vacuum nozzle will be solid blue. (Fig. 6) Place your foot lightly on the top of the vacuum nozzle and tilt the handle back to begin vacuuming.
To switch to vacuuming in bare floor mode, step on the pedal once more. The bare floor light will now be solid blue. (Fig. 7)
To return to standby mode, step on the pedal once more.

NOTE: If the unit is jammed both bare floor and carpet lights will begin to blink blue. Please reference the troubleshooting guide for more information.

QUICK TIP: The vacuum can be switched from carpet to bare floor mode while actively vacuuming or while the unit is at rest. Switching to bare floor mode will disengage the brush roll.

USING THE ACCESSORIES

To use the crevice tool or the dusting brush:

- 1 Remove the accessory hose from the back of the unit by turning the hose to the left or right to unlock. (Fig. 8)
- 2 Insert the crevice/brush combo tool onto the end of the hose. (Fig. 9) To use it as a crevice tool, press the latch on the crevice nozzle and slide the brush down to expose the crevice nozzle.
- 3 To replace the accessory hose back into the vacuum, remove the accessories and insert the hose into the back of the vacuum. Push down to lock. (Fig. 10)

For best results empty the Dust Cup after each use; empty several times during prolonged usage or when it reaches the **MAX** fill line.

NEVER OVER-FILL THE DUST CUP.

⚠ Always unplug the vacuum from the electrical outlet before removing and emptying the dust cup.

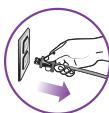

CAUTION:
Unplug the vacuum;
failure to do so might
result in electric
shock.



Fig. 11

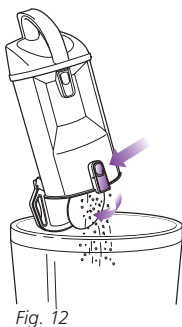

Fig. 12

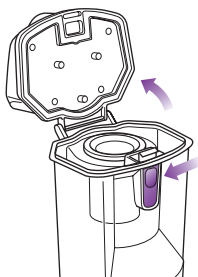

Fig. 13

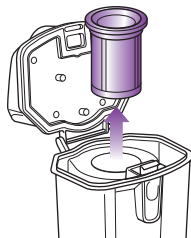

Fig. 14

EMPTYING THE DUST CUP

- 1 Press the dust cup release button on the top of the unit. Pull the dust cup out of the unit by pulling forward on the handle. (Fig. 11)
- 2 Hold the dust cup over a trash receptacle and press the button at the bottom of the dust cup to empty the dust cup. (Fig. 12)
- 3 Close the bottom trap door and replace the dust cup into the unit.
- 4 To replace the dust cup into the unit, gently push the dust cup assembly down and in. The dust cup will click into place.

EMPTYING THE DUST SCREEN

Over time the debris may gather in the dust screen of your **Vac-OR-Steam™**. Clean the dust screen often for optimal suction performance.

- 1 To clean the dust screen, press the top dust cup lid latch to access the dust screen and remove built-up debris as required. (Fig. 13, Fig. 14)
- 2 Place the dust screen back into the unit and close the dust cup lid. You will hear an audible click when the dust cup lid is closed and secure.
- 3 To replace the dust cup into the unit, gently push the dust cup assembly down and in. The dust cup will click into place.

Vacuum Mode - cont.

COMPONENT	MAINTENANCE SCHEDULE
1 Dust Cup	Empty each time you vacuum.
2 Pre-Motor Foam Filters	Rinse and air dry every month under normal use.
3 Post-Motor HEPA Filter	Clean once every 12 months under normal use.

⚠ NOTE: The material in the filters will discolor over time. This is NORMAL and will not affect the performance of the filters.

⚠ DO NOT operate the vacuum without ALL the filters in place.

⚠ DO NOT operate the vacuum with WET filters.

⚠ Always unplug the vacuum from the electrical outlet before doing any maintenance on the appliance.

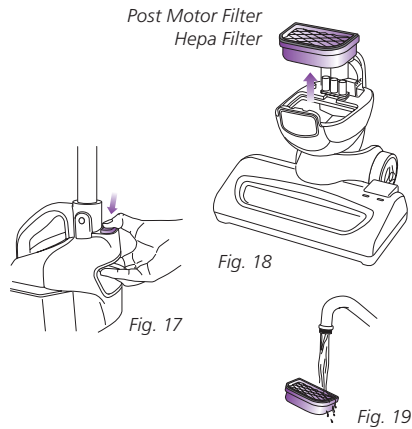
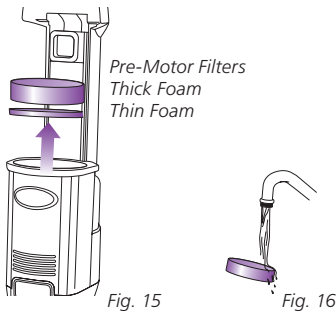

TO CLEAN THE PRE-MOTOR FILTERS

- 1 Press the dust cup release button on the top of the unit. Pull the dust cup out of the unit by pulling forward on the handle.
 - 2 Remove the two foam filters from the unit. (Fig. 15)
 - 3 Thoroughly rinse the two filters in lukewarm water. Squeeze out any excess water. (Fig. 16) Air dry for 24 hours before reusing.
- ⚠ DO NOT** use a hair dryer or any other forced hot air to dry the filter.
- 4 Insert a dry filter set into the unit. The order of the filters impacts your dust cup performance. Make sure the thick filter is on the top and the thin filter is on the bottom.

TO CLEAN THE POST-MOTOR HEPA FILTER

- 1 To release the vacuum nozzle, press the top "nozzle release" button first and then lift up on the main body. (Fig. 17)
 - 2 Lift the HEPA filter out from the vacuum nozzle. (Fig. 18)
 - 3 Thoroughly rinse the filter in lukewarm water. (Fig. 19) Air dry for 24 hours before reusing.
- ⚠ DO NOT** use a hair dryer or any other forced hot air to dry the filter.
- 4 Once it is thoroughly dry, replace the HEPA filter into the vacuum nozzle.
- ⚠ NOTE:** Any other servicing should be performed by an authorized service representative.

Occasionally the vacuum may become blocked by a build up of debris and the **Blockage Indicator light will illuminate**. It is important to locate where the blockage is and carefully remove it without causing damage to yourself, the unit or anything else. Perform the following steps to try to find the blockage.

- ⚠ Beware of sharp objects when clearing blockages.
- ⚠ Damages caused while clearing or attempting to clear blockages are not covered under your product's limited warranty.
- ⚠ Replace parts securely before using again.
- ⚠ Blockages may cause your vacuum to overheat and shut down. If so, clear the blockages, then follow the instructions for **Resetting the Motor Thermostat**.

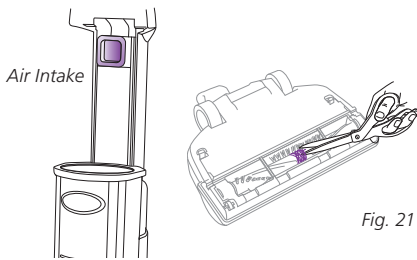

Fig. 20

CHECKING FOR BLOCKAGES

Dust Cup Air Duct:

- 1 Remove Dust Cup Assembly and empty Dust Cup if necessary.
- 2 Check Air Duct behind Dust Cup for clogs; clear before replacing Dust Cup Assembly. (Fig. 20)

CLEANING THE VACUUM NOZZLE:

The rotating brush in the vacuum nozzle must be free of debris for effective cleaning and maximum suction.

- 1 Disconnect the vacuum nozzle and turn it over to inspect the bottom. If a build-up of debris is wound around the rotating brush, remove by carefully cutting with scissors. Avoid damaging or cutting the bristles. (Fig. 21)

Vacuum Mode: Storage

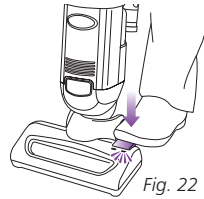

Fig. 22

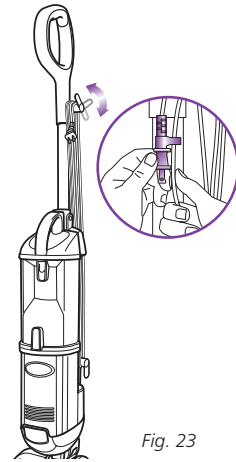

Fig. 23

- 1 Tilt the cleaning unit back into upright position.
- 2 Tap the foot pedal until the unit returns to standby mode. The carpet light (on the left hand side of the nozzle) should be blinking blue. (Fig. 22)
- 3 Unplug the unit.
- 4 Wrap cord around cord holders and secure plug. Store cleaning unit in an upright position. (Fig. 23)

TO RESET THE MOTOR THERMOSTAT:

- 1 Step on the foot pedal until it goes to standby mode.
- 2 Unplug the vacuum.
- 3 Empty the dust cup and clean filters.
- 4 Check for blockages in hose, accessories and inlet openings.
- 5 Allow the unit to cool for a minimum of 45 minutes.

Note: If vacuum still does not start, contact Customer Service at: 1-800-798-7398.

Steam Mode: Assembly

⚠ Always unplug the vacuum from the electrical outlet before changing cleaning nozzles.

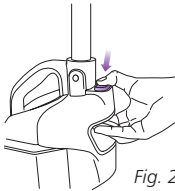

Fig. 24

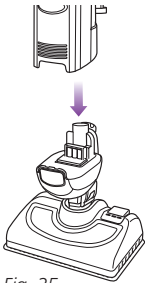

Fig. 25

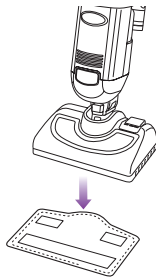

Fig. 26

💡 The **Vac-OR-Steam™**, is a complete bare-floor and carpet cleaning system. The steam nozzle also sanitizes bare floors.

Do not use chemicals or detergents in your **Vac-OR-Steam™**. You only need water to achieve super-heated, sanitizing steam.

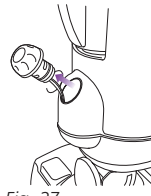

Fig. 27

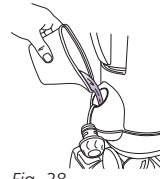

Fig. 28

CHANGING TO STEAM MODE

- 1 To release the vacuum nozzle and change to the steam nozzle, press the top “nozzle release” button. (Fig. 24) Lift the main body up and the vacuum nozzle will be released. You may need to apply gentle pressure to the nozzle head with your foot to separate the two parts.

ASSEMBLY STEAM MODE

- 1 Place the main unit on top of the steam nozzle and press down to make sure that the steam nozzle is firmly secure to the main body. (Fig. 25) You will hear an audible click when the two parts are attached correctly.

⚠ IMPORTANT: Steam nozzle head and multi-purpose steam pad must be attached to the cleaning unit in order to use the steam function.

- 2 Place the multi-purpose steam pad on the floor and position the steam nozzle over it. (Fig. 26)

⚠ IMPORTANT: Make sure the steam nozzle head is well secured to the main body by lifting up on the unit before use.

FILLING THE WATER TANK

- 1 Before use, make sure to fill the water tank. To fill the water into the steam nozzle head, turn the water fill cap counterclockwise to open. (Fig. 27)
- 2 Use the filling flask and pour water into the tank. (Fig. 28) Do not overfill. Replace the cap on the water tank by turning cap clockwise and tightening.

💡 QUICK TIP: The steam nozzle head can be filled with water before or after it is attached to the main body of the unit.

⚠ NOTE: If you live in a hard water area, we recommend using distilled water in your **Vac-OR-Steam™**.

AVOIDING DECALCIFICATION YOUR STEAM MOP

Calcium and mineral deposits can build up and impact the performance of your **Vac-OR-Steam™** over time. To extend the life of your product we recommend that you use distilled water.

Steam Mode

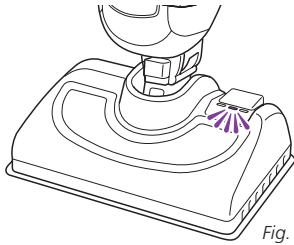
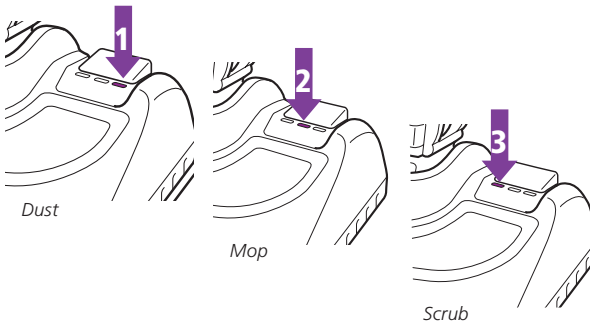

Fig. 29



Dust

Mop

Scrub

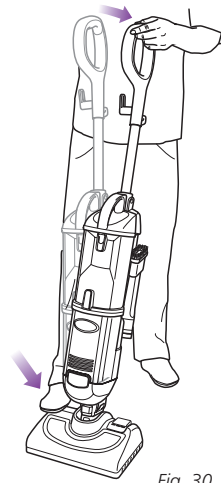

Fig. 30

USING STEAM MODE

- NOTE:** You should vacuum your bare floors before you steam them.
- 1 Twist the quick release cord holder to unwrap the power cord completely and plug in the unit. The LED lights on the steam nozzle will begin to flash blue in a chasing manner. (Fig. 29)
 - 2 To begin steaming, step gently on the foot pedal once to enter DUST mode (1). The DUST light on the unit will appear solid blue. DUST setting is a light steam for a quick dusting and fastest dry time.
To switch to MOP mode (2), step on the foot pedal a second time. The MOP mode light will appear solid blue. MOP setting is for normal, everyday steam cleaning.
To switch to SCRUB mode (3), step on the foot pedal a third time. The SCRUB mode light will appear solid blue. SCRUB setting is for heavy cleaning.

- 3 After selecting the preferred mode, place your foot lightly on the top of the steam nozzle and tilt the handle back. Begin mopping in a backward and forward motion. (Fig. 30)
To return to standby mode step on the pedal again until the LED lights are flashing blue in a chasing manner.



QUICK TIP: The steam mode (DUST, MOP, SCRUB) can be switched while actively steaming or while the unit is at rest.

- IMPORTANT:** Do not use the mop without attaching a multi-purpose cleaning pad and adding water to the tank first. When you are using the steam nozzle head for the first time, it might take longer than the 30 seconds to start steaming. **You will not notice any visible steam until the steam mode is chosen and the handle is tilted back.**

- NOTE:** Check water level and fill anytime throughout the cleaning process to maintain optimal steam.

Steam Mode - cont.

The **Shark®** Vac-OR-Steam™ has three unique steam settings so you can use the perfect amount of steam for the cleaning task at hand. See below for tips on when to use each setting.

Setting	Ideal for These Surfaces	Recommended Usage
DUST 	Laminate Bamboo Hardwood Marble	Light cleaning and dusting Loosen and lift light dirt Sanitize floors
MOP 	Hardwood Marble Tile Stone	Basic, everyday cleaning Remove spots and smaller messes Clean moderate and heavily-trafficked areas Sanitize floors
SCRUB 	Tile Stone Linoleum <hr style="border-top: 1px dashed black;"/> Carpet (with Carpet Glider)	Tough cleaning and removal of stuck-on messes and stains Deep clean heavily-trafficked areas Cut through heavy dirt and grime Sanitize floors <hr style="border-top: 1px dashed black;"/> Freshen area rugs and carpets



Steam Mode: Storage

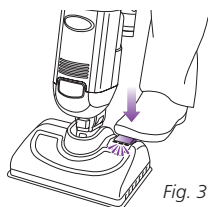

Fig. 31

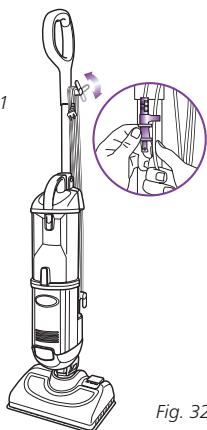

Fig. 32

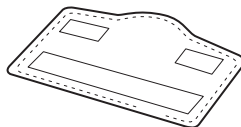

Fig. 33

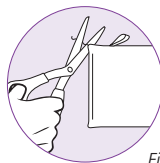

Fig. 34

STORAGE

- 1 Tilt the cleaning unit back to the upright position.
- 2 Tap the foot pedal until the unit returns to standby mode. The LED lights should be blinking blue in a chasing manner. (Fig. 31)
- 3 Unplug the unit.
- 4 Press your foot on the tail of the steam pad to separate the steam pad from the steam nozzle head by pulling up on the unit.
- 5 Wrap the cord around cord holders and secure the plug. (Fig. 32)
- 6 Press the top "nozzle release" button and lift the main body up and the steam nozzle will be released. You may need to apply gentle pressure to the steam nozzle head with your foot to separate the two parts.
- 7 Remove the water tank cap and empty the water tank.
- 8 Store the cleaning unit in an upright position. The unit can be stored with a nozzle on it or separately.

CARE OF YOUR MULTI-PURPOSE CLEANING PAD

- 1 We recommend washing your cleaning pad separately from other fabrics to avoid picking up lint. **Only use liquid detergent (no powder detergent) or bleach.** Line dry or dry on a low dryer setting. (Fig. 33)
 - 2 If there are loose threads on the cleaning pad carefully cut the thread with scissors. Do not pull on them or cut at the base. (Fig. 34)
- ! IMPORTANT:** The cleaning pad may be very hot from the steam. Use caution when removing. Let the unit cool for 2-3 minutes.

Troubleshooting Guide

PROBLEM	POSSIBLE REASONS & SOLUTIONS
<p>The Vac-OR-Steam™ will not turn on.</p>	<p>Your Vac-OR-Steam™ should be securely plugged into a 120V AC electrical outlet only.</p> <p>Check your fuse or breaker.</p> <p>Check to make sure the steam or vacuum nozzle is attached correctly.</p>
<p>The Vac-OR-Steam™ will not make steam.</p>	<p>Make sure the water tank is filled to the indicated fill line.</p> <p>Attach Steam Pad and Steam Nozzle to base of the unit.</p> <p>TILT MOP HANDLE BACK TO GENERATE STEAM.</p>
<p>The Vac-OR-Steam™ leaves water on the floor.</p>	<p>Check to see if your multi-purpose cleaning pad has absorbed too much moisture. We recommend you unplug the Vac-OR-Steam™ and replace the multi-purpose cleaning pad.</p> <p>Make sure the steam pad is attached correctly.</p> <p>Wait 30 seconds after choosing the steam setting before mopping, allowing water to heat to a 212°F sanitizing steam. If the unit is not allowed to heat properly, some water may be emitted.</p>
<p>The Vac-OR-Steam™ is hard to push.</p>	<p>Make sure the steam pad is attached correctly.</p> <p>Check to see if the cleaning pad is excessively dirty. Replace if the pad is too dirty or wet.</p>
<p>The Vac-OR-Steam™ is not picking up dirt.</p>	<p>Check filters to see if they need cleaning. Follow instructions for rinsing and drying the filters before re-inserting back into the unit. (See "Maintenance" sections for instructions.)</p> <p>Dust cup may be full. Empty the dust cup.</p> <p>Check nozzle or the air intake hose for blockages. Clear blockages if required.</p> <p>Check that no debris has clogged the brushroll on the vacuum nozzle. Follow instructions in "Cleaning the Vacuum Nozzle" section to clean the brushroll.</p>
<p>The Vac-OR-Steam™ turns off on its own.</p>	<p>The Vac-OR-Steam™ is equipped with a motor protective thermostat. If for some reason your appliance overheats, the thermostat will automatically turn the unit off. Should this occur, perform the following steps to restart the motor thermostat:</p> <ol style="list-style-type: none"> 1. Step on the foot pedal until it goes to standby mode. 2. Unplug the vacuum. 3. Empty the dust cup and clean filters. (See "Maintenance" sections for instructions.) 4. Check for blockages in hose, accessories and inlet openings. (See "Checking for Blockages" for instructions.) 5. Allow the unit to cool for a minimum of 45 minutes. 6. Plug in the vacuum. 7. Step on the foot pedal to select the vacuum mode and tilt the vacuum back to start vacuuming.



Ordering Parts

To order additional parts and accessories, go to www.sharkclean.com or call **1-800-798-7398**.

PART	PART NO.
Foam & HEPA Filters	XFF3010
Multi-Purpose Steam Pad	P130W3010
Carpet Glider	XCG3010
Wide Mouth Brush	XMT3010
18" Flexible Crevice Tool	X18FL3010
24" Flexible Crevice Tool	X24FL3010



EURO-PRO THREE (3) YEARS LIMITED WARRANTY

EURO-PRO Operating LLC warrants this product to be free from defects in material and workmanship for a period of three (3) years from the date of the original purchase, when utilized for normal household use, subject to the following conditions, exclusions and exceptions.

If your appliance fails to operate properly while in use under normal household conditions within the warranty period, return the complete appliance and accessories, freight prepaid. For assistance with warranty service options or customer support, please call our customer care and product specialists at , call 1 (800) 798-7398 or visit our website www.sharkclean.com.

If the appliance is found to be defective in material or workmanship, **EURO-PRO Operating LLC** will repair or replace it free of charge. Proof of purchase is required and a fee of \$19.95 will apply to cover the cost of return freight. *

The liability of **EURO-PRO Operating LLC** is limited solely to the cost of the repair or replacement of the unit at our option. This warranty does not cover normal wear of parts and does not apply to any unit that has been tampered with or used for commercial purposes. This limited warranty does not cover damage caused by misuse, abuse, negligent handling or damage due to faulty packaging or mishandling in transit. This warranty does not cover damage or defects caused by or resulting from damages from shipping or repairs, service or alterations to the product or any of its parts, which have been performed by a repair person not authorized by **EURO-PRO Operating LLC**.

This warranty is extended to the original purchaser of the unit and excludes all other legal and/or conventional warranties. The responsibility of **EURO-PRO Operating LLC** warranty if any, is limited to the specific obligations expressly assumed by it under the terms of the limited warranty. **In no event is EURO-PRO Operating LLC** liable for incidental or consequential damages of any nature whatsoever. Some states/provinces do not permit the exclusion or limitation of incidental or consequential damages, so the above may not apply to you.

This warranty gives you specific legal rights, and you may also have other rights which vary from state to state or province to province.

***Important: Carefully pack item to avoid damage in shipping. Be sure to include proof of purchase date and to attach tag to item before packing with your name, complete address and phone number with a note giving purchase information, model number and what you believe is the problem with the item. We recommend you insure the package (as damage in shipping is not covered by your warranty). Mark the outside of your package "ATTENTION CUSTOMER SERVICE". We are constantly striving to improve our products, therefore the specifications contained herein are subject to change without notice.**

Product Registration

Please visit www.sharkclean.com or call **1-800-798-7398** to register your new **Shark®** product within ten (10) days of purchase. You will be asked to provide the store name, date of purchase and model number along with your name and address.

The registration will enable us to contact you in the unlikely event of a product safety notification. By registering you acknowledge to have read and understood the instructions for use, and warnings set forth in the accompanying instructions.

Euro-Pro Operating LLC

US: Newton, MA 02459

CAN: Ville St-Laurent, QC H4S 1A7

1-800-798-7398

www.sharkclean.com

Copyright © 2012 Euro-Pro Operating LLC

Printed in China

Illustrations may differ from actual product.

MV3010.E.120713.2