

Hot Swappable Power Supply

Ordering Guide

for HP A5800-48G-PoE+ Switch with 2 Interface Slots

Part number: 5998-1958

Document version: 6W100-20110408



Legal and notice information

© Copyright 2011 Hewlett-Packard Development Company, L.P.

No part of this documentation may be reproduced or transmitted in any form or by any means without prior written consent of Hewlett-Packard Development Company, L.P.

The information contained herein is subject to change without notice.

HEWLETT-PACKARD COMPANY MAKES NO WARRANTY OF ANY KIND WITH REGARD TO THIS MATERIAL, INCLUDING, BUT NOT LIMITED TO, THE IMPLIED WARRANTIES OF MERCHANTABILITY AND FITNESS FOR A PARTICULAR PURPOSE. Hewlett-Packard shall not be liable for errors contained herein or for incidental or consequential damages in connection with the furnishing, performance, or use of this material.

The only warranties for HP products and services are set forth in the express warranty statements accompanying such products and services. Nothing herein should be construed as constituting an additional warranty. HP shall not be liable for technical or editorial errors or omissions contained herein.

Contacting HP

For worldwide technical support information, see the HP support website:

<http://www.hp.com/support>

Before contacting HP, collect the following information:

- Product model names and numbers
- Technical support registration number (if applicable)
- Product serial numbers
- Error messages
- Operating system type and revision level
- Detailed questions

Subscription service

HP recommends that you register your product at the Subscriber's Choice for Business website:

<http://www.hp.com/go/e-updates>

After registering, you will receive e-mail notification of product enhancements, new driver versions, firmware updates, and other product resources.

Warranty

The Hewlett-Packard Limited Warranty Statement for this product and the HP Software License Terms which apply to any software accompanying this product are available on the HP networking Web site at www.hp.com/networking/warranty. The customer warranty support and services information are available on the HP networking Web site at www.hp.com/networking/support. Additionally, your HP-authorized network reseller can provide you with assistance, both with services that they offer and with services offered by HP.

Documentation

For the latest documentation, visit the HP website, www.hp.com, and select the **Support & Troubleshooting** link.

- Choose **See support and troubleshooting information** radio button
- Enter product name/number OR choose the automatic product name/number detection OR select a product category
- From the product page, choose **Manuals** link to see the documentation associated with your product.

Hot Swappable Power Supply Ordering Guide

Power supply overview

Adopting advanced power supply design, the HP A5800-48G-PoE+ Switch with 2 Interface Slots (hereafter referred to as *A5800-48G-PoE+ (2 slot)*) and HP A5800-48G-PoE+ TAA Switch with 2 Interface Slots (hereafter referred to as *A5800-48G-PoE+ TAA (2 slot)*) features the following:

- Adopting hot swappable power supply design, each switch providing two hot swappable power supply slots, as shown in [Figure 1](#).
- Supporting different models of hot swappable power supplies. For more information, see [Table 1](#).
- Supporting combination of different hot swappable power supplies. You can select them as needed. For more information, see [Table 2](#).

Figure 1 Location of power supplies on an *A5800-48G-PoE+ (2 slot)/A5800-48G-PoE+ TAA (2 slot)* (rear panel)

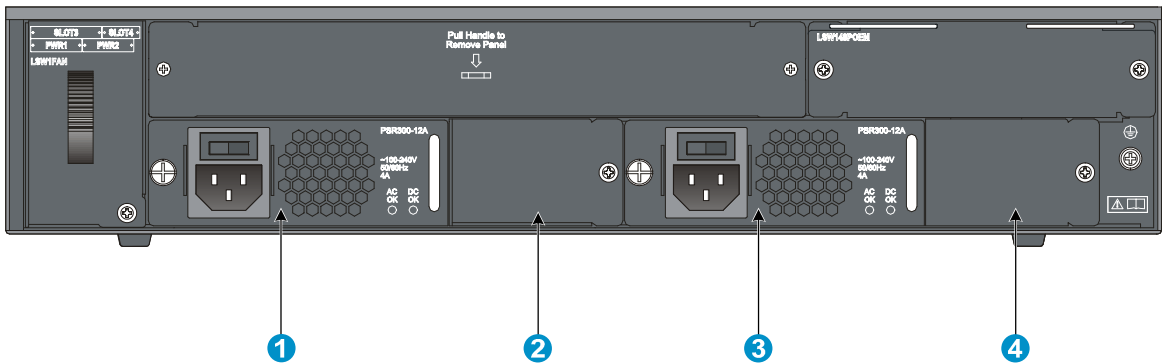

(1) Hot swappable power supply 1	(2) Filler module (Remove the module when hot swappable power supply 1 is a 750 W power supply.)
(3) Hot swappable power supply 2	(4) Filler module (Remove the module when hot swappable power supply 2 is a 750 W power supply.)

NOTE:

The A5800-48G-PoE+ (2 slot)/A5800-48G-PoE+ TAA (2 slot) provides two power supply slots on its rear panel. Hot swappable power supply slot 1 is empty when the switch is shipped, and hot swappable power supply slot 2 is installed with a filler panel. [Figure 1](#) illustrates a switch with two PSR300-12A AC power supplies.

Table 1 Power supply models supported by the *A5800-48G-PoE+ (2 slot)/A5800-48G-PoE+ TAA (2 slot)*

Model	Power supply mode
PSR300-12A (JC087A)	AC input (Rated voltage range: 100 VAC to 240 VAC; 50 Hz or 60 Hz)

Model	Power supply mode
PSR300-12D1 (JC090A)	–48 VDC equipment-room power supply (Rated voltage range: –48 VDC to –60 VDC) HP A-RPS1600 (JG136A) DC power supply (Rated voltage range: –52 VDC to –55 VDC)
PSR750-A (JC089A)	AC input (Rated voltage range: 100 VAC to 240 VAC; 50 Hz or 60 Hz)

Guide to purchase

Table 2 Hot swappable power supply configuration of the A5800-48G-PoE+ (2 slot)/A5800-48G-PoE+ TAA (2 slot)

Model (Slot 1)	Model (Slot 2)	30 W PoE	15.4 W PoE	Remarks
PSR300-12A	—	Not supported	Not supported	—
PSR300-12D1	—	Not supported	Not supported	—
PSR300-12A	PSR300-12A	Not supported	Not supported	Power supply backup
PSR300-12D1	PSR300-12D1	Not supported	Not supported	Power supply backup
PSR300-12A	PSR300-12D1	Not supported	Not supported	Power supply backup
PSR750-A	—	12-port middle power PoE (30 W)	24-port standard PoE (15.4 W)	Maximum PoE power: 425 W
PSR750-A	PSR750-A	24-port middle power PoE (30 W)	48-port standard PoE (15.4 W)	Maximum PoE power: 740 W

△ CAUTION:

- Do not plug a 300 W power supply (PSR300-12A or PSR300-12D1) and a 750 W power supply (PSR750-A) on one A5800-48G-PoE+ (2 slot)/A5800-48G-PoE+ TAA (2 slot).
- Purchase a power supply according to whether PoE is needed and the power of powered devices (PDs) to ensure normal PoE power supply. For the introduction and installation of hot swappable power supplies, see the corresponding power supply user manual or *HP A5800 Switch Series Installation Guide*.