

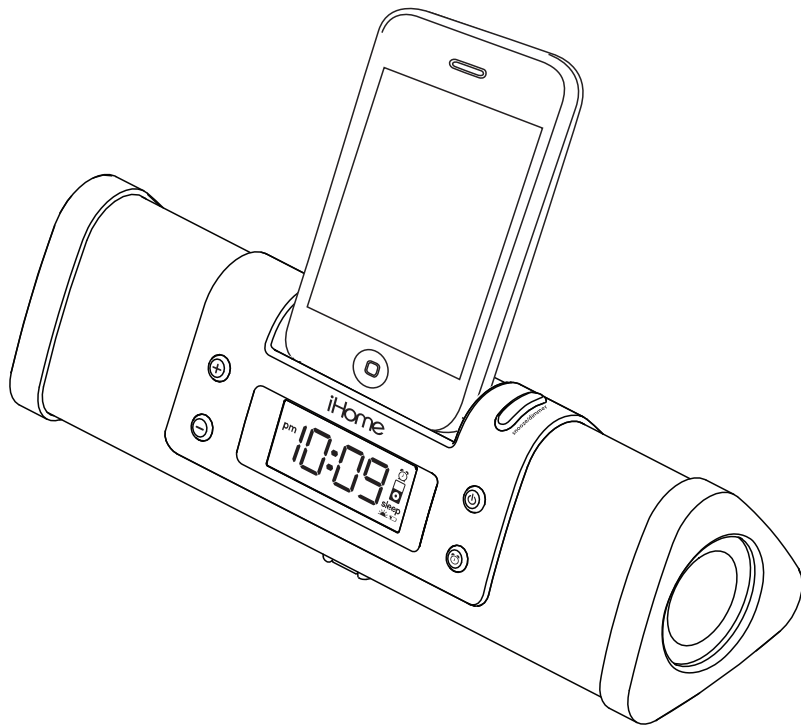

Model iP16  
**Portable Alarm Clock Speaker  
System for your iPhone / iPod®**



**Questions? Visit [www.ihomeaudio.com](http://www.ihomeaudio.com)**

## Table of Contents

Quick Start .....	1
Controls and Indicators .....	2
iP16 Display .....	3
Install Clock Backup Battery .....	3
Using iP16 .....	4
Charging your iPhone / iPod .....	4
Listening to your iPhone / iPod .....	4
Setting the Time .....	5
Alarm Operation .....	6
Sleep Operation .....	7
Snooze/Dimmer Operation .....	7
A Consumer Guide to Product Safety .....	8
Trouble Shooting .....	9
Solución De Problemas .....	10
Warranty Information .....	11

## Maintenance

- Place the unit on a level surface away from sources of direct sunlight or excessive heat.
- Protect your furniture when placing your unit on a natural wood and lacquered finish. A cloth or other protective material should be placed between it and the furniture.
- Clean your unit with a soft cloth moistened only with mild soap and water. Stronger cleaning agents, such as Benzine, thinner or similar materials can damage the surface of the unit.

**NOTE:** Be careful not to touch the surface of the speakers at either end of the unit

## Getting Started

**Thank you for purchasing the iHome iP16 Audio Speaker System for your iPhone/iPod. Designed specifically to work with your iPhone/iPod, this system provides high quality audio performance that brings out the best in your music.**

**Please read this instruction book carefully before operating the iP16 and keep it for future reference.**

### Check for iPhone/iPod compatibility

iP16 is an advanced system and supports most updated iPod features. To make sure your iPhone/iPod works properly with iP16, please update your iPhone/iPod firmware with the latest version via iTunes.

## FCC Information

This device complies with Part 15 of the FCC Rules. Operation is subject to the following two conditions: (1) This device may not cause harmful interference, and (2) this device must accept any interference received, including interference that may cause undesired operation.

**Warning:** Changes or modifications to this unit not expressly approved by the party responsible for compliance could void the user's authority to operate the equipment.

**NOTE:** This equipment has been tested and found to comply with the limits for a Class B digital device, pursuant to Part 15 of the FCC Rules. These limits are designed to provide reasonable protection against harmful interference in a residential installation. This equipment generates, uses and can radiate radio frequency energy and, if not installed and used in accordance with the instructions, may cause harmful interference to radio communications. However, there is no guarantee that interference will not occur in a particular installation. If this equipment does cause harmful interference to radio or television reception, which can be determined by turning the equipment off and on, the user is encouraged to try to correct the interference by one or more of the following measures:

- Reorient or relocate the receiving antenna.
- Increase the separation between the equipment and receiver.
- Connect the equipment into an outlet on a circuit different from that to which the receiver is connected.
- Consult the dealer or an experienced radio/TV technician for help.

This Class B digital apparatus complies with Canadian ICES-003.

Cet appareil numérique de la classe B est conforme à la norme NMB-003 du Canada.

## Battery Warning

### For models that use Lithium batteries

- Lithium batteries can explode or cause burns if disassembled, shorted, recharged, exposed to water, fire, or high temperatures & not handled appropriately
- Do not place loose batteries in a pocket, purse, or other container containing metal objects, do not mix with used or other battery types, or store with hazardous or combustible materials.
- Store in cool, dry, ventilated area.
- Follow applicable laws and regulations for transport and disposal.

### For models that require more than one battery

- Do not mix with used or other battery types/brands
- Replace all batteries at the same time
- Do not open batteries
- Do not dispose of in fire
- Do not heat above 75°C (167°F)
- Do not expose contents to water
- Do not charge or recharge
- Do not install backwards

# Quick Start

## 1:power

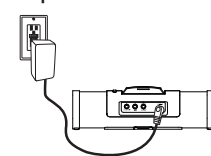

Attach the AC adaptor cable to the DC jack on the back of the iP16 and plug the other end into a working wall socket. *For portable operation*, remove battery compartment door on the bottom of the unit and insert 4 AA batteries (see diagram on page 4).

## 2:inserts

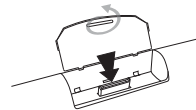

See the table below to find which side of the dock insert matches your iPhone/iPod model and place insert in dock. NOTE: iPhone 3G, iPhone 3GS, iPod Classic 160 GB and nano 6G do not require the insert.

- 1) Turn insert so correct side of the insert for your iPhone/iPod is facing the display.
- 2) Slide insert downwards until it snaps into place

## 3:iPhone/iPod

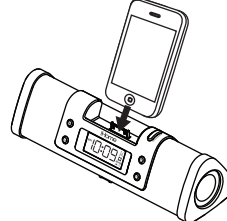

Gently dock iPhone/iPod into dock (iPhone/iPod must not be in a skin or case). iPhone/iPod will charge while docked. Press the **Power Button** on the iP16 to play the iPhone/iPod.

Use this insert		Classic/Touch side	Nano side
For this iPhone/iPod	no insert needed for iPod Classic 160 GB iPhone 3G/3GS iPod nano 6G	iPod classic (80, 120 GB) iPhone 4, iPod touch	all iPod nano models up to nano 5G

## 4:time



*To use Time Sync*, dock your iPhone or iPod touch and press the **Clock Adj. Button**. SYN will appear on the display and the unit will sync to the time on your iPhone or iPod.

*To set time manually*,

- Press the **DST On/Off Button** on the back of the unit as needed to add or subtract an hour for daylight saving time or standard time.
- Press & Hold the **Clock Adj. button** on the back of the unit until the hour display flashes.
- Press the **+** or **- buttons** to set the hour, then press the Clock Adj. button
- Press the **+** or **- buttons** to set the minutes then press the Clock Adj. button again to confirm time setting.

## Controls and Indicators

### Front Panel

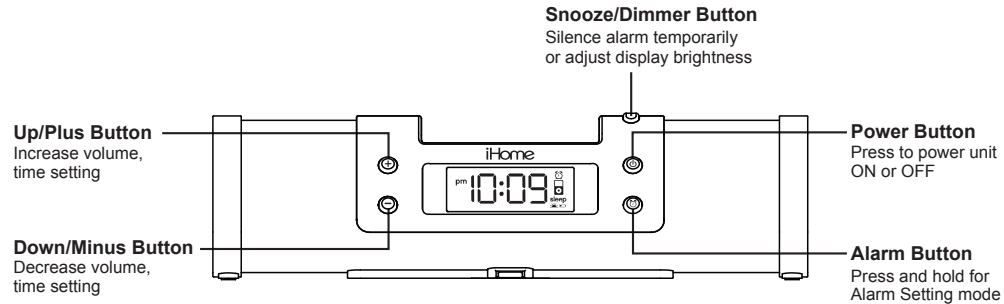

### Back Panel

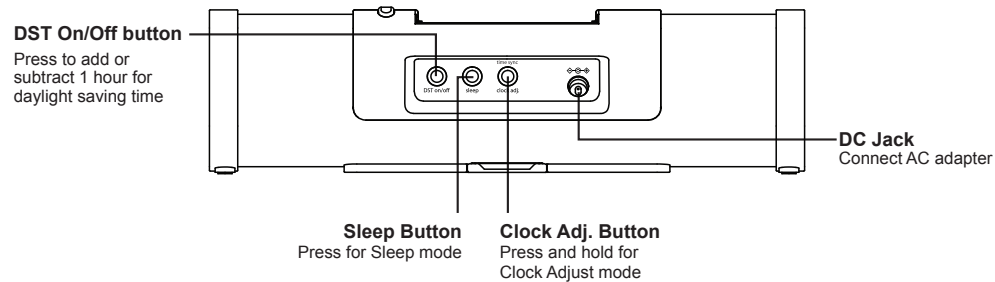

## iP16 Display

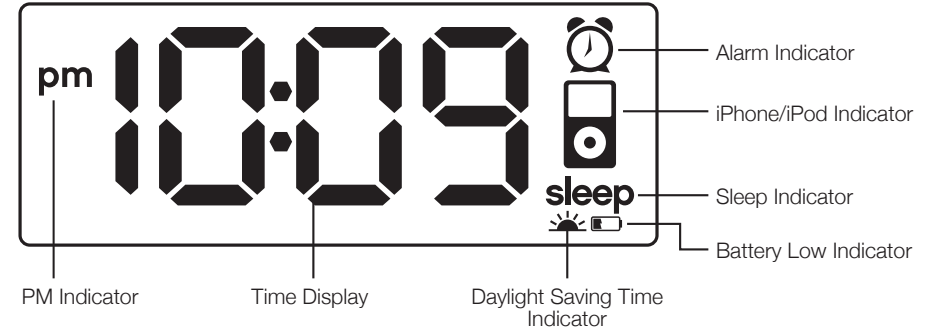

## Install Clock Backup Battery

The iP16 uses a CR2032 button cell battery (included with instructions) to keep alarm and clock settings in the event of a power failure and 4 “AA” batteries to maintain alarm operation.

If the Backup Battery has been installed and a power failure occurs or the AC adaptor is accidentally disconnected, the display backlight will not remain lit, but current time and alarm time settings will be temporarily maintained. Otherwise, you must reset the time and alarm settings. If 4 “AA” batteries are installed, alarm will operate when unit is not connected to AC adaptor.

1. Please make sure the AC adaptor is connected. Otherwise all settings may be lost during battery replacement.
2. Open and remove the battery compartment release tab located on the bottom of the unit.
3. Pinch the backup battery release tab and pull the backup battery holder free.
4. Insert one CR2032 button cell battery with the + side facing upwards.
5. Replace the backup battery holder into the unit, then replace the battery compartment door.

**Note:** Make sure you dispose of batteries properly (see your local regulations).

**Note:** Buttons will not function if only back up battery installed.

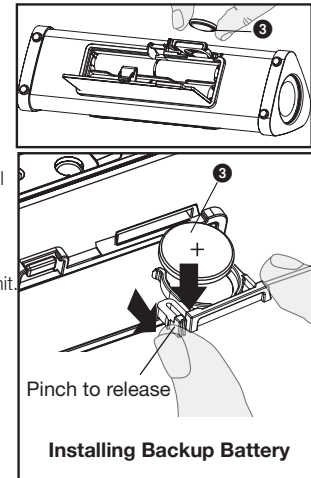

## Using iP16

### Install AC Adaptor

Connect the AC adaptor cable plug into the jack on the back of the iP16, then plug the AC adaptor into the wall outlet.

### Install iPhone/iPod Insert

Your iP16 comes with a double-sided insert to ensure certain iPhone/iPod models fit properly in the dock. To place an insert:

1. Identify the side of the insert that matches your iPhone/iPod model (see table on page 1).
2. Gently press the iPod insert into the dock with the proper side facing the connector pins.

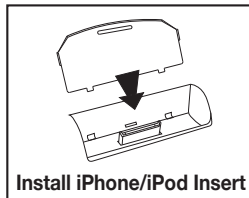

### Installing/Replacing Batteries for Portable Operation

The iP16 uses 4 “AA” batteries for portable operation. The iP16 will not charge your iPhone/iPod while operating on batteries.

If sound becomes weak or distorted, it is time to replace the batteries.

- Open the battery compartment cover located on the bottom of the unit.
- Insert 4 “AA” batteries as indicated. Replace battery compartment cover.
- We recommend the use of alkaline batteries for longer life.

**NOTE:** To save battery life, when running on batteries, unit will automatically power OFF after 3 minutes of non-use (no song playing).

Batteries information:

- Do not mix alkaline, standard (carbon -zinc) or rechargeable (nickel-cadmium) batteries.

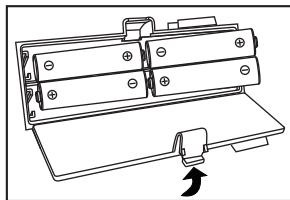

## Charging Your iPhone/iPod

**Note:** Please make sure you are using the correct side of the insert for your iPhone/iPod model, if needed (see Install iPhone/iPod Insert) and that your iPhone/iPod is properly docked into the iP16.

1. While your iPhone/iPod is docked in the unit and the unit is connected to AC power, it recharges until fully charged. iPhone/iPod will not be overcharged. Unit will not charge iPhone/iPod when operating on batteries.

## Listening to Your iPhone/iPod

1. Dock an already playing iPhone/iPod and the iP16 will automatically turn on. You will hear the music playing from your iPhone/iPod. **Note:** If the volume on the playing audio is too low on the iPhone/iPod, the iP16 may not detect that the iPhone/iPod is in play mode. Press the **⏮** button once to play iPhone/iPod.
2. When the iPhone/iPod is docked and in standby mode, press the **⏮** button on the iP16 to play your iPhone/iPod.
3. Press **play/pause** on your iPhone/iPod to pause play; press again to resume it.
4. Press the **+** or **-** buttons on the iP16 to adjust the system volume.
5. To turn off the unit, press the **⏮** button on the iP16. Your iPhone/iPod will continue charging while in the dock.

## Setting the Time

### Setting the Time using Time Sync

Time sync mode allows you to sync the iP16 to the time from your iPhone or recent models of iPod like iPod

Touch, iPod Nano and iPod Classic (older models such as iPod Mini do not support this feature).

1. Make sure your iPhone or iPod is properly docked. Press the **Clock Adj. Button** located at the back of the unit.

“SYN” will appear on the display, indicating sync function is in progress.

2. After sync is complete, the display will show the current time from your iPhone/iPod clock and two beeps will confirm time sync is done.
3. If time sync fails, 2 second long beeps sound and the unit exits time sync mode. Try syncing again with a different iPhone or iPod or set time manually (see below).

NOTE: The iPhone is constantly updated to current time via cell phone towers. The time on your iPod is only accurate to the last time it was synced to a computer. It's possible to have up to 59 seconds difference between the iP16 and synced iPhone/iPod.

### Setting the Time Manually

1. Press and hold the **Clock Adj. Button** for 2 seconds until the hour display flashes. Press the **+** or **- Button** until the current hour is displayed. Remember to set the correct AM or PM time (a PM icon to the left of the time display is the PM indicator; there is no AM indicator). Note that the PM indicator will not appear when using 24 hour display mode.
2. Press the **Clock Adj. Button** again. The minute display will flash. Press the **+** or **- Button** until the current minute is displayed. Hold for rapid advance.
3. Press the **Alarm Set Button** during time setting to toggle 12-hour or 24-hour display format.
4. Press the **Clock Adj. Button** again to confirm the clock setting. You will hear 2 beeps indicating the clock time is set.
5. Press the **DST on/off Button** located on the back of the unit to add one hour for daylight saving time (on) or to subtract one hour for standard time (off). The **☀** icon will appear on the display to indicate DST is on.



## Alarm Operation



The iP16 Audio System for iPhone/iPod features “Sure Alarm”. Provided you have installed the 4 “AA” batteries, if a power failure occurs or the AC adaptor is accidentally disconnected, the alarm will still wake you up.

This unit also features Gentle Waking, which gradually increases the volume of whatever alarm you set.



**NOTE: TO WAKE TO iPhone/iPod, YOUR iPhone/iPod MUST BE PROPERLY DOCKED AND OFF (NOT IN PLAY MODE) OR NO iPhone/iPod ALARM WILL SOUND.**

### Setting the Alarm

1. Press and hold the  **button** until the hour display flashes. Press the **+ or – Button** until the desired alarm hour is displayed. Remember to set the correct AM or PM time, indicated by PM on the display; there is no AM indicator.
2. Press the  **button** again, then press the **+ or – Button** until the desired alarm minute is displayed.
3. Press the  **button** again to exit the setting mode. You should hear 2 beeps indicating the alarm is set.

**Note:** Once you set the alarm time, the alarm will be automatically armed, indicated by the  icon. To disarm the alarm, press the  button . The  icon will disappear and the alarm will not sound at the set time.

**Note:** Make sure to adjust volume level for a comfortable wake up volume.

4. When the alarm is sounding, the  icon will flash.
  - **To snooze during the alarm**, press the **Snooze/Dimmer Button**. The alarm will be silenced for 9 minutes, then come on again.
  - **To turn the alarm off and reset it to come on the next day**, press the  **Button**.
5. If the alarm is not turned off once it sounds, it will play for one hour then turn off automatically. This cycle will repeat every 24 hours unless the controls are changed.

**Note:** Please make sure your iPhone/iPod has enough songs to play for one hour, otherwise please set the iPhone/iPod repeat mode to ON.

**Note:** If there is no iPhone/iPod present or there is no music detected on the iPhone/iPod at alarm time, the iP16 will automatically switch to buzzer alarm.

## Sleep Operation

1. When the iP16 is off or while listening to your iPhone/iPod, press the **Sleep Button** located on the back of the unit to enter sleep mode. The **Sleep Icon** will appear on the display to indicate it is in sleep mode. Sleep mode has a Gentle Sleep feature which gradually lowers the volume before it shuts off.
2. You can adjust the sleep timer from 90, 60, 30 or 15 minutes by pressing the **Sleep Button** again. The unit will automatically turn off after the selected time.
3. When the display changes back to show the real time, pressing the **Sleep Button** once will show the sleep time remaining. Pressing it again will change the sleep time to the next lowest increment.
4. The iP16 has an independent volume setting for sleep mode so you can adjust the sleeping volume without affecting the alarm volume. Press the **+ and – Buttons** to adjust the sleep volume. The sleep volume will remain at that level the next time you enter sleep mode until controls are changed.
5. To stop listening at any time, press the  **button** to turn unit off.

## Snooze/Dimmer Operation

1. Press the **Snooze/Dimmer Button** after the alarm sounds. The alarm will go off and will come on again in about 9 minutes. You may repeat this cycle several times during the one hour alarm cycle.
2. During normal operation with the AC adaptor, press the **Snooze/Dimmer Button** to control the brightness (high, medium, low and off) of the LCD display. During portable operation with 4 “AA” batteries, the LCD backlight will display for about 5 seconds when you press the **Snooze/Dimmer Button** once.

# IMPORTANT SAFETY INSTRUCTIONS

When used in the directed manner, this unit has been designed and manufactured to ensure your personal safety. However, improper use can result in potential electrical shock or fire hazards. Please read all safety and operating instructions carefully before installation and use, and keep these instructions handy for future reference. Take special note of all warnings listed in these instructions and on the unit.

- Water and Moisture** – The unit should not be used near water. For example: near a bathtub, washbowl, kitchen sink, laundry tub, swimming pool or in a wet basement.
- Ventilation** – The unit should be situated so that its location or position does not interfere with its proper ventilation. For example, it should not be situated on a bed, sofa, rug or similar surface that may block ventilation openings. Also, it should not be placed in a built-in installation, such as a bookcase or cabinet, which may impede the flow of air through the ventilation openings.
- Heat** – The unit should be situated away from heat sources such as radiators, heat registers, stoves or other appliances (including amplifiers) that produce heat.
- Power Sources** – The unit should be connected to a power supply only of the type described in the operating instructions or as marked on the appliance.
- Power-Cable Protection** – Power supply cables should be routed so that they are not likely to be walked on or pinched by items placed upon or against them. It is always best to have a clear area from where the cable exits the unit to where it is plugged into an AC socket.
- Cleaning** – The unit should be cleaned only as recommended. See the Maintenance section of this manual for cleaning instructions.
- Objects and Liquid Entry** – Care should be taken so that objects do not fall and liquids are not spilled into any openings or vents located on the product.
- Attachments** – Do not use attachments not recommended by the product manufacturer.
- Lightning and Power Surge Protection** – Unplug the unit from the wall socket and disconnect the antenna or cable system during a lightning storm or when it is left unattended and unused for long periods of time. This will prevent damage to the product due to lightning and power-line surges.
- Overloading** – Do not overload wall sockets, extension cords, or integral convenience receptacles as this can result in a risk of fire or electric shock.
- Damage Requiring Service** – The unit should be serviced by qualified service personnel when:
  - the power supply cable or plug has been damaged.
  - objects have fallen into or liquid has been spilled into the enclosure.
  - the unit has been exposed to rain.
  - the unit has been dropped or the enclosure damaged.
  - the unit exhibits a marked change in performance or does not operate normally.
- Periods of Nonuse** – If the unit is to be left unused for an extended period of time, such as a month or longer, the power cable should be unplugged from the unit to prevent damage or corrosion.
- Servicing** – The user should not attempt to service the unit beyond those methods described in the user's operating instructions. Service methods not covered in the operating instructions should be referred to qualified service personnel.

**Questions? Visit [www.ihomeaudio.com](http://www.ihomeaudio.com)**

## Trouble Shooting

Symptom	Possible Problem	Solution
Unit doesn't respond (no power)	AC adaptor isn't plugged to a wall outlet or the connector is not plugged into the power supply jack on the back of the unit	Plug the AC adaptor into a wall outlet and plug the connector into the supply jack on the unit
	Wall outlet is not functioning	Plug another device into the same outlet to confirm the outlet is working. Turn on any switch that controls the outlet.
	Batteries are weak/dead	Replace current batteries with fresh ones
iPhone/iPod does not dock properly	Using no or wrong iPhone/iPod insert	Make sure the dock insert is the proper fit to your iPhone/iPod
	Dock or connector is obstructed	Remove your iPhone/iPod from the dock and check for obstruction on the connectors in the dock and on your iPhone/iPod. Then reseat it in the dock.
iPhone/iPod does not respond to the unit	iPhone/iPod is not docked properly	Remove your iPhone/iPod from the dock and check for obstruction on the connectors in the dock and on your iPhone/iPod. Then reseat it in the dock.
	Your iPhone/iPod software is too old	Upgrade software on your iPhone/iPod via iTunes
	iPhone/iPod is locked up	Please refer to your iPhone/iPod manual for details. Please make sure your iPhone/iPod is working properly before docking in the unit.
iPhone/iPod doesn't charge up	Unit is operating on batteries/not connected to AC adaptor	Unit will not charge iPhone/iPod when running on batteries. Connect unit to AC adaptor to charge iPhone/iPod.
	iPhone/iPod is not docked properly	Remove your iPhone/iPod from the dock and check for obstruction on the connectors in the dock and on your iPhone/iPod. Then reseat it in the dock.
	iPhone/iPod is locked up/frozen	Please refer to your iPhone/iPod manual for details. Please make sure your iPhone/iPod is working properly before dock into the unit.
	iPhone/iPod battery has problem	
Sound is distorted	Volume level is set too high	Decrease the volume.
	Sound source is distorted	If iPhone/iPod original sound source is poor quality, distortion and noise are easily noticed with high-power speakers. Try a different file from a trusted source such as iTunes.
	Batteries are weak/dead	Replace current batteries with fresh ones

## Solucionando Problemas

Síntoma	Causa Posible	Solución
La unidad no responde (no enciende)	El adaptador de AC no ha sido conectado a la corriente eléctrica o el cable no ha sido conectado a la parte posterior de la unidad.	Conecte el adaptador AC al tomacorrientes y el cable a la ficha de entrada de la unidad.
	El tomacorrientes no funciona.	Conecte otro aparato al mismo tomacorrientes para verificar si se encuentra activo.
	Las baterías están gastadas	Reemplace las baterías
El iPhone/iPod no encastra correctamente	El encastre no es el correcto o no ha colocado encastre alguno.	Verifique tener el encastre correspondiente antes de intentar acoplarlo al aparato.
	La muesca o el encastre están obstruidos.	Retire el iPhone/iPod de la muesca y elimine la obstrucción. Vuelva a acoplar su iPhone/iPod.
El iPhone/iPod no se comunica con la unidad	El iPhone/iPod no está colocado correctamente.	Retire el iPhone/iPod de la muesca y elimine la obstrucción. Vuelva a acoplar su iPhone/iPod.
	El software (programa) de su iPod es obsoleto	Actualice su programa vía iTunes.
	El iPhone/iPod está trabado	Verifique el correcto funcionamiento de su iPhone/iPod antes de acoplarlo a la unidad. Por favor, refiérase al Manual del Usuario de su iPhone/iPod para mayor información.
El iPhone/iPod no carga	El iPhone/iPod no está colocado correctamente.	Retire el iPhone/iPod de la muesca y elimine la obstrucción. Vuelva a acoplar su iPhone/iPod.
	El iPhone/iPod está trabado.	Verifique el correcto funcionamiento de su iPhone/iPod antes de acoplarlo a la unidad. Por favor, refiérase al Manual del Usuario de su iPhone/iPod para mayor información.
	La batería del iPhone/iPod tiene algún problema.	
El sonido sale distorsionado	El nivel de volumen está alto	Baje el nivel de volumen. Apague la función EQ/3D.
	La fuente de sonido está distorsionada	Si utiliza un iPhone/iPod Shuffle o una fuente de sonido externa como un iPhone/iPod de generaciones anteriores, intente bajar el volumen del aparato en sí. También puede intentar reducir los bajos.
	Las baterías están gastadas	Reemplace las baterías

## Limited 1 Year Warranty Information

iHome Products, a division of SDI Technologies Inc. (hereafter referred to as SDI Technologies), warrants this product to be free from defects in workmanship and materials, under normal use and conditions, for a period of One Year from the date of original purchase.

Should this product fail to function in a satisfactory manner, it is best to first return it to the store where it was originally purchased. Should this fail to resolve the matter and service still be required by reason of any defect or malfunction during the warranty period, SDI Technologies will repair or, at its discretion, replace this product without charge (except for a \$10.00 charge for handling, packing, return UPS/postage, and insurance). This decision is subject to verification of the defect or malfunction upon delivery of this product to the Factory Service Center listed below. The product must include proof of purchase, including date of purchase. The fee for service without proof of purchase is \$25.00.

Before returning this product for service, please first replace the batteries (if applicable) with fresh ones, as exhausted or defective batteries are the most common cause of problems encountered.

If service is still required:

1. Remove the batteries (if applicable) and pack the unit in a well padded, heavy corrugated box.
2. Enclose a photocopy of your sales receipt, credit card statement, or other proof of the date of purchase, if within the warranty period.
3. Enclose a check or money order payable to the order of SDI Technologies, for the sum of \$10.00 (\$25.00 without proof of purchase).
4. Send the unit prepaid and insured, to the Factory Service Center listed below.

### Consumer Repair Department

*SDI Technologies Inc.  
1330 Goodyear Drive  
El Paso, TX 79936-6420*

### Disclaimer of Warranty

**NOTE:** This warranty is valid only if the product is used for the purpose for which it was designed. It does not cover (i) products which have been damaged by negligence or willful actions, misuse or accident, or which have been modified or repaired by unauthorized persons; (ii) cracked or broken cabinets, or units damaged by excessive heat; (iii) damage to digital media players, CD's or tape cassettes (if applicable); (iv) the cost of shipping this product to the Factory Service Center and its return to the owner.

This warranty is valid only in the United States of America and does not extend to owners of the product other than to the original purchaser. In no event will SDI Technologies or any of its affiliates, contractors, resellers, their officers, directors, shareholders, members or agents be liable to you or any third party for any consequential or incidental damages, any lost profits, actual, exemplary or punitive damages. (Some states do not allow limitations on implied warranties or exclusion of consequential damages, so these restrictions may not apply to you.) This warranty gives you specific legal rights, and you may also have other rights which vary from state to state.

Your acknowledgement and agreement to fully and completely abide by the above mentioned disclaimer of warranty is contractually binding to you upon your transfer of currency (money order, cashier's check, or credit card) for purchase of your SDI Technologies product.

© 2011 SDI Technologies, Inc. All rights reserved

**Questions? Visit [www.ihomeaudio.com](http://www.ihomeaudio.com)  
or call 1-800-288-2792 Toll Free**

iHome®