

**Hamilton Beach®**

*Coffee Grinder*

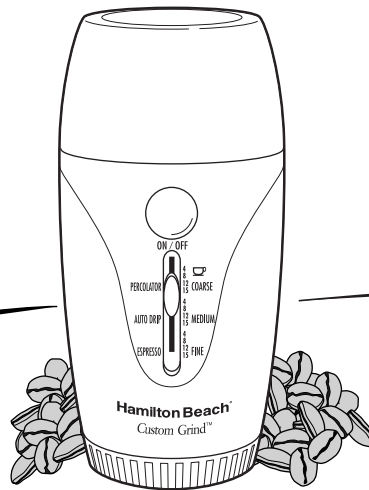

English .....2

USA: 1-800-851-8900

Canada : 1-800-267-2826

840107900

## IMPORTANT SAFEGUARDS

When using electrical appliances, basic safety precautions should always be followed including the following:

1. Read all instructions.
2. To protect against risk of electrical shock, do not put unit, cord or plug in water or other liquid.
3. Close supervision is necessary when any appliance is used by or near children.
4. Unplug from outlet when not in use, before putting on or taking off parts, and before cleaning.
5. Avoid contacting moving parts.
6. Do not operate any appliance with a damaged cord or plug or after the appliance malfunctions, or is dropped or damaged in any manner. **Call our toll free customer service number** for information on examination, repair or electrical or mechanical adjustment.
7. The use of attachments not recommended or sold by the manufacturer may cause fire, electric shock or injury.
8. Do not use outdoors.
9. Do not let cord hang over edge of table or counter or touch hot surfaces including stove.
10. Check grinding chamber for presence of foreign objects before using.
11. Do not use appliance for other than intended purpose.
12. Do not remove cover until blade has completely stopped rotating.

## SAVE THESE INSTRUCTIONS

## CONSUMER SAFETY INFORMATION

**This appliance intended for household use only.**

This appliance is equipped with a polarized plug. This type of plug has one blade wider than the other. The plug will fit into an electrical outlet only one way. This is a safety feature intended to help reduce the risk of electrical shock. If you are unable to insert the plug into the outlet, try reversing the plug. If the plug should still fail to fit, contact a qualified electrician to replace the obsolete outlet. Do not attempt to defeat the safety purpose of the polarized plug by modifying the plug in any way.

## *Know Your Coffee Grinder*

1. Cover
2. Grinding Chamber
3. ON/OFF Button
4. Grind Setting Switch
5. Body
6. Base with Cord Wind

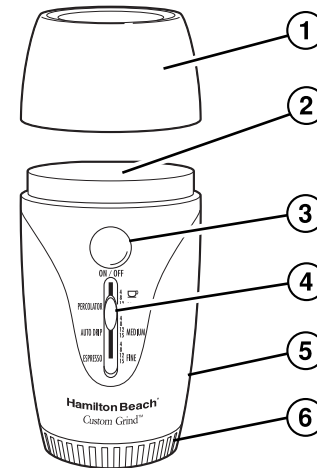

## How To Use

1. Before first use, please clean the coffee grinder.
2. Remove cover by turning counter-clockwise to the unlock position, then lift straight up.
3. Using measurements on cover, fill with desired amount of coffee beans and pour into grinding chamber or scoop beans directly into grinding chamber.
4. Place cover onto grinder making sure that arrow on cover is aligned with unlock symbol on back of grinder. Then turn lid clockwise to the locked position.
5. Hold the plug and pull slowly to release stored cord. Plug into outlet.
6. Move the grind setting switch to the amount to be ground and desired fineness of grind.
7. Press and hold the ON/OFF button. Release button once grinder begins. The grinder will stop automatically when grinding is complete. To stop grind cycle at anytime, push the ON/OFF button. When the ON/OFF button is pressed again, grinder will start from beginning of timed cycle.
8. When finished unplug grinder, clean grinding chamber, and rewind cord.

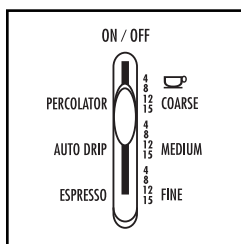
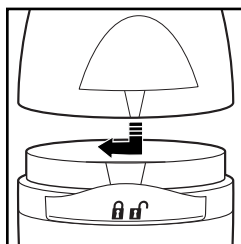
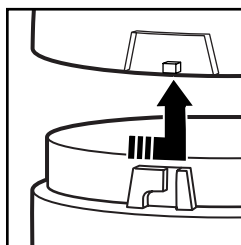

**NOTE:** The grinder will only operate with cover in the locked position.

## Tips

- For best flavor, store coffee beans in an airtight container.
- Grind beans immediately before brewing.
- When grinding more than 12 scoops of coffee beans, pour beans into cover, then turn grinder upside down and lock onto cover. Be sure to align tab on lid with the unlock symbol.
- Grinding times will vary by amount and fineness setting:
 

<b>COARSE</b>	9 to 13 seconds	(Percolator, French Press)
<b>MED</b>	14 to 17 seconds	(Auto Drip)
<b>FINE</b>	25 to 28 seconds	(Espresso)
- To ensure optimal grinding performance, allow your coffee grinder to cool for at least one minute between uses.
- Coffee flavor and strength is a personal preference. Vary the type of coffee beans, amount of coffee and fineness of grind to find the flavor you prefer.
- To grind amounts not on controls, select the next closest amount listed.

## How To Clean

1. Unplug from outlet before cleaning.
2. Carefully wipe the grinding chamber with a soft, damp cloth. Be careful cleaning around sharp blades.
3. Rinse and dry cover. Wipe grinder with a damp cloth.
4. Hold grinder and turn the base in direction of arrow to rewind cord.

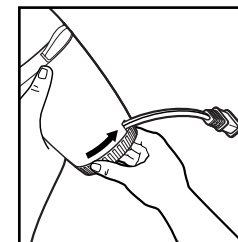

**Do not immerse coffee grinder in water or other liquid.**

## Customer Service

If you have a question about your coffee grinder, call our toll-free customer service number. Before calling, please note the model, type, and series numbers and fill in that information below. These numbers can be found on the bottom of your coffee grinder. This information will help us answer your question much more quickly.

MODEL: \_\_\_\_\_ TYPE: \_\_\_\_\_ SERIES: \_\_\_\_\_

### LIMITED WARRANTY

This product is warranted to be free from defects in material and workmanship for a period of two (2) years for Hamilton Beach Portfolio products or one (1) year for Hamilton Beach products from the date of original purchase, except as noted below. During this period, we will repair or replace this product, at our option, at no cost. THE FOREGOING WARRANTY IS IN LIEU OF ANY OTHER WARRANTY, WHETHER EXPRESS OR IMPLIED, WRITTEN OR ORAL INCLUDING ANY WARRANTY OF MERCHANTABILITY OR FITNESS FOR A PARTICULAR PURPOSE. ANY LIABILITY IS EXPRESSLY LIMITED TO AN AMOUNT EQUAL TO THE PURCHASE PRICE PAID, AND ALL CLAIMS FOR SPECIAL, INCIDENTAL AND CONSEQUENTIAL DAMAGES ARE HEREBY EXCLUDED. There is no warranty with respect to the following, which may be supplied with this product: glass parts, glass containers, cutter/strainer, blades, and/or agitators. This warranty extends only to the original consumer purchaser and does not cover a defect resulting from abuse, misuse, neglect, use for commercial purposes, or any use not in conformity with the printed directions. This warranty gives you specific legal rights, and you may also have other legal rights which vary from state to state, or province to province. Some states or provinces do not allow limitations on implied warranties or special, incidental or consequential damages, so the foregoing limitations may not apply to you.

If you have a claim under this warranty, DO NOT RETURN THE APPLIANCE TO THE STORE! Please call our CUSTOMER SERVICE NUMBER. (For faster service please have model, series, and type numbers ready for operator to assist you.)

### CUSTOMER SERVICE NUMBERS

In the U.S. 1-800-851-8900

In Canada 1-800-267-2826

Web site address: [www.hamiltonbeach.com](http://www.hamiltonbeach.com)

**KEEP THESE NUMBERS FOR FUTURE REFERENCE!**

HAMILTON BEACH ♦ PROCTOR-SILEX, INC.

263 Yadkin Road  
Southern Pines, North Carolina 28387

840107900

PROCTOR-SILEX CANADA, INC.

Picton, Ontario K0K 2T0

Web site address: [www.hamiltonbeach.com](http://www.hamiltonbeach.com)

11/02