

# FM/AM Clock Radio

Operating Instructions

## ICF-C707

### DREAM MACHINE

Dream Machine is a trademark of Sony Corporation.



No Power No Problem is a trademark of Sony Corporation.

©2010 Sony Corporation Printed in China



4 1 8 0 7 2 1 1 1 (1)

<http://www.sony.net/>

For customers who purchased this product in the USA Please register this product on line at <http://www.sony.com/productregistration>. Proper registration will enable us to send you periodic mailings about new products, services, and other important announcements. Registering your product will also allow us to contact you in the unlikely event that the product needs adjustment or modification. Thank you.

### WARNING

To reduce the risk of fire or electric shock, do not expose this apparatus to rain or moisture.

To reduce the risk of fire, do not cover the ventilation of the apparatus with newspapers, tablecloths, curtains, etc. And do not place lighted candles on the apparatus.

To reduce the risk of fire or electric shock, do not expose this apparatus to dripping or splashing, and do not place objects filled with liquids, such as vases, on the apparatus.

Do not install the appliance in a confined space, such as a bookcase or built-in cabinet.

Do not expose the batteries (battery pack or batteries installed) to excessive heat such as sunshine, fire or the like for a long time.

As the main plug is used to disconnect the unit from the mains, connect the unit to an easily accessible AC outlet. Should you notice an abnormality in the unit, disconnect the main plug from the AC outlet immediately.

The unit is not disconnected from the AC power source (mains) as long as it is connected to the wall outlet, even if the unit itself has been turned off.

You are cautioned that any changes or modifications not expressly approved in this manual could void your authority to operate this equipment.

The nameplate and important information concerning safety are located on the bottom exterior.

### CAUTION

Danger of explosion if battery is incorrectly replaced. Replace only with the same type.

### NOTE

This equipment has been tested and found to comply with the limits for a Class B digital device, pursuant to Part 15 of the FCC Rules. These limits are designed to provide reasonable protection against harmful interference in a residential installation. This equipment generates, uses and can radiate radio frequency energy and, if not installed and used in accordance with the instructions, may cause harmful interference to radio communications. However, there is no guarantee that interference will not occur in a particular installation. If this equipment does cause harmful interference to radio or television reception, which can be determined by turning the equipment off and on, the user is encouraged to try to correct the interference by one or more of the following measures:

- Reorient or relocate the receiving antenna.
- Increase the separation between the equipment and receiver.
- Connect the equipment into an outlet on a circuit different from that to which the receiver is connected.
- Consult the dealer or an experienced radio/TV technician for help.

### WARNING

- Replace the battery for the clock backup with a Sony CR2032 lithium battery. Use of another battery may present a risk of fire or explosion.
- Battery may explode if mistreated. Do not recharge, disassemble or dispose of in fire.
- Dispose of the used battery promptly. Keep away from children.

## Important Safety Instructions

- 1) Read these instructions.
- 2) Keep these instructions.
- 3) Heed all warnings.
- 4) Follow all instructions.
- 5) Do not use this apparatus near water.
- 6) Clean only with dry cloth.
- 7) Do not block any ventilation openings. Install in accordance with the manufacturer's instructions.
- 8) Do not install near any heat sources such as radiators, heat registers, stoves, or other apparatus (including amplifiers) that produce heat.
- 9) Do not defeat the safety purpose of the polarized or grounding-type plug. A polarized plug has two blades with one wider than the other. A grounding type plug has two blades and a third grounding prong. The wide blade or the third prong are provided for your safety. If the provided plug does not fit into your outlet, consult an electrician for replacement of the obsolete outlet.
- 10) Protect the power cord from being walked on or pinched particularly at plugs, convenience receptacles, and the point where they exit from the apparatus.
- 11) Only use attachments/accessories specified by the manufacturer.
- 12) Use only with the cart, stand, tripod, bracket, or table specified by the manufacturer, or sold with the apparatus. When a cart is used, use caution when moving the cart/apparatus combination to avoid injury from tip-over.



- 13) Unplug this apparatus during lightning storms or when unused for long periods of time.
- 14) Refer all servicing to qualified service personnel. Servicing is required when the apparatus has been damaged in any way, such as power-supply cord or plug is damaged, liquid has been spilled or objects have fallen into the apparatus, the apparatus has been exposed to rain or moisture, does not operate normally, or has been dropped.

### For the state of California, USA only

Perchlorate Material –special handling may apply. See [www.dtsc.ca.gov/hazardouswaste/perchlorate](http://www.dtsc.ca.gov/hazardouswaste/perchlorate)  
Perchlorate Material: Lithium battery contains perchlorate

## Features

- Dual alarm FM/AM synthesized clock radio
- Nature Sound (Sea Waves, Birds, Rain, Brook, Under the Sea)
- Temperature display (Fahrenheit / Centigrade) 5°F – 122°F (–15°C – 50°C)
- Built-in audio cable for Digital Music Player
- 10 Station Presets (5 FM/5 AM)
- Various types of alarms - radio, buzzer and Nature Sounds (5)
- Automatic time set: when you plug the clock in for the first time, the current time will be shown in the display
- Automatic Daylight Savings Time Set/ Summer time adjustment
- 100 year calendar and **DATE/TIME ZONE** button to display year, month and date
- Brightness Control (High/Low/Off)
- No Power No Problem alarm system to keep the clock and the alarm operating during a power interruption with a CR2032 battery installed
- Extendable Snooze system - Snooze time can be set from 10 to 60 minutes
- Progressive Alarm Speed (buzzer only)

## Precautions

- Play the unit on the power source specified in “Specifications.”
- To disconnect the power cord (mains lead), pull it out by the plug, not the cord.
- Since a strong magnet is used for the speaker, keep personal credit cards using magnetic coding or spring-wound watches away from the unit to prevent possible damage from the magnet.
- Do not leave the unit in a location near a heat source such as a radiator or airduct, or in a place subject to direct sunlight, excessive dust, mechanical vibration, or shock.

- Allow adequate air circulation to prevent internal heat build-up. Do not place the unit on a thick pile surface (rug, a blanket, etc.), or near materials that might block the ventilation holes (such as a curtain, etc.).
  - Should any solid object or liquid fall into the unit, unplug the unit and have it checked by qualified personnel before operating it any further.
  - To clean the casing, use a soft cloth dampened with a mild detergent solution.
  - Never touch the wire of the external FM antenna during a thunderstorm. Furthermore, immediately disconnect the main plug from the wall outlet.
- #### NOTES ON THE LITHIUM BATTERY
- Wipe the battery with a dry cloth to assure a good contact.
  - Be sure to observe the correct polarity when installing the battery.
  - Do not hold the battery with metallic tweezers, otherwise a short-circuit may occur.

If you have any questions or problems concerning your unit, consult your nearest Sony dealer.

## Troubleshooting

Should any problem persist after you have made the following checks, consult your nearest Sony dealer.

### The clock flashes “AM 12:00” due to a power interruption.

- The battery is low. Replace the battery. Remove the old battery and install a new one.

### The alarm settings do not sound at the preset alarm time.

- Check that alarm “**A**” or alarm “**B**” is properly set/displayed.

### The alarm settings are activated but there is no sound at the preset alarm time.

- Check the alarm volume setting.

### When daylight saving time begins, the clock does not employ the daylight saving time automatically.

- Make sure the clock is set correctly.
- Press and hold **DISPLAY/CLOCK** and **SNOOZE / BRIGHTNESS** simultaneously for at least 2 seconds to activate the Automatic DST function.

## Specifications

#### Time display

12-hour system

#### Radio section

##### Frequency range

Band	Frequency	Channel step
FM	87.5 MHz – 108 MHz	0.1 MHz
AM	530 kHz – 1 710 kHz	10 kHz

#### General

##### Speaker

Approx. 3.6 cm (1 7/16 inches) dia. 8 Ω

##### Input

Built-in audio cable with stereo-mini plug (∅ 3.5 mm)

##### Power output

0.7 W (at 10% harmonic distortion)

##### Power requirements

120 V AC, 60 Hz  
For clock back up: 3V DC, one CR2032 battery

##### Nature Sound

Sea Waves, Birds, Rain, Brook, Under the Sea

##### Temperature range

5 °F – 122 °F (–15 °C – 50 °C)

##### Temperature resolution

1 °F (1 °C)

##### Dimensions

Approx. 190 mm × 67 mm × 62 mm (w/h/d)  
(7 1/2 inches × 2 3/4 inches × 2 1/2 inches) not including projecting parts and controls

##### Mass

Approx. 620 g (1 lb 5.87 oz) including power supply unit and CR2032 battery

##### Supplied accessories

AM loop antenna (1)

Design and specifications are subject to change without notice.

## Connecting the antenna

### To connect the AM loop antenna

The shape and the length of the antenna is designed to receive AM signals. Do not dismantle or roll up the antenna.

- 1 Remove only the loop part from the plastic stand.
  - 2 Set up the AM loop antenna.
- 

- 3 Connect the cords to the AM antenna terminals. Cord (A) or cord (B) can be connected either way round.

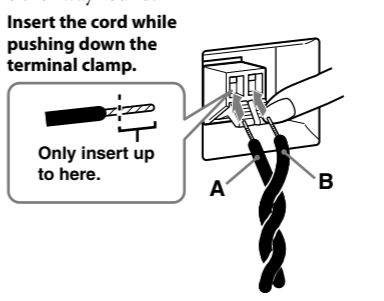

- 4 Make sure the AM loop antenna is connected firmly by pulling softly.

### Adjusting the AM loop antenna

Find a place and an orientation that provides good reception.

- Do not place the AM loop antenna near the unit or other AV equipment, as noise may result.

#### Tip

Adjust the direction of the AM loop antenna for best AM broadcast sound.

## About the backup battery

To maintain accurate time, this unit includes an internal CR2032 battery as a backup power source in the event of a power interruption.

### Knowing when to replace the battery

When the battery becomes weak, “**Ⓢ**” will appear in the display.

If a power interruption occurs while the battery is weak, the current time and alarm will be initialized.

Replace the battery with a Sony CR2032 lithium battery. Use of another battery may cause a fire or explosion.

#### Note

If “AM 12:00” flashes in the display when the unit is connected to an AC outlet for the first time, the battery may be weak. In this case, consult your Sony dealer.

### Installing and replacing the backup battery

- 1 Keep the AC plug connected to the AC outlet, remove the screw that secures the battery compartment at the bottom of the unit using a screwdriver, and pull the battery compartment marked **PULL OPEN**. (See fig. **A**-①)
- 2 Insert a new battery in the battery holder with the **+** side facing up. To remove the battery from the battery compartment, push it out from the side marked **PUSH**. (See fig. **A**-②)
- 3 Insert the battery compartment back into the unit and secure it with the screw. (See fig. **A**-③)
- 4 When you are replacing the battery, press any of the following buttons: **RADIO · BAND, AUDIO IN,** or **NATURE SOUND / PRESET** to turn “**Ⓢ**” off in the display.

#### Note

When you replace the battery, do not disconnect the AC plug from AC outlet. Otherwise, the 100 year calendar, current time, alarm and station presets will be initialized.

