

# MAINTENANCE REMINDER SHEET

## JS46

### 22" Walk Behind Mower

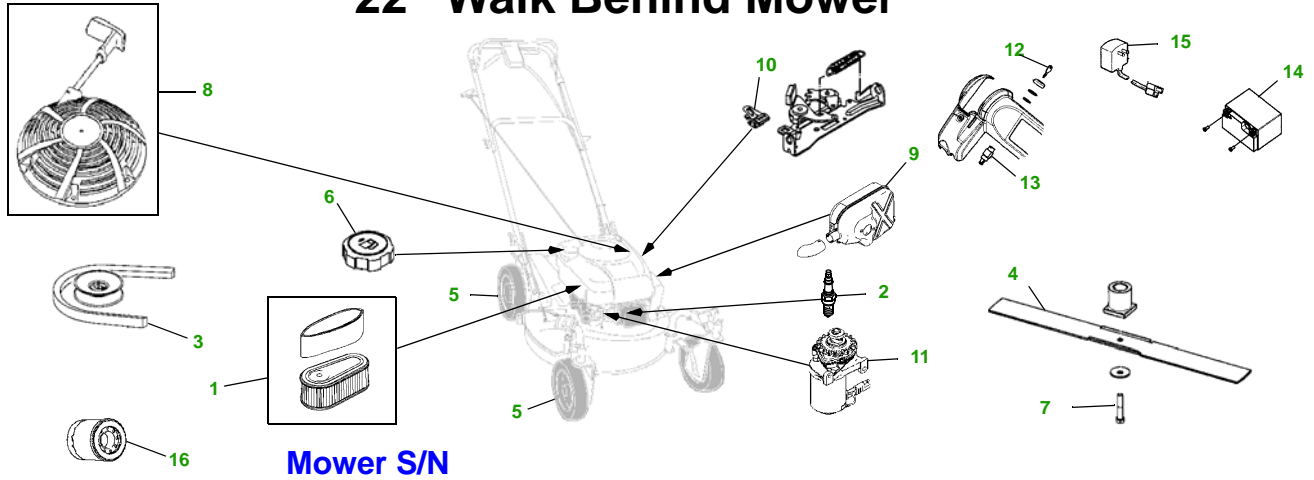

Mower S/N

Key No.	Description	Key No.	Description
1	MIU12719 ..... AIR FILTER - PRECLEANER	8	MIA11824 ..... RECOIL STARTER
	MIU12718 ..... AIR FILTER ELEMENT		LG280399S ..... ROPE
2	M143270 ..... SPARK PLUG - ENG MARKED 12S975-0132-B1		LG281434S ..... GRIP
	..... OR 121S75-0114-F1	9	MIA11820 ..... MUFFLER
	MIU11193 ..... SPARK PLUG - ENG MARKED 12S975-0134-B1	10	LG692310 ..... SWITCH - STOP
3	GX23549 ..... BELT - DRIVE	11	MIU12774 ..... STARTER MOTOR
4	GX23522 ..... BLADE	12	GX23565 ..... KEY
5	GY21070 ..... WHEEL - FRONT	13	GX22325 ..... START SWITCH
	GY21081 ..... WHEEL - REAR	14	SW4L-BS ..... BATTERY
6	M143291 ..... FUEL CAP	15	GX23068 ..... BATTERY CHARGER
	MIU12350 ..... FUEL CAP - CALIFORNIA	16	MIA11787 ..... OIL FILTER
7	GX22376 ..... BOLT		

#### Service Recommendations

#### "As Needed" Parts

Qty	Part No	Item	Qty or Capacity	Change Interval in Hours
11	MIA11787	Engine Oil Filter		5 (Break-in) / Every 25
7	TY22070	1 Qt. Engine Oil Torq Gard® SAE 30	20 oz	5 (Break-in) / Every 25
2	MIU11193 M143270	Spark Plug		100/200
2	M147431	Air Filter - Paper		100/200
2	TY6341	JD Multi Purpose SD Polyurea Grease		As Needed

Qty	Part No	Item
1	AM130907	Mower Deck Leveling Gauge
1	TY26183	Grease Gun

#### FOR ON-LINE PARTS ASSISTANCE:

[www.JDParts.Deere.com](http://www.JDParts.Deere.com)

- VIEW [John Deere Parts Catalog](#) to look-up part numbers
- ORDER parts on-line from your [John Deere Dealer](#)
- SEARCH for parts for [YOUR specific model](#)
- SEARCH for parts by [Partial Part Number](#)



[www.Deere.com](http://www.Deere.com)

- PRINT [Valuable Parts Coupons](#) for discounts at your John Deere Dealer
- REVIEW John Deere [Parts Quality Stories](#)
- SEE a complete list of all [Home Maintenance Kits](#)
- CONSIDER [Quick Reference Guides](#) for your commercial equipment

#### FOR ON-LINE SERVICE ASSISTANCE:

[www.Deere.com](http://www.Deere.com)

- VIEW [Technical \(Service\) Publications and Operator's Manuals](#)
- SELECT the desired [Maintenance Plan](#) that is right for you
- UNDERSTAND the [John Deere Warranty](#) on your equipment

#### OTHER SITES:

- SEARCH [Home & Workshop Products](#) off the Residential section at Deere.com.
- GO TO [www.johndeerecredit.com](http://www.johndeerecredit.com) to find your finance solution
- FIND the mower that is right for you through our [JD Mower Selection Tool](#)
- GO TO [www.johndeeregifts.com](http://www.johndeeregifts.com) to stop by John Deere's "General Store"

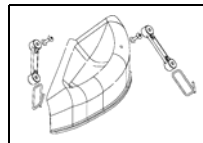

Mulch Plug ..... GX23513

Dealer Name  
Contact Name  
Dealer Phone No



#### Home Maintenance Kit

Unit	Kit Number
JS46	N/A

