



# MODEL H5373 1/2 HP ELECTRIC MOTOR INSTRUCTION SHEET

## Model H5373 Specifications

Power ..... 1/2 HP  
 Cycle.....60Hz  
 Voltage .....110/220V  
 Prewired ..... 110V  
 Amps .....8/4A  
 RPM..... 1725  
 Phase ..... Single  
 Class..... B  
 Start Capacitor .....200MFD 125VAC  
 Dimensions..... 1 1/2"D x 2 3/8"L

## Electrical Safety

If you are unsure how to attach wires to terminals, DO NOT continue. Contact a qualified electrician for assistance. Connecting wires improperly may cause them to come loose or contact other wires, which can cause electrocution, fire, or a short.

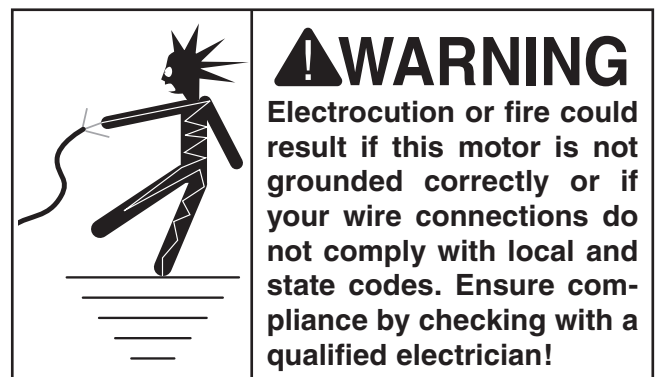
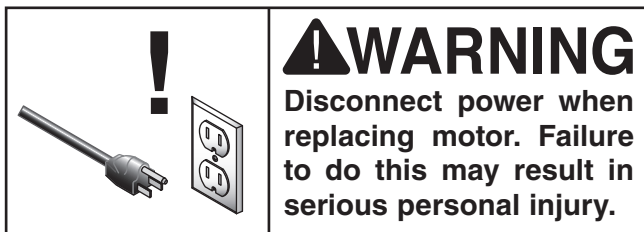

## Replaceable Parts

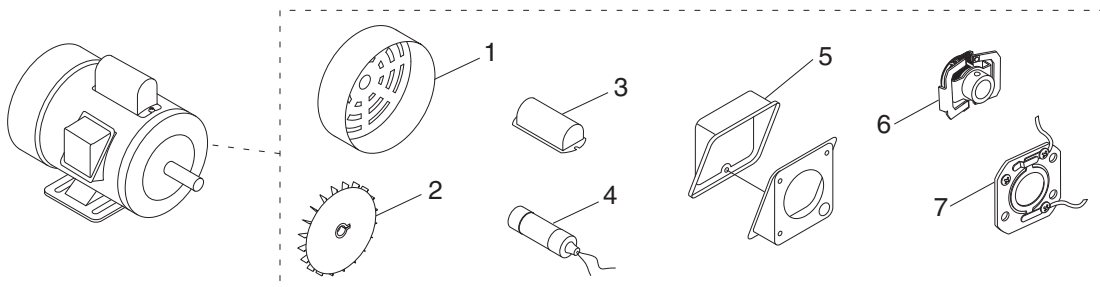

REF	PART #	DESCRIPTION
1	PH5373001	MOTOR FAN COVER
2	PH5373002	MOTOR FAN
3	PH5373003	S CAPACITOR COVER
4	PC200C	S CAPACITOR 200M 125V 1-1/2 X 2-3/8

REF	PART #	DESCRIPTION
5	PH5373005	JUNCTION BOX
6	PH5373006	CENTRIFUGAL SWITCH
7	PH5373007	CONTACT PLATE

COPYRIGHT © DECEMBER, 2007 BY GRIZZLY INDUSTRIAL, INC.  
**WARNING: NO PORTION OF THIS INSTRUCTION SHEET MAY BE REPRODUCED IN ANY SHAPE OR FORM WITHOUT THE WRITTEN APPROVAL OF GRIZZLY INDUSTRIAL, INC.**  
 #JB10230 PRINTED IN TAIWAN

# H5373 Wiring Diagram

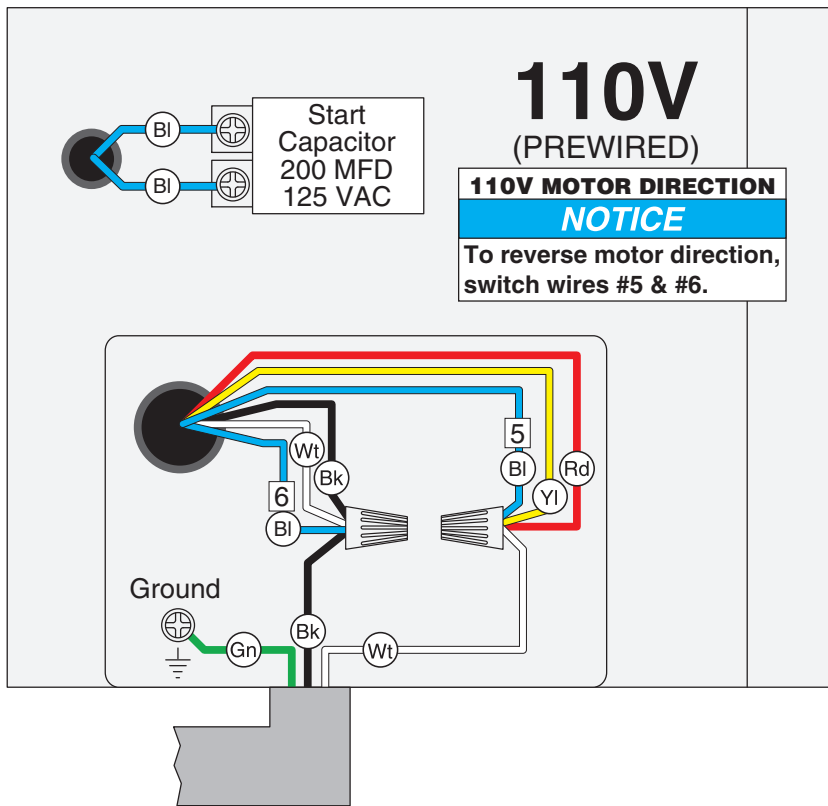

View this page in color at [www.grizzly.com](http://www.grizzly.com).

**COLOR KEY**

BLACK	— Bk —
WHITE	— Wt —
GREEN	— Gn —
RED	— Rd —
YELLOW	— Yl —
BLUE	— Bl —

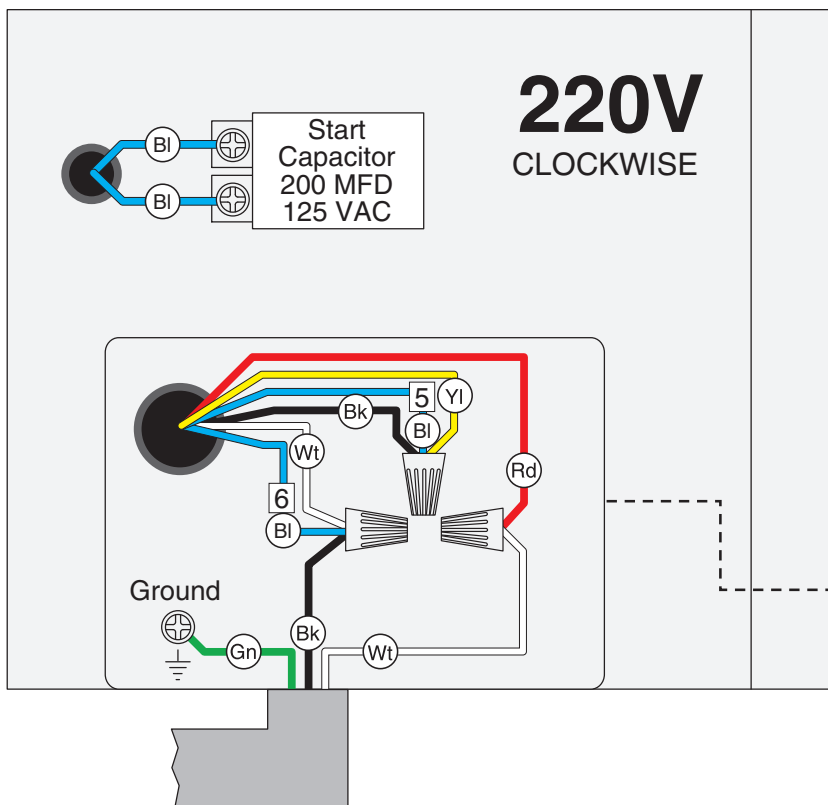

**NOTICE**  
The motor wiring shown here is current at the time of printing, but it may not match your machine. Always use the wiring diagram inside the motor junction box.

