

# NEC

## INSTRUCTION MANUAL COLOUR TELEVISION



**PF32WT100**

# TABLE OF CONTENTS

<b>IMPORTANT SAFEGUARDS</b> .....	<b>4</b>
<b>IDENTIFICATION OF CONTROLS</b> .....	<b>6</b>
Main body (Front) .....	6
Main body (Top) .....	6
Main body (Side) .....	7
Main body (Back) .....	7
<b>CONNECTING EXTERNAL EQUIPMENT</b> .....	<b>8</b>
TV/AV selection .....	8
Connection to a camcorder or other video player .....	8
Connection to Digital Audio .....	9
<b>REMOTE CONTROL</b> .....	<b>10</b>
Remote Control Hand Piece .....	10
Battery Installation & Functions .....	10
<b>BASIC INSTALLATION</b> .....	<b>11</b>
Switching on TV set .....	11
Automatic tuning .....	11
<b>MENU DESCRIPTION</b> .....	<b>12</b>
Main menu .....	12
How to use the sub-menus .....	12
Picture menu .....	13
Sound menu .....	14
Install menu .....	16
Program list edit .....	16
Feature menu .....	17
<b>SOUND CONTROL</b> .....	<b>18</b>
Volume adjustment .....	18
Mute .....	18
Mono forcing, Dual language .....	18
<b>PICTURE CONTROL</b> .....	<b>19</b>
Picture setting .....	19
Program status display (Recall) .....	19
Sleep function .....	19
Format selection .....	19
<b>TELETEXT</b> .....	<b>20</b>
Entering / Exit Teletext Mode .....	20
Page Selection .....	20
Teletext format picture & sound control .....	20
Useful teletext functions .....	21
<b>BEFORE CALLING SERVICE PERSONNEL</b> .....	<b>22</b>
<b>SPECIFICATION</b> .....	<b>23</b>

# IMPORTANT SAFEGUARDS

- 1 **Read Instructions** · All the safety and operating instructions should be read before the appliance is operated.
- 2 **Retain Instructions** · The safety and operating instructions should be retained for future reference.
- 3 **Heed Warnings** · All warnings on the appliance and in the operating instructions should be adhered to.
- 4 **Follow Instructions** · All operating and use instructions should be followed.
- 5 **Cleaning** · Unplug TV from the wall outlet before cleaning. Do not use liquid cleaners or aerosol cleaners. Use a damp cloth for cleaning.
- 6 **Attachments** · Do not use attachments not recommended by the TV manufacturer as they may cause hazards.
- 7 **Water and Moisture** · Do not set liquids, including flower vase and vessels filled with chemicals or water etc, on top of the unit as liquid could get inside the unit. If a hazardous object falls inside the TV set, unplug it immediately and call qualified technician for remove.

## PORTABLE CABINET WARNING

- 8 **Accessories** · Do not place this TV on an unstable cabinet, stand, bracket, or table. The TV may fall, causing serious injury to someone, and serious damage to the appliance. Use only with a cabinet, stand, bracket, or table recommended by the manufacturer, or sold with the TV. Any mounting of the appliance should follow the manufacturer's instructions and use a mounting accessory recommended by the manufacturer. An appliance and cart combination should be moved with care. Quick stops, excessive force, and uneven surfaces may cause the appliance and cabinet combination to overturn.



- 9 **Ventilation** · Slots and openings in the cabinet and the back or bottom are provided for ventilation and to ensure reliable operation of the TV and to protect it from overheating, and these openings must not be blocked or covered. The openings should never be blocked by placing the TV on a bed, sofa, rug, or other similar surface. This TV should never be placed near or over a radiator or heat register. This TV should not be placed in a built-in installation such as a bookcase or rack unless proper ventilation is provided or the manufacturer's have been adhered to. Around the space should be more than 10cm.
- 10 **Power Sources** · This TV should be operated only from the type of power source indicated on the marking label. If you are not sure of the type of power supply to your home, Please contact NEC service centres.
- 11 **Grounding or Polarization** · This TV is equipped with a polarized alternating · current line plug (a plug having one blade wider than the other). This plug will fit into the power outlet only one way. This is a safety feature. If you are unable to insert the plug fully into the outlet, contact your electrician to replace your obsolete outlet. Do not defeat the safety purpose of the polarized plug.
- 12 **Power- Cord Protection** · Power-supply cords should be routed so that they are not likely to be walked on or pinched by items placed upon or against them, paying particular attention to cords at plugs, and the point where they exit from the appliance.
- 13 **Lightning** · For added protection for this TV receiver during a lightning and storm, or when it is left unattended and unused for long periods of time, unplug it from the wall outlet and disconnect the antenna or cable system. This will prevent damage to the TV due to lightning and power-line surges.
- 14 **Power Lines** · An outside antenna system should not be located in the vicinity of overhead power lines or other electric light or power circuits, or where it can fall into such power lines or circuits. When installing an outside antenna system, extreme care should be taken to keep from touching such power lines or circuits as contact with them might be fatal.

- 15 **Overloading** · Do not overload wall outlets and extension cords as this can result in a risk of fire or electric shock.
- 16 **Object and Liquid Entry** · Never push objects of any kind into this TV through openings as they may touch dangerous voltage points or short out parts that could result in a fire or electric shock. Never spill liquid of any kind on the TV.
- 17 **Servicing** · Do not attempt to service this TV yourself as opening or removing covers may expose you to dangerous voltage or other hazards. Refer all servicing to qualified service personnel.
- 18 **Damage Requiring Service** · Unplug this TV from the wall outlet and refer servicing to qualified service personnel under the following conditions :
- A. When the power-supply cord or plug is damaged or frayed.
  - B. If liquid has been spilled, or objects have fallen into the TV.
  - C. If the TV has been exposed to rain or water.
  - D. If the TV does not operate normally by following the operating instructions. Adjust only those controls that are covered by the operating instructions, as improper adjustment of other controls may result in damage and will often require extensive work by a qualified technician to restore the TV to its normal operation.
  - E. If the TV has been dropped or damaged in any way.
  - F. When the TV exhibits a distinct change in performance - this indicates a need for service.
- 19 **Replacement Parts** · When replacement parts are required, be sure the service technician has used replacements parts specified by the manufacturer that have the same characteristics as the original part. Unauthorized substitutions may result in fire, electric shock, injury to persons or other hazards.
- 20 **Safety Check** · Upon completion of any service or repairs to this TV, ask the service technician to perform routine safety checks to determine that the TV is in proper operating condition.
- 21 **Heat** · This TV product should be situated away from heat sources such as radiators, heat registers, stoves, or other products (including amplifiers) that produce heat.
- 22 **Secondary Switch** · When switching off, the apparatus is not completely switched off from the mains. To disconnect it from the mains, you have to unplug mains.
- 23 The appliance is not intended for use by young children or infirm persons without supervision.
- 24 Young children should be supervised to ensure that they do not play with the appliance.
- 25 The surface of the TV screen is coated with a thin film, which can easily be damaged. Be very careful with it when handling the TV.
- 26 Should the TV become soiled, wipe it with a soft dry cloth. Never use any cleaner or detergent on it.

# IDENTIFICATION OF CONTROLS

## Main Body (Front)

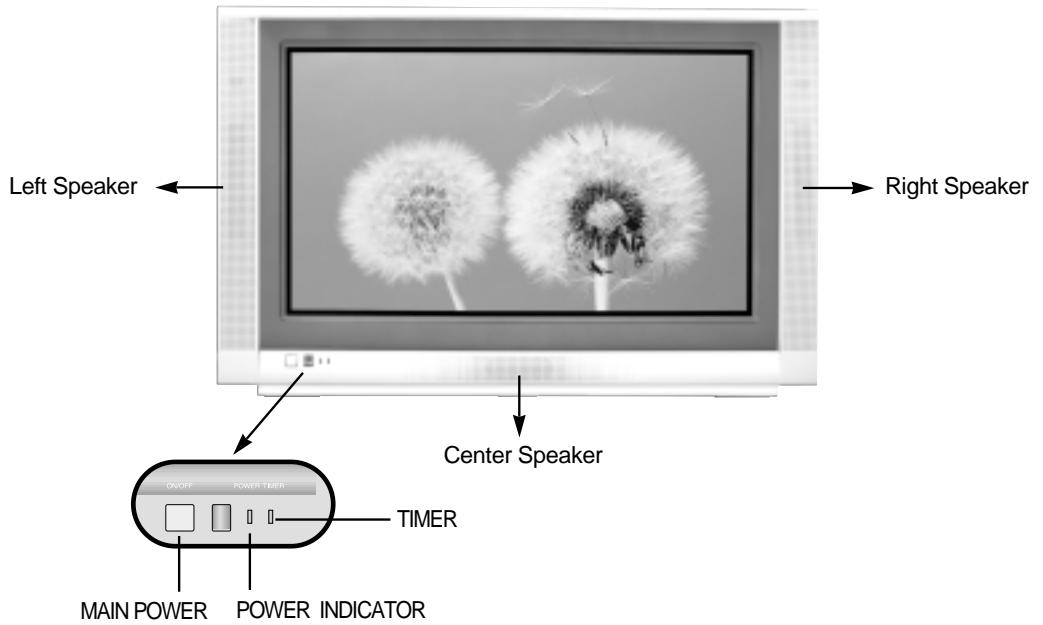

## Main Body (Top)



## Main Body (Side)

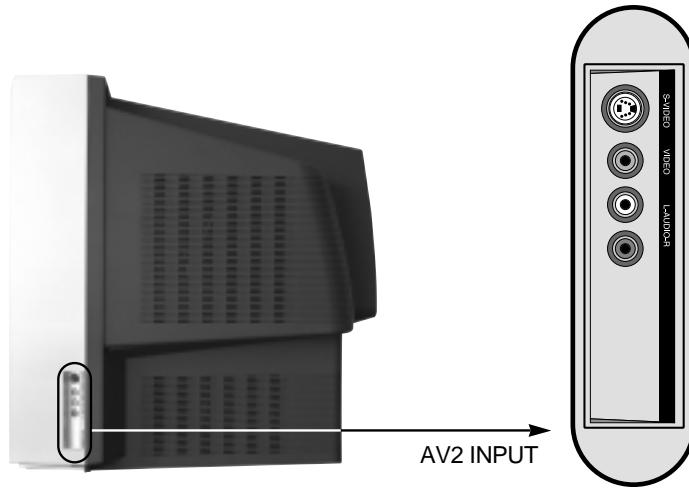

## Main Body (Back)

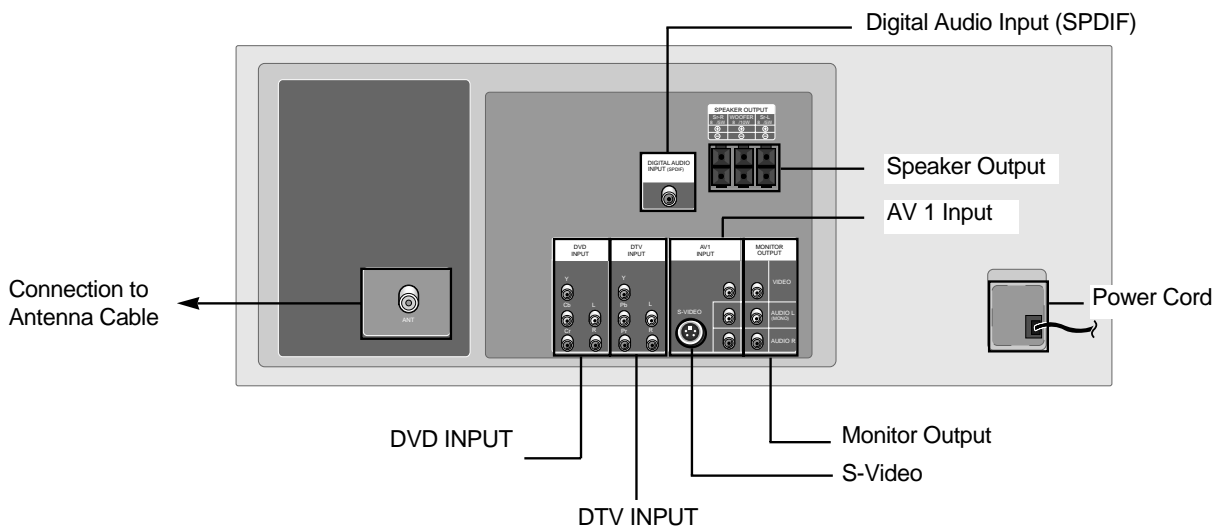
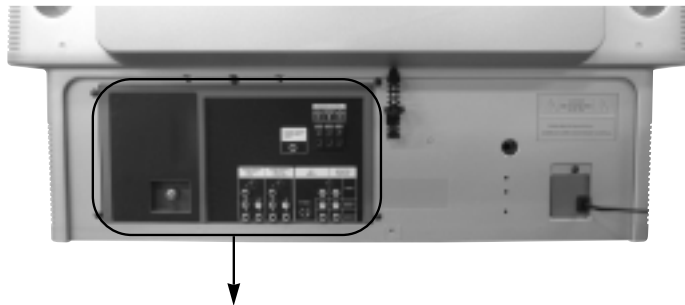

# CONNECTING EXTERNAL EQUIPMENT

## TV/AV Selection

Allows to switch between TV and external modes, By repeatedly pressing the remote control TV/AV or the TV top panel TV/AV button, the on-screen display is changed as shown :

RF > AV 1 > AV 2 > DVD > DTV

But it is changed according to whether you connect S-VIDEO 1(S-VIDEO 2) or not.

If you connect S-VIDEO 1 (S-VIDEO 2), SVHS 1 (SVHS 2) is displayed instead of AV 1 (AV 2).

That is, S-VIDEO 1 (S-VIDEO 2) & AV 1 (AV 2) can not be displayed at the same time.

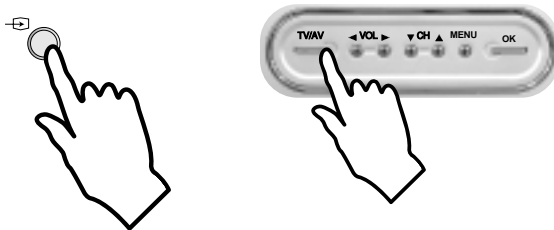

## Connection to a camcorder or other video player

### BACK

Connect the AUDIO / VIDEO OUT terminal of your video player (or camcorder) to AUDIO / VIDEO IN terminal of with AUDIO / VIDEO connecting cable.

When marking connection, please ensure that you turn the main switch OFF to prevent any damage to the equipment.

**Remark :** DVD INPUT is 576i input only and DTV INPUT is 576p or 1080i(50Hz) input only.  
If there are wrong connections, TV does not display any picture.

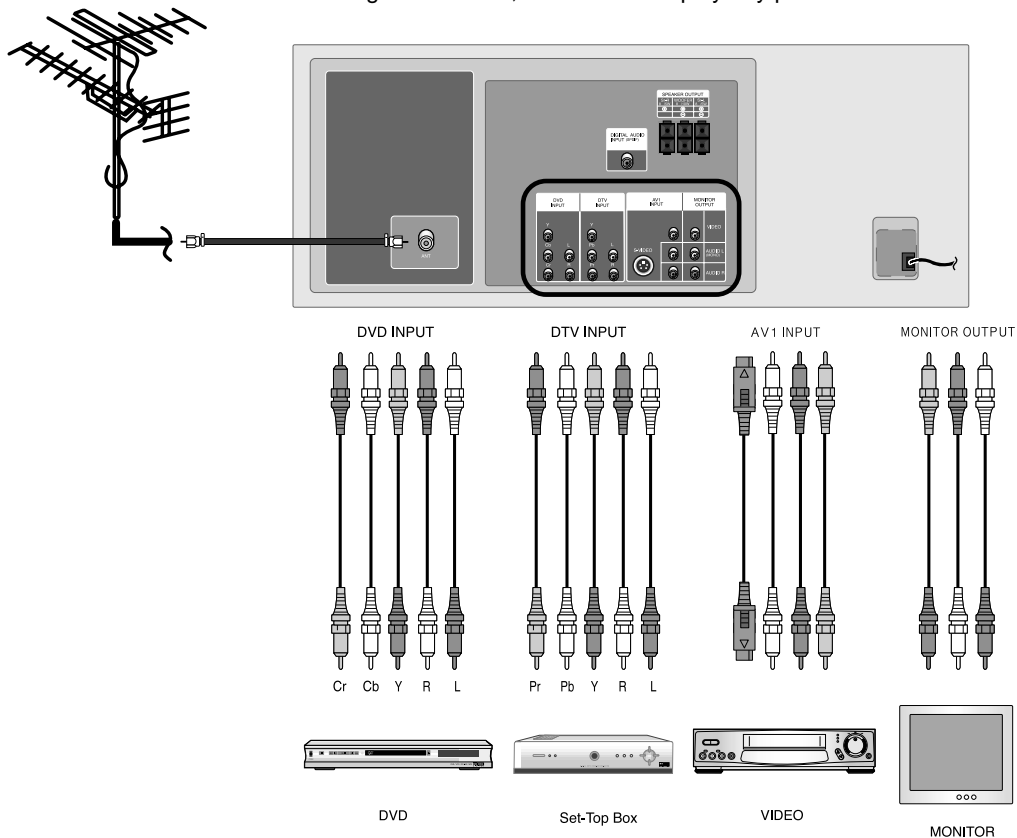

## SIDE (AV2 INPUT)

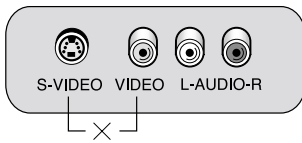
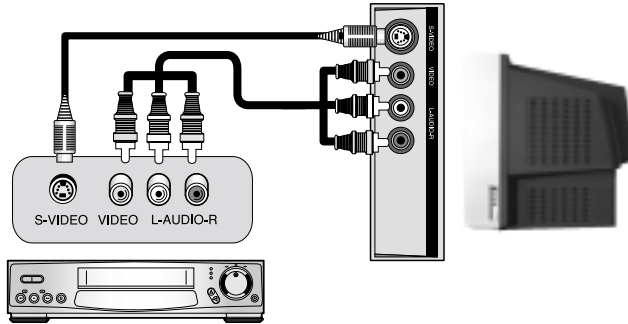

Remark : You can't connect with S-VIDEO & VIDEO at the same time. So user has to select the one of them.

## Connection to Digital Audio

You can enjoy the high quality sound of Dolby Digital sound.

What is Dolby Digital ?

Dolby Digital is the surround sound technology recently used in theaters, and is now available to reproduce this realistic effect at home. You can enjoy motion picture and live concert DVD video discs with dynamic realistic sound by connecting the TV / DVD to the 6 channel amp equipped with a Dolby Digital decoder or Dolby Digital processor.

When marking connection, please ensure that you turn the main switch OFF to prevent any damage to the equipment.

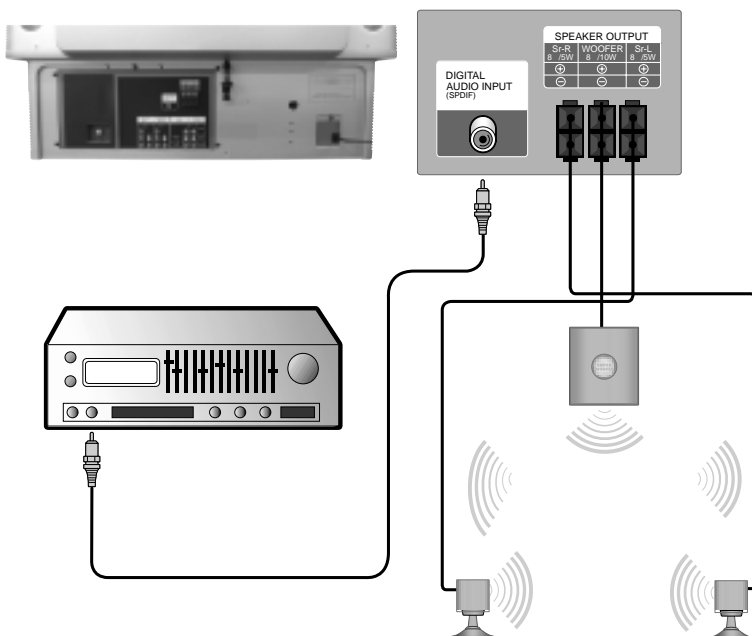

Remark : SPDIF is used in digital sound.  
So it can be operated in AV and DVD/DTV INPUT Mode



# REMOTE CONTROL

## Remote Control Hand Piece

### TV mode

A1	POWER
A2	SOUND MUTE
A3	NUMBER 0..9
A4	SLEEP
A5	TV / AV
A6	PROGRAM UP (CURSOR UP)
A7	VOLUME DOWN (CURSOR LEFT)
A8	.
A9	.
A10	.
A11	SKIP
A12	MOVE
A13	♪ (LISTENING MODE)
A14	MODE
A15	ZOOM
A16	RECALL
A17	NORMAL
A18	OK/PRESET
A19	MENU
A20	VOLUME UP (CURSOR RIGHT)
A21	PROGRAM DOWN (CURSOR DOWN)
A22	TV > TELETEXT
A23	.
A24	.
A25	.
A26	DELETE

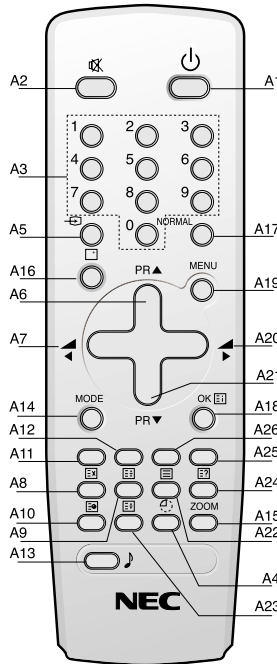

### TELETEXT mode

A1	POWER
A2	SOUND MUTE
A3	NUMBER 0..9
A4	.
A5	.
A6	PAGE UP
A7	VOL/BRIGHT/CONTRAST DOWN
A8	CANCEL
A9	PAGE HOLD
A10	SUBPAGE
A11	RED
A12	GREEN
A13	.
A14	.
A15	.
A16	.
A17	.
A18	INDEX
A19	VOL/BRIGHT MENU SELECTION
A20	VOL/BRIGHT UP
A21	PAGE DOWN
A22	TELETEXT > TV
A23	HEIGHT
A24	REVEAL
A25	CYAN
A26	YELLOW

Remark : As previously stated, All description will be written by using upper words

## Battery Installation & Functions

### Battery installation

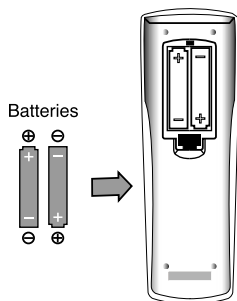

Insert two size AAA batteries matching the +/- polarities of the battery to the +/- marks inside the battery compartment.

### Tips for remote operation

#### Effective range

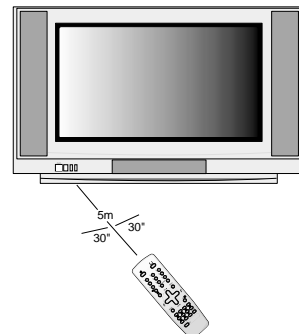

- When the remote control will not be used for a long period of time or when the batteries are worn out, remove the batteries to prevent leakage.
- Do not throw the batteries into a fire. Dispose of used batteries in the specified manner.
- Do not drop, dampen or disassemble the remote control.

# BASIC INSTALLATION

## Switching On TV Set

- 1) If stand-by indicator is red, then the TV set is in stand-by mode. You can switch on using the remote control POWER button (A1), the NUMBER 0...9 buttons (A3), or PROGRAM UP (A6) / DOWN (A21) buttons. The front panel PROGRAM UP/DOWN buttons can also be used. Once on, the stand-by indicator turns off and the picture appears on the screen.
- 2) If stand-by indicator is not lit, then the TV set is powered off. You must press the TV set front panel MAIN POWER button. If a picture does not appear, then the stand-by indicator will be lighted red. In this case, use the remote control as indicated in 1).
- 3) If stand-by indicator is flickering then the TV set is in child-lock mode. It is necessary to use the remote control POWER button (A1), NUMBER 0...9 buttons (A3), or PROGRAM UP (A6) / DOWN (A21) buttons. The Top panel PROGRAM UP/DOWN buttons will not function. Once on, the stand-by indicator turns and the picture appears on the screen.

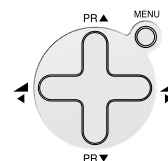
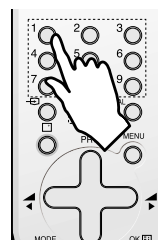
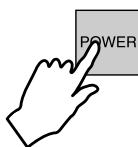
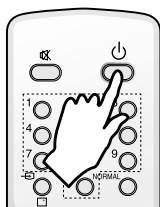

## SWITCHING OFF TV SET

- 1) Pressing the remote control POWER button (A1), you can switch off to stand-by mode (low power consumption mode) which also allows quick restart by remote control (see above: SWITCHING ON TV SET).
- 2) Pressing the TV set front panel MAIN POWER button, you can completely power off the TV set. In this case, you must use the same front panel POWER button to switch on again (see above: SWITCHING ON TV SET).

**Remark:** If a broadcast signal is not present after 30 minutes, the TV set will be automatically turned to stand-by mode.

## Automatic Tuning

ATSS = Automatic Tuning and Sorting System.

To start the ATSS function :

- 1) Press the MENU button (A19), then select the INSTALL menu by using Remote control CURSOR UP (A6), DOWN (A21) buttons.
- 2) Press and hold the OK button (A18) to start the automatic tuning.

The ATSS function has started when the phase "Please Wait!" appears (in red characters) in the help instructions box, below the install menu. when the ATSS function is finished, the stored programs are displayed on screen using Edit menu presentation (to exit tuning before automatic tuning is finished, press the remote control MENU button (A19)).

# MENUS DESCRIPTION

## MAIN MENU

All menus are removed within 25 seconds if you don't press any button.

Press the remote control MENU button (A19) to display the main menu. Then, you have the choice between several sub-menus:

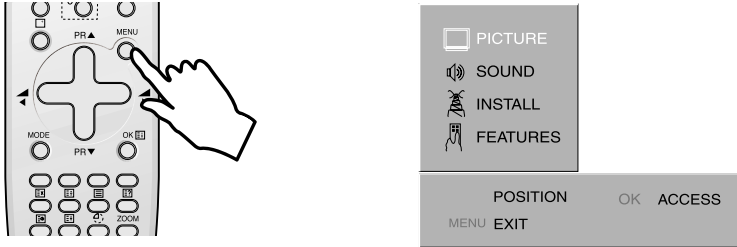

If you want to Exit the main menu, press the MENU button (A19) a second time.

- To select one of the sub-menus, use the remote control CURSOR UP (A6), DOWN (A21) buttons.
- To enter the selected sub-menu, press the remote control OK button (A18).

**Remark:** In AV mode the INSTALL menu is not available, and will not be selectable.

## HOW TO USE THE SUB-MENUS

The sub-menus referred to here are PICTURE, SOUND, INSTALL, FEATURES

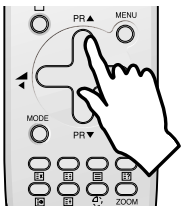

- Select the desired **Position** by using the remote control CURSOR UP (A6) or DOWN (A21) buttons.

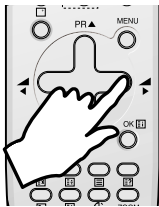

- The remote control CURSOR LEFT (A7) or RIGHT (A20) buttons if you want to modify the function value

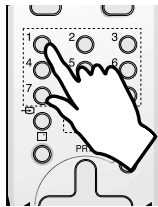

- The remote control NUMBER 0...9 buttons (A3) to enter directly new data.



- **Store** (if needed) by pressing the remote control OK button (A18).

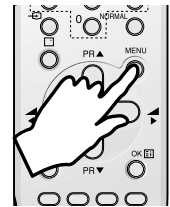

- Then **Exit** to main menu by pressing the MENU button (A19).

## PICTURE MENU

-You can select the picture quality instantly.

### To Select the Picture Mode

1. Press the menu button to select the PICTURE and then displayed on the right appearances. By pressing the OK button or NORMAL button, the following three modes change cyclically.

FAVOURITE > NORMAL I > NORMAL II

- The current selected picture mode is displayed in the menu header.
  - The FAVOURITE mode contains the settings that you last entered.
2. You can select the BRIGHTNESS, CONTRAST, COLOUR, SHARPNESS, TINT and PIC.TILT with CURSOR UP (A6)/DOWN (A21) buttons.  
After selecting items, you can adjust each level with CURSOR LEFT (A7)/RIGHT (A20).
  3. NOISE RED (NOISE REDUCTION) feature is selected On/Off according to your preference.
  4. PIC.TILT feature adjusts a tilt of displayed picture with CURSOR LEFT (A7)/RIGHT (A20).  
The red point of bar represents the center tilt of picture.
  5. If the NTSC standard is detected, then TINT will available.  
Otherwise TINT will be displayed, but not selectable.

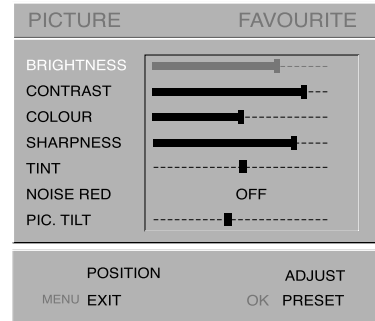

# SOUND MENU

## To Select Listening Mode

1. Press the menu button to select the SOUND and to be displayed on the right appearance. By pressing the CURSOR LEFT (A7)/RIGHT (A20), the following five modes change cyclically.

STEREO > SURROUND > CONCERT > JAZZ CLUB > CATHEDRAL

### - STEREO

This mode operates differently according to input source.

If RF or AV sources are inputted, it is operated STEREO or MONO by only R/L (RIGHT/LEFT) speakers.

If SPDIF source is inputted, it is operated down mixed Dolby Digital sound by only R/L speakers. Other speakers are not supportable.

### - SURROUND

This mode operates automatically according to input source (Reference the table.)

Input source		Listening Mode
SPDIF	Dolby Digital 2.0 CH	Dolby Pro Logic II
	Dolby Digital Except Dolby Digital 2.0 CH	Dolby Digital
	PCM	Dolby Pro Logic II
AV / RF	Mono or Stereo	Dolby Pro Logic II

**Remark:** Dolby Digital 2.0 CH represents which is coded R/L sound. DTS source through SPDIF input is not supportable.

### - CONCERT/ JAZZ CLUB/ CATHEDRAL

You can select mode according to your preference. These modes add your choice to SURROUND sound.

So, you can enjoy a stereophonic sound by selecting these modes.

-VOICE CLARITY: This feature gives you more correct and clean Pronunciations. Especially, it is outstanding in speech program.

## To Set up Speakers.

### Reference

L/R : Left(Right) speaker

Ls/Rs : Left (Right) surround speaker

C : Center speaker.

SUB : Sub Woofer speaker

1. Press the CURSOR UP(A6)/DOWN(A21) buttons to select the speaker setup and Press the OK (A18) button. then It will be displayed on the right appearance.

2. You can setup the speaker output. If all speakers are connectrd, then turn on Ls/Rs. If Ls/Rs is off, the Ls and Rs level menu will be inactive.

3. TEST TONE feature can be selected by pressing CURSOR LEFT(A7)/ RIGHT (A20) buttons. After turning the test tone ON, user can adjust the level of each speakers connected, using NOISE tone. Simply use CURSOR UP(A6)/ DOWN (A21) to select the speakers, and then do the level adjustment using CURSOR LEFT(A7)/ RIGHT (A20) buttons.

**Remark:** When adjusting the speaker level, it is a good way to use this test tone.

4. You can adjust all speakers' level. Red point of each bar represents original speaker level. If you press the CURSOR LEFT (A7), the selected speaker level is decreased. On the contrary, the speaker level is increased.

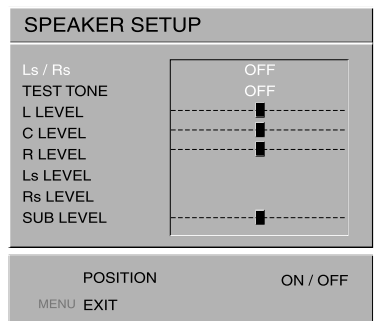
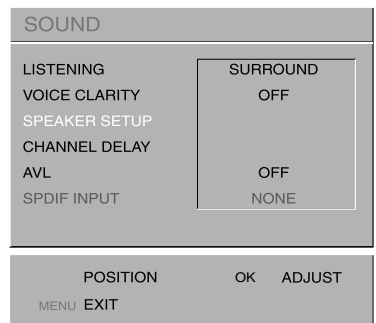
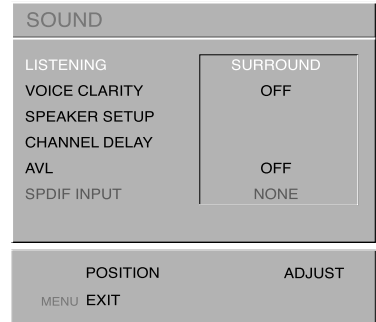

5. CHANNEL DELAY feature provides you a variety of sound effect with delaying signal. The user can give a delay to each speaker (C/Ls/Rs). To adjust the speaker delay, Press OK (A18). You can select a speaker by using CURSOR UP (A6) /DOWN (A21) buttons.

Its range of delay: C 00ms ~05ms  
Ls/Rs 00ms ~ 15ms

6. AVL feature has On/Off according to your preference. This feature corrects for large volume level changes such as occur when passing from a movie to advertisements.

7. SPDIF INPUT indicates what input source (AV1/ SVHS1, AV2/SVHS2, DVD, DTV and NONE) connects to SPDIF. This function will only work if a Digital Audio output is connected to the TV through Dolby DIGITAL (AUDIO INPUT) connector. This SPDIF menu indicates where the SPDIF (Digital audio) can be heard. If you select SPDIF INPUT "DVD", then you can listen the sound of SPDIF (digital audio) only when you select "DVD" through TV/AV button. Otherwise the R/L line input will be heard.

Ex) You can listen to DVD Line input L/R sound, when you see DVD and select SPDIF INPUT "AV1/SVHS1, AV2/SVHS2, DTV or None".

**NOTE:**

- Ensure that SPDIF is set to NONE, if there is no digital audio input connected.
- If by mistake the SPDIF input is selected to one of the input (AV1 AV2 / DVD / DTV), while there is no digital audio input connected, then no sound will be heard at that selected input.

**Remark: SOUND MODE INDICATION**

This feature displays which sound mode operates. As you know, sound mode is changed according to input source and listening mode.

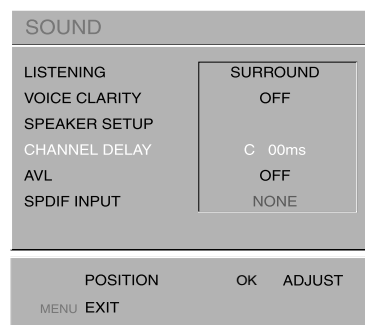

Input Source / Listening Mode	SPDIF			AV(R/L Input)	RF	DESCRIPTION
	Dolby Digital (Except 2.0ch)	Dolby Digital (2.0)	PCM			
STEREO	Dolby Digital	Dolby Digital	Not Display	Not Display	Not Display	L/R/SUB Speaker
SURROUND	Dolby Digital	Dolby Digital Dolby PL II	Dolby PL II	Dolby PL II	Dolby PL II	All Speaker
CONCERT(SURROUND+ CONCERT EFFECT)	Dolby Digital	Dolby Digital Dolby PL II	Dolby PL II	Dolby PL II	Dolby PL II	All Speaker
JAZZ CLUB(SURROUND+ JAZZ CLUB EFFECT)	Dolby Digital	Dolby Digital Dolby PL II	Dolby PL II	Dolby PL II	Dolby PL II	All Speaker
CATHEDRAL(SURROUND+ CATHEDRAL EFFECT)	Dolby Digital	Dolby Digital Dolby PL II	Dolby PL II	Dolby PL II	Dolby PL II	All Speaker

**Remark:** If video signal is not inputted (for example PCM input from audio CD), SOUND mode indication is not displayed.

Dolby Digital 2.0 : Dolby Digital 2CH (R/L)

Dolby PL II : Dolby Pro Logic II

Manufactured under License from Dolby Laboratories, "Dolby", "Pro Logic", and the double-D symbol are trademarks of Dolby Laboratories.

# INSTALL MENU

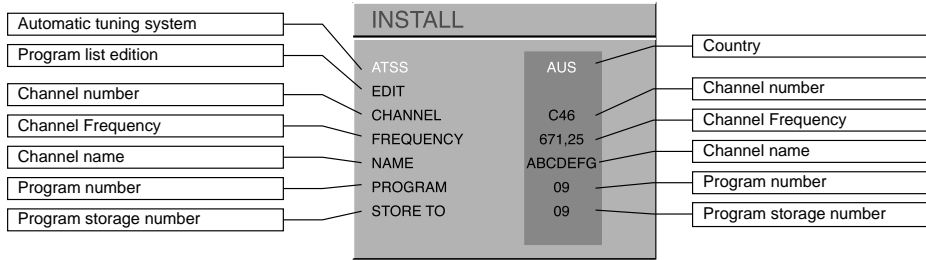

**WARNING :** This television has been factory pretuned to channels 2, 7, 9, 10 and 28. If the auto search function is activated, these preset channels will be deleted and new channels tuned to 1, 2, 3 ETC.

# PROGRAM LIST EDIT

This allows you to easily manipulate the existing program order allocation. by using EDIT menu functions described below

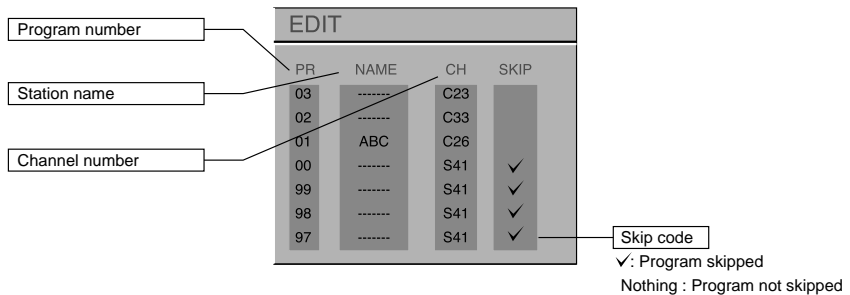

To enter the EDIT menu: From Install menu, select "Edit", and press the OK button (A18): the EDIT menu appears.

The current program being displayed is highlighted in blue (on the central line). In the above case, the current program is PR00. The 3 previous, and 3 following programs, are always displayed. Any program from 00 to 99 can be selected, by using the remote control CURSOR UP (A6) / DOWN (A21) buttons.

The memorised programs can be modified as follows :

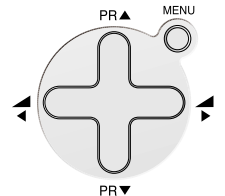

## Channel skipping

- You can select skip "YES" or "NO" using the remote control RED "Skip" button (A11). A program with skip "YES" doesn't appear on screen when changing channels with the PROGRAM UP (A6) / DOWN (A21) buttons.

## Channel deleting

- Select the program to delete using the remote control CURSOR UP (A6) / DOWN (A21) buttons.
- Press the remote control YELLOW "Delete" button (A26). The deleted program is moved to program number 99 with skip changed to "YES". The existing 99 program is moved to program number 98 and so on.

## Channel order changing

- Select the program to move using the remote control CURSOR UP (A6) / DOWN (A21) buttons.
- Press the remote control GREEN "Move" button (A12). The program line background is highlighted in orange, and can be moved to another position using the remote control CURSOR UP (A6)/ DOWN (A21) buttons.
- When the desired position is reached, confirm the new position pressing the remote control GREEN "Confirm" button (A12). Then the program line background will return again to gray.

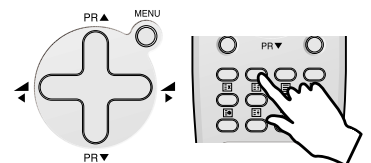
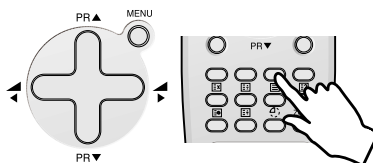
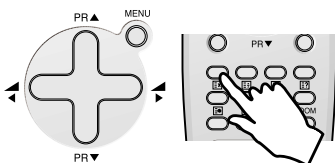

## FEATURE MENU

### -TO SELECT CHILD LOCK

- 1) You can prevent the use of the TV set without the remote control.  
Press the MENU button to select the FEATURES and press the Cursor Up (A6)/Down (A21) to select the CHILD LOCK.
- 2) Press the Cursor Left (A7)/Right (A20) to change CHILD LOCK on/off.
- 3) Once the user has set this CHILD LOCK to on or off, it will remain in this condition until the user changes it again.

FEATURES	
CHILD LOCK	ON
WAKE TIME	OFF
WAKE PROG.	02
CLOCK	12 : 24
SCAN MODE	100Hz

### -TO SET WAKE TIME & WAKE PROG

It is necessary to have set the clock in order to be able to use this function. If the CLOCK is not set then the WAKE TIME & WAKE PROG will not be selectable.

- 1) Select the WAKE TIME with the Cursor Up (A6)/Down (A21).
- 2) Press the Cursor Left (A7)/Right (A20) to activate the hour or the minute and Preset the hour or the minute with the direct number buttons (A3)
- 3) After setting a WAKE TIME, you can select WAKE PROG with the Cursor Left (A7)/Right (A20) or direct number buttons (A3).

POSITION	ON/OFF
MENU EXIT	

### -TO SET CLOCK

This function allows user to enter the time manually.

If you turn off the set with the main power button, the clock setting is lost. An automatic attempt is made to set the clock again at power on.

### -SCAN MODE

This function allows user to select 100Hz/PROGRESSIVE (50Hz) according to your preference.

**Remark :** This function can be selected in RF & AV PAL signals.

100Hz can not be selected in AV NTSC input or DTV INPUT.



# SOUND CONTROL

## VOLUME ADJUSTMENT

Use the remote control VOLUME UP (A20) / DOWN (A7) buttons or the TV set front panel VOLUME UP / DOWN buttons.

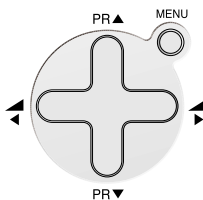

## MUTE

Mute the sound by pressing the remote control SOUND MUTE button (A2).

Then,  logo is displayed. The previous sound setting is returned after pressing the same button a second time.

If a sound related function is used (e.g. VOLUME, ) then the MUTE will also be cancelled.

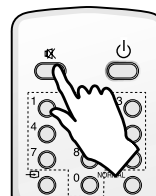

## MONO FORCING, DUAL LANGUAGE

- If you are unable to get good sound quality for a program due to poor reception, you can force a change from stereo to mono transmission by pressing the remote control MODE button (A14).

Then the program status display will indicate "MONO" with a  icon.

- On the other hand, during a program with dual language transmission, the MODE button (A14) allows you to toggle between the first and second language. The program status display will indicate "DUAL 1" or "DUAL 2" (plus NICAM according to the received signal).

- To return to initial state, press again the MODE button (A14).

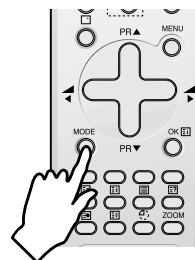

# PICTURE CONTROL

## PICTURE SETTING

You can select three pictures settings, by using the remote control NORMAL button (A17)

- Normal I (standard hard picture)
- Normal II (standard soft picture)
- Favourite

For other adjustments: BRIGHTNESS, CONTRAST, COLOUR, SHARPNESS, NOISE REDUCTION, use the PICTURE menu.

If an NTSC signal is received, then the TINT adjustment will also be available.

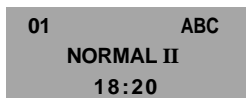
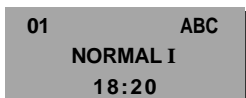
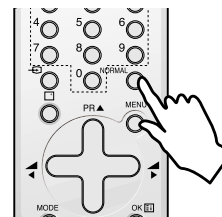

## PROGRAM STATUS DISPLAY (Recall)

Use the remote control RECALL button (A16) to display (for 4 seconds only) program status information. This display appears also after a program selection or switching on the TV set.

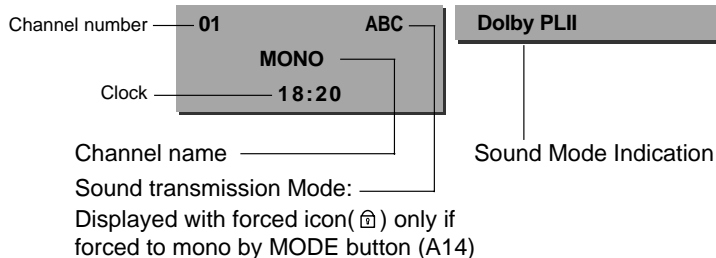

## SLEEP FUNCTION

The set will turn off (to stand-by mode) after a period of time that you can select. By repeated use of the remote control SLEEP button (A4), you can enter one of the following settings :

OFF > 20 min > 40 min > 60 min > 80 min > 100 min > 120 min > OFF

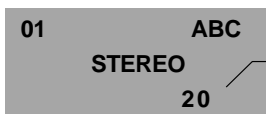
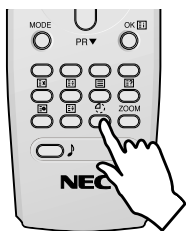

Remaining time (minutes) before TV set switches off

The SLEEP time remaining (before TV turn-off) can be seen again at any time by one touch on the remote control SLEEP button (A4).

A second touch (while the status display is active) will modify the SLEEP time remaining.

## FORMAT SELECTION

The user can be forced the preferred mode by repeated pressing of the remote control ZOOM button(A15) :

the following picture formats are available :

STANDARD > PANORAMA > ZOOM 1 > ZOOM 2 > 4 : 3

**Remark** : This function is not used in DTV INPUT mode.

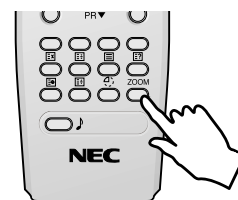

# TELETEXT

## ENTERING / EXIT TELETEXT MODE

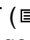
- Select the desired program with teletext.
- Press the remote control TELETEXT (  ) button (A22) to select teletext mode. The initial page (or the last page viewed if you have already used teletext in the present channel) appears.

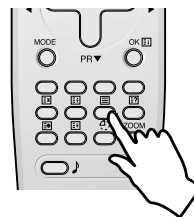

## PAGE SELECTION

- You can directly enter the 3 figure page number by using the remote control NUMBER 0...9 buttons (A3).
- You can sequentially select teletext pages by pressing the remote control PAGE UP (A6) / DOWN (A21) buttons.
- At the base of the screen a menu of coloured page links is available, showing either page numbers or a title with headings (eg Sport, News) in RED, GREEN, YELLOW or CYAN colour. These pages can be accessed by using the corresponding coloured buttons (A11, A12, A26, A25) on the remote control.

Once a request is made, the page number is shown in the extreme top left corner of the screen. If the requested page is not immediately available the rolling header will be active until the page arrives.

## TELETEXT FORMAT PICTURE & SOUND CONTROL

### Doubling character height

Repeatedly pressing the HEIGHT button  (A23) doubles the character height in the following order:

Upper half of the page (UP) > Lower half of the page (DOWN) > Return to normal height.

If the page is in UP or DOWN mode, then normal size is automatically set if :

- A new page request is made (e.g. CYAN, INDEX or PAGE UP/DOWN).
- CANCEL mode (A8) function is used.
- VOLUME menu is activated the with the MENU button (A19).

**Note :** The menu at the base of the screen is always visible

### Volume and brightness control in teletext mode

VOLUME ( and sound MUTE), BRIGHTNESS controls are all possible in teletext. The BRIGHTNESS controls is dedicated to the teletext display.

- Access the VOLUME control by pressing the MENU button (A19) in teletext mode. A bar graph will appear in the lower part of the screen (as in TV mode). If MUTE is active, a mute icon is also shown.
- A second press on the MENU button (A19) will access the BRIGHTNESS control, and the third press will back to normal condition.
- The active bargraph will timeout after 3-4 seconds (as in TV mode VOLUME control) or by pressing on the MENU button (A19) third time (after brightness control)
- Each control can be adjusted by using the remote control CURSOR RIGHT (A20) / LEFT (A7) buttons.
- Mute can always be activated by pressing the SOUND MUTE button (A2).
- Any change to the VOLUME level will cancel the SOUND MUTE.

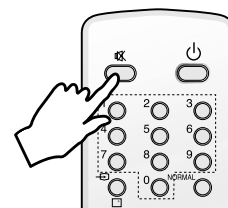
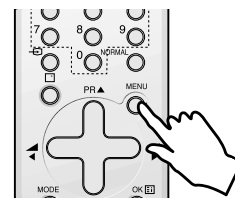
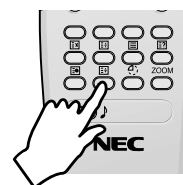

## USEFUL TELETEXT FUNCTIONS

**INDEX**  button (A18): Allows you to return directly to the initial teletext page.

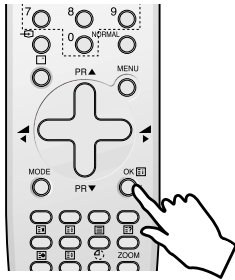

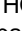
**PAGE HOLD**  button (A9): Any teletext page or subpage can be held on the screen by pressing the PAGE HOLD button.

- The page number shown in the extreme top left corner of the screen will become red.
- Press the HOLD button again to cancel hold mode (the page number will return to white).

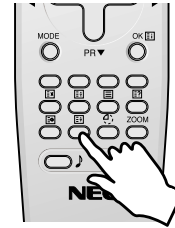

**SUBPAGE**  button (A10): Allows you to request a specific subpage:

- Press the SUBPAGE button (A10). At the base of the screen a SUBPAGE menu will appear. This has a red subpage minus link, a green subpage plus link, plus a white background showing (e.g. for page 110), 110 / 0001. This is ready to accept the subpage number.
- Enter directly the subpage number you want with the remote control NUMBER 0...9 buttons (A3): for example to request the 2nd subpage, type 0002.
- Alternatively, use the red subpage minus link or the green subpage plus link.
- The subpage number entered is shown at the base of the screen.
- If the requested page is not immediately available the rolling header will be active until the page arrives. Warning: If the subpage is not available (does not exist), then the header will roll continuously and no new page will be found.
- To exit subpage mode, press the SUBPAGE button (A10) again.

**Note** : Teletext specification allows for subpage numbers 0000 to 3979 (the first figure is limited to the range 0..3, and the third figure 0..7).



**REVEAL**  button (A24): Press this button to reveal, on certain pages, hidden information such as the answer to a quiz.

- Press the button again to hide the information.

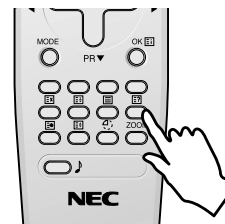



## BEFORE CALLING SERVICE PERSONNEL

Symptoms	Correction
<ul style="list-style-type: none"><li>· Colour is not displayed and net pattern is displayed on the specific channel.</li></ul>	<ul style="list-style-type: none"><li>▶ Check the external antenna and cable TV conditions.</li><li>▶ Check whether you select the correct channel.</li></ul>
<ul style="list-style-type: none"><li>· Vertical and horizontal line and net pattern are displayed on the screen in a moment. Vibration is also displayed.</li></ul>	<ul style="list-style-type: none"><li>▶ Check the interference wave caused by car, neon sign, and high frequency.</li><li>▶ Check the strong interference radio wave from wave of other devices or radio station. Please stop the use mobile phone, hair dryer, and electric drill.</li></ul>
<ul style="list-style-type: none"><li>· Pictures are overlapped and white and black spots are displayed</li></ul>	<ul style="list-style-type: none"><li>▶ Check damage of antenna or connection of antenna cable.</li><li>▶ Check the height and direction of antenna. If it is incorrect, please adjust the antenna.</li></ul>
<ul style="list-style-type: none"><li>· The original colours are not displayed in a screen in specific areas.</li></ul>	<ul style="list-style-type: none"><li>▶ Remove from magnetic fields or rotate set until purity error disappears.</li></ul>
<ul style="list-style-type: none"><li>· Picture is displayed irregularly.</li></ul>	<ul style="list-style-type: none"><li>▶ Check the connection of antenna cable (incorrect connection or disconnection).</li><li>▶ Move this product to another location.</li></ul>
<ul style="list-style-type: none"><li>· No picture and sound</li></ul>	<ul style="list-style-type: none"><li>▶ Plug the power cord into the wall outlet securely.</li><li>▶ Press the [TV / AV] button to change input mode.</li></ul>
<ul style="list-style-type: none"><li>· No sound</li></ul>	<ul style="list-style-type: none"><li>▶ [MUTE] button may be pressed.</li><li>▶ Check the volume.</li><li>▶ Check whether SPDIF is selected to one of the input or not (Refer to Page 15). Select SPDIF to NONE, if there is no digital audio input connected.</li></ul>
<ul style="list-style-type: none"><li>· The remote control does not work properly</li></ul>	<ul style="list-style-type: none"><li>▶ Check a stoppage of power supply</li><li>▶ Check whether the power cord is plugged into the wall outlet</li><li>▶ The batteries in remote control may be exhausted or loaded in wrong polarity.</li><li>▶ Check whether the remote control is too far from the player and is not pointed at the remote sensor of the player.</li></ul>



# SPECIFICATION

MODEL		PF32WT100	
TV Standard	Colour system	PAL, NTSC 3.58 / 4.43 (AV)	
	Sound system	B/G, D/K, I, H, M (AV)	
Rated voltage		220-240V ~, 50Hz	
Power consumption	Power on	160 W	
	Stand-by	1.2W $\pm$ 10%	
Sound Output Power	Main R/L	7W + 7W (10% THD, 80% MOD, At 1KHz, Listening : STEREO)	
	Surround R/L, Center	5W +5W ,5W (10%THD, SPDIF, Dolby Digital -20dBFs, 1KHz, Listening : SURROUND)	
	Woofer	7W (10%THD, SPDIF, Dolby Digital -20dBFs, 100Hz, Listening : SURROUND)	
Channel Coverage	VHF	BAND I : CH0 - CH4 [CH0(46.25MHz), CH2(64.25MHz)] BAND II : CH5 - CH12 [CH7(182.25MHz), CH10(196.25MHz), CH10(209.25MHz)] CABLE BAND : S1' - S3', S1- S20 HYPER BAND : S21 - S41	
	UHF	BAND IV, V : CH21 - CH69 [CH28(527.25 MHz)]	
Tuning System		Frequency Synthesizer Tuning System	
Channel Indication		On Screen Display	
Program Selection		100 Programs	
Aux, Terminal	Input	REAR	AV1 RCA Jack S-VHS 1 (S-Video) SPDIF(Coaxial) DVD INPUT, DTV INPUT
		SIDE	AV2 RCA Jack S-VHS 2 (S-Video)
	Output	REAR	Monitor Out RCA Jack Surround R/L, Woofer Speaker
Remote Control Unit		R-49C08 (Required two 1.5V batteries type with AAA size)	
Dimension		890(W) $\times$ 580(W) $\times$ 564(D)	
Picture Tube		32" WIDE FLAT TYPE	
Weight	Net weight	57 kg	
	Gross weight	63 kg	



**NEC Australia Pty. Ltd.**  
**ABN 86 001 217 527**  
**Home Electronics Group**

## **NEC Service Centres**

**PH: 131-632**

---

### **NEW South Wales**

Sydney	184 Milperra Rd, Revesby 2212	(02)9780 8688
Newcastle	120 Parry Street, Newcastle West 2302	(02)4926 2466

### **Victoria**

Melbourne	Unit 1/6 Garden Road, Clayton 3168	(03)8562 6245
-----------	------------------------------------	---------------

### **Queensland**

Brisbane	Unit 4/305 Montague Road, WEST END 4101	(07)3840 5858
Southport	Shop 1, 48 Ferry Road, Southport 4215	(07)5591 3670

### **South Australia**

Adelaide	84A Richmond Rd, Keswick, 5053	(08)8375 5710
----------	--------------------------------	---------------

### **Western Australia**

Perth	45 Sarich Court, Osborne Park 6017	(08)9445 5901
-------	------------------------------------	---------------

For Service in outer areas, please contact your NEC retailer for the address of the nearest Authorised NEC Service Centre.

---

**NEC Australia Pty. Ltd.**  
**Home Electronics Group**  
**244 Beecroft Road EPPING 2121**  
**Tel: 131 632**  
**Fax: (02)9877 2353**