

Register your product and get support at

[www.philips.com/welcome](http://www.philips.com/welcome)

DVP3950



User manual	7	Instrukcja obsługi	44
Příručka pro uživatele	16	Manual de utilizare	54
Εγχειρίδιο χρήσης	25	Príručka užívateľa	63
Felhasználói kézikönyv	35	Kullanım kılavuzu	72

**PHILIPS**



- EN Before you connect this DVD player, read and understand all accompanying instructions.
- CS Před zapojením DVD přehrávače si přečtěte všechny doprovodné instrukce.
- EL Προτού συνδέσετε αυτή τη συσκευή αναπαραγωγής δίσκων DVD, διαβάστε προσεκτικά όλες τις συνοδευτικές οδηγίες.
- HU A DVD-lejátszó csatlakoztatása előtt figyelmesen olvassa el az összes kapcsolódó utasítást.
- PL Przed podłączeniem tego odtwarzacza DVD należy zapoznać się ze wszystkimi dołączonymi instrukcjami.
- RO Înainte de a conecta acest player DVD, citiți și înțelegeți toate instrucțiunile însoțitoare.
- SK Skôr ako pripojíte tento prehrávač diskov DVD, prečítajte si všetky uvedené pokyny a uistite sa, že im rozumiete.
- TR Bu DVD oynaticıyı bağlamadan önce, birlikte verilen tüm talimatları okuyun ve anlayın.



ABOUT DIVX VIDEO: DivX® is a digital video format created by DivX, LLC, a subsidiary of Rovi Corporation. This is an official DivX Certified® device that plays DivX video. Visit [divx.com](http://divx.com) for more information and software tools to convert your files into DivX videos.

ABOUT DIVX VIDEO-ON-DEMAND: This DivX Certified® device must be registered in order to play purchased DivX Video-on-Demand (VOD) movies. To obtain your registration code, locate the DivX VOD section in your device setup menu. Go to [vod.divx.com](http://vod.divx.com) for more information on how to complete your registration.

DivX®, DivX Ultra®, DivX Certified® and associated logos are trademarks of Rovi Corporation or its subsidiaries and are used under license.

DivX Ultra® Certified to play DivX® video with advanced features and premium content.



Manufactured under license from Dolby Laboratories.

Dolby and the double-D symbol are trademarks of Dolby Laboratories.



'DVD Video' is a trademark of DVD Format/Logo Licensing Corporation.

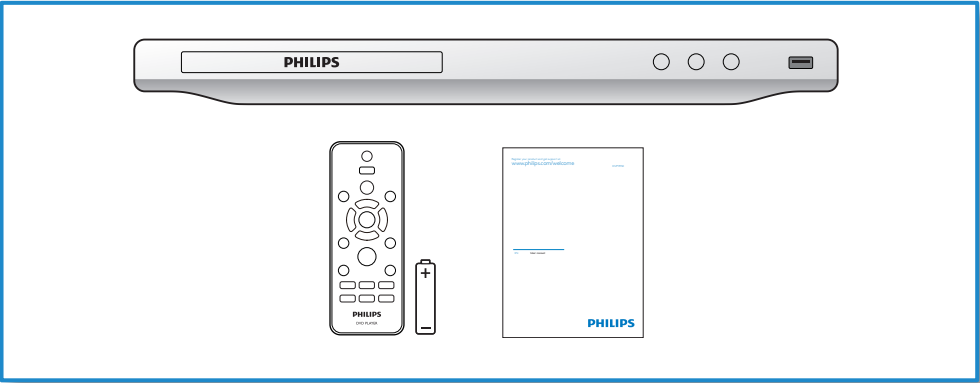

# 1

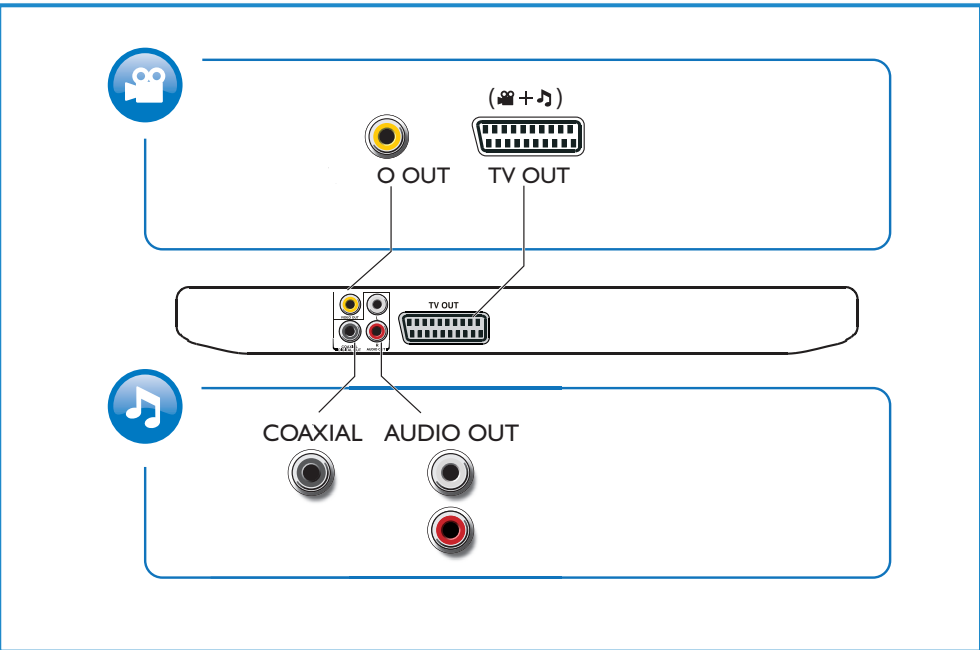

2

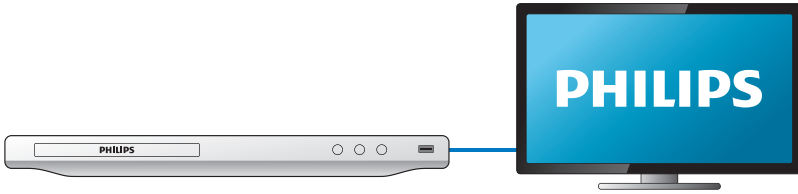

TV OUT



VIDEO OUT + AUDIO OUT



3

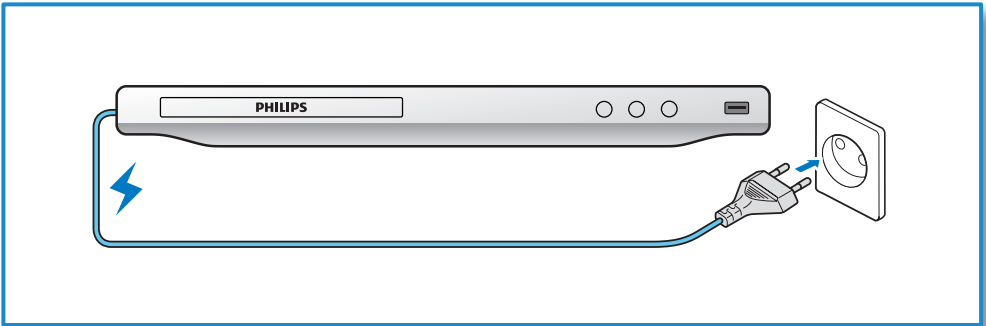

4

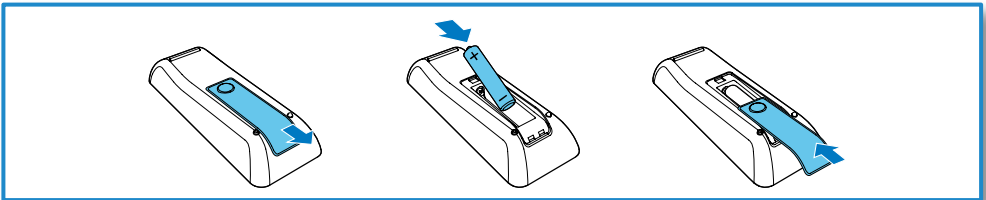

5

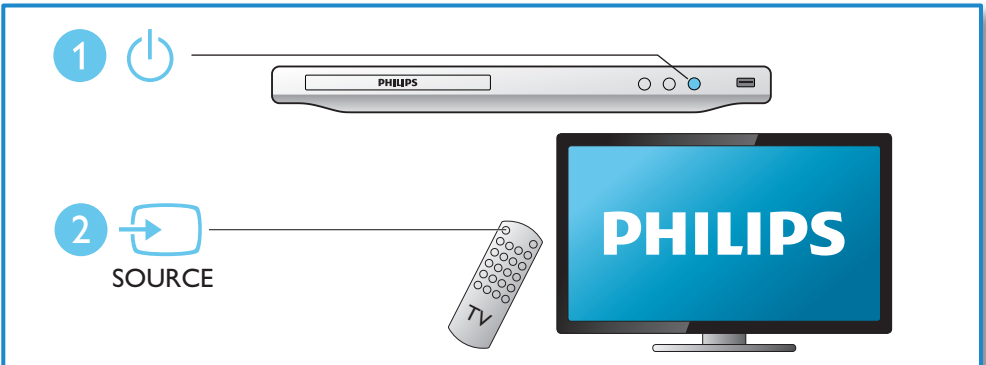

# 6



2



DVD  
VCD  
CD  
MP3 / JPEG

1

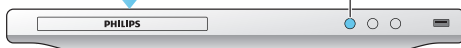

3

4



USB

1

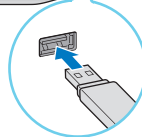

2

3

4

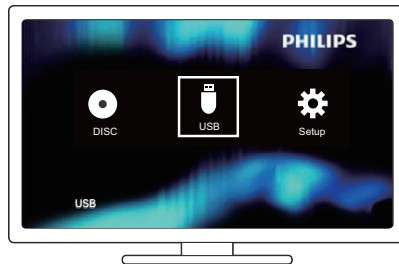
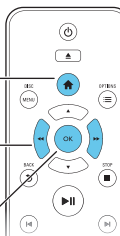

# Contents

---

<b>1</b>	<b>Hookup and play</b>	2-6
<hr/>		
<b>2</b>	<b>Use your DVD player</b>	8
	Basic play control	8
	Video options	9
	Play a musical slideshow	9
	Repeat play	9
	Skip play	9
	DivX videos	10
<hr/>		
<b>3</b>	<b>Change settings</b>	11
	General (sleep, standby...)	11
	Picture	11
	Sound	11
	Preference (languages, parental control...)	12
<hr/>		
<b>4</b>	<b>Software update</b>	13
<hr/>		
<b>5</b>	<b>Specifications</b>	13
<hr/>		
<b>6</b>	<b>Troubleshooting</b>	14

## 2 Use your DVD player

Congratulations on your purchase, and welcome to Philips! To fully benefit from the support that Philips offers, register your product at [www.philips.com/welcome](http://www.philips.com/welcome).

### Basic play control

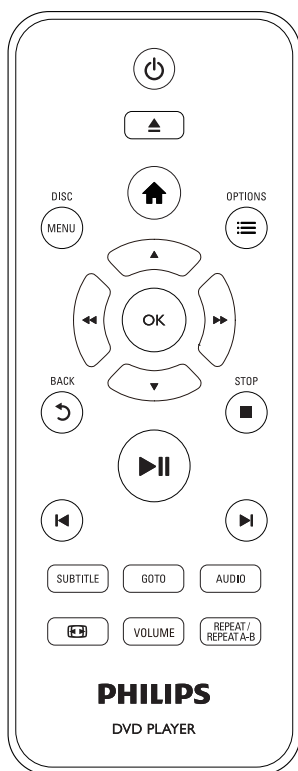

During play, press the following buttons to control the player:

Button	Action
	Turn on the player; or switch to standby.
	Open or close the disc compartment.
	Access the home menu.
<b>DISC MENU</b>	Access or exit the disc menu.
	Access more options during video play.
	Navigate the menus. Slow forward or backward. Press repeatedly to change a search speed.
	Navigate the menus. Fast forward or backward. Press repeatedly to change a search speed.
<b>OK</b>	Confirm a selection or entry.
	Return to a previous display menu.
	Stop play.
	Start, pause or resume play.
	Skip to the previous or next track, chapter or file.
<b>SUBTITLE</b>	Select a subtitle language.
<b>GOTO</b>	Skip to a title, a chapter or a track.
<b>AUDIO</b>	Select an audio language or channel.
	Fit the picture display to the TV screen. Zoom the picture in or out.
<b>VOLUME</b>	Activate volume control, and then press  to change a volume level.
<b>REPEAT/REPEAT A-B</b>	Select a repeat play option.



## Video options

During video play, press **≡** **OPTIONS** to access the following options.

- **[Info]**: Display the current play information.
- **[PBC]**: Display or skip the content menu for VCD and SVCD.
- **[Aspect ratio]**: Select a picture display format to fit the TV screen.
- **[Volume]**: Change a volume level.
- **[Angle]**: Select a camera angle from which video is viewed.

## Play a musical slideshow

Play music and pictures simultaneously to create a musical slideshow.

- 1 From a disc or connected USB storage device, play a music file.
- 2 Press **▲▼** to navigate to the picture files.
- 3 Select a picture from the same disc or USB, and press **OK** to start slideshow.
- 4 Press **■** to stop slideshow.
- 5 Press **■** again to stop music play.

## Control photo play

During a photo slideshow, use the remote control to control the play.

Button	Action
<b>▲▼</b>	Rotate a picture horizontally/vertically.
<b>◀◀/▶▶</b>	Rotate a picture anti-clockwise/clockwise.
<b>≡</b> <b>OPTIONS</b>	Access to select <b>[Color]</b> to display a picture in color or black and white. Access to select <b>[Photo preview]</b> to display pictures in thumbnail.
<b>⏏</b>	Zoom in or out of a photo. Play pauses in zoom mode.
<b>OK</b>	Start or resume a play.

■ Stop a play.

## Repeat play

During play, press **REPEAT/REPEAT A-B** repeatedly to select a repeat play option.

- Repeat the current title, chapter, or track.
- Repeat all the contents on a disc or a USB storage device.
- Repeat play for a specific section.

To Repeat play for a specific section

- 1 Press **REPEAT/REPEAT A-B** repeatedly to select **↻A** as a start point.
- 2 Press **REPEAT/REPEAT A-B** again to select **↻AB** as an end point.  
↳ The repeat play of the marked section starts.
- 3 To cancel repeat play, press **REPEAT/REPEAT A-B** until **[Off]** is displayed.

### ≡ Note

- Repeat play of the marked section is only possible within a title or track.

## Skip play

You can skip play to a specific title, chapter or track.

- 1 During play, press **GOTO**.  
↳ An input field bar is displayed, and "0" blinks.
- 2 Press **▲▼** to select a digit as a title, chapter, or track number.
- 3 After a digit is selected, press **◀◀/▶▶** to change a digit position.
- 4 If necessary, repeat step 2 and 3 to complete the input of a title, chapter, or track number.

- 5 Press **OK**.  
↳ The play skips to the selected title, chapter or track.

---

## DivX videos

You can play DivX videos from a disc or a USB storage device.

### VOD code for DivX

- Before you purchase DivX videos and play them on this player, go to [vod.divx.com](http://vod.divx.com) to register this player using the DivX VOD code.
- Display the DivX VOD code: press **▲**, and select **[Setup] > [General] > [DivX(R) VOD Code]**.

### DivX subtitles

- Press **SUBTITLE** to select a language.
- If subtitles are not displayed correctly, change the character set that supports DivX subtitles. Select a character set: press **▲**, and select **[Setup] > [Preferences] > [DivX Subtitle]**.

Character set	Languages
<b>[Standard]</b>	English, Albanian, Danish, Dutch, Finnish, French, Gaelic, German, Italian, Kurdish (Latin), Norwegian, Portuguese, Spanish, Swedish, and Turkish
<b>[Central Europe]</b>	Albanian, Croat, Czech, Dutch, English, German, Hungarian, Irish, Polish, Romanian, Slovak, Slovene, and Serbian
<b>[Cyrillic]</b>	Bulgarian, Belorussian, English, Macedonian, Moldavian, Russian, Serbian, and Ukrainian
<b>[Greek]</b>	Greek

### Note

- To use the subtitles, make sure that the subtitle file has the same name as the DivX video file name. For example, if the DivX video file is named "movie.avi", save the subtitle file as "movie.srt", or "movie.sub".
- This player can play subtitle files in the following formats: .srt, .sub, .txt, .ssa, and .smi.

## 3 Change settings

This section helps you change the settings of this player.

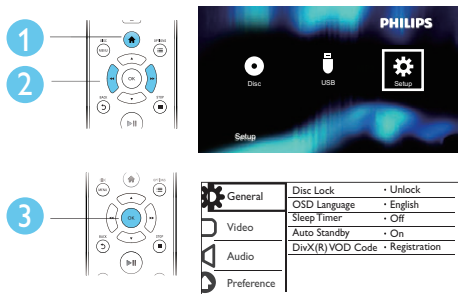

### Note

- You cannot change a menu option that is grayed out.
- To access **[Preferences]**, stop the disc play.
- To return to the previous menu, press **↶**. To exit the menu, press **⬆**.

### General (sleep, standby...)

- 1 Press **⬆**.
- 2 Select **[Setup]** > **[General]** to access the general setup options.
  - **[Disc Lock]**: Lock or unlock a disc for play. To play a locked disc, you need to input your password: press **▲▼** to enter a digit, and press **◀▶** to change a digit position. The default password is "136900".
  - **[OSD Language]**: Select a language for on-screen menu.
  - **[Sleep Timer]**: Set a period of time for this player to switch automatically to standby mode from play.
  - **[Auto Standby]**: Enable or disable auto standby. If enabled, this player switches automatically to standby after 15

minutes of inactivity (for example, in pause or stop mode).

- **[DivX(R) VOD Code]**: Display the DivX® registration code and deregistration code.

### Picture

- 1 Press **⬆**.
- 2 Select **[Setup]** > **[Video]** to access the video setup options.
  - **[TV System]**: Select a TV system that matches your TV. By default, this setting matches the common TVs in your country.
  - **[Aspect ratio]**: Select a picture display format to fit the TV screen.
  - **[Picture Setting]**: Select a predefined color setting, or customize a setting.
  - **[RGB]**: Turn on or off scart video output when this player is connected through the **TV OUT** connector:

### Sound

- 1 Press **⬆**.
- 2 Select **[Setup]** > **[Audio]** to access the audio setup options.
  - **[Analogue Output]**: Select an audio format for sound output when this player is connected through the **AUDIO OUT L/R** connectors.
  - **[Digital Audio]**: Select an audio format for sound output when this player is connected through the **COAXIAL** connector.
    - **[Digital Output]** - Select a type of digital output: **[Off]** - Disable digital output; **[All]** - Support multi-channel audio formats; **[PCM Only]** - Downmix to two-channel audio signal.

- **[LPCM Output]** - Select a LPCM (Linear Pulse Code Modulation) output sampling rate. The higher the sampling rate, the better the sound quality. **[LPCM Output]** is enabled only when **[PCM Only]** is selected under **[Digital Output]**.
- **[Volume]**: Change a volume level.
- **[Sound Mode]**: Select a preset sound effect.
- **[Night Mode]**: Select quiet or full dynamic sound. Night mode decreases the volume of loud sound and increases the volume of soft sound (such as speech).
- **[Password]**: Set or change a password to play a restricted disc. Input "136900" if you do not have a password or if you have forgotten your password
- **[DivX Subtitle]**: Select a character set that supports the subtitle of your DivX video.
- **[Version Info]**: Display the software version for this player.
- **[Default]**: Reset all settings to the factory default, except for the settings for **[Disc Lock]**, **[Parental Control]** and **[Password]**.



#### Note

- Night mode is only available for Dolby encoded DVD discs.



#### Note

- If your preferred language is not available for disc language, audio or subtitle, you can select **[Other]** from the menu options and input 4-digit language code which can be found at the back of this user manual.
- The rating levels are country-dependent. To allow all discs to be played, select **[8 Adult]**.

## Preference (languages, parental control...)

- 1 Press **▲**.
- 2 Select **[Setup]** > **[Preferences]** to access the preference setup options.
  - **[Audio]**: Select an audio language for video.
  - **[Subtitle]**: Select a subtitle language for video.
  - **[Disc Menu]**: Select a menu language for a video disc.
  - **[Parental Control]**: Restrict access to discs that are encoded with ratings. Input "136900" to access the restriction options: When the password field is highlighted, press **OK** to enter an input stage, press **▲▼** to select a digit and press **◀▶** to change a digit position.
  - **[PBC]**: Display or skip the content menu for VCD and SVCD.

## 4 Software update

### Note

- Power supply must not be interrupted during software update.

To check for updates, compare the current software version of this player with the latest software version (if available) at the Philips website.

- Press .
- Select **[Setup]** > **[Preferences]** > **[Version Info]**, and then press **OK**.
- Write down the model name and the software version number.
- Visit [www.philips.com/support](http://www.philips.com/support) to check for the latest software version, using the model name and software version number.
- Refer to the upgrade instructions given on the website to complete the software update.

## 5 Specifications

### Note

- Specifications are subject to change without notice

### Region code

This player can play discs with the following region codes.

DVD region code	Countries
	Europe

### Playable media

- DVD, DVD-Video, VCD, SVCD, Audio CD
- DVD+R/+RW, DVD-R/-RW, DVD+R/-R DL (Dual Layer), CD-R/-RW (maximum 299 folders and 648 files)
- USB storage device

### File format

- Video: avi, .divx, .mp4, .xvid
- Audio: .mp3, .wma
- Picture: .jpg, .jpeg

### USB

- Compatibility: Hi-Speed USB (2.0)
- Class support: USB Mass Storage Class
- File system: FAT16, FAT32
- Maximum number of albums/folders: 299
- Maximum number of tracks/titles: 648
- Support USB HDD (Hard Disc Drive): an external power source may be needed

### Video

- Signal system: PAL, NTSC
- Composite video output: 1 Vp-p (75 Ohm)
- Scart: European connector

### Audio

- 2-channel analog output
  - Audio Front L&R : 2 Vrms (47k Ohm)
- Digital output: 0.5 Vp-p (75 Ohm)
  - Coaxial
- Sampling frequency:

- MP3: 22.05 kHz, 24 kHz, 32 kHz, 44.1 kHz, 48 kHz
- WMA: 44.1 kHz, 48 kHz
- Constant bit rate:
  - MP3: 8 kbps - 320 kbps
  - WMA: 32 kbps - 192 kbps

#### Main unit

- Dimensions (W x H x D): 310 x 39.5 x 210 (mm)
- Net Weight: 1.0 kg

#### Power

- Power supply rating: AC 230V~, 50 Hz
- Power consumption: 10 W
- Power consumption in standby mode: 0.5 W

#### Accessories supplied

- Remote control and one battery
- User manual

#### Laser specification

- Type: Semiconductor laser InGaAlP (DVD), AlGaAs (CD)
- Wave length: 658 nm (DVD), 790 nm (CD)
- Output Power: 7.0 mW (DVD), 10.0 mW (VCD/CD)
- Beam divergence: 60 degrees

## 6 Troubleshooting



#### Warning

- Risk of electric shock. Never remove the casing of the player.

To keep the warranty valid, never try to repair the player yourself.

If you have problems using this player, check the following points before you request service. If you still have a problem, register your player and get support at [www.philips.com/support](http://www.philips.com/support).

If you contact Philips, you will be asked for the model and serial number of this player. The model number and serial number are on the back of this player. Write the numbers here:

Model No. \_\_\_\_\_

Serial No. \_\_\_\_\_

#### No picture.

- The TV video input channel is not correctly selected (see the TV's user manual).
- If you have changed a TV system setting, switch back to the default setting: 1) Press **▲** to open the disc compartment. 2) Press **SUBTITLE**.

#### No sound output from the TV.

- Make sure that the audio cables are correctly connected between this player and the TV.

#### No sound during DivX video playback.

- The audio codes are not supported.

#### No audio output from the loudspeakers of the connected external audio device (for example, stereo system, amplifier receiver).

- Make sure that the audio cables or coaxial cable are correctly connected.
- Switch the external audio device to correct audio input source.

**Disc cannot be read.**

- Make sure that this player supports the disc (see "Specifications" > "Playable media").
- For a recorded disc, make sure that the disc is finalized.

**A USB storage device cannot be read.**

- Make sure that the format of the USB storage device is compatible with this player (see "Specifications" > "USB").
- Make sure that the file system on the USB storage device is supported by this player (see "Specifications" > "USB").

**Files cannot be displayed or read.**

- Make sure that the number of files or folders does not exceed the supported limit of this player (maximum 648 files or 299 folders).
- Make sure that this player supports these files (see "Specifications" > "File format").

**DivX video files cannot be played.**

- Make sure that the DivX video file is complete.
- Make sure that the file extension is correct.
- DRM-protected video files that are stored on a USB flash drive cannot be played through an analog video connection (for example, composite, component, and scart). Transfer the video content onto a supported disc to play these files.

**DivX subtitles do not display correctly.**

- Make sure that the subtitle file has the same name as the DivX video file.
- Make sure that the subtitle file has an extension name supported by this player (.srt, .sub, .txt, .ssa, or .smi).
- Select the character set that supports the subtitle (see "Use your DVD player" > "DivX videos").

## Language Code

Abkhazian	6566	Inupiaq	7375	Pushto	8083
Afar	6565	Irish	7165	Russian	8285
Afrikaans	6570	Íslenska	7383	Quechua	8185
Amharic	6577	Italiano	7384	Raeto-Romance	8277
Arabic	6582	Ivrit	7269	Romanian	8279
Armenian	7289	Japanese	7465	Rundi	8278
Assamese	6583	Javanese	7486	Samoan	8377
Avestan	6569	Kalaallisut	7576	Sango	8371
Aymara	6589	Kannada	7578	Sanskrit	8365
Azerhijani	6590	Kashmiri	7583	Sardinian	8367
Bahasa Melayu	7783	Kazakh	7575	Serbian	8382
Bashkir	6665	Kernewek	7587	Shona	8378
Belarusian	6669	Khmer	7577	Shqip	8381
Bengali	6678	Kinyarwanda	8287	Sindhi	8368
Bihari	6672	Kirghiz	7589	Sinhalese	8373
Bislama	6673	Komi	7586	Slovensky	8373
Bokmål, Norwegian	7866	Korean	7579	Slovenian	8376
Bosanski	6683	Kuanyama; Kwanyama	7574	Somali	8379
Brezhoneg	6682	Kurdish	7585	Sotho; Southern	8384
Bulgarian	6671	Lao	7679	South Ndebele	7882
Burmese	7789	Latina	7665	Sundanese	8385
Castellano, Español	6983	Latvian	7686	Suomi	7073
Catalán	6765	Letzeburgesch;	7666	Swahili	8387
Chamorro	6772	Limburgan; Limburger	7673	Swati	8383
Chechen	6769	Lingala	7678	Svenska	8386
Chewa; Chichewa; Nyanja	7889	Lithuanian	7684	Tagalog	8476
中文	9072	Luxembourgish;	7666	Tahitian	8489
Chuang; Zhuang	9065	Macedonian	7775	Tajik	8471
Church Slavic; Slavonic	6785	Malagasy	7771	Tamil	8465
Chuvash	6786	Magyar	7285	Tatar	8484
Corsican	6779	Malayalam	7776	Telugu	8469
Česky	6783	Maltese	7784	Thai	8472
Dansk	6865	Manx	7186	Tibetan	6679
Deutsch	6869	Maori	7773	Tigrinya	8473
Dzongkha	6890	Marathi	7782	Tonga (Tonga Islands)	8479
English	6978	Marshallese	7772	Tsonga	8483
Esperanto	6979	Moldavian	7779	Tswana	8478
Estonian	6984	Mongolian	7778	Türkçe	8482
Euskara	6985	Nauru	7865	Turkmen	8475
Ελληνικά	6976	Navaho; Navajo	7886	Twi	8487
Faroese	7079	Ndebele, North	7868	Uighur	8571
Français	7082	Ndebele, South	7882	Ukrainian	8575
Frysk	7089	Ndonga	7871	Urdu	8582
Fijian	7074	Nederlands	7876	Uzbek	8590
Gaelic; Scottish Gaelic	7168	Nepali	7869	Vietnamese	8673
Gallègan	7176	Norsk	7879	Volapuk	8679
Georgian	7565	Northern Sami	8369	Walloon	8765
Gikuyu; Kikuyu	7573	North Ndebele	7868	Welsh	6789
Guarani	7178	Norwegian Nynorsk;	7878	Wolof	8779
Gujarati	7185	Occitan; Provençal	7967	Xhosa	8872
Hausa	7265	Old Bulgarian; Old Slavonic	6785	Yiddish	8973
Herero	7290	Oriya	7982	Yoruba	8979
Hindi	7273	Oromo	7977	Zulu	9085
Hiri Motu	7279	Ossetian; Ossetic	7983		
Hrvatski	6779	Pali	8073		
Ido	7379	Panjabi	8065		
Interlingua (International)	7365	Persian	7065		
Interlingue	7365	Polski	8076		
Inuktitut	7385	Português	8084		





Specifications are subject to change without notice  
© 2012 Koninklijke Philips Electronics N.V.  
All rights reserved.

DVP3950\_58\_UM\_V1.3

