



# SERVICE PARTS LIST

**BUL. 54-22-0051**

## 3/4 H.P. BENCH GRINDER

REVISED BUL  DATE  
May '93

**Catalog No. 5060**

MODEL REF. NO. **63109-D**

WIRING INSTR.  
(Refer to Diagram on fig. 32)

**208/220/440 VOLT THREE PHASE**

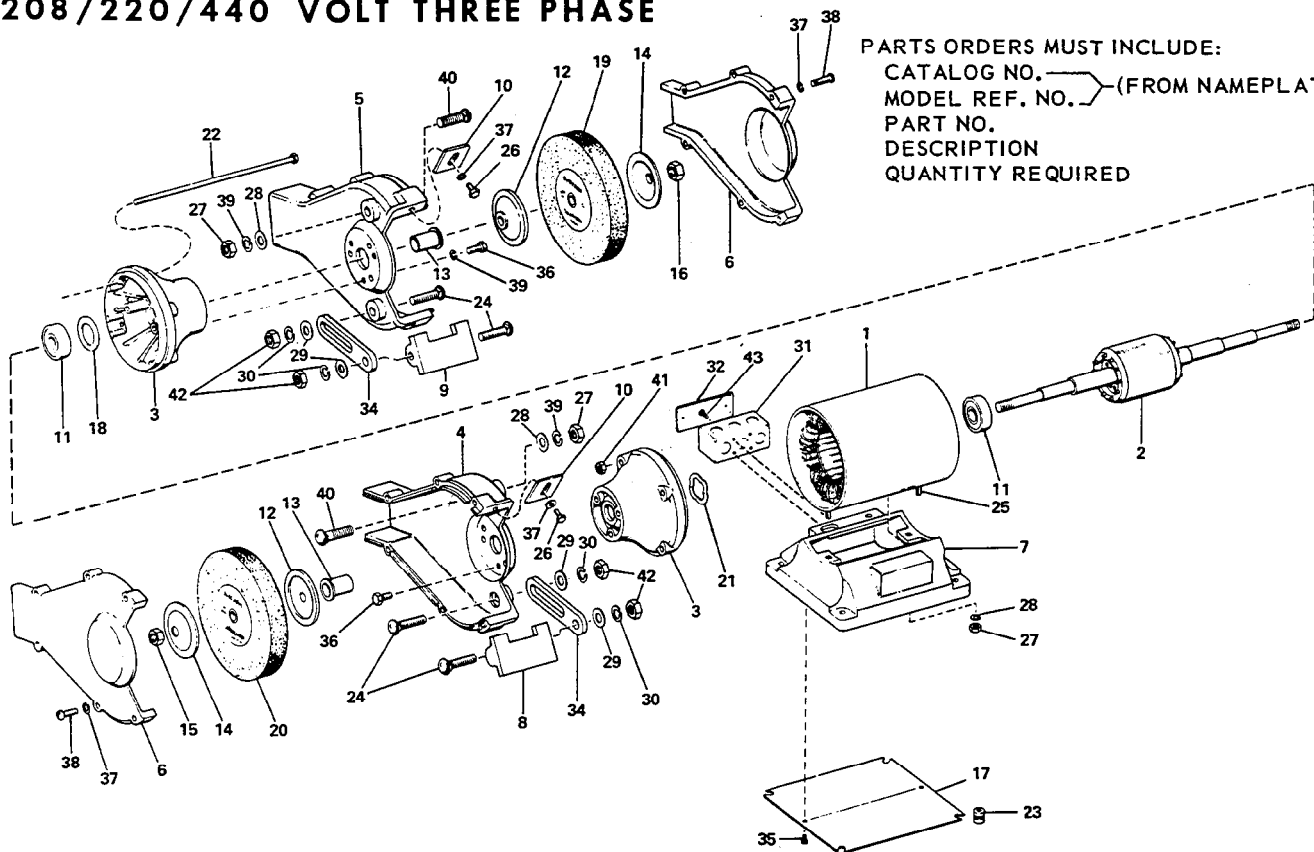

**PARTS ORDERS MUST INCLUDE:**  
 CATALOG NO. (FROM NAMEPLATE)  
 MODEL REF. NO. (FROM NAMEPLATE)  
 PART NO.  
 DESCRIPTION  
 QUANTITY REQUIRED

FIG.	PART NO.	DESCRIPTION OF PART	NO. REQ.	FIG.	PART NO.	DESCRIPTION OF PART	NO. REQ.
1	23-58-0330	Wound Stator with Frame	(1)	23	42-38-0085	Rubber Base Bumper	(4)
2	23-40-0290	Rotor and Shaft Assembly	(1)	24	06-10-1275	3/8-16x1-3/8 Carriage Bolt	(4)
3	42-25-0245	End Shield	(2)	25	06-10-3200	5/16-18x7/8 Carriage Bolt	(2)
4	43-54-0136	L.H. Wheel Guard	(1)	26	06-75-0075	1/4-20x1/2 Hex. Hd. Bolt	(2)
5	43-54-0135	R.H. Wheel Guard	(1)	27	06-55-1990	5/16-18 Hex. Nut	(4)
6	42-92-0105	Wheel Guard Cover	(2)	28	45-88-5245	5/16 Flat Washer	(4)
7	42-20-0276	Base	(1)	29	45-88-5261	3/8 Flat Washer	(4)
8	44-85-0125	L.H. Tool Rest	(1)	30	06-97-4125	3/8 Lock Washer	(4)
9	44-85-0115	R.H. Tool Rest	(1)	31	22-12-0045	Conduit Box	(1)
10	45-12-0125	Spark Guard	(2)	32	42-92-0225	Conduit Box Cover	(1)
11	02-04-5045	Bearing	(2)	34	42-36-0030	Tool Rest Support	(2)
12	43-34-0025	Inner Wheel Flange	(2)	35	06-81-0275	10-32x3/8 Pan Hd. Screw	(2)
13	45-36-0635	Spacer Sleeve	(2)	36	06-75-0310	5/16-18x7/8 Hex. Hd. Bolt	(6)
14	43-34-0047	Outer Wheel Flange	(2)	37	06-97-4000	1/4 Lock Washer	(14)
15	06-55-3325	L.H. 5/8-18 Hex. Nut	(1)	38	06-81-4750	1/4-20x1 Round Hd. Screw	(12)
16	06-55-3300	R.H. 5/8-18 Hex. Nut	(1)	39	06-97-4100	5/16 Lock Washer	(8)
17	42-92-0055	Base Cover	(1)	40	06-10-3230	5/16-18x1-3/8 Carriage Bolt	(2)
18	45-14-0111	Shim	(1)	41	06-57-6060	10-32 Whiz Nut	(4)
19	-	Grinding Wheel (See Catalog)	(1)	42	06-57-5165	3/8-16 Hex Lock Nut	(4)
20	-	Grinding Wheel (See Catalog)	(1)	43	06-81-0450	8-32x3/8 Pan Hd. Screw	(2)
21	40-50-7661	Finger String	(1)				
22	06-75-0068	10-32x10 Long thru Bolt	(4)				