

Built-In Potwasher™ Model HDA860 OPERATING INSTRUCTIONS

**SAVE THESE INSTRUCTIONS
WITH YOUR USE AND CARE BOOK**

Before operating your dishwasher,
READ YOUR USE AND CARE BOOK.
It contains valuable information about
loading, detergents, dispensers, wash-
ing special items and **IMPORTANT**
CAUTIONS FOR THE PERSONAL SAFETY
OF THOSE USING THIS APPLIANCE.

Special Features

- ★ **ENERGY SAVER DRY** option pushbuttons let you save electrical power by shutting off the heater in the dry cycle when fast drying is not needed.
- ★ **WASH CYCLES:**
The Power Scrub® Cycle, combined with the Potwasher's high performance Power Wash™ system, may not do everything (such as remove burned-on soils), but will remove dried-on and baked-on soils from pots, pans and casseroles.
 - 3 pushbutton automatic cycles—POWER SCRUB®, NORMAL SOIL, and RINSE & HOLD
 - SHORT WASH setting on control dial to save water
- ★ **REVERSIBLE COLOR PANELS** let you change color at any time you want. Black glass (Kit No. HDX50, extra cost), wood or other decorative finishes can be substituted for the reversible color panels.
- ★ **SOUND INSULATED** for quiet operation.
- ★ **CRYSTAL-CLEAR™ RINSE DISPENSER** automatically injects wetting agent into the final rinse to reduce water spotting.
- ★ **3-LEVEL POWER WASH™ SYSTEM** provides thorough dishwashing, with water directed upward, downward and from the middle.

Additional Quality Features

- BUILT-IN SOFT FOOD DISPOSER
- WASH-WATER TEMPERATURE MAINTENANCE
- CYCLE-INDICATOR CONTROL DIAL
- AUTOMATIC DUAL DETERGENT DISPENSER
- CUSHION-COATED, RANDOM-LOADING FULL-EXTENSION RACKS
- WHITE PORCELAIN-ENAMEL INTERIOR
- AUTOMATIC WATER-LEVEL CONTROL
- CALROD® HEATING UNIT

Key Facts

- **Dimensions:** Height 33 $\frac{3}{8}$ " (adjusts to 35").
Width 23 $\frac{3}{8}$ "
Depth 25 $\frac{3}{8}$ " including handle.
Door swings out 24 $\frac{3}{8}$ ".
- **Electrical requirements:**
Volts: 115
Amps: 15 amp circuit breaker or regular fuse.
Hertz: 60
2-Wire service with a separate ground wire is required. This appliance must be grounded for safe operation.
- **Total cycle time** (normal cycle): 67 minutes
- **Water consumption** (normal cycle): 11.4 gallons
- **Machine electrical energy** (normal cycle): 0.76 Kwh.
- **White porcelain enamel interior.**
- **Inlet water pressure required:** 15 to 120 lbs. per square inch.
- **Inlet water temperature recommended:** 140°F.
- **Underwriters' Laboratories, Inc. listed.**

UCB 39-5131

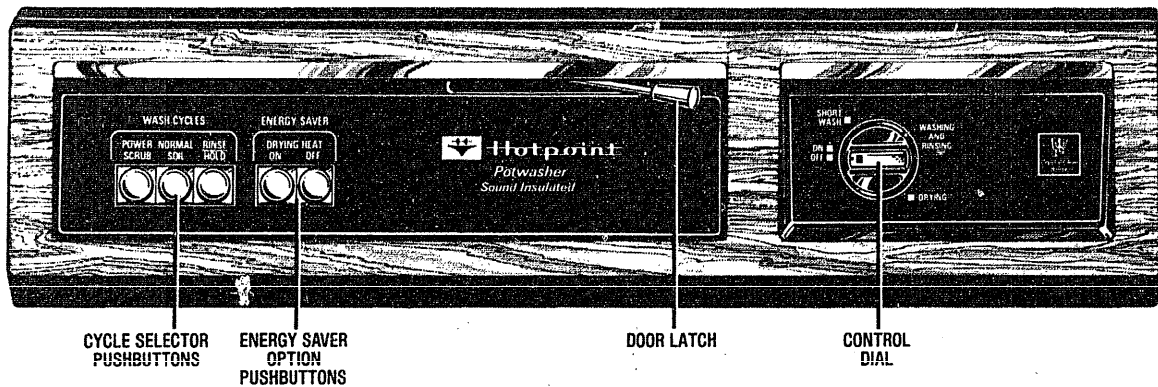

Features of your new potwasher™

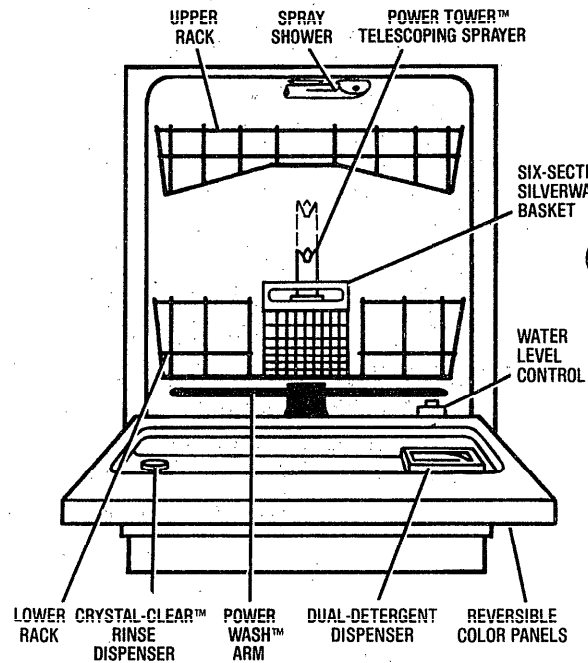

Before operating your dishwasher ...

CHECK WATER TEMPERATURE

FOR BEST RESULTS, WATER TEMPERATURE SHOULD BE BETWEEN 140° AND 150°F. Instructions for measuring water temperature are in your Use & Care Book.

FILL CRYSTAL-CLEAR™ RINSE DISPENSER

See instructions in your Use & Care Book.

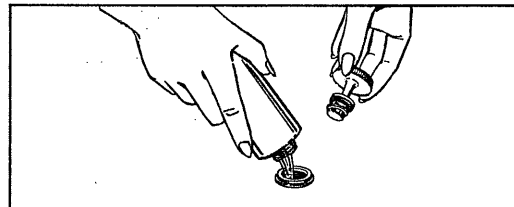

To operate your dishwasher...

1 PREPARE YOUR TABLEWARE, POTS & PANS, AND LOAD DISHWASHER PROPERLY

See your Use & Care Book.

2 ADD DETERGENT

Proper detergents are very important to achieve good dishwashing results. Use only fresh detergents designed for automatic dishwashers. Review the detergent section of the Use and Care Book to become fully familiar with detergent loading procedure.

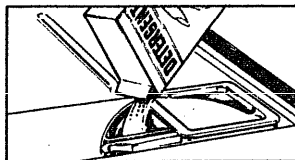

3 SELECT THE CYCLE

- **POWER SCRUB®** cycle is designed to remove **DRIED-** and **BAKED-ON** soils. These soils will be removed from utensils that are in good condition if you follow loading and operating instructions carefully. It is especially important to load items with heavy, **DRIED-ON** and **BAKED-ON** soils such as pots, pans and casseroles, open end down in the lower rack facing directly toward the lower wash arm. In this position the items will receive the most vigorous wash action for maximum soil removal. As you would expect, severely **BURNED-ON** soils occasionally may not be completely removed, especially if the surface of the utensil is etched, pitted or otherwise in poor condition. After washing items of this type, any remaining soils should be removed by hand. Discoloration of utensils caused by overheating during cooking cannot be removed by the dishwasher.

NORMAL SOIL cycle is for most loads of everyday dishes, glasses and cookware with light to heavy soils.

RINSE & HOLD cycle should be selected when you have only a partial load and plan to wait until the dishwasher is filled before washing. **DO NOT USE DETERGENT IN THE RINSE & HOLD CYCLE.**

NOTE: After using the **RINSE & HOLD** cycle, be sure you select the desired wash cycle for the next load.

INTERRUPTING A CYCLE

Forget a dish?

1. Push door latch to the left. Door safety interlock switch will cut off the washing action.
2. Wait a few seconds for water action to subside, then open door.
3. Add dishes you may have forgotten... or remove items.

- **SHORT WASH** cycle is for tableware that is mildly soiled with soils that have not dried on. Normally you will not require two detergent washes with this cycle.

ENERGY SAVER OPTION BUTTONS

DRYING HEAT ON—Depress this button and the drying heater is energized to circulate heated air over the dishes for fast drying.

DRYING HEAT OFF—Depress this button and the drying heater is disconnected to save electrical energy and allow the dishes to dry by their own heat over time. This option is best used when the dishes are washed at night and can remain in the dishwasher until the next morning. Natural drying time will be reduced if you open the dishwasher door after the cycle is complete.

Use of this option reduces the electrical energy used by this model approximately 8%.

Estimated yearly savings, depending on your local electric rates, are as follows:

Electric Rate (per Kwh)	\$.05	\$.08	\$.11
Estimated Yearly Savings	\$ 5.20	\$ 8.32	\$ 11.44

4 START YOUR DISHWASHER

If your dishwasher drains into a food waste disposer, run the disposer until it is completely empty before starting the dishwasher.

TO START DISHWASHER:

- For **POWER SCRUB**, **NORMAL SOIL** or **RINSE & HOLD** cycles; Close door and move door latch to the right to the locked position. Slowly turn control dial toward the **ON** position or until you hear the dishwasher start. To obtain the benefits of a complete cycle, be careful that you do not turn the dial any further than necessary to start the dishwasher.
- For **SHORT WASH** cycle: Close door but do not latch it. Slowly rotate dial clockwise to **SHORT WASH** position on dial. Then move door latch to the right to locked position.



4. Close door and push latch to right. Cycle will automatically resume operation.

NOTE: Soiled dishes should not be added after the main detergent wash portion of the cycle.

Interrupt the wash and rinse periods as seldom as possible. Water temperature is reduced, decreasing washability, when door is opened on any dishwasher.

What happens during the cycle...

● Dishwasher will complete cycle sequence automatically and control dial will advance to OFF position.

CYCLE SEQUENCE (minutes — approx.)	Power Scrub	Normal Soil	Rinse & Hold	Short Wash
Wash/Rinse	4	4	4	—
Rinse	6	6	6	—
Rinse	3	3	—	3
Main Detergent Wash	44	18	—	18
Rinse	4	4	—	4
Rinse	9	9	—	9
*Electric Dry	23	23	—	23
Total Time (approx.)	93	67	10	57

*This portion of the cycle is eliminated with Drying Heat Off.

● Occasional clicking sounds that occur are caused by:

- soft food disposer mechanism shredding action.
- drain valve at start of pump out of wash and rinse water.
- timer control as cycle progresses.
- detergent cup when it opens in the main wash.

● The motor stops during the drying period.

● Water vapor is released through the vent under the door handle during drying cycle. It may be visible.

Reversible color panels, black glass, or other special finishes

Your dishwasher comes with reversible and interchangeable front panels. Black glass panels are available at extra cost.

Both door and access panels are held in place by the panel trim. Each side of each reversible color panel is finished in a different color.

TO CHANGE COLOR PANELS:

1. Take out two screws from door and two screws from access. Then remove the side trims from either side of the dishwasher.
2. Slide out the panels and replace them with the color you want in front.
3. Replace the side trims.

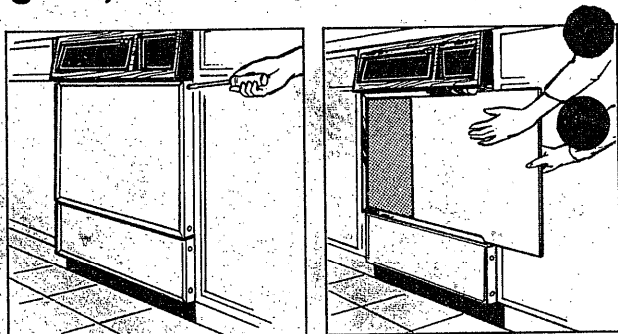

Special 1/4"-thick wood inserts cut to approximately the same dimensions can be used to replace the two metal panels.

Other special finishes can be applied to the metal panels to match your kitchen decor.

BEFORE YOU CALL FOR SERVICE...

Check the TROUBLE-SHOOTING GUIDE in your USE AND CARE BOOK. It lists many minor causes of problems that you can correct and may save you an unnecessary service call.



**CUSTOMER CARE
... EVERYWHERE**
Fast, Dependable Service

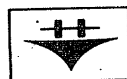

Hotpoint
A QUALITY PRODUCT OF GENERAL ELECTRIC COMPANY

Appliance Park, Louisville, Kentucky 40225

Pub. No. 39-5131

HDA860

11-79

Part No. 218A3664P63