

INSTALLATION DIRECTIONS DS 800/80

The DS 800/80 are both a doorbell and telephone signalers. The DS 800/80 are designed to work with most kinds of doorbell systems and standard modular telephone jacks. They will work in homes with or without an existing doorbell or chime.

The DS 800 flashes a light that is plugged into its outlet and also sends signals to Sonic Alert remote receivers.

The DS 80 also flashes a light that is plugged into its outlet but does not send a signal to remote receivers. This model is best used in studio apartments and dorm rooms that will only need one light for signaling.

To install the DS 800/80, follow the instructions below that match your type of doorbell system.

HOMES WITH NO DOORBELL SYSTEM

1. Remove DS 800/80, doorbell button and wire from box. Locate a 120-volt electrical outlet that is within 7 feet of a modular telephone jack. If this is not possible you will need to purchase a telephone extension cord to reach your telephone jack outlet. These can be purchased at Radio Shack or hardware store. This 120-volt electrical outlet should be as close as possible to the front door.
2. Connect one end of provided wire to the two screws on the doorbell button. Wrap one wire under each screw and tighten the screws with a screwdriver. Be careful that the two wires do not touch each other. If the two wires touch, lights plugged into the signalers will flash continuously. It does not matter which wire goes to which screw.
4. To install the doorbell button outside of your door, either run the wire around the doorframe or drill a hole through the wall where the doorbell button will be located. Mount the doorbell button at the desired location using screws provided.
5. Run the wire attached to the doorbell button to the electrical outlet where the DS 800/80 will be plugged in. Attach this end of the wire to the screws marked 1 & 2 on the back of the DS 800/80. Wrap wire under each screw and tighten the screws with a screwdriver. Be careful NOT to let the 2 wires touch each other.

Be careful running wiring so it won't tangle or get tripped over. The length of the wire provided may be extended up to 100 feet. Wind up or cut off any excess wire.

6. Go to part 2 on back side for **Telephone Signaler** and final installation steps.

HOMES WITH ELECTRICAL DOORBELL OR CHIME

Important - for systems with 8, 16, or 24-volt doorbell chime only. Do not use with 120-volt chimes.

1. Remove DS 800/80, and wire from box.
2. Locate existing doorbell or chime box (where doorbell sound comes from).
3. Next locate a 120-volt electrical outlet that is within 7 feet of a modular telephone jack. If this is not possible you will need to purchase a telephone extension cord to reach your telephone jack outlet. These can be purchased at Radio Shack or hardware store. Keep in mind a wire will be running from the signaler to the chime box, so its best to be as close as possible to the chime box when selecting the 120 volt electrical outlet.
4. Remove cover to doorbell or chime. On one end of the wire enclosed, connect one of the wires to the screw on the doorbell or chime marked "Tran" or "common". Do not remove existing wires.
5. Connect the other wire from the same end to the screw marked "Front". The DS 800/80 will flash when the front doorbell button is pressed. If the wire is connected to the doorbell screw marked "Rear" the DS 800/80 will flash when the rear doorbell button is pressed.
6. Run the wire attached to the chime box to the electrical outlet where the DS 800/80 will be plugged in. Attach this end of the wire to the screws marked 1 & 2 on the back of the DS 800/80. Wrap wire under each screw and tighten the screws with a screwdriver. Be careful NOT to let the 2 wires touch each other.
7. Go to part 2 on back side for **Telephone Signaler** and final installation steps.

HOMES WITH INTERCOM SYSTEMS

The DS 800 / 80 will work with most intercom systems. For this feature the optional DS 800T Sensor is required.

PART 2

TELEPHONE AND FINAL INSTALLATION PROCEDURES

After the wires have been connected to your signaler, the DS 800/80 is almost ready for use.

1. Plug the DS 800/80 into the 120-volt outlet and plug the telephone cord into a nearby modular telephone jack. Plug any incandescent lamp into the outlet on the side of the DS 800/80, (MAXIMUM 300 WATTS). Be sure that the lamp is in the "On" position. The light will stay off until the signaler is activated.

3. You must be careful when plugging the DS 800/80 into the electrical wall outlet. If the outlet cover plate is metal, the screws on the back of the DS 800/80 may touch the plate. This is not dangerous and will not damage the DS 800/80 but it will cause the lights to flash. To prevent this, simply replace the metal cover plate with a plastic cover or put a piece of electrical tape over the screws on the back of the DS 800/80.

FLASHING LIGHTS IN OTHER ROOMS

DS 800 only

To flash lights in other rooms, you can use remote receivers, models SA 101, SA 201, BL 300, RH 100 and Sonic Boom Alarm Clock as needed. They simply plug into any electrical outlet in the room that you want to be alerted. Be sure your lamp is in the "ON" position if using a lamp with a receiver.

DS 80 only

The DS 80 does not send a signal to remote receivers. This model is best used in studio apartments and dorm rooms that will only need one light for signaling.

If you need technical assistance installing the DS 800/80, please call your local Dealer or Sonic Alert for assistance.

1-248-577-5400 or e-mail us at sonic-info@sonicalert.com

Rev. 1.0

Installation Diagram DS 800/80

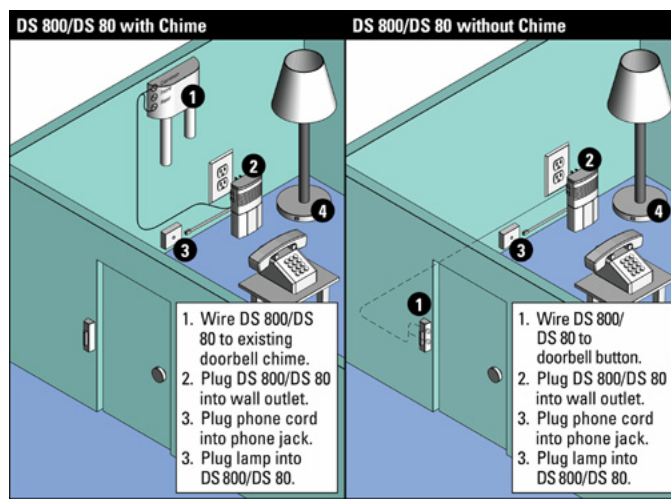

SONIC ALERT'S LIMITED WARRANTY

The Deluxe Wired Doorbell, Telephone & Intercom Signaler Model DS800 is warranted against manufacturing defects in materials and workmanship for (5) years from the date of purchase. Within this period Sonic Alert will repair or replace at our option the DS800 without charge for parts and labor. Simply send the DS800 (postpaid) and a copy of your sales slip as proof of purchase to: Sonic Alert Inc., Attn: Repairs 1050 E. Maple Rd., Troy MI 48083

www.SonicAlert.com

1-248-577-5400