

iLuv

THANK YOU FOR YOUR PURCHASE
Visit our website at www.i-Luv.com

iLuv®

Model : iMM190
Instruction Manual

© 2010 www.i-Luv.com

iLuv is a registered trademark owned by iLuv Creative Technology. iPod is a trademark of Apple Inc. registered in the US and other countries. iPhone is a trademark of Apple Inc. All logos and brands are the property of their respective owners. iPod is not included in this package. The specifications and product images or graphics may slightly differ from the actual product. Features and specifications are subject to change without prior notification.

© 2010 iLuv Creative Technology All rights reserved. No portion of this printed material or product enclosed herewith including design, shape or graphics, may be reproduced or transmitted in any form without the expressed written consent of iLuv Creative Technology by any means, electronic or mechanical, including photocopying, recording or use of an information storage and retrieval system. Any unauthorized distribution or reproduction of this printed material or product, or any portion thereof, will be prosecuted to the fullest possible extent of the law.

Designed in New York, USA / Printed in China

App Station™

INTRODUCTION

Congratulations on your purchase of the new iLuv IMM190 for your iPod touch and/or iPhone. Designed specifically to work with iPod and/or iPhone, this product is uniquely designed to operate using an iLuv application download available from iTunes app store (search for iLuv App Station). Please keep this manual for future reference.

- Portable / desktop (6 x AA batteries or AC operated) speaker for your iPhone or iPod
- Stands horizontally or vertically to match your iPhone or iPod touch screen aspect
- Establishes full functions of the iLuv alarm clock application (available from iTunes app store)
- Plays and charges your iPhone or iPod
- Power On/Off button with LED indicator
- Built with dynamic acoustic speaker chambers to enhance sound clarity
- Powerful amplifiers provide better efficiency and performance
- Auxiliary line input for any audio devices with 3.5mm jack

iLuv App Alarm Clock for iPhone / iPod touch
(available free from Apple iTunes app store)

- The iLuv App becomes a big display digital alarm clock with responsive visual equalizer display for the IMM190
- Multiple alarms to wake to your own favorite iPhone or iPod music
- Play songs using iLuv App

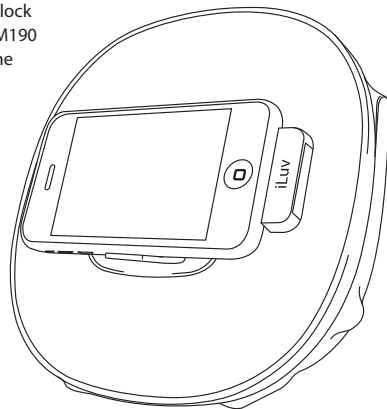

INTRODUCTION

Compatible with iPhone / iPod*

iPhone 3GS, iPhone 3G, iPhone, iPod touch 2nd generation, iPod touch 1st generation, iPod classic 120GB, 160GB, iPod classic 80GB, iPod nano 5th generation, iPod nano 4th generation, iPod nano 3rd generation, iPod nano 2nd generation, iPod nano 1st generation, iPod mini, iPod 4th generation, iPod 5th generation (with video)

* The App only works with iPod touch and iPhone models. With all other compatible iPod models, the IMM190 only functions as a simple speaker system, and playback is controlled using the functions of your iPod itself.

TABLE OF CONTENTS

| | |
|---------------------------------------|----|
| INTRODUCTION | 1 |
| GETTING STARTED | |
| Power Source | 4 |
| Protect your Furniture | 4 |
| Installing the Batteries | 5 |
| Location of Controls on the Main Unit | 6 |
| OPERATIONAL INSTRUCTIONS | |
| Turning the System ON | 7 |
| Turning the System OFF | 7 |
| General Playback | 7 |
| Adjusting the Volume | 7 |
| Controlling the Snooze Function | 7 |
| Answering your iPhone | 7 |
| Using the iPod/iPhone App | 8 |
| TROUBLESHOOTING GUIDE | 9 |
| USER SAFETY GUIDE | 10 |
| SPECIFICATIONS | 16 |

GETTING STARTED

Power Source

- This system is designed to operate on AC100V~240V 60/50Hz house current or 6 X AA batteries (not included) only.
- Connecting this system to any other power source may cause damage to the system and such damage is not covered by your warranty.
- Main plug is used as the disconnect device, the disconnect device shall remain readily operable.

Note:

The system has an AC plug and will only fit into matching AC outlets. This is a safety feature to reduce the possibility of electric shock. If the plug will not fit in your AC outlets, you should have the outlet changed by a qualified, licensed electrician. Do not use an adapter to make the plug fit into your outlet. This defeats the safety feature and could expose you to electric shock.

Protect your Furniture

This model is equipped with a non-skid rubber base to prevent the product from moving when you operate the controls. This base is made from non-migrating rubber material specially formulated to avoid leaving any marks or stains on your furniture. However certain types of oil based furniture polishes, wood preservatives, or cleaning sprays may cause the rubber base to soften, and leave marks or a rubber residue on the furniture. To prevent any damage to your furniture we strongly recommend that you purchase small self-adhesive felt pads, available at hardware stores and home improvement centers everywhere, and apply these pads to the bottom of the rubber 'feet' before you place the product on fine wooden furniture.

GETTING STARTED

Installing the Batteries

In addition to AC power, this unit can operate on 6 X "AA" batteries (not included).

1. Open the Battery Compartment.
2. Insert 6 "AA" size batteries into the Battery Compartment, making sure that the batteries are installed with the proper polarity (+/-) are maintained.

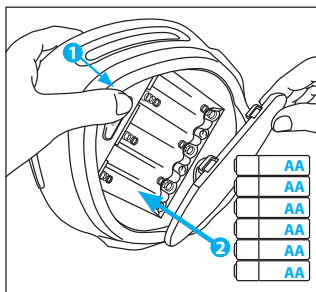

Notes on battery use

- To save battery power, please always use AC adaptor for speaker power supply.
- Load new batteries with their polarities (+/-) aligned correctly.
- Do not apply heat to batteries, or internal short circuit may occur.
- If this unit is not to be used for a long period of time, remove all batteries and store them in a cool and dry place.
- Remove spent batteries immediately and dispose of them.
- Do not use old and new batteries together. Also never use an alkaline battery with a magnesium battery.

GETTING STARTED

Location of Controls on the Main Unit

1. Speakers
2. iPhone / iPod support release switch
3. iPhone / iPod support (for horizontal display)
4. iPhone / iPod support pad
5. iPhone / iPod dock (30pin connector)
6. ⏻ button
7. VOL + / VOL -
8. SNOOZE button
9. Battery compartment
10. AUX IN jack
11. Power adapter jack

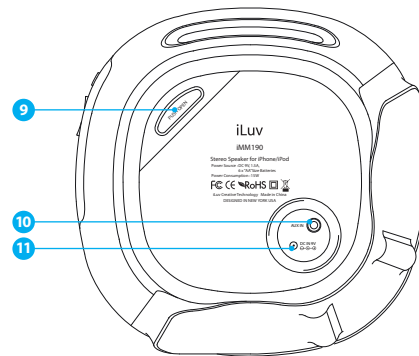
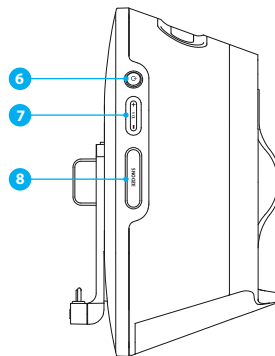
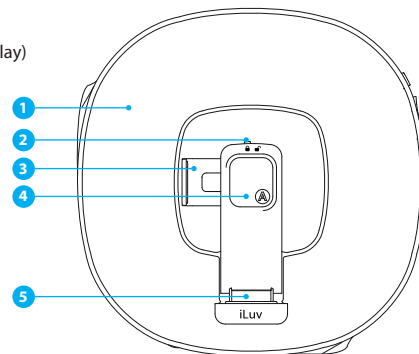

OPERATIONAL INSTRUCTIONS

Turning the System ON

Press  on the unit. Blue LED will turn on. Place your iPhone or iPod in the dock.

Turning the System OFF

In any working mode, press  on the unit. Blue LED will turn off.

General Playback

PLAY/PAUSE, NEXT, PREV, FAST FORWARD and REWIND are controlled directly through the iPhone or iPod App. When using other iPod models, use the controls on your iPod itself. Operational instructions for the application are contained in the app itself. Download from iTunes App Store.

Note: When viewing your iPhone or iPod horizontally, be sure the support is adjusted for proper fit.

Adjusting the Volume

Press VOL + or VOL - to adjust the sound level during playback.

Controlling the Snooze Function*

When the alarm sounds, press SNOOZE on the unit to delay the alarm for 7/9/12/15/30 minutes.

*Clock and alarm functions are set using the App. The Snooze function is the only clock feature controlled by the IMM190.

OPERATIONAL INSTRUCTIONS

Answering your iPhone

If you receive an incoming call on your iPhone while it is in the dock, you may answer the call in one of the following ways:

- Remove your iPhone from the 30pin connector in the IMM190 and use your iPhone manually.
- Leave your iPhone in the dock and use the speaker phone feature.

Note: The speakers on the IMM190 are not in use when operating the speaker phone function. Sound will only be heard through your iPhone.

Using the iPod/iPhone App

With the App loaded onto your iPod touch or iPhone, the following functions are available and are controlled directly through the Application platform.

- Time Display
 - Can be formatted in a 12-hour or 24-hour format
 - Can be displayed vertically or horizontally
 - Choose different background themes
 - Dimmer can be controlled on the touch screen by sliding finger up or down
- Alarm Clock Function
 - Set recurring settings (Every day, Weekdays, Weekends)
 - Wake to a choice of from unique alarm sounds and music choices from your iPod touch or iPhone
- Select snooze time
 - Nine (9) minutes (default setting)
 - Selectable times: 7 / 9 / 12 / 15 / 30 minutes
- Music playback
 - Control PLAY/PAUSE, NEXT, PREV, FW, RW
 - Display song name

TROUBLESHOOTING GUIDE

No sound or unclear sound

Make sure the power is turned on (Blue LED is on)
Make sure your iPod or iPhone is securely docked
Adjust the sound level using the VOL- or VOL+ buttons

Music does not transfer from iPod or iPhone to the iMM190 speakers

Make sure the power is turned on (Blue LED is on)
Make sure your iPod or iPhone is securely docked

LED is off

Make sure the iMM190 is turned on. (Blue LED is on)

Low or distorted sound

Adjust the sound level using the VOL- or VOL+ buttons

Music does not play after hanging up a phone call

Press PLAY on the LCD screen of your iPhone to resume playback

USER SAFETY GUIDE

WARNING

- TO PREVENT FIRE OR SHOCK HAZARD. DO NOT EXPOSE THIS APPLIANCE TO RAIN OR MOISTURE.
- THIS APPLIANCE SHALL NOT BE EXPOSED TO DRIPPING OR SPLASHING WATER AND THAT NO OBJECT FILLED WITH LIQUIDS SUCH AS VASES SHALL BE PLACED ON APPARATUS.



The lightning flash with an arrowhead symbol within an equilateral triangle is intended to alert the user of the presence of un-insulated "dangerous voltage" within the product's enclosure that may be of sufficient magnitude to constitute a risk of electric shock to people.

CAUTION
RISK OF ELECTRIC
SHOCK DO NOT OPEN

WARNING: To reduce the risk of electric shock, do not remove cover (or back). No user-servic-able parts inside. Refer servicing to qualified service personnel.



The exclamation point within an equilateral triangle is intended to alert the user of the presence of important operating and maintenance (servicing) instruction in the literature accompanying the appliance.

IMPORTANT SAFETY INSTRUCTIONS

1. Read these instructions
2. Keep these instructions
3. Heed all warnings
4. Follow all instructions
5. Do not use this apparatus near water
6. Clean only with dry cloth
7. Do not block any ventilation openings. Install in accordance with the manufacturer's instructions
8. Do not install near any heat sources such as radiators, heat registers, stoves, or other apparatus (including amplifiers) that produce heat.

USER SAFETY GUIDE

IMPORTANT SAFETY INSTRUCTIONS - continued

9. Do not defeat the safety purpose of the polarized or grounding-type plug. A polarized plug has two blades with one wider than the other. A grounding type plug has two blades and a third grounding prong. The wide blade or the third prong are provided for your safety. If the provided plug does not fit into your outlet, consult an electrician for replacement of the obsolete outlet.
10. Protect the power cord from being walked on or pinched particularly at plugs, convenience receptacles, and the point where they exit from the apparatus.
11. Only use attachments/accessories specified by the manufacturer.
12. Use only with the cart, stand, tripod, bracket, or table specified by the manufacturer, or sold with the apparatus. When a cart is used, use caution when moving the cart/apparatus combination to avoid injury from tip-over.
13. Unplug this apparatus during lightning storms or when unused for long periods of time.
14. Refer all servicing to qualified service personnel. Servicing is required when the apparatus has been damaged in any way, such as power-supply cord or plug is damaged, liquid has been spilled or objects have fallen into the apparatus, the apparatus has been exposed to rain or moisture, does not operate normally, or has been dropped.
15. Grounding or Polarization – This product may be equipped with a polarized alternating-current line plug (a plug having one blade wider than the other). This plug will fit into the power outlet only one way. This is a safety feature. If you are unable to insert the plug fully into the outlet, try reversing the plug. If the plug should still fail to fit, contact your electrician to replace your obsolete outlet. Do not defeat the safety purpose of the polarized plug.
Alternate Warnings – This product is equipped with a three-wire grounding-type plug, a plug having a third (grounding) pin. This plug will only fit into a grounding-type power outlet. This is a safety feature. If you are unable to insert the plug into the outlet, contact your electrician to replace your obsolete outlet. Do not defeat the safety purpose of the grounding-type plug.



USER SAFETY GUIDE

IMPORTANT SAFETY INSTRUCTIONS - continued

16. Ventilation – Slots and openings in the cabinet are provided for ventilation and to ensure reliable operation of the product and to protect it from overheating, and these openings must not be blocked or covered. The openings should never be blocked by placing the product on a bed, sofa, rug, or other similar surface. This product should not be placed in a built-in installation such as a bookcase or rack unless proper ventilation is provided or the manufacturer's instructions have been adhered to.
17. The MAINS plug or an appliance coupler is used as the disconnect device, the disconnect device shall remain readily operable.



CLEANING

Always disconnect unit from power supply before attempting to clean it. Use soft clothmoistened with soapy water, and wipe gently. Do not use solvents or abrasive materials.



YOU CAN HELP TO PROTECT THE ENVIRONMENT!

Please remember to respect the local regulations: Hand in the non-working electrical equipment to an appropriate waste disposal center.

FOR USED BATTERIES

Disposed of the used batteries properly. Please follow the local regulations for the battery disposal.

USER SAFETY GUIDE

FCC NOTICE TO A USER IN USA

This equipment has been tested and found to comply with the limits for a Class B digital device, pursuant to Part 15 of the FCC Rules. These limits are designed to provide reasonable protection against harmful interference in a residential installation. This equipment generates, uses, and can radiate radio frequency energy and, if not installed and used in accordance with the instructions, may cause harmful interference to radio communications. However, there is no guarantee that interference will not occur in a particular installation. If this equipment does cause harmful interference to radio or television reception, which can be determined by turning the equipment off and on, the user is encouraged to try to correct the interference by one or more of the following measures:

1. Reorient or relocate the receiving antenna.
2. Increase the separation between the equipment and receiver.
3. Connect the equipment into an outlet on a circuit different from that to which the receiver is connected.
4. Consult the dealer or an experienced radio/TV technician for help.

FCC RULES

This device complies with Part 15 of the FCC Rules. Operation is subject to the condition that this device does not cause harmful interference.

Note: Do not make changes or modify the device in any way. Changes or modifications not expressly approved by the party responsible for compliance could void the user's authority to operate the equipment.

USER SAFETY GUIDE

FCC NOTICE TO A USER IN USA - continued

IMPORTANT NOTES ON HEARING

Your hearing is very important to you and to us, so please take care when operating this equipment. We strongly recommend you to follow the guideline below in order to prevent possible damage or loss of hearing.

If you continuously listen to the loud sounds, your hearing will adapt to continuous loud sounds and will give you the impression that the volume has been reduced. What seems normal to you may in fact be harmful. To guard against this **BEFORE YOUR HEARING ADAPTS**, set the volume at a low level and slowly increase the volume level until you can hear comfortably and clearly without distortion. Damage to your hearing is accumulative and is irreversible. Any ringing or discomfort in the ears indicates that the volume is too loud. Once you have established a comfortable listening level, **DO NOT INCREASE THE VOLUME LEVEL FURTHER.**

In the use of headphones, please take more attention. Hearing experts say that listening to a loud music can damage your hearing, especially when listening to music with headphones.

IC NOTICE TO A USER IN CANADA

Since digital circuitry may cause interference to other radio or television tuners nearby, switch this unit off when not in use or move it away from the affected radio/television tuner.

NOTE: This digital apparatus does not exceed the Class B limits for radio noise emissions from digital apparatus as set out in the Radio Interference Regulations of Industry Canada. These limits are designed to provide reasonable protection against harmful interference in a residential installation. This equipment generates, uses and can radiate radio frequency energy and, if not installed and used in accordance with the instructions, may cause harmful interference to radio communications. However, there is no guarantee that interference will not occur in a particular installation.

USER SAFETY GUIDE

IC NOTICE TO A USER IN CANADA - continued

If this equipment does cause harmful interference to radio or television operation (which can be determined by turning the equipment off), the user is encouraged to try to correct the interference by one or more of the following measures:

- Reorient or relocate the receiving antenna.
- Increase the separation between the equipment and receiver.
- Connect the equipment into an outlet on a circuit different from that to which the receiver is connected.
- Consult the dealer or an experienced radio / TV technician for help.

WARNING!

- The apparatus shall not be exposed to dripping or splashing and that no objects filled with liquids, such as vases, shall be placed on apparatus.
- Mains plug is used as the disconnect device. It shall remain readily operable and should not be obstructed during intended use. To be completely disconnected, the apparatus from supply mains, the mains plug of the apparatus shall be disconnected from the mains socket outlet completely.

SPECIFICATIONS

- Total 8W output (4W / Channel)
- Full-range (50mm) driver + Tune Port
- S/N ratio: 60dB@1W
- Frequency Response: 200Hz – 15k Hz
- Power Adaptor: 9V, 1.5A
- Dimensions: 6.7" x 6.7" x 4" (170mm x 170mm x 102mm)



MEMO

MEMO

