

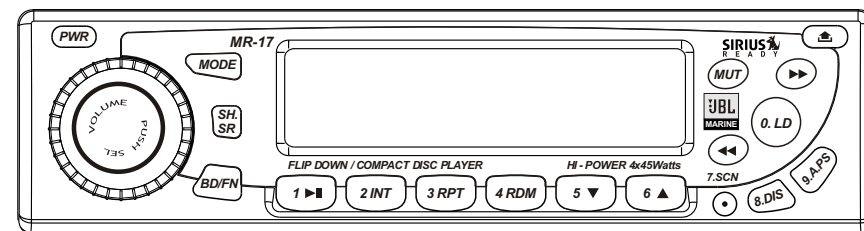

# Operation Manual for Users

Model No.: MR-17



**!!!!!!! ATTENTION !!!!!!!**  
THE RESET BUTTON MUST BE PRESSED  
TO ENSURE PROPER OPERATION.  
SEE INSTRUCTION MANUAL

This product is sold and serviced exclusively by Prospec Electronics Inc. and must be returned to Prospec for in and out of warranty repairs. It can not be serviced under warranty by other JBL service centers. All products sold and serviced exclusively by Prospec Electronics Inc.  
For service contact us : 3325 South Morgans Point Road Mt Pleasant SC 29466  
Tel 843-849-9037 Fax 843-849-9054

Revised 28 / April / 05

## Trouble shooting guide

### INTERFERENCE ON RADIO

- Poor atmospheric conditions - Try again later in the day
- Antenna / lead broken or damaged

### DISTORTED AUDIO

- Check loudspeaker wiring  
This product contains a biamp. It is important not to connect the front loudspeaker ground to the rear speaker ground.
- Faulty loudspeaker
- Distortion at highest volume levels may be normal, as amplifier has reached maximum power output. Otherwise the power and ground wire might be too small of a gauge. Use 10amp cable or more.
- Reduce the bass effect or switch off the loudness mode
- Boat battery and or charging circuit may be faulty

## Specifications

FM TUNER	AM TUNER (OPTION)
<b>Tuning Range :</b> 87.5 ~ 107.9MHz(USA) 87.5 ~ 108MHz(EUR) <b>Sensitivity :</b> 10dB / uV <b>Separation :</b> 30dB	<b>Tuning Range :</b> 530 ~ 1710KHz(USA) 522 ~ 1620KHz(EUR) <b>Sensitivity :</b> 35dB / uV
COMPACT DISC	AUDIO AMP & GENERAL
<b>Freq. Response :</b> 20 Hz-20 KHz <b>Total Harmonic Distortion :</b> 0.8% <b>Signal - Noise Ratio :</b> 65 dB <b>Dynamic Range :</b> 90 dB	<b>Power Output :</b> 4 x 45 watts <b>Power Supply :</b> DC + 12V Negative Ground <b>Speaker Impedance:</b> 4 ohm

## Precautions and maintenance

### 1. Reset function

A microprocessor reset button has been provided to facilitate manual resetting of the internal microprocessor. In the unlikely event that the player fails to operate correctly refer to step 2 below.

**Note:** It will be necessary to re-enter the radio preset memories as these will have been erased when the microprocessor is reset. After resetting the player, ensure all functions are operating correctly.

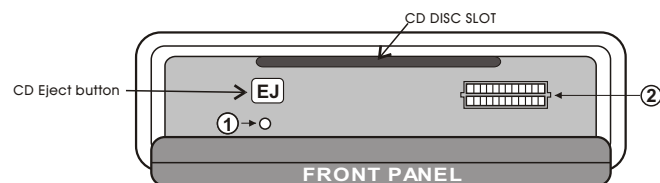

### 2. Caution

- ① **RESET** : If you are faced with a malfunction during the operation, simply press the reset button.
- ② **CONNECTOR PIN** : Always keep connector pin clean.  
If the PIN connector looks dirty, use cotton tips to clean it, so as to avoid any unexpected malfunction caused by dirt.

## Contents

Contents .....	1
Wiring Identification .....	2
Installing and Removing the Detachable Face .....	3
Important Notes .....	4
Installation .....	5
Supporting the Unit .....	6
Identification of Controls and Functions .....	7
Controls .....	8-9
Station Tuning .....	10
Operating the CD & CD Changer .....	11
Precautions and Maintenance .....	12
Trouble Shooting Guide & Specifications .....	13

**PLEASE NOTE:** In order to receive Sirius Satellite radio broadcast, you must install JBL Sir2.5 as well as a satellite antenna (both sold separately).



### What is SIRIUS Satellite Radio?

SIRIUS, headquartered in New York, offers over 120 channels of digital quality radio transmitted across the continental US from three high-tech satellites. Along with offering a full spectrum of music genres, users can also listen to popular news, entertainment and sports channels. SIRIUS currently offers 65 music channels, 24 news channels (including traffic and weather), 7 sports channels (including two dedicated play-by-play channels) and 24 talk / entertainment channels.  
For more information on SIRIUS, visit [siriusradio.com](http://siriusradio.com).

## Wiring identification

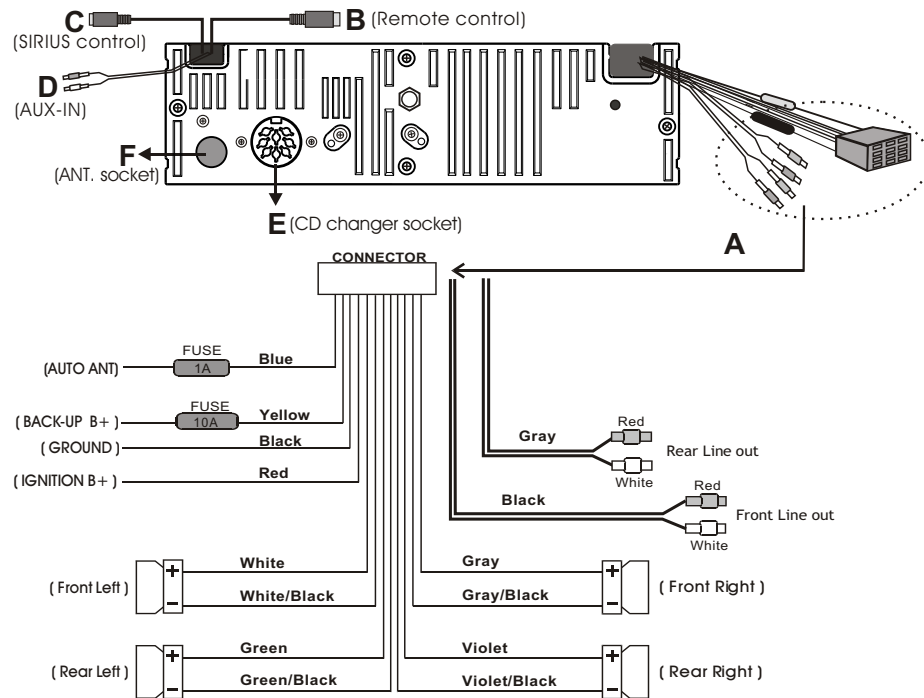

### Installation Notes

Applicable to both 2 and 4-speaker connection:

- Connections
- Din cable connection for remote control
- Din cable connection for SIRIUS control
- AUX-IN
- CD changer socket
- Antenna socket

This radio contains four separate power amplifiers. To prevent possible damage to these amplifiers please ensure the following:

- The boat chassis is not used as a loudspeaker ground(-).
- Front and rear loudspeaker connecting wires are not joined together.
- Any wires not used when completing a two speaker installation are fully insulated.
- The memory wire (yellow) is connected to a permanent + 12V supply.
- The power wire (red) is connected via the ignition switch of the boat.

## Operating the CD & CD changer

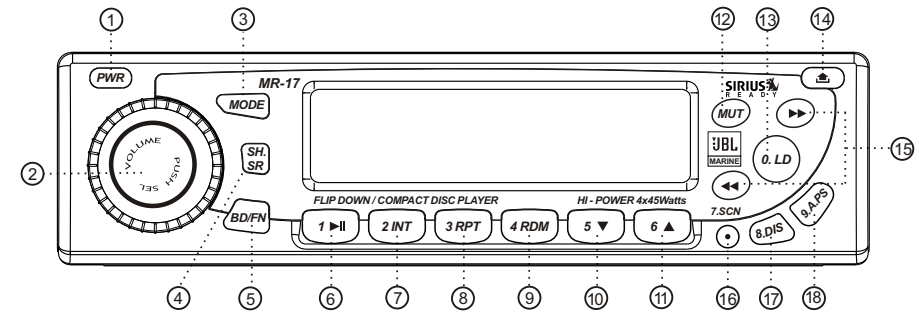

### 1. Loading a CD

Open the door by pushing button (14). Insert a CD label side up into the slot opening, then close the door. The CD will begin playing automatically after it is loaded.

#### Notes:

- NEVER insert foreign objects into the CD slot opening.
- If a CD is difficult to insert, there may already be a CD loaded in the unit.
- Some recorded CD-Rs or CD-RWs may not be usable with this CD player.

2. Select the CD->CDC by pressing the **"MODE" button (3)**.

3. Press **presets button (10) or (11)** to choose the DISC that you would like to play. (This button works when you install the CD changer to the radio unit. CDC is optional.)

4. **Play / Pause (6)**

Push to pause and push again to resume play.

5. **Intro Scan (7)**

Press this button to hear the first 10 seconds of each track on the disc. Press this button again to restore the player to its normal play mode.

6. **Repeat play button (8)**

While playing a desired track, press RPT button to play the track repeatedly. Press RPT button again to return to normal play mode.

7. **Random play button (9)**

Press RDM button to play all tracks on a CD in random sequence. Press RDM button again to return the player to normal mode.

8. **Track Tuning (15)**

Search the tracks on the DISC with the ◀ and ▶ buttons. If you press and hold the ◀ or ▶ button continuously, the track goes fast - forward ◀ or rewinds ▶ .

## Station Tuning

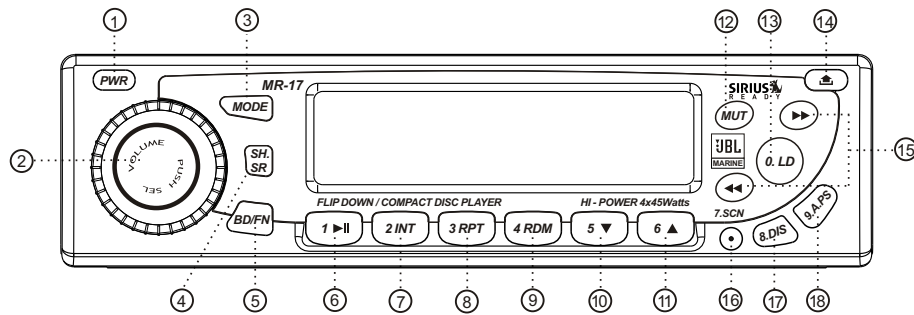

**1. Manual/Seek tuning buttons (15):** Press this button quickly to activate the Seek mode. The Seek mode will automatically seek up or down the wave band and stop at the next station of sufficient signal strength. Press and hold tuning buttons for 2 seconds to enter manual tuning mode. The unit will revert back to Seek mode after 10 seconds without use.

**2. Manual Station store:** Select the desired band and tune to a radio station to be memorized. Choose the preset button memory location 1-6 into which the station is to be stored and press and hold that preset button for 2 seconds. The station will now be entered into the preset memory. 6 stations can be memorized on each of the FM1, FM2, FM3, AM1, AM2.

### 3. A.P.S - Auto store function (18)

Press and hold button (18) for approximately 2 seconds until you hear a beep which confirms the memory function is engaged. The unit will "SEARCH" for six strong stations and automatically store them on buttons 1 - 6. You can override the preset station on any button by manually setting a new frequency.

### 4. Scan (16)

In Radio mode, press the SCAN (16) button to scan strong stations for previewing. At the desired station press the "SCAN (16)" button again to stop scanning.

### 5. Program Memory Scan

Momentarily press A.P.S and the unit will scan for stored stations. Momentarily press it again to stop scanning.

## Installing and Removing the Detachable Face

### To Install / attach the faceplate:

Place the detachable face plate onto the radio one side at a time so that the grooved edge of the face plate lines up directly with the connecting piece on the radio. The face plate should fit easily inside the plastic trim. When the face plate is securely in place, a distinct "click" will be heard, indicating that it is locked correctly in place.

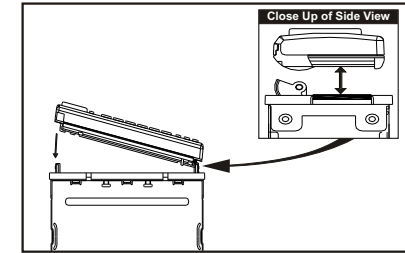

### To remove the face plate:

1. Press Release button, then the front panel will open (fold down).

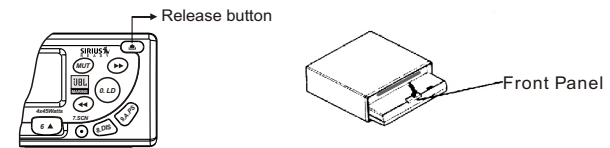

2. Grip the release section and pull the front panel forward.  
- Be careful not to grip the front panel display too tightly or to drop the panel.

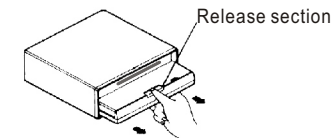

3. Close the inner cover.  
- After removing the front panel, be sure to close the inner cover to prevent dirt, dust or other foreign matter from entering the CD slot.

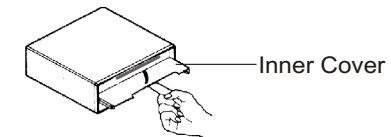

4. Keep the detachable front panel in the protective case provided.

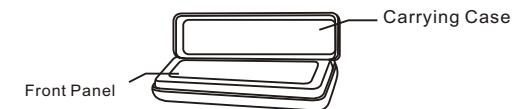

## Important notes

Prior to the final installation, carry out a sound check. If high distortion or intermittent sound is experienced, it is possible that the wiring from the CD receiver to the boat's electrical system is poor or that the battery needs recharging.

If the battery and its charging circuit are OK, then rewire the yellow fused wire of the CD player directly to the positive terminal (+) of the boat battery.

Marine accessory shops stock the connector blocks and the 10 Amp cable that may be necessary for extending the fuse wire connection.

### ■ Grounding

Make sure that the black wire on the wiring harness is connected to a good ground point on the boat. If the chassis of the boat is used as a grounding point, make sure that the surface is scraped clean of paint before attaching the wire to it.

It is preferable to connect the black ground wire directly to negative terminal (-) of the boat battery.

### ■ Warning: polarity...

This model is only suitable for use in boats which have a Negative ground system, e. g. : the negative terminal of the boat battery is connected to the chassis.

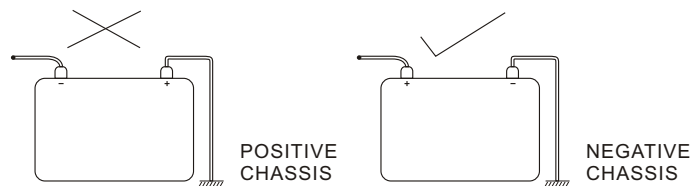

### ■ Connecting the Speakers and Power Cables

Before you wire your system, disconnect your boat battery's positive (+) cable.

This helps prevent damage in case of a short. When you complete the wiring, reconnect the battery cable and test your marine stereo. When connecting your marine stereo's black ground wire, be sure to connect the wire to a metal part of your boat or preferably to the negative (-) terminal of the boat battery.

## Controls

### c. Area Selection

By pressing SEL(2) button again, the unit will be in Area Selection mode, then turn the knob right or left to choose USA or EUR. Press and hold BD/FN for 2 seconds to confirm selection.

### d. DSP

Choose from flat, classic, pop or rock by pressing the SEL(2) button again. Adjust with spindle knob.

### 3. Volume control

Turn the spindle knob (2) left or right to decrease or increase the volume level. The radio will automatically default to volume mode when powered on.

#### - Bass control

Turn left to decrease the bass.  
Turn right to increase the bass.

#### - Treble control

Turn left to decrease the treble.  
Turn right to increase the treble.

#### - Balance control

Turn left to decrease the right speaker volume.  
Turn right to decrease the left speaker volume.

#### - Fader control

Turn left to decrease the volume level of any speakers connected to the front channel.  
Turn right to decrease the volume level of any speakers connected to the rear channel.

### 4. "MODE" button (3)

Press this button to select Radio, CD, CDC, SIRIUS or AUX-IN.

### 5. BD/FN button (5)

Press the BD/FN(5) button shortly to select the desired band:FM1,FM2,FM3, AM1 and AM2.

### 6. SHIFT / SCROLL button (4)

SIRIUS function button only.

### 7. How to adjust the clock / time (17)

Press DIS(17) button once to display the time.

a. Press and hold the DIS (17) button until the time flashes on the display.

b. Turn spindle knob(2) clockwise to set hour.

c. Turn spindle knob(2) counter clockwise to set minutes.

d. Press the DIS button again quickly to accept the adjusted time.

If no button is pressed within 5 seconds, then it automatically accepts the adjusted time without further intervention from the user.

### 8. Loudness function (13)

In order to emphasize the bass and the treble at low volume, press the LD (13) button. To turn off loudness, press the LD button again.

## Controls

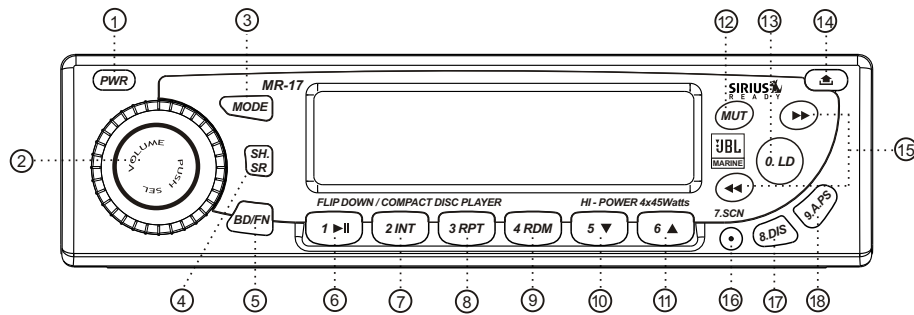

### 1. POWER ON/OFF button (1)

Push the PWR button (1) to turn on the unit. Push the button again to turn off the unit.

### 2. SEL and VOL button (2)

#### 1) Audio control ( VOLUME / BASS / TREBLE / BALANCE / FADER )

Short pressing the SEL (2) button you can select which of the below features to set:

- VOL display - volume control > press button (2)>
- BAS display - bass tone control >press button (2)>
- TRB display - treble tone control > press button (2)>
- BAL display - balance control > press button (2)>
- FAD display - fader control > press button (2)>

Then use the spindle knob(2) to adjust. In each mode, the waiting time is about 5 seconds. If the waiting time is over, it returns to the last display mode of Radio, CD, or CDC mode. These settings are indicated on the display window.

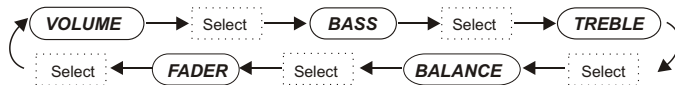

#### 2) Beep 2nd , I-Vol , Area and DSP Selection

When the SEL button (2) is pressed over 2 seconds, the unit will be operated as below:



#### a. Beep 2nd

In the Beep 2nd mode, you can control Beep on or Beep 2nd by turning the spindle knob.

- Beep on : You can hear "beep" sound when you press any buttons.
- Beep 2nd :You can hear "beep" sound when you press a button over 1.5 seconds.

#### b. I-Vol

By pressing the SEL(2) button again, the unit will turn to I-VOL mode (Initial Volume Level Adjustment). You can adjust the I-Vol to the level you want by turning the spindle knob. After setting the initial level, when the unit is powered on/off, detached on/off, or when the ACC is turned on/off, the I-VOL will keep the volume adjusted to the preset level when unit is turned on.

## Installation

### 1. Precautions

Choose the mounting location carefully so that the unit will not interfere with the normal driving functions of the boat.

Avoid installing the unit where it would be subject to high temperature, such as from direct sunlight or hot air, or where it would be subject to dust, dirt or excessive vibration. Use only the supplied mounting hardware for a safe and secure installation. Be sure to remove the front panel before installing the unit.

### 2. Mounting angle adjustment

Adjust the mounting angle to less than 20 degrees from horizontal.

### 3. Mounting example

<< Installation in the cabinet >>

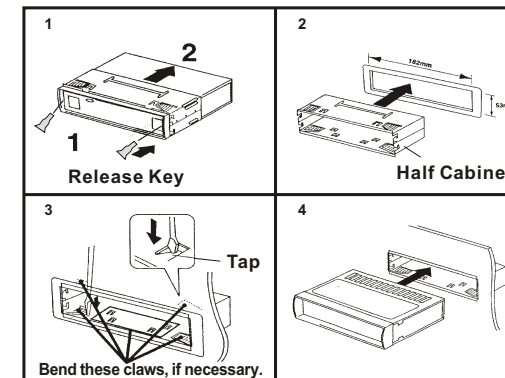

- **Note:** Keep the release key in a safe place as you may need it in future to remove the unit from the boat.

### 4. Attaching the Trim Ring

- Attach the Trim Ring to the Radio after installing.
- Be sure to insert the Trim Ring in the correct direction.

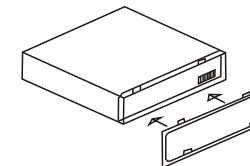

## Supporting the unit

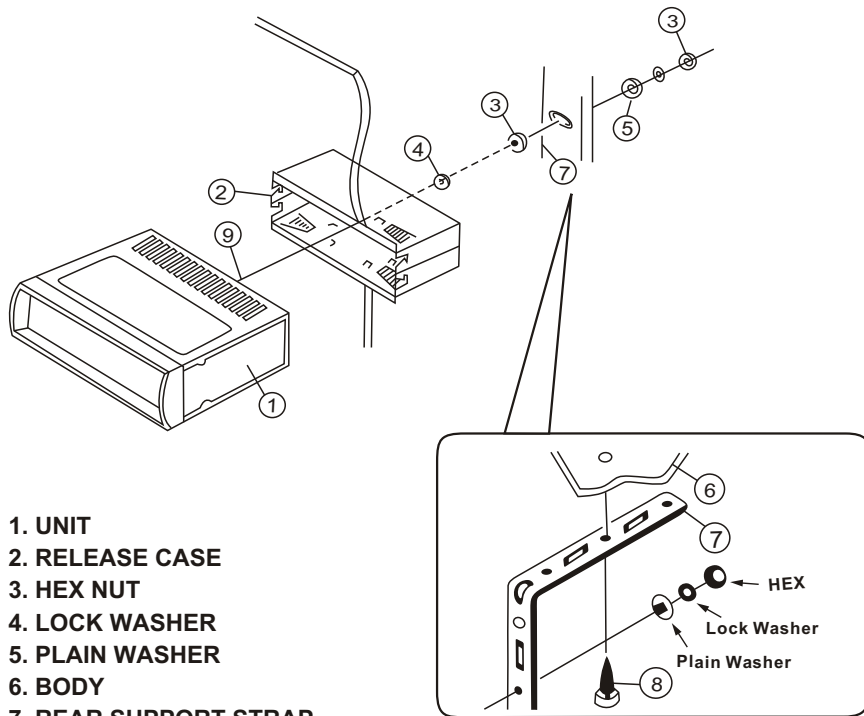

1. UNIT
2. RELEASE CASE
3. HEX NUT
4. LOCK WASHER
5. PLAIN WASHER
6. BODY
7. REAR SUPPORT STRAP
8. TAPPING SCREW
9. M5 X 20 HEX BOLT

■ Accessories subject to change without notice.

### 1. Fuse replacement

If the fuse blows, check the power connection and replace the fuse. If the fuse blows again after the replacement, there may be an internal malfunction. In this case, consult your nearest dealer.

### 2. Warning

Use the specified amperage fuse for each lead.  
Use of a higher amperage fuse may cause serious damage.

## Identification of controls and functions

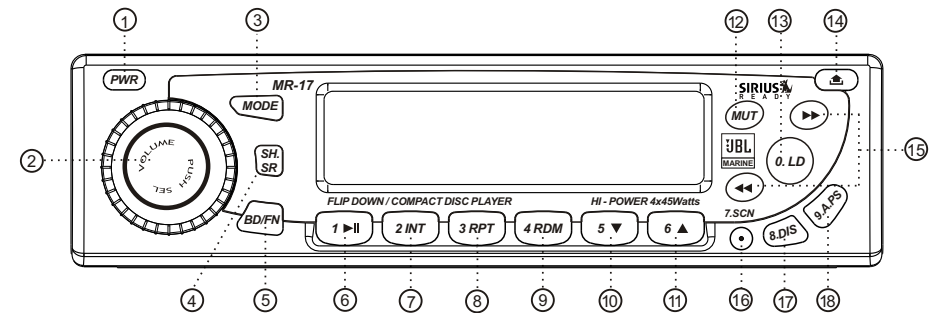

1. POWER ON / OFF button
2. Electronic Function SELECT button, Volume decrease or increase button
3. MODE button <Radio → CD → CDC → SIRIUS → AUX-IN>
4. SH. SR (SHIFT / SCROLL) button (SIRIUS only)
5. BD / FN button
6. CD play / pause button, radio preset 1 button
7. CD intro scan button, radio preset 2 button
8. CD repeat track button, radio preset 3 button
9. CD random play button, radio preset 4 button
10. DISC DOWN (CD changer) button, radio preset 5 button
11. DISC UP (CD changer), radio preset 6 button
12. MUTE button
13. LOUD (loudness) button (#0 SIRIUS only)
14. Front panel release button
15. Radio tune UP / DOWN button, CD track UP / DOWN button
16. SCAN button (#7 SIRIUS only)
17. DISP (display) button (#8 SIRIUS only)
18. A.P.S - Auto Preset Scan button (#9 SIRIUS only)