

## Setting the Brightness of the Backlight

Slide **BRIGHTNESS** to select HI (high), MID (middle) or LOW for the display according to your preference.

## Setting the Clock

- Plug in the clock radio. The display will flash “AM 12:00”.
- Press **CLOCK** for a few seconds. You will hear a beep and the hour will start to flash in the display.
- Press **TUNE•TIME SET +** or **-** until the correct hour appears in the display.
- Press **CLOCK** once. You can set the minutes in the same way as the hour. After setting the minutes, press **CLOCK** to start the clock, and you will hear two short beeps.

To set the current time rapidly, hold down **TUNE•TIME SET +** or **-**.

In step 4, when you press **CLOCK** after the minute setting to activate the clock, the seconds start counting from zero.

- Notes**
- The clock setting will be cancelled if you press **OFF ■•ALARM RESET** while setting the clock.
  - If you do not press a button for about 1 minute while setting the clock, the clock setting will be cancelled.

## Changing AM Channel Step

The AM channel step differs depending on area. The channel step of this unit is factory-set to 10 kHz to change the setting as shown below to be able to listen to the radio.

Area	Channel step
North and South American	10 kHz
Other countries/regions	9 kHz

- Press **OFF ■•ALARM RESET** to turn off the power.

- While holding down **OFF ■•ALARM RESET**, keep pressing **PRESET TUNING 1** for more than 5 seconds. Two short beeps will sound, and the AM channel step will be changed. If you proceed to step 2, the channel step will change again.

- Notes**
- When the AM channel step is changed, the preset stations for AM will be initialized.
  - When the AM channel step is changed, the FM channel step also will be changed.

## Playing a CD

An 8 cm (3-inch) CD can be played without an adaptor.

- Push **PUSH OPEN** to open the CD compartment lid and place a disc.
- Push **PUSH CLOSE** to close the CD compartment lid.

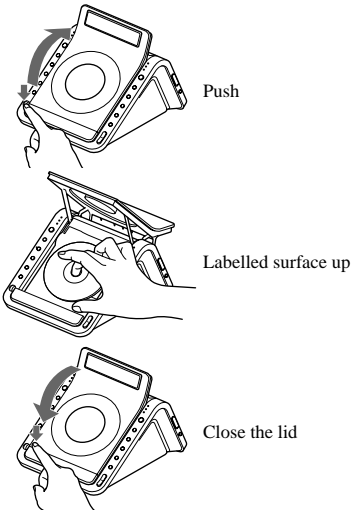

- Press **CD ►II**. “►CD” and “TRACK 01” appear on the display to indicate that track 1 of the CD is playing.
- Press **VOL +** or **-** to adjust the volume.

To	Press
Pause	<b>CD ►II</b>
Resume play after pause	<b>CD ►II</b> again
Locate the beginning of the current track (AMS*)	<b>◀◀**</b>
Locate the next track (AMS*)	<b>▶▶**</b>
Go back at high speed	Hold down <b>◀◀**</b>
Go forward at high speed	Hold down <b>▶▶**</b>
Locate the previous track (AMS*)	<b>◀◀</b> repeatedly**
Locate the succeeding track (AMS*)	<b>▶▶</b> repeatedly**
Stop play	<b>■</b>

\* AMS = Automatic Music Sensor  
\*\* These operations are possible during both play and pause.

### About CD-Rs/CD-RWs

This unit is compatible with CD-Rs/CD-RWs but playback capability may vary depending on the quality of the disc, the recording device and application software.

### Music discs encoded with copyright protection technologies

This product is designed to play back discs that conform to the Compact Disc (CD) standard. Recently, various music discs encoded with copyright protection technologies are marketed by some record companies. Please be aware that among those discs, there are some that do not conform to the CD standard and may not be playable by this product.

#### To handle compact discs

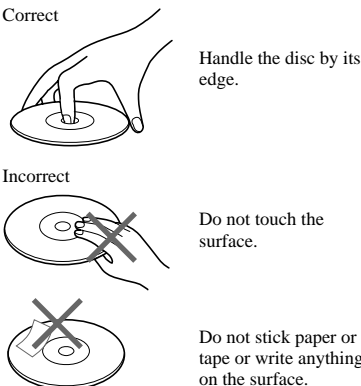

#### Notes

- Discs with non-standard shapes (e.g., heart, square, star) cannot be played on this unit. Attempting to do so may damage the unit. Do not use such discs.
- If you press **CD ►II** when there is no disc in the CD compartment, “00” flashes for about 5 seconds on the display and the unit turns off automatically.
- After 20 minutes, playback will be stop when you press **CD ►II** during play back.

### Various Modes of CD Playback

You can play tracks repeatedly or in random order.

Press **MODE**. Each press changes the play mode as follows:

Display Indication	Play mode
none	(normal play)
“REP 1”	(single repeat)
“REP ALL”	(all repeat)
“SHUFFLE”	(shuffle play)
“SHUFFLE REP”	(shuffle repeat)

### To listen with headphones (not supplied)

Connect headphones (not supplied) to the jack. The sound through the speaker will not be heard. The same applies when you listen to the radio.

## Playing the Radio —Manual Tuning

- Press **RADIO ON•BAND** to turn on the radio. “RADIO” appears on the display.
- Press **RADIO ON•BAND** repeatedly to select the desired band. Each press changes the band as follows:
- Use **TUNE•TIME SET +** or **-** to tune into a station. Two short beeps sound when the minimum frequency of each band is received during tuning.
- Adjust volume using **VOL +** or **-**.

When you release **TUNE•TIME SET +** or **-** after locating your desired station, the display returns to the previous display after about 10 seconds.

To check the frequency of the tuned-in station, press **RADIO ON•BAND** and the frequency appears for about 10 seconds.

To turn off the radio, press **OFF ■•ALARM RESET**.

## Improving the Reception

#### TV/WEATHER/FM:

Extend the FM wire antenna fully to increase reception sensitivity.

**AM:** Rotate the unit horizontally for optimum reception. A ferrite bar antenna is built into the unit.

Do not operate the unit over a steel desk or metal surface, as this may lead to interference of reception.

## Presetting Your Favorite Station —Preset Tuning

You can preset up to 10 stations in FM (5 stations in FM1, 5 stations in FM2), and 5 stations each in AM, TV, WEATHER.

### Presetting a Station

- Follow steps 1 to 4 in “Playing the Radio” and manually tune into the station you wish to preset.
- Hold down the **PRESET TUNING** button you wish to preset until you hear two short beeps.

**Example:** Display window when you preset FM 90 MHz in the **PRESET TUNING 2** button for FM2.



The frequency remains on the display for about 10 seconds and then returns to the previous display.

To preset another station, repeat these steps. To change the preset station, tune into the desired station and hold down the **PRESET TUNING 1** to **5** button. The new station will replace the previous station on the **PRESET TUNING** button.

### Tuning into a Preset Station

- Press **RADIO ON•BAND** to turn on the radio.
- Press **RADIO ON•BAND** to select the band.
- Press the desired **PRESET TUNING** button.
- Adjust the volume using **VOL +** or **-**. After about 10 seconds, the display will return to the previous display but the **PRESET TUNING** button number will remain.

#### Note

Holding down the desired **PRESET TUNING** button for more than a few seconds in step 3 will replace the previous station on the **PRESET TUNING** button with the station you are tuned into.

## Switching between monaural and stereo

The radio is set for stereo reception at the default setting. If FM stereo reception is poor, set to “FM MONO (monaural).” Noise will be reduced although the sound will not be heard in stereo.

- Press **RADIO ON•BAND** to turn on the radio.

- Press **RADIO ON•BAND** repeatedly to select FM 1 or FM 2.
- Press **MODE**. “FM MONO” appears in the display. To revert to stereo mode, press **MODE** again.

## Setting the Alarm

This clock radio is equipped with 3 alarm modes—CD, radio and buzzer. Before setting the alarm, make sure to set the clock (see “Setting the Clock”).

### To Set the Alarm Time

- Press **ALARM A** or **B** for a few seconds. After one beep, “ALARM” and the hour will flash on the display.
- Press **TUNE•TIME SET +** or **-** until the desired hour appears. To set the hour rapidly, hold down **TUNE•TIME SET +** or **-**.
- Press **ALARM A** or **B**. After one beep, the minutes will flash.
- Repeat step 2 to set the minutes and press **ALARM A** or **B**. After one beep, the alarm mode is entered.
- Press **TUNE•TIME SET +** or **-** until the desired alarm indicator flashes. You can choose one mode among “CD,” “RADIO” and “BUZZER.” Set the alarm mode as follows:
  - CD: see “**A** Setting the CD Alarm.”
  - RADIO: see “**B** Setting the Radio Alarm.”
  - BUZZER: see “**C** Setting the Buzzer Alarm.”

### **A** Setting the CD Alarm

For the CD alarm, the track you specified as the wake-up track is played first. (If the CD play mode is set to “SHUFFLE” or “SHUFFLE REP.” however, all the tracks are played in random order.)

- Perform steps 1 to 5 in “To set the Alarm Time.”
- Press **ALARM A** or **B** to select “CD” alarm mode. After one beep, “WAKE UP TRACK” appears on the display.
- Press **TUNE•TIME SET +** or **-** to select the desired wake-up track number.
- Press **ALARM A** or **B**. After one beep, “WAKE UP VOLUME” will flash.
- Press **TUNE•TIME SET +** or **-** to adjust the volume. You can also adjust the volume using **VOL +** or **-**.
- Press **ALARM A** or **B**. Two short beeps will confirm the setting. If the CD indicator does not light, press **ALARM A** or **B** to light the CD indicator, and the CD will start at the set time.

### **B** Setting the Radio Alarm

For the radio alarm, the station you specified as the wake-up station is played.

- Perform steps 1 to 5 in “To set the Alarm Time.”
- Press **ALARM A** or **B** to select “RADIO” alarm mode. “WAKE UP STATION” appears and the preset number flashes on the display.
- Press **TUNE•TIME SET +** or **-** to select the desired wake-up station. Preset number changes in the order as follows:

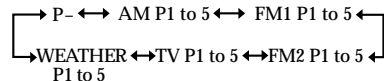

- “P-” is the last received station. You can directly select the desired wake-up station by pressing **RADIO ON•BAND** or the **PRESET TUNING** button while the indication “P-” is not displayed.
- Press **ALARM A** or **B**. After one beep, “WAKE UP VOLUME” will flash.
  - Press **TUNE•TIME SET +** or **-** to adjust the volume. You can also adjust the volume using **VOL +** or **-**.
  - Press **ALARM A** or **B**. Two short beeps will confirm the setting. If the RADIO indicator does not light, press **ALARM A** or **B** to light the RADIO indicator, and the radio will start at the set time.

### **C** Setting the Buzzer Alarm

- Perform steps 1 to 5 in “To set the Alarm Time.”
- Press **ALARM A** or **B** to select “BUZZER” alarm mode. Two short beeps will confirm the setting. If the BUZZER indicator does not light, press **ALARM A** or **B** to light the BUZZER indicator, and the buzzer will sound at the set time.

### ALARM ON—

Press **ALARM A** or **B** to activate the alarm setting. If the setting indicator does not light, the alarm setting is not activated. You can only check the alarm setting when it is activated.

If you set the CD alarm and there is no disc in the CD player, the buzzer alarm will sound in its place at the time set.

For the alarm, the beeping of the alarm becomes more rapid after every few seconds in three progressive stages.

When headphones (not supplied) are plugged into the unit, the alarm will not sound through the speakers regardless of the alarm mode setting.

#### Note

When Alarm A and Alarm B are set for the same time, the Alarm A takes precedence.

### To Doze for a Few More Minutes

Press **SNOOZE•SLEEP OFF**. The CD, radio or buzzer alarm turns off but will be automatically activated again after about 10 minutes. Every time you press **SNOOZE•SLEEP OFF**, the snooze time changes as follows:

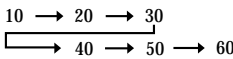

The display shows the snooze time for a few seconds and returns to show the current time. When you press **SNOOZE•SLEEP OFF** after the current time appears, the snooze time starts from 10 minutes again.

The maximum length of the snooze time is 60 minutes.

### ALARM OFF—

Press **ALARM A** or **B** to deactivate the alarm setting.

The CD, radio, or buzzer alarm is turned off automatically after 60 minutes.

### To Stop the Alarm

Press **OFF ■•ALARM RESET** to turn off the alarm. The alarm will come on again at the same time the next day.

## Using the NAP Timer (Count Down Timer)

The NAP timer sounds the buzzer after a preset time duration.

Press **NAP** repeatedly until the desired minutes are displayed. Every press changes the display as follows:

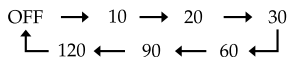

“**NAP**” appears and the NAP time is displayed for a few seconds. NAP timer starts counting down the NAP time.

When the selected NAP time has passed, a beep sounds, and “**NAP**” flashes in the display. The buzzer is turned off automatically after about 60 minutes.

### To Stop the NAP Timer

Press **NAP** or **OFF ■•ALARM RESET** to turn off the buzzer.

### To Deactivate the NAP Timer

Press **NAP**. “**NAP**” goes off in the display.

## Setting the Sleep Timer

You can fall asleep to the CD or the radio using the built-in sleep timer to turn off the CD or the radio automatically after a preset duration.

Press **SLEEP** during CD or radio play. You can set the sleep timer to durations of 90, 60, 30, or 15 minutes. Every push changes the display as follows:

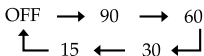

“SLEEP” will appear in the display when the duration time is set.

The CD or the radio will play for the time you set, then shut off.

When the sleep timer reaches a remaining time of a few minutes, “SLEEP” will flash in the display and the sound output will gradually decrease in volume (Gentle Sleep function). If you press **VOL +** or **-** at this time, “SLEEP” will light up and the decrease in the volume will stop.

To turn off the CD or the radio before the preset time, press **SNOOZE•SLEEP OFF**.