

HT-AS730S

# AV Receiver System

## user manual

imagine the possibilities

Thank you for purchasing this Samsung product.  
To receive more complete service,  
please register your product at  
[www.samsung.com/register](http://www.samsung.com/register)



# Safety information

## SAFETY WARNINGS

TO REDUCE THE RISK OF ELECTRIC SHOCK, DO NOT REMOVE REAR COVER (or BACK). NO USER SERVICEABLE PARTS INSIDE. REFER SERVICING TO QUALIFIED SERVICE PERSONNEL.



This symbol indicates “dangerous voltage” inside the product that presents a risk of electric shock or personal injury.



This symbol indicates important instructions accompanying the product.

**CLASS 1 LASER PRODUCT**  
**KLASSE 1 LASER PRODUKT**  
**LUOKAN 1 LASER LAITE**  
**KLASS 1 LASER APPARAT**  
**PRODUCTO LASER CLASE 1**

### CLASS 1 LASER PRODUCT

This Compact Disc player is classified as a CLASS 1 LASER product.

Use of controls, adjustments or performance of procedures other than those specified herein may result in hazardous radiation exposure.

#### CAUTION :

TO REDIVISIBLE LASER RADIATION WHEN OPEN AND INTERLOCKS DEFEATED, AVOID EXPOSURE TO BEAM.

- THIS PRODUCT UTILIZES A LASER. USE OF CONTROLS OR ADJUSTMENTS OR PERFORMANCE OF PROCEDURES OTHER THAN THOSE SPECIFIED HEREIN MAY RESULT IN HAZARDOUS RADIATION EXPOSURE. DO NOT OPEN COVER AND DO NOT REPAIR YOURSELF. REFER SERVICING TO QUALIFIED PERSONNEL.

### Note to CATV system installer

This reminder is provided to call the CATV system installer's attention to Section 820~40 of the NEC which provides guidelines for proper grounding and, in particular, specifies that the cable ground shall be connected to the grounding system of the building, as close to the point of cable entry as practical.

### WARNING

To reduce the risk of fire or electric shock, do not expose this appliance to rain or moisture.

### CAUTION

Apparatus shall not be exposed to dripping or splashing and no objects filled with liquids, such as vases, shall be placed on the apparatus.

## PRECAUTIONS

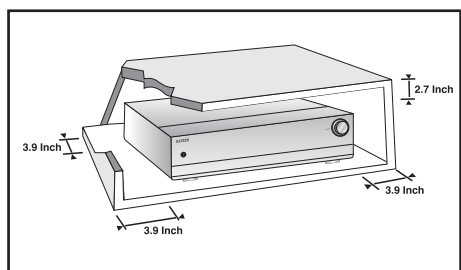

Ensure that the AC power supply in your house complies with the identification sticker located on the back of your player. Install your player horizontally, on a suitable base (furniture), with enough space around it for ventilation (3~4inches). Make sure the ventilation slots are not covered. Do not stack anything on top of the amplifier. In order to disconnect the player completely from the power supply, remove the mains plug from the wall outlet, especially when left unused for a long period of time.

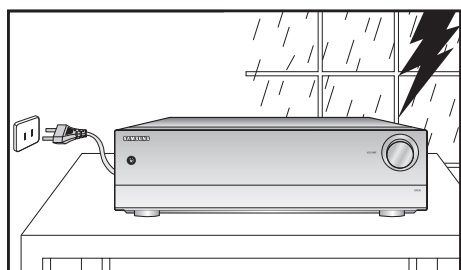
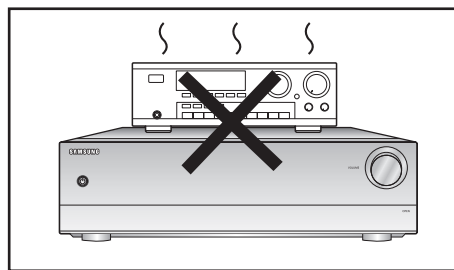

During thunderstorms, disconnect AC main plug from the wall outlet.  
Voltage peaks due to lightning could damage the unit.

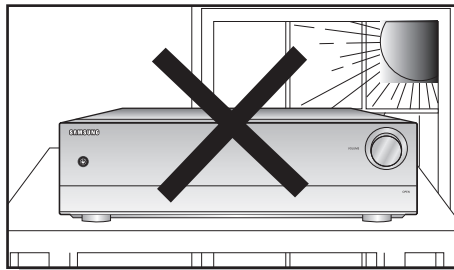

Do not expose the unit to direct sunlight or other heat sources.  
This could lead to overheating and malfunction of the unit.

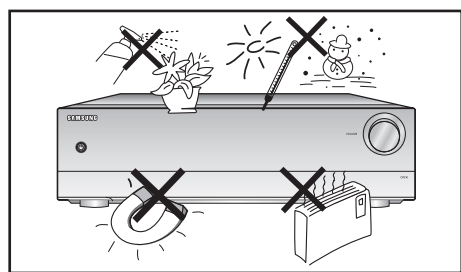

Protect the player from moisture (i.e. vases), and excess heat (e.g. fireplace) or equipment creating strong magnetic or electric fields (i.e. speakers...). Disconnect the power cable from the AC supply if the player malfunctions. Your player is not intended for industrial use.

Use of this product is for personal use only.

Condensation may occur if your player or disc have been stored in cold temperatures.

If transporting the player during the winter, wait approximately 2 hours until the unit has reached room temperature before using.

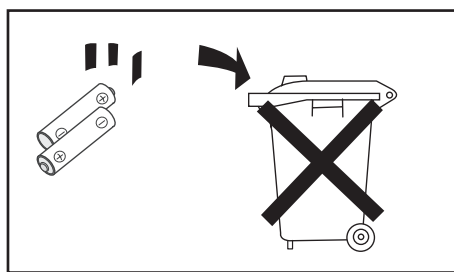

The batteries used with this product contain chemicals that are harmful to the environment.  
Do not dispose of batteries in the general household trash.

# Features

## Digital AV Receiver

This product is a pure digital AV receiver that performs digital signal processing to minimize signal distortion and loss.

## Dolby Pro Logic IIx

Dolby Pro Logic IIx is a new technology that provides discrete 7.1 channels out of 2 channel or multi channel sources. It also provides Music, Movie and Game modes.

Dolby Pro Logic IIx is an improved surround system that is optimized to a 7.1 CH multimedia system, enabling you to maximize your entertainment experience.

## DTS 96/24



DTS 96/24 encodes standard 16 bit/44.1 kHz sound to 24 bit/96kHz and applies it to a 5.1 CH sound track.

## DOLBY DIGITAL EX

Adds a surround back channel for more spacious sound compared to regular 5.1 channel Dolby Digital.

## DTS (Digital Theater Systems)

DTS provides a discrete 5.1 CH digital audio signal for both music and movie contents and uses less compression than Dolby Digital for richer sound.

## iPod



You can enjoy music files by connecting your iPod to the AV Receiver with the supplied iPod dock.

## DTS NEO:6



Provides a full range of 6 channels by converting a digital PCM or analog stereo signal using DTS digital matrix decoding.

## SFE (Sound Field Effect) Using 32bit Audio Digital Signal Processing

Provides more realistic surround sound with normal stereo audio sources.

## Anynet+ (HDMI-CEC) Function

Anynet+ is a function that can be used to operate this AV Receiver with a Samsung TV remote control, by connecting the receiver to a SAMSUNG TV using an HDMI Cable. (This function is available only in connection with Samsung TV and DVD player supporting Anynet+(HDMI-CEC).)

## DTS-ES (Extended Surround)



The DTS-ES (Extended Surround) system is a new multi digital signal format that was developed by Digital Theater Systems Inc.

Supporting full compatibility with the conventional DTS digital surround sound format, the DTS-ES (Extended Surround) system improves the surround signal for a 360-degree surround effect.

DTS-ES adds an additional rear center surround channel for 6.1 channel sound.

## ACCESSORIES



Remote control  
(AH59-01951K)



FM antenna  
(AH42-00017A)

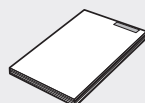

User's manual  
(AH68-02174S)

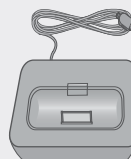

iPod Dock  
(AH97-02650C)



ASC microphone  
(AH30-00099A)



# Contents

## SAFETY INFORMATION

2

- 2 Safety Warnings
- 3 Precautions

## FEATURES

4

- 4 Accessories

## DESCRIPTION

7

- 7 Front Panel
- 8 Rear Panel
- 10 Display
- 11 Insert Remote Control Batteries
- 11 Operation Range of the Remote Control
- 12 Tour of the Remote Control

## CONNECTIONS

14

- 14 Speaker Positioning
- 16 Connecting the Speakers
- 17 Connecting the Video Out to your TV
- 18 Connecting External Devices/your TV via HDMI
- 19 HDMI Function
- 20 Connecting a DVD or BD(Blu-Ray) Player
- 21 Connecting a Cable, Satellite or Set-top Box
- 22 Connecting a VCR
- 23 Connecting a CD Player
- 24 Connecting 7.1 Channel Devices
- 25 Connecting an iPod
- 27 Connecting the FM Antenna
- 27 Connecting Aux Components

## SETUP

28

- 28 Setup Menu Tree
- 32 Input Setup
- 33 Speaker Setup
- 37 Surround Setup
- 42 Option Setup

## OPERATION

45

- 45 Before Using the AV Receiver
- 46 Selecting Digital/Analog Input
- 47 Using the Surround Modes
- 50 Using the Speaker Adjustment Buttons
- 51 Listening to the Radio
- 52 Using an iPod
- 54 Convenient Functions

# Contents

---

## MISCELLANEOUS

56

- 56 Operating Your TV with the Remote Control
- 58 Operating Your DVD or BD with the Remote Control

## TROUBLESHOOTING

59

- 59 Troubleshooting

## APPENDIX

61

- 61 Specifications

# Description

## FRONT PANEL

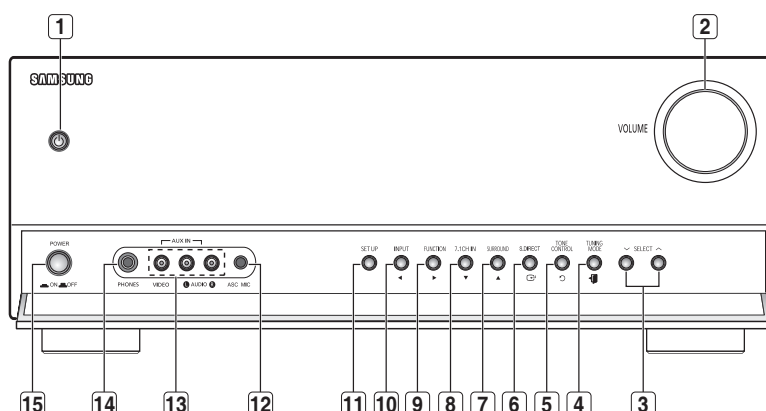

<b>1</b>	<b>STANDBY/ON button</b>	Sets the AV receiver to Standby.
<b>2</b>	<b>VOLUME Control</b>	Adjusts the volume level.
<b>3</b>	<b>SELECT button</b>	Used to change the radio frequency or select detailed options in Surround mode.
<b>4</b>	<b>TUNING MODE button</b>	Used to select Manual or Auto mode for FM radio.
<b>5</b>	<b>TONE CONTROL button</b>	Used to adjust the bass and treble level. * Also used to return to the previous menu from the SETUP menu.
<b>6</b>	<b>S.DIRECT button</b>	Used to output 2 CH PCM audio signal without any signal processing, providing higher audio quality. This is useful for obtaining the best sound from a connected CD player. * Also used to select an item in the SETUP menu.
<b>7</b>	<b>SURROUND button</b>	Toggles to select a surround sound mode. * Also used to move the cursor up in the SETUP menu.
<b>8</b>	<b>7.1CH IN button</b>	Used to select a connected 7.1 multi channel player * Also used to move the cursor down in the SETUP menu.
<b>9</b>	<b>FUNCTION button</b>	Used to select a source (FM, DVD, SAT, TV, VCR, CD, AUX, 7.1 MULTI CH) * Also used to move the cursor to the right in the SETUP menu.
<b>10</b>	<b>INPUT MODE</b>	Toggles to select an input mode for the selected source. * Also used to move the cursor to the left in the SETUP menu.
<b>11</b>	<b>SETUP button</b>	Displays the SETUP menu where you can select a menu item (INPUT, SPEAKER, SURROUND, OPTION).
<b>12</b>	<b>ASC MIC JACK</b>	Used to connect the ASC MIC for setting up ASC (Auto Sound Calibration).
<b>13</b>	<b>AUX IN Jack</b>	Auxiliary AV input terminals used to connect a camcorder, portable DVD player or gaming device.
<b>14</b>	<b>HEADPHONE Jack</b>	Stereo headset input jack.
<b>15</b>	<b>POWER button</b>	Turns the receiver on/off.

# Description

## REAR PANEL

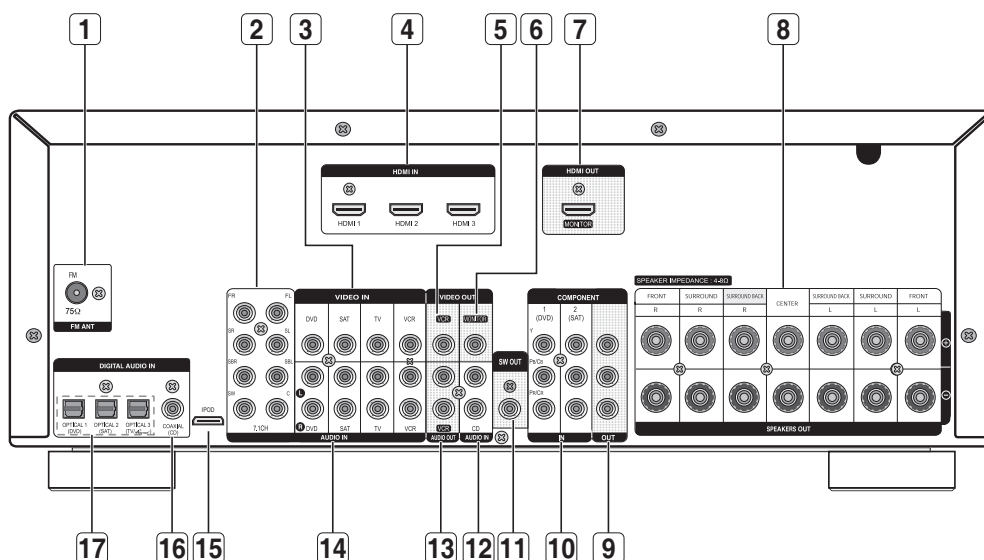

<b>1</b>	<b>FM Antenna JACK</b>	Connect the FM Antenna here.
<b>2</b>	<b>7.1 CH ANALOG AUDIO INPUT JACKS</b>	Receives the analog audio signal from an external player with a multi-channel port.
<b>3</b>	<b>VIDEO INPUT JACKS</b>	Receives the video signal from a video player (DVD, SAT, TV, VCR).
<b>4</b>	<b>HDMI INPUT JACKS</b>	Receives digital video and audio signals simultaneously using an HDMI cable.
<b>5</b>	<b>VCR VIDEO OUTPUT JACK</b>	Outputs the video signal to the VCR.
<b>6</b>	<b>MONITOR OUTPUT JACK</b>	Outputs the video signal to video devices (TV, Projector etc).
<b>7</b>	<b>HDMI OUTPUT JACK</b>	Outputs digital video and audio signals simultaneously using an HDMI cable.
<b>8</b>	<b>SPEAKER OUTPUT TERMINALS</b>	Speaker connection terminals
<b>9</b>	<b>COMPONENT VIDEO OUTPUT JACK</b>	Outputs the component video signal.

<b>10</b>	<b>COMPONENT VIDEO INPUT JACKS</b>	Receives the component video signal.
<b>11</b>	<b>SUBWOOFER AUDIO OUTPUT JACK</b>	Connect the subwoofer.
<b>12</b>	<b>CD AUDIO INPUT JACKS</b>	Receives the audio signal from an audio CD player.
<b>13</b>	<b>VCR AUDIO OUTPUT JACK</b>	Outputs the audio signal to a VCR.
<b>14</b>	<b>AUDIO INPUT JACKS</b>	Receives the audio signal from a video player.
<b>15</b>	<b>IPOD INPUT JACK</b>	Receives the audio/video signal from an iPod.
<b>16</b>	<b>COAXIAL INPUT JACK (DIGITAL AUDIO IN)</b>	Receives the digital coaxial audio signal.
<b>17</b>	<b>OPTICAL INPUT JACKS (DIGITAL AUDIO IN)</b>	Receives the digital optical audio signal.

# DISPLAY

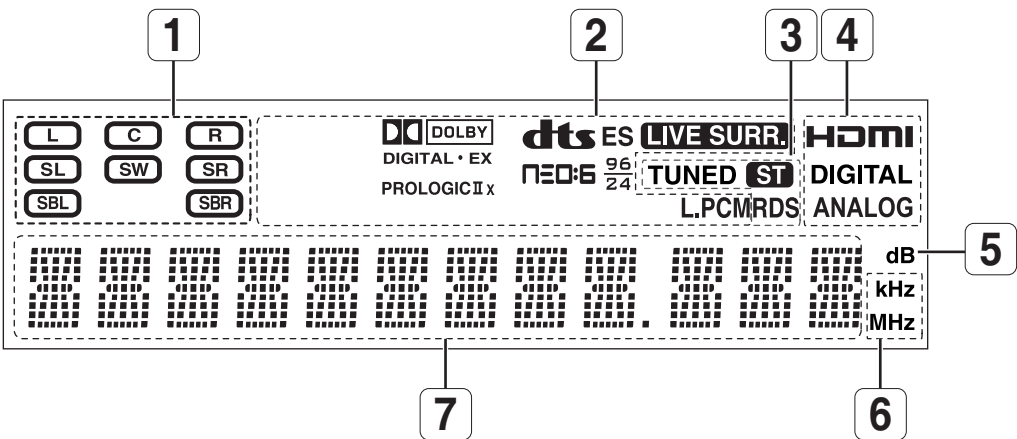

1	SPEAKER INDICATORS	Receives the audio/video signal from an iPod.
2	LISTENING MODE INDICATORS	Displays the current listening mode.
3	TUNING INDICATORS	Displays the status of the current radio broadcasting.
4	AUDIO INPUT INDICATORS	Displays the input signal type of the current audio source.
5	VOLUME LEVEL INDICATOR	Displays the volume level.
6	RADIO FREQUENCY INDICATOR	Displays the current radio frequency range.
7	MESSAGE DISPLAY	Informs you of the status of the receiver.

## INSERT REMOTE CONTROL BATTERIES

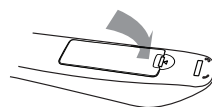
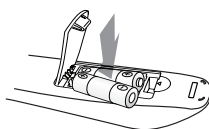

**1. Lift the cover at the back of the remote control upward as shown.**

**2. Install two AAA size batteries.**  
Make sure to match the "+" and "-" ends of the batteries with the diagram inside the compartment.

**3. Replace the cover.**  
Assuming typical TV usage, the batteries last for about one year.



Follow these precautions to avoid leaking or cracking cells:

- Place batteries in the remote control so they match the polarity : (+) to (+) and (-) to (-).
- Use the correct type of batteries. Batteries that look similar may differ in voltage.
- Always replace both batteries at the same time.
- Do not expose the batteries to heat or a flame.

## OPERATION RANGE OF THE REMOTE CONTROL

The remote control can be used up to approximately 23 feet/7 meters in a straight line. It can also be operated at a horizontal angle of up to 30° from the remote control sensor.

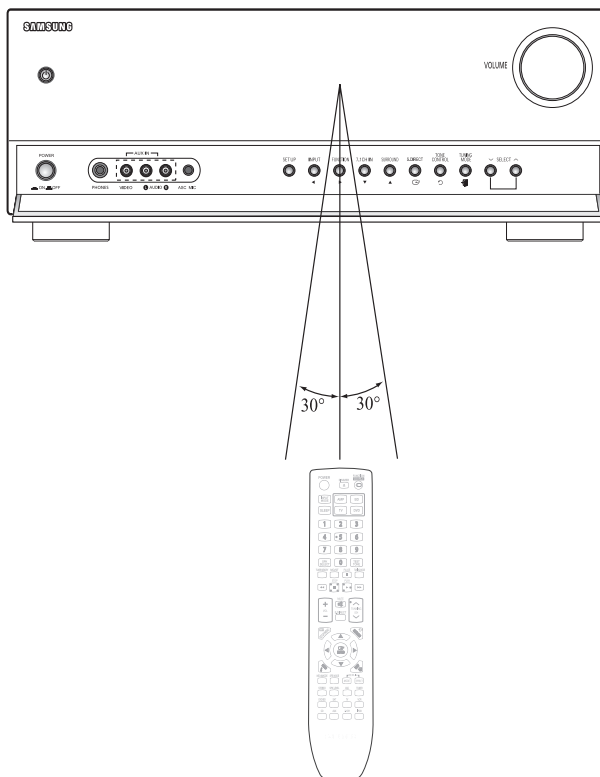

## TOUR OF THE REMOTE CONTROL

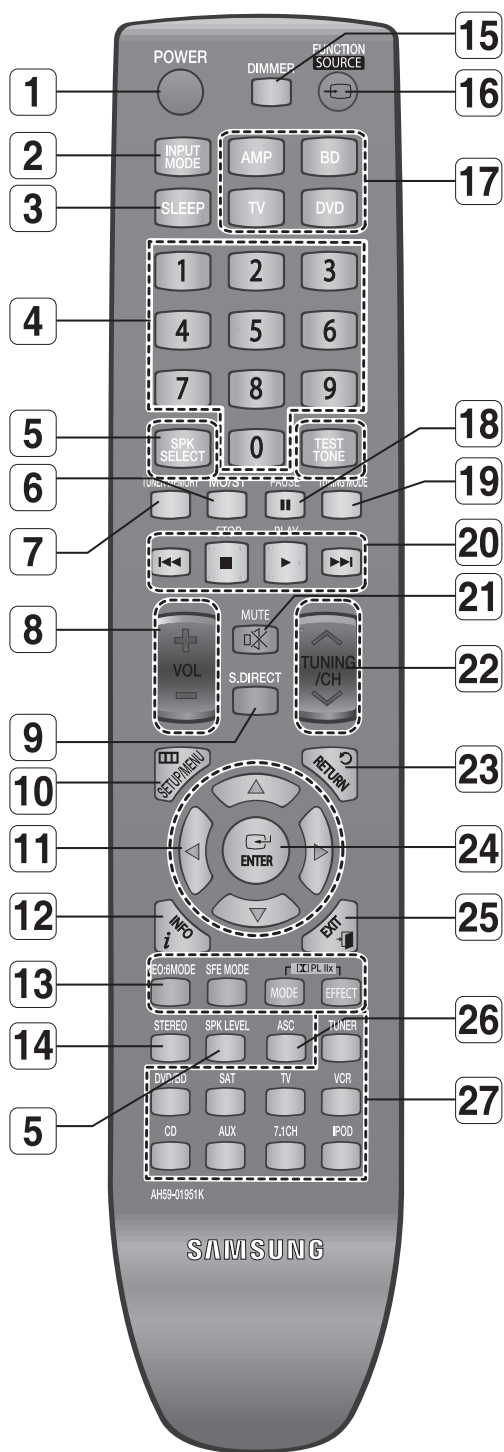



<b>1</b>	<b>POWER button</b>	Turns the receiver on/off.
<b>2</b>	<b>INPUT MODE button</b>	Toggles to select an input mode for the selected source.
<b>3</b>	<b>SLEEP button</b>	Used to set the Sleep Timer.
<b>4</b>	<b>NUMBER buttons</b>	Used to select a TV channel.
<b>5</b>	<b>SPK LEVEL/ SPK SELECT/ TEST TONE buttons</b>	Used to select and adjust the level of a desired speaker. Also used to select the Test Tone function.
<b>6</b>	<b>MO/ST button</b>	Select MONO or STEREO for radio broadcasting.
<b>7</b>	<b>TUNER MEMORY button</b>	Used to set a preset radio frequency.
<b>8</b>	<b>VOLUME CONTROL buttons</b>	Adjusts the volume of the selected device.
<b>9</b>	<b>S.DIRECT button</b>	Used to output 2CH PCM audio without any signal processing, providing higher audio quality. This is useful for obtaining the best sound from a connected CD player.
<b>10</b>	<b>SETUP/MENU button</b>	Displays the SETUP menu where you can select a menu item (INPUT, SPEAKER, SURROUND, OPTION).
<b>11</b>	<b>UP/DOWN/LEFT/RIGHT buttons</b>	Used to navigate the menus.
<b>12</b>	<b>INFO button</b>	Displays information on the connected device currently being used.
<b>13</b>	<b>SURROUND mode buttons</b>	Used to select a surround sound mode.
<b>14</b>	<b>STEREO button</b>	Outputs the sound of the selected source in 2 CH stereo.
<b>15</b>	<b>DIMMER button</b>	Adjusts the brightness of the display.
<b>16</b>	<b>FUNCTION button</b>	Toggles to find and select an input source.
<b>17</b>	<b>SELECT DEVICE buttons</b>	Select one from the 4 provided sources that you want to control using the remote control.
<b>18</b>	<b>PAUSE button</b>	Pauses playback on a connected device.
<b>19</b>	<b>TUNING MODE button</b>	Used to select Auto or Manual mode for FM radio.
<b>20</b>	<b>EXTERNAL DEVICE PLAYBACK buttons</b>	Used to control playback functions on external devices.
<b>21</b>	<b>MUTE button</b>	Mutes the sound of a connected device.
<b>22</b>	<b>TUNING/CHANNEL buttons</b>	Used to change the radio broadcasting frequency or TV channel.
<b>23</b>	<b>RETURN button</b>	Used to return to the previous menu from the SETUP menu.
<b>24</b>	<b>ENTER button</b>	Used to select an item in the SETUP menu.
<b>25</b>	<b>EXIT button</b>	Exits the SETUP menu.
<b>26</b>	<b>ASC button</b>	Used to set the ASC function.
<b>27</b>	<b>FUNCTION selector buttons</b>	Used to select an input source.

# Connections

This section involves various methods of connecting the AV receiver to other external components.

Before moving or installing the product, be sure to turn off the power and disconnect the power cord.

## SPEAKER POSITIONING

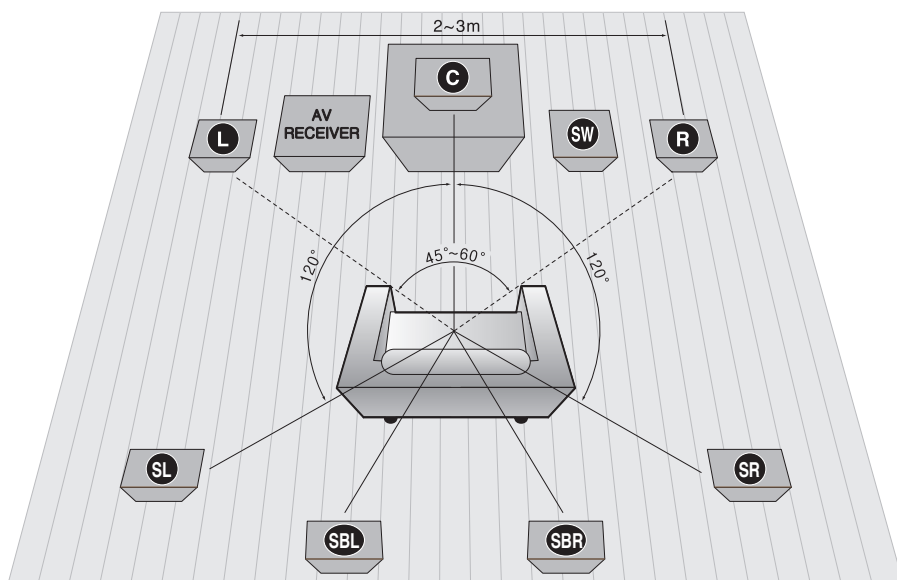

### Position of AV Receiver

Place AV Receiver on a dedicated stand or rack.

### Subwoofer **SW**

The position of the subwoofer is not so critical. Place it anywhere you like.

### Subwoofer function

Active subwoofer with integrated 150W amplifier provides rich bass sound.

- Connect the **SW OUT** terminal of the amplifier to the **INPUT** terminal of the subwoofer speaker.
- Press the **POWER** button on the rear side of the subwoofer to turn the power on.
- Using the subwoofer's VOLUME control, you can set the desired bass level (See page 35 "Setting the speaker level" to set the subwoofer level in the menu).

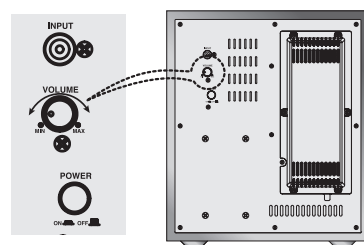

### Front Speakers **L R**

Place these speakers in front of your listening position, facing inwards (about 45°) toward you.

Place the speakers so that their tweeters will be at the same height as your ears.

Align the front face of the front speakers with the front face of the center speaker or place them slightly in front of the center speaker.

## SPEAKER POSITIONING (CONTINUED)

### Center speaker **C**

It is best to install it at the same height as the front speakers.

You can also install it directly over or under the TV.

### Surround Speakers **SL SR**

Place these speakers behind your listening position.

If there isn't enough room, place these speakers so they face each other.

Place them about 2 to 3 feet (60 to 90cm) above your ears, facing slightly downward.

Unlike the front and center speakers, the surround speakers are used to handle mainly sound effects and sound will not come from them all the time.

### Surround Back Speakers **SBL SBR**

If you are using two rear center speakers, place them facing forward from behind the listening position.

Place the surround back speaker about 2.3-3.3feet (70 cm to 1 m).



- When you attach the speakers to a wall, make sure to fasten them tightly so they do not fall off.

### Speaker Configuration

For the best surround-sound experience, you should connect seven speakers and a powered subwoofer.

The following table shows which channels you should use based on the number of speakers you have.

2 speakers	3 speakers	4 speakers	5 speakers	6 speakers	7 speakers
<b>L</b>	<b>L</b>	<b>L</b>	<b>L</b>	<b>L</b>	<b>L</b>
<b>R</b>	<b>R</b>	<b>R</b>	<b>R</b>	<b>R</b>	<b>R</b>
	<b>C</b>		<b>C</b>	<b>C</b>	<b>C</b>
		<b>SL</b>	<b>SL</b>	<b>SL</b>	<b>SL</b>
		<b>SR</b>	<b>SR</b>	<b>SR</b>	<b>SR</b>
				<b>SBL</b>	<b>SBL</b>
					<b>SBR</b>



- If you're using only one surround back speaker, connect it to the SURR BACK L terminals.
- No matter how many speakers you use, a powered subwoofer is recommended for powerful and solid bass.

## CONNECTING THE SPEAKERS

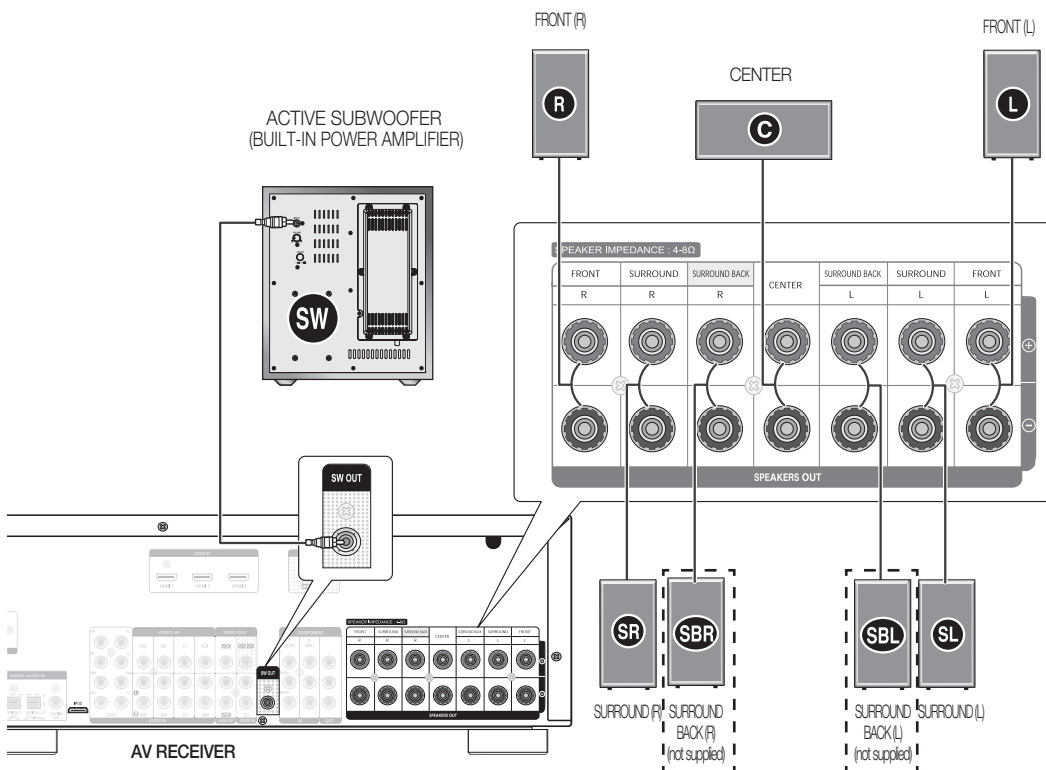

### Connecting Speaker Wire

1. Loosen the knob by turning counterclockwise.
2. Insert the bare part of the wire into the hole in the side of each terminal.
3. Tighten the knob by turning clockwise to secure the wire.

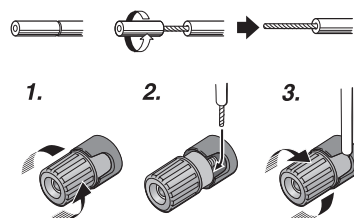

- Keep the subwoofer speaker out of reach of children to prevent them from inserting their hands or objects into the duct (hole).
- Never touch speaker terminals while the power is on. Doing so could result in electric shock.
- Make sure the polarities (+ and -) are correct.

### Connecting The Speakers

1. Press down the terminal tab on the back of the speaker.
2. Insert the black wire into the black terminal (-) and the red wire into the red (+) terminal, and then release the tab.
3. Connect the connecting plugs to the back of the AV Receiver.
  - Make sure the colors of the speaker terminals on the back of the AV receiver match the colors of the connecting plugs.

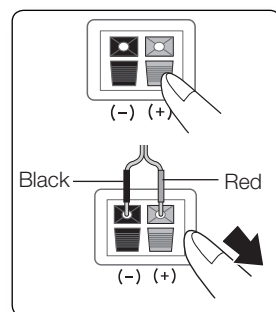

## CONNECTING THE VIDEO OUT TO YOUR TV

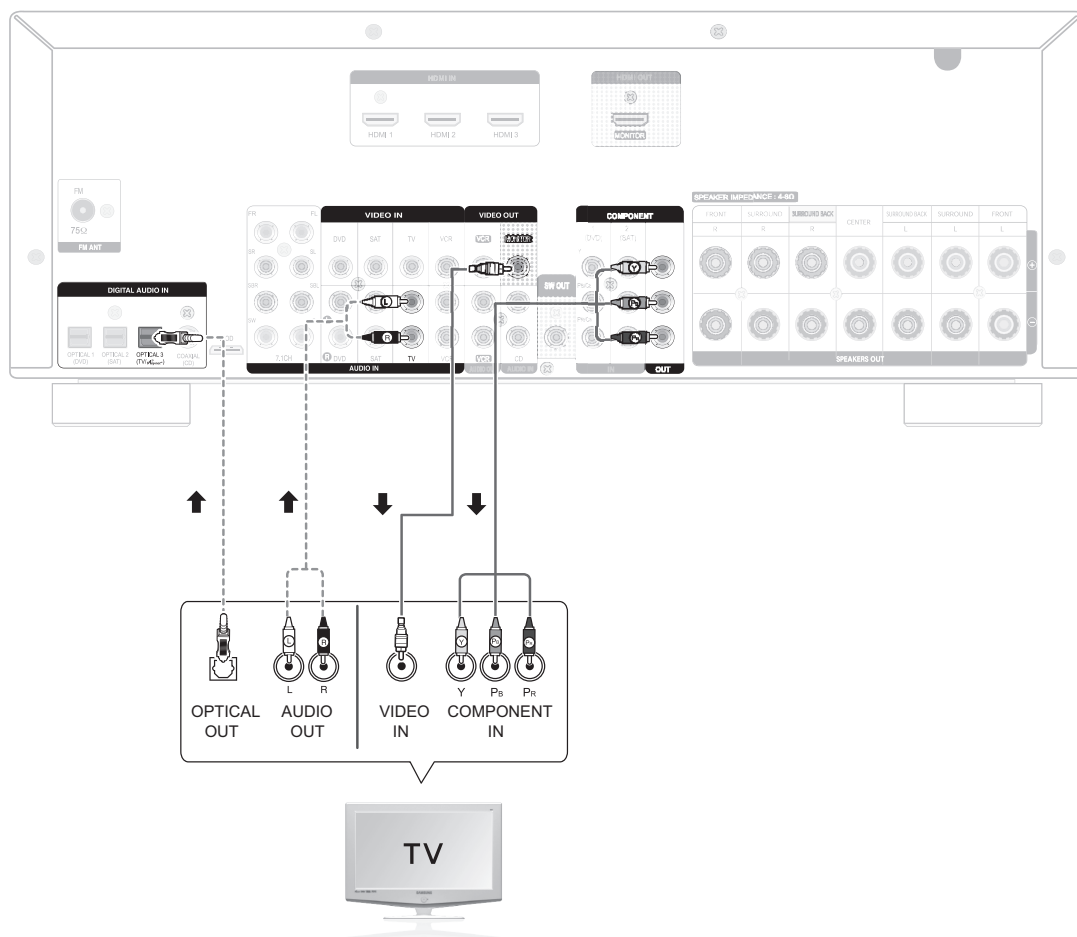

### Video Connection

If your television is equipped with Component Video inputs, connect a Component video cable(not supplied) from the Component Video Output (P<sub>R</sub>, P<sub>B</sub> and Y) jacks on the back of your AV Receiver to the Component Video Input jacks on your TV.

**OR**

Connect the Video cable from the VIDEO OUT (MONITOR) jack on the back of your AV Receiver to the Video Input jack on your TV.

### Audio Connection

Connect the Digital Input (OPTICAL 3) on your AV Receiver to the Digital Output of the TV.

**OR**

Connect AUDIO IN (TV) on your AV Receiver to the Audio Out of the TV.

# CONNECTING EXTERNAL DEVICES/YOUR TV VIA HDMI

HDMI is a digital standard interface for connection to such devices as a TV, projector, DVD player, Blu-ray player, settop box and more.

HDMI removes any loss of signal from analog conversion, enabling you to enjoy video and audio sound quality as it was originally created in the digital source.

By connecting through the HDMI(High-Definition Multimedia Interface) interface, you can play back digital video and audio.

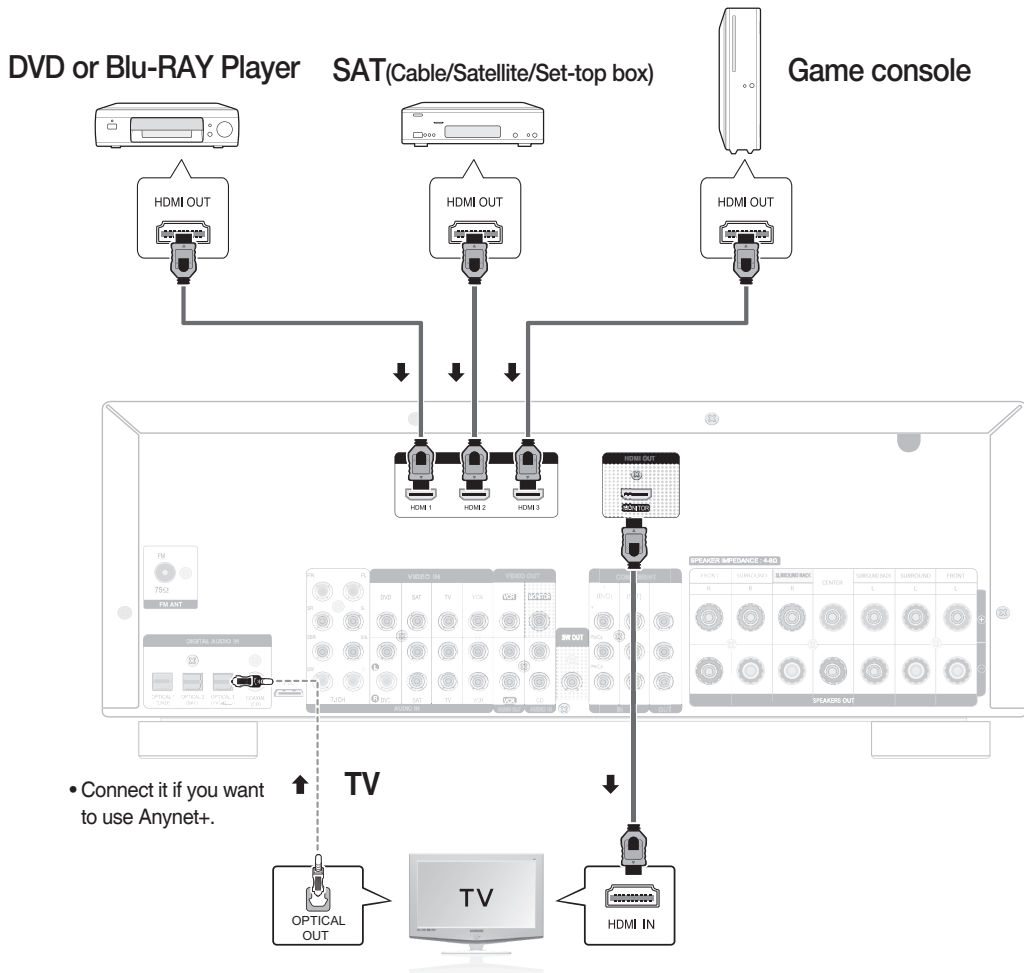

## High-bandwidth Digital Content Protection System (HDCP) support

To play digital contents through the HDMI connection, both of the connected external device and TV must support High-bandwidth Digital Content Protection System (HDCP). This product supports HDCP.

Compatibility with a TV Supporting HDMI	
A TV with an HDMI jack.	Video/Audio
A TV with a DVI-D jack (TV supporting HDCP)	Video
A TV with a DVI-D jack (TV not supporting HDCP)	-

- Audio from SACD discs will not be heard. To play a DVD disc whose copyright is protected by CPPM, use a player supporting CPPM.
- The quality of the audio output through the HDMI jack (sampling frequency and bit rate) may be limited by the performance of the connected device.
- Since HDMI connection supports both video and audio, you don't have to connect an additional audio cable.

## HDMI FUNCTION

### Using Anynet+(HDMI-CEC)

Anynet+ is a function that enables you to control other Samsung Devices with your Samsung TV's remote control. Anynet+ can be used by connecting this AV Receiver to a SAMSUNG TV using an HDMI Cable. This is only available with SAMSUNG TVs that support Anynet+.

1. Connect the AV receiver to a Samsung TV with an HDMI cable. (See page 18)
2. Set the Anynet+ function on your TV.  
(See the TV instructions manual for more information.)
  - You can operate the volume on the AV receiver by using Volume buttons on the TV remote control.

#### If you select the TV

Set the Anynet+(HDMI-CEC) to **On** by pressing the Anynet+ button on your TV.

- **Receiver : On** : You can listen to audio through the AV Receiver.
- **Receiver : Off** : You can listen to audio through the TV.



#### If you select the DVD Player

Select THEATER to connector and set the option of each item below.

- **View TV** : If Anynet+(HDMI-CEC) set to on and you select View TV, the AV receiver will automatically switch to SAT OPTIC2(DIGITAL IN).
- **Receiver : On** : You can listen to audio through the AV receiver.
- **Receiver : Off** : You can listen to audio through the TV.



### To turn off Anynet+

1. Press **SETUP/MENU** button, and then press the **ENTER** button.
  - "SETUP MODE" appears on the display and goes into Setup Mode.
2. Press **◀▶** button to select the "ANYNET+ MODE", and then press the **ENTER** button.
3. Press the **▲▼** button to set ANYNET+ to OFF.
  - If you are using Anynet+, set ANYNET+ to ON and if not, set it to OFF.

#### - To exit setup mode-

- Press **SETUP/MENU, EXIT or RETURN** button.  
"SETUP OFF" appears on the display and Setup Mode is exited.



- If you use an HDMI cable to connect a Samsung TV to your AV Receiver, you can operate the AV receiver using the TV's remote control. This function is available only in connection with Samsung TV and DVD player supporting Anynet+ (HDMI-CEC).
- Please check your TV for the **Anynet+** logo. If your TV has an **Anynet+** logo, then it supports the Anynet+ function.
- When you are making Anynet+ connection, do not connect more than two AV receivers (Anynet+ installed). Otherwise, it can cause a malfunction.
- Anynet+ does not work if the function is set to iPod AUDIO.

## CONNECTING A DVD OR BD(Blu-Ray) PLAYER

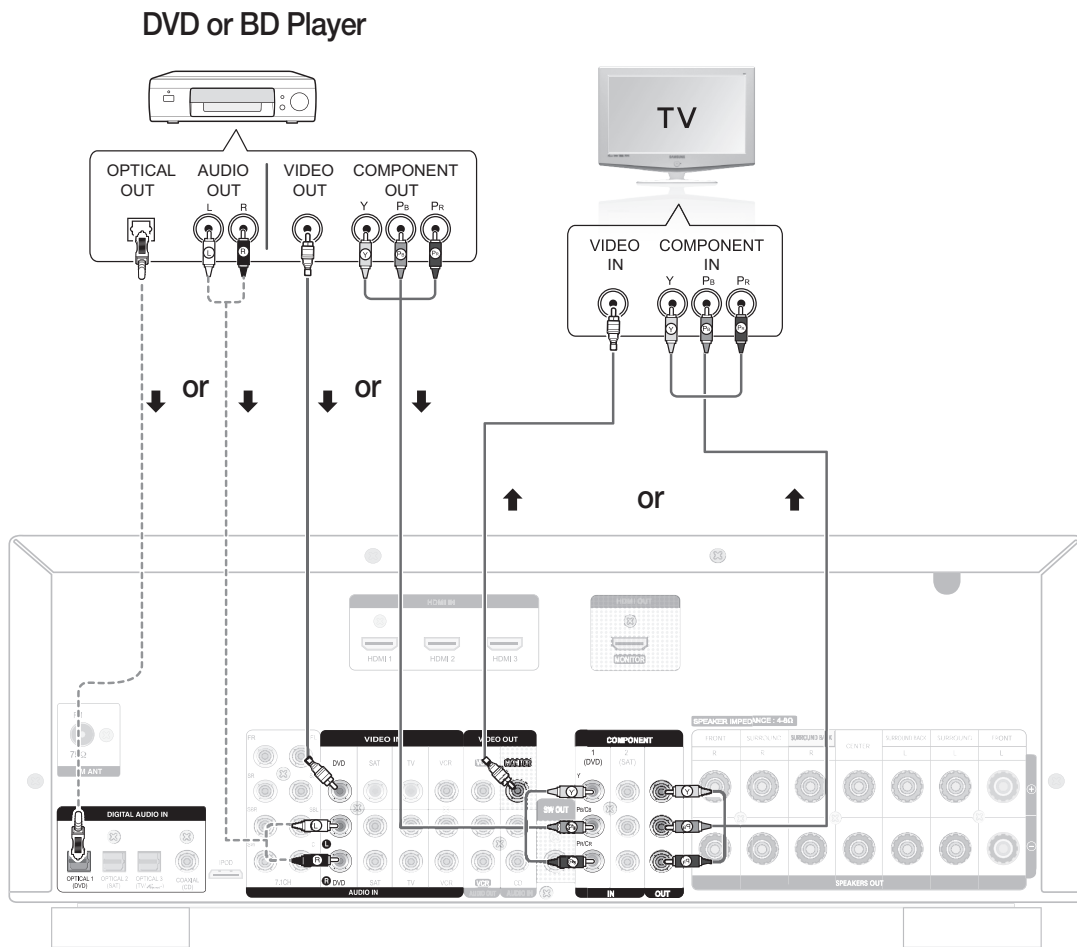

### Video Connection

Connect a Component video cable(not supplied) from the COMPONENT IN (DVD) (P<sub>R</sub>, P<sub>B</sub> and Y) jacks on the back of your AV Receiver to the Component Video Output jacks on your DVD/BD player.

**OR**

Connect a Video cable from the VIDEO IN (DVD) jack on the back of your AV Receiver to the Video Output jack on your DVD/BD player.

### Audio Connection

Connect the Digital Input (OPTICAL 1) on your AV Receiver to the Digital Output of the DVD/BD player.

**OR**

Connect AUDIO IN (DVD) on your AV Receiver to the Audio Out of the DVD/BD player.



## CONNECTING A CABLE, SATELLITE OR SET-TOP BOX

### SAT (Cable/Satellite/Set-top box)

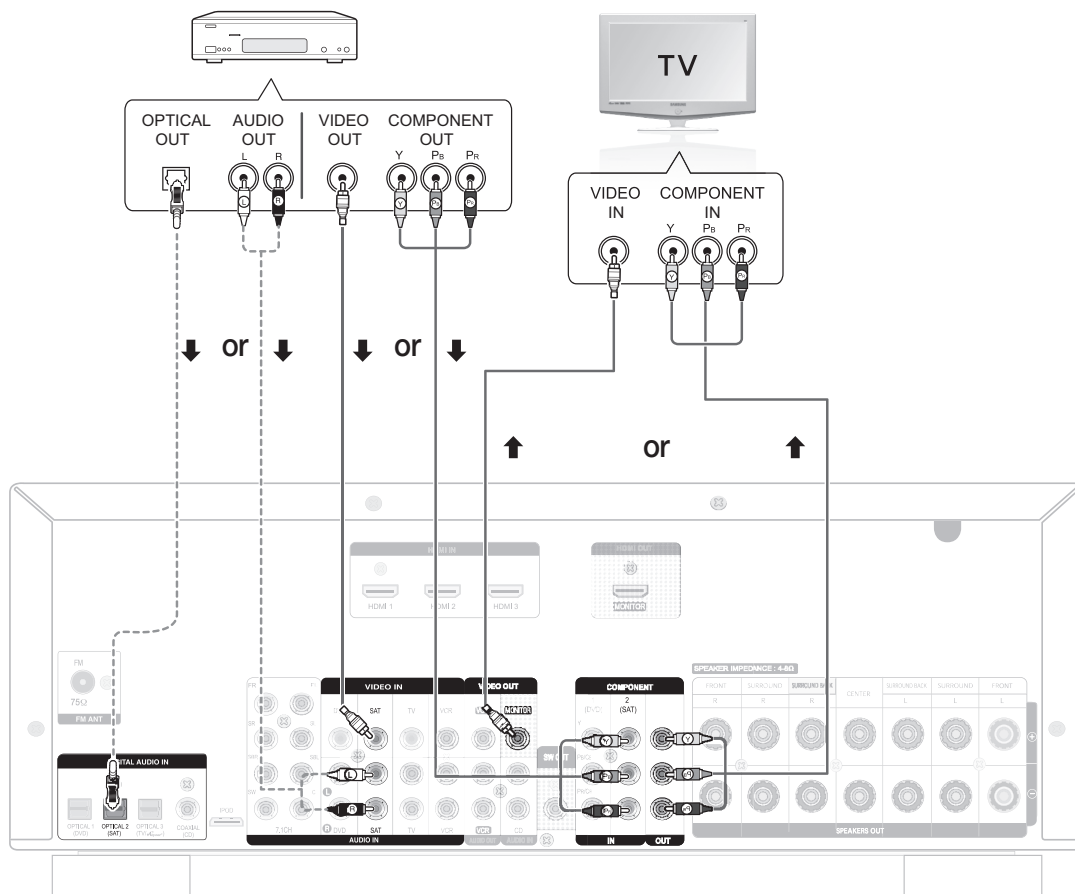

### Video Connection

Connect a Component video cable(not supplied) from the COMPONENT IN (SAT) (P<sub>R</sub>, P<sub>B</sub> and Y) jacks on the back of your AV Receiver to the Component Video Output jacks on your SAT.

**OR**

Connect a Video cable from the VIDEO IN (SAT) jack on the back of your AV Receiver to the Video Output jack on your SAT.

### Audio Connection

Connect the Digital Input (OPTICAL 2) on your AV Receiver to the Digital Output of the SAT.

**OR**

Connect AUDIO IN (SAT) on your AV Receiver to the Audio Out of the SAT.



- Disconnect the power plug from the outlet if you will not use this unit for a long period of time.
- If the external component has only one audio output jack, connect it to either the right or left audio input jack of the main unit. Connect the audio cable's red plug to the red jack and white cable to the white jack.
- If you use the AV Receiver to control your DVD/BD player, the pause function will not work.

## CONNECTING A VCR

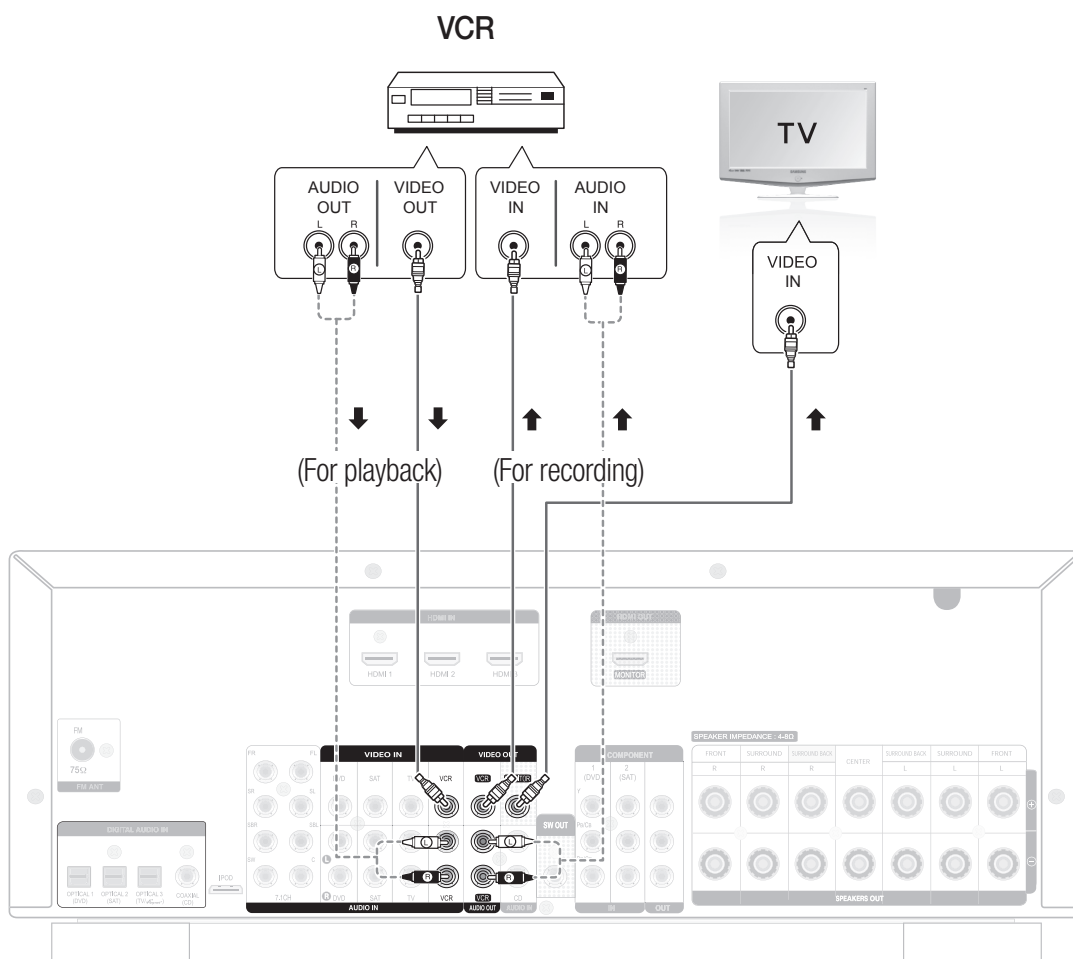

### Video Connection

#### For playback

Connect a Video cable from the VIDEO IN (VCR) jack on the back of your AV Receiver to the Video Output jack on your VCR.

#### For recording

Connect a Video cable from the VIDEO OUT (VCR) jack on the back of your AV Receiver to the Video Input jack on your VCR.

### Audio Connection

#### For playback

Connect AUDIO IN (VCR) on your AV Receiver to the Audio Out of the VCR.

#### For recording

Connect AUDIO OUT (VCR) on your AV Receiver to the Audio In of the VCR.



■ Disconnect the power plug from the outlet if you will not use this unit for a long period of time.

## CONNECTING A CD PLAYER

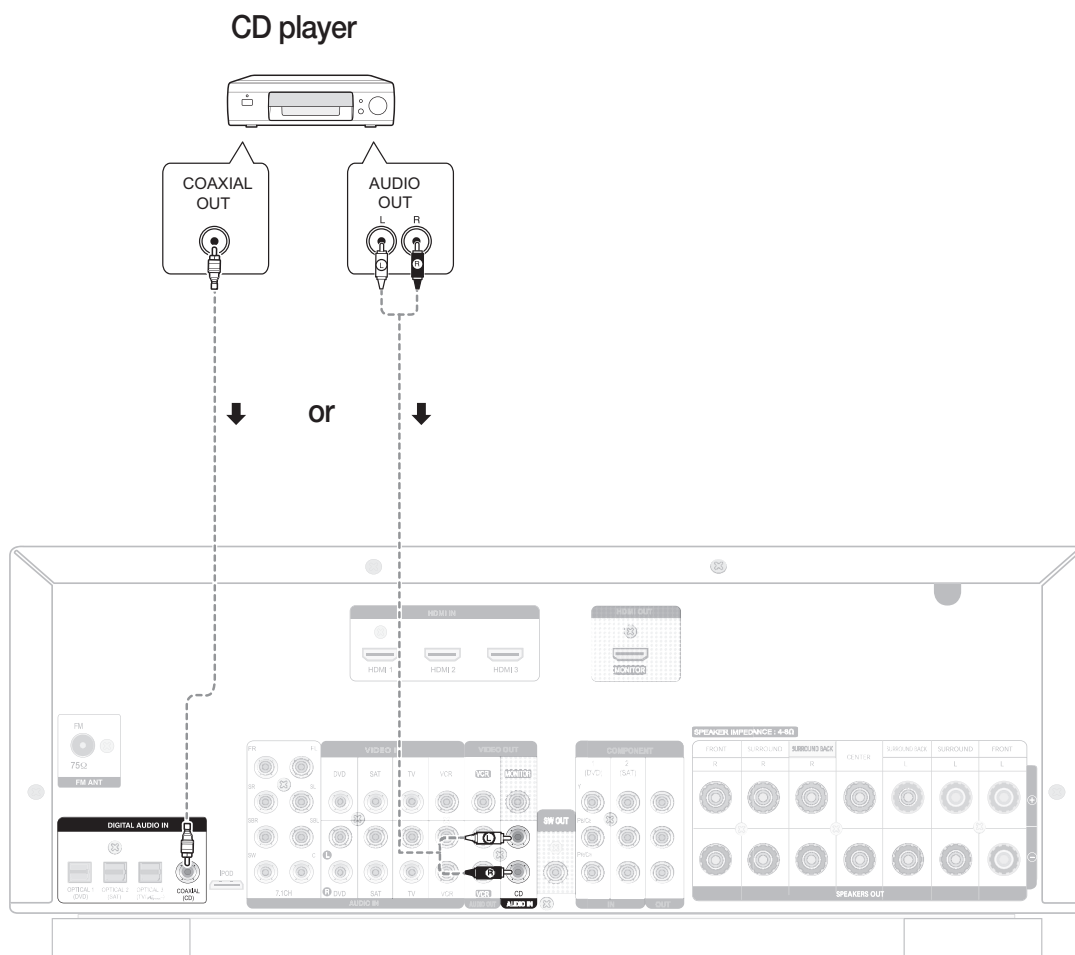

### Audio Connection

Connect the Digital Input (COAXIAL) on your AV Receiver to the Digital Output of the CD Player.

**OR**

Connect AUDIO IN (CD) on your AV Receiver to the Audio Out of the CD player.



- If the external component has only one audio output jack, connect it to either the right or left audio input jack of the main unit. Connect the audio cable's red plug to the red jack and white cable to the white jack.

# CONNECTING 7.1 CHANNEL DEVICES

You can connect the AV receiver to a DVD player, SUPER AUDIO CD player or other device with 7.1 channel output.

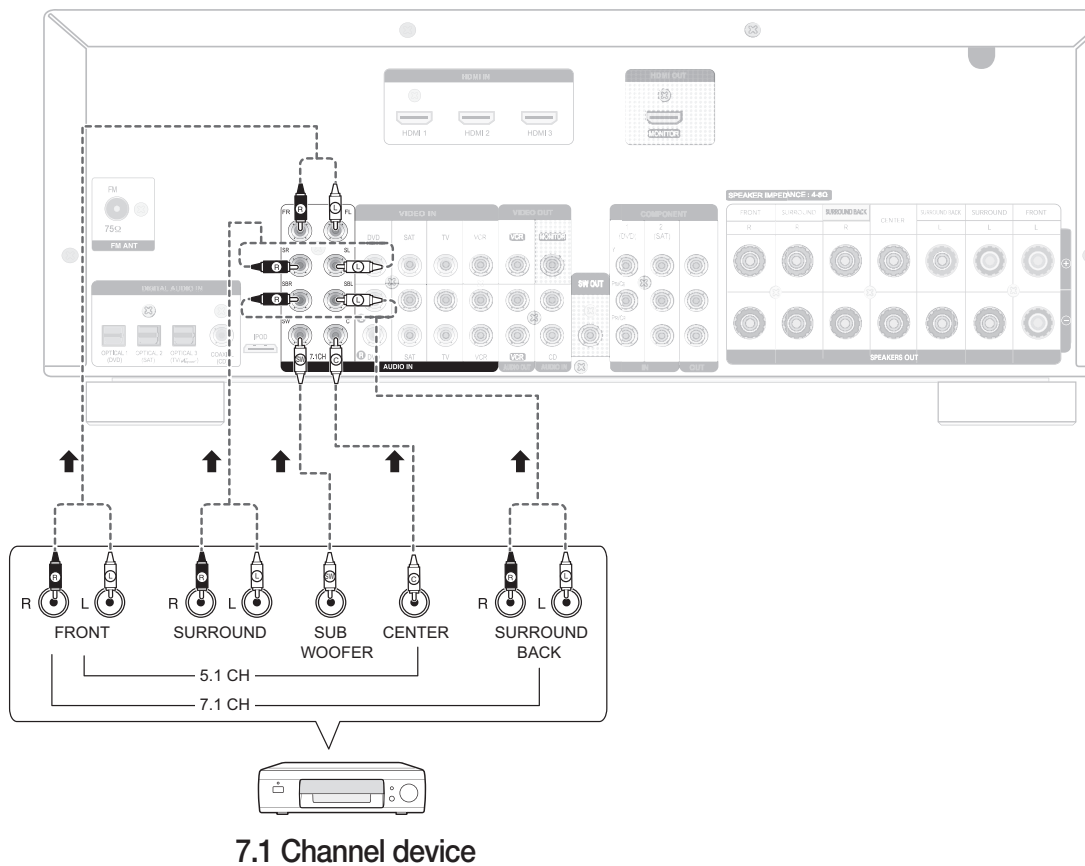

## CONNECTING AN iPod

You can listen to the audio from an iPod through the main unit. For iPod operation with your receiver, see pages 26 and 54 ~ 55.

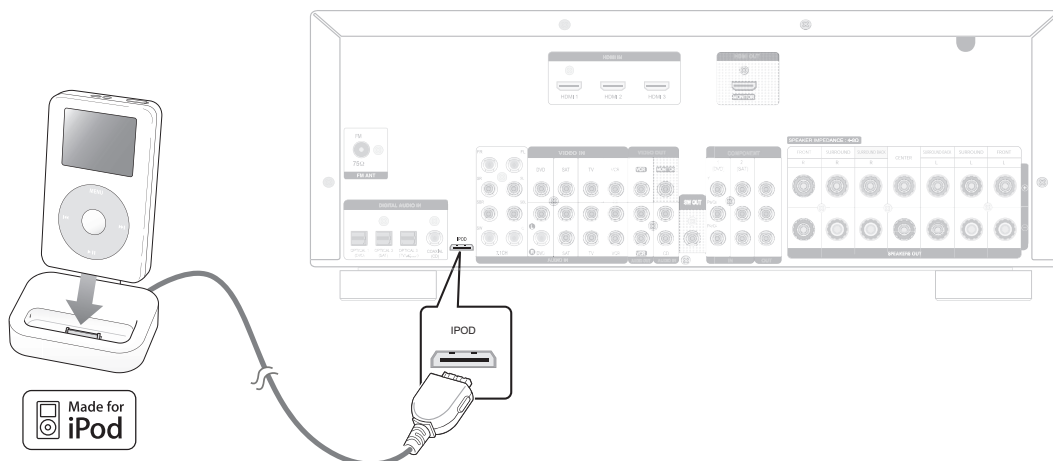

1. Connect the iPod dock connector to the iPod jack on your receiver.
2. Place the iPod in the Dock.
  - If you want to play a movie stored in your iPod player, you should set the player's **TV Out** option to **On** before inserting it into the dock. See page 53.
3. Press the **IPOD** button on the remote control.
  - You can also use the **FUNCTION** button on the main unit.  
The mode switches as follows :  
**FM → DVD → SAT → TV → VCR → CD → AUX → 7.1 MULTI CH → IPOD AUDIO → IPOD VIDEO.**

## Disconnecting an iPod

Follow the steps below to prevent damage to an iPod and data when disconnecting from your AV receiver.

1. Press the **FUNCTION** button on the main unit to switch to a mode other than **IPOD AUDIO** or **IPOD VIDEO**.
- OR
1. Turn off the AV Receiver.
  2. Disconnect the iPod player from the iPod dock, or remove the iPod dock connector from the AV receiver.













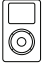

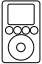
- You must have the VIDEO (Monitor or VCR) output connected to your TV to view iPod video. See page 22.
- Adjust the volume to a moderate level before you connect your iPod and AV Receiver.
- When the unit is powered on and you connect an iPod, the unit will charge your iPod's battery.
- Make sure to connect the dock connector so that the label "**SAMSUNG**" faces upward.
- "Made for iPod" means that an electronic accessory has been designed to connect specifically to iPod and has been certified by the developer to meet Apple performance standards.

## CONNECTING AN iPod (Continued)

---

### iPod models that are compatible with HT-AS730S

---

 <b>iPod</b> 1st+2nd generation 5GB 10GB 20GB	 <b>iPod</b> 5th generation (video) 30GB 60GB 80GB	 <b>iPod</b> 3rd generation 10GB 15GB 20GB 30GB 40GB
 <b>iPod nano</b> 2nd generation(aluminum) 2GB 4GB 8GB	 <b>iPod mini</b> 4GB 6GB	 <b>iPod</b> 4th generation 20GB 40GB
 <b>iPod nano</b> 3rd generation (video) 4GB 8GB	 <b>iPod</b> 4th generation (color display) 20GB 30GB 40GB 60GB	 <b>iPod classic</b> 80GB 120GB 160GB
 <b>iPod touch</b> 1st generation 4GB 16GB 32GB	 <b>iPod nano</b> 4th generation(video) 8GB 16GB	 <b>iPod nano</b> 1st generation 1GB 2GB 4GB
 <b>iPod touch</b> 2nd generation 8GB 16GB 32GB		



- "Made for iPod" means that an electronic accessory has been designed to connect specifically to iPod and has been certified by the developer to meet Apple performance standards.
- Apple is not responsible for the operation of this device or its compliance with safety and regulatory standards.

iPod is a trademark of Apple Inc., registered in the U.S. and other countries.

1. Connect the FM antenna supplied to the FM 75Ω COAXIAL terminal as a temporary measure.
2. Slowly move the antenna wire around until you find a location where reception is good, then fasten it to a wall or other rigid surface.



- Do not place the antenna cable close to the power cord. Keep it as far away as possible.
- If you experience poor FM reception, use an external antenna.

You can connect external devices you use for a short time (camcorder, game console, mobile equipment, etc.) to the front of this unit for convenience.



# Setup

For your convenience, you can set this AV receiver's features for the best use.

## SETUP MENU TREE

Here's a quick look at how the setup menus are organized on your AV Receiver.

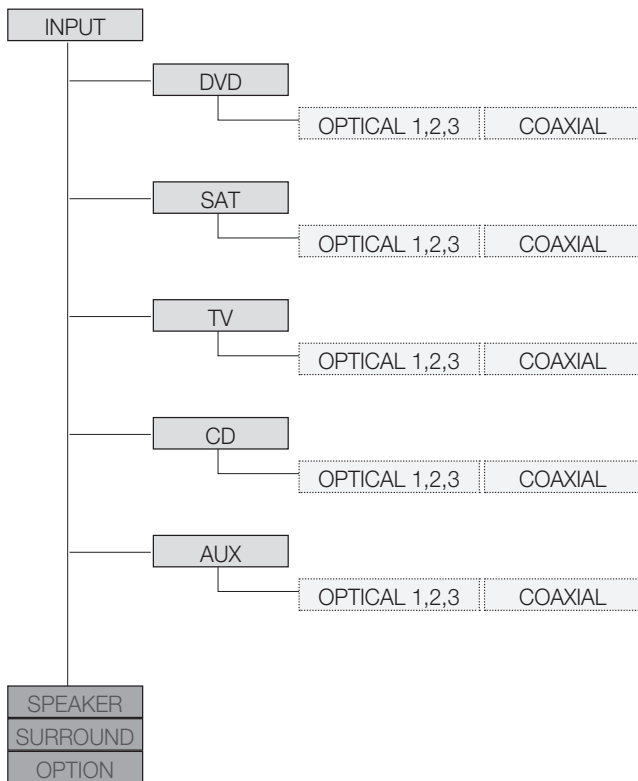



# SETUP MENU TREE (Continued)

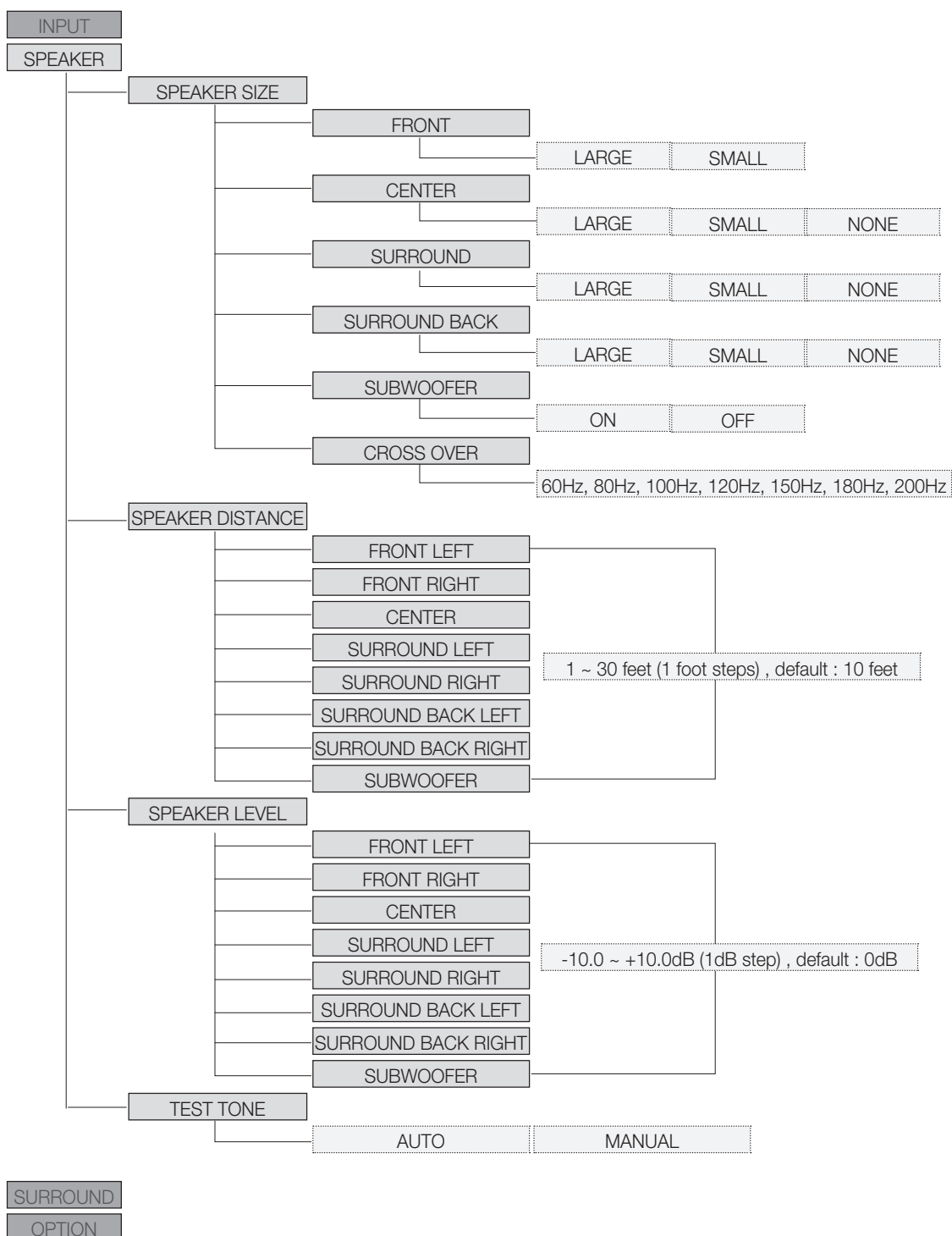

# SETUP MENU TREE (Continued)

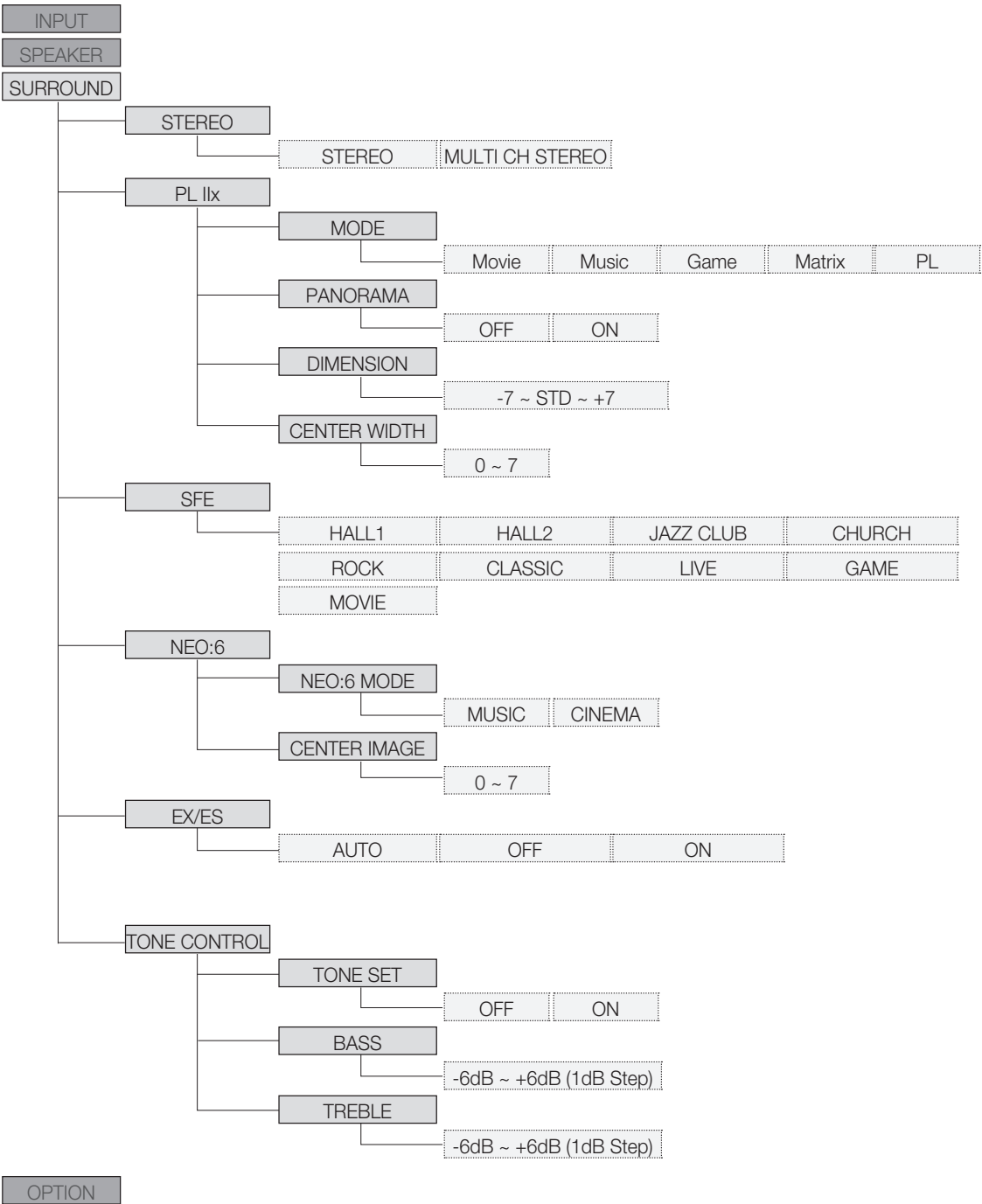

## SETUP MENU TREE (Continued)

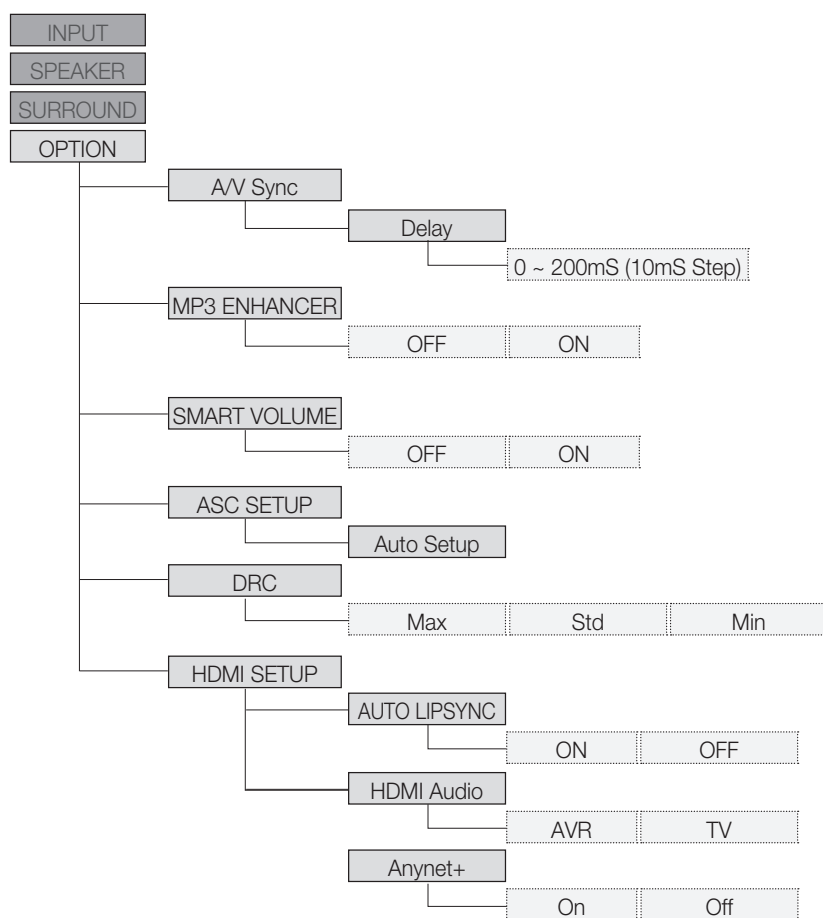

# INPUT SETUP

## Selecting a source device and connection jack

Select the external devices you have connected to the receiver.

1. Press **SETUP/MENU** button
  - "INPUT" appears on the display and goes into Setup Mode.
2. Press the **▶** button to select a desired device.
3. Press the **▲** or **▼** button to select a desired jack.



**- To exit setup mode -**

- Press **SETUP/MENU, EXIT or RETURN** button.  
"SETUP OFF" appears on the display and Setup Mode is exited.

**- Digital Audio Input Select -**

SOURCE DEVICE \ INPUT JACK	AUDIO	Default
DVD	OPTIC1,2,3,COAX	OPTIC1
SAT	OPTIC1,2,3,COAX	OPTIC2
TV	OPTIC1,2,3,COAX	OPTIC3
CD	OPTIC1,2,3,COAX	COAX
AUX	OPTIC1,2,3,COAX	OPTIC1

- You can also use **SETUP**, **◀**, **▶**, **▼**, **▲**, **↵** (ENTER), **↻** (RETURN) and **⏏** (EXIT) buttons on the front of your AV Receiver.
- To move up one level from **SETUP/MENU** or **EXIT SETUP** when the **SETUP** mode is released, press the **RETURN** button.

## SPEAKER SETUP

### Setting the speaker size

Signal outputs and frequency response from the speaker will be adjusted according to your speaker configuration and whether certain speakers are used or not.

1. Press **SETUP/MENU** button.
  - "INPUT" appears on the display.
2. Press **▲▼** button to select "SPEAKER", and then press the **ENTER**.
3. Press **▲▼** button to select "SPK SIZE", and then press the **ENTER** or **▶** button.
4. Press **◀▶** button to select the speaker you want.
  - Each time you press this button, FRONT → CEN → SURR → S.BACK → S.W → CROVR will be selected in turn.
5. Press **▲▼** button to set the mode (LARGE, SMALL etc.) for the selected speaker.
6. Repeat steps 3-4 to set the mode for each speaker.

- To exit setup mode -

- Press **SETUP/MENU, EXIT or RETURN** button.  
"SETUP OFF" appears on the display and Setup Mode is exited.

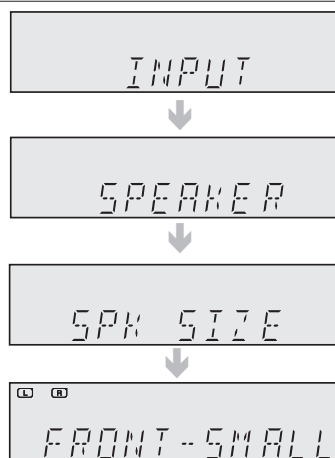

### Setting the Speaker

SPEAKER	Possible Settings	Default Setting
FRONT(Front)	LARGE, SMALL	SMALL
CEN(Center)	LARGE, SMALL, NONE	SMALL
SURR(Surround)	LARGE, SMALL, NONE	SMALL
S.BACK (Surround Back)	LARGE, SMALL, NONE	SMALL
SUB(Subwoofer)	ON, OFF	ON
CROVR (Crossover Frequency)	60, 80, 100, 120, 150, 180, 200(Hz)	150Hz

- **LARGE** : Select when using large speakers. You can listen to full range sound.
- **SMALL** : Select this when using small speakers
- **NONE** : Select when no speaker is used
- **ON (subwoofer)** : Select when using the subwoofer speaker.
- **OFF (subwoofer)** : Select when not using the subwoofer speaker.
- **CROVR** : Select the crossover frequency for the best bass response in your room.

## SPEAKER SETUP (Continued)

### Setting the speaker listening distance

If the speakers cannot be placed at equal distances from the listening position, you can adjust the delay time of the audio signals from the center and surround speakers.

1. Press **SETUP/MENU** button.
  - "INPUT" appears on the display and goes into Setup Mode.
2. Press **▲▼** button to select "SPEAKER", and then press the **ENTER**.
3. Press **▲▼** button to select "SPK DISTANCE", and then press the **ENTER** or **▶** button.
4. Press **◀▶** button to select the speaker you want.
  - Each time you press this button, F.L → F.R → CEN → S.L → S.R → SBL → SBR → S.W will be selected in turn.
5. Press **▲▼** button to set the speaker distance.
  - For FRONT LEFT, FRONT RIGHT, CENTER, SURR. LEFT, SURR. RIGHT, SURR. BACK LEFT, SURR. BACK RIGHT, SUBWOOFER Speaker, you can set the distance from the speaker to listening position between 1ft ~ 30ft (0.3~9.0m) in intervals of 1ft (0.3m).

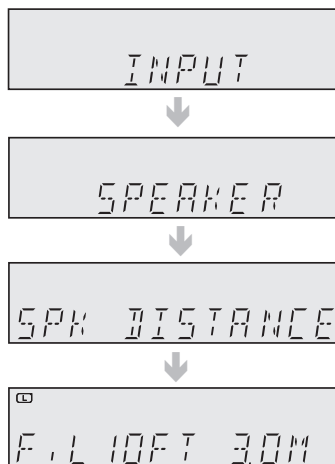

#### - To exit setup mode -

- Press **SETUP/MENU, EXIT or RETURN** button.  
"SETUP OFF" appears on the display and Setup Mode is exited.

#### - Setting Speaker Distance -

Set the distance from the speaker to listening position in intervals of 1ft(0.3m).

- |  |   |
|--|---|
| • F.L (front left) : 1ft ~ 30ft          | • CEN (center) : 1ft ~ 30ft             |
| • F.R (front right) : 1ft ~ 30ft         | • S.R (surround right) : 1ft ~ 30ft     |
| • SBR (surround back right) : 1ft ~ 30ft | • SBL (surround back left) : 1ft ~ 30ft |
| • S.L (surround left) : 1ft ~ 30ft       | • SW (subwoofer) : 1ft ~ 30ft           |



- If the listening position is beyond the range of the speaker distance setup, set the speaker distance to the maximum.
- The distance range of the overall speaker system is determined based on the F.L(front left) speaker distance from the listening position.
- Based on the max delay channel, the distance of the front speaker is 4.9ft(5ms) and the surround speaker can be set up to 14.7ft(15ms).

## SPEAKER SETUP (Continued)

### Setting the speaker level

You can set the balance and level of speakers.

1. Press **SETUP/MENU** button.
  - "INPUT" appears on the display and goes into Setup Mode.
2. Press **▲▼** button to select "SPEAKER", and then press the **ENTER**.
3. Press **▲▼** button to select "SPK LEVEL", and then press the **ENTER** or **▶** button.
4. Press **◀▶** button to select the speaker you want.
  - Each time you press this button, F.L → F.R → CEN → S.L → S.R → SBL → SBR → S.W will be selected in turn.
5. Press **▲▼** button to set the speaker mode.
  - You can adjust it from -10 to +10dB in 1 step increments.
  - The sound gets quieter at -10dB and louder at +10dB.

- To exit setup mode -

- Press **SETUP/MENU, EXIT or RETURN** button.
- "SETUP OFF" appears on the display and Setup Mode is exited.

### Setting Speaker Level

- F.L (front left) : -10 ~ +10dB
- F.R (front right) : -10 ~ +10dB
- CEN (center) : -10 ~ +10dB
- S.L (surround left) : -10 ~ +10dB
- S.R (surround right) : -10 ~ +10dB
- SBL (surround back left) : -10 ~ +10dB
- SBR (surround back right) : -10 ~ +10dB
- S.W (subwoofer) : -10 ~ +10dB

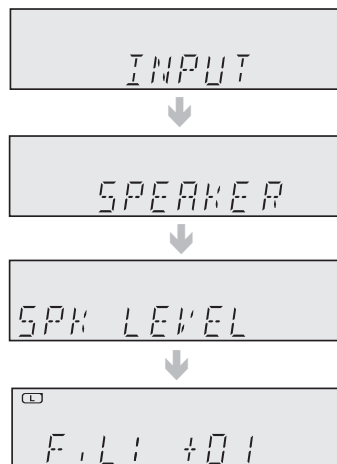

## SPEAKER SETUP (Continued)

### Setting the test tone

Use the test tone to check the speaker connection status or level.

1. Press **SETUP/MENU** button.

- "INPUT" appears on the display and goes into Setup Mode.

2. Press **▲▼** button to select "SPEAKER", and then press the **ENTER**.

3. Press **▲▼** button to select "TEST TONE", and then press the **ENTER** or **▶** button.

4. Press **▲▼** button to select the option you want, and then press the **ENTER** or **▶** button.

- **AUTO** : Test signal will be automatically output as follows;  
F.L → CEN → S.W → F.R → S.R → SBR → SBL → S.L.  
- During test tone output, press **▲▼** button to adjust the speaker output level from -10 to +10 dB by 1 step.

- **MANU** (MANUAL): Enables you to adjust the output level of the speaker manually.

- 1) Press **◀▶** button to select the speaker you want.

Each time you press **◀▶** button, F.L → CEN → S.W → F.R → S.R → SBR → SBL → S.L will be selected in turn.

- 2) Press **▲▼** button to set the test tone as you want.

You can adjust the speaker output level from -10 to +10dB by 1 step.

The sound gets quieter at -10dB and louder at +10dB.

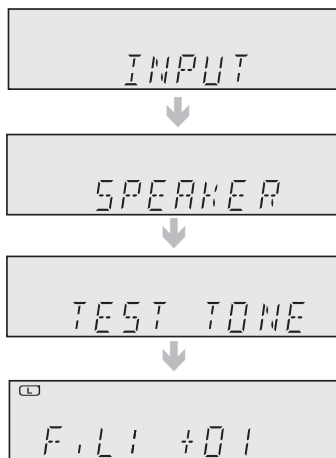

### Test Tone Output

- |                                   |   |
|-----------------------------------|---|
| • F.L (front left) : -10 ~ +10dB  | • S.R (surround right) : -10 ~ +10dB      |
| • CEN (center) : -10 ~ +10dB      | • SBR (surround back right) : -10 ~ +10dB |
| • S.W (subwoofer) : -10 ~ +10dB   | • SBL (surround back left) : -10 ~ +10dB  |
| • F.R (front right) : -10 ~ +10dB | • S.L (surround left) : -10 ~ +10dB       |

### - To stop test tone -

- Press **SETUP/MENU** or **EXIT** button once time.  
"SETUP OFF" appears on the display and test tone stops.



## SURROUND SETUP

### Setting the stereo mode

You can select this mode when listening to sound through the front left and right speakers and subwoofer.

1. Press **SETUP/MENU** button.
    - "INPUT" appears on the display and goes into Setup Mode.
  2. Press **▲▼** button to select "SURROUND", and then press the **ENTER**.
  3. Press **▲▼** button to select "STEREO", and then press the **ENTER** or **▶** button.
  4. Press **▲▼** button to set STEREO mode you want.
    - **STEREO:2CH** : Select this for 2 CH stereo output.
    - **STEREO:MULTI** : Select this for Multi-CH output.
- To exit setup mode -
- Press **SETUP/MENU, EXIT or RETURN** button.  
"SETUP OFF" appears on the display and Setup Mode is exited.

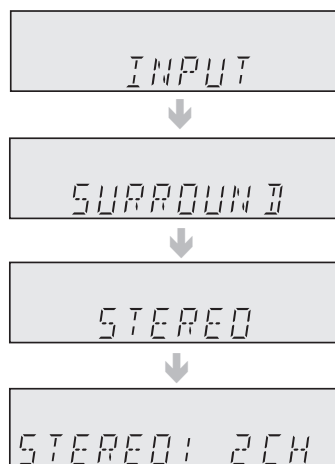

## SURROUND SETUP (Continued)

### Setting Dolby Pro Logic II X mode

This mode provides 7.1 channel sound from 2 channel sources.

1. Press **SETUP/MENU** button.
  - "INPUT" appears on the display and goes into Setup Mode.
2. Press **▲▼** button to select "SURROUND", and then press the **ENTER**.
3. Press **▲▼** button to select "PL II x", and then press the **ENTER** or **►** button.
4. Press **▲▼** button to select the option you want, and then press the **ENTER** or **►** button.

- **MODE** : Each time you press **▲▼** button, MOVIE → MUSIC → GAME → MATRIX → PL will be selected in turn.

**MOVIE** : Adds realism to the movie soundtrack.

**MUSIC** : Provides 7.1 channel surround sound for digital, analog or existing stereo sources such as CD, TAPE, FM, TV and stereo VCR.

**GAME** : Enhances the excitement of the game's sound.

**MATRIX** : You will hear 7.1 channel surround sound.

**PL** : You will experience a surround effect with just the front left and right speakers.

- **PANORAMA** : You can set it ON or OFF.  
(This mode extends the front stereo image to include the surround speakers for an exciting "wraparound" effect with side wall imaging.)
- **DIMENSION** : You can set from -7 to +7.  
(Incrementally adjusts the sound field (DSP) from the front or surround.)
- **CENTER WIDTH** : You can set from 0 to 7.  
(This sets the width of the center image. The higher the setting, the less sound comes from the center speaker.)

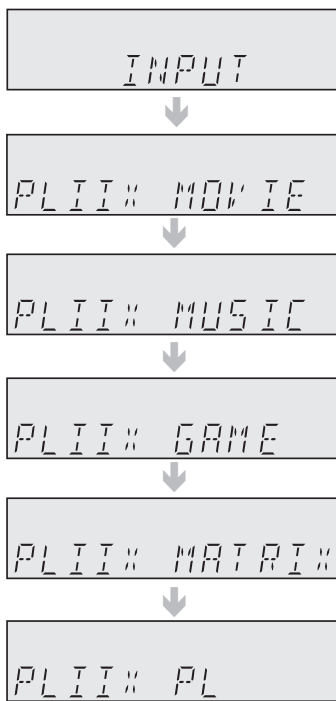

- PANORAMA, DIMENSION and CENTER WIDTH settings are enabled only if the mode is set to "MUSIC".
- You cannot use Dolby Pro Logic IIx mode for multi channel signals such as Dolby Digital and DTS.
- Pro Logic works only for PCM audio signals with sampling frequencies of 32KHz, 44KHz or 48KHz.
- Sound will not be output from the surround back speakers if the PCM audio signal is mono.

## SURROUND SETUP (Continued)

### Setting SFE(Sound Field Effect) mode

The SFE (Sound Field Effect) function uses 9 different DSP sound field effects to digitally simulate actual music environments such as concert halls or cinemas.

1. Press **SETUP/MENU** button.
  - "INPUT" appears on the display and goes into Setup Mode.
2. Press **▲▼** button to select "SURROUND", and then press the **ENTER**.
3. Press **▲▼** button to select "SFE", and then press the **ENTER** or **▶** button.
4. Press **▲▼** button to set the Sound Field Effect you want.
  - Each time you press the button, HALL 1 → HALL 2 → JAZZ CLUB → CHURCH → ROCK → CLASSIC → LIVE → GAME → MOVIE will be selected in turn.

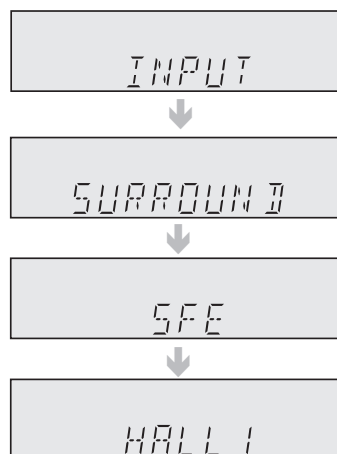

### Setting NEO:6 mode

You can play back 2 channel sound over 6.1 channels when enjoying music or a movie.

1. Press **SETUP/MENU** button.
  - "INPUT" appears on the display and goes into Setup Mode.
2. Press **▲▼** button to select "SURROUND", and then press the **ENTER**.
3. Press **▲▼** button to select "NEO:6", and then press the **ENTER** or **▶** button.
4. Press **▲▼** button to set the NEO:6 mode you want.
  - **NEO:6 MODE** : Each time you press **▲▼** button, MUSIC → CINEMA will be selected in turn.  
This mode decodes 2 channel signals to a high precision digital matrix decoder for 6.1 channel sound.
  - **MUSIC** : NEO:6 MUSIC mode is optimized for music playback
  - **CINEMA** : NEO:6 CINEMA mode is optimized for movie playback.
  - **CENTER IMAGE** : Press **▲▼** button to set the sound image you want.

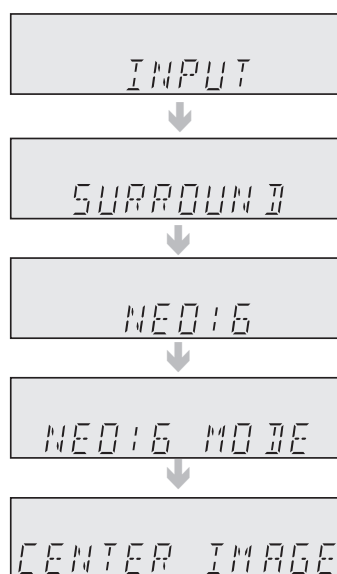

You can set the sound image from 0 to 7

This parameter adjusts the height of the center image through the front and center speakers. "0" is the lowest while "7" is the highest.

#### - To exit setup mode-

- Press **SETUP/MENU, EXIT or RETURN** button.  
"SETUP OFF" appears on the display and Setup Mode is exited.



- NEO:6 mode cannot be used with DTS and Dolby Digital multi channel signals.
- Pro Logic works only for PCM audio signals with sampling frequencies of 32KHz, 44KHz or 48KHz.

## SURROUND SETUP (Continued)

### Setting EX/ES mode

When surround back speakers are connected, you can listen to 6.1 or 7.1 multi-channel sound using the built-in Dolby Digital Surround EX or DTS ES decoder. This function works when a Dolby Digital or DTS source (such as a DVD player) is input, and does not work with L.PCM and Dolby Digital 2 channel sources.

1. Press **SETUP/MENU** button.
  - "INPUT" appears on the display and goes into Setup Mode.
2. Press **▲ ▼** button to select "SURROUND", and then press the **ENTER**.
3. Press **▲ ▼** button to select the "EX / ES", and then press the **ENTER** or **►** button.
  - "EX/ES : AUTO" appears on the display.
4. Press **▲ ▼** button to set the EX/ES you want.
  - **AUTO** : If the unit receives an audio signal that it can recognize, it will select an optimal decoder for playback in 6.1/7.1 channel.
  - If the amplifier does not recognize the audio signal, it will not play in 6.1/7.1 channel automatically.
  - **ON** : Dolby Digital or DTS signal will be played in 6.1 / 7.1 channel using Dolby Digital Surround EX / DTS ES decoder.
  - **OFF** : Dolby Digital Surround EX / DTS ES decoder will not be used for playback.

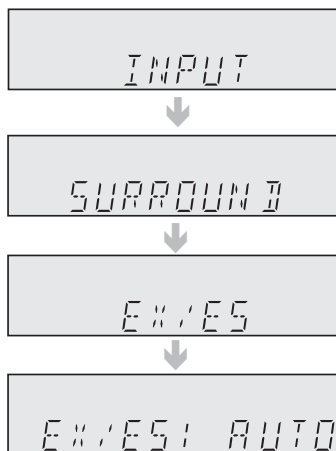

#### - To exit setup mode-

- Press **SETUP/MENU, EXIT or RETURN** button.
- "SETUP OFF" appears on the display and Setup Mode is exited.

### Dolby Digital - EX

Movie soundtracks encoded with Dolby Digital EX will play audio over the surround back channels also.

### DTS-ES (Discrete 6.1, Matrix 6.1)

A surround back channel is added to the DTS 5.1 channel system, improving the sense of sound directionality and space.

A built-in DTS-ES decoder has been equipped with this system that supports discs encoded with DTS-ES Direct and DTS-ES Matrix.



- You cannot use DTS-ES without surround back speakers connected.
- If the input source is in DTS 96/24, you will hear only 5.1 CH sound even if you have set EX/ES to On.

## SURROUND SETUP (Continued)

### Setting Tone Control

This will enable you to adjust the bass and treble level.

1. Press **SETUP/MENU** button.
  - "INPUT" appears on the display and goes into Setup Mode.
2. Press **▲▼** button to select "SURROUND", and then press the **ENTER**.
3. Press **▲▼** button to select "TONE CONTROL", and then press the **ENTER** or **▶** button.
3. Press **▲▼** button.
  - Each time you press this button, TONE SET → BASS → TREBLE will be selected in turn.
  - If it is set to TONE: OFF, the Tone Control function will be disabled..
5. Press **▲▼** button to set the TONE CONTROL you want.
  - You can adjust it from -6 to +6dB by 1 step.
  - The sound gets smaller at -6dB and louder at +6dB.

- To exit setup mode -

- Press **SETUP/MENU, EXIT or RETURN** button.  
"SETUP OFF" appears on the display and Setup Mode is exited.

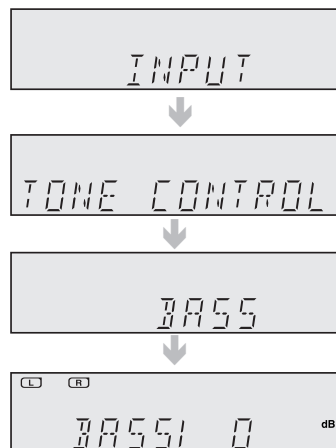

- The Tone Control function can be applied to all channels except for the subwoofer.
- You can also press TEST TONE button on the remote control to use this function.

## OPTION SETUP

The Option menu enables you to make different audio settings to enhance your AV receiver experience.

1. Press **SETUP/MENU** button.
  - "INPUT" appears on the display and goes into Setup Mode.
2. Press **▲▼** button to select the "OPTION", and then press the **ENTER**.
3. Press **▲▼◀▶** button to set the OPTION you want.

### AV SYNC

Video may look slower than the audio if it is connected to a digital TV. If this occurs, adjust the audio delay time to match the video.

- You can adjust it from 0 to 200mS in 10mS steps.

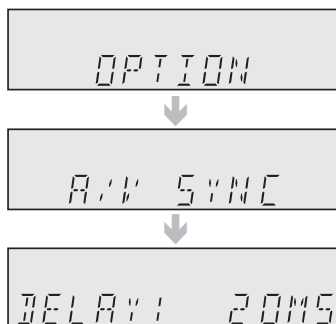

### MP3 Enhancer

This also helps enhance your sound experience (ex. mp3 music). Use this if you want to hear better sound from a low quality mp3 source.

- On
- Off

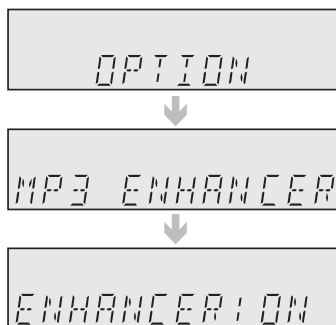

### Smart Volume

This will regulate and stabilize the volume level against a drastic volume change when changing channels or during a scene transition.

- Off
- On

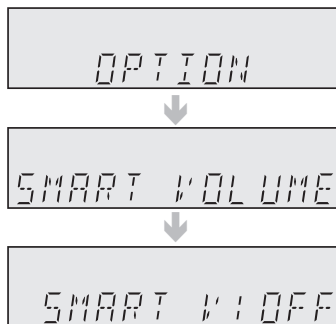

- To move up one level from SETUP/MENU or EXIT SETUP when the SETUP mode is released, press the RETURN button.

## OPTION SETUP (Continued)

### ASC (Auto Sound Calibration)

By setting the ASC function just once when you relocate or install the unit, you can have the unit automatically recognize the distance between speakers, levels between channels, and frequency characteristics to create a 7.1-channel sound field optimized for your environment.

1. Plug the ASC microphone into the ASC input jack.
2. Place the ASC microphone at the listening position.
3. Press **SETUP/MENU** button.
4. Press **▲ ▼** button to select the "OPTION", and then press the **ENTER** or **▶** button.
5. Press **▲ ▼** button to select the "ASC SETUP", and then press the **ENTER** or **▶** button.
6. Press the **ENTER** or **▶** button to select the "ASC AUTO", and then press the **ENTER** or **▶** button.
  - To create the optimal 7.1 channel sound field, the selections are in the following sequence:

**L → C → R → SR → SBR → SBL → SL → SW**

7. If you see a message of "READY" on the screen, press the **ENTER** button to apply the measurement value. And then unplug the ASC microphone.

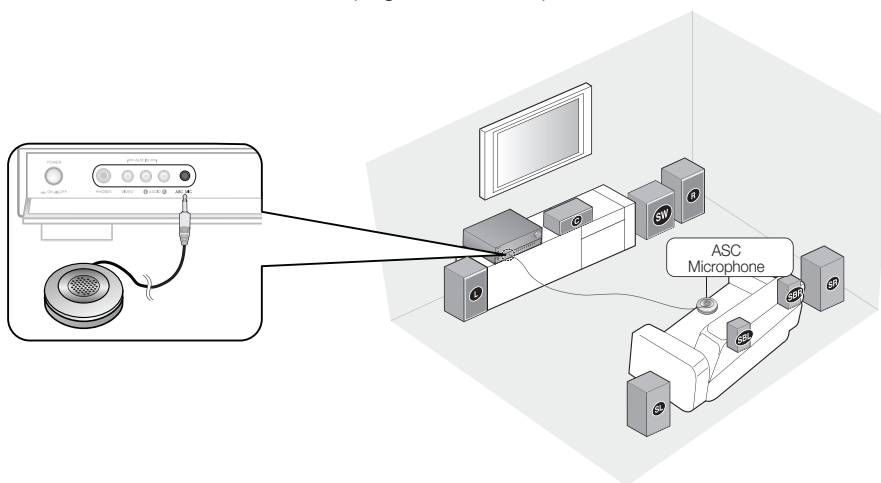
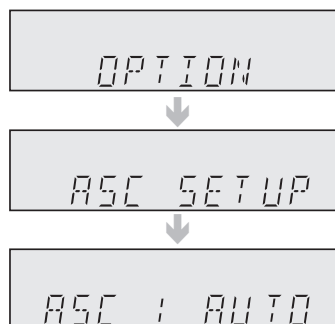

#### To cancel the ASC (Auto Sound Calibration) setup.

This will be automatically reverted if you press the **SETUP/MENU**, **EXIT** or **RETURN** button.



- Setting the ASC function takes about 3 minutes.
- Because the volume level of the tone is fixed during the ASC setup, you cannot adjust the volume using the volume control buttons.
- If the auto sound microphone is disconnected during the ASC setup, the setup will be cancelled.
- When ASC measuring is done with a message of "READY" on the screen, The measurement value will not apply until you press the **ENTER** button .
- To move up one level from **SETUP/MENU** or **EXIT SETUP** when the **SETUP** mode is released, press the **RETURN** button.
- You can also press **ASC** button on the remote control to use this function.

## OPTION SETUP (Continued)

### DRC

You can use this function to enjoy Dolby Digital sound when watching movies at low volume at night. DRC compresses the audio to make the loudest sounds quieter and the quietest sounds louder.

- Each time you press ▲▼ button, DRC : STD → DRC : MIN → DRC : MAX will be selected in turn.

#### Setting DRC

- **STD** : Sets DRC effect to standard.
- **MAX** : Sets DRC effect to maximum.
- **MIN** : Sets DRC effect to minimum.

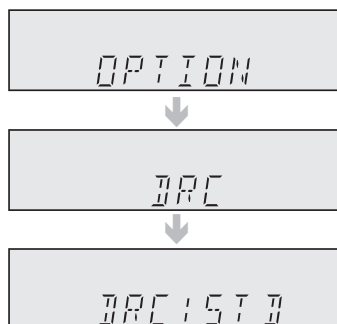

### HDMI Setup

Use this if you want to transfer audio signal using the HDMI cable.

#### 1. HDMI Audio : AVR, TV

This preference determines whether audio received at the HDMI IN is output by the HDMI OUT. You may want to turn this preference on if your TV is connected to the HDMI OUT and you want to listen to the audio from a component that's connected to an HDMI IN, through your TV's speakers.

Normally, this should be set to Off.

- AVR : HDMI audio is not output
- TV : HDMI audio is output

#### 2. Anynet+ Mode : Off, On

Anynet+ is a function that enables you to control other Samsung Devices with your Samsung TV's remote control.

- On : Anynet+ enabled.
- Off : Anynet+ disabled.

#### 3. AUTO LIPSYNC : ON, OFF

The AV receiver can be set to automatically correct any delay between the video and the audio, based on the data from the connected monitor.

- ON : HDMI lip sync enabled.
- OFF : HDMI lip sync disabled.



- HDMI Audio is enabled only if both of HDMI INPUT and HDMI OUT are connected properly and work normally.
- To move up one level from SETUP/MENU or EXIT SETUP when the SETUP mode is released, press the RETURN button.
- This function works only if your HDMI-compatible TV supports HDMI Lip Sync.



# Operation

## BEFORE USING THE AV RECEIVER

### Turning On/Off

Connect the power plug to the outlet.

Press the POWER button of the remote control.

- This unit will be turned on or set to Standby mode.

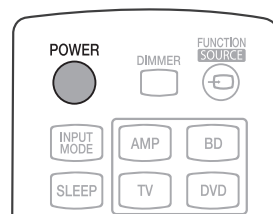

### Remote control functions

You can operate your AMP (this AV receiver), TV, DVD and BD player with this remote control.

See pages 56 ~ 58 for more details.

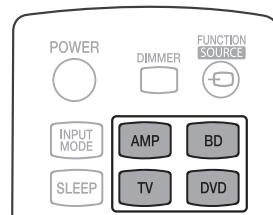

### To select a function

#### Method 1

Press the Function button.

- Each time you press this button, **FM** → **DVD** → **SAT** → **TV** → **VCR** → **CD** → **AUX** → **7.1 MULTI CH** → **IPOD** will be selected in turn.

#### Method 2

Press DVD/BD, SAT, TV, VCR, CD, AUX, 7.1CH, IPOD or TUNER button.

- You can directly select the desired function.

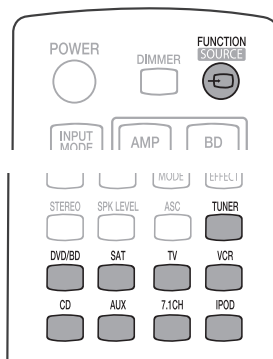

## SELECTING DIGITAL/ANALOG INPUT

You can listen to sound in 2 channel analog , Dolby Digital or DTS using this unit.  
Press the **INPUT MODE** button on the remote control to select the external device you have connected.

- Each time you press this button, input mode changes as follows:

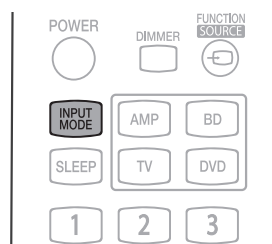

### For DVD/SAT function

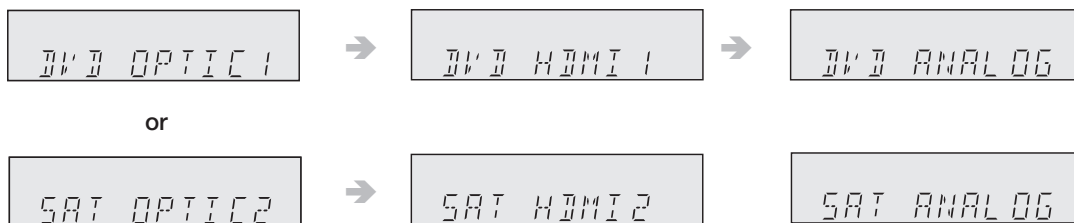

### For CD function



### For AUX function

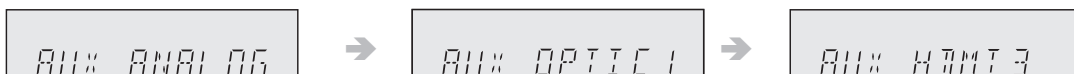

- You can also change input mode by pressing the INPUT MODE button on the front of your AV Receiver.
- You can change the detailed input setting in the "INPUT" setup. (See page 32)
- You can enjoy Dolby Digital or DTS if you connect the digital audio output jack of an external audio component to the optical or coaxial digital audio input jack on the main unit.

## USING THE SURROUND MODES

### Using the NEO:6 MODE button

Press **NEO:6 MODE** button.-

- Each time you press this button, MUSIC → CINEMA will be selected in turn.

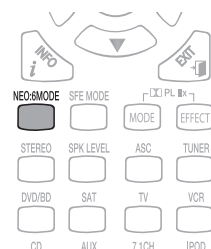

### Using the SFE MODE button

Press **SFE MODE** button.

- Each time you press this button, HALL 1 → HALL 2 → J.CLUB → CHURCH → ROCK → CLASSIC → LIVE → GAME will be selected in turn.

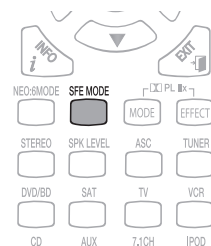

### Using the DOLBY PL IIx MODE button

Press **DOLBY PL IIx MODE** button.

- Each time you press this button, MOVIE → MUSIC → GAME → MATRIX → PL will be selected in turn.

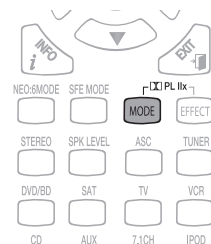

### Using the DOLBY PL IIx EFFECT button

- Press **DOLBY PL IIx MODE** button to select 'MUSIC' Mode.
- Press **DOLBY PL IIx EFFECT** button
  - Each time you press this button, C-WIDTH → DIMENSION → PANORAMA will be selected in turn.
- Press **▲▼** button to select Dolby Pro Logic IIx effect you want.
  - C-WIDTH** : You can set from 0 to 7.
  - DIMENSION** : You can set from -7 to +7.
  - PANORAMA** : You can set it ON or OFF.

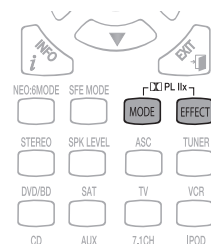

### Using the STEREO button

Press **STEREO** button.

- Outputs the sound of the selected source device in 2 CH stereo.

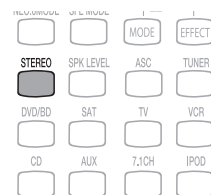

## USING THE SURROUND MODES (Continued)

---

### Using the SURROUND button on the front of the main unit

---

#### Selecting the NEO:6 mode

1. Press **SURROUND** button briefly to select "NEO:6" mode.
  - Each time you press this button, STEREO → PLIIx → NEO:6 → SFE will be selected in turn.
2. Press **SELECT** ( **▼**, **▲** ) button.
  - Each time you press this button, MUSIC → CINEMA will be selected in turn.

#### Selecting the SFE mode

1. Press **SURROUND** button to select 'SFE' Mode.
  - Each time you press this button, STEREO → PLIIx → NEO:6 → SFE will be selected in turn.
2. Press **SELECT**( **▼**, **▲** ) button.
  - Each time you press **SELECT** ( **▼**, **▲** ) button,  
HALL 1 → HALL 2 → J.CLUB → CHURCH → ROCK → CLASSIC → LIVE → GAME will be selected in turn.

#### Selecting the PLIIX mode

1. Press **SURROUND** button to select "PLIIX" mode.
  - Each time you press this button, STEREO → PLIIx → NEO:6 → SFE will be selected in turn.
2. Press **SELECT**( **▼**, **▲** ) button.
  - Each time you press **SELECT** ( **▼**, **▲** ) button, MOVIE → MUSIC → GAME → MATRIX → PL will be selected in turn.



- You cannot use Dolby Pro Logic IIx mode for multi channel signals such as Dolby Digital and DTS.
- Pro Logic works only for PCM audio signals with sampling frequencies of 32KHz, 44KHz or 48KHz.
- Sound will not be output from the surround back speaker if the PCM audio signal is mono.

#### Selecting the STEREO mode

Press **SURROUND** button to select "STEREO" mode.

- Each time you press this button, STEREO → PLIIx → NEO:6 → SFE will be selected in turn.

## USING THE SURROUND MODES (Continued)

### Surround Mode and Input Signal Chart

o = active, – = inactive

Surround Mode	Input Signal	Decoding	Output Channel					Display Information	
			L/R	C	SL SR	SBL SBR	SubW	Display Signal Format	Channel Status
DOLBY (MUSIC, CINEMA, MATRIX, GAME, PRO LOGIC)	Dolby D Surr. EX	Dolby Digital 5.1	o	o	o	o	o	DIGITAL	L, C, R, SL, SR, SBL, SBR, SW
	Dolby D (5.1ch)	Dolby Digital 5.1	o	o	o	–	o	DIGITAL	L, C, R, SL, SR, SW
	Dolby D (2ch)	Pro Logic II x	o	o	o	o	o	DIGITAL	L, C, R, SL, SR, SBL, SBR, SW
	Dolby D (2ch Surr)	Pro Logic II x	o	o	o	o	o	DIGITAL	L, C, R, SL, SR, SBL, SBR, SW
	L.PCM (Audio)	Pro Logic II x	o	o	o	o	o	L.PCM	L, C, R, SL, SR, SBL, SBR, SW
NEO:6 (MUSIC, CINEMA)	Analog	Pro Logic II x	o	o	o	o	o	Analog	L, C, R, SL, SR, SBL, SBR, SW
	L.PCM (Audio)	Neo:6	o	o	o	o	o	L.PCM	L, C, R, SL, SR, SBL, SBR, SW
	Analog	Neo:6	o	o	o	o	o	Analog	L, C, R, SL, SR, SBL, SBR, SW
	Dolby D (2ch)	Neo:6	o	o	o	o	o	DIGITAL	L, C, R, SL, SR, SBL, SBR, SW
SFE	Dolby D (2ch Surr)	Neo:6	o	o	o	o	o	DIGITAL	L, C, R, SL, SR, SBL, SBR, SW
	Dolby D (2ch)	DD+SFE	o	o	o	–	o	DIGITAL	L, C, R, SL, SR, SBL, SBR, SW
	Dolby D (2ch Surr)	DD+SFE	o	o	o	–	o	DIGITAL	L, C, R, SL, SR, SBL, SBR, SW
	L.PCM (Audio)	SFE	o	o	o	–	o	L.PCM	L, C, R, SL, SR, SBL, SBR, SW
EX/ES	Analog	SFE	o	o	o	–	o	Analog	L, C, R, SL, SR, SBL, SBR, SW
	Dolby D Surr. EX	Dolby Digital EX	o	o	o	o	o	DIGITAL	L, C, R, SL, SR, SBL, SBR, SW
	Dolby D (5.1ch)	Dolby Digital EX	o	o	o	o	o	DIGITAL	L, C, R, SL, SR, SBL, SBR, SW
	DTS-ES	DTS-ES	o	o	o	o	o	dtc, ES	L, C, R, SL, SR, SBL, SBR, SW
STEREO	DTS (5.1ch)	DTS-ES	o	o	o	o	o	dtc	L, C, R, SL, SR, SBL, SBR, SW
	Dolby D (2ch)	Stereo	o	–	–	–	o	DIGITAL	L, R, SW
	Dolby D (2ch Surr)	Stereo	o	–	–	–	o	DIGITAL	L, R, SW
	L.PCM (Audio)	Stereo	o	–	–	–	o	L.PCM	L, R, SW
	L.PCM 96KHz	Stereo	o	–	–	–	o	L.PCM	L, R, SW
	Analog	Stereo	o	–	–	–	o	Analog	L, R, SW

- **L/R** : front speaker (left/right)
- C** : center speaker
- SL/SR** : surround speaker (left/right)
- SBL/SBR** : surround back speaker (left/right)
- SW** : subwoofer



- Channel status displays are dependent on the speaker configuration.
- SFE mode works with 2-ch signals.

## USING THE SPEAKER ADJUSTMENT BUTTONS

### Using the SPK SELECT button

1. Press **SPK SELECT** button to select the speaker you want.
  - Each time you press this button, FRONT → CEN → SURR → S.BACK → S.W → CROVR → SPK MODE OFF will be selected in turn
2. Press **▲▼** button to set the mode (Large, Small etc.) for the selected speaker.
  - Repeat steps 1-2 to set the mode for each speaker.



### Using the SPK LEVEL button

1. Press **SPK LEVEL** button to select the speaker you want.
  - Each time you press this button, F.L → F.R → CEN → S.L → S.R → SBL → SBR → S.W → SPK LVL OFF will be selected in turn.
2. Press **▲▼** button to set the speaker level you want.
  - You can adjust it from -10 to +10dB by 1 step.
  - The sound gets quieter at -10dB and louder at +10dB.

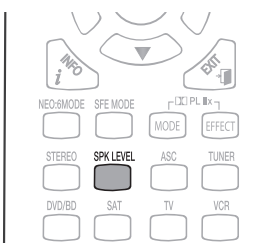

### Using the Test Tone button

Press **TEST TONE** button.

- Test signal will be automatically output as follows; F.L → CEN → S.W → F.R → S.R → SBR → SBL → S.L
- During test tone output, press **▲▼** button to adjust the speaker output level from -10 to +10 dB in 1 step increments.



## LISTENING TO THE RADIO

You can listen to the radio by using either automatic or manual tuning.

1. Press **TUNER** button.
2. Selected frequency.
  - Automatic tuning 1 :
    - 1) Press TUNING MODE button to select PRESET.
    - 2) Press TUNING/CH ( **▼**, **▲** ) button to select the preset frequency.
  - Automatic tuning 2 :
    - 1) Press TUNING MODE button to select MANUAL.
    - 2) Press and hold TUNING/CH ( **▼**, **▲** ) button to automatically tune in frequency.
  - Manual tuning :
    - 1) Press TUNING MODE button to select MANUAL.
    - 2) Press TUNING/CH ( **▼**, **▲** ) button briefly to increase or decrease the frequency step by step.



■ You can also select FM by pressing the FUNCTION button on the front of your AV Receiver.

### To Listen to mono/stereo

Press **MO/ST** button on the remote.

- Each time you press this button, STEREO → MONO will be selected in turn.
- If you select MONO in an area with weak reception, it will help to reduce noise.
- This function works only with the Remote Control.

## Presetting radio stations

You can preset up to 30 FM stations.

E.g.: Setting station FM 89.10 in preset 2.

1. Press **TUNER** button.
2. Press TUNING MODE button to select MANUAL and then press **TUNING/CH** ( **▼**, **▲** ) button to select 89.10.
  - Refer to step 2 above to tune in automatically and manually.
3. Press **TUNER MEMORY** button.
  - Tuner number will blink on the display.
4. Press **TUNING/CH** ( **▼**, **▲** ) button to select preset 2.
  - You can select from presets 1 to 30.
5. Press **TUNER MEMORY** button.
  - Tuner number will disappear and station 89.10 will be saved in preset 2.
6. To preset other stations, repeat steps 2 to 5.

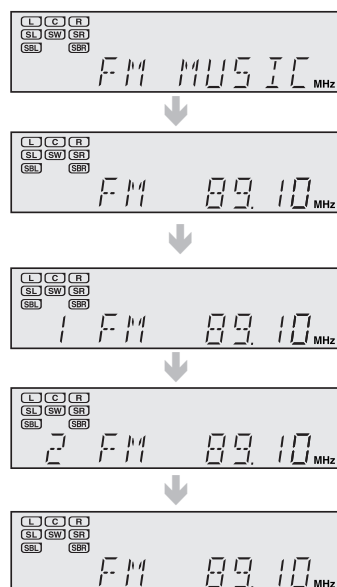

### To Listen to Preset Station

- Press **TUNING MODE** button of the remote control to select the PRESET and press **TUNING/CH** ( **▼**, **▲** ) button.

## USING AN iPod

---

You can enjoy playback of your iPod using the supplied remote control.

### Listening to Music (IPOD audio function)

---

You can play music files stored in the iPod player by connecting it to the AV receiver.

1. Connect the iPod dock connector to the iPod jack on the AV Receiver.
2. Place the iPod in the Dock.
  - Your iPod is automatically turned on.
3. Press the **FUNCTION** button on the remote control to select **IPOD** mode.
  - Press the **FUNCTION** button until **IPOD AUDIO** is selected
4. Press the **PLAY** button on the remote control to play.
  - The AV receiver starts playing from the first track of the iPod player.
5. You can use the remote control or main unit to control simple playback functions such as **PLAY**, **PAUSE**, **STOP**, **F-SKIP** (⏮) and **B-SKIP** (⏭).

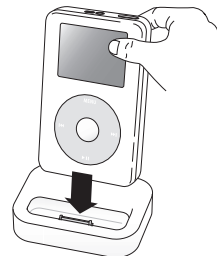

- See page 26 for compatible iPods.  
Compatibility depends on the software version of your iPod.  
This product only supports playing audio from your iPod.



## USING AN iPod (Continued)

### Watching a Movie (IPOD Video function)

You can play video files stored in the iPod player by connecting it to the AV receiver.

1. Connect the iPod dock connector to the iPod jack on the AV receiver.
2. In the iPod screen, move to **Videos > Settings** and set the **TV Out** option to **On**.
3. Place the iPod in the Dock.
4. Press the **FUNCTION** button on the remote control to select **IPOD** mode.
  - If the iPod player is connected to the AV receiver, each time you press the **FUNCTION** button, it will be toggled in the order of **IPOD AUDIO** → **IPOD VIDEO**.
5. Set the AV IN option of the TV connected to the AV receiver to COMPOSITE.

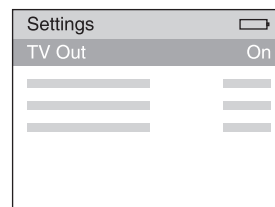

<iPod Screen>

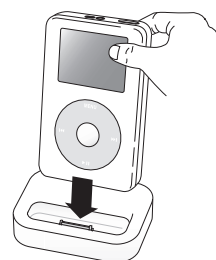

Follow the iPod onscreen guide through the following steps.

6. Press the **▲**, **▼** buttons on the remote control to select **Videos** and press the **ENTER** button.
7. Press the **▲**, **▼** buttons on the remote control to select **Movies** and press the **ENTER** button.
8. Press the **▲**, **▼** buttons to select the file to play and press the **ENTER** button.
  - Video files of the iPod player will be played on the TV screen.
9. You can use the remote control or main unit to control simple playback functions such as **PLAY**, **PAUSE**, **STOP**, and **◀▶**.
  - If you press the **PREV** button within 3 seconds after the playback, the player will stop playing and return to the list screen.
  - If you press the **PREV** button 3 seconds or later after the playback, the player will move to the start screen of the current file.
  - Press the **NEXT** button to stop playing and return to the list screen.
  - Press the **RETURN** button to return to the previous menu.

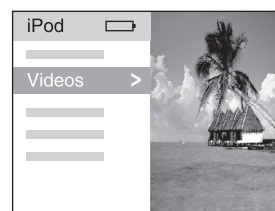

<iPod Screen>



- You must have the VIDEO (Monitor or VCR) output connected to your TV to view iPod video.
- See page 26 for compatible iPods.  
Compatibility depends on the software version of your iPod.
- When the current file is played to the end, the next file will not be played automatically. To play the next file, select a file to play in the list screen of the iPod player.
- No other screen than the playback one will appear on the TV screen. Check other screens on the iPod player.

## CONVENIENT FUNCTIONS

### Sleep timer function

You can set the time that this unit will shut itself off.

Press **SLEEP** button.

- SLEEP : OFF → 15 → 30 → 45 → 60 → 90 → 120 M (MIN) will be selected in turn.

#### To check sleep timer

Press the **SLEEP** button.

- The remaining time before this unit will shut itself off is shown on the display.
- Pressing the button again changes the sleep time from what you set previously.

#### To cancel sleep timer

- Press SLEEP button until “SLEEP : OFF” appears on the display.



### Mute function

This function is useful when answering a doorbell or telephone call.

Press the **MUTE** button.

- MUTE appears on the display.

#### To output sound again

Press the **MUTE** button again.

- MUTE will disappear and sound will output.



- SLEEP, Mute and the Adjust Display functions can only be operated with the remote control.

### Reset function

Signal outputs and frequency response from the speaker will be adjusted according to your speaker configuration and whether certain speakers are used or not.

1. Press the **MUTE** button.
  - MUTE appears on the display.
2. Press “0” button five times and then press the **ENTER** button.
  - “INITIAL : NO” appears on the display.
3. Press ▲▼ buttons to select “YES”.
  - The unit will turn off after 5 seconds.

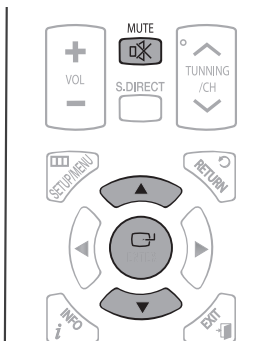

#### Using the SELECT button

1. Turn off the power and hold the **SELECT** (▼,▲) button for longer than 5 seconds.
  - POWER STANDBY indicator will flash.



- Using the RESET function will erase all stored settings.
- Do not use this unless necessary.

## CONVENIENT FUNCTIONS (Continued)

### Adjust the display

You can adjust the brightness of the display.

Press the **DIMMER** button.

- Each time you press this, the brightness changes as follows : DARK → BRIGHT.

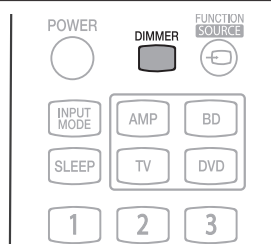

### Using headphones

Use headphones (not supplied) for private listening pleasure.

Connect the headphones to the headphone jack and listen to music.



- Do not turn the volume up too high when you use headphones as It may damage your hearing.

## OPERATING YOUR TV WITH THE REMOTE CONTROL

---

1. Press **POWER** button to turn on the TV.
2. Press **TV** button to set the remote to TV mode.
3. Point the remote control toward the TV.
4. While holding down **POWER** button, enter the code corresponding to your brand of TV.
  - If there is more than one code listed for your TV in the table, enter one at a time to determine which code works.
  - If the code matches the TV's code, the TV will be turned off.
5. If TV is turned on or off when you press the power button of the remote control, the setting is completed.
  - You can use the TV POWER, VOLUME, CHANNEL, MENU and Numeric buttons (0~9).



- The remote control may not work on some brands of TVs. Also, some operations may not be possible depending on your brand of TV.
- The remote control will work with Samsung TVs by default.

# OPERATING YOUR TV WITH THE REMOTE CONTROL (Continued)

## TV Brand Code List

Brand	Code Number	Brand	Code Number	Brand	Code Number
Admiral (M.Wards)	056, 057, 058	Luxman	018	Sylvania	018, 040, 048, 054, 059, 060, 062
A Mark	001, 015	LXI (Sears)	019, 054, 056, 059, 060, 062, 063, 065, 071	Symphonic	061, 095, 096
Anam	001, 002, 003, 004, 005, 006, 007, 008, 009, 010, 011, 012, 013, 014	Magnavox	015, 017, 018, 048, 054, 059, 060, 062, 072, 089	Tatung	006
AOC	001, 018, 040, 048	Marantz	040, 054	Techwood	018
Bell & Howell (M.Wards)	057, 058, 081	Matsui	054	Teknika	003, 015, 018, 025
Brocsonic	059, 060	MGA	018, 040	TMK	018, 040
Candle	018	Mitsubishi/MGA	018, 040, 054, 059, 060, 075, 101	Toshiba	019, 057, 063, 071, 101, 107, 109, 110, 111, 113
Cetronic	003	MTC	018	Vidtech	018
Citizen	003, 018, 025	NEC	018, 019, 020, 040, 059, 060	Videch	059, 060, 069
CINEMA	097	Nikei	003	Wards	015, 017, 018, 040, 048, 054, 060, 064
Classic	003	Onking	003	Yamaha	018
Concerto	018	Onwa	003	York	040
Contec	046	Panasonic	006, 007, 008, 009, 054, 066, 067, 073, 074	Yupiteru	003
Coronado	015	Penney	018	Zenith	058, 079
Craig	003, 005, 061, 082, 083, 084	Philco	003, 015, 017, 018, 048, 054, 059, 062, 069, 090	Zonda	001
Croslex	062	Philips	015, 017, 018, 040, 048, 054, 062, 072, 112, 114, 117, 118	Dongyang	003, 054
Crown	003	Pioneer	063, 066, 080, 091	LOWE	054
CURTIS MATHES	059, 061, 063	Portland	015, 018, 059	FINLUX	054, 109, 114
CXC	003	Proton	040	YOKO	054
Daewoo	002, 003, 004, 015, 016, 017, 018, 019, 020, 021, 022, 023, 024, 025, 026, 027, 028, 029, 030, 032, 034, 035, 036, 040, 048, 059, 090, 099, 100	QUASAR	006, 066, 067	LOEWE OPTA	054, 114
Daytron	040	Radio Shack	017, 048, 056, 060, 061, 075	PHONOLA	054, 112, 114
Dynasty	003	RCA/Proscan	018, 059, 067, 076, 077, 078, 092, 093, 094	RADIOLA	054, 112
Emerson	003, 015, 040, 046, 059, 061, 064, 082, 083, 084, 085	Realistic	003, 019	SCHNEIDER	054
Fisher	019, 065, 103	Sampo	040	AKAI	103
Funai	003	Samsung	000, 015, 016, 017, 040, 043, 046, 047, 048, 049, 054, 059, 060, 098	GRUNDIG	108, 109, 113, 119, 120, 121
Futuretech	003	Sanyo	019, 061, 065, 101, 102, 103, 104	BLAUPUNKT	108
General Electric (GE)	006, 040, 056, 059, 066, 067, 068	Scott	003, 040, 060, 061	SIEMENS	108
Hall Mark	040	Sears	015, 018, 019	CGE	113
Hitachi	015, 018, 050, 059, 069	Sharp	015, 057, 064, 101, 105, 106, 115	IMPERIAL	113
Inkel	045	Signature 2000 (M.Wards)	057, 058	MIVAR	113
JC Penny	056, 059, 067, 086	Sony	050, 051, 052, 053, 055, 101	SABA	114
JVC	070	Soundesign	003, 040	BANG&OLUFSEN	114
KTV	059, 061, 087, 088	Spectricon	001	BRIONVEGA	114
KEC	003, 015, 040	SSS	018	FORMENTI	114
KMC	015			METZ	114
LG (Goldstar)	001, 015, 016, 017, 037, 038, 039, 040, 041, 042, 043, 044, 054, 086			WEGA	114
				RADIOMARELLI	114
				SINGER	114
				SINUDYNE	114
				TELEFUNKEN	116

## OPERATING YOUR DVD OR BD PLAYER WITH THE REMOTE CONTROL

1. Press **POWER** button to turn on the DVD (BD) player.
2. Press **DVD (BD)** button to set the remote to DVD (BD) mode.
  - If you operate VCR, press VCR button to set the remote to VCR mode.
3. Point the remote control toward the DVD (BD).
4. While holding down **POWER** button, enter the code corresponding to your brand of DVD (BD).
  - If there is more than one code listed for your DVD (BD) in the table, enter one at a time to determine which code works.
  - If the code matches the DVD (BD)'s code, the DVD (BD) will be turned off.
5. If DVD (VCR) is turned on or off when you press the power button of the remote controller, the setting is completed.
  - You can use DVD (BD) POWER, VOLUME, PLAY, PAUSE, STOP, SKIP, MENU and Numeric button (0~9).



- The remote control may not work on some brands of DVD (BD). Also, some operations may not be possible depending on your brand of DVD (BD).
- The remote control will work with Samsung DVD (BD) by default.

### DVD Brand Code List

Brand	Code Number	Brand	Code Number	Brand	Code Number
DENON	003, 032	ONKYO	004, 014	TOSHIBA	004, 018
DOONOON	019	OPTIMUS	011	YAMAHA	009, 033
DMTECH	017	PANASONIC	021	ZENITH	004, 024
FISHER	002	PROSCAN	006	TAEGWANG	026
GE	006	PHILIPS	004, 023	PS2	028
HARMAN/KARDON	012	PIONEER	007, 011, 022, 025	X-BOX	029
JVC	010, 013	RCA	006	APEX	030
KENWOOD	008	SAMSUNG	000, 027	Marantz	031
LG	001	SANYO	002		
MAGNAVOX	004	SONY	015, 020		
MINISUBISHI	005, 016	THETA DIGITAL	011		

### BD player Brand Code List

Brand	Code Number
SAMSUNG	000, 001, 002, 003, 004



- For the BD player, only a Samsung product can be controlled with the remote control.

# Troubleshooting

Before requesting service, please check the following.

Symptom	Check	Remedy
The unit will not turn on.	<ul style="list-style-type: none"> <li>Is the power cord plugged into the outlet?</li> </ul>	<ul style="list-style-type: none"> <li>Connect the power plug to the outlet.</li> </ul>
A function does not work when the button is pressed.	<ul style="list-style-type: none"> <li>Is there static electricity in the air?</li> </ul>	<ul style="list-style-type: none"> <li>Disconnect the power plug and connect it again.</li> </ul>
Sound is not produced.	<ul style="list-style-type: none"> <li>Are the speakers and external components connected properly?</li> <li>Is the Mute function on?</li> <li>Is the volume set to minimum?</li> <li>Is the speaker setup set incorrectly to NONE?</li> </ul>	<ul style="list-style-type: none"> <li>Connect them correctly.</li> <li>Press Mute button to cancel the function.</li> <li>Adjust the volume.</li> <li>Refer to pages 33 to select LARGE, SMALL or YES.</li> </ul>
Picture does not appear on a TV when the function is selected.	<ul style="list-style-type: none"> <li>Is the external component connected properly?</li> </ul>	<ul style="list-style-type: none"> <li>Connect it correctly.</li> </ul>
Remote controller does not work.	<ul style="list-style-type: none"> <li>Are the batteries drained?</li> <li>Is the distance between remote control and main unit too great?</li> </ul>	<ul style="list-style-type: none"> <li>Replace with new batteries.</li> <li>Operate at close distance.</li> </ul>
The sound from the left/right channels is reversed.	<ul style="list-style-type: none"> <li>Are the left/right speaker or left/right input/output cables connected properly?</li> </ul>	<ul style="list-style-type: none"> <li>Check the left/right channel and connect it/ them correctly.</li> </ul>
Can't receive radio broadcasts.	<ul style="list-style-type: none"> <li>Is FM antenna connected properly?</li> </ul>	<ul style="list-style-type: none"> <li>Connect the antenna correctly.</li> <li>If the input strength of antenna signal is weak, install the FM antenna in a place with good reception.</li> </ul>
There is no sound from surround speakers.	<ul style="list-style-type: none"> <li>Is the surround speaker connected properly?</li> <li>Is SURR (surround) incorrectly set to NONE in speaker setup?</li> <li>Is surround mode set to stereo?</li> </ul>	<ul style="list-style-type: none"> <li>Refer to pages 14 ~16 to connect them properly.</li> <li>Refer to page 33 to select LARGE or SMALL.</li> <li>Refer to pages 37 ~ 41 to select proper Surround Mode.</li> </ul>

Symptom	Check	Remedy
There is no sound from surround back speakers	<ul style="list-style-type: none"> <li>• Are the surround back speakers connected properly?</li> <li>• Is the S.BACK(Surround Back) selected to NONE in Speaker Setup?</li> <li>• Is Surround Mode set to EX/ES?</li> </ul>	<ul style="list-style-type: none"> <li>• Refer to pages 14 ~16 to connect it properly.</li> <li>• Refer to page 33 to select LARGE or SMALL.</li> <li>• Refer to page 40 to set Surround Mode to EX/ES.</li> </ul>
Can't select EX/ES mode.	<ul style="list-style-type: none"> <li>• Is S.BACK(Surround Back) selected to NONE in Speaker Setup?</li> <li>• Is the input signal selected properly?</li> </ul>	<ul style="list-style-type: none"> <li>• Refer to page 33 to select LARGE or SMALL.</li> <li>• Use 7.1 channel external component.</li> </ul>
Can't select Dolby Pro Logic IIx mode.	<ul style="list-style-type: none"> <li>• Is the input signal selected properly?</li> </ul>	<ul style="list-style-type: none"> <li>• Select 2 channel Dolby Digital, PCM, and Analog input signal.</li> </ul>
Can't select NEO:6 mode.	<ul style="list-style-type: none"> <li>• Is the input signal selected properly?</li> </ul>	<ul style="list-style-type: none"> <li>• Use PCM and Analog input signal.</li> </ul>
There is no sound when playing a DTS encoded DVD.	<ul style="list-style-type: none"> <li>• Is Digital input selected?</li> </ul>	<ul style="list-style-type: none"> <li>• Check whether the DVD player is properly connected and refer to page 46 to select the digital input.</li> </ul>

## Product protection function

### Heat protection

- The protection function will come on if the main unit or power transformer overheats.

"PROTECTION" will appear in the display .

This function will come on :

- If speaker terminal is shorted
- If speaker cable is shorted

If there is no problem when you turn the unit on again after turning it off, PROTECTION mark will disappear on the display and the unit will work properly.



- If PROTECTION appears on the display, check whether the speaker terminal is shorted and then turn on the unit



# Appendix

## SPECIFICATIONS

GENERAL	Power supply		120V, 60 Hz
	Standby power consumption		0.9W
	Power consumption	Main unit	75W
		Subwoofer	90W
	Weight		12.7 lbs
	Dimensions (W x H x D)		16.9 x 5.7 x 13.7 inches
	Operating temperature range		41°F~+95°F
	Operating humidity range		10%~75%
FM TUNER	Frequency response		87.5~108.0MHz
	Usable sensitivity		12dBf
	S/N ratio		MONO/STEREO 55/55dB
	Distortion		MONO/STEREO 0.3/0.8%
	Stereo separation		30dB
	Tuner output level		1kHz, 75kHz Dev
AMPLIFIER	Rated output		20Hz~20kHz/THD = 0.9%
	Front speaker(left+right)		4 Ω 100W/CH
	Center speaker		4 Ω 100W/CH
	Surround speaker(left+right)		4 Ω 100W/CH
	Surround back		4 Ω 100W/CH
	Input sensitivity/impedance		450mV/47kΩ
	S/N ratio (analog input)		80dB
	Separation (1kHz)		60dB
FREQUENCY RESPONSE	Analog input		20Hz~20kHz(±3dB)
	Digital input/96kHz PCM		20Hz ~44kHz(±3dB)
HDMI	Input		Compatible 1080p
	Output		Compatible 1080p
VIDEO OUTPUT	TV format		NTSC/PAL
	Input level/impedance		1Vp-p/75 Ω
	Output level/impedance		1Vp-p/75 Ω
	Video frequency response		5Hz to 10kHz(-3dB)
	S/N ratio		60dB

\* S/N ratio, distortion, separation and usable sensitivity are based on measurement using AES (Audio Engineering Society) guidelines.

The Samsung logo is located at the top left of the page, enclosed in a black oval with the word "SAMSUNG" in white capital letters.

## LIMITED WARRANTY TO ORIGINAL PURCHASER

Samsung Electronics Canada Inc.(SECA), warrants that this product is free from defective material and workmanship.

SECA further warrants that if this product falls to operate properly within the specified warranty period and the failure is due to improper workmanship or defective materials, SECA will repair or replace the product at its option.

All warranty repairs must be performed by a SECA Authorized Service Center. (The name and address of the location nearest you can be obtained by calling toll free: 1- 800- SAMSUNG)

### LABOR

One year (Carry- in)

### PARTS

One year

On carry-in models, transportation to and from the service center is the customer's responsibility.

The original dated sales receipt must be retained by the customer and is the only acceptable proof of purchase. It must be presented to the authorized service center at the time service is requested.

## EXCLUSIONS (WHAT IS NOT COVERED)

This warranty does not cover damage due to accident, fire, flood and/ or other acts of God; misuse, incorrect line voltage, improper installation, improper or unauthorized repairs, commercial use or damage that occurs in shipping. Exterior and interior finish, lamps, glass are not covered under this warranty. Customer adjustments which are explained in the instruction manual are not covered under the terms of this warranty. This warranty will automatically be voided for any unit found with a missing or altered serial number. This warranty is valid only on products purchased and used in Canada.

**HEADQUARTERS  
SAMSUNG ELECTRONICS CANADA INC.,  
CUSTOMER SERVICE  
55 STANDISH COURT MISSISSAUGA, ONTARIO L5R 4B2 CANADA  
FABRIQUE EN CORÉE  
1-800-SAMSUNG (1-800-7267864)  
WWW.SAMSUNG.COM/CA**

## Contact SAMSUNG WORLD WIDE

If you have any questions or comments relating to Samsung products, please contact the SAMSUNG customer care center.

Region	Country	Customer Care Center ☎	Web Site
North America	CANADA	1-800-SAMSUNG(726-7864)	www.samsung.com/ca
	MEXICO	01-800-SAMSUNG(726-7864)	www.samsung.com/mx
	U.S.A	1-800-SAMSUNG(726-7864)	www.samsung.com/us
Latin America	ARGENTINE	0800-333-3733	www.samsung.com/ar
	BRAZIL	0800-124-421, 4004-0000	www.samsung.com/br
	CHILE	800-SAMSUNG(726-7864)	www.samsung.com/cl
	NICARAGUA	00-1800-5077267	www.samsung.com/latin
	HONDURAS	800-7919267	www.samsung.com/latin
	COSTA RICA	0-800-507-7267	www.samsung.com/latin
	ECUADOR	1-800-10-7267	www.samsung.com/latin
	EL SALVADOR	800-6225	www.samsung.com/latin
	GUATEMALA	1-800-299-0013	www.samsung.com/latin
	JAMAICA	1-800-234-7267	www.samsung.com/latin
	PANAMA	800-7267	www.samsung.com/latin
	PUERTO RICO	1-800-682-3180	www.samsung.com/latin
	REP. DOMINICA	1-800-751-2676	www.samsung.com/latin
	TRINIDAD & TOBAGO	1-800-SAMSUNG(726-7864)	www.samsung.com/latin
	VENEZUELA	0-800-100-5303	www.samsung.com/latin
Europe	COLOMBIA	01-8000112112	www.samsung.com.co
	BELGIUM	02 201 2418	www.samsung.com/be (Dutch) www.samsung.com/be_fr (French)
	CZECH REPUBLIC	800-SAMSUNG(800-726786)	www.samsung.com/cz
	DENMARK	8-SAMSUNG(7267864)	www.samsung.com/dk
	FINLAND	30-6227 515	www.samsung.com/fi
	FRANCE	01 4863 0000	www.samsung.com/fr
	GERMANY	01805 - SAMSUNG(726-7864 € 0,14/Min)	www.samsung.de
	HUNGARY	06-80-SAMSUNG(726-7864)	www.samsung.com/hu
	ITALIA	800-SAMSUNG(726-7864)	www.samsung.com/it
	LUXEBURG	02 261 03 710	www.samsung.com/lu
	NETHERLANDS	0900-SAMSUNG (0900-7267864) (€ 0,10/Min)	www.samsung.com/nl
	NORWAY	3-SAMSUNG(7267864)	www.samsung.com/no
	POLAND	0 801 1SAMSUNG(172678), 022-607-93-33	www.samsung.com/pl
	PORTUGAL	80820-SAMSUNG(726-7864)	www.samsung.com/pt
	SLOVAKIA	0800-SAMSUNG(726-7864)	www.samsung.com/sk
	SPAIN	902-1-SAMSUNG (902 172 678)	www.samsung.com/es
	SWEDEN	075-SAMSUNG(726 78 64)	www.samsung.com/se
	U.K	0845 SAMSUNG (7267864)	www.samsung.com/uk
	EIRE	0818 717 100	www.samsung.com/ie
	AUSTRIA	0810-SAMSUNG(7267864, € 0.07/min)	www.samsung.com/at
	SWITZERLAND	0848-SAMSUNG(7267864, CHF 0.08/min)	www.samsung.com/ch
CIS	RUSSIA	8-800-555-55-55	www.samsung.ru
	KAZAKHSTAN	8-10-800-500-55-500	www.samsung.com/kz_ru
	UZBEKISTAN	8-10-800-500-55-500	www.samsung.com/kz_ru
	KYRGYZSTAN	00-800-500-55-500	
	TADJIKISTAN	8-10-800-500-55-500	
	UKRAINE	8-800-502-0000	www.samsung.ua
	LITHUANIA	8-800-77777	www.samsung.com/lt
	LATVIA	8000-7267	www.samsung.com/lv
	ESTONIA	800-7267	www.samsung.com/ee
Asia Pacific	AUSTRALIA	1300 362 603	www.samsung.com/au
	NEW ZEALAND	0800 SAMSUNG (0800 726 786)	www.samsung.com/nz
	CHINA	800-810-5858, 400-810-5858, 010-6475 1880	www.samsung.com/cn
	HONG KONG	3698-4698	www.samsung.com/hk
	INDIA	3030 8282, 1800 110011, 1-800-3000-8282	www.samsung.com/in
	INDONESIA	0800-112-8888	www.samsung.com/id
	JAPAN	0120-327-527	www.samsung.com/jp
	MALAYSIA	1800-88-9999	www.samsung.com/my
	PHILIPPINES	1-800-10-SAMSUNG(726-7864) 1-800-3-SAMSUNG(726-7864), 02-5805777	www.samsung.com/ph
	SINGAPORE	1800-SAMSUNG(726-7864)	www.samsung.com/sg
	THAILAND	1800-29-3232, 02-689-3232	www.samsung.com/th
	TAIWAN	0800-329-999	www.samsung.com/tw
	VIETNAM	1 800 588 889	www.samsung.com/vn
Middle East & Africa	TURKEY	444 77 11	www.samsung.com/tr
	SOUTH AFRICA	0860-SAMSUNG(726-7864 )	www.samsung.com/za
	U.A.E	800-SAMSUNG (726-7864), 8000-4726	www.samsung.com/ae

