

## CADENZA WHIRLPOOL MODEL NUMBER

**6060.028**  
**6060.028H**

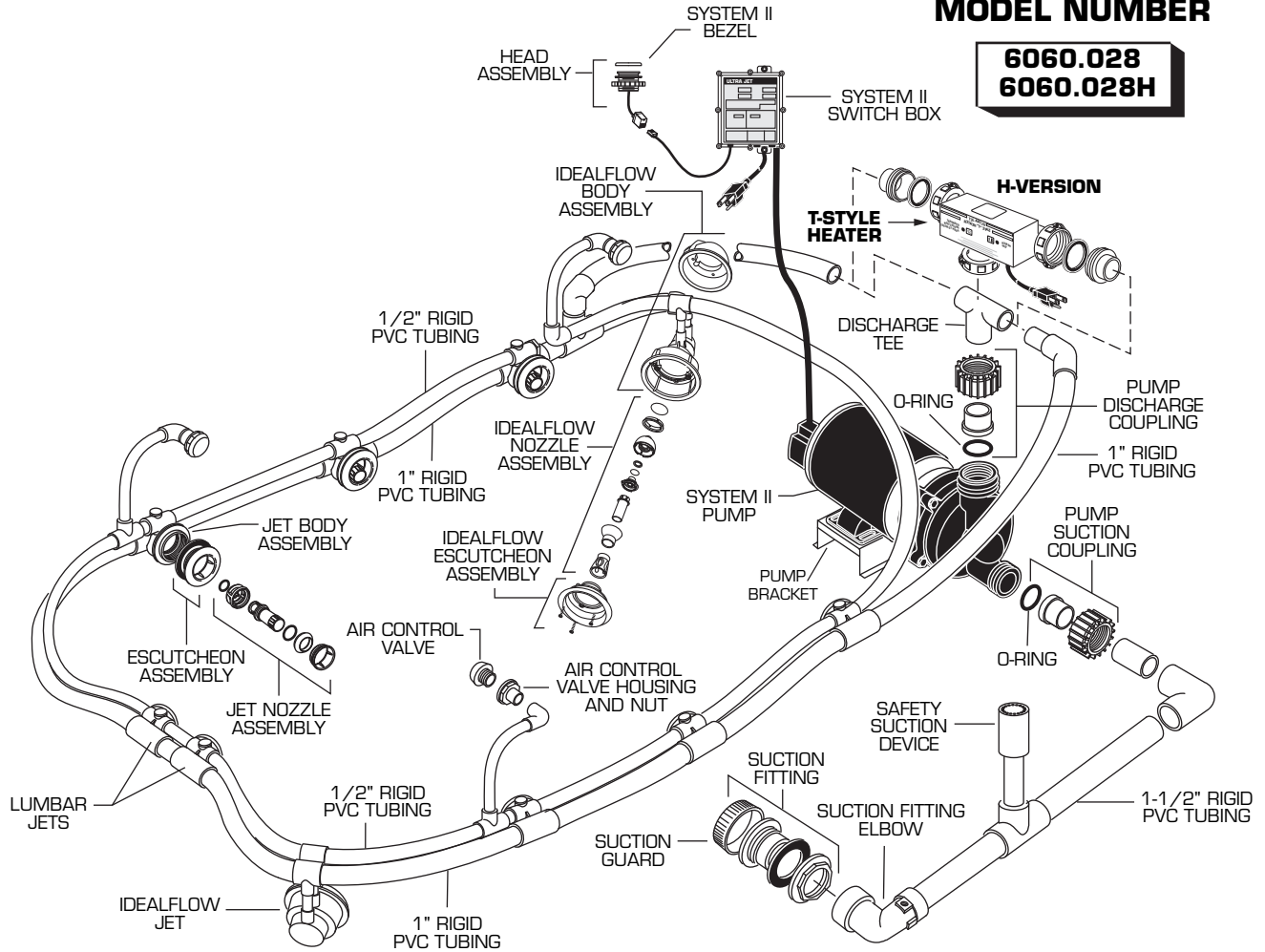

USABLE ON	DESCRIPTION	PART NUMBER	PKG QTY
ALL MODELS	Pump Suction Coupling	047186-0070A	1
	O-Ring	047187-0070A	1
	Pump Discharge Coupling	047186-0070A	1
	Pump (two speed, 2 HP)	752466-0070A	1
	★ Air Control Valve	751677-XXX0A	1
	★ Air Control Valve Housing/Nut	068917-XXX0A	1
	★ Jet Nozzle Assembly $\Delta$	047587-XXX0A	1
	★ Escutcheon Assembly $\square$	047588-XXX0A	1
	Jet Body Assembly (Acrylic Wpl)	047627-0070A	1
	Jet Body Assembly (Idealcast Wpl)	047589-0070A	1
	★ Idealflow Nozzle Assembly	752407-XXX0A	1
	★ Idealflow Escutcheon Assembly	752408-XXX0A	1
	Idealflow Body Assembly	752409-0070A	1
	★ Suction Guard	750537-XXX0A	1
	★ Suction Fitting	752396-XXX0A	1
	Suction Fitting Elbow	751186-0070A	1
	Discharge Tee	047438-0070A	1
	Safety Suction Device (8")	752361-0070A	1
	★ Head Assembly $\circ$	752118-YYY0A	1
	★ System II Bezel $\circ$	752115-YYY0A	1
Switch Box	752468-0070A	1	
Pump Bracket (Acrylic Wpl)	047437-0070A	1	
.028H	Heater	752356-0070A	1

$\circ$  Available in Chrome and Polished Brass.

NOTE: Schedule 40 Rigid PVC Piping available through local plumbing supply outlets.  
See Section "J" for Additional Parts and Accessories.

$\Delta$  Removal/installation requires tool part no. 047530-0070A.

$\square$  Removal/installation requires tool part no. 047605-0070A.

★ Replace XXX with Fixture Color Code, YYY with Trim Finish