

Fisher-Price®

www.fisher-price.com



H4828



H3370



Twin Time Dollhouse™

Parts

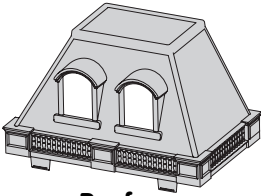

Roof

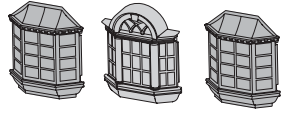

3 Windows

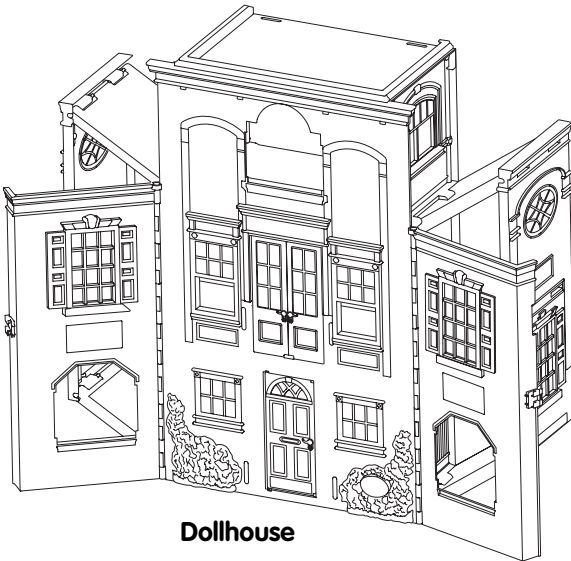

Dollhouse



Valance

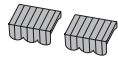

2 Awnings

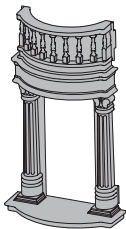

Door Frame

PARTS NOT SHOWN:

Kitchen Island

2 Cradles

2 Baby Blankets

Sofa

Easy Chair

Chair

Cat Bed

Snack Tray

Train Toy

Rocking Horse

**2 Flower Boxes
with Flowers**

5 Figures

Assembly

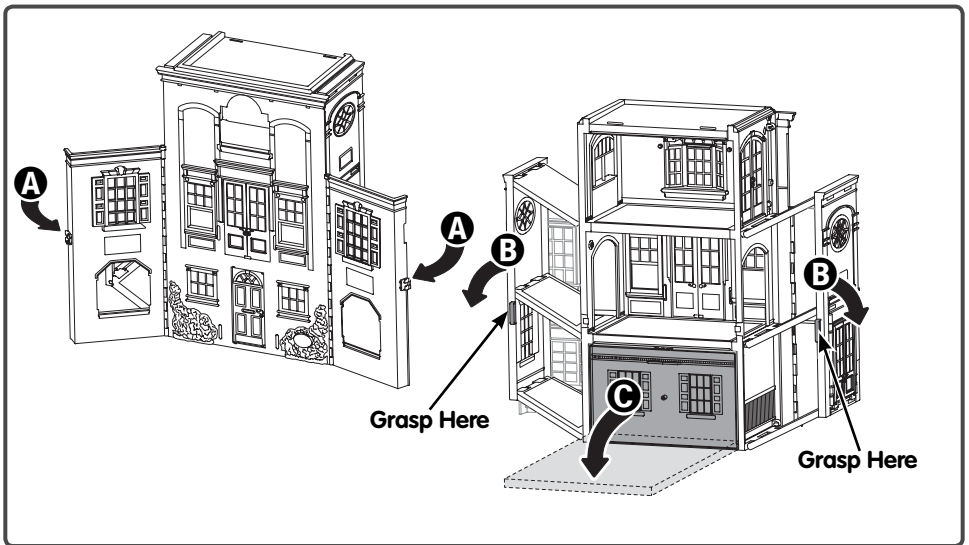

- Grasp the latches and open the back of dollhouse **A**.
- Lower the sides **B**.
- Lower the "patio" **C**.

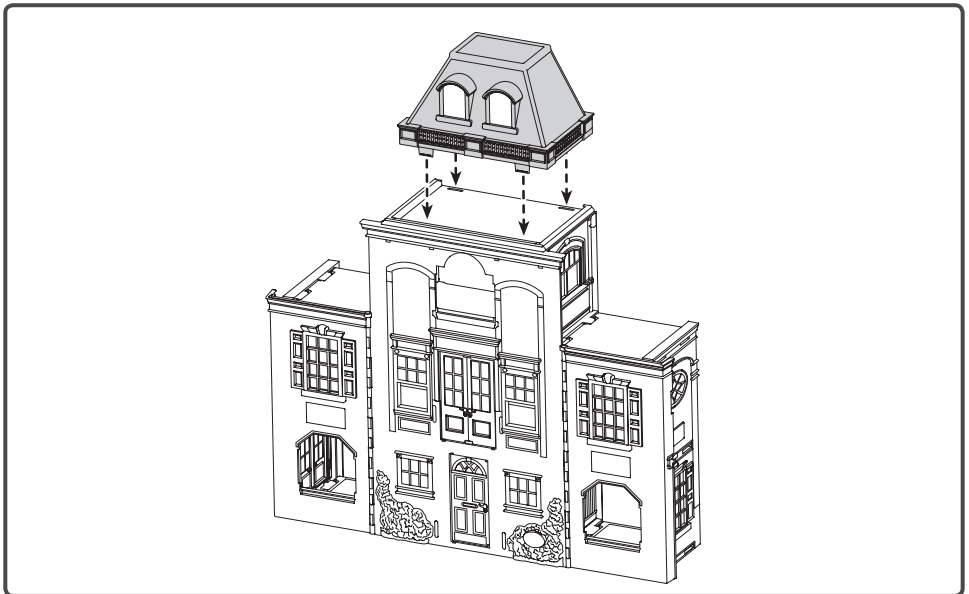

- **"Snap"** the roof to the top of the dollhouse.

Assembly

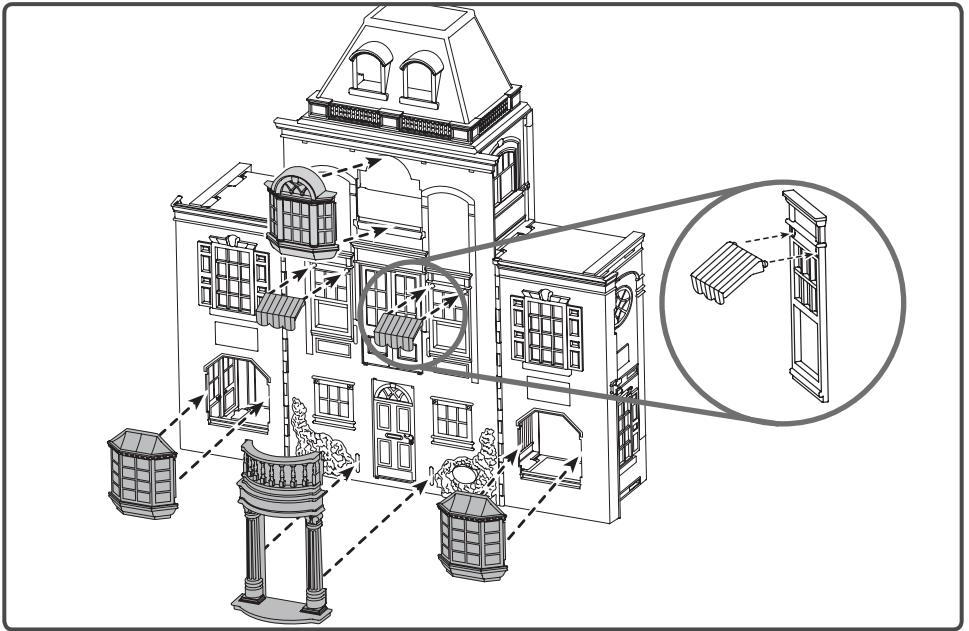

- **“Snap”** the door frame and three windows to the front of the dollhouse.
- **“Snap”** the awnings onto the front of the dollhouse at an angle, as shown.

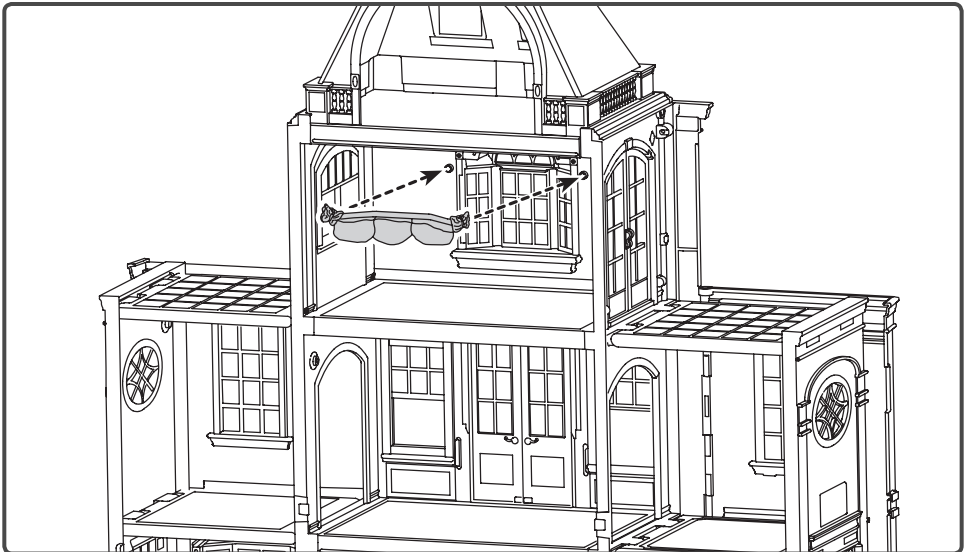

- Press to fit the valance above the third floor window.

Fold Up Storage

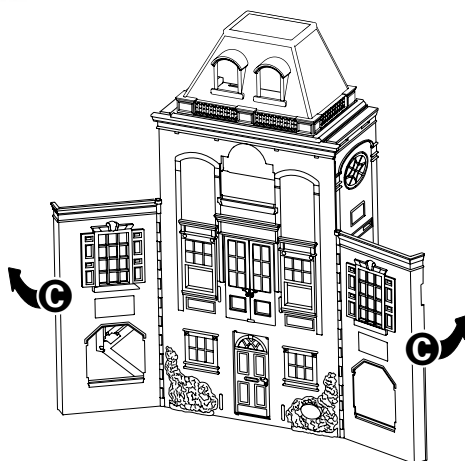
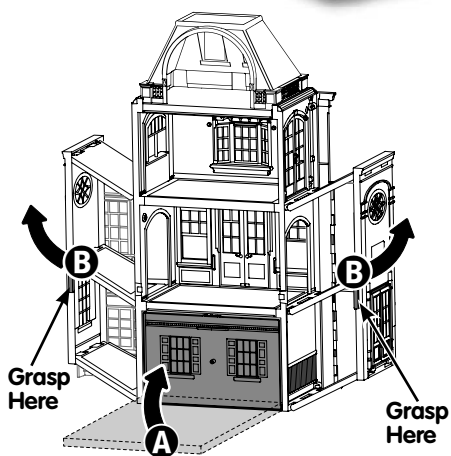

- Place all accessories inside the dollhouse. Lift the patio **A**.
- Grasp the colored handles and lift both sides **B**.

- Fold both sides in **C**.

Consumer Information

Please keep this instruction sheet for future reference, as it contains important information.

Adult assembly is required.

No tools needed for assembly.

Wipe this toy with a clean cloth dampened with a mild soap and water solution.



CONSUMER ASSISTANCE

Call toll free: 1-800-432-5437 (US & Canada only)
M-F 9AM to 7PM / SAT 11AM to 5PM (EST)

 service.fisher-price.com

Write to us at: Fisher-Price® Consumer Relations,
636 Girard Avenue, East Aurora, New York 14052.

Hearing-impaired consumers using TTY/TDD equipment,
please call 1-800-382-7470.

For countries outside the United States:

Canada: Mattel Canada Inc., 6155 Freemont Blvd.,
Mississauga, Ontario L5R 3W2; www.service.mattel.com.

Great Britain: Mattel UK Ltd, Vanwall Business Park,
Maidenhead SL6 4UB. Helpline: 01628 500303.
www.service.mattel.com/uk

Australia: Mattel Australia Pty. Ltd., 658 Church Street,
Locked Bag #870, Richmond, Victoria 3121 Australia.
Consumer Advisory Service 1300 135 312.

New Zealand: 16-18 William Pickering Drive,
Albany 1331, Auckland.

Asia: Mattel East Asia Ltd, Room 1106, South Tower,
World Finance Centre, Harbour City, Tsimshatsui, HK, China.