

Nurisu

Coway Hot & Cold Water Purifier [Nurisu] User's Manual

Do not fail to read this manual for your safety and proper use before operating the water purifier.

CHP-01BR/CHP-01BL/CHP-01BU



- Meticulous Water Purifier To Realize "A/S comes first".
- A warranty is inclosed in this manual.

DEAR COWAY'S CUSTOMERS

First of all, we would like to thank you very much for purchasing this water purifier by Coway. This product is superior to the ones in function in the past, and we believe that it will provide you with cleaner and healthier water. We would like to recommend you to read carefully this User's Manual for proper operation and maintenance and keep it well together with the warranty. This user's manual could solve your problem resulted from that you can easily fix by yourself in just a few minutes.



Read this Manual

Inside this manual you will find many helpful hints on maintaining your water purifier properly. Just a little preventive care on your part can save you a great deal of time and money over the life of your system.



Review the Section on Troubleshooting Tips

You'll find many answers to common problems here. If you review this chart of Troubleshooting Tips first, you may not need to call for service at all.



If You Need Service

If you do need service, you can relax knowing help is only a phone call away.

Safety Information

Electricity Safety	02
Installation and Use Safety	03

Operating Instructions

Features of Nurisu	05
Names of Each Component	07
Indication Parts	08
Operation Parts	08
Operation Method	09
Cleaning Method	11
About Coway's Reverse Osmosis System	13
Water Purifier Process	14
/Estimated Time of Filter Replacement	
Waterflow Diagram	17

Troubleshooting Tips

Before Asking for Service	15
---------------------------------	----

Customer Service

Warranty Information	18
----------------------------	----

IMPORTANT SAFETY INFORMATION

Read All Instructions Before Using.

WARNING

For your safety, the information in this manual must be followed to minimize the risk of property damage or personal injury.



Electricity Safety

- Only connect the power cord to voltage rating that matches it on the rating plate to avoid danger such as electric shock or fire. And be sure the electric outlet is inside location to protect from moisture.

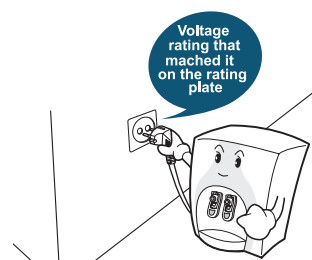

- Be sure the power cord not to be bend by force and do not put a heavy object on the power cord to avoid any electric leakage or damage.

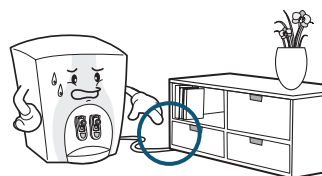

- Do not pull the power plug from the outlet with a wet hand to avoid electric shock. If the supply cord is damaged, it must be replaced by the manufacturer or its service agent or a similarly qualified person in order to avoid a hazard.

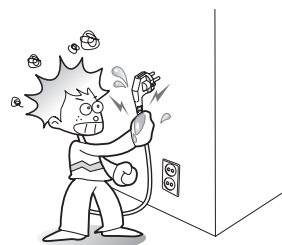

- Never splash the water purifier with water to avoid the risk of electric shock.

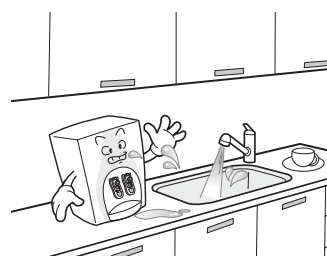

⚠ WARNING

Do not use with water that is microbiologically unsafe or unknown quality.



Installation and Safe Use

- Keep the water purifier out of direct sunlight. The sun's heat may distort non-metallic part and may damage the electronics.

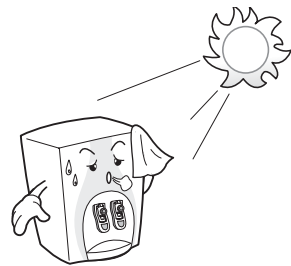

- Do not install the water purifier where it could freeze. Freezing damage is not covered by the warranty.

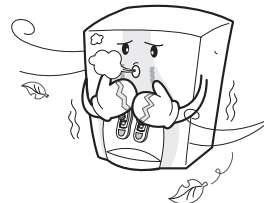

- Keep the water purifier away from place being humid and dust rising place to avoid electric shock and fire.

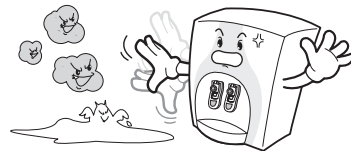

- If house water pressure is over the maximum working pressure of the water purifier(referring to rating plate), install a pressure reducing valve in the water supply line to it.

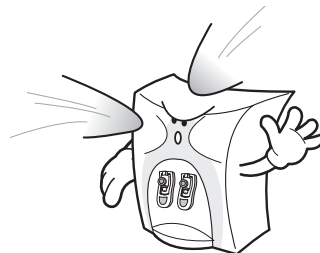

- Only connect the water purifier to cold water pipe. Do not run hot water over 40°C through it. It will defect the filters of the water purifier.

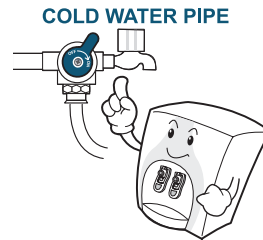

- Periodical filter replacement is prerequisite for getting clean water. In case filter are overused, the performance of filters is deteriorated. Therefore, do not miss the time of filter replacement.

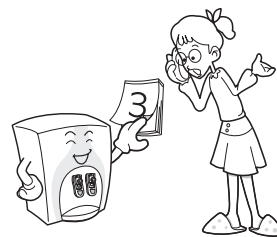

- When it is newly installed or relocated, plug the power cord into the wall outlet after 30 minutes.

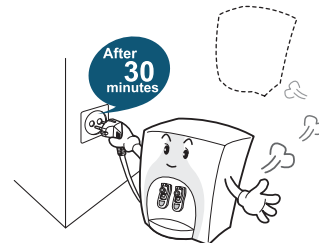

- When it is newly installed or not in use for a long time, drain all the water in the storage tank before use.

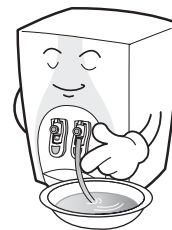

- The temperature of hot water is over 90°C. Therefore be careful not to get burned by the hot water.



FEATURES OF NURISU HOT & COLD WATER PURIFIER

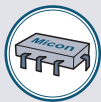

Micom Control System

It is easy to use as it is automatically controlled by Micom.

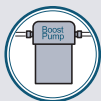

Boost Pump for Pressurizing Supplying Water(CHP-01BR)

Superior purified-water quality is guaranteed even in the low water pressure area by pressurizing supplying water.



Function of Indicating Temperature

It shows the operation of the product such as temperature of hot & cold water and operation state of the water purifier.



Changeover Faucet for Cold Water and Purified Water

It is easy to use by adopting a changeover faucet which makes it possible to select cold water or purified water.



Hot Water Safety Faucet Device

The hot water faucet is equipped with a safety device to prevent a burn by hot water(92℃).



Detachable and Attachable Waterspout

The waterspout can be easily attached or detached.



Function of Protecting Overheating and Overcooling

As a heating or cooling function does not work when the storage tank is not properly filled with purified water, it prevents damage to be caused by overheating and overcooling of hot/cold water tank.



Perfect Airtight Tank

It further enhances sanitation by applying separated airtight structure to perfectly prevent the secondary contamination to be caused by foreign materials such as dust, bug, and so on the storage tank.



Compact and Elegant Design

It maximizes its application in a small space with a compact structure and elegant design of two-tone color, which goes well any places.



Anti-Bacterial System

It enhances sanitation by using silver-impregnated activated carbon which eliminates odor in the water and obstructs the growth of microorganisms.

NAMES OF EACH COMPONENT/ INDICATION PARTS/ OPERATION PARTS

Front

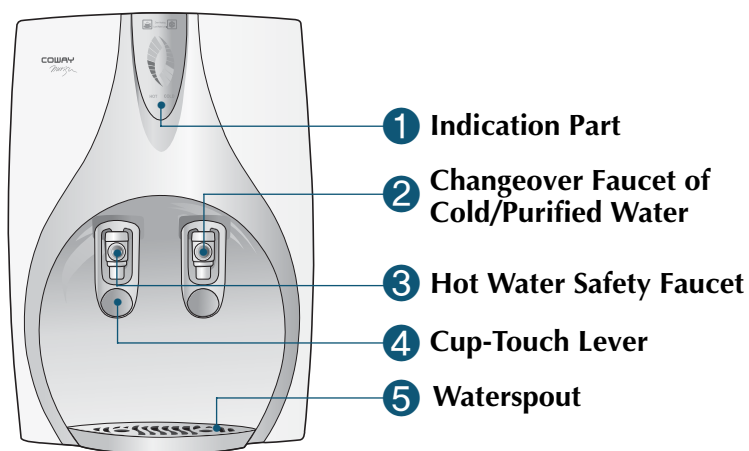

Rear

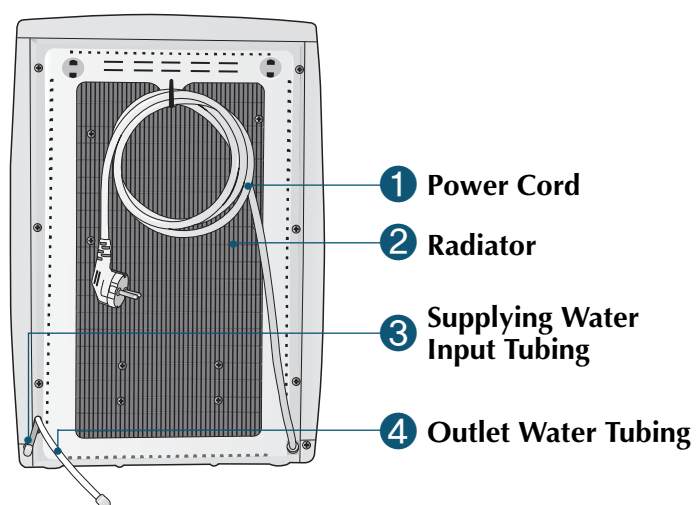

Indication Parts

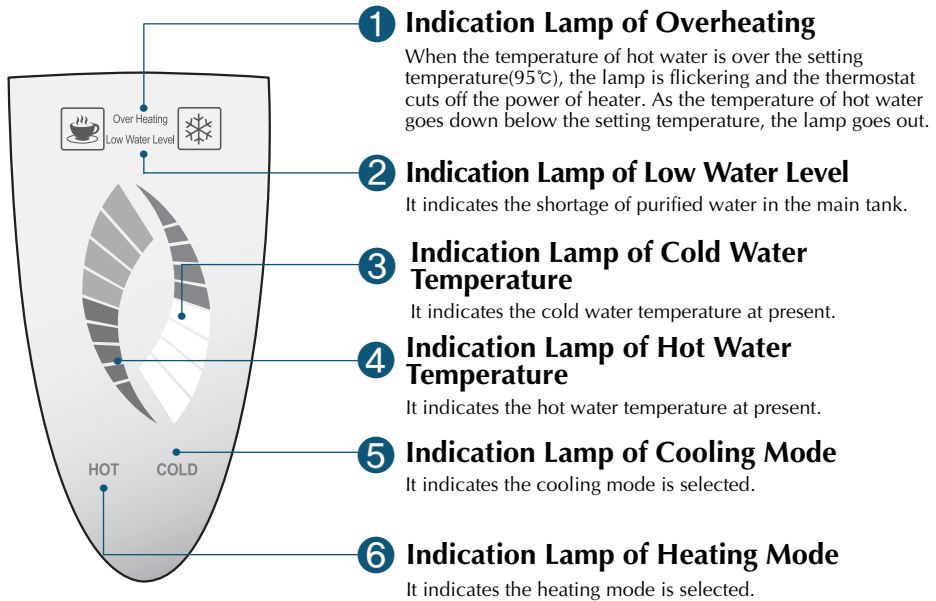

1 Indication Lamp of Overheating

When the temperature of hot water is over the setting temperature(95°C), the lamp is flickering and the thermostat cuts off the power of heater. As the temperature of hot water goes down below the setting temperature, the lamp goes out.

2 Indication Lamp of Low Water Level

It indicates the shortage of purified water in the main tank.

3 Indication Lamp of Cold Water Temperature

It indicates the cold water temperature at present.

4 Indication Lamp of Hot Water Temperature

It indicates the hot water temperature at present.

5 Indication Lamp of Cooling Mode

It indicates the cooling mode is selected.

6 Indication Lamp of Heating Mode

It indicates the heating mode is selected.

Operating Parts

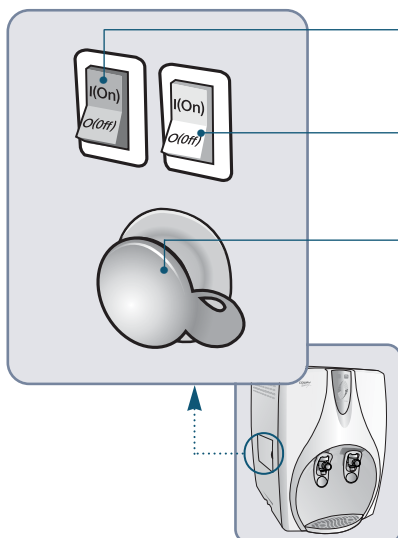

1 Heating Mode Switch

It is used for operating the heating device. If the switch is off, the heater for hot water is not worked.

2 Cooling Mode Selection Switch

It is used for operating the cooling device. If the switch is off, the compressor for cold water is not worked.

3 Hot Water Drain-Outlet

It is used for draining water out of the hot water tank.

⚠ WARNING

Draining hot water from the outlet, be careful not to be scalded.

OPERATION METHOD

WARNING

After installation the power supply cord and plug shall be accessible.

Note: The cold and hot water you drink are made of the purified water. Therefore, you do not need to care the quality of them.

Connection to the Power

Connect it to voltage rating that matches it on the rating plate.

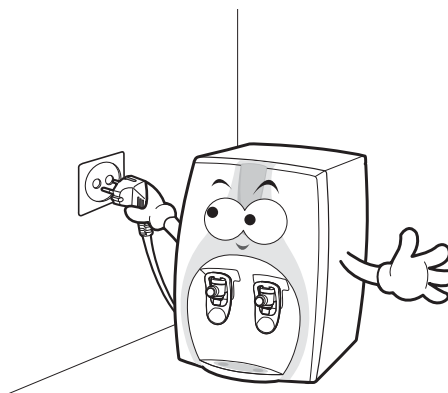

Open the Supplying Water Valve

Open the valve to supply water to the water purifier.

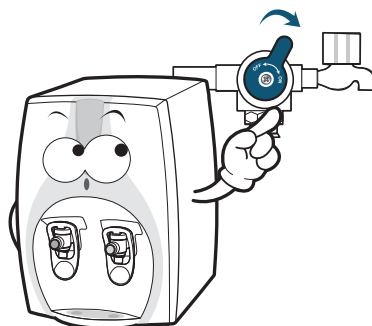

CAUTION !!

After installed, moved, and severely shaken, about 30 minutes are needed for stabilization of cooling device before using the product.

When Cold/Purified Water Is Used

- 1 Turn on the cold water selection switch and make sure that the indication lamp of cold water in the indication part is turned on.

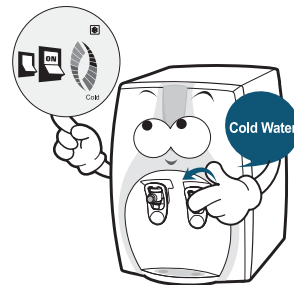

- 2 Turn the cold/purified changeover faucet to the C.W or C.C.W as you wish to drink water and push the cold/purified switch faucet lever. Then, you can drink cold or purified water.

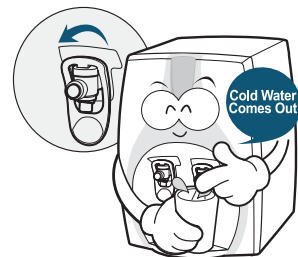

When Hot Water Is Used

- 1 Turn on the hot water selection switch and make sure that the hot water indication lamp is turned on in the indication part.

⚠ WARNING

The temperature of hot water is over 90°C. Therefore, be careful not to get burned by the hot water.

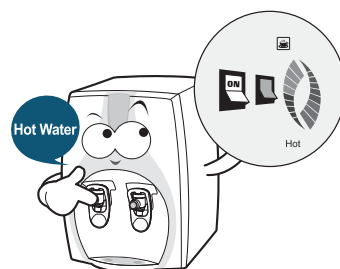

- 2 After 30 minutes pass, press the red-color hot water safety button and lightly push the lever. Then, you can drink hot water.

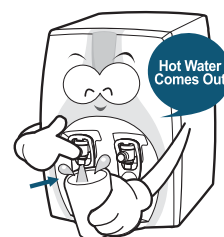

CLEANING METHOD



CAUTION !!

Keep the surrounding environment neat all the time and clean the inside of the tank once a month.

Use of Wasserspout

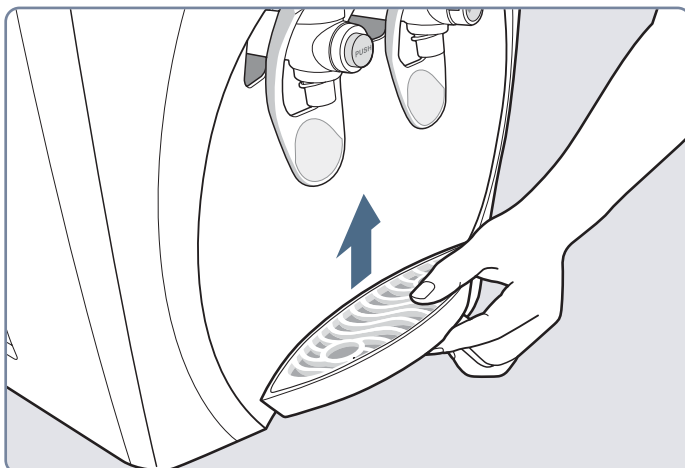

In case the waterspout is separated.

It is easily separated if you take it out while lifting it slightly upward.

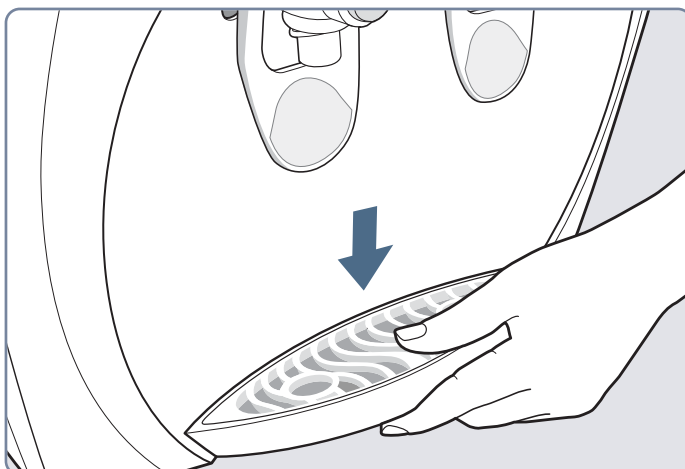

In case the waterspout is installed to the product.

After tightly sticking the hook of the waterspout to the front of the product, slightly push and press it downward.

Cleaning the Storage Tank

- 1 Pull out the power cord from the wall outlet

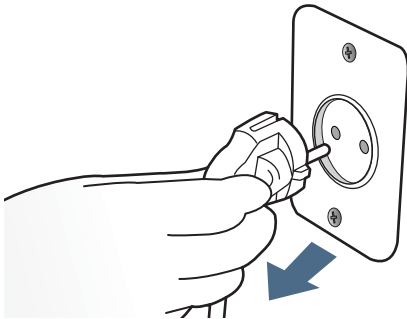

- 2 Drain all the water in the storage tank by using the drain hose. Then, keep it on a water reservoir.

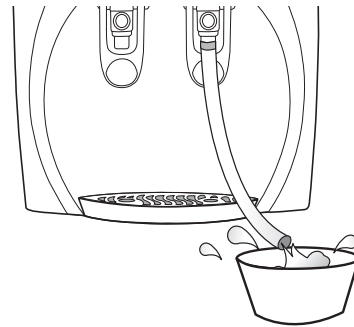

- 3 Open the upper cover of the product and open the cap of the storage tank.

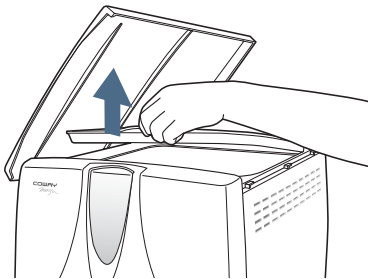

- 4 Wipe the inside of the storage tank with a soft cloth soaked with a edible detergent.

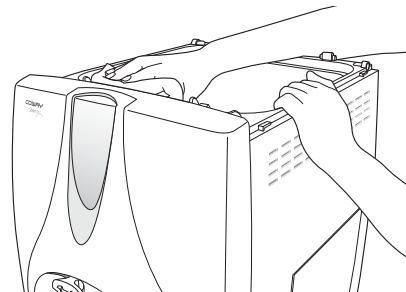

- 5 Wash out the storage tank with the reserved water and drain it through the drain hose.

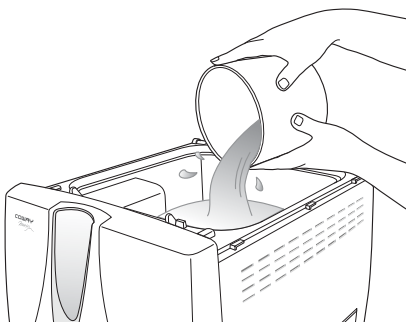

- 6 Close the cap and the upper cover. And plug the power cord into the wall outlet.

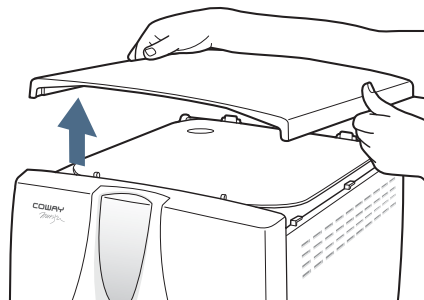

ABOUT COWAY'S REVERSE OSMOSIS SYSTEM

How does Coway's Water Purifier Filter Out Wastes?

The osmotic membrane phenomenon has been applied to Coway water purifier, where a TFC membrane with pores that measure $0.001\mu\text{m}$ (1/1,000,000 of a strand of hair) is used to purify water. The components of our water purification system are as follow:

Plus-Sediment Filter

Using a step-by-step filtering method per pore, this filter effectively reduces various foreign particles that come from the service water pipe such as bits of rust and also protects the membrane. The Plus-Sediment filter vastly reduces dirt, sand, rust particles, and other sediment.

Pre-Carbon Filter

The activated carbon filter reduces chlorine, fluoride, odor, tri-halo methane, gas additive MTBE, and organic pollutants such as pesticides, EBD, PCB, benzene and TCB.

Reverse Osmotic Membrane Filter

The reverse osmosis filter reduces cryptosporidium, viruses, coliform, bacteria, radioactive radon, ethylene glycol(anti-freeze), arsenic, copper, iron, lead, manganese, as well as dissolved chemical solids such as bicarbonate, cyanide, ferrocyanide, nitrates and nitrites.

Post-Carbon Filter

Made using coconut, this filter reduces unpleasant smell from water and enhances water flavor.

UF Membrane Filter

This filter removes water contaminants such as waterborne Microorganisms and harmful macromolecular organic chemicals Etc.

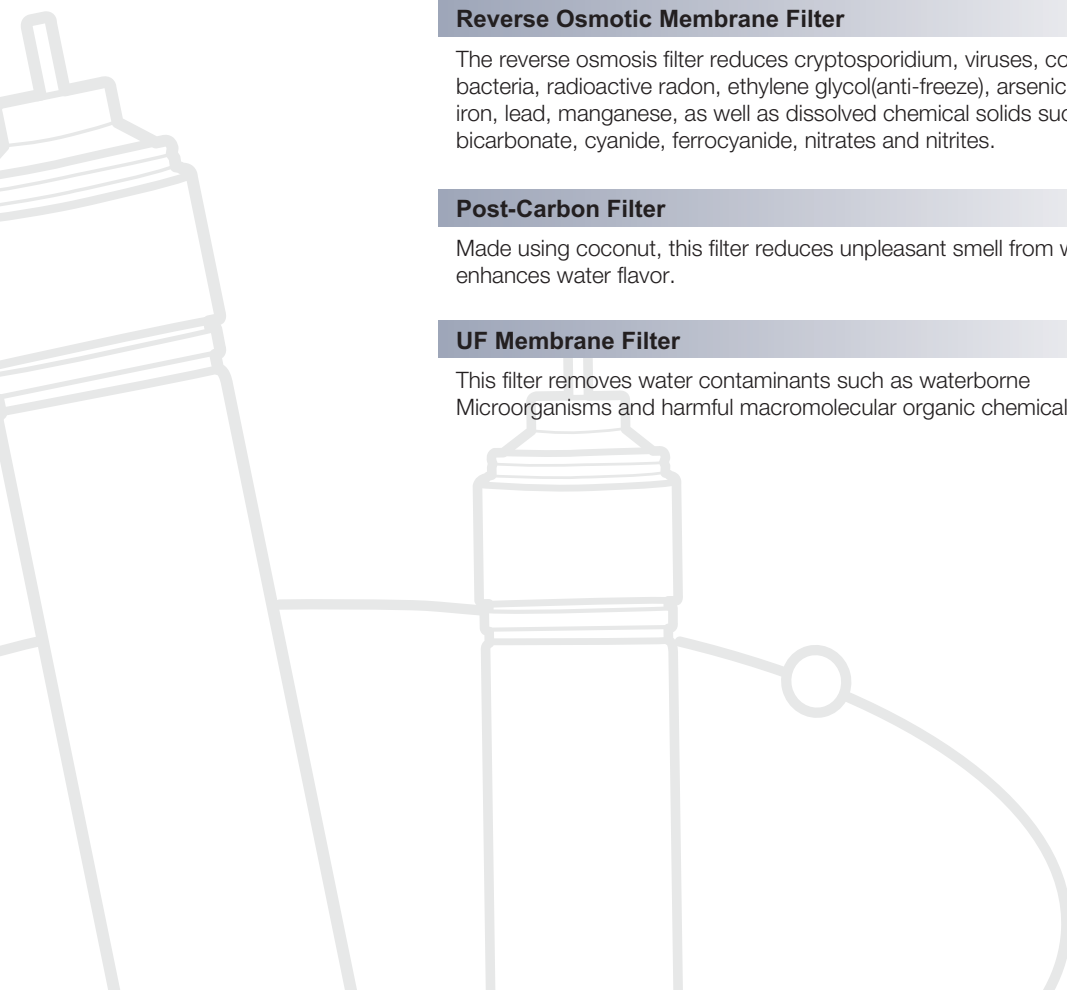

Water Purifier Process

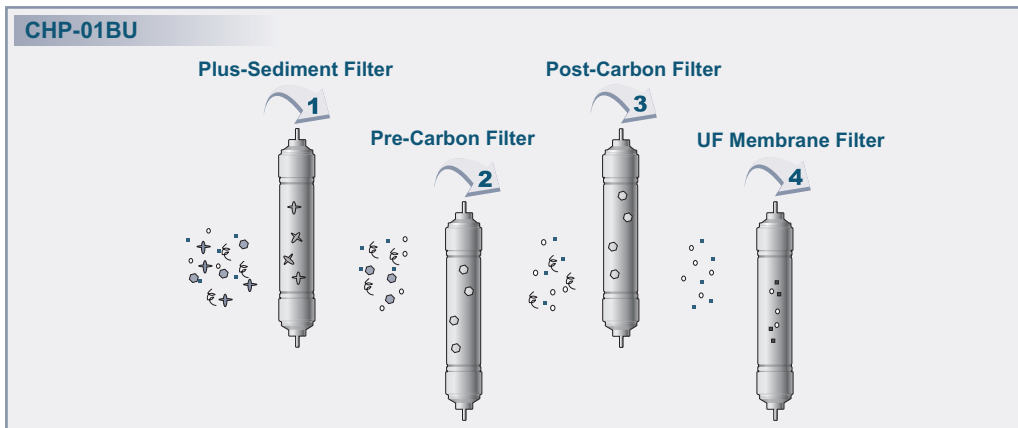
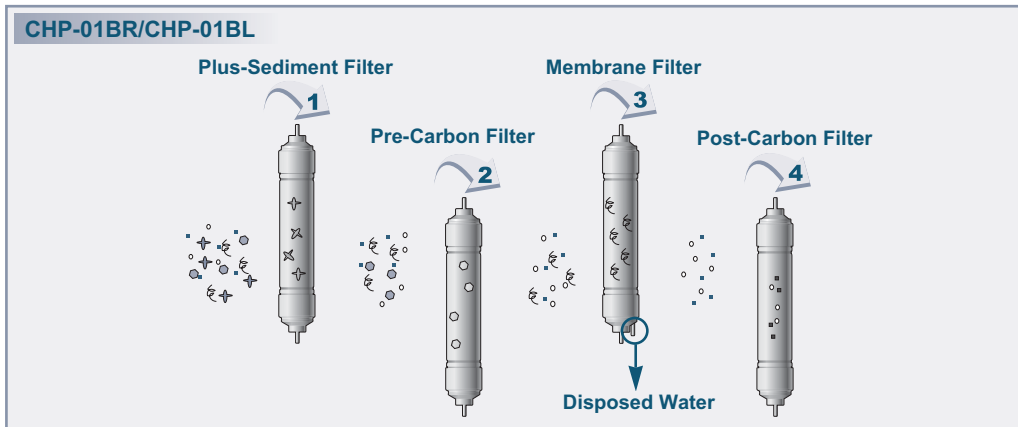

⚠ WARNING Use of Disposed Water

It shall be used for cleaning a toilet, cleaning a house, doing the dishes, doing the washing, and as water for sundry uses. However, please do not use it for potable water or cooking water.

Estimated Time of Filter Replacement

The estimated replacement time of filter which is a consumable part is not an indication of quality guaranteed period, but it means the ideal time of filter replacement. Accordingly, the estimated time of filter replacement may be shortened in case it is used in the area of poor water quality or it is used a lot.

Names of Filter	Usable Period
Plus-Sediment filter	3~6 months
Pre-Carbon filter	12 months
Membrane filter	12~24 months
Post-Carbon filter	12~18 months
UF Membrane filter	12 months

CHECKUP POINT BEFORE ASKING FOR A/S SERVICE

Please checkup the following points before asking for A/S service.

Trouble	Check-up	Troubleshooting
Unusual taste of water	Have you cleaned the storage tank?	Clean the storage tank.
	Have you stored the purified water too long?	Drain the stored water and clean the storage tank.
	Is it the time to replace the filter?	Replace the filter.
The amount of the purified water has suddenly increased(decreased).	Is it connected to the power?	Check if the power cord is plugged in.(CHP-01BR)
	Haven't you closed the supplying water valve?	Check the supplying water valve.
	Haven't the temperature of the supplying water dropped dramatically?	If the water temperature lowers, the amount of purified water reduces.
	It looks that the filter is blocked or damaged.	Replace the filter.
The function of cooling or heating does not work properly	Is the cold or hot water selection switch on?	Turn on the cold or hot water selection switch.
	Is the low-level indication lamp on?	When the low-level indication lamp is on, the function of cooling & heating stops temporarily.
	Is the overheating lamp on?	Ask for A/S service .

Trouble	Check-up	Troubleshooting
No water comes out.	Is there the suspension of water supply or the supplying water valve closed?	Open the supplying water valve.
	It looks that the drain faucet out of order.	Ask for A/S service.
	Have you missed the time of filter replacement?	Replace the filter.
During operation, all functions stopped suddenly.	Is the supplying water supplied smoothly?	Check the supplying water valve.
	Is the power connected?	Check if the power cord is correctly plugged in.
	Is the purified water overflowed or leaking?	Ask for A/S service.
	It looks that the fuse is blown.	Ask for A/S service.



WATERFLOW DIAGRAM

CHP-01BR

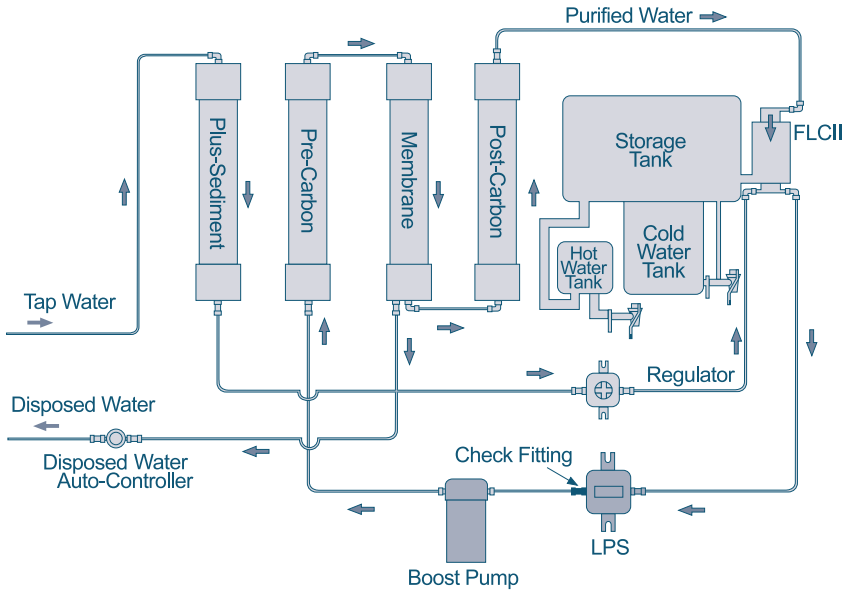

NOTE Exclude boost pump, LPS, and check fitting on CHP-01BL

CHP-01BU

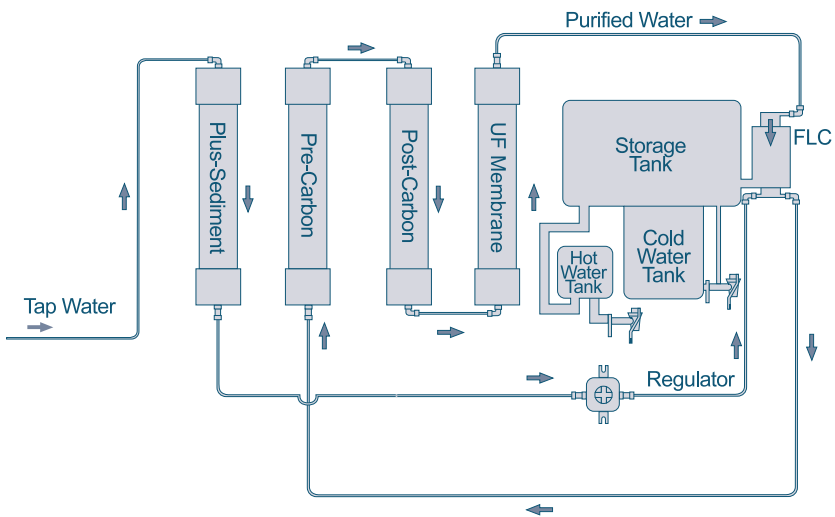

Product Name		Nurisu Hot & Cold Water Purifier
Model		CHP-01BR/BL/BU
Rated Power Consumption	Compressor	0.95A
	Heater	350W
Tank Capacity	Purified Water	6.6 liter
	Cold Water	3.5 liter
	Hot Water	1.2 liter
Cooling/Heating Controlled Temperature	Cold Water	4℃
	Hot Water	94℃
Purification Method		Reverse Osmotic Pressure (R/O, Low pressure R/O) Ultrafiltration (pressure of 14.7psi)
Purification Capacity		7.9 liter/hr(25℃, 60psi):CHP-01BR
		5 liter/hr(25℃, 20psi):CHP-01BL
		62.5 liter/hr(25℃, 14.7psi):CHP-01BU
Dimension		(365)W x (485)D x (524)H mm

- Without any prior notice, all or a part of the product are subject to change for the purpose of improving the performance of the product.
- There may be a difference in the volume of purified water according to water pressure and water temperature.