

LCD TV and Home Theater

# Quick reference guide

## 1 Connect audio and video

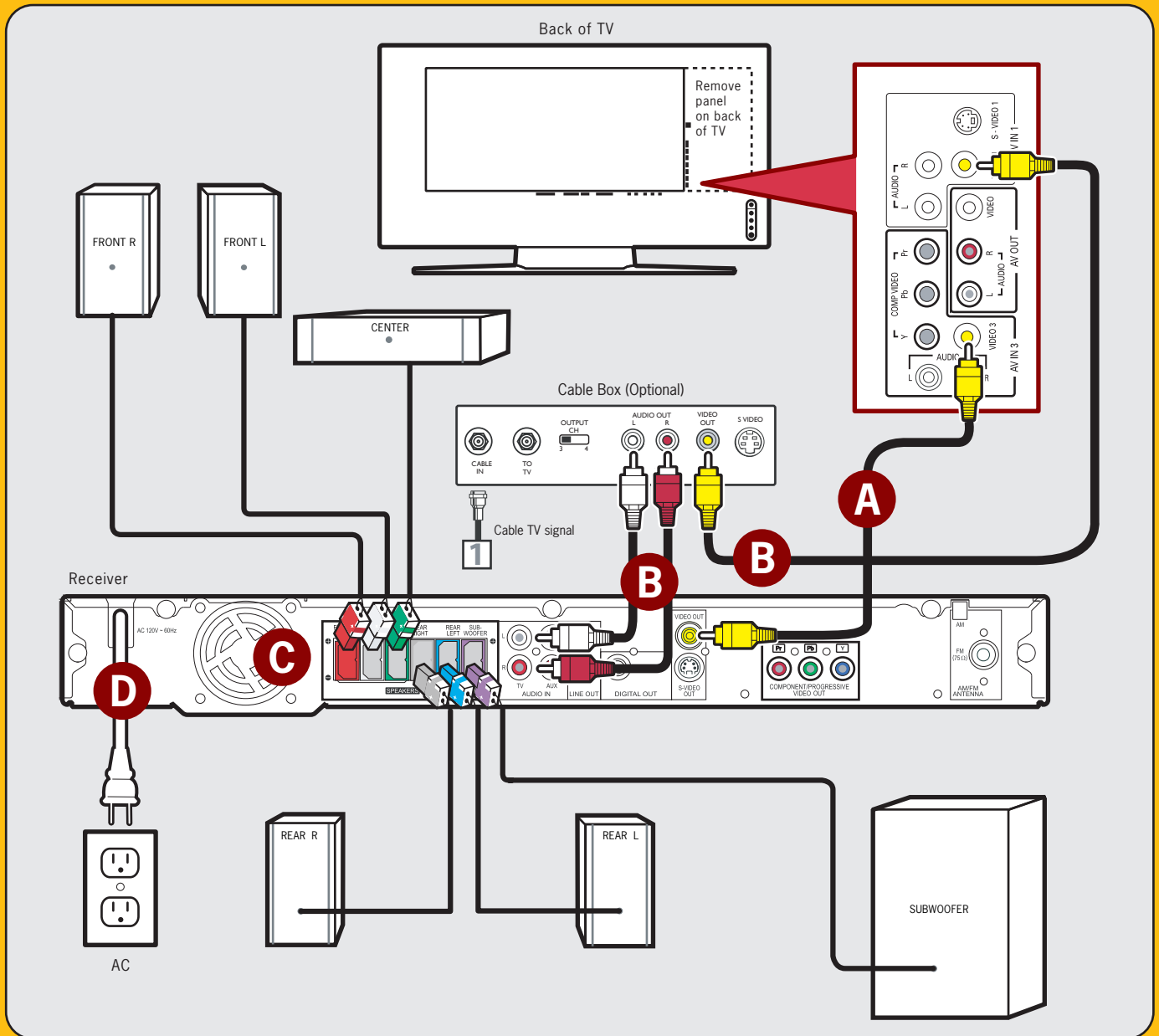

- A** Connect the video cable to receiver
- B** (Optional) Connect cable box audio cables to receiver and video cable to television
- C** Connect speakers and subwoofer to receiver
- D** Connect power to receiver

# 2 Remote Controls

## Tips on Using Your New TV / Home Theater System

### In order to watch a TV program via your cable box

- A** Using the Magnavox TV remote control, press the **power button** on the remote to turn the TV on.
- B** Now press the **source button** on the remote until you see **AV 1** on the upper left hand side of the screen.
- C** Using the Philips Home Theater remote control, press the **TV button** on the remote and set your desired volume level by pressing the **Vol +** or **Vol -** buttons.
- D** (Please note volume will come from the home theater speakers only.)

Using your cable box remote change the channel on the cable box to the desired viewing station.

**NOTE:** Using the volume buttons on the Philips Home Theater remote control will display the volume bar for the TV and the Home Theater system. This is normal behavior for these components. As long as you connect the audio cables to only the Home Theater system (see front page of this guide) only the home theater system volume bar will reflect the actual audio level.

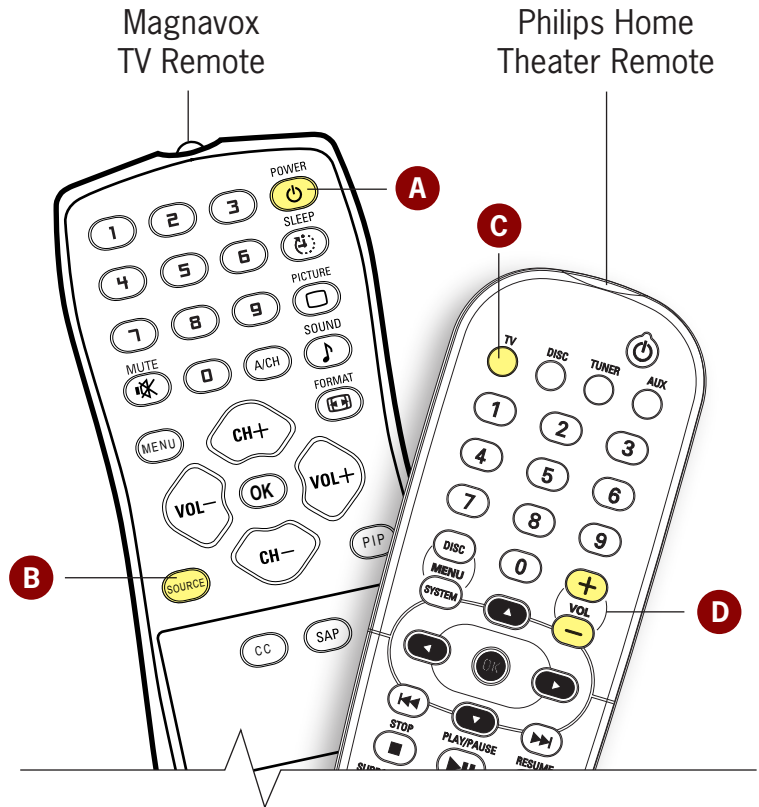

### In order to watch a DVD via your Home Theater System

- A** Using the Magnavox TV remote control, press the **power button** on the remote to turn the TV on.
- B** Now press the **source button** on the remote until you see **AV 3** on the upper left hand side of the screen.
- C** Using the Philips Home Theater remote control, press the **Disc button** on the remote. Insert your DVD and then set your desired volume level by pressing the **Vol +** or **Vol -** buttons on the remote control.
- D**

For further information, consult the directions for use and other documentation that came with each component.

