





## WARNING:

TO PREVENT FIRE OR SHOCK HAZARD, DO NOT EXPOSE THIS APPLIANCE TO RAIN OR MOISTURE. DO NOT REMOVE COVER. PILOT LAMPS SOLDERED IN PLACE. NO USER SERVICEABLE PARTS INSIDE. REFER SERVICING TO QUALIFIED SERVICE PERSONNEL.

	<b>CAUTION</b> RISK OF ELECTRIC SHOCK DO NOT OPEN	
<b>CAUTION:</b> TO REDUCE THE RISK OF ELECTRIC SHOCK, DO NOT REMOVE COVER (OR BACK). NO USER - SERVICEABLE PARTS INSIDE. REFER SERVICING TO QUALIFIED SERVICE PERSONNEL.		
	The lightning flash with arrowhead symbol, within an equilateral triangle, is intended to alert user to the presence of uninsulated "dangerous voltage" within the product's enclosure that may be of sufficient magnitude to constitute risk of electric shock to persons.	
	The exclamation point within an equilateral triangle is intended to alert user to the presence of important operating and maintenance (servicing) instruction in the literature accompanying the appliance.	

## SPECIFICATIONS

FREQUENCY RANGE	: FM 88 - 108 MHz AM 530 - 1710 KHz
POWER CONSUMPTION	: 10W
POWER SOURCE	: AC 120V ~ 60Hz
ANTENNAS	: Built - in line cord antenna for FM Built - in ferrite bar for AM
SPEAKER	: 114.3 x 69.8 (4 1/2 x 2 3/4 ) Oval 8 ohms

\* DESIGN AND SPECIFICATION SUBJECT TO CHANGE WITHOUT NOTICE.  
CAUTION: TO PREVENT ELECTRIC SHOCK, MATCH WIDE BLADE OF PLUG TO WIDE SLOT, FULLY INSERT.

YOU'RE THERE WITH A CROSLEY  
**CROSLEY RADIO**

1220 East Oak Street • Louisville, Kentucky 40204  
www.crosleyradio.com

910-080900-011

**CROSLEY**  
**RADIO**

**CR10**

**Diner Jukebox AM/FM Radio With Cassette**

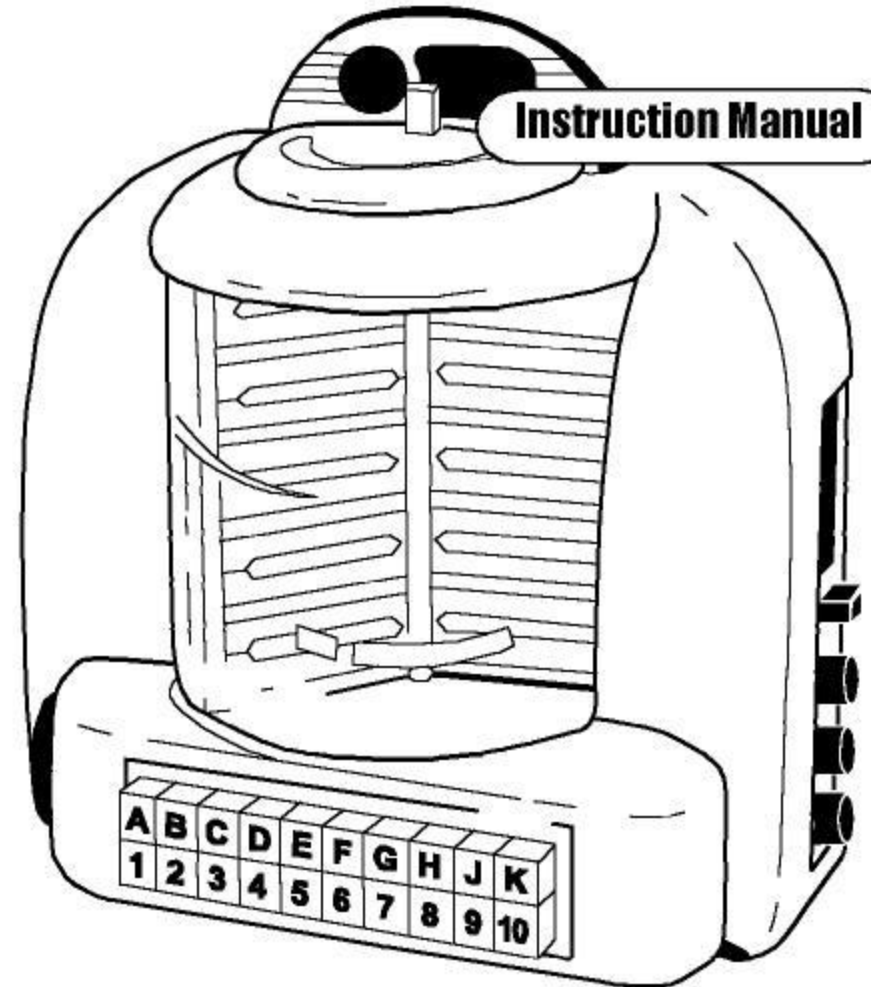

## IMPORTANT SAFETY INSTRUCTION

PLEASE READ CAREFULLY ALL THE FOLLOWING IMPORTANT SAFEGUARDS THAT ARE APPLICABLE TO YOUR EQUIPMENT

1. Read Instructions - All the safety and operating instructions should be read before the product is operated.
2. Retain instructions - The safety and operating instructions should be retained for future reference.
3. Heed Warnings - All warnings on the product and in the operating Instructions should be adhered to.
4. Follow Instructions - All operating and use instructions should be followed.
5. Cleaning - Unplug this product from the wall outlet before cleaning. Do not use liquid cleaners or aerosol cleaners. Use a damp cloth for cleaning.
6. Attachments - Do not use attachments not recommended by the product manufacturer as they may cause hazards.
7. Water and Moisture - Do not use this product near water - for example, near a bath tub, wash bowl, kitchen sink, or laundry tub; in a wet basement; or near a swimming pool; and the like.
8. A product and cart combination should be moved with care. Quick stops, excessive force, and uneven surfaces may cause the product and cart combination to overturn.
9. Ventilation - Slots and openings in the cabinet are provided for ventilation and to ensure reliable operation of the product and to protect it from overheating, and these openings must not be blocked or covered. The openings should never be blocked by placing the product on a bed, sofa, rug, or other similar surface. This product should not be placed in a built - in installation such as a bookcase or rack unless proper ventilation is provided or the manufacturer's instructions have been adhered to.
10. Power Sources - This product should be operated only from the type of power source indicated on the marking label, if you are not sure of the type of power supply to your home. Consult your product dealer or local power company. For products intended to operate from battery power, or other sources, refer to the operating instructions.
11. Grounding or Polarization - This product may be equipped with a polarized alternating-current line plug (a plug having one blade wider than the other). This plug will fit into the power outlet only one way. This is a safety feature. If you are unable to insert the plug fully into the outlet try reversing the plug. If the plug should still fail to fit, contact your electrician to replace your obsolete outlet. Do not defeat the safety purpose of the polarized plug.
12. Power - Cord Protection - Power - supply cords should be routed so that they are not likely to be walked on or pinched by items placed upon or against them, paying particular attention to cords at plugs, convenience receptacles, and the point where they exit from the product.
13. Lightning - For added protection for this product during a lightning storm, or when it is left unattended and unused for long periods of time, unplug it from the wall outlet and disconnect the antenna or cable system. This will prevent damage to the product due to lightning and power - line surges.
14. Power Lines - An outside antenna system should not be located in the vicinity of overhead power lines or other electric light or power circuits, or where it can fall into such power lines or circuits. When installing an outside antenna system, extreme care should be taken to keep from touching such power lines or circuits as contact with them might be fatal.



AC  
Polarized Plug

15. Overloading - Do not overload wall outlets, extension cords, or integral convenience receptacles as this can result in a risk of fire or electric shock.
16. Object and Liquid Entry - Never push objects of any kind into this product through openings as they may touch dangerous voltage points or short - out parts that could result in a fire or electric shock. Never spill liquid of any kind on the product.
17. Servicing - Do not attempt to service this product yourself as opening or removing covers may expose you to dangerous voltage or other hazards. Refer all servicing to qualified service personnel.
18. Damage Requiring Service - Unplug this product from the wall outlet and refer servicing to qualified service personnel under the following conditions:
  - a. When the power-supply cord or plug is damaged.
  - b. If liquid has been spilled, or objects have fallen into the product.
  - c. If the product has been exposed to rain or water.
  - d. If the product does not operate normally by following the operating instructions. Adjust only those controls that are covered by the operating instructions as an improper adjustment of other controls may result in damage and will often require extensive work by a qualified technician to restore the product to its normal operation.
  - e. If the product has been dropped or damaged in any way.
  - f. When the product exhibits a distinct change in performance - this indicates a need for service.
19. Replacement Parts - When replacement parts are required, be sure the service technician has used replacement parts specified by the manufacturer or have the same characteristics as the original part. Unauthorized substitutions may result in fire, electric shock, or other hazards.
20. Safety Check - Upon completion of any service or repairs to this product, ask the service technician to perform safety checks to determine that the product is in proper operating condition.
21. Wall or ceiling Mounting - The product should be mounted to a wall or ceiling only as recommended by the manufacturer.
22. Heat - The product should be situated away from heat sources such as radiators, Heat registers, stoves, or other products (including amplifiers) that produce heat.

**WARNING:** Changes or modifications to this unit not expressly approved by the party responsible for compliance could void the user's authority to operate the equipment.

**NOTE:** This equipment has been tested and found to comply with the limits for a Class B digital device, pursuant to Part 15 of the FCC Rules. These limits are designed to provide reasonable protection against harmful interference in a residential installation. This equipment generates, uses, and can radiate radio frequency energy and, if not installed and used in accordance with the instructions, may cause harmful interference to radio communications. However, there is no guarantee that interference will not occur in a particular installation. If this equipment does cause harmful interference to radio or television reception, which can be determined by turning the equipment off and on, the user is encouraged to try to correct the interference by one or more of the following measures:

- Reorient or relocate the receiving antenna.
- Increase the separation between the equipment and receiver.
- Connect the equipment into an circuit different from that to which the receiver is connected.
- Consult the dealer or an experienced radio TV technician for help.

## POWER SOURCE

Unwind the AC power cord (9) at the back of the unit and connect it to a power outlet.

## EXTERNAL ANTENNA

The unit is provided with a wire antenna for FM (8) reception. Move the wire until the reception is clear. Do not connect the FM antenna to any external antenna. AM reception would be improved by relocating the unit.

## RADIO OPERATION

1. Rotate the VOLUME knob (5) from the OFF position past the 'click' towards the MAX position to turn on the unit.
  2. Select your desired radio band (AM or FM) by rotating the FUNCTION knob (6) to the AM or FM position. The dial scale can be seen by carefully flipping the dial cover down.
  3. Select the desired radio station by rotating the TUNING knob (7).
  4. Adjust the listening level by rotate by rotating the VOLUME knob (5).
- \* To turn off the unit, rotate the VOLUME knob (5) past the 'click' to the OFF position.

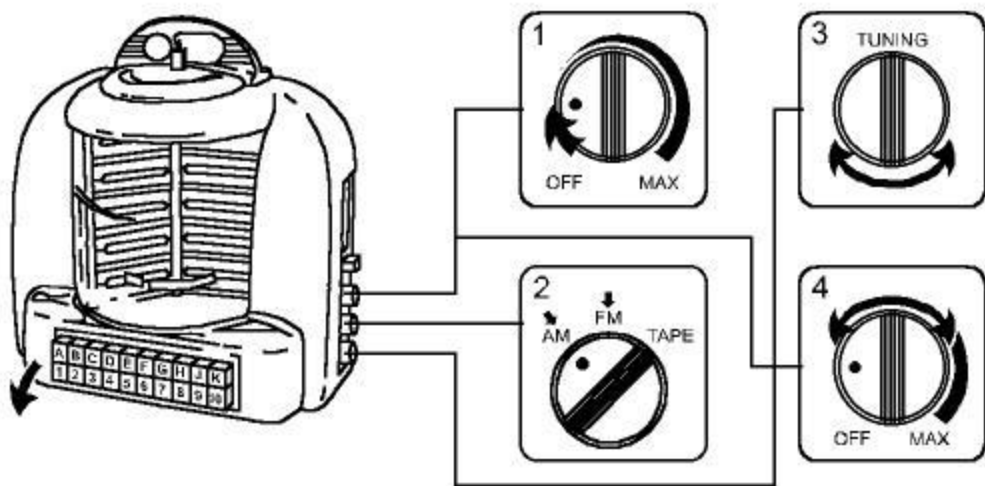

## CASSETTE TAPE OPERATION

1. Rotate the VOLUME knob (5) from the OFF position past the "click" towards the MAX position to turn on the unit.
2. Rotate the FUNCTION knob (6) to the TAPE position.
3. Insert a cassette tape into the cassette tape door (TAPE IN) (3). Be sure to observe proper cassette orientation when inserting a tape into the unit (see fig.3 below). The tape will start playing as soon as the cassette is properly seated. If you are having trouble inserting the cassette, do not use force! Remove the tape, check for proper cassette orientation, then try again. Please do not leave the cassette tape in the mechanism when it is not in use.

4. Adjust the listening level by rotate by rotating the VOLUME knob(5).

- \* If you wish to fast forward the tape, push the CASSETTE button (4) halfway down to the F.FWD position. It will lock in this position and tape will advance quickly. No playback will be heard during the F.FWD mode. To cancel the F.FWD mode simply depress the cassette button a second time. It will pop out and the PLAY mode will resume, unless you have fast forwarded to the end of the cassette, in which case you should fully depress the CASSETTE button (4) to eject the cassette.
- \* If you wish to eject the tape thus stopping playback, push the cassette button all the way down to the EJECT position.
- \* When the tape reaches its end in either the play or fast forward mode, the cassette will automatically stop. At the end of the cassette, the EJECT button should be fully depressed to remove the cassette. Failure to do so places unnecessary wear on both the cassette motor and your cassette tape.
- \* To turn off the unit, rotate the VOLUME knob (5) past the 'click' to the OFF position.

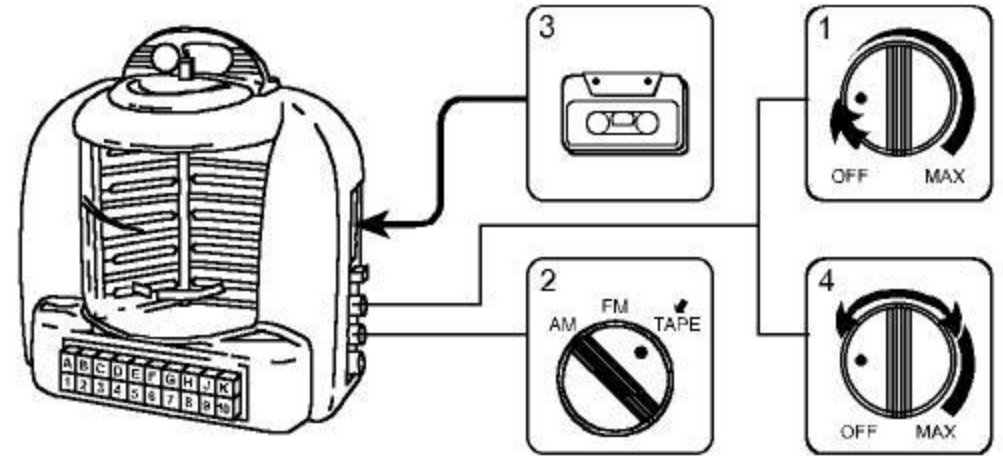

## IMPORTANT CLEANING INSTRUCTIONS

The cabinet of this radio has been chrome-dipped to recreate the look and feel of the original classic unit.

In order to maintain the brilliance of the metallic finish never use solvents, abrasives or cleaners. A simple wiping with a soft cloth is all that is needed to keep the outside of the radio looking like new. Failure to observe this guideline will void any related warranty claim.

## TROUBLE SHOOTING GUIDE

### The unit is not functioning

- \* The AC power cord is not connected to a power outlet.
- \* The unit is not turned on : rotate the VOLUME knob from the OFF position past the "click" to turn on the unit.

### No radio

- \* The function switch is not in the correct position. Turn function switch insert to RADIO.
- \* Adjust the VOLUME knob.
- \* Rotate the TUNING knob to find a radio station.

### Cassette tape cannot be inserted

- \* The cassette tape is inserted in the wrong position.

### No cassette playback

- \* The cassette tape is not pushed all the way in.
- \* Adjust the volume knob.
- \* The cassette has reached the end of the side being played. Open cassette tape door, take out tape, flip over the cassette and reinsert.

## LOCATION OF PARTS

1. SPEAKER
2. DIAL COVER & TUNING DISPLAY
3. CASSETTE TAPE DOOR
4. CASSETTE BUTTON
5. VOLUME KNOB
6. FUNCTION KNOB
7. TUNING KNOB
8. FM ANTENNA
9. POWER PLUG

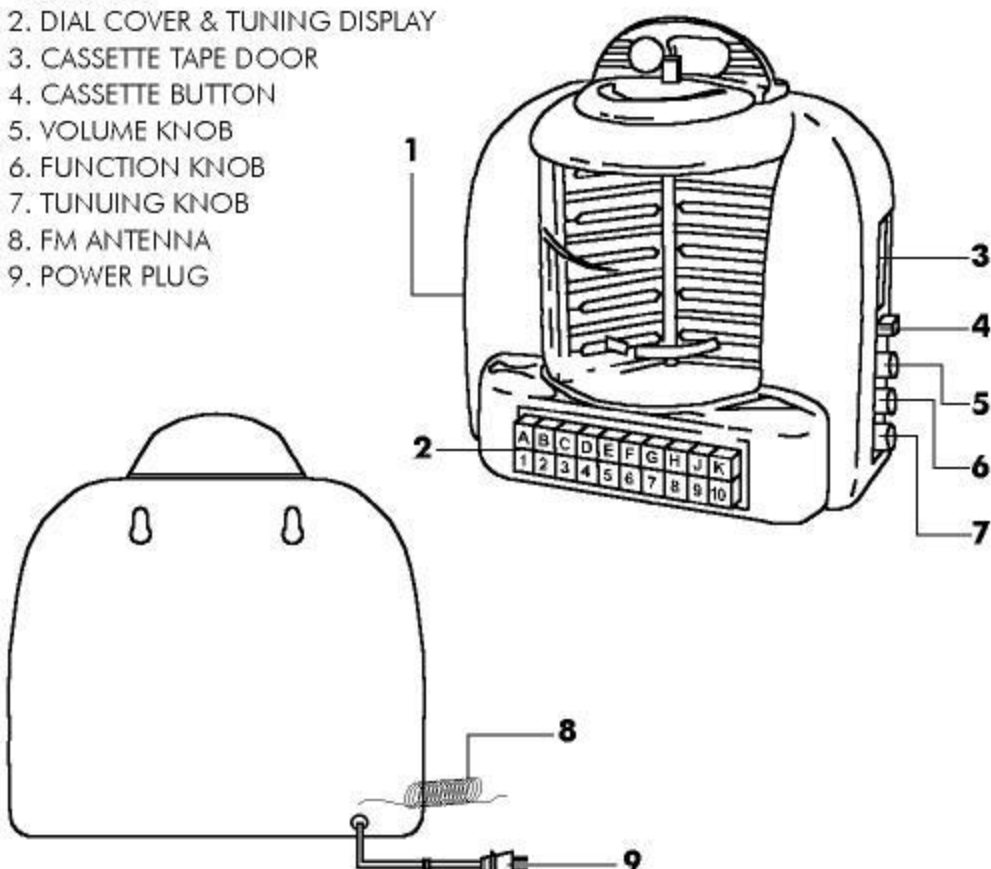

## WARRANTY

Crosley Radio Products are warranted against defects in material and workmanship for a period of 90 days beginning from the date of sale to the original purchaser.

Should the unit fail under normal usage during the 90 day warranty period, a request for RETURN AUTHORIZATION (R.A.) must be made by the original customer before returning the unit. Call Crosley Radio customer service for Return Authorization at (502) 583-4246 from 9 AM to 5 PM (EST) Monday to Friday.

Upon receiving the RETURN AUTHORIZATION number from the Customer Service Department, properly pack your unit in its original packaging. Include any adapters, parts, & accessories which were originally provided with the product, along with a check or money order for \$19.95 made out to Crosley Radio to cover the handling and return postage. Display the R.A. # on the outside of the carton and ship PREPAID via standard UPS or its equivalent.

**CROSLEY  
RADIO**

ATTN: RETURNS DEPT  
2001 PRODUCTION DRIVE  
BAY 2 & 3  
LOUISVILLE, KY 40299

CROSLEY RADIO assumes no responsibility for units sent without prior Return Authorization.

The purchaser's bill of sale is the only proof of warranty entitlement and must accompany the unit.

The warranty does not cover damage due to acts of nature, accident, misuse, abuse, negligence, commercial use or modification of, or to any part of the product. This warranty does not cover damage due to improper operation or maintenance, connection to improper voltage supply, or attempted repair by anyone other than a facility authorized by Crosley Radio to service the product. This warranty does not cover products sold AS IS or consumables (such as fuses or batteries). This warranty is valid only in the United States.

This warranty gives the purchaser specified legal rights in addition to any rights which may vary from state to state.

In accordance with the "Moss-Magnuson Warranty Act" of July 10, 1975, this is termed a "limited warranty" which in no way compromises Crosley Radio, high standards of Quality and Workmanship.