

# AM5055 Roadster V.92 USB



## FAST, PROFESSIONAL INTERNET CONNECTION

### V.92 – QUICK CONNECT, FASTER BROWSING\*

Your NetComm Roadster features the latest V.92 technology.

- QuickConnect cuts the time it takes to connect.
- V.44 compression speeds Web browsing and download speeds.

*\* Your Internet Service Provider must support the V.92 standard for these features to work. If a V.92 connection is not available, this modem automatically reverts to the 56K V.90 mode.*

### USB FOR TRUE PLUG & PLAY

USB allows significantly faster communications and easier connectivity – simply plug it in and your computer does the rest! There's no need for that extra power point or cable either – the USB port delivers enough power to run your modem.

### DESKTOP FAXING

Send a fax direct from your PC without leaving your desk; file it with your other documents on your network or hard drive.

### TELEPHONE ANSWERING MACHINE (TAM)

With the NetComm Roadster you not only get a modem, but an "Out of Office Assistant" as well. TAM lets you set up multiple voicemail boxes, one for each member of the office or family.

### FLASH ROM UPGRADEABLE

If the need arises to update your firmware, the NetComm Roadster V.92 can be upgraded directly from our website.

### ULTRA CONNECT

Ultra Connect, NetComm's enhanced technology, manages your connection to your ISP and negotiates aggressive transmission speeds for faster connections, downloads and web surfing.

### CALLER ID<sup>†</sup>

NetComm's Roadster V.92 allows the display of caller numbers, giving you the option to filter your calls before answering.

### DISTINCTIVE RING SUPPORT<sup>†</sup> FAXSTREAM DUET™

The Roadster V.92 can automatically distinguish between an incoming fax or voice call on a single telephone line.

*†Your telephone service provider must first enable this service.*

## CHECK THESE GREAT FEATURES

- Now with V.92\* for the fastest, most reliable connections and auto fall-back for full compatibility
- V.44 compression for accelerated web browsing\*
- Ultra fast upload speed with V.92 – up to 48kbps\*
- QuickConnect dramatically reduces log-on time\*
- True Plug & Play with one-plug USB connection and easy set-up

## 3 YEAR WARRANTY\*

1 year warranty out of the box.  
Extra 2 years FREE with online  
registration at [www.netcomm.com.au](http://www.netcomm.com.au)

\*Conditional upon registration online.

# AM5055 Roadster V.92 USB

## DESKTOP FAXING

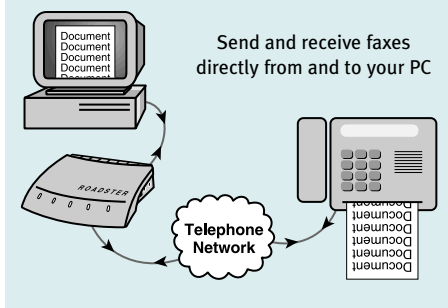

## TELEPHONE ANSWERING MACHINE (TAM)

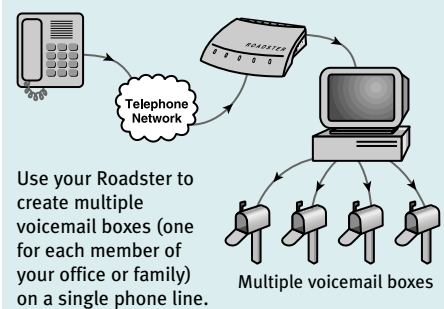

## IMPORTANT INFORMATION

Do not connect your modem to a digital phone line or digital PABX. 56Kbps is the maximum download speed and 48Kbps is the maximum upload speed. Both are subject to telecommunications carrier service.

Your Internet Service Provider must support the V.92 standard for V.92 features to work. If a V.92 connection is not available, this modem automatically reverts to the 56K V.90 mode.



## TECHNICAL SPECIFICATIONS

56Kbps (download)	Auto-negotiates V.90 & V.92
48Kbps(upload)	V.44
Error Correction	ITU-T V.42, MNP 2-4, MNP 10EC
Data Compression	ITU-T V.44, V.42bis, MNP 5
Maximum Throughput	230,400bps
Fax Send/Receive Speeds	14,000bps (Class 1 & 2)
Digital Line Protection	Yes
Voice Capable	Yes
(Telephone Answering Machine – TAM)	Yes
Flash ROM Upgradeable	Yes
Video support compatibility	V.80 for H.324

## SUGGESTED SYSTEM REQUIREMENTS

- A Pentium processor for Internet access
- Microsoft Windows® 95, 98, 2000, ME or XP
- 32MB RAM
- Hard Disk with 80MB free space
- CD-ROM drive for software installation

## PACKAGE CONTENTS

- Roadster USB V.92 Data/Fax/Voice Modem
- NetComm Communications CD packed full of useful software and utilities including Fax, Data, Voicemail and Acrobat.
- RJ11 to RJ11 Telephone cable
- RJ11 to 605 Line Adaptor
- USB data cable
- Quick Start & Installation Guide

Your Netcomm dealer:

**NetComm is Australia's dynamic data communications and networking solutions provider. For more information on this and other NetComm products, please visit [www.netcomm.com.au](http://www.netcomm.com.au)**

NetComm Limited ABN 85 002 490 486

PO Box 1200, Lane Cove NSW 2066 Australia.

**PHONE** (02) 9424 2070 • **FAX** (02) 9424 2010

**www.netcomm.com.au** • **EMAIL** [sales@netcomm.com.au](mailto:sales@netcomm.com.au)

Trademarks and registered trademarks are the property of NetComm Limited or their respective owners. Specifications are subject to change without notice. Images shown may vary slightly from the product.