

# HP Officejet 7500A Wide-Format e-All-in-One Solution and Feature Guide





# CONTENTS

Getting to know the HP Officejet 7500A Wide-Format e-All-in-One .....	1
Product walk-around.....	2
Top features .....	3
Deliver professional quality at low cost .....	4
Print without a PC using web-connected solutions .....	5
Produce vivid, fast drying, professional prints .....	6
Cut energy use and build your bottom line .....	8
Get wide-format versatility in an All-in-One .....	9
Gain efficiency with wireless productivity .....	11
Legendary HP reliability .....	13
A—Technical specifications .....	14
B—Accessories and supplies .....	17



# Getting to know the HP Officejet 7500A Wide-Format e-All-in-One

---

Welcome to the Solution and Feature Guide for the new HP Officejet 7500A Wide-Format e-All-in-One. This guide will introduce you to the e-All-in-One.

Create professional color documents for the lowest cost per page compared with in-class, wide-format inkjet all-in-ones on a range of paper types and sizes up to 330 by 483 mm (13 by 19 in).<sup>1</sup> A wide-format tray and automatic document feeder help you increase productivity. Use the integrated wired and wireless networking to share with multiple users.<sup>2</sup> A 2.36-inch touchscreen delivers touch-and-tap access to apps.<sup>3</sup> Print from anywhere, anytime with any mobile device, using HP ePrint.<sup>4</sup>

## Target customer

Ideal for businesses that need a wireless, web-connected All-in-One to print low-cost, professional marketing materials up to 330 by 483 mm (13 by 19 in), web content via apps, or from remote locations using HP ePrint.<sup>3,4</sup>



# Product walk-around

HP Officejet 7500A Wide-Format e-All-in-One shown

- 1 Large 2.36-inch intuitive touchscreen control panel for copy, scan, and fax operation
- 2 35-sheet automatic document feeder (ADF)
- 3 Ink cartridge cover provides quick access to four individual ink cartridges
- 4 100-sheet output tray supports sizes up to A3+/B-size
- 5 Memory card slots for walk-up photo printing
- 6 150-sheet input tray supports sizes up to A3+/B-size
- 7 192 MHz processor and 128 MB RAM provide quick, reliable printing
- 8 Hi-Speed USB 2.0 port provides effortless direct connections
- 9 Built-in wireless networking
- 10 Built-in Ethernet networking
- 11 RJ-11 fax ports



# Top features

---

- **Print to impress.**

Produce professional-quality color for the lowest cost per page compared with in-class, wide-format, inkjet all-in-ones.<sup>1</sup> Deliver stunning images and laser-quality black text. High-capacity cartridges offer even more value.<sup>5</sup>

- **Print without a PC using web-connected solutions.**

When you are in the office, apps enable you to print the forms and documents you need most frequently from your e-All-in-One—without returning to your PC.<sup>3</sup> The product's touchscreen puts web content and product functions at your fingertips. And when you are away from your office, use your handheld mobile device to print to a web-connected printer across the room or across town.<sup>4</sup>



- **Print stunning, fade-resistant photos and laser-quality text.**

The HP Officejet 7500A Wide-Format e-All-in-One makes a long-lasting business impression with professional-quality color that dries quickly and is exceptionally fade resistant. Archived documents retain text and color quality for decades.<sup>6</sup>

- **Save energy and conserve resources.**

Reduce costs, use less energy, and save paper with this ENERGY STAR®-qualified e-All-in-One. Robust digital faxing features allow you to save paper, while HP Planet Partners helps you to recycle responsibly.

- **Get wide-format versatility in an All-in-One.**

The device adjusts to accommodate media up to 330 by 483 mm (13 by 19 in)—with only a slightly bigger footprint than A4/letter printers. Its paper-handling features make it easy to print the business documents you need, with support for paper (plain, inkjet, photo), envelopes, and cards (index, greeting). Improve productivity with advanced copy features. Complete more tasks without your PC. Simply touch the screen to copy, scan, or fax documents

- **Stay connected and improve your efficiency by sharing resources.**

More users can access the same device with both wireless and wired networking options.

# Deliver professional quality at **LOW COST**

---

Print to impress. With individual HP ink cartridges, you produce professional-quality color for the lowest cost per page compared with in-class, wide-format, inkjet all-in-ones.<sup>1</sup> High-capacity cartridges offer an even greater value and a lower cost per page.<sup>5</sup>

## Reduce costs over in-class, wide-format all-in-ones

Print color documents at the lowest cost per page versus in-class, wide-format inkjet printers<sup>1</sup>. HP's ink-delivery system features four individual ink cartridges, as well as specially designed printheads, so you replace only the ink cartridge that runs out. Print up to 420 pages before replacing the black cartridge and up to 300 pages before replacing a color cartridge.<sup>7</sup>

Print more pages before replacing your ink cartridge with high-capacity, individual ink cartridges.<sup>5</sup> You can print up to 1,200 pages before replacing the high-capacity black cartridge and up to 700 pages before replacing a high-capacity color cartridge.<sup>7</sup> High-capacity ink cartridges let you print laser-quality black text and color with fewer interruptions.





# Print without a PC using **WEB-CONNECTED** solutions

Print your documents on the go—without a PC—with HP ePrint.<sup>4</sup> Use your handheld mobile device to print to the nearest web-connected printing device. And when you are in the office, the e-All-in-One offers apps that enable you to quickly access the internet, obtain documents, and print them faster and with less hassle—without using a PC.<sup>3</sup> The product's touchscreen puts web content and product functions at your fingertips.

## Print from the web and mobile devices—PC free<sup>4</sup>

Create the crucial connection between your business and your documents. HP ePrint technology lets you print at your convenience using any internet-capable printing device. HP ePrint technology liberates printing from your home or office by allowing you to print content while traveling or simply out and about from your mobile phone, laptop, or mobile device.

Because larger documents, presentations, and PDF files can be difficult to read on small, handheld device screens, you can easily print documents from your mobile device to read or take with you.

Easily print on the go using one of two methods:

- Download the app (ePrint) from your provider and you're ready to print. Use your mobile device to locate the web-connected printing device closest to you. Then simply send your documents to the device and pick up the pages.
- Attach your document to an email message. Forward that message to a web-connected printing device from your email-capable device and collect your printed document.



## Touch, access, store, and print your business information in seconds

This HP web-enabled e-All-in-One includes apps that you can access from your device's touchscreen control panel.<sup>3</sup> These apps are special print applications available exclusively to HP web-enabled printing devices.

Apps connect the web and your device in an altogether new and seamless way. Choose from a growing library of apps that make printing faster, simpler, and more useful than ever. Access your documents and print them in one touch from your e-All-in-One. Use these apps to:

- Keep commonly used business forms—invoices, contracts, receipts, and more—at your fingertips. Print them when you need them without a PC.
- Store documents on the web—not your PC. Easily scan to the web, then access and print your documents online when you need them.
- Connect to your customized marketing material—brochures, flyers, and more—on Marketsplash by HP and print them in a snap.

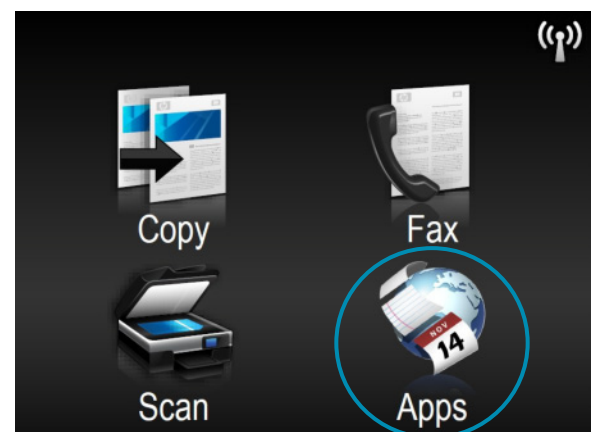

# Produce **VIVID, FAST DRYING,** professional prints

The HP Officejet 7500A Wide-Format e-All-in-One makes a long-lasting business impression with professional-quality color that dries quickly and resists fading. Archived documents retain text and color quality for decades.<sup>6</sup>

## Print fast-drying documents

Handle your documents confidently with HP Officejet inks and HP Everyday Papers with ColorLok® technology. Make an impression every time you print in color using HP Officejet inks and up to 4800 by 1200 optimized dpi. HP Officejet inks for business are specifically developed for use with the HP printhead. Officejet inks enable quick throughput with improved handling ability. Unique ink formulations help extend the life of the printhead and enhance reliability.

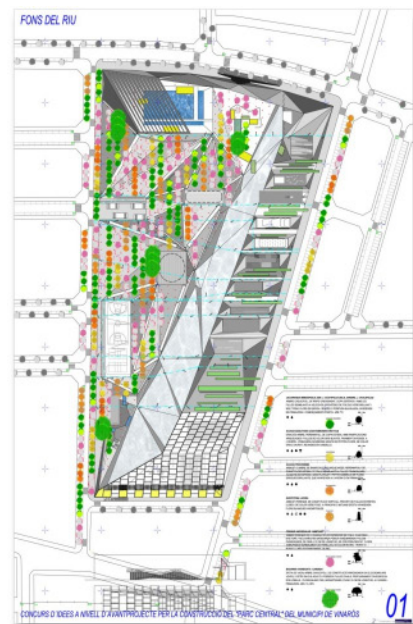

## Archive documents and photos with confidence

Documents degrade over time. As a document ages and is exposed to elements like light, heat, moisture, contact with objects, and pollution, the chemicals used to print the document break down. Additionally, the chemicals used in the papers themselves can contribute to the degradation of the document.

The HP Officejet inks developed for the new HP Officejet 7500A Wide-Format e-All-in-One create durable documents on HP Everyday Papers, brochure papers, and photo papers that may be both archived and displayed for decades.<sup>6</sup>

## Marketing your business just got faster, easier, and free

Everything you need to give your business the professional look it deserves is available at Marketsplash. Thousands of templates created by award winning business designers ensure your marketing materials are both unique and distinct. Choose from logos, flyers, brochures and more, then customize your selection to meet the needs of your business. And when it's time to reprint your marketing materials, convenient one-touch access right from your eAll-in-One gives you the freedom to print whenever you want. Making your business look good has never been easier!

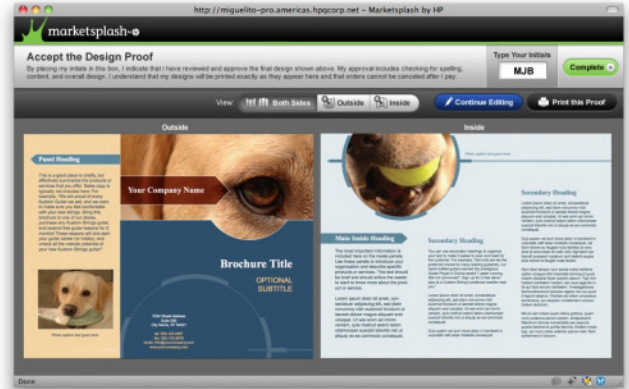
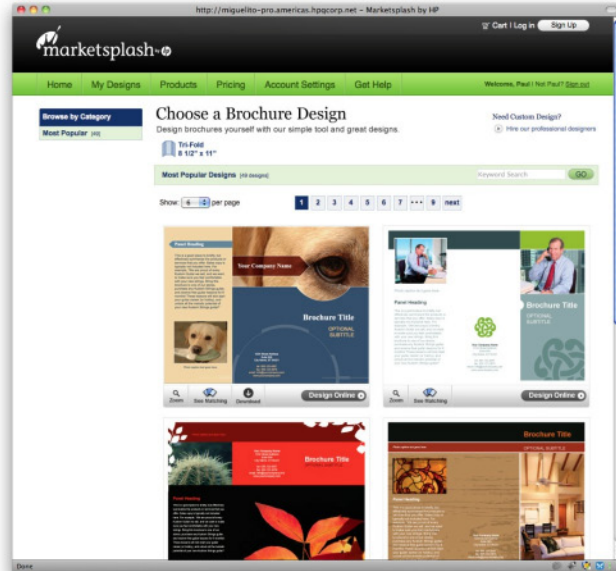

To see what's available and for updates, visit [www.marketsplash.com](http://www.marketsplash.com).

# Cut energy use and BUILD YOUR BOTTOM LINE

Reduce costs, use less energy, and save paper with this ENERGY STAR®-qualified e-All-in-One. Robust digital faxing features allow you to save paper, while HP Planet Partners helps you to recycle responsibly.

This product is designed to make it easier for you to save money and conserve resources. Discover how easy it can be to conserve energy and recycle effectively by selecting the **Eco Tips** located in the **Discover** section of the touchscreen.

## Consume less energy

- Consume up to 40 percent less energy than color laser all-in-ones.<sup>8</sup> Save money through reduced energy costs by using an e-All-in-One that meets U.S. Environmental Protection Agency (EPA) strict energy efficiency guidelines.
- Consume virtually no power during idle mode, and because the e-All-in-One employs Instant-on Technology, experience no additional time for warm up. LED technology is also cleaner, more reliable, and more energy-efficient than fluorescent tube technology.

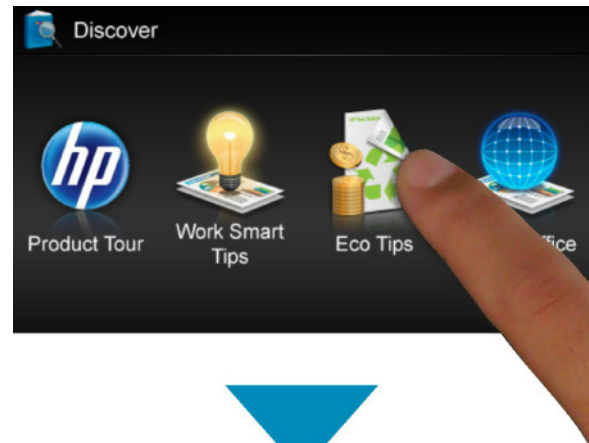

## Save resources

Easily recycle materials, save paper, and use fewer resources across the entire lifecycle of the e-All-in-One.

- Send and receive incoming faxes electronically from your computer instead of on paper. Save money on paper and ink, while reducing paper waste and clutter. In addition, you can easily forward them to colleagues via email or enter fax information in your document management system for secure archiving.
- Unwanted incoming faxes can waste your valuable time, ink, and paper while keeping your fax phone line tied up. The Junk Fax Blocker feature works with Caller ID service to block incoming junk faxes from the senders you enter into device memory.<sup>9</sup> When you activate this feature and enter in unwanted fax numbers, Junk Fax Blocker can effectively eliminate future faxes and phone calls from unwanted sources.
- Simplify the management and disposal of products, and recover some of their value at end of use. Through HP Planet Partners—a free, convenient return and recycling program available in more than 49 countries—you can be assured cartridges won't end up in a landfill.<sup>10</sup> All returned Original HP print cartridges go through a multiphase recycling process where they are reduced to raw materials that are used to make new metal and plastic products.

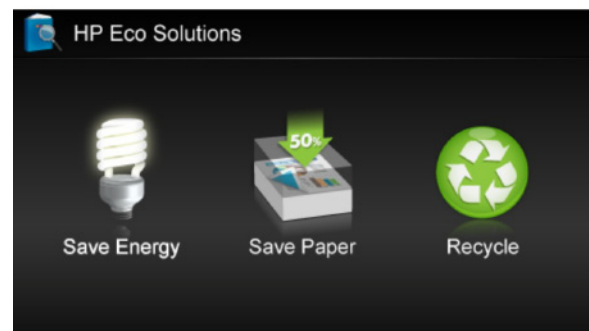

## Minimize the impact of printing

- Print more responsibly. The EU RoHS (Restriction of Hazardous Substances) Directive restricts the use of certain substances (lead, mercury, cadmium, hexavalent chromium and two flame-retardants: PBB and PBDE) in electronic products. HP has achieved compliance with the EU RoHS regulations for hundreds of thousands of hardware parts, substituting new materials in many of them, while developing numerous HP and industry standards to ensure these products meet our customers' expectations for performance, quality, and reliability.
- Consolidate supplies orders to reduce or eliminate the environmental impact of packing and transporting multiple single orders using HP SureSupply. You can also order multiple replacement ink cartridges at once for a cost savings to you.<sup>11</sup>

## GET WIDE-FORMAT VERSATILITY in an All-in-One

The HP Officejet 7500A Wide-Format e-All-in-One adjusts to accommodate media up to 330 by 483 mm (13 by 19 in)—with only a slightly bigger footprint than A4/letter printers. Its paper-handling features make it easy to print the business documents you need, with support for paper (plain, inkjet, photo), envelopes, and cards (index, greeting).

Your office has a new command center for printing, faxing, and scanning. The e-All-in-One's intuitive touchscreen, front-facing USB port, and memory card slots enable you to complete day-to-day tasks without your PC.

### Large-format, borderless printing

Enjoy the flexibility of printing your photos, brochures, and other marketing material with or without borders for a truly professional look. Borderless printing lets you print to the edge on all four sides of photo and brochure papers—no special photo papers with tear-off tabs or strips are required.



## Bypass the PC

Produce business documents and photos—right from the e-All-in-One. Simply insert a memory card into one of the integrated slots and use the touchscreen to start printing. The e-All-in-One's intuitive 2.36-inch touchscreen eliminates the need for buttons. Simply touch the screen to copy, fax, or scan documents. Select **Apps** on the touchscreen to quickly and easily access the forms and documents you use most frequently—without returning to your PC. ((For more information on apps, see "Touch, access, store, and print your business information in seconds" on page 5.)

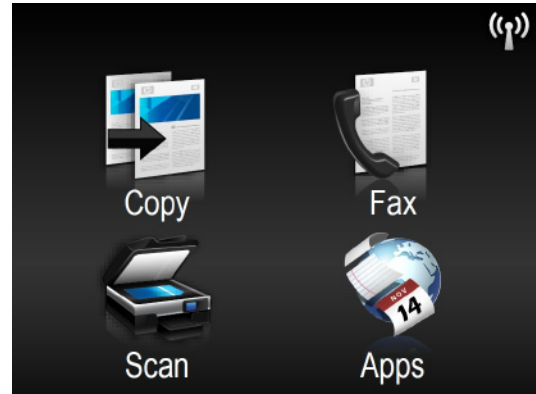

## Get a complete office solution at a great price

As a small office business owner, you want to concentrate on your business, not your equipment. The HP Officejet 7500A Wide-Format e-All-in-One is designed to be easy to use and offers fast, high-quality printing and copying, high-resolution scanning, and reliable faxing to help increase productivity. The following digital solutions contribute to the product's efficiency.

### Create flawless copies

Take the guesswork out of copying using CopySmart. The HP Officejet 7500A Wide-Format e-All-in-One makes it easy to create flawless copies without skewing.

### Easily make copies—even of two-sided ID cards

Use the scan and copy features to print fast, easy copies. Capture both sides of a double-sided identification card and print them on one side of a single page for reporting and filing.

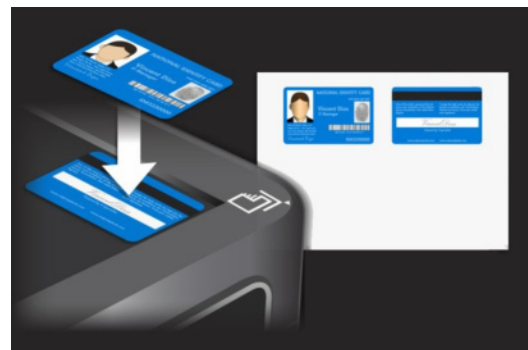

## Produce dazzling, high-quality prints fast

Print your office documents fast with speeds equivalent to a laser printer of up to 10 ppm black and 7 ppm color.<sup>12</sup> And when speed is critical, the device prints documents at a maximum print speed of up to 33 ppm black and 32 ppm color.

In an effort to standardize print speeds industry-wide, HP and other manufacturers have worked with ISO to develop a standard method to measure print speed. Because no international standards for measuring speeds have existed, comparing print speeds between products or manufacturers has been challenging for customers.

ISO standard print speed is measured using the same three files—which represent three typical office documents—on each device. Each document is four pages long since the typical office print job is three to five pages long.<sup>13</sup> The ISO print speed specification helps customers make performance comparisons.

## Produce brilliant prints with HP technology

HP's dual-drop-volume technology ensures that you get finely detailed images and graphics, up to 4800 by 1200-optimized dpi, without the lighter, photo dye-load inks used in six-ink printing. An improved halftoning process enables smooth gradations and outstanding color accuracy.

In dual-drop-volume printing, the ink cartridges contain specially formulated full-dye load color inks that are fired onto the page in different ink droplet volumes. In dual-drop-volume modes, the printer can fire any combination of small or large ink droplets at a given print position—small and large droplets together, just small droplets, or just large droplets. The printer determines the combination of ink droplets to provide optimal print quality and speed.

## Unattended, uninterrupted printing, copying, and scanning

Load documents into the 35-sheet automatic document feeder (ADF) and walk away. Copy, scan, or fax up to legal-sized originals from the ADF.

## Create perfect digital copies of large-sized items in seconds

When you need to scan legal documents, scrapbook pages, magazines, or other items larger than A4 or letter-sized paper, ArcSoft Scan-n-Stitch Deluxe enables you to scan and stitch easily from the e-All-in-One. With the click of a button, the application automatically rotates, aligns, and stitches multiple sections of a page into a single, seamless image file—giving you an exact digital copy of your paper original. You can also copy and scan large sized documents using the touchscreen.

## Never miss a fax

Thanks to innovative HP technologies, you can receive and save up to 100 pages of incoming faxes into your e-All-in-One's memory even when the power is off or the paper tray is empty.

# GAIN EFFICIENCY with wireless productivity

Stay connected and make your work space more efficient by sharing resources—more users can access the same device with wireless networking and built-in Ethernet.

With its flexible connectivity via the USB 2.0 Hi-Speed port and wireless 802.11n networking, the HP Officejet 7500A Wide-Format e-All-in-One is designed with businesses in mind.

The product offers affordable networking to meet the needs of your small business:

- **Enables convenient sharing**—Designed to handle up to five network users.
- **Provides simple installation**—The e-All-in-One's software includes step-by-step instructions. No specialized networking skills are required.
- **Supports mixed operating system environments**—Personal computers and Macintosh computers can be on the same network.
- **Saves space in the office**—There's no need for each user to give up desk space for an e-All-in-One.



## Wireless (Wi-Fi) networking

The HP Officejet 7500A Wide-Format e-All-in-One includes built-in wireless networking, so you can connect the e-All-in-One directly to a Wi-Fi network without using an external print server. Wireless networking allows work teams with a wireless router and a notebook or desktop computer with a wireless card or adapter to print via a wireless connection—there's no need for a cable between the computer and the e-All-in-One. And data travels quickly, at speeds up to 300 Mbps across distances of up to 100 feet (30.5 meters). The benefits that are unique to built-in wireless networking include:

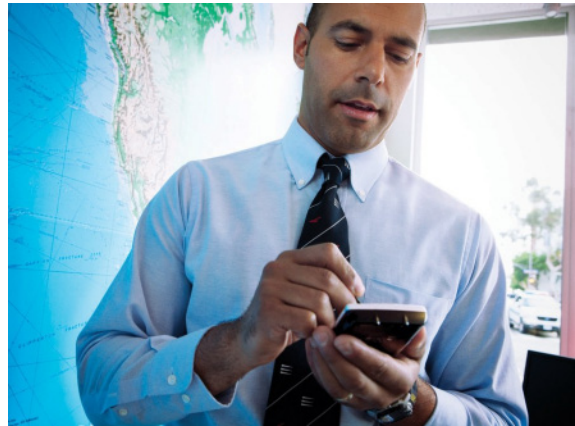

- **Increases mobility**—Place the e-All-in-One anywhere in your wireless network environment.
- **Reduces cable clutter**—Keep your office environment tidy and organized with fewer cables.
- **Simplifies relocation**—Fewer cables make it easier to move equipment from one location to another; there's no need to purchase expensive networking cables or invest time installing networking wires.

## Wired (Fast Ethernet) networking

Designed to be easy to share, the e-All-in-One offers embedded wired networking capabilities that allow you to connect the e-All-in-One directly to a 10/100Base-T Fast Ethernet network. With the e-All-in-One turned on, simply connect an Ethernet cable from the device's RJ-45 port to the network hub, switch, or router, and then run the installation software on each of the computers on the network. On-screen instructions provide easy step-by-step installation.

## No IT? No problem

HP offers tools for the small business owner who doesn't have a dedicated IT department:

- **Order supplies**—A single screen shows your e-All-in-One's ink status and provides direct access to online shopping from preferred resellers or HP SureSupply.<sup>11</sup>
- **Troubleshoot before there is trouble**—Get alerts on current and future device problems through HP Proactive Support.



# Legendary HP RELIABILITY

---

This device sets the standard for industry reliability, providing a worry-free office solution. If you ever do need service and support, HP's Customer Care is one of the best. By being certain of a maximum uptime, you'll boost productivity and end frustration.

- Prior to its introduction, a new HP Officejet product undergoes rigorous HP testing to ensure that it provides consistent high-quality performance. Tests are performed with a large sample of devices through each step of the design process, to be certain that the product measures up to HP standards. The result is a solid, reliable product that produces consistent, excellent output quality over the life of the device and its supplies.
- The e-All-in-One comes standard with a one-year limited hardware warranty backed by HP Customer Care with technical phone support.



# A—TECHNICAL SPECIFICATIONS

<b>Print/Copy speed<sup>12</sup></b>	Draft	Laser Comparable	Best
Black text	33 ppm	10 ppm	1.5 ppm
Mixed color	32 ppm	7 ppm	1.5 ppm
<b>First page out<sup>14</sup></b>	As fast as 16 seconds (black), 19 seconds (color)		
<b>Processor</b>	192 MHz		
<b>Memory</b>	128 MB		
<b>Resolution</b>	Black: Up to 1200 optimized dpi from 600 input dpi Color: Up to 4800 by 1200 optimized dpi color (when printing from a computer on selected HP photo papers and 1200 input dpi)		
<b>Recommended monthly page volume<sup>15</sup></b>	200 to 450 pages		
<b>Duty cycle</b>	Up to 7,000 pages		
<b>Fax features</b>	Color fax; auto reduction; auto redial; speed dial; group speed dial; poll to receive; forwarding (black only); distinctive ring; delayed send (black only); scan and fax; fax phone TAM interface; PC fax send and receive; 100 phone numbers memory, 100 pages fax memory, junk fax blocker, <sup>9</sup> up to 300 by 300 dpi		
<b>Digital sending features</b>	Scan to PC; Scan to Card		
<b>Display</b>	2.36 in. (6.1 cm) color graphics display		
<b>Paper</b>			
Input	150-sheet input tray, 35-sheet automatic document feeder		
Output	100-sheet output bin		
Two-sided printing	Manual		
Sizes	A5, B5, executive, A4, letter, legal, tabloid, Hagaki, B7, 4 by 6 in, 10 by 15 cm, HV, A6, 2L, cabinet, 13 by 18 cm, 5 by 7 in, Ofuku Hagaki, 8 by 10 in, B4, 11 by 14 in, A3, 12 by 12 in, A3, Super B, A3+		
Custom media sizes <sup>16</sup>	76 by 127 mm to 330 by 482.6 mm (3 by 5 in to 13 by 19 in)		
Weights	Plain paper: 75 to 90 g/m <sup>2</sup> (20 to 24 lb) B-size: up to 286 g/m <sup>2</sup>		
Types	Paper (brochure, inkjet, plain); photo; envelopes; cards (index); transparencies		
<b>Connectivity</b>			
Interfaces	1 USB (2.0); 1 Ethernet; 1 Wireless 802.11g/b; 2 memory card slots; 2 RJ-11 fax		
Memory card support	Secure Digital, MultimediaCard, Secure MultimediaCard, Reduced-Size MultimediaCard (RS-MMC)/MMCmobile (adapter not included, purchase separately), MMCmicro/miniSD/microSD (adapter not included, purchase separately), xD-Picture Card		
Languages	PCL 3 GUI <sup>17</sup>		
<b>Operating systems</b>	Windows® XP® Service Pack 2, Windows Vista®, Windows 7 Mac OS X v10.5, v10.6 Linux (for more information, see <a href="http://hplipopensource.com/hplip-web/index.html">hplipopensource.com/hplip-web/index.html</a> )		

<b>Network operating systems</b>	<p>Microsoft® Windows XP (32-bit) (Professional and Home Editions), Windows Vista 32-bit and 64-bit (Ultimate Edition, Enterprise Edition, and Business Edition), Windows 7 (32-bit and 64-bit)</p> <p>Windows Small Business Server 2003 32-bit and 64-bit, Windows 2003 Server 32-bit and 64-bit, Windows 2003 Server R2 32-bit and 64-bit (Standard Edition, Enterprise Edition), Windows Small Business Server 2008 64-bit, Windows 2008 Server 32-bit and 64-bit, Windows 2008 Server R2 64-bit (Standard Edition, Enterprise Edition)</p> <p>Citrix XenDesktop 4, Citrix XenServer 5.5</p> <p>Microsoft Windows 2003 Server Terminal Services, Microsoft Windows 2003 Server Terminal Services with Citrix Presentation Server 4.0, Microsoft Windows 2003 Server Terminal Services with Citrix Presentation Server 4.5, Microsoft Windows 2003 Server Terminal Services with Citrix XenApp 5.0, Microsoft Windows 2003 Server Terminal Services with Citrix Metaframe XP with Feature Release 3, Microsoft Windows 2003 Small Business Server Terminal Services, Microsoft Windows Server 2008 Terminal Services, Microsoft Windows Small Business Server 2008 Terminal Services, Microsoft Windows 2008 Server Terminal Services with Citrix XenApp 5.0</p> <p>Novell Netware 6.5, Open Enterprise Server 2</p> <p>Mac OS X v10.5, v10.6</p>
<b>Recommended system requirements</b>	<p>Microsoft Windows 7: 1 GHz 32-bit (x86) or 64-bit (x64) processor, 1 GB (32-bit) or 2 GB (64-bit) RAM, 1.5 GB hard disk space, CD-ROM/DVD drive or internet connection, USB port</p> <p>Microsoft Windows Vista: 800 MHz 32-bit (x86) or 64-bit (x64) processor, 512 MB RAM, 2.0 GB hard disk space, CD-ROM/DVD drive or internet connection, USB port</p> <p>Microsoft Windows XP (32-bit) Service Pack 2: Intel® Pentium® II, Celeron® or compatible processor, 233 MHz or higher, 128 MB RAM, 750 MB hard disk space, CD-ROM/DVD drive or internet connection, USB port</p> <p>Mac OS X v10.5.8, v10.6: PowerPC G4, G5, or Intel Core processor, 300 MB free hard disk space</p>
<b>Dimensions (W by D by H)</b>	606 by 426 by 293 mm (23.86 by 16.77 by 11.54 in)
<b>Weight</b>	14 kg (30.8 lb)
<b>What's in the box</b>	e-All-in-One, Power cord, Power supply, USB cable (AP only), LAN cable (AP only), User Guide, Setup Poster, Ink printhead, Ink cartridges, Printer driver CD, Scan-n-Stitch CD, Phone cord
<b>Warranty</b>	One-year limited hardware warranty, 24-hour, 7 days-a-week web support, business hour phone support within warranty period

## Environmental and power specifications

### Environmental ranges

Recommended operating temperature	15 to 32° C (59 to 90° F)
Maximum operating temperature	40° C (104° F)
Storage temperature	-40 to 60° C (-40 to 140° F)
Recommended operating humidity	15 to 80 percent, non-condensing
Non-operating humidity	15 to 90 percent, non-condensing
Operating altitude	Up to 2400 m (8000 ft)

**Power specifications**<sup>18</sup> Input requirements: 100 to 240 VAC, 50/60 Hz

### Power consumption

<sup>19</sup>

Maximum	50 watts
Active	15 watts, Best mode 20 watts, Normal mode 26 watts, Fast Draft mode
Off	0.75 watts
Sleep	4.1 watts
Ready	6 watts
Scanning	13 watts

ENERGY STAR® qualified models, see [www.hp.com/energystar](http://www.hp.com/energystar)

### Power certifications

EMC	CISPR 22: 2005/EN 55022: 2006 Class B, EN 55024: 1998+A1: 2001+A2: 2003, EN 61000-3-2: 2006, EN 61000-3-3: 1995+A1: 2001; FCC CFR 47, Part 15 Class B/ICES-003, Issue 4 Class B
Safety	IEC 60950-1: 2001/EN 60950-1: 2001+A11: 2004; EN 60825-1 1994+A1: 2002+A2: 2001; UL 60950-1: 2003 CAN/CSA-22.2 No. 60950-1-03; AS/NZS 60950: 2000, GB4943: 2001; NOM-019-SCFI-1998

# B—ACCESSORIES AND SUPPLIES

Use accessories and supplies specifically designed for the e-All-in-One to ensure optimal performance. To order the e-All-in-One accessories and supplies listed here, go to the HP web site at [www.hp.com/ghp/buyonline.html](http://www.hp.com/ghp/buyonline.html). If you don't have access to the internet, contact your qualified HP dealer, or call HP at (800) 282-6672 (U.S.).

<b>Product</b>	HP Officejet 7500A Wide-Format e-All-in-One	C9309A
<b>Connectivity</b>	Hi-Speed USB cable	Q6264A
<b>Ink cartridges<sup>7</sup></b>	HP 920XL Cyan Officejet Ink Cartridge (~300 pages)	CD972A
	HP 920XL Magenta Officejet Ink Cartridge (~300 pages)	CD973A
	HP 920XL Yellow Officejet Inkjet Cartridge (~300 pages)	CD974A
	HP 920XL Black Officejet Ink Cartridge (~420 pages)	CD975A
	HP 920 Cyan Officejet Ink Cartridge (~700 pages)	CH634A
	HP 920 Magenta Officejet Ink Cartridge (~700 pages)	CH635A
	HP 920 Yellow Officejet Ink Cartridge (~700 pages)	CH636A
	HP 920 Black Officejet Ink Cartridge (~1,200 pages)	CD971A

## Contact information

### Hewlett-Packard Company

300 Hanover Street

Palo Alto, CA 94304-1185

Phone: (650) 857-1501

Fax: (650) 857-5518

Web address: [www.hp.com](http://www.hp.com)

Contact HP by country:

[www.welcome.hp.com/country/us/eng/contact\\_us.html](http://www.welcome.hp.com/country/us/eng/contact_us.html)

HP Shopping (for U.S. only)

[www.hpshopping.com](http://www.hpshopping.com) or 1-888-999-4747

## End notes

- <sup>1</sup> Letter cost per page comparisons for B-size inkjet all-in-ones with fax <\$300 from major vendors as of March 2010. For details, see [www.hp.com/go/officejet](http://www.hp.com/go/officejet). Officejet ISO yield with highest-capacity cartridges based on continuous printing. For details, see [www.hp.com/go/learnaboutsupplies](http://www.hp.com/go/learnaboutsupplies).
- <sup>2</sup> Wireless performance depends upon physical environment and distance from access point.
- <sup>3</sup> Requires an internet connection to the e-All-in-One. Apps availability varies by country. Services may require registration. For details, see [www.hp.com/go/ePrintCenter](http://www.hp.com/go/ePrintCenter).
- <sup>4</sup> May require an internet connection to the e-All-in-One. Feature works with any internet- and email-capable device. For details, see [www.hp.com/go/ePrintCenter](http://www.hp.com/go/ePrintCenter).
- <sup>5</sup> Not included. Please purchase separately.
- <sup>6</sup> Based on HP internal testing using a range of plain papers, including papers with the ColorLok® logo. For details, go to [www.hp.com/go/printpermanence](http://www.hp.com/go/printpermanence).
- <sup>7</sup> Approximate yield. Actual yield depends on printer and specific use. See [www.hp.com/go/pageyield](http://www.hp.com/go/pageyield) for more information. Average based on ISO/IEC 24711 or HP testing methodology and continuous printing. Actual yield varies considerably based on content of printed pages and other factors. Some ink from included cartridge is used to start up the printer. For details, see [www.hp.com/go/learnaboutsupplies](http://www.hp.com/go/learnaboutsupplies).
- <sup>8</sup> Compared to the majority of letter-size color laser all-in-ones <\$600, March 2010; for details, see [www.hp.com/go/officejet](http://www.hp.com/go/officejet). Energy use based on HP testing using the ENERGY STAR® program's TEC test method criteria.
- <sup>9</sup> Requires caller ID service, not included. Price and service are subject to contract.
- <sup>10</sup> HP ink cartridge return and recycling is available in 49 countries and territories around the world, covering 88 percent of the addressable market; see [www.hp.com/recycle](http://www.hp.com/recycle) for details.
- <sup>11</sup> HP SureSupply is a free tool that helps you keep up with your print supplies. When your e-All-in-One sends you a low-ink alert, SureSupply lets you immediately order the correct supplies online—often with free shipping—either from a participating retailer or from HP. For more information, visit [www.hp.com/go/SureSupply](http://www.hp.com/go/SureSupply); only available with Original HP supplies; internet access required.
- <sup>12</sup> Based on ppm measured using ISO/IEC 24734. Standard applies to inkjet and laser products and excludes first set of test documents. For details, see [www.hp.com/go/inkjetprinter](http://www.hp.com/go/inkjetprinter).
- <sup>13</sup> For details, see [www.infotrends.com/public/Content/Presentations/officeprinteruse.pdf](http://www.infotrends.com/public/Content/Presentations/officeprinteruse.pdf).
- <sup>14</sup> Either after first page or after first set of ISO test pages. For details, see [www.hp.com/go/printerclaims](http://www.hp.com/go/printerclaims).
- <sup>15</sup> HP recommends that the number of printed pages per month be within the stated range for optimum device performance, based on factors including supplies replacement intervals and device life over an extended warranty period.
- <sup>16</sup> Windows does not support custom paper sizes.
- <sup>17</sup> Latest printer driver is available on the HP support website at [www.hp.com/support](http://www.hp.com/support).
- <sup>18</sup> Power requirements are based on the country or region where the product is sold. Do not convert operating voltages or use with other voltages. Doing so might cause damage that would not be covered under the HP product warranty.
- <sup>19</sup> Power measurements are based on ENERGY STAR® OM test procedure.



ENERGY STAR and the ENERGY STAR logo are registered U.S. marks. Intel, Pentium, and Celeron are trademarks or registered trademarks of Intel Corporation or its subsidiaries in the United States and other countries. Microsoft, Windows, and Windows XP are registered trademarks of Microsoft Corporation. Windows Vista is either a registered trademark or trademark of Microsoft Corporation in the United States and/or other countries.

© Copyright 2010 Hewlett-Packard Development Company, L.P.

The information contained herein is subject to change without notice. The only warranties for HP products and services are set forth in the express warranty statements accompanying such products and services. Nothing herein should be construed as constituting an additional warranty. HP shall not be liable for technical or editorial errors or omissions contained herein.

To learn more, visit [www.hp.com](http://www.hp.com)

