

# TRANSFORMERS UNIVERSE

**AGES 5+**  
B3840/B3793 ASST.

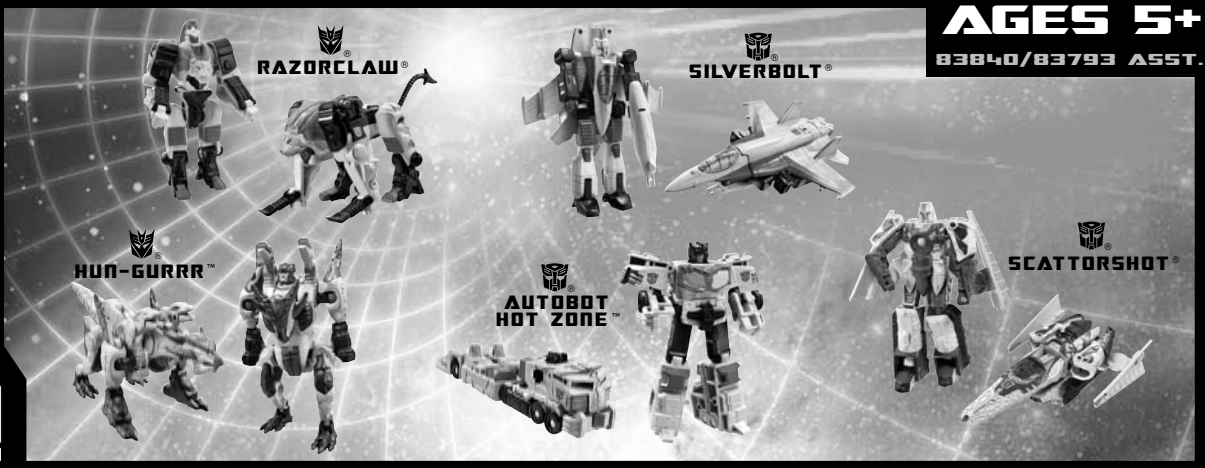

NOTE: Some parts are made to detach if excessive force is applied and are designed to be reattached if separation occurs. Adult supervision may be necessary for younger children.

## CHANGING TO VEHICLE

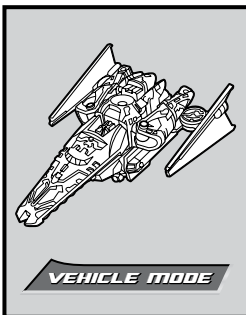
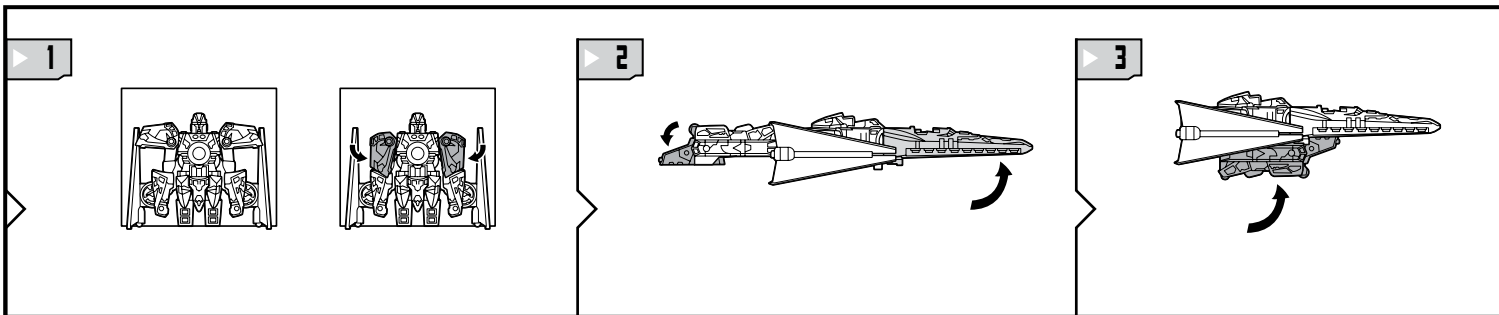
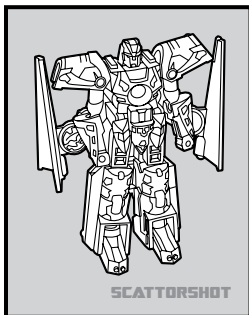
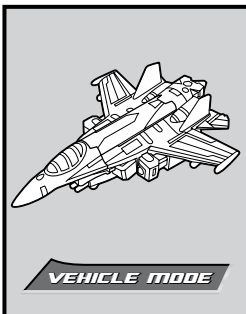
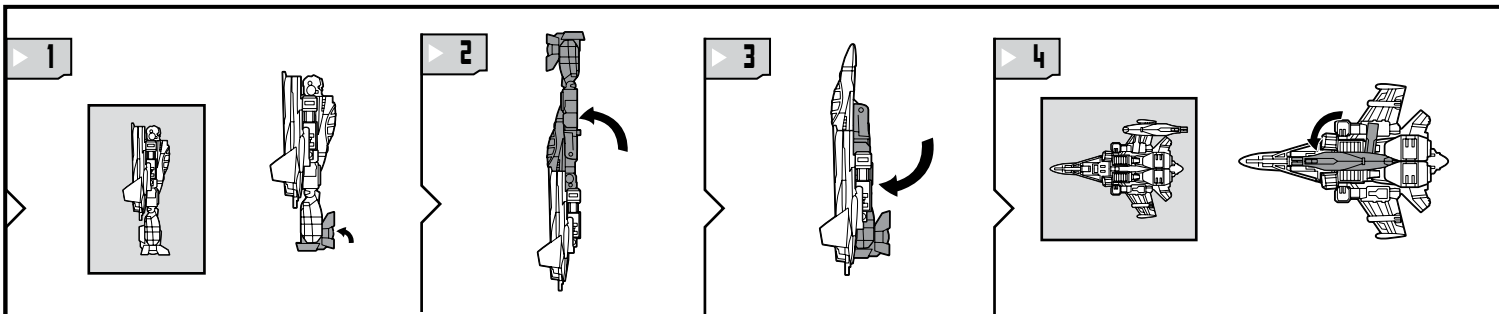
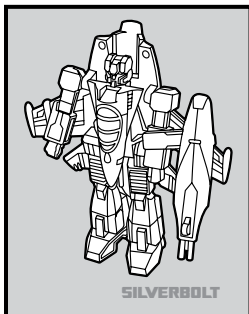
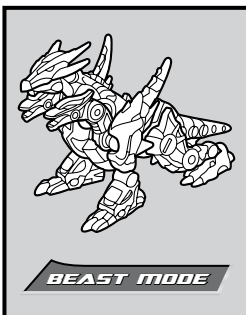
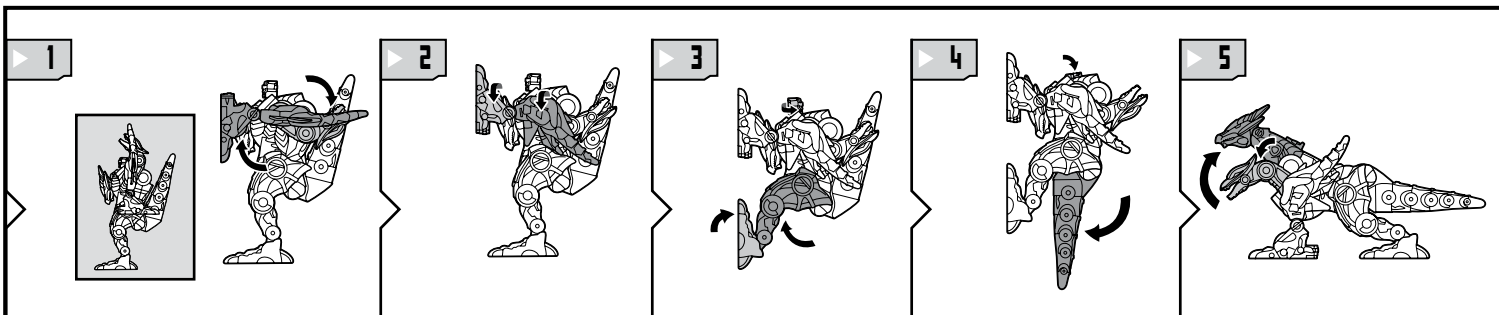
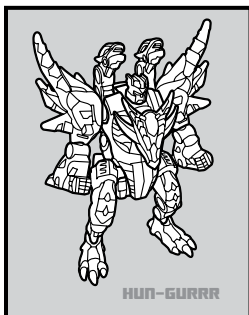
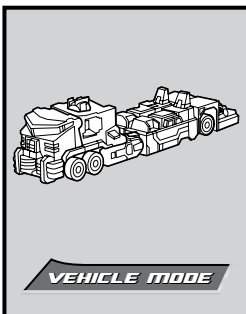
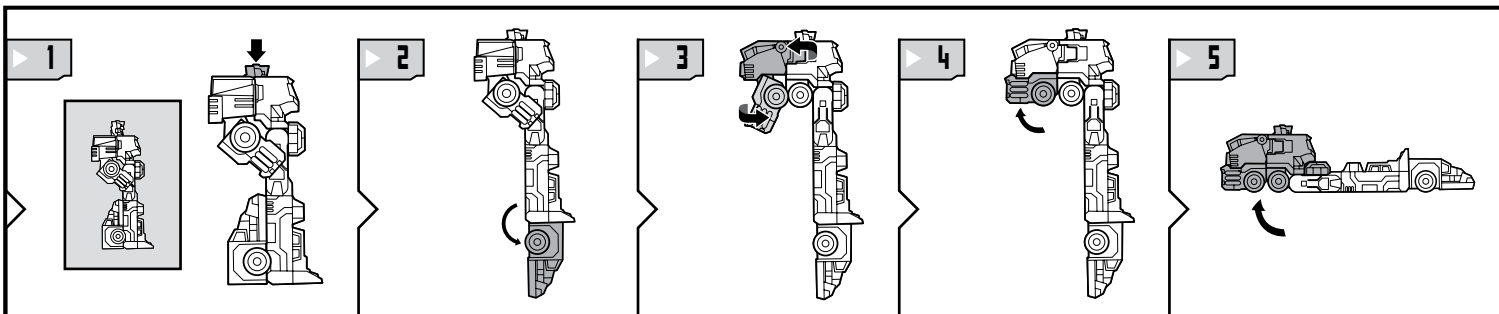
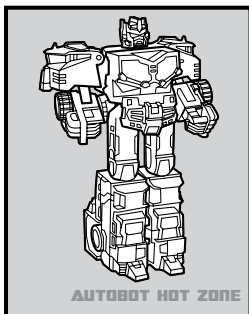
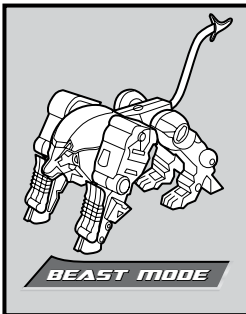
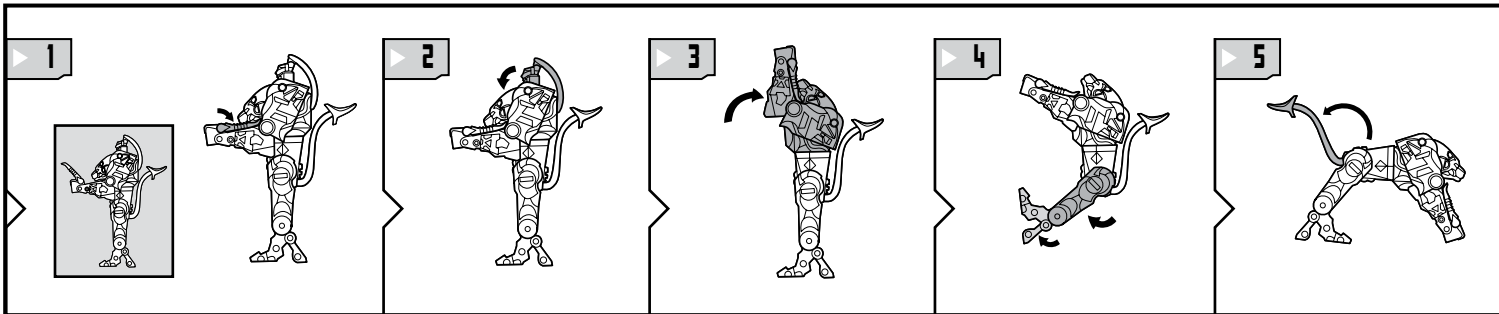
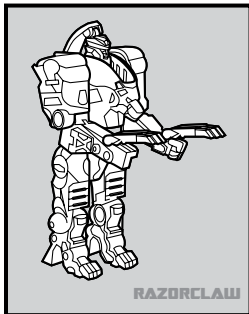

Reverse order of instructions to convert back into robots.



© 2008 Hasbro. All rights reserved.  
TM & © denote U.S. trademarks.  
Manufactured under license from Tomy Company, Ltd.

Some poses may require hand support.

P/N 6805280000

TRANSFORMERS.COM



Not suitable for children under 3 years because of small parts - choking hazard.