

# Continental



Utilizing Environmentally Safe, CFC-free R-404A Refrigerant



CPT42



CPT67



CPT92



CPT117

## Refrigerator

### PIZZA PREPARATION TABLE REFRIGERATORS

#### Standard Features

- Modern, State-of-the-Art Styling
- Performance Rated Refrigeration System Utilizing Environmentally Safe R-404A Refrigerant
- Exclusive Recessed Pan Rail with Specialized Wrapped Coldwall Allows Pan Product to Maintain 33-41°F Being in Compliance with and Certified Under the New '98 NSF Standard for Preparation Units
- Convenient Top Rail Shut-Off Switch with Separate Temperature Controls for Rail and Base
- Cabinet Construction Consisting of Heavy Gauge #300 Series, Stainless Steel Top, Stainless Steel Front and Case End Panels, Aluminum Case Back Cover and Interior
- Extra Wide 19" High Density, Full Length Polyethylene Cutting Board
- Automatic, Energy Saving, Non-Electric Condensate Disposal System
- Spring Loaded, Self Closing Doors with Magnetic, Snap-In Door Gaskets
- 5" High Swivel Casters
- Heavy-Duty, Long Lasting, Epoxy-Coated Steel Wire Shelves
- Non-Corrosive, Extra Large, Plasticized Fin Evaporator Coil
- High Density, Non-CFC Polyurethane Foamed-in-Place Insulation
- Completely Enclosed, Vented and Removable Case Back
- Easily Accessible and Serviceable Front Slide-Out Condensing Unit
- Interior Hanging Thermometer
- Extra Long 10' Power Supply Cord and Plug Attached

#### Optional Features & Accessories

- |  |  |
|--|--|
| • Stainless Steel Interior -SS Models        | • Stainless Steel Overshelf Assembly   |
| • Stainless Steel, 6" Deep Insert Pans       | • Stainless Steel or Black Legs  |
| • Interior Adjustable, Removable Angle Sides | • Remote Models-R  |
| • Wire Rod, Bun Tray Racks                   | • Electric Condensate  |
| • Wire Rod, Garnish Racks                    | • Exterior Dial Thermometer  |
| • Additional Epoxy Coated Steel Wire Shelves | • Two Heavy Duty, Self Closing External Roll-Out Drawers per Section in Lieu of Door |
|  | • Stainless Steel Rear Cover   |



c





## SPECIFICATIONS

	CPT42	CPT67	CPT92	CPT117
<b>DIMENSIONAL DATA</b>				
Cu. Ft.	8.0	17.0	26.0	35.0
Pan Capacity	(4) ONE-THIRD / (1) ONE-HALF	(9) ONE-THIRD	(12) ONE-THIRD	(16) ONE-THIRD
Ext. Dim. (WxDxH)	42 <sup>1</sup> / <sub>4</sub> x36x44 <sup>13</sup> / <sub>16</sub>	67 <sup>1</sup> / <sub>4</sub> x36x44 <sup>13</sup> / <sub>16</sub>	92 <sup>1</sup> / <sub>4</sub> x36x44 <sup>13</sup> / <sub>16</sub>	117 <sup>1</sup> / <sub>4</sub> x36x44 <sup>13</sup> / <sub>16</sub>
Shelf Area	3.8	8.0	12.4	16.8
Shelves	1	2	3	4
Doors	1	2	3	4
Condensing Unit Size (H.P.)	1/4	1/3	1/3	1/2
Refrigerant	R-404A	R-404A	R-404A	R-404A
Cabinet Electrical	115/60/1	115/60/1	115/60/1	115/60/1
Amps	5.2	7.6	7.8	10.9
Fans	1	2	2	3
Interior Depth (in.)	28 <sup>1</sup> / <sub>2</sub>	28 <sup>1</sup> / <sub>2</sub>	28 <sup>1</sup> / <sub>2</sub>	28 <sup>1</sup> / <sub>2</sub>
Interior Height (in.)	26	26	26	26
Interior Width (in.)	22	47	72	97
Clear Door Width (in.)	21 <sup>3</sup> / <sub>8</sub>	21 <sup>3</sup> / <sub>8</sub>	21 <sup>3</sup> / <sub>8</sub>	21 <sup>3</sup> / <sub>8</sub>
Clear Door Height (in.)	23 <sup>3</sup> / <sub>8</sub>	23 <sup>3</sup> / <sub>8</sub>	23 <sup>3</sup> / <sub>8</sub>	23 <sup>3</sup> / <sub>8</sub>
Shipping Weight (lbs.)	355	495	605	725
Shipping Height (in.)	43 <sup>3</sup> / <sub>4</sub>	43 <sup>3</sup> / <sub>4</sub>	43 <sup>3</sup> / <sub>4</sub>	43 <sup>3</sup> / <sub>4</sub>
Shipping Length (in.)	44 <sup>1</sup> / <sub>4</sub>	69 <sup>1</sup> / <sub>4</sub>	94 <sup>1</sup> / <sub>4</sub>	119 <sup>1</sup> / <sub>4</sub>
Shipping Depth (in.)	36	36	36	36

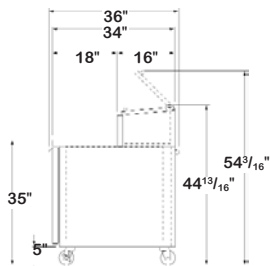

SIDE VIEW

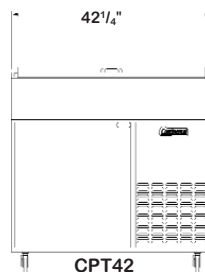

CPT42  
FRONT VIEW

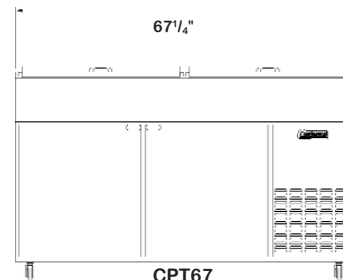

CPT67  
FRONT VIEW

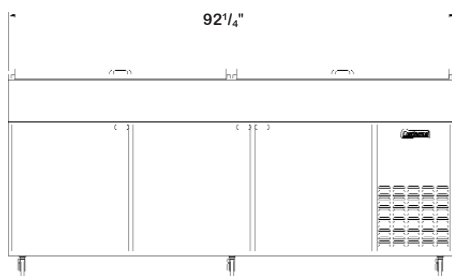

CPT92  
FRONT VIEW

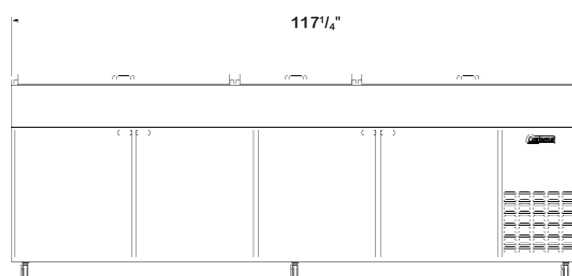

CPT117  
FRONT VIEW

# Continental

Refrigerator

A Division of National Refrigeration & A/C Products, Inc.  
539 Dunksferry Road Bensalem, PA 19020  
(800) 523-7138 Fax: (215) 244-9579  
www.continentalrefrigerator.com

VLCPT205