

KitchenAid® COOKTOP PARTS

For Models: KECC507KBL1, KECC507KSS1, KECC507KBT1, KECC507KWW1
(Black) (S.Steel) (Biscuit) (Designer White)

36" ELECTRIC
BUILT-IN
COOKTOP

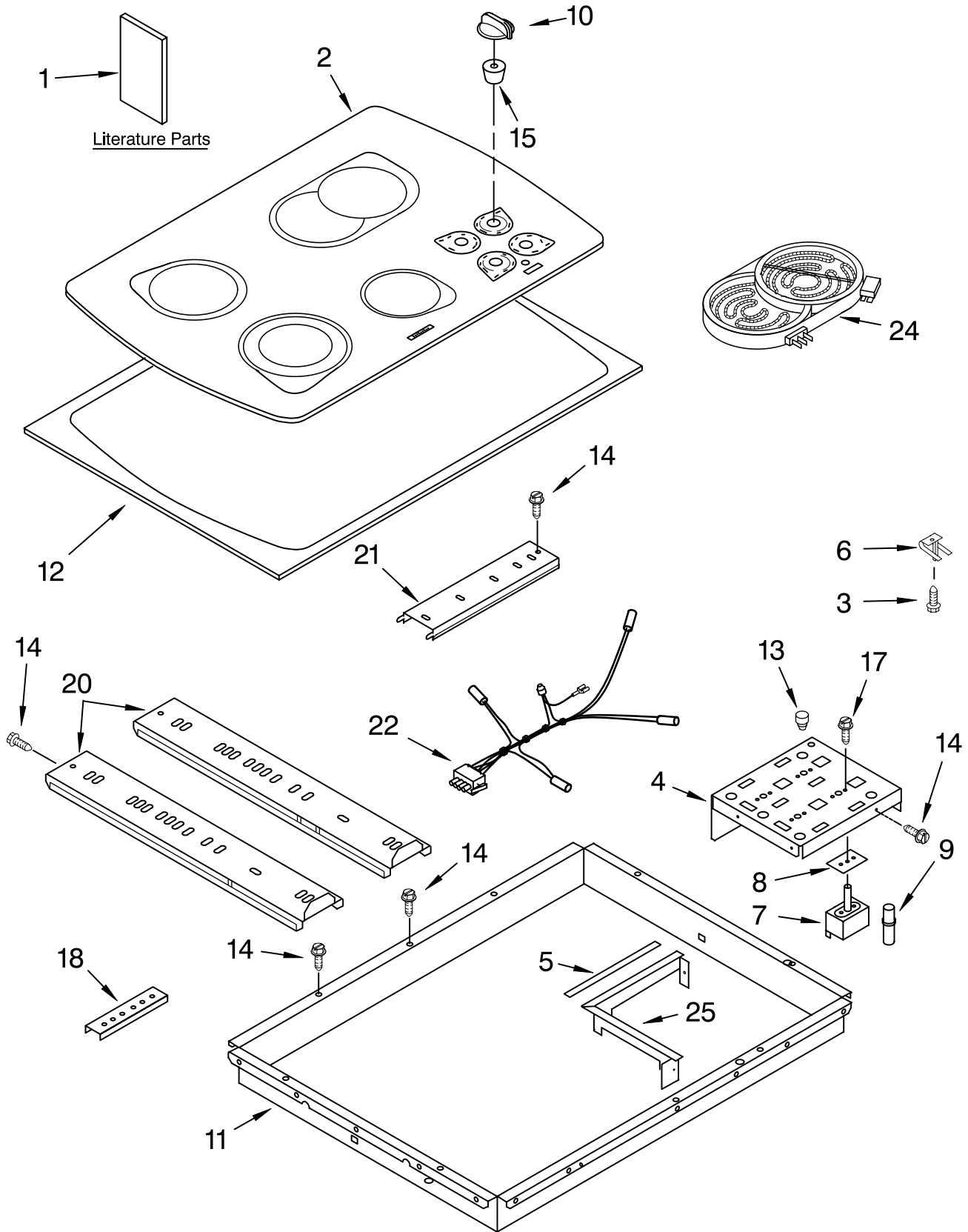

FOR ORDERING INFORMATION REFER TO PARTS PRICE LIST

COOKTOP PARTS

For Models: KECC507KBL1, KECC507KSS1, KECC507KBT1, KECC507KWW1
 (Black) (S.Steel) (Biscuit) (Designer White)

Illus. No.	Part No.	DESCRIPTION
1		Literature Parts
	LIT4455836	Installation Instructions
	LIT4456009	Wiring Diagram
	LIT8284718	Use & Care Guide
	LIT3191638	Safe Cooking Tips
	LIT8284600	Energide Label
		COOKTOP PARTS
2		Cooktop, Glass
	8284887	Black
	8284888	White
	8284890	Biscuit
	8284889	Designer White
	8284891	S.Steel
3	246119	Screw
4	4455421	Bracket, Switch Mounting
5	3191839	Seal, Heat Shield
6	3191791	Spring Locator(10)
	246119	Screw (8)
7		Switch, Infinite
	3191049	LR – RF
	4456027	LF – RR
8	3183956	Seal, Switch Shaft
9	3191945	Light, Indicator
10		Knob, Control (4)
	9750372FF	Black
	9750372FW	White
	9750372FC	Biscuit
11	4456401	Box, Burner
12	8284627	Frame, Cooktop (S.Steel model only)
13	3192477	Bumper, Silicone
14	3196537	Screw
15	3182435	Seal, Switch (5)
17	311865	Screw
18	4455917	Bracket, Mounting
	3400093	Screw
	4167077	Nut
20	3191515	Rail, Element (2)
21	3192268	Rail, Element (1)
22	3191343	Lamp, Hot Surface Indicator
24		Element, Surface
	8523693	1000/2400W – LF
	4452742	1200W – RF
	4452741	1000/1800W – RR
	8523697	1500W – LR
	3192737	Seal, Heat
	3192439	Seal, Limiter
25	4455468	Shield, Heat

FOR ORDERING INFORMATION REFER TO PARTS PRICE LIST

MISCELLANEOUS PARTS

For Models: KECC507KBL1, KECC507KSS1, KECC507KBT1, KECC507KWW1
(Black) (S.Steel) (Biscuit) (Designer White)

<u>Illus.</u>	<u>Part</u>	
<u>No.</u>	<u>No.</u>	<u>DESCRIPTION</u>

**FOLLOWING PARTS
NOT ILLUSTRATED**

Miscellaneous

3172515 Mtg. Hardware Kit
3192408 Bracket,
Support (2)

SPLICING WIRES--25FT.

LENGTH

242828 Wire, Black
4456028 Jumper, Wire
12 Ga. 150° C
242820 Wire, Black
14 Ga. 150° C
242822 Wire, Blue
14 Ga. 150° C
242830 Wire, Brown
14 Ga. 200° C
242823 Wire, Green
14 Ga. 150° C
242824 Wire, Orange
14 Ga. 150° C
242829 Wire, Red
12 Ga. 150° C
242825 Wire, Red
14 Ga. 150° C
242831 Wire, Red
14 Ga. 200° C
242826 Wire, White
14 Ga. 150° C
242827 Wire, Yellow
14 Ga. 150° C
242832 Wire, Yellow
14 Ga. 200° C

ACCESSORY PARTS

3191048 Cleaner, Glass

WIRING HARNESS PARTS

4456016 Harness, Main
3400015 Screw, Ground
4456064 Conduit Assy.

FOR ORDERING INFORMATION REFER TO PARTS PRICE LIST