

KitchenAid® COOKTOP PARTS

For Models: KECC507RBL00, KECC507RWW00, KECC507RBB00, KECC507RSS00
(Black) (Pure White) (Pure Biscuit) (S.steel)

30" ELECTRIC
CERAN
COOKTOP

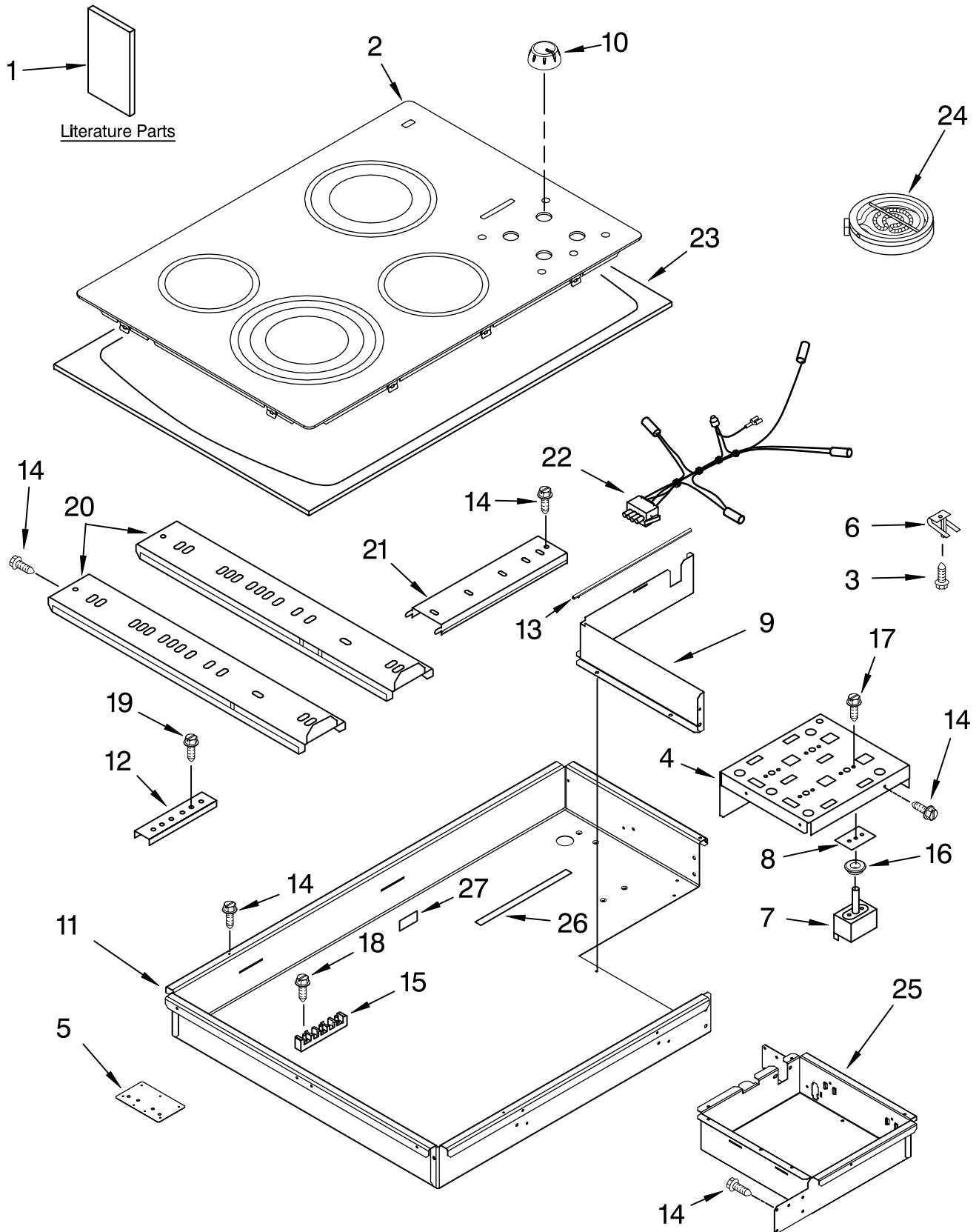

FOR ORDERING INFORMATION REFER TO PARTS PRICE LIST

COOKTOP PARTS

For Models: KECC507RBL00, KECC507RWW00, KECC507RBB00, KECC507RSS00
 (Black) (Pure White) (Pure Biscuit) (S.steel)

Illus. No.	Part No.	DESCRIPTION
1		Literature Parts
	8286066	Installation Instructions
	8286429	Wiring Diagram
	8286067	Use & Care Guide
	3191638	Safer Cooking Tips
	9759133	Safer Cooking Tips
	8286061	Energuide Label
2		Cooktop, Glass
	8286210	Black
	8286212	White
	8286211	Biscuit
	8286209	S.Steel
3	246119	Screw
4	8285935	Bracket, Switch Mounting
5	8286535	Bracket, Bottom
6	9759094	Spring Locator (8)
7		Switch, Infinite
	8286464	Single (2)
	8286465	Dual
	8286466	Triple
8	3183956	Seal, Switch Shaft
9	8286577	Wall, Inside (Heat Shield)
10		Knob, Control (4)
	8286096BL	Black
	8286096WH	White
	8286096BT	Biscuit
	8286096CM	Cashmere Metal
11	8286554	Box, Burner
12	4455917	Bracket, Mounting
13	8285240	Seal, Heat
14	3196537	Screw
15	4449868	Block, Terminal
16		Seal, Switch
	8285469	Black
	8286596	Clear
17	311865	Screw
18	3196163	Screw
19	3400093	Screw
20	8286585	Rail, Element (2)
21	8286344	Rail, Element (1)
22	8286055	Lamp, Hot Surface Indicator
23	8285709	Frame, Cooktop (S.Steel Mdl Only)
24		Element, Surface
	8523698	1200W LR
	8523697	1500W RF
	8285937	2000/1000W RR
	8286187	2500/1800/900W LF
25	8286573	Box, Control
26	8285426	Seal, Heat Shield
27	112432	Nut, 10-32 Hex

FOR ORDERING INFORMATION REFER TO PARTS PRICE LIST

OPTIONAL PARTS

For Models: KECC507RBL00, KECC507RWW00, KECC507RBB00, KECC507RSS00
(Black) (Pure White) (Pure Biscuit) (S.steel)

Illus. No.	Part No.	DESCRIPTION
------------	----------	-------------

Miscellaneous

	3172515	Mtg. Hardware Kit
	3192408	Bracket, Support (2)

OPTIONAL PARTS

FOLLOWING PARTS NOT ILLUSTRATED

SPLICING WIRES--25FT.

LENGTH

4456028	Wire, Jumper
242828	Wire, Black 12 Ga. 150° C
242820	Wire, Black 14 Ga. 150° C
242822	Wire, Blue 14 Ga. 150° C
242830	Wire, Brown 14 Ga. 200° C
242823	Wire, Green 14 Ga. 150° C
242824	Wire, Orange 14 Ga. 150° C
242829	Wire, Red 12 Ga. 150° C
242825	Wire, Red 14 Ga. 150° C
242831	Wire, Red 14 Ga. 200° C
242826	Wire, White 14 Ga. 150° C
242827	Wire, Yellow 14 Ga. 150° C
242832	Wire, Yellow 14 Ga. 200° C

ACCESSORY PARTS

3191048	Cleaner, Glass
---------	----------------

WIRING HARNESS PARTS

8286467	Wiring Harness
8286382	Clip (Harness)
3400015	Screw, 10-32 x 3/8
8286338	Conduit, Harness
8286238	Thermostat (100c-94c)

FOR ORDERING INFORMATION REFER TO PARTS PRICE LIST