

KitchenAid® COOKTOP PARTS

For Models: KECC507GBL0, KECC507GWH0, KECC507GAL0, KECC507GBT0
(Black) (White) (Almond) (Biscuit)

30" ELECTRIC
BUILT-IN
COOKTOP

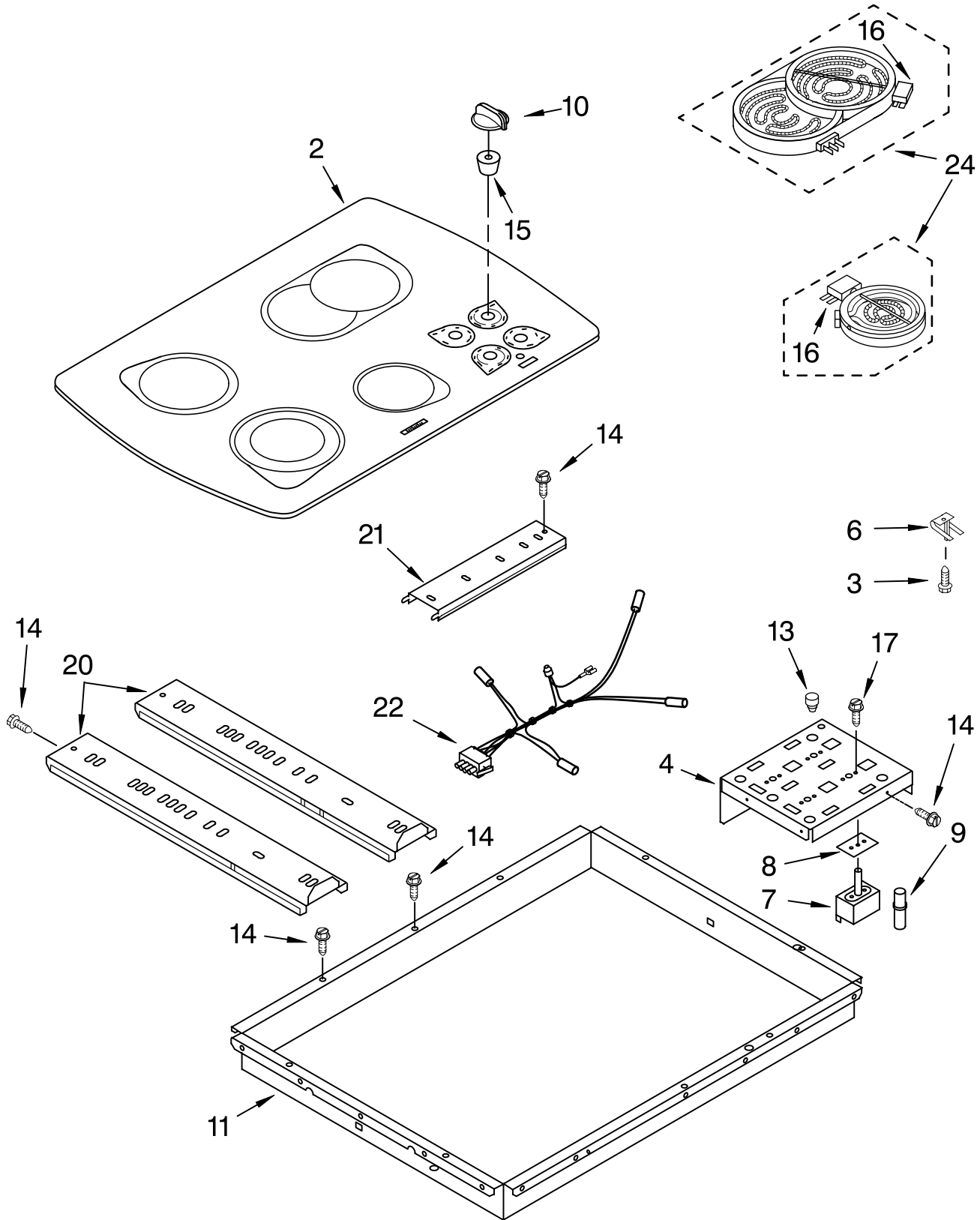

FOR ORDERING INFORMATION REFER TO PARTS PRICE LIST

COOKTOP PARTS

For Models: KECC507GBL0, KECC507GWH0, KECC507GAL0, KECC507GBT0
 (Black) (White) (Almond) (Biscuit)

Illus. No.	Part No.	DESCRIPTION
2		Cooktop, Glass
	3191911	Black
	3191872	White
	3191873	Almond / Biscuit
3	246119	Screw
4	3192163	Bracket, Switch Mounting
6	3191791	Spring Locator (8)
7		Switch, Infinite
	3191049	Use W/1500W Left Rear Burner
	3188516	Use W/1800W Right Rear Burner
	3191049	Use W/1200W Right Front Burner
	3188516	Use W/2400 W Left Front Burner
8	3183956	Seal, Switch Shaft
9	3191945	Light, Indicator
10		Knob, Control (4)
	9750372FF	Black
	9750372FW	White
	9750372FT	Almond
	9750372FC	Biscuit
11	3191162	Box, Burner
13	9750835	Bumper, Silicone
14	3196537	Screw
15	3182435	Seal, Switch (4)
16		Switch, Limiter
	3191965	Use W/3192171 R.F. Element
	3191964	Use W/3192172 L.R. Element
	3191963	Use W/3191720 R.R. Element
	3191966	Use W/3191723 L.F. Element
17	311865	Screw
20	3191515	Rail, Element (2)
21	3192268	Rail, Element (1)
22	3191343	Lamp, Hot Surface Indicator
24		Element, Surface (Includes # 16)
	3192171	1200W Right Front
	3192172	1500W Left Rear
	3191720	1800W Right Rear
	3191723	2400W Left Front

FOR ORDERING INFORMATION REFER TO PARTS PRICE LIST

MISCELLANEOUS PARTS

For Models: KECC507GBL0, KECC507GWH0, KECC507GAL0, KECC507GBT0
(Black) (White) (Almond) (Biscuit)

Illus. No.	Part No.	DESCRIPTION
-------------------	-----------------	--------------------

**FOLLOWING PARTS
NOT ILLUSTRATED**

LITERATURE PARTS

LIT3191771 Installation
Instructions
LIT3191795 Wiring Diagram
LIT3191524 Use & Care Guide

Miscellaneous

3172515 Mtg. Hardware Kit

SPLICING WIRES--25FT.

LENGTH

242828 Wire, Black
12 Ga. 150° C
242820 Wire, Black
14 Ga. 150° C
242822 Wire, Blue
14 Ga. 150° C
242830 Wire, Brown
14 Ga. 200° C
242823 Wire, Green
14 Ga. 150° C
242824 Wire, Orange
14 Ga. 150° C
242829 Wire, Red
12 Ga. 150° C
242825 Wire, Red
14 Ga. 150° C
242831 Wire, Red
14 Ga. 200° C
242826 Wire, White
14 Ga. 150° C
242827 Wire, Yellow
14 Ga. 150° C
242832 Wire, Yellow
14 Ga. 200° C

ACCESSORY PARTS

3191048 Cleaner, Glass

WIRING HARNESS PARTS

3192265 Wiring Harness
Surface Unit
3400015 Screw, Ground
3192220 Conduit Assy.

FOR ORDERING INFORMATION REFER TO PARTS PRICE LIST