

KitchenAid® COOKTOP PARTS

For Models: KECC507GBL2, KECC507GWH2, KECC507GAL2, KECC507GBT2, KECC507GWW2
(Black) (White) (Almond) (Biscuit) (Designer White)

30" ELECTRIC
BUILT-IN
COOKTOP

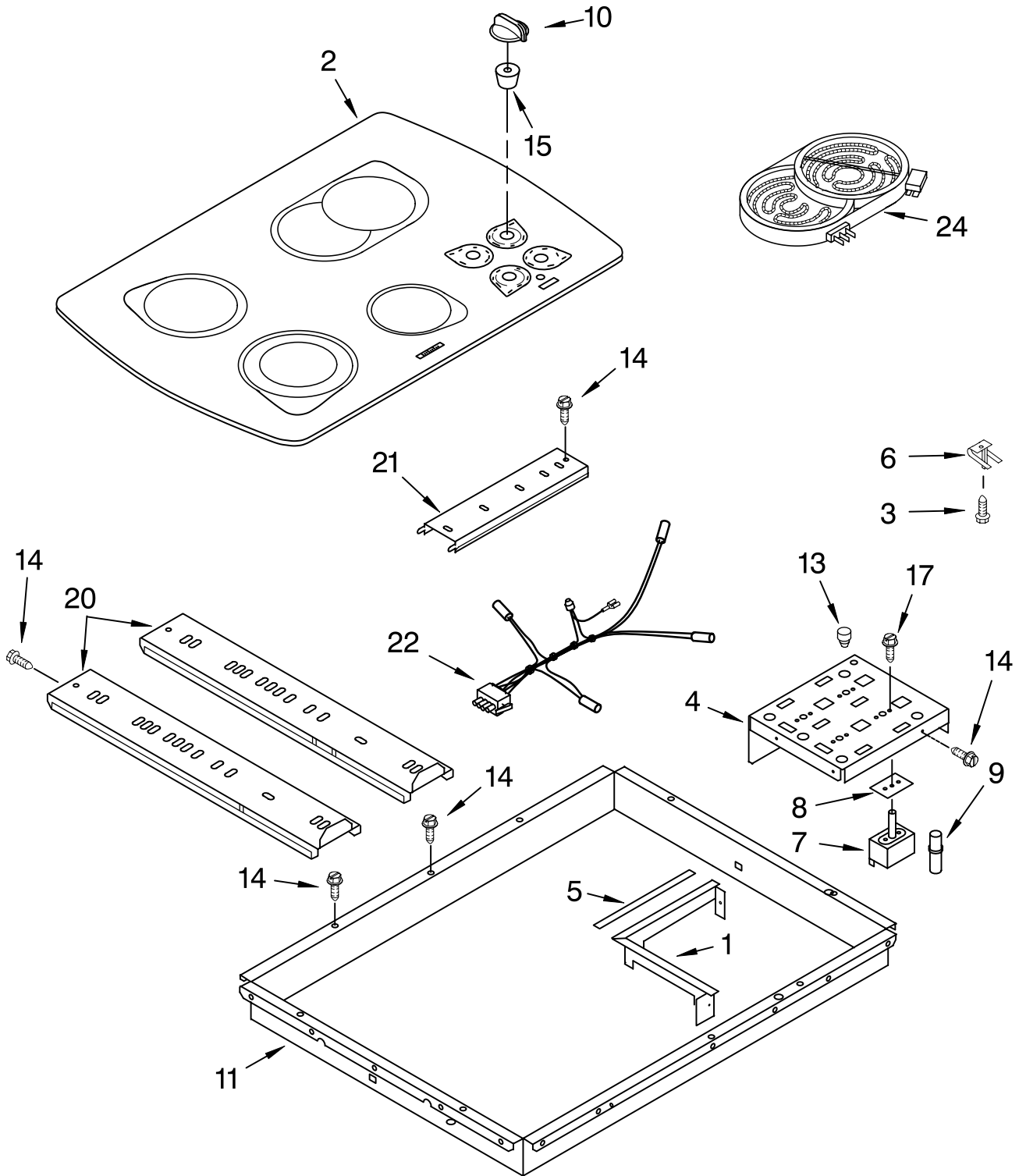

FOR ORDERING INFORMATION REFER TO PARTS PRICE LIST

COOKTOP PARTS

For Models: KECC507GBL2, KECC507GWH2, KECC507GAL2, KECC507GBT2, KECC507GWW2
 (Black) (White) (Almond) (Biscuit) (Designer White)

Illus. No.	Part No.	DESCRIPTION
1	4455468	Shield, Heat
2		Cooktop, Glass
	4455297	Black
	4455293	White
	4455292	Honeycomb
	8284699	Designer White
3	246119	Screw
4	4455421	Bracket, Switch
5	3191839	Seal, Heat Shield
6	3191791	Spring Locator (8)
7		Switch, Infinite
	3191049	Use W/1500W Left Rear Burner
	3188516	Use W/1800W Right Rear Burner
	3191049	Use W/1200W Right Front Burner
	3188516	Use W/2400 W Left Front Burner
8	3183956	Seal, Switch Shaft
9	3191945	Light, Indicator
10		Knob, Control (4)
	9750372FF	Black
	9750372FW	White
	9750372FT	Almond
	9750372FC	Biscuit
11	4456401	Box, Burner
13	3192477	Bumper, Silicone
14	3196537	Screw
15	3182435	Seal, Switch (4)
17	311865	Screw
20	3191515	Rail, Element (2)
21	3192268	Rail, Element (1)
22	3191343	Lamp, Hot Surface Indicator
24		Element, Surface
	4452742	1200W – RF
	4452743	1500W – LR
	4452741	1000/1800W – RR
	8272563	1000/2400W – LF
	3192737	Seal, Heat
	3192439	Seal, Limiter

FOR ORDERING INFORMATION REFER TO PARTS PRICE LIST

MISCELLANEOUS PARTS

For Models: KECC507GBL2, KECC507GWH2, KECC507GAL2, KECC507GBT2, KECC507GWW2

(Black)

(White)

(Almond)

(Biscuit)

(Designer White)

Illus. No.	Part No.	DESCRIPTION
------------	----------	-------------

**FOLLOWING PARTS
NOT ILLUSTRATED**

LITERATURE PARTS

LIT3192799 Installation Instructions
 LIT3191795 Wiring Diagram
 LIT8284718 Use & Care Guide
 LIT3191638 Safe Cooking Tips

Miscellaneous

3172515 Mtg. Hardware Kit
 4455364 Bracket, Support (4)
 3192408 Bracket, Support (2)

Illus. No.	Part No.	DESCRIPTION
------------	----------	-------------

SPLICING WIRES--25FT.

LENGTH

242828 Wire, Black
 12 Ga. 150° C
 242820 Wire, Black
 14 Ga. 150° C
 242822 Wire, Blue
 14 Ga. 150° C
 242830 Wire, Brown
 14 Ga. 200° C
 242823 Wire, Green
 14 Ga. 150° C
 242824 Wire, Orange
 14 Ga. 150° C
 242829 Wire, Red
 12 Ga. 150° C
 242825 Wire, Red
 14 Ga. 150° C
 242831 Wire, Red
 14 Ga. 200° C
 242826 Wire, White
 14 Ga. 150° C
 242827 Wire, Yellow
 14 Ga. 150° C
 242832 Wire, Yellow
 14 Ga. 200° C

Illus. No.	Part No.	DESCRIPTION
------------	----------	-------------

ACCESSORY PARTS

3191048 Cleaner, Glass

WIRING HARNESS PARTS

4455273 Wiring Harness Surface Unit
 3400015 Screw, Ground
 3192220 Conduit Assy.

FOR ORDERING INFORMATION REFER TO PARTS PRICE LIST