

KitchenAid® COOKTOP PARTS

For Models: KECC507GBL3, KECC507GWH3, KECC507GAL3, KECC507GBT3, KECC507GWW3
(Black) (White) (Almond) (Biscuit) (Designer White)

36" ELECTRIC
BUILT-IN
COOKTOP

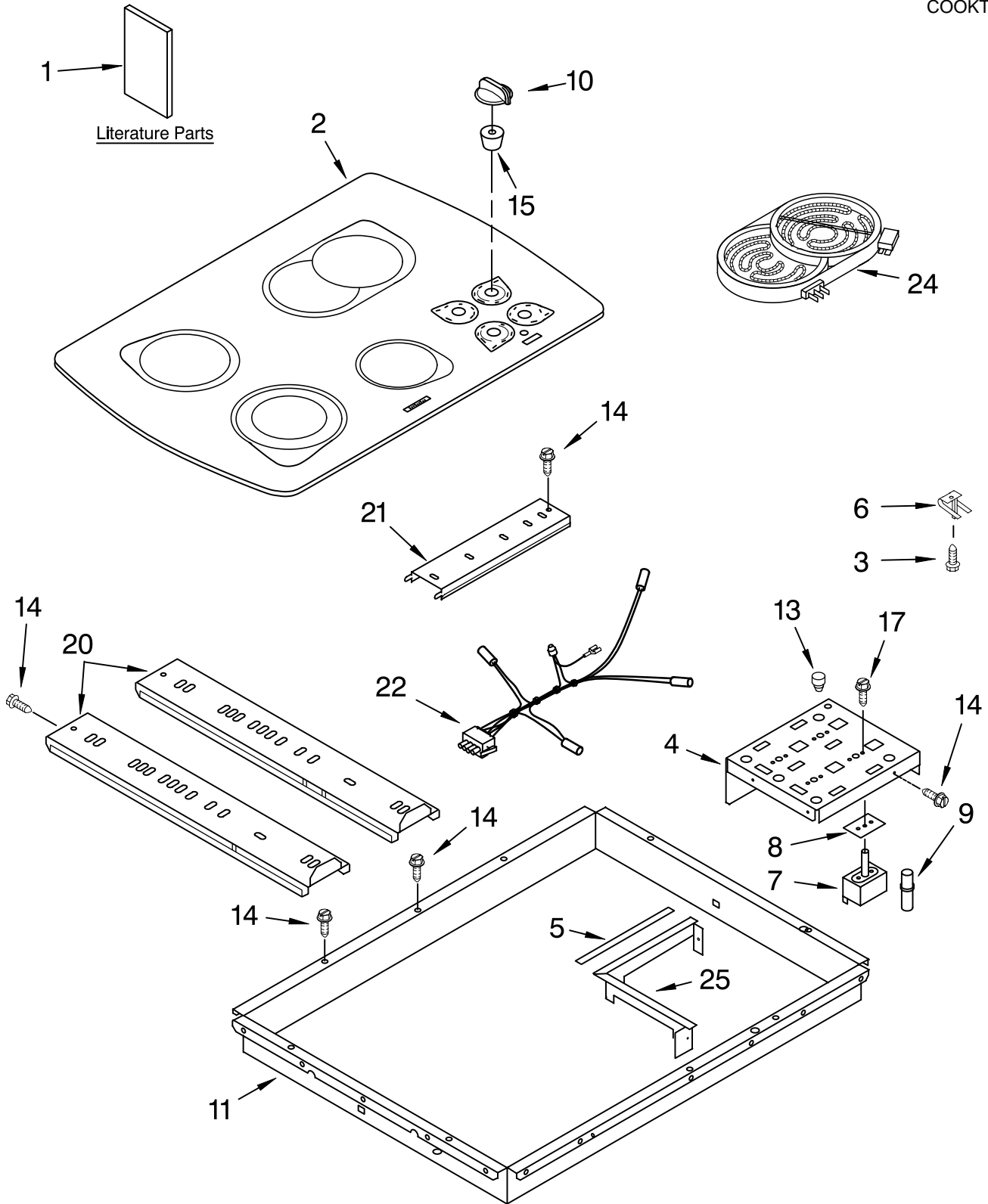

FOR ORDERING INFORMATION REFER TO PARTS PRICE LIST

COOKTOP PARTS

For Models: KECC507GBL3, KECC507GWH3, KECC507GAL3, KECC507GBT3, KECC507GWW3
 (Black) (White) (Almond) (Biscuit) (Designer White)

| Illus. No. | Part No. | DESCRIPTION |
|------------|------------|-----------------------------|
| 1 | | Literature Parts |
| | LIT3191771 | Installation Instructions |
| | LIT3191797 | Wiring Diagram |
| | LIT3191524 | Use & Care Guide |
| | LIT3191638 | Safe Cooking Tips |
| 2 | | Cooktop, Glass |
| | 4455548 | Black |
| | 4455544 | White |
| | 4455543 | Almond/Biscuit |
| | 4455713 | Designer White |
| 3 | 246119 | Screw |
| 4 | 4455421 | Bracket, Switch Mounting |
| 5 | 3191839 | Seal, Heat Shield |
| 6 | 3191791 | Spring Locator(10) |
| | 246119 | Screw (8) |
| 7 | | Switch, Infinite |
| | 3191049 | LR – RF |
| | 3188516 | LF – RR |
| 8 | 3192439 | Seal, Switch Shaft |
| 9 | 3191945 | Light, Indicator |
| 10 | | Knob, Control (4) |
| | 9750372FF | Black |
| | 9750372FW | White |
| | 9750372FT | Almond |
| | 9750372FC | Biscuit |
| 11 | 4456401 | Box, Burner |
| 13 | 3192477 | Bumper, Silicone |
| 14 | 3196537 | Screw |
| 15 | 3182435 | Seal, Switch (5) |
| 17 | 311865 | Screw |
| 20 | 3191515 | Rail, Element (2) |
| 21 | 3192268 | Rail, Element (1) |
| 22 | 3191343 | Lamp, Hot Surface Indicator |
| 24 | | Element, Surface |
| | 8272563 | 1000/2400W – LF |
| | 4452742 | 1200W – RF |
| | 4452741 | 1000/1800W – RR |
| | 4452743 | 1500W – LR |
| | 3192737 | Seal, Heat |
| | 3192439 | Seal, Limiter |
| 25 | 4455468 | Shield, Heat |

MISCELLANEOUS PARTS

For Models: KECC507GBL3, KECC507GWH3, KECC507GAL3, KECC507GBT3, KECC507GWW3
(Black) (White) (Almond) (Biscuit) (Designer White)

| <u>Illus. No.</u> | <u>Part No.</u> | <u>DESCRIPTION</u> |
|-------------------|-----------------|--------------------|
|-------------------|-----------------|--------------------|

**FOLLOWING PARTS
NOT ILLUSTRATED**

Miscellaneous

3172515 Mtg. Hardware Kit
3192408 Bracket,
Support (2)

SPLICING WIRES--25FT.

LENGTH

242828 Wire, Black
12 Ga. 150° C
242820 Wire, Black
14 Ga. 150° C
242822 Wire, Blue
14 Ga. 150° C
242830 Wire, Brown
14 Ga. 200° C
242823 Wire, Green
14 Ga. 150° C
242824 Wire, Orange
14 Ga. 150° C
242829 Wire, Red
12 Ga. 150° C
242825 Wire, Red
14 Ga. 150° C
242831 Wire, Red
14 Ga. 200° C
242826 Wire, White
14 Ga. 150° C
242827 Wire, Yellow
14 Ga. 150° C
242832 Wire, Yellow
14 Ga. 200° C

ACCESSORY PARTS

3191048 Cleaner, Glass

WIRING HARNESS PARTS

4455273 Harness, Main
3400015 Screw, Ground
3192220 Conduit Assy.

FOR ORDERING INFORMATION REFER TO PARTS PRICE LIST