



ITEM NO. \_\_\_\_\_

# ASC-2E

## THE PLATINUM SERIES ELECTRIC CONVECTION OVEN



ASC-2E  
WITH MOBILE STAND  
OPTION 5004687

- Superior baking and roasting capability.
- Solid stainless steel door and a double pane thermal window.
- Single door includes a spring-loaded roller assembly and a heavy-duty door hinging system.
- Solid welded construction with stainless steel front, sides, top and rear enclosure panel.
- Removable oven baffle provides easy cleaning.
- Heavy-duty 1/4 hp, two-speed motor provides a fan speed for high volume production or delicate baking.
- Easy to clean porcelain enamel oven interior is standard.
- 5kW heating elements.
- Durable, low maintenance stainless steel door gaskets.

The Platinum Series electric convection oven features solid welded construction, an angle iron frame, and a non-corrosive stainless steel exterior. The oven interior is constructed of porcelain enamel with coved corners, and a heavy duty, 14 gauge bottom liner. The oven is supplied with five (5) chrome plated wire shelves with 2 removable side racks and 9 shelf positions spaced at 1-5/8" (41mm). It is furnished with 5,000 watt heating elements and a heavy duty, 1/4 hp, two-speed fan motor. Control includes a 100°F to 500°F (38°C to 260°C) thermostat and a 60 minute, count-down timer. The control features an oven cool-down function, oven-ready indicator light, and produces an audible signal when time has expired. The oven is supplied with 4" (102mm) bullet legs.

**MODEL ASC-2E:** MANUAL CONTROL, PORCELAIN ENAMEL INTERIOR

**MODEL ASC-2E/e:** ELECTRONIC CONTROL WITH FOOD PROBE, PORCELAIN ENAMEL INTERIOR



### FACTORY INSTALLED OPTIONS

- Stainless steel oven interior

### ADDITIONAL FEATURES

- Stackable design



W164 N9221 Water Street • P.O. Box 450 • Menomonee Falls, Wisconsin 53052-0450 • U.S.A.  
 PHONE: 262.251.3800 800.558.8744 U.S.A./CANADA FAX: 262.251.7067 800.329.8744 U.S.A. ONLY  
[www.alto-shaam.com](http://www.alto-shaam.com)

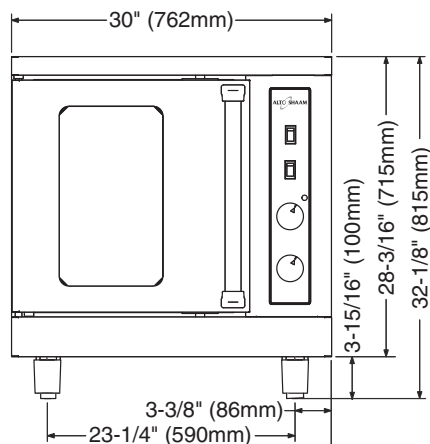
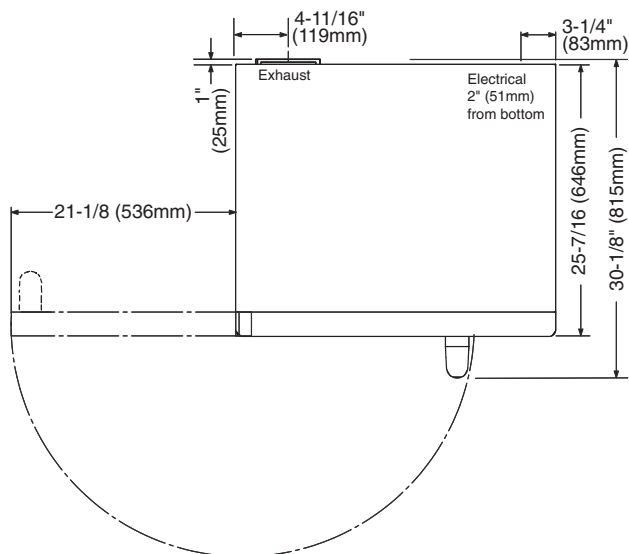

<b>DIMENSIONS:</b> H x W x D
EXTERIOR: 32-1/8" x 30" x 30-1/8" (815mm x 762mm x 815mm)
INTERIOR: 20" x 15" x 21" (508mm x 381mm x 533mm)

ELECTRICAL					
VOLTAGE	PHASE	CYCLE/HZ	AWG	AMPS	kW
208 (AGCY)	1	60	10	24.0	5.0
240 (AGCY)	1	60	10	20.8	5.0
208 (AGCY)	3	60	12	13.8	5.0
240 (AGCY)	3	60	12	12.0	5.0
<b>NO CORD AND PLUG</b>					

MINIMUM CLEARANCE REQUIREMENTS	
SIDES	2" (51mm)
BACK SIDE	0" (0mm)
FROM GREASE PRODUCING EQUIPMENT	6" (152mm)
RECOMMENDED SERVICE ACCESS RIGHT SIDE	20" (508mm)

PRODUCT/PAN CAPACITY
27 lb (12 kg) MAXIMUM — 17 qts (15 liters)
Nine (9): 18" x 13" x 1" half-size sheet pans
5 chrome plated wire shelves with 2 removable side racks and 9 shelf positions spaced at 1-5/8" (41mm)

WEIGHT	
NET: 250 lb (113 kg) EST.	SHIP: 325 lb (147 kg) EST.
CRATE	44" H x 42" W x 42" D EST.
DIMENSIONS:	(1118mm x 1067mm x 1067mm)
MINIMUM ENTRY CLEARANCE	31" (787mm) UNCRATED

INSTALLATION REQUIREMENTS
— This appliance must be installed level and must not be installed in any area where it may be affected by steam, grease, dripping water, high temperatures, or any other severely adverse conditions.
— Mobile appliances must be secured to the building structure by means of a restraining device (NOT FACTORY SUPPLIED).
— Hood installation is recommended (CHECK LOCAL CODES).

OPTIONS & ACCESSORIES
<b>LEG KIT, 4" (102mm)</b>
<input type="checkbox"/> Seismic feet .....5004688
<b>LEG KIT</b>
<input type="checkbox"/> with Bullet feet, 19-1/2" (495mm) HEIGHT .....5005169
<input type="checkbox"/> with Seismic feet, 19-1/2" (495mm) HEIGHT .....5005168
<input type="checkbox"/> with Casters, 23" (584mm) HEIGHT .....5005181
<input type="checkbox"/> <b>SHELF, OVEN RACK</b> .....SH-26894
<b>STACKING HARDWARE</b>
SEE INDIVIDUAL STACKING COMBINATION SPECIFICATION SHEETS
<b>STAND, SINGLE OVEN</b>
<input type="checkbox"/> with Bullet feet, 26-1/2" (673mm) HEIGHT .....5004672
<input type="checkbox"/> with Seismic feet, 26-1/2" (673mm) HEIGHT .....5005172
<input type="checkbox"/> with Casters, 30" (762mm) HEIGHT .....5004687