



User Guide

HP L717g 17" and
HP L919g 19" Flat Panel Monitors

Document Part Number: 395552-001

May 2005

This guide provides information on setting up the monitor, installing drivers, using the on-screen display menu, troubleshooting and technical specifications.

Enhanced for Accessibility

© 2005 Hewlett-Packard Development Company, L.P.

HP, Hewlett Packard, and the Hewlett-Packard logo are trademarks of Hewlett-Packard Company in the U.S. and other countries.

Compaq and the Compaq logo are trademarks of Hewlett-Packard Development Company, L.P. in the U.S. and other countries.

Microsoft, Windows, and the Windows logo are trademarks of Microsoft Corporation in the U.S. and other countries.

All other product names mentioned herein may be trademarks of their respective companies.

Hewlett-Packard Company shall not be liable for technical or editorial errors or omissions contained herein or for incidental or consequential damages in connection with the furnishing, performance, or use of this material. The information in this document is provided “as is” without warranty of any kind, including, but not limited to, the implied warranties of merchantability and fitness for a particular purpose, and is subject to change without notice. The warranties for Hewlett-Packard products are set forth in the express limited warranty statements accompanying such products. Nothing herein should be construed as constituting an additional warranty.

This document contains proprietary information that is protected by copyright. No part of this document may be photocopied, reproduced, or translated to another language without the prior written consent of Hewlett-Packard Company.



WARNING: Text set off in this manner indicates that failure to follow directions could result in bodily harm or loss of life.



CAUTION: Text set off in this manner indicates that failure to follow directions could result in damage to equipment or loss of information.

User Guide

HP L717g 17" and L919g 19" Flat Panel Monitors

First Edition (May 2005)

Document Part Number: 395552-001

Contents

1 Product Features

2 Safety and Maintenance Guidelines

Important Safety Information	2-1
Maintenance Guidelines	2-2
Cleaning the Monitor	2-3
Shipping the Monitor	2-3

3 Setting Up the Monitor

Installing the Stand Base	3-1
Removing the Stand Base	3-2
Selecting the Signal Connectors and Cables	3-3
Connecting the Monitor	3-4
Mounting the Monitor	3-9
Locating the Rating Labels	3-10

4 Operating the Monitor

Software and Utilities	4-1
The Information File	4-1
The Image Color Matching File	4-2
Installing the .INF and .ICM Files	4-2
Installing from the CD	4-2
Downloading from the Worldwide Web	4-3
Front Panel Controls	4-4
Adjusting the Screen Image	4-6
Using the On-Screen Display	4-6

Selecting and Adjusting OSD Menus	4-9
Optimizing Digital Conversion	4-12
Identifying Monitor Conditions	4-12
HP Display LiteSaver.	4-13
Installing the HP Display LiteSaver Software.	4-13

A Troubleshooting

Solving Common Problems	A-1
Using the Worldwide Web.	A-4
Preparing to call Technical Support.	A-5

B Technical Specifications

L717g Flat Panel Monitor	B-1
L919g Flat Panel Monitor	B-4
Recognizing Preset Display Resolutions	B-6
Entering User Modes	B-7
Energy Saver Feature.	B-7
Power Light Indicators.	B-8

C Agency Regulatory Notices

Federal Communications	
Commission Notice	C-1
Modifications.	C-2
Cables	C-2
Declaration of Conformity for Products Marked with the FCC	
Logo (United States Only)	C-2
Materials Disposal	C-3
Canadian Notice.	C-3
Avis Canadien	C-3

Disposal of Waste Equipment by Users in Private Household in the European Union	C-4
ENERGY STAR Compliance	C-4
Power Cord Set Requirements	C-5

D LCD Monitor Quality and Pixel Policy

Product Features

The Flat Panel Display has an active matrix, thin-film transistor (TFT), liquid crystal display (LCD). The monitor features include:

L717g Model

- 17-inch (43.27 cm) viewable area display.
- 1280 × 1024 native resolution, plus full-screen support for lower resolutions.
- Wide viewing angle to allow viewing from a sitting or standing position, or moving side-to-side.
- Tilt and swivel adjustment capabilities.
- Removable stand base and VESA 100mm mounting holes for flexible mounting solutions.
- Plug and play capability if supported by your system.
- On-Screen Display (OSD) adjustments for ease of set-up and screen optimization.
- Software and documentation CD includes an information file (INF), Image Color Matching file (ICM), and product documentation.
- Energy Saver feature for Energy Star compliance.

- Compliant with the EPA ENERGY STAR regulated specification.

L919g Model

- 19-inch (48.19 cm) viewable area display.
- 1280 x 1024 native resolution, plus full-screen support for lower resolutions.
- Wide viewing angle to allow viewing from a sitting or standing position, or moving side-to-side.
- Tilt and swivel adjustment capabilities.
- Removable stand base and VESA 100mm mounting holes for flexible mounting solutions.
- Plug and play capability if supported by your system.
- On-Screen Display (OSD) adjustments for ease of set-up and screen optimization.
- Software and documentation CD includes an information file (INF), Image Color Matching file (ICM), and product documentation.
- Energy Saver feature for Energy Star compliance.
- Compliant with the EPA ENERGY STAR regulated specifications.

Safety and Maintenance Guidelines

Important Safety Information

A power cord is included with your monitor. If another cord is used, use only a power source and connection appropriate for this monitor. For information on the correct power cord set to use with your monitor, refer to the “Power Cord Set Requirements” section in Appendix C.



WARNING: To reduce the risk of electric shock or damage to your equipment, do not disable the power cord grounding feature. This equipment is designed to be connected to a grounded (earthed) power outlet that is easily accessible to the operator. The grounding plug is an important safety feature.



WARNING: For your safety, be sure that the power outlet you plug the power cord into is easily accessible and located as close to the equipment as possible. When you need to disconnect the power to the equipment, unplug the power cord from the power outlet by grasping the plug firmly. Never pull on the cord.



CAUTION: For the protection of your monitor, as well as your computer, connect all power cords for your computer and its peripheral devices (such as a monitor, printer, scanner) to some form of surge protection device such as a power strip or Uninterruptible Power Supply (UPS). Not all power strips provide surge protection; the power strips must be specifically labeled as having this ability. Use a power strip whose manufacturer offers a Damage Replacement Policy so you can replace your equipment if surge protection fails.

Maintenance Guidelines

To enhance the performance and extend the life of your monitor:

- Do not open your monitor cabinet or attempt to service this product yourself. Adjust only those controls that are covered in the operating instructions. If your monitor is not operating properly or has been dropped or damaged, contact your HP authorized dealer, reseller, or service provider.
- Use only a power source and connection appropriate for this monitor, as indicated on the label/back plate of the monitor.
- Be sure the total ampere rating of the products connected to the outlet does not exceed the current rating of the electrical outlet, and the total ampere rating of the products connected to the cord does not exceed the rating of the cord. Look on the power label to determine the ampere rating (AMPS or A) for each device.
- Install your monitor near an outlet that you can easily reach. Disconnect the monitor by grasping the plug firmly and pulling it from the outlet. Never disconnect the monitor by pulling the cord.
- Turn your monitor off when not in use. You can substantially increase the life expectancy of your monitor by using a screen saver program and turning off the monitor when not in use.

- Slots and openings in the cabinet are provided for ventilation. These openings must not be blocked or covered. Never push objects of any kind into cabinet slots or other openings.
- Do not drop your monitor or place it on an unstable surface.
- Do not allow anything to rest on the power cord. Do not walk on the cord.
- Keep your monitor in a well-ventilated area, away from excessive light, heat or moisture.
- When removing the monitor base, you must lay the monitor face down on a soft area to prevent it from getting scratched, defaced, or broken.

Cleaning the Monitor

1. Turn off the monitor and the computer.
2. Unplug the monitor from the wall outlet.
3. Clean the monitor plastics with a clean cloth dampened with water.
4. Clean the monitor screen with an antistatic screen cleaner.



CAUTION: Do not use benzene, thinner, ammonia, or any other volatile substances to clean your monitor or the screen. These chemicals may damage the cabinet finish as well as the screen.

Shipping the Monitor

Keep the original packing box in a storage area. You may need it later if you move or ship your monitor.

Setting Up the Monitor

To set up the monitor, ensure that the power is turned off to the monitor, computer system, and other attached devices, then follow the steps below.

Installing the Stand Base

1. Place the monitor with its front facing downward on a cushion or soft cloth.



Do not install the stand base if the monitor will be used on a wall, swing arm, or other mounting fixture; instead see the section on “Mounting the Monitor” in this chapter.

2. Align the hooks on the stand base with the matching slots in the base of the monitor.
3. Insert the hooks into the slots.

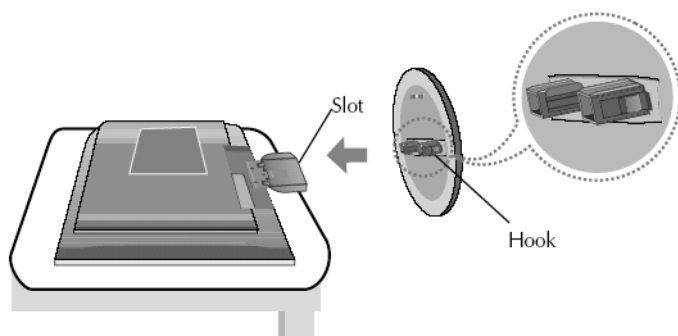

Inserting the Monitor into the Stand Base

Removing the Stand Base

1. Place the monitor with its front facing downward on a cushion or soft cloth.



CAUTION: Do not remove the stand base from the monitor while the monitor is in the upright position. Lay the front bezel down on a soft area to prevent it from getting scratched, defaced, or broken.

2. To remove the stand base, hold the bottom of the stand with one hand and pull the base bottom latch with the other hand, as shown in the following figure.



CAUTION: Ensure that the bottom of the stand base is positioned over a table or desktop before removing the base from the monitor.

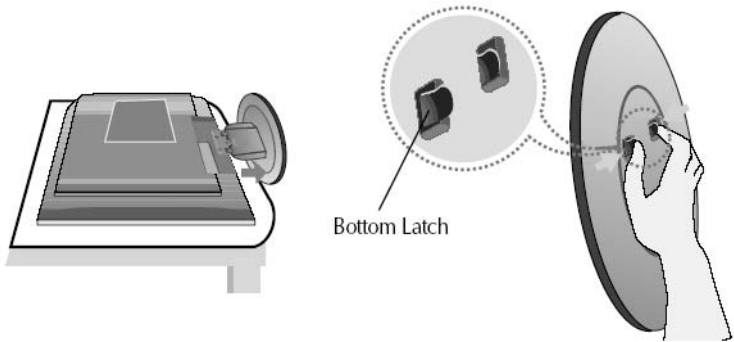

Removing the Stand Base From the Monitor



CAUTION: After the stand base is connected, try not to disconnect it. Do not carry the product upside down holding only the base. The product may fall and get damaged or cause injury to your feet.

Selecting the Signal Connectors and Cables

There are two signal input connectors available on the monitor:

- VGA connector
- DVI-D connector

The monitor will automatically determine which inputs have valid video signals.

The video mode supported by the DVI-D connector is determined by the video cable used. For digital operation, used the DVI-D signal cable provided. For analog operation, use the VGA signal cable provided.

Connecting the Monitor

1. Place the monitor in a convenient, well-ventilated location near your computer.
2. Connect the signal cable ❶. When attached, tighten the thumbscrews to secure the connection.
 - a. For analog operation, connect one end of the VGA signal cable to the VGA connector on the monitor and the other end to the VGA connector on the computer. This cable is provided with the monitor.
 - b. For digital operation, use the DVI-D signal cable. Connect one end of the DVI-D cable to the DVI connector on the monitor and the other end to the DVI connector on the computer. This cable is provided with the monitor.



CAUTION: The DVI-D cable supplied with the monitor is for digital-to-digital connection only. Your computer must have a DVI-compatible graphics card installed for use with this cable.

3. Connect the power cable ❷ to back of the monitor, and the other end to an electrical wall outlet that is easily accessible and close to the monitor.



WARNING: To reduce the risk of electric shock or damage to your equipment:

- Do not disable the power cord grounding plug. The grounding plug is an important safety feature.
 - Plug the power cord into a grounded (earthed) electrical outlet that is easily accessible at all times.
 - Disconnect power from the monitor by unplugging the power cord from the electrical outlet.
 - Do not place anything on power cords or cables. Arrange them so that no one may accidentally step on or trip over them. Do not pull on a cord or cable. When unplugging from the electrical outlet, grasp the cord by the plug.
-

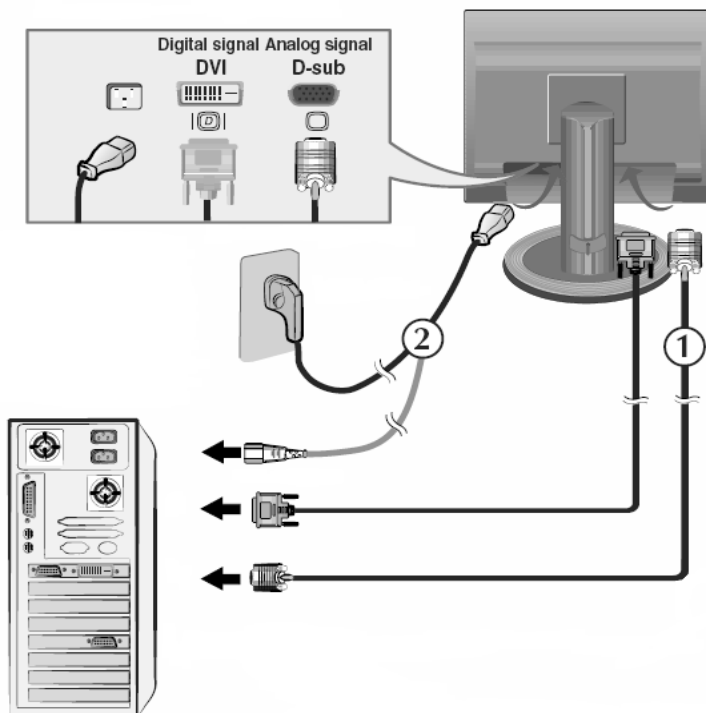

Connecting the Signal and Power Cables (The rear view of your computer and monitor may differ from the view shown in this illustration.)

4. Adjust the monitor as needed for your comfort using the monitor's tilt and swivel adjustment capabilities.



It is recommended that in order to maintain an ergonomic and comfortable viewing position, the forward tilt angle of the monitor should not exceed 5 degrees.

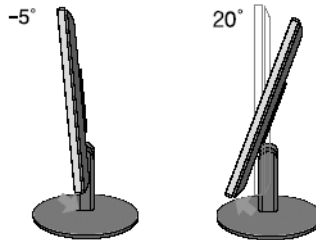

Tilting the Monitor

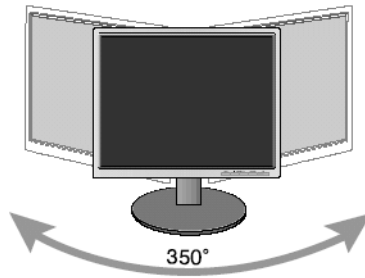

Swiveling the Monitor

5. Press the power button on the front of the panel to turn on the monitor. When the monitor power is turned on, the **Self Image Setting Function** is enabled automatically (only analog mode).



The **Self Image Setting Function** provides you with optimal display settings. When the monitor is connected for the first time, this function automatically adjusts the display to optimal settings for individual input signals. If you want to adjust the monitor while in use, or want to manually run this function once again, press the Auto/Set button on the front panel of the monitor. Otherwise, you may enable the Factory Reset option on the On-Screen Display (OSD) adjustment menu. However, be aware that this option initializes all the menu items except Language.



CAUTION: When the monitor is on, burn-in image damage may occur on monitors that display the same static image on screen for a prolonged period of time. To avoid burn-in image damage on your monitor screen, you should always activate a screen saver application or turn off the monitor when it is not in use for a prolonged period of time. Image retention is a condition that may occur on all LCD screens.

Mounting the Monitor

The monitor panel can be mounted on a wall, a swing arm, or other mounting fixture.

1. If the stand base is attached, follow the procedure in “Removing the Stand Base” at the beginning of this chapter.



CAUTION: Before beginning to disassemble the monitor, be sure the monitor is turned off and the power and signal cables are both disconnected. If your monitor has a connected audio cable, disconnect it.

After the base is removed from the monitor, four threaded mounting holes are exposed on the monitor back panel to be used for mounting purposes. These mounting holes are spaced 100mm apart and are compliant with the Video Electronics Standards Association (VESA) standard for mounting flat panel displays.



CAUTION: This monitor supports the VESA industry standard 100mm mounting holes. To attach a third party mounting solution to the monitor, four 4mm, 0.7 pitch, and 10mm long screws are required (not provided with the monitor). Longer screws should not be used because they may damage the monitor. It is important to verify that the manufacturer’s mounting solution is compliant with the VESA standard and is rated to support the weight of the monitor display panel. For best performance, it is important to use the power and video cable provided with the monitor.

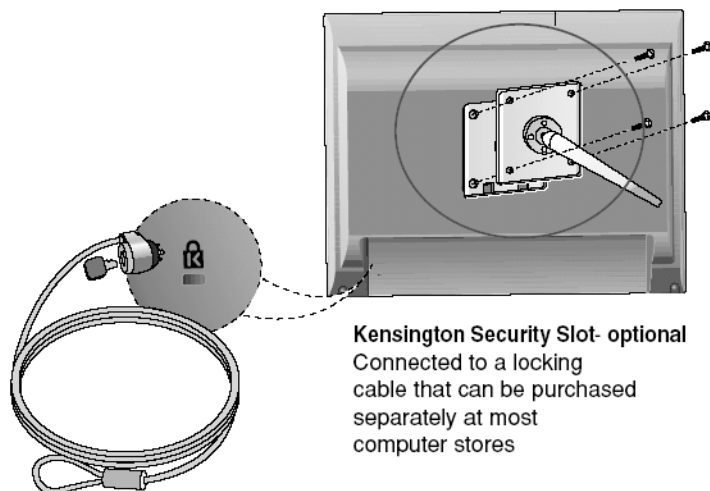

Kensington Security Slot- optional
Connected to a locking
cable that can be purchased
separately at most
computer stores

Installing the VESA Mounting Assembly and Kensington Lock

2. Mount the monitor to a swing arm or other mounting fixture by following the instructions included with the mounting fixture to be used.

Locating the Rating Labels

The rating labels on the monitor provide the spare part number, product number, and serial number. You may need these numbers when contacting HP about your monitor model. The rating label is located on the rear panel to the left side of the VESA mounting holes.

Operating the Monitor

Software and Utilities

The monitor includes a CD that contains two files you can install on your computer:

- an .INF (Information) file
- an .ICM (Image Color Matching) file

Adobe Acrobat Reader is supplied on this CD and can be installed from the menu.



If the monitor does not include a CD, the .INF and .ICM files can be downloaded from the HP monitors support Web site. See “Downloading from the Worldwide Web” in this chapter.

The Information File

The .INF file enables the computer to communicate with the monitor and use all the monitor features. The .INF file defines monitor resources used by Microsoft Windows operating systems to ensure monitor compatibility with the computer’s graphics adapter.

This monitor is Windows Plug and Play compatible and the monitor will work correctly without installing the .INF file. Monitor Plug and Play compatibility requires that the computer’s graphic card is VESA DDC2 compliant and that the monitor connects directly to the graphics card. Plug and Play does not

work through separate BNC type connectors or through distribution buffers/boxes. You may need to install the .INF file if these conditions are not met.

The Image Color Matching File

The .ICM file provides accurate color representation. The .ICM files are data files that are used in conjunction with graphics programs to provide consistent color matching from monitor screen to printer, or from scanner to monitor screen. The .ICM file contains a monitor color system profile. This file is activated from within graphics programs that support this feature.



The ICM color profile is written in accordance with the International Color Consortium (ICC) Profile Format specification.

Installing the .INF and .ICM Files

After you determine that you need to update, you can install the .INF and .ICM files from the CD or download them.

Installing from the CD

To install the .INF and .ICM files on the computer from the CD:

1. Insert the CD in the computer CD-ROM drive. The CD menu displays.
2. View the “INF and ICM Readme” file.
3. Select “Install INF and ICM Files.”
4. Follow the on-screen instructions.
5. After the INF software has been installed, restart Windows.

6. Ensure that the proper resolution and refresh rates appear in the Windows Display control panel.



You may need to install the digitally signed monitor .INF and .ICM files manually from the CD in the event of an installation error. Refer to the INF and ICM Readme file on the CD.

Downloading from the Worldwide Web

To download the latest version of .INF and .ICM files from the HP monitors support Web site:

1. Refer to <http://www.hp.com/support> and select your country region.
2. Follow the links for your monitor to the support page and download page.
3. Ensure your system meets the requirements.
4. Download the software by following the instructions.

Front Panel Controls

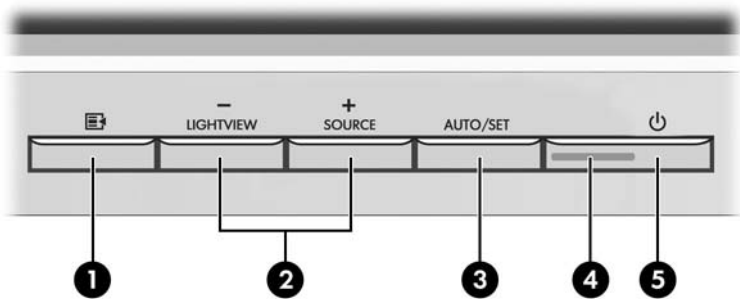

Control		Function
❶	Menu	Enters or exits the OSD menu.
	OSD Locked/Unlocked	<p>The menu button also allows you to lock the current control settings so that they cannot not be inadvertently changed.</p> <p>Press and hold the menu button for 5 seconds. The message OSD LOCKED will appear.</p> <p>You can unlock the OSD controls at any time by pressing the Menu button for 5 seconds. The message OSD UNLOCKED will appear.</p>
❷	- + Buttons	Selects or adjusts functions in the OSD.

Control	Function
- /Lightview	<p>The Lightview hot key lets you select DAY TEXT or NIGHT TEXT for the best desired image condition optimized to the environment (such as ambient illumination and image types). When the OSD is off, press the - button to select the day or night text.</p> <ul style="list-style-type: none"> • Day: bright ambient illumination • Night: dark ambient illumination • Text: for text images (word processing, etc.) • Movie: for animation images in videos or movies • Photo: for pictures or drawings • Normal: for use under normal conditions
+ /Source	<p>Use this hotkey to select VGA or DVI video signal input. When the OSD is off, press the + button to enable the VGA or DVI connector. Use this feature when two computers are connected to the monitor. The VGA signal input is the default connector.</p>
③ Auto/Set	<p>Enters a selection in the OSD.</p>
Auto Image Adjustment	<p>When adjusting the display settings, always press the Auto/Set button before entering the OSD. This will automatically adjust your display image to the ideal setting for the current screen resolution size (display mode).</p> <p>The best display mode is</p> <p>17-inch monitor: 1280x1024</p> <p>19-inch monitor: 1280x1024</p>
④ Power Indicator	<p>Lights up green when the monitor operates normally (On Mode). If the monitor is in Sleep Mode (Energy Saving), the indicator color changes to amber.</p>
④ Power button	<p>Turns the monitor on or off.</p>

Adjusting the Screen Image

Use the On-Screen Display (OSD) to adjust the screen image, position and operating parameters of the monitor based on your viewing preferences. To make screen adjustments in the OSD:

1. If the monitor is not already on, press the Power button to turn on the monitor.

Allow the monitor to stabilize for at least 30 minutes before making image adjustments.
2. Press the **Menu** button, then the main menu of the OSD appears.
3. To access a menu control, use the - or + buttons. When the icon you want becomes highlighted, press the **Auto/Set** button.
4. Use the - / + buttons to adjust the image to the desired level. Use the **Auto/Set** button to select other sub-menu items.
5. Press the **Menu** button once to return to the main menu to select another function. Press the **Menu** button twice to exit the OSD menu.

Using the On-Screen Display

The following table lists the available adjustments and selections you can make using the OSD menu.

Main Menu	Sub Menu		Reference
Picture	Brightness	x	Adjusts the brightness, contrast and gamma of the screen.
	Contrast	x	
	Gamma	x	

Main Menu	Sub Menu		Reference
Color	Preset	x	Customizes the color of the screen.
	• 6500K	x	
	• 9300K	x	
	Red	x	
	Green	x	
	Blue	x	
Position	Horizontal	x	Adjusts the position of the screen.
	Vertical	x	
Tracking	Clock	x	Improves the clarity and stability of the screen.
	Phase	x	
Setup	Language	x	Customizes the screen status for your operating environment.
	OSD Position	x	
	• Horizontal	x	
	• Vertical	x	
	White Balance	x	
	Power Indicator	x	
	Factory Reset	x	

x = Indicates adjustable

The OSD menu system uses icons, icon names and icon descriptions to help you select and adjust an item. View the following example of an OSD menu screen to become familiar with the selections.

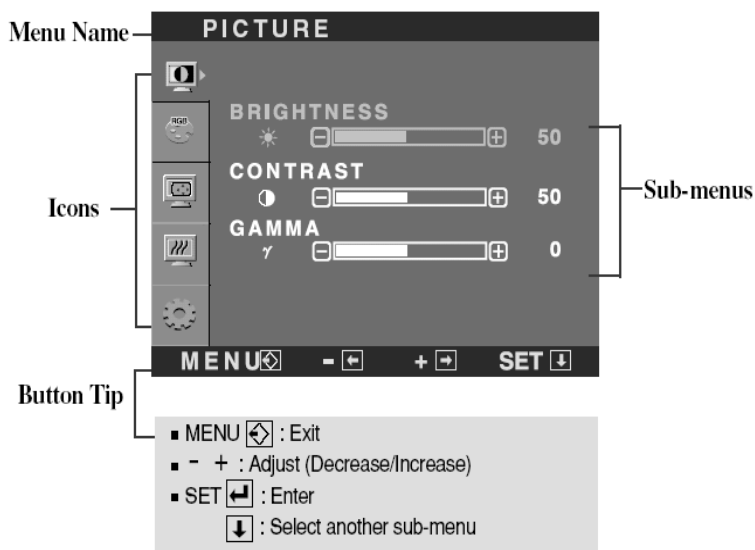

Selecting and Adjusting OSD Menus

Press the Menu button to access the OSD main menu. The following table lists the menu selections and their functions.

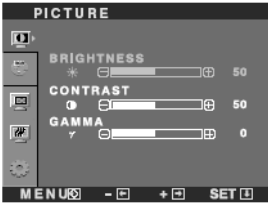
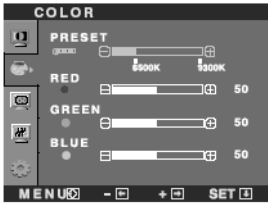
Main Menu	Sub menu	Description
<p>Picture</p>  <p>The screenshot shows the 'PICTURE' OSD menu. It has a left sidebar with icons for Picture, Input, and Audio. The main area shows four settings: BRIGHTNESS (50), CONTRAST (50), GAMMA (0), and PHASE (0). Each setting has a slider and a numeric value. At the bottom are 'MENU', 'SET', and navigation buttons.</p> <ul style="list-style-type: none"> • Menu: Exit • -: Decrease • +: Increase • Set: Select another sub-menu 	<p>Brightness</p> <p>Contrast</p> <p>Gamma</p> <p>Phase</p>	<p>To adjust the brightness of the screen</p> <p>To adjust the contrast of the screen.</p> <p>Set your own gamma value: -50/0/50. On the monitor, high gamma values display whitish images and low gamma values display high contrast images.</p>
<p>Color</p>  <p>The screenshot shows the 'COLOR' OSD menu. It has a left sidebar with icons for Picture, Input, and Audio. The main area shows four settings: PRESET (6500K), RED (50), GREEN (50), and BLUE (50). Each setting has a slider and a numeric value. At the bottom are 'MENU', 'SET', and navigation buttons.</p> <ul style="list-style-type: none"> • Menu: Exit • -: Decrease • +: Increase • Set: Select another sub-menu 	<p>Preset</p> <p>Red</p> <p>Green</p> <p>Blue</p>	<p>Select the screen color.</p> <ul style="list-style-type: none"> • 6500K: Slightly reddish white. • 9300K: Slightly bluish white. <p>Set your own red color levels.</p> <p>Set your own green color levels.</p> <p>Set your own blue color levels.</p>

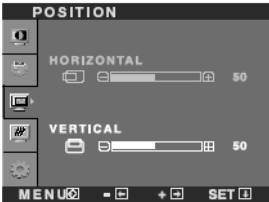
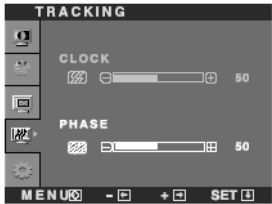
Main Menu	Sub menu	Description
<div>Position</div> <div></div>	<div>Horizontal</div> <div>Vertical</div>	<div>To move the image left and right.</div> <div>To move the image up and down.</div>
<div><ul style="list-style-type: none">• Menu: Exit• - : Decrease• + : Increase• Set: Select another sub-menu</div>		
<div>Tracking</div> <div></div>	<div>Clock</div> <div>Phase</div>	<div>To minimize any vertical bars or strips visible on the screen background. The horizontal screen image will also change.</div> <div>To adjust the focus of the display. This item allows you to remove any horizontal noise and clear or sharpen the image of characters.</div>
<div><ul style="list-style-type: none">• Menu: Exit• - : Decrease• + : Increase• Set: Select another sub-menu</div>		

Main Menu	Sub menu	Description
Setup		
	Language	To choose the language in which the control names are displayed.
	OSD Position	To adjust position of the OSD window on the screen.
	White Balance	If the output of the video card is different than the required specifications, the color level may deteriorate due to video signal distortion. Using this function, the signal level is adjusted to fit into the standard output level of the video card in order to provide the optimal image. Activate this function when white and black colors are present in the screen.
	Power Indicator	Use this function to set the power indicator on the front side of the monitor to ON or OFF. If you set OFF, it will turn off. If you set ON at any time, the power indicator will automatically be turned on.
	Factory Reset	Restore all factory default settings except Language. Press the > button to reset immediately.

- Menu: Exit
- - : Decrease
- + : Increase
- Set: Select another sub-menu

If this does not improve the screen image, restore the factory default settings. If necessary, perform the white balance function again. This function will be enabled only when the input signal is an analog signal.

Optimizing Digital Conversion

This monitor contains advanced circuitry that allows the flat panel screen to function like a standard monitor. Two controls in the on-screen display can be adjusted to improve image performance: Clock and Phase. Use these controls only when the auto-adjust function does not provide a satisfactory image.



The Clock must first be set correctly since the Phase settings are dependent on the main Clock setting.

- Clock—Increase/decrease the value to minimize any vertical bars or stripes visible on the screen background.
- Phase—Increase/decrease the value to minimize video distortion or video jitter.



When using the controls, you will obtain the best results by using the Auto-Adjustment pattern application provided on the CD.



When adjusting the Clock and Phase values, if the monitor images become distorted, continue adjusting the values until the distortion disappears. To restore the factory settings, select the Factory Reset menu in the on-screen display.

Identifying Monitor Conditions

Special messages will appear on the monitor screen when identifying the following monitor conditions:

- Out of Range— Indicates the monitor does not support the input signal because the resolution and/or refresh rate are set higher than the monitor supports. Set the resolution and refresh rate for 1280 x 1024 at 60 Hz. Restart your computer for the new settings to take effect.

- **Check Signal Cable**— Indicates the signal cable is not properly connected to the computer.
- **OSD Locked**—The OSD can be enabled or disabled by pressing and holding the Menu button on the front panel for 5 seconds. If the OSD is locked, the warning message OSD LOCKED displays for ten seconds.
 - ❑ If the OSD is locked, press and hold the Menu button for 5 seconds to unlock the OSD.
 - ❑ If the OSD is unlocked, press and hold the Menu button for 5 seconds to lock the OSD.
- **Unrecognized monitor Plug&Play (VESA DDC) monitor found**—The video card installed in the computer may not support plug and play function.

HP Display LiteSaver

HP Display LiteSaver is a software application, available on the CD, that increases monitor life and saves energy. It allows you to place your monitor into its low power sleep mode at predefined times by shutting down or reducing power to most internal circuits. This helps protect the LCD panel against image retention. Image retention can occur when the monitor is left on while displaying the same image for an extended period of time, leaving a shadow of the image on the screen.

Installing the HP Display LiteSaver Software

1. Insert the CD in the computer CD-ROM Drive. The CD menu displays.
2. Select “Install HP Display LiteSaver Software.”
3. After installing the software, click the HP Display LiteSaver icon in the Windows system tray or right-click the icon and select **Configure...** from the pop-up menu.

4. Select the following options to configure the HP Display LiteSaver features:

Configure Options	Function
Enable Display LiteSaver	Enables the HP Display LiteSaver functions; deselect to disable the HP Display LiteSaver.
Display Off	Sets the time when the monitor automatically turn off. This does not affect screen saver operation, which has priority over the HP Display LiteSaver.
Display On	Sets the time when the monitor automatically turns on. This does not affect screen saver operation, which has priority over the HP Display LiteSaver.
Activity Extension	Sets the time in minutes before the monitor turns off if there is any keyboard or mouse activity after the Display Off time is reached. If the keyboard or mouse is used, then HP Display LiteSaver waits until the set amount of time before turning the display off again. Set to 0 to disable. If disabled, the monitor will turn off as soon as the Display Off time is reached, regardless of keyboard or mouse activity.
Show 1 minute Display Off Notice	Displays a popup message in the system tray 1 minute before the monitor is turned off by HP Display LiteSaver.
Status	Shows the time until the monitor is next due to be turned off by HP Display LiteSaver.

Configure Options	Function
OK	Stores the current settings and minimizes HP Display LiteSaver to the System Tray.
Cancel	Restores the previous settings and minimizes HP Display LiteSaver to the System Tray. HP Display LiteSaver will continue to run.
Help	Opens the online help file.
Exit	Exits and closes the HP Display LiteSaver. It will no longer control the monitor power until it is next run.

View “HP Display LiteSaver Readme” on the CD for additional information on how to configure the HP Display LiteSaver.

Troubleshooting

Solving Common Problems

The following table lists possible problems, the possible cause of each problem, and the recommended solutions.

Problem	Possible Cause	Solution
Screen is blank.	Power cord is disconnected.	Connect the power cord.
	Power switch on front panel of the monitor is turned off.	Press the front panel power button.
	Video cable is improperly connected.	Connect the video cable properly. Refer to <i>Chapter 3, Setting Up the Monitor</i> , for more information.
	Screen blanking utility is active.	Press any key on the keyboard or move the mouse to inactivate the screen blanking utility.
Image appears blurred, indistinct, or too dark.	Brightness and contrast are too low.	Press the Auto/Set button on the front panel. If this does not correct the image, press the Menu button to open the OSD Menu, and adjust the brightness and contrast scales as needed.

Problem	Possible Cause	Solution
Image is not centered.	Position may need adjustment.	Press the Menu button to access the OSD menu. Select Position/ Horizontal or Vertical to adjust the horizontal or vertical position of the image.
	Display position is incorrect.	Press the Auto/Set button to automatically adjust the screen image to the ideal setting. If results are unsatisfactory, adjust the image position using the Horizontal and Vertical position icon on the screen display. Check Control Panel->Display->Settings to see if the frequency or the resolution was changed. If yes, readjust the video card to the recommended resolution.
"Check Signal Cable" is displayed on screen.	Monitor video cable is disconnected.	Connect the 15-pin monitor video cable to the VGA connector on the computer or the DVI-D signal cable to the DVI connector on the computer. Be sure that the computer power is off while connecting the video cable.

Problem	Possible Cause	Solution
"OSD LOCKED" is displayed on screen	OSD controls are secured.	Unlock the OSD controls at any time by pressing the Menu button for 5 seconds: the message OSD UNLOCKED will appear.
"Out of Range" is displayed on screen.	Video resolution and/or refresh rate are set higher than what your monitor supports.	Restart your computer and enter Safe Mode. Change your settings to 1280 x 1024 @ 60Hz or to a supported setting (see "Factory Preset Display Modes" table in Appendix B). Restart your computer so that the new settings take effect.
HP Display LiteSaver doesn't turn off the monitor screen	The Activity Extension time has not elapsed.	The default Activity Extension value is set to 10 minutes. The HP Display LiteSaver will wait to detect no input or movement from the keyboard or mouse for 10 consecutive minutes after the Display Off time has passed, before the monitor enters into low-power mode. For example, if the Display Off time is set to 5 minutes from the current time and the Activity Extension is set to 10 minutes, the HP Display LiteSaver will not actually turn off the display until 10 minutes of inactivity has elapsed, even though the Display Off time is 5 minutes from now.

Problem	Possible Cause	Solution
	<p>The HP Display LiteSaver may not be compatible with your computer system.</p> <p>Some notebook computers are not compatible and the monitor power can not be controlled.</p>	<p>Confirm that the HP Display LiteSaver is compatible with your system.</p> <ol style="list-style-type: none"> 1. Right-click on the HP Display LiteSaver icon in the system tray. 2. Select "Power Off Display" from the menu. <p>The monitor screen should turn off if the system is compatible. To turn the monitor back on, wait 5 seconds and move the mouse.</p> <p> If the monitor did not turn off, then your computer graphics driver is not compatible with the HP Display LiteSaver software.</p>

Using the Worldwide Web

For online access to technical support information, self-solve tools, online assistance, community forums of IT experts, broad multivendor knowledge base, monitoring and diagnostic tools, go to: <http://www.hp.com/support>.

Preparing to call Technical Support

If you cannot solve a problem using the troubleshooting tips in this section, you may need to call technical support. Have the following information available when you call:

- The monitor
- Monitor model number
- Serial number for the monitor
- Purchase date on invoice
- Conditions under which the problem occurred
- Error messages received
- Hardware configuration
- Hardware and software you are using

Technical Specifications



All performance specifications are provided by the component manufacturers. Performance specifications represent the highest specification of all HP's component manufacturers' typical level specifications for performance and actual performance may vary either higher or lower.

L717g Flat Panel Monitor

L717g Specifications

Display	17.0 inches	43.2 cm
----------------	-------------	---------

	Flat Panel Active matrix -TFT LCD
	Anti-Glare coating
	17 inches viewable
	0.26mm pixel pitch

Sync input

Horizontal Frequency	Analog 30 - 83kHz (automatic) Digital 30 - 71 kHz
Vertical Frequency	56 - 75Hz (automatic)
Input Form	Separate TTL, Positive/Negative SOG (Sync On Green)

L717g Specifications (Continued)

Video Input

Signal Input	15 pin D-Sub Connector or 24-pin DVI-D Connector
Input form	RGB Analog (0.7Vp-p/75 ohm)

Resolution

Max	D-sub Analog: VESA 1280 x 1024 @75Hz DVI-D Digital: VESA 1280 x 1024 @60Hz
Recommended	VESA 1280 x 1024 @ 60Hz

Plug & Play

DDC 2B

Power Consumption

On Mode	43 W
Sleep Mode	≤1 W
Off Mode	≤1 W

Dimensions and Weight (with tilt/swivel stand)

Width	14.49 inches	368 mm
Height	15.31 inches	389 mm
Depth	9.07 inches	230.4 mm
Maximum Weight (Unpacked)	10.80 lbs.	4.9 kg

Tilt/Swivel Range

Tilt	-5° ~ 20°
Swivel	350°

Input Power

AC 100-240V~ 50/60Hz 1.0A

L717g Specifications *(Continued)*

Environmental Conditions

Operating Conditions

Temperature	10° C to 35° C
Humidity	10% to 80% non-condensing

Storage Conditions

Temperature	-20° C to 60° C
Humidity	5% to 95% non-condensing

Power Cord	Wall outlet type or PC outlet type
-------------------	------------------------------------

L919g Flat Panel Monitor

L919g Specifications

Display	19.0 inches	48.18 cm
----------------	-------------	----------

Flat Panel Active matrix -TFT LCD
Anti-Glare coating
19 inches viewable
0.294mm pixel pitch

Sync input

Horizontal Frequency	Analog 30 - 83kHz (automatic) Digital 30 - 71kHz
----------------------	---

Vertical Frequency	56 - 75Hz (automatic)
--------------------	-----------------------

Input Form	Separate TTL, Positive/Negative SOG (Sync On Green)
------------	--

Video Input

Signal Input	15 pin D-Sub Connector or 24-pin DVI-D Connector
--------------	---

Input form	RGB Analog (0.7Vp-p/75 ohm)
------------	-----------------------------

Resolution

Max	D-sub Analog: VESA 1280 x 1024 @75Hz DVI-D Digital: VESA 1280 x 1024 @60Hz
-----	---

Recommended	VESA 1280 x 1024 @ 60Hz
-------------	-------------------------

Plug & Play	DDC 2B
------------------------	--------

Power Consumption

On Mode	43 W
---------	------

Sleep Mode	≤1 W
------------	------

Off Mode	≤1 W
----------	------

L919g Specifications (Continued)

Dimensions and Weight (with tilt/swivel stand)

Width	16.26 inches	413 mm
Height	16.57 inches	421 mm
Depth	9.07 inches	230.4 mm
Maximum Weight (Unpacked)	12.57 lbs.	5.7 kg

Tilt/Swivel Range

Tilt	-5° ~ 20°
Swivel	350°

Input Power	AC 100-240V~ 50/60Hz 1.0A
--------------------	---------------------------

Environmental Conditions

Operating Conditions

Temperature	10° C to 35° C
Humidity	10% to 80% non-condensing

Storage Conditions

Temperature	-20° C to 60° C
Humidity	5% to 95% non-condensing

Power Cord	Wall outlet type or PC outlet type
-------------------	------------------------------------

Recognizing Preset Display Resolutions

The display resolutions listed below are the most commonly used modes and are set as factory defaults. This monitor automatically recognizes these preset modes and they will appear properly sized and centered on the screen.

Factory Preset Display Modes			
Preset	Pixel Format	Horz Freq (kHz)	Vert Freq (Hz)
1	640 x 350	31.469	70
2	720 x 400	31.468	70
3	640 x 480	31.469	60
4	640 x 480	37.500	75
5	800 x 600	37.879	60
6	800 x 600	46.875	75
7	832 x 624	49.725	75
8	1024 x 768	48.363	60
9	1024 x 768	60.023	75
10	1152 x 870	68.681	75
11	1152 x 900	61.805	65
12	1280 x 1024	63.981	60
13	1280 x 1024	79.976	75

Entering User Modes

The video controller signal may occasionally call for a mode that is not preset if:

- You are not using a standard graphics adapter.
- You are not using a preset mode.

If this occurs, you may need to readjust the parameters of the monitor screen by using the on-screen display. Your changes can be made to any or all of these modes and saved in memory. The monitor automatically stores the new setting, then recognizes the new mode just as it does a preset mode. In addition to the 13 factory preset modes, there are four user modes that can be entered and stored.

Energy Saver Feature

When the monitor is in its normal operating mode, the monitor uses less than 45 watts of power and the Power light is green.

The monitor also supports a reduced power state. The reduced power state will be entered into if the monitor detects the absence of either the horizontal sync signal and/or the vertical sync signal. Upon detecting the absence of these signals, the monitor screen is blanked, the backlight is turned off, and the Power light is turned amber. When the monitor is in the reduced power state, the monitor will utilize less than 1 watt of power. There is a brief warm up period before the monitor will return to its normal operating mode.

Refer to your computer manual for instructions on setting energy saver features (sometimes called power management features).



The above energy saver feature only works when connected to computers that have energy saver features.

By selecting settings in the monitor's Energy Saver utility, you can also program the monitor to enter into the reduced power state at a predetermined time. When the monitor's Energy Saver utility causes the monitor to enter the reduced power state, the Power light turns amber.

Power Light Indicators

Mode	LED Color
On Mode	Green
Sleep Mode	Amber
Off Mode	Off

Agency Regulatory Notices

Federal Communications Commission Notice

This equipment has been tested and found to comply with the limits for a Class B digital device, pursuant to Part 15 of the FCC Rules. These limits are designed to provide reasonable protection against harmful interference in a residential installation. This equipment generates, uses, and can radiate radio frequency energy and, if not installed and used in accordance with the instructions, may cause harmful interference to radio communications. However, there is no guarantee that interference will not occur in a particular installation. If this equipment does cause harmful interference to radio or television reception, which can be determined by turning the equipment off and on, the user is encouraged to try to correct the interference by one or more of the following measures:

- Reorient or relocate the receiving antenna.
- Increase the separation between the equipment and the receiver.
- Connect the equipment into an outlet on a circuit different from that to which the receiver is connected.
- Consult the dealer or an experienced radio or television technician for help.

Modifications

The FCC requires the user to be notified that any changes or modifications made to this device that are not expressly approved by Hewlett Packard Company may void the user's authority to operate the equipment.

Cables

Connections to this device must be made with shielded cables with metallic RFI/EMI connector hoods to maintain compliance with FCC Rules and Regulations.

Declaration of Conformity for Products Marked with the FCC Logo (United States Only)

This device complies with Part 15 of the FCC Rules. Operation is subject to the following two conditions: (1) this device may not cause harmful interference, and (2) this device must accept any interference received, including interference that may cause undesired operation.

For questions regarding your product, contact:

Hewlett Packard Company
P.O. Box 692000, Mail Stop 530113
Houston, Texas 77269-2000

Or, call 1-800-HP-INVENT (1-800-474-6836)

For questions regarding this FCC declaration, contact:

Dept. of Product Safety & Compliance
LG Electronics U.S.A. Inc.
2000 Millbrook Dr.
Lincolnshire, Illinois 60069, U.S.A.

Or, call 1-847-941-8373

To identify this product, refer to the Part, Series, or Model number found on the product.

Materials Disposal

This HP product contains the following materials that might require special handling at end-of-life:

- Mercury in the fluorescent lamp in the display LCD.
- Lead in the solder and some component leads.

Disposal of this material can be regulated because of environmental considerations. For disposal or recycling information, contact your local authorities or the Electronic Industries Alliance (EIA) (www.eiae.org).

Canadian Notice

This Class B digital apparatus meets all requirements of the Canadian Interference-Causing Equipment Regulations.

Avis Canadien

Cet appareil numérique de la classe B respecte toutes les exigences du Règlement sur le matériel brouilleur du Canada.

Disposal of Waste Equipment by Users in Private Household in the European Union



This symbol on the product or on its packaging indicates that this product must not be disposed of with your other household waste. Instead, it is your responsibility to dispose of your waste equipment by handing it over to a designated collection point for the recycling of waste electrical and electronic equipment. The separate collection and recycling of your waste equipment at the time of disposal will help to conserve natural resources and ensure that it is recycled in a manner that protects human health and the environment. For more information about where you can drop off your waste equipment for recycling, please contact your local city office, your household waste disposal service or the shop where you purchased the product.

ENERGY STAR Compliance

Monitors that are marked with the ENERGY STAR Logo meet the requirements of the U.S. Environmental Protection Agency (EPA) ENERGY STAR program. As an ENERGY STAR Partner, Hewlett Packard Company has determined that this product meets the ENERGY STAR guidelines for energy efficiency. Specific details on using the Energy Saving features can be found in the energy saver or power management section of the computer manual.

Power Cord Set Requirements

The monitor power supply is provided with Automatic Line Switching (ALS). This feature allows the monitor to operate on input voltages between 100-120V or 200-240V.

The power cord set (flexible cord or wall plug) received with the monitor meets the requirements for use in the country where you purchased the equipment.

If you need to obtain a power cord for a different country, you should purchase a power cord that is approved for use in that country.

The power cord must be rated for the product and for the voltage and current marked on the product's electrical ratings label. The voltage and current rating of the cord should be greater than the voltage and current rating marked on the product. In addition, the cross-sectional area of the wire must be a minimum of 0.75 mm² or 18AWG, and the length of the cord must be between 6 feet (1.8 m) and 12 feet (3.6 m). If you have questions about the type of power cord to use, contact your HP authorized service provider.

A power cord should be routed so that it is not likely to be walked on or pinched by items placed upon it or against it. Particular attention should be paid to the plug, electrical outlet, and the point where the cord exits from the product.

LCD Monitor Quality and Pixel Policy

The TFT monitor uses high-precision technology, manufactured according to HP standards, to guarantee trouble-free performance. Nevertheless, the display may have cosmetic imperfections that appear as small bright or dark spots. This is common to all LCD displays used in products supplied by all vendors and is not specific to the HP LCD. These imperfections are caused by one or more defective pixels or sub-pixels.

- A pixel consists of one red, one green, and one blue sub-pixel.
- A defective whole pixel is always turned on (a bright spot on a dark background), or it is always off (a dark spot on a bright background). The first is the more visible of the two.
- A defective sub-pixel (dot defect) is less visible than a defective whole pixel and is small and only visible on a specific background.

The HP display does not have more than:

- 3 bright dots.
- 5 dark dots.
- 5 total bright and dark dots.
- No more than two adjacent (less than 2.5 mm edge-to-edge) defective pixels.

To locate defective pixels, the monitor should be viewed under normal operating conditions, in normal operating mode at a supported resolution and refresh rate, from a distance of approximately 50 cm (16 in.).

HP expects that, over time, the industry will continue to improve its ability to produce LCDs with fewer cosmetic imperfections and HP will adjust guidelines as improvements are made.