



VT3 Vaportite

Gasketed Enclosure

EN-SEAL™ gasketing offers unprecedented resistance to water absorption

GASKETED ENCLOSURE

VT3

VAPORTITE

Features

- Impact resistant lens with linear prism
- Wet location rated
- En-Seal™ continuous gasketing
- Reinforced FRP housing
- Galvanized steel mounting brackets
- Watertight hubs at each end accept 1/2" conduit

Improved Lens Geometry

- Redesigned corners for added durability
- Better light output
- Improved light distribution
- Linear ribs control lamp image

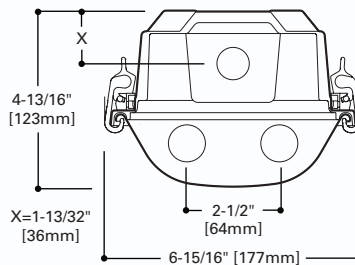

Applications

- Commercial Kitchens
- Parking Garages
- Car Washes
- Schools
- Government Facilities
- Industrial Facilities
- Public Areas
- Gas Stations
- Subways

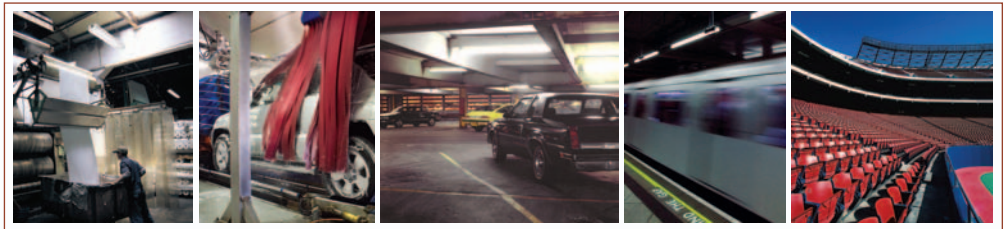

Mounting

- Optional Spring Mount Bracket (stainless steel)
 - Simple installation
 - Bracket installs first, then fixture snaps securely into place
- Brass Mounting Stud - used with steel mounting brackets



Lenses

- Acrylic DR Extreme (best) 100%
- DR Acrylic High Impact (better) 50%
- DR Acrylic Impact Resistant (good) 15%

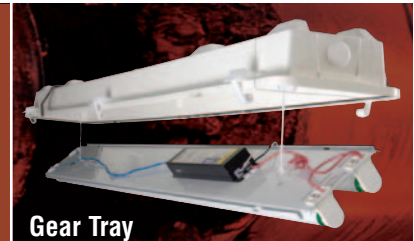

Gear Tray

- Less Steel
- Faster Assembly
- Simplified Service



Photometrics

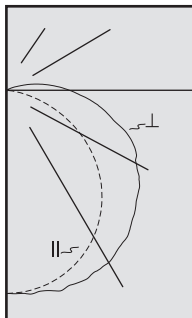

VT3-232DR-UNV-EB81-WL-U
 (1) Electronic Ballasts
 (2) 32W T8 lamps
 2850 lumens
 Spacing criterion:
 (II) 1.3 x mounting
 height, (⊥) 1.5 x
 mounting height
 Efficiency 77.4%
 Test Report:
 LTL10864.IES
 LER =72
 Yearly Cost of 1000
 lumens, 3000 hrs at
 .08 KWH = \$3.34

Candela

Angle	Along II	45°	Across ⊥
0	1103	1103	1103
5	1097	1108	1107
10	1083	1107	1106
15	1059	1091	1127
20	1025	1089	1113
25	983	1058	1098
30	932	1035	1088
35	870	991	1052
40	801	952	1024
45	725	892	971
50	640	831	920
55	548	753	878
60	451	683	814
65	352	611	771
70	251	550	698
75	155	471	592
80	77	367	513
85	28	290	427
90	6	217	342

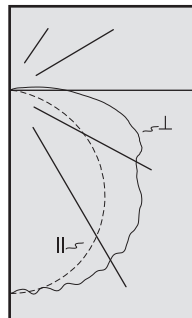

VT3-254DR-UNV-EHT1-WL-U
 (1) Electronic Ballasts
 (2) 54W T5 lamps
 4400 lumens
 Spacing criterion:
 (II) 1.2 x mounting
 height, (⊥) 1.5 x
 mounting height
 Efficiency 69.7%
 Test Report:
 LTL10777.IES
 LER =59
 Yearly Cost of 1000
 lumens, 3000 hrs at
 .08 KWH = \$4.05

Candela

Angle	Along II	45°	Across ⊥
0	1546	1546	1546
5	1540	1525	1533
10	1519	1548	1525
15	1483	1514	1546
20	1436	1509	1566
25	1375	1487	1530
30	1300	1446	1509
35	1215	1396	1502
40	1118	1315	1425
45	1012	1267	1384
50	896	1174	1308
55	770	1081	1179
60	634	954	1107
65	496	827	1101
70	352	771	1044
75	219	704	936
80	113	578	807
85	47	432	614
90	13	285	431

Coefficients of Utilization

rc	Effective floor cavity reflectance																				
	80%						70%						50%						20%		
	70	50	30	10	70	50	30	10	50	30	10	50	30	10	50	30	10	50	30	10	0
0	91	91	91	91	89	89	89	89	84	84	84	79	79	79	75	75	75	73			
1	82	78	74	70	79	75	72	69	71	68	66	67	65	63	64	62	60	58			
2	74	67	61	56	71	65	60	55	61	57	53	58	54	51	55	52	49	47			
3	67	58	52	46	65	57	51	46	54	49	44	51	47	43	49	45	42	40			
4	61	51	44	39	59	50	43	38	48	42	37	45	40	36	43	39	35	33			
5	56	45	38	32	54	44	37	32	42	36	31	40	34	30	38	33	30	28			
6	51	40	33	28	49	39	32	27	37	31	27	36	30	26	34	29	26	24			
7	47	36	29	24	45	35	28	23	33	27	23	32	27	23	30	26	22	20			
8	43	32	25	20	42	31	25	20	30	24	20	29	23	19	27	23	19	17			
9	40	29	22	17	38	28	22	17	27	21	17	26	20	17	25	20	16	15			
10	37	26	20	15	36	26	19	15	24	19	15	23	18	15	22	18	14	13			

Coefficients of Utilization

rc	Effective floor cavity reflectance																				
	80%						70%						50%						20%		
	70	50	30	10	70	50	30	10	50	30	10	50	30	10	50	30	10	50	30	10	0
0	82	82	82	82	80	80	80	80	76	76	76	72	72	72	69	69	69	67			
1	74	70	66	63	72	68	65	62	65	62	59	61	59	57	58	57	55	53			
2	66	60	55	50	64	58	54	49	55	51	48	53	49	46	50	47	45	43			
3	60	52	46	41	58	51	45	41	49	44	40	46	42	39	44	41	38	36			
4	55	46	40	35	53	45	39	34	43	38	33	41	36	33	39	35	32	30			
5	50	40	34	29	48	40	33	29	38	32	28	36	31	27	34	30	27	25			
6	46	36	29	25	44	35	29	24	34	28	24	32	27	24	31	26	23	22			
7	42	32	26	21	41	32	25	21	30	25	21	29	24	20	28	23	20	18			
8	39	29	23	18	38	28	22	18	27	22	18	26	21	17	25	20	17	16			
9	36	26	20	16	35	25	19	15	24	19	15	23	18	15	22	18	15	13			
10	33	23	18	14	32	23	17	14	22	17	13	21	17	13	20	16	13	12			

Zonal Lumen Summary

Zone	Lumens	%Lamp	%Fixture
0-30	899	15.8	20.4
0-40	1512	26.5	34.3
0-60	2847	49.9	64.5
0-90	4169	73.1	94.5
0-180	4413	77.4	100.0

Luminaire Data

Angle in Deg	Average 0-Deg cd/sm	Average 45-Deg cd/sm	Average 90-Deg cd/sm
45	5519	7213	7212
55	5083	6756	7098
65	4347	6377	7074
75	3001	6097	6510
85	1349	5151	6092

Zonal Lumen Summary

Zone	Lumens	%Lamp	%Fixture
0-30	1253	14.2	20.4
0-40	2112	24.0	34.4
0-60	3985	45.3	64.9
0-90	5908	67.1	96.3
0-180	6137	69.7	100.0

Luminaire Data

Angle in Deg	Average 0-Deg cd/sm	Average 45-Deg cd/sm	Average 90-Deg cd/sm
45	7704	10245	10279
55	7142	9700	9531
65	6126	8631	10102
75	4240	9114	10293
85	2265	7674	8760

Ordering Information

SAMPLE NUMBER: VT3-232DR-UNV-EB81-WL-U

VT3

Tandem
Blank= 4' Length
8T=8' Length

Series
VT3=Vaportite

Number of Lamps³
1, 2 or 3 Lamps
(Not included)

Wattage (Length)
32=32W T8 (48")
28T5=28W T5 (48")
54T5=54W T5HO (48")⁵

Lens
DR=Internal Prismatic Lens/15% DR High Impact Additive (Standard)
DR-50=50% High Impact Additive (High Impact)
DR-100=100% High Impact Additive (Extreme)

Voltage¹
120V=120 Volt
277V=277 Volt
347V=347 Volt
UNV=Universal Voltage
120/277²
UNC=Universal Voltage
347/480

GL=Single Element Fuse
GM=Double Element Fuse
EL=Emergency Installed

Ballast Type¹
EB8 =T8 Electronic Instant Start.
Total Harmonic Distortion < 10%
No. of Ballast
1 or 2

EB8 /PLUS= T8 Electronic Instant Start.
High Ballast Factor >1.13.
Total Harmonic Distortion < 20%
No. of Ballast
1 or 2

ER8 =T8 Electronic Program Rapid Start.
Total Harmonic Distortion < 10%
No. of Ballast
1 or 2

EBT =T5 Linear Electronic Program Rapid Start.⁴
Total Harmonic Distortion < 10%
No. of Ballast
1 or 2

EHT =T5 Linear Electronic Start High Ambient.⁵
Total Harmonic Distortion < 10%
No. of Ballast
1 or 2

WL=Wet Label

Packaging
U=Unit Pack

Options
8L=8 Latches (IP67 Rating)
M4=Miro 4 Interior Reflector
RIF1=Radio Interference Suppressor
TH=(2) Top Watertite Hubs only, no End Hubs
TEH=(2) Top & (2) End Watertite Hubs (all Watertite Hubs have 1/2" Conduit Entry)
SSL=Stainless Steel Latches

Accessories (order separately)
VT2-Chain/Set-U=Chain Hanging Set
Includes 6 ft. of chain, 4 large S-Hooks and 4 small S-Hooks
Order One (1) Kit for each 4' Fixture
Two (2) Kits Recommended For 8' Fixtures.
VT2-SS-MBK=Stainless Steel Mounting Bracket

NOTES:

¹ Products also available in non-US voltages and frequencies for international markets.
² Not available when specifying emergencies, voltage must be specific.
³ 3-lamp only available for 32W T8 lamps.
⁴ EBT ballast option applies to 28W T5 only.
⁵ 54W T5HO must use EHT ballast option. 8 ft. 54W T5HO must use (2) EHT ballasts.

For complete product data, reference the Fluorescent Specification binder. Specifications & dimensions subject to change without notice. Consult your Cooper Lighting Representative for availability and ordering information.



Cooper Lighting

Customer First Center
1121 Highway 74 South
Peachtree City, GA 30269

P: 770-486-4800
F: 770-486-4801

www.cooperlighting.com

International Sales, USA

Cooper Lighting
1121 Highway 74 South
Peachtree City, GA 30269

P: 770-486-4800
F: 770-486-4801

Canada

Cooper Lighting
5925 McLaughlin Road
Mississauga, Ontario L5R 1B8

P: 905-507-4000
F: 905-568-7049

The Cooper Lighting Family

Halo
Metalux
Lumark
Sure-Lites
Neo-Ray
Corelite
Portfolio
Iris
Shaper
io
Lumière
Invue
McGraw-Edison
Streetworks
Fail-Safe
MWS
DLS
RSA
Ametrix

Domestic Facilities

Cranbury, New Jersey
Elk Grove Village, Illinois
Irving, Texas
Ontario, California
Peachtree City, Georgia

Canadian Facilities

Calgary, Alberta T2E 7V9
Chomedey, Laval P.Q.

Metalux is a valuable trademark of Cooper Industries in the United States and other countries.
You are not permitted to use the Cooper Trademarks without the prior written consent of Cooper Industries.

Cooper Industries, Ltd.
600 Travis, Ste. 5800
Houston, TX 77002-1001
P: 713-209-8400
www.cooperindustries.com