

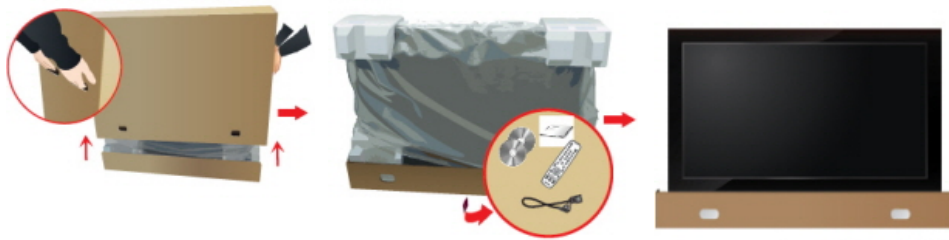

PDP DISPLAY

quick start guide

P50HP ,P50FP ,P63FP

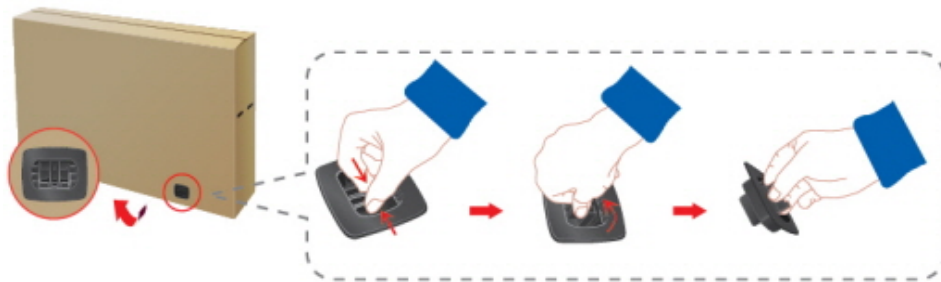

 Note

-
-



PDP Display



(AAA X 2)



D-Sub

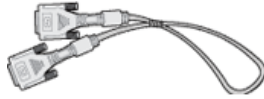

DVI

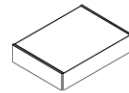

KIT

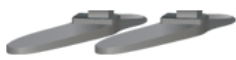

(P50HP ,P50FP
.)



BNC



BNC to RCA

()



•

•

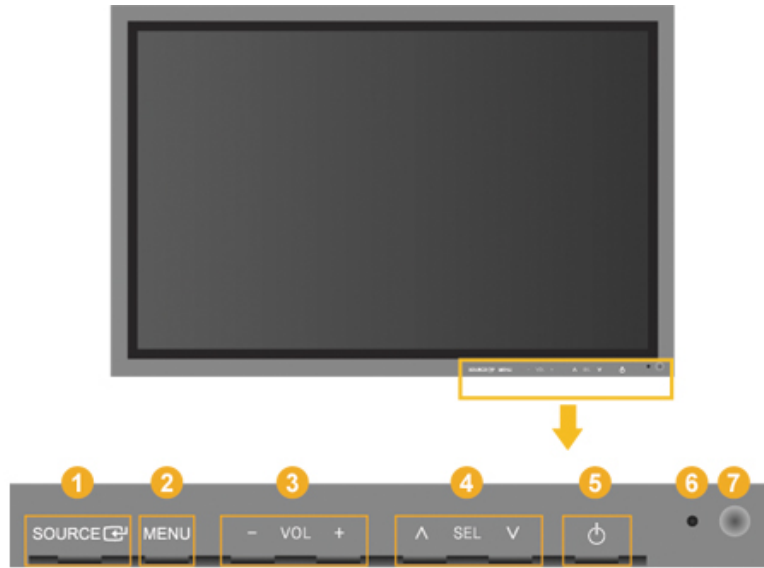

① SOURCE [SOURCE]

[PC] → [DVI] → [외부입력] → [HDMI] → [컴포넌트] → [BNC]

Enter [Enter]

② MENU [MENU]

③ - VOL+

④ ^ SEL v

⑤ [Power]

⑥



7

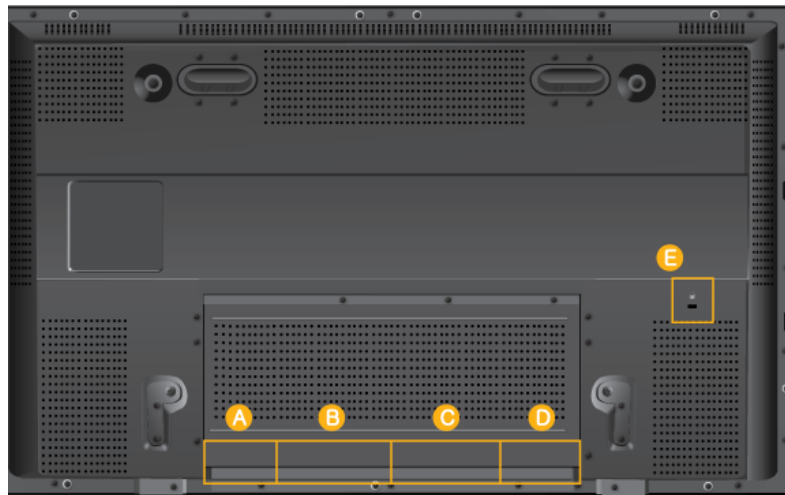

A

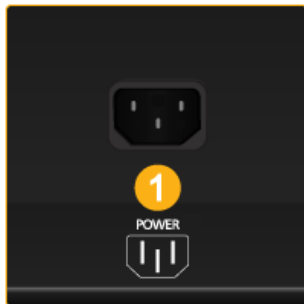

1 POWER IN

B

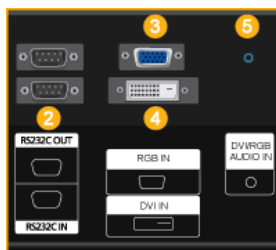

2 RS232C OUT/IN(RS232C) /

MDC(Multiple Display Control) /

3 RGB IN (PC)

D-SUB [RGB] PC
RGB .

4 DVI IN (PC)

DVI [DVI] PC
DVI .

5 DVI / PC / HDMI IN [DVI / PC / HDMI AUDIO IN] (DVI / PC / HDMI ())

[DVI / PC / HDMI AUDIO IN] PC

C

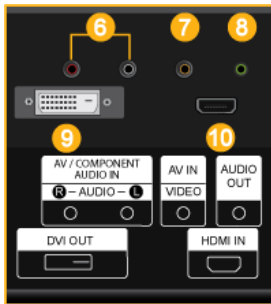

6 AV / COMPONENT AUDIO IN [L- AUDIO - R] ([L-AUDIO-R]

7 AV IN [VIDEO]

VIDEO [VIDEO]

8 AUDIO OUT ()

9 DVI OUT

DVI

10 PDP

10 HDMI IN

HDMI HDMI HDMI
HDMI .

D

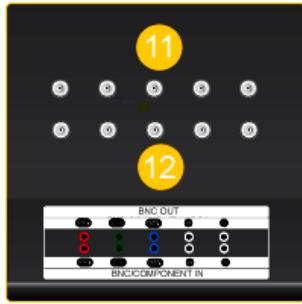

11 BNC OUT [R/PR, G/Y, B/PB, H, V] (BNC)

BNC (PC) : R, G, B, H, V

12 BNC/COMPONENT IN [R/PR, G/Y, B/PB, H, V] (BNC /)

E

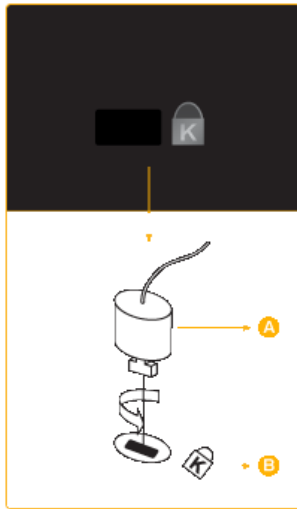

1.



2.

3.



()

TV

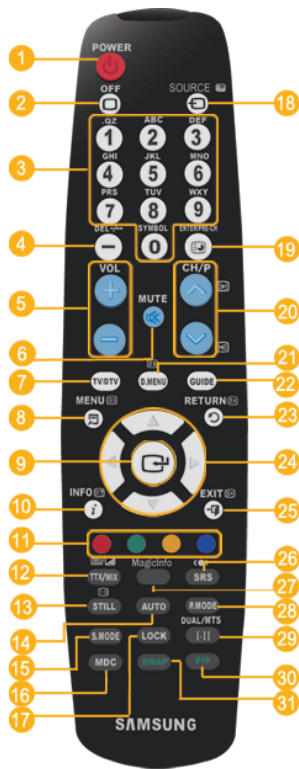

- 1 POWER
- 2 OFF
- 3
- 4 DEL
- 5 + VOL -
- 6 MUTE
- 7 TV/DTV
- 8 MENU
- 9 INFO
- 10 INFO
- 11
- 12 TTX/MIX
- 13 STILL
- 14 AUTO
- 15 S.MODE
- 16 MDC
- 17 LOCK
- 18 SOURCE
- 19 ENTER/PRE-CH
- 20 CH/P
- 21 D.MENU
- 22 GUIDE
- 23 RETURN
- 24 Up-Down Left-Right buttons
- 25 EXIT
- 26 SRS
- 27 MagicInfo
- 28 P.MODE
- 29 DUAL/MTS
- 30 *PIP*
- 31 *SWAP*

- 1. POWER
- 2. Off
- 3.

4. DEL  "-") DTV DTV MMS(

5. + VOL -

6.  MUTE 가

7. TV/DTV (+) 가

8.  MENU TV

9. 

10. *i* INFO 가

11.

12.  TTX/MIX TV

- Teletext

 , , , , , , , ,

13. STILL

14. AUTO PC

15. S.MODE 가 가 가 가 ()

16. MDC MDC 가

17. LOCK LOCK

18.  SOURCE TV/

19.  ENTER/PRE-CH

20.  VCH/PA TV

21. D.MENU DTV

22. GUIDE 가

23.  RETURN

24.

25. →  EXIT

26.  SRS

SRS

27. MagicInfo

MagicInfo 가

28. P.MODE

가

/HDMI /TV : P.MODE

4가 가
가

()

PC / DVI / MagicInfo: M/B (MagicBright)

MagicBright , PC

가
가 ()

29.  DUAL/MTS

DUAL-

TV DUAL
STEREO/MONO, DUAL 1 / DUAL II, MONO/NICAM
MONO/NICAM STEREO

MTS-

MTS (Multichannel Television Stereo)

			MTS/S_Mode		
FM	Mono		Mono		
	Stereo		Mono	Stereo	
	SAP		Mono	SAP	Mono

30. PIP

31. SWAP

가 PIP
가 PIP

Mechanical Layout (P50HP, P50FP)

Mechanical Layout



DVD, VCR

AV

가

AV

가

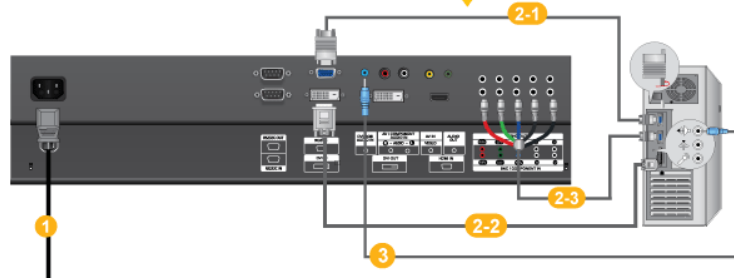
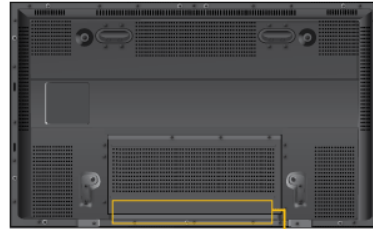

1

220V

110V

2

2가

2가

가

2-1

D-Sub()

• D-Sub

RGB

D-Sub



2-2

DVI()

• DVI

DVI

DVI



2-3

BNC()

• BNC

BNC/COMPONENT IN - R, G, B, H, V

D-Sub

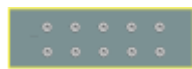

3



-
- DVI
-



DVD, VCR

AV

가

AV

가

AV

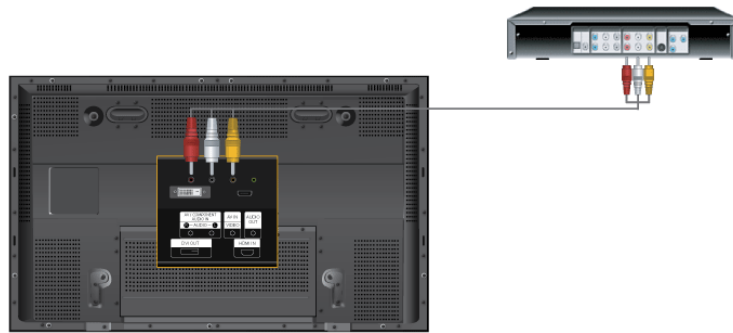

1

DVD, VCR
[R-AUDIO-L]

2

DVD, VCR

DVD

3

SOURCE

DVD, VCR

가

"



DVD, VCR

AV

가

AV

가

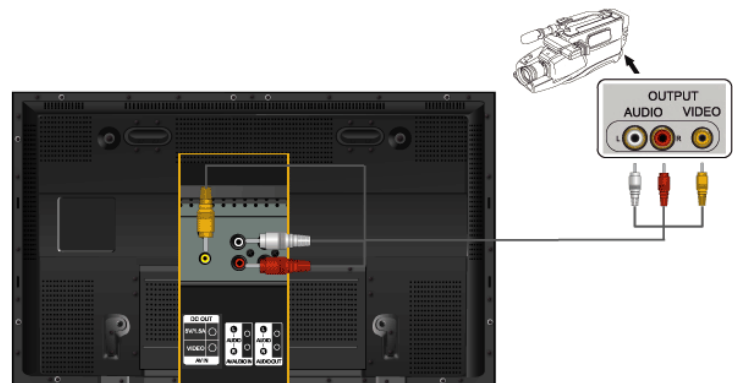

1. AV AV/COMPONENT AUDIO IN [L-AUDIO-R]

2. AV IN [VIDEO]

3. 'SOURCE' 'Source'

4.



가 .(

DVD

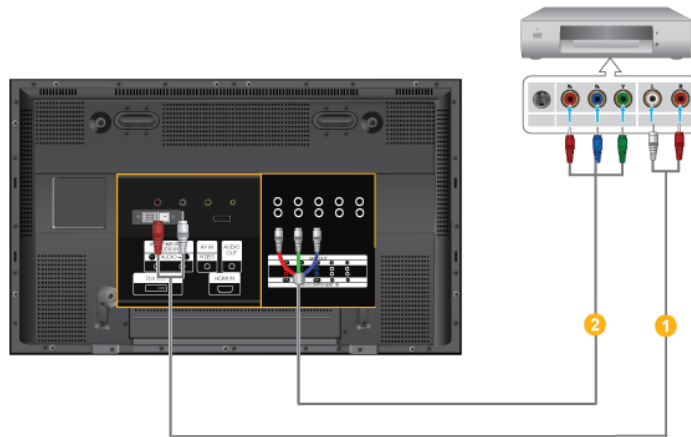

1. AV/COMPONENT AUDIO IN [L-AUDIO-R] DVD

2. BNC / COMPONENT IN - P_R , Y , P_B port



• 'SOURCE'

• DVD



•

DVD

DTV



•

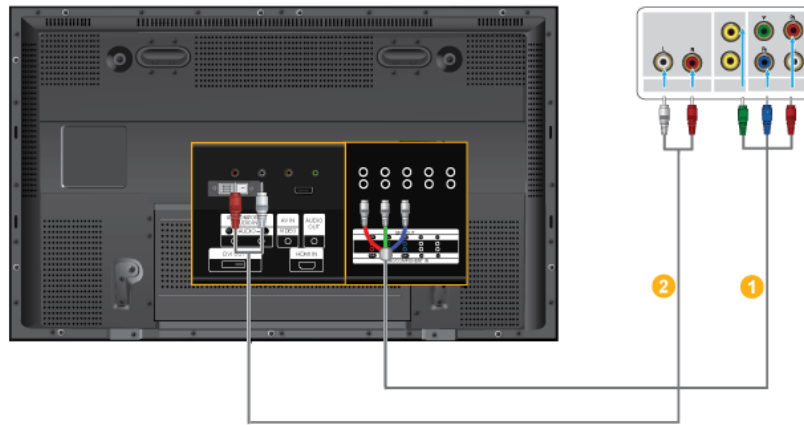

1. BNC / COMPONENT IN - P_R, Y, P_B P_R, Y, P_B

2. AV/COMPONENT AUDIO IN [L-AUDIO-R]



• 'SOURCE'



•

HDMI

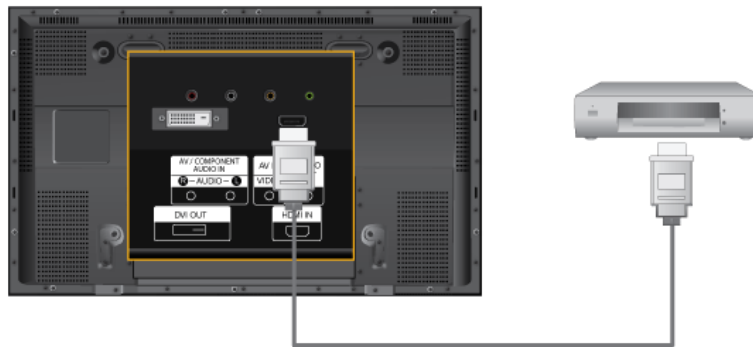

• HDMI HDMI [HDMI IN]

• [HDMI] PC

DVI

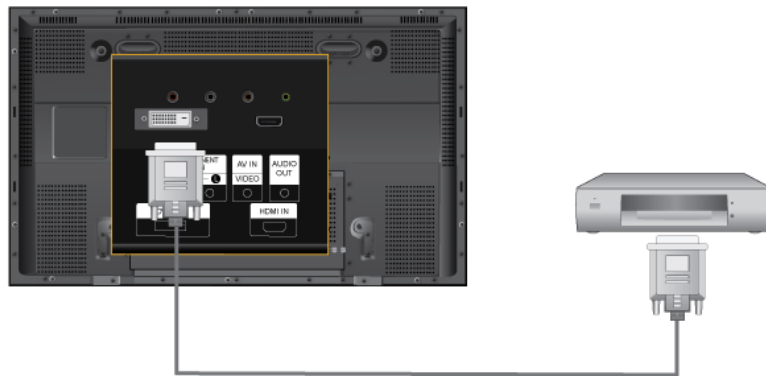

- DVI DVI PDP DVI IN
- Source -> Edit Name Menu DVI AV



- AUX L, R AUDIO OUT



, 가 . 가

, 가

- 1.
- 2.
- 3.

가 ()

LED



- 4.

1360 x 768(1980 x 1080)
가 1

가

. 85Hz

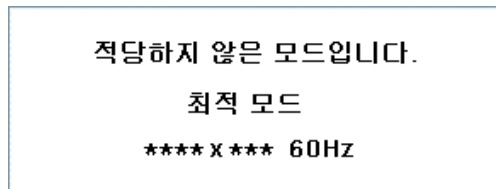

가

>

- 1)



• ,
 • . ()

2)

()



• , ,
 (.)
 •

/



PC

PC

가

1

1.

2.

3

(" " 가 3 .)

3.

PC

()

4.

50Hz ~ 85Hz

(, 60Hz .)

5.

" " " " ()



•

(PC)



Q:

A:

()



Q:

A:

()

Q: " " 가

A:

()

A:

Q: " " 가

A: 가

A:

Q:

A:

()

Q:

A:

A: ()

A:

Q:

A: 가 가
가

Q: 가

A: 가 가
가

Q:

A:

(,)

Q:

A:

Q:

A:

Q:

A:

Q:

0.5 1

A: 가

Q:

A: MENU

"TEST GOOD"



Q: 가

A:

()

A:

Q: 가

A:

A: 가

Q: 가

A:



Q:

A: +/- 가 ?

A: 가 ?

A: 가 ?

A: 가 ?

A: ?

MagicInfo



가 USB Flash Disk .

Q: 가 USB Flash Disk

A: 1) 512Mb USB USB Bootable Disk TOOL 가 USB
Disk . () : HP USB Disk Storage Format Tool)

A: 2) USB Disk OS .

A: 3) CMOS Setup 가 USB Booting 가
"Usb Boot First" Enable .

A: 4) USB Disk set power on USB .

A: 5) c:\ghost Local Partition From Image USB Disk
.

A: 6) 가 .

Q: ?

A:

. (.)

Q: ?

A: Windows XP:
Set the resolution in the .

A: Windows ME/2000:

* .

Q: ?

A: Windows XP:
Set the resolution in the

BIOS SETUP . (Windows/)

A: Windows ME/2000:

BIOS SETUP

. (Windows/)

Q: /PDP ?

A:

, PDP
가

가

Q:

?

A: Movie
MPEG1

WMV, MPEG1

가

.(

) ,

. WMV,



,
가

. 가

.