

## INSTALL INSTRUCTIONS C-TCB-14 UNIVERSAL TELESCOPING COMPUTER BASE

**TOOLS REQUIRED:**

3/16" Allen wrench  
Ratcheting Wrench  
Standard Socket Set

Powered Drill (if necessary)  
Drill Bit Set (if necessary)

**HARDWARE:**

<u>QTY</u>	<u>DESCRIPTION</u>	<u>PART #</u>
1	Pole support assembly	CM93071-14W
1	Telescoping pole assembly	CM93072-14
4	1/4-20 Nylock nut	GSM30016
4	1/4" Flat washer	GSM31005
4	1/4 - 20 x 1/2" Hex head bolt	GSM33000

**Always!**

- Read all instructions before installing any Havis-Shields Equipment Corp products.
- Check for obstructions (Wire, brake lines, fuel tank, etc.) before drilling any holes!
- Use hardware provided with install kit

**SUB ASSEMBLY:**

1. Confirm receipt of all hardware and components.
2. C-TCB-14 offers multiple mounting options.
  - a. Havis Shields extruded Trak Mount
  - b. Any flat surface with access to bolt.
3. Mounting option to be determined by installer.

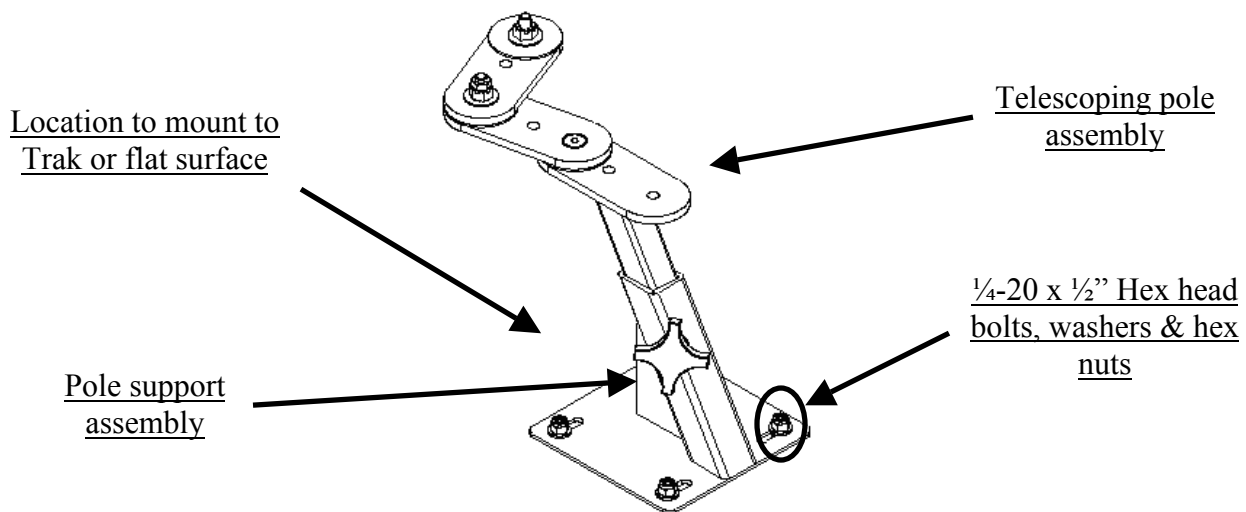

## **INSTALLATION:**

### **1. Mount C-TCB-14 to Havis-Shields Trak Mount:**

- Mount console, transmission hump bracket(s), and Trak mount being sure to leave room for C-TCB-14
- Slide (4) ¼-20 x ½” Hex head bolts, (2) in each rail.
- Place Pole support assembly so slots line up with hex head bolts on Trak mount.
- Secure with ¼” Flat washers and nylock nuts.
- Attach optional C-3090 Computer mounting platform to Telescoping pole assembly.

*Note: It is recommended to leave all components loose on Trak until exact positioning is determined.*

### **2. Mount C-TCB-14 to flat surface:**

- Exact location to be determined by installer.
- Position C-TCB-14 on floor or other flat surface in vehicle.
- Mark and drill ¼” holes.
- Bolt using ¼-20 x ½” Hex head bolts, washers and nylock nuts.
- Attach optional C-3090 Computer mounting platform to Telescoping pole assembly.