

***BOSE***<sup>®</sup>

Setup Guide

Guía de instalación

Guide d'installation



**VIDEOWAVE<sup>™</sup> ENTERTAINMENT SYSTEM**

# SAFETY INFORMATION

## Please read this guide

Please take the time to follow the instructions in this setup guide carefully. They will help you set up and operate your system properly and enjoy its advanced features. Please save all safety and operating instructions, including this guide, for future reference.

All Bose products must be used in accordance with local, state, federal, and industry standards.

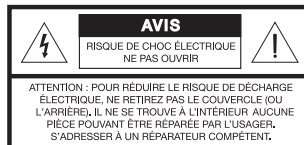
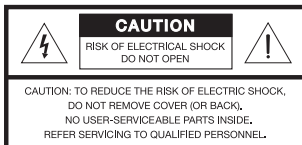

 The lightning flash with arrowhead symbol within an equilateral triangle alerts the user to the presence of uninsulated, dangerous voltage within the system enclosure that may be of sufficient magnitude to constitute a risk of electric shock.

 The exclamation point within an equilateral triangle alerts the user to the presence of important operating and maintenance instructions in this guide.

## WARNINGS:

- To reduce the risk of fire or electrical shock, do not expose the product to rain or moisture.
- Do not expose this apparatus to dripping or splashing, and do not place objects filled with liquids, such as vases, on or near the apparatus. As with any electronic products, use care not to spill liquids into any part of the system. Liquids can cause a failure and/or a fire hazard.

- Do not place any naked flame sources, such as lighted candles, on or near the apparatus.
- Keep the remote control batteries away from children. They may cause a fire or chemical burn if mishandled. Do not recharge, disassemble, heat above 100°C (212°F), or incinerate. Dispose of used batteries promptly. Replace only with batteries of the correct type and model number.



Please dispose of used batteries properly, following any local regulations. Do not incinerate.

- Contains small parts that may be a choking hazard. Not suitable for children under age 3.



- Never place the equipment on an unstable surface. The equipment may fall, causing serious personal injury or death. Many injuries, particularly to children, can be avoided by taking simple precautions such as:
  - Only using furniture that can safely support the equipment.
  - Ensuring the equipment is not overhanging the edge of the supporting furniture.
  - Not placing the equipment on furniture (for example, cupboards or bookcases) without appropriately anchoring both the furniture and the equipment to a wall.
  - Not placing toys or other items on top of the equipment.
  - Not standing the equipment on cloth or other materials placed between the equipment and supporting furniture.
  - Educating children about the dangers of playing with the equipment and climbing on furniture to reach the equipment.

- *Allowing children to push, pull, or climb on the monitor may cause it to tip over, possibly resulting in personal injury or death.*
  - *For safety and greater stability, installation of the included anti-tip straps is recommended.*
  - *Be sure to install both anti-tip straps according to the instructions on page 10.*
- *If wall-mounting the monitor, follow the wall bracket manufacturer's instructions and the guidelines provided here and on page 12. Unsafe mounting of any heavy load can result in serious injury and property damage.*
  - *Use only an agency-approved wall-mount bracket capable of supporting a 110 lbs. (49.9 kg) product.*
  - *Make sure the wall bracket is installed according to all applicable building codes.*
  - *If you doubt your ability to safely wall-mount this product, contact a professional installer for help.*
- *Long-term exposure to loud audio may cause hearing damage. It is best to avoid extreme volume when using the system with or without headphones, especially for extended periods.*

**CAUTIONS:**

- *Make no modifications to the system or accessories. Unauthorized alterations may compromise safety, regulatory compliance, and system performance, and may void the warranty.*
- *Due to ventilation requirements, do not place the monitor in a confined space such as in a wall cavity or in an enclosed cabinet.*
- *Do not block any of the ventilation openings on the rear panel of the monitor. These openings provide the necessary ventilation to ensure reliable operation and to prevent overheating.*
- *Do not place the monitor near or over a source of heat, such as a fireplace, or in direct sunlight.*

**Notes:**

- Where the mains plug or appliance coupler is used as the disconnect device, such disconnect device shall remain readily operable.
- The product must be used indoors. It is neither designed nor tested for use outdoors, in recreation vehicles, or on boats.
- This product is intended to be used only with the power supply provided.
- Product labels are located on the bottom of the control console, on the back of the monitor, and inside the battery compartment door of the remote control.

**IMPORTANT SAFETY INSTRUCTIONS**

1. Read these instructions.
2. Keep these instructions.
3. Heed all warnings.
4. Follow all instructions.
5. Do not use this apparatus near water.
6. Clean only with a dry cloth.
7. Do not block any ventilation openings. Install in accordance with the manufacturer's instructions.
8. Do not install near any heat sources such as radiators, heat registers, stoves, or other apparatus (including amplifiers) that produce heat.
9. Protect the power cord from being walked on or pinched particularly at plugs, convenience receptacles, and the point where they exit from the apparatus.
10. Only use attachments/accessories specified by the manufacturer.
11. Unplug this apparatus during lightning storms or when unused for long periods of time.
12. Refer all servicing to qualified personnel. Servicing is required when the apparatus has been damaged in a way, such as power-supply cord or plug is damaged, liquid has been spilled or objects have fallen into the apparatus, the apparatus has been exposed to rain or moisture, does not operate normally, or has been dropped.

## SAFETY INFORMATION

---

### Notice

This equipment has been tested and found to comply with the limits for a Class B digital device, pursuant to Part 15 of the FCC rules. These limits are designed to provide reasonable protection against harmful interference in a residential installation. This equipment generates, uses, and can radiate radio frequency energy and, if not installed and used in accordance with the instructions, may cause harmful interference to radio communications. However, there is no guarantee that interference will not occur in a particular installation.

If this equipment does cause harmful interference to radio or television reception, which can be determined by turning the equipment off and on, you are encouraged to try to correct the interference by one or more of the following measures:

- Reorient or relocate the receiving antenna.
- Increase the separation between the equipment and receiver.
- Connect the equipment to an outlet on a different circuit than the one to which the receiver is connected.
- Consult the dealer or an experienced radio/TV technician for help.

Changes or modifications not expressly approved by Bose Corporation could void the user's authority to operate this equipment.

Operation is subject to the following two conditions: (1) This device may not cause harmful interference, and (2) this device must accept any interference received, including interference that may cause undesired operation.

 Bose Corporation hereby declares that this product is in compliance with the essential requirements and other relevant provisions of Directive 1999/5/EC and other applicable Directives. The complete Declaration of Conformity can be found at [www.Bose.com/compliance](http://www.Bose.com/compliance).

<b>WELCOME</b>	<b>7</b>
Thank you .....	7
Product overview .....	7
The setup process .....	7
<b>PHYSICAL SETUP</b>	<b>8</b>
Monitor placement and connections .....	8
Monitor placement recommendations .....	8
Placing the monitor with attached stand .....	9
Installing the anti-tip straps .....	10
Wall-mounting the monitor .....	12
Control console placement and connections .....	14
<b>INTERACTIVE SETUP</b>	<b>16</b>
Starting the system .....	16
If you have setup problems .....	18
Contacting customer service .....	18



## Thank you

---

Thank you for purchasing the Bose® VideoWave™ entertainment system. This guide provides you with step-by-step instructions for setting up your new entertainment system.

**Note:** *Professional installation is recommended.*

---

## Product overview

---

The VideoWave system features a 46-inch monitor, and comes with a control console, a remote control, and a dock compatible with iPod. The control console connects to the monitor using a single cable. Each of your A/V devices connects to the back of the control console.

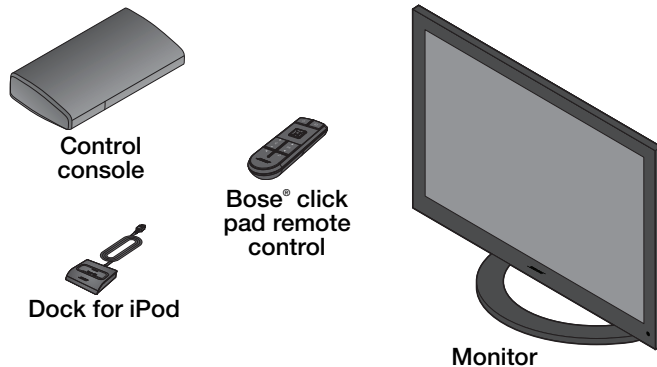

## The setup process

---

The two kits labeled **1** and **2** contain system parts that are used in different stages of the setup process.

Carefully unpack each item as you proceed through the setup. If an item is damaged, do not attempt to use it. Notify Bose or your authorized Bose dealer immediately. For Bose contact information, see the address sheet included in Kit **2**.

There are two parts to the setup process:

- **Physical setup** – This part of the setup includes placing the monitor and control console and making system connections. The items used in this stage are the monitor and the parts located in Kit **1**.
- **Interactive setup** – This part begins when you turn on the system and start following the on-screen instructions provided by the Unify™ intelligent integration system. This proprietary technology will help you complete the setup, showing you the right inputs and best connection options, and will even verify that you've done it correctly. The items used for this stage are located in Kit **2**.

## PHYSICAL SETUP

### Monitor placement and connections

The monitor can be placed on furniture using the attached stand or it can be mounted on a wall.

**WARNING:** *The monitor weighs about 110 lbs. (49.9 kg). To prevent personal injury, a two-person lift is required.*

**CAUTION:** *DO NOT mount or place the monitor in a recessed area or cabinet. This can block the ventilation openings and affect the acoustic performance.*

**CAUTION:** *Do not place the monitor near or over a source of heat, such as a fireplace. Any damage that may occur to your monitor as a result of placing it over a fireplace will not be covered by the limited warranty on your VideoWave™ entertainment system.*

### Monitor placement recommendations

Much like a live performance in a concert hall, the VideoWave™ entertainment system relies on the reflective surfaces of the room to deliver a spacious home theater experience. The system features ADAPTiQ® audio calibration technology, which customizes the sound during setup based on where the system is positioned, as well as the size, shape, and furnishings of the room it is in.

The following recommendations are provided to help you place the monitor in the best possible location:

- The back of the monitor should be approximately 1-4 inches (2.5-10.0 cm) from a wall.
- You should try to allow 3 - 10 ft. (0.9 - 3.0 m) between the monitor and the side walls of the room.
- The area between the side walls and the monitor should be free of as many objects as possible that would block the sound, such as tall bookcases and storage cabinets.
- To enjoy the best audio and video performance, try to have the vertical center of the screen at eye level when seated.

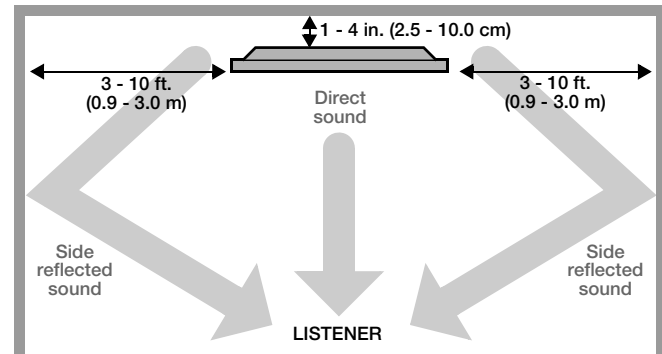

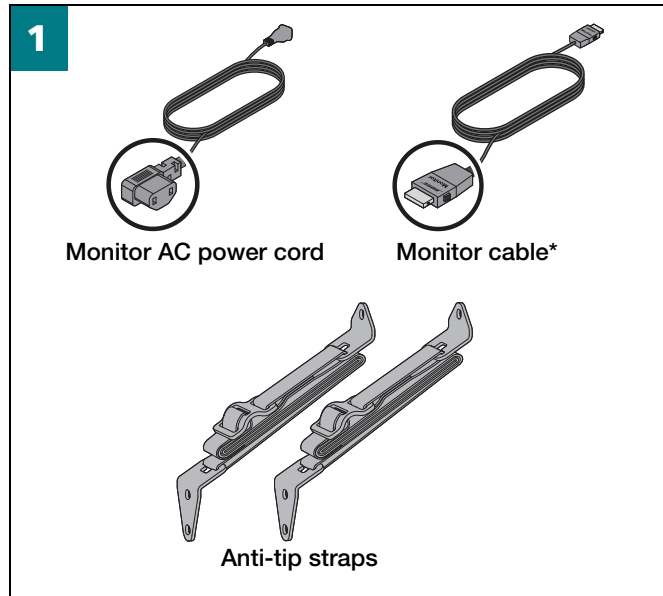

**You need these items from Kit 1:**

*\*Not rated for in-wall use. In-wall cables are available from Bose or a Bose authorized dealer.*

**Placing the monitor with attached stand**

1. Place the monitor on a stable, flat surface capable of supporting the weight of the monitor.

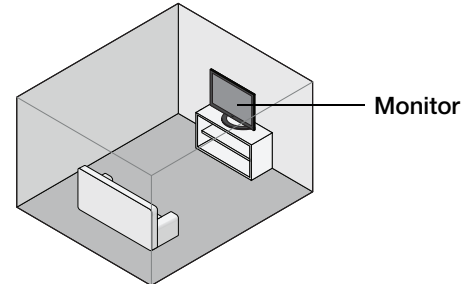

2. On the rear panel of the monitor, firmly pull out on the bottom of the connector cover to remove it.

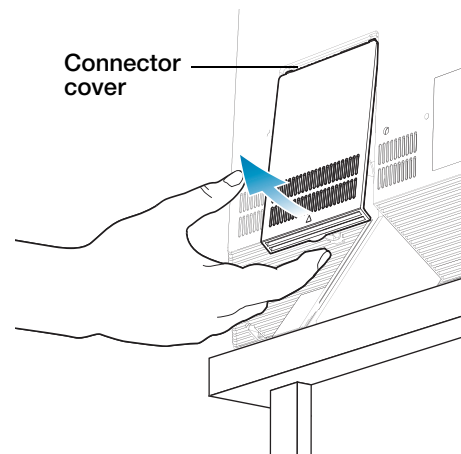

## PHYSICAL SETUP

3. Attach the monitor cable and AC power cord to the monitor as shown.

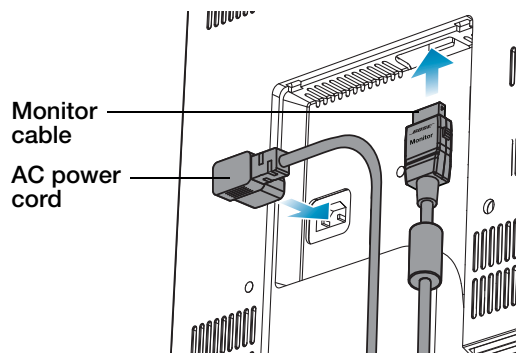

4. Route both cords through the leg of the stand and re-attach the connector cover.

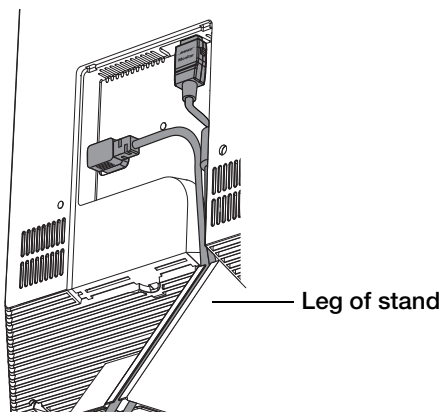

5. Plug the AC power cord from the monitor into a live AC (mains) outlet.
6. Go to “Control console placement and connections” on page 14 to continue the physical setup.

---

**CAUTION:** Bose strongly recommends installing the two included anti-tip straps that, when properly installed, provide an extra measure of security in the event that the monitor accidentally starts to tip over.

---

### Installing the anti-tip straps

It is important that you install both straps according to the following instructions.

---

**WARNING:** Do not use the anti-tip straps for any application other than the one specified in this setup guide.

---



---

**CAUTION:** If you are unsure of the construction methods used in your home, or if you do not understand these instructions or have any concerns or questions, please contact a professional installer.

---

- Using a 5/32" (4 mm) T-handle hex wrench (not included), remove the top two bolts from the rear panel of the monitor as indicated.

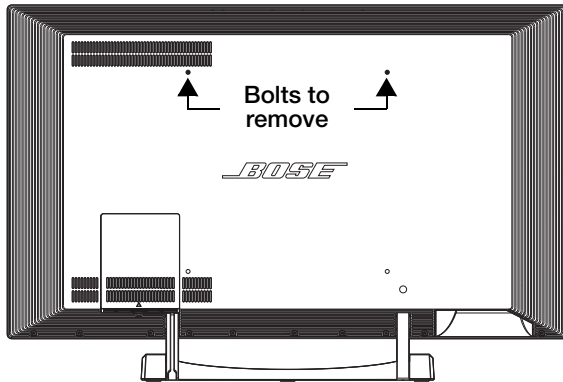

- Using the same bolts, attach the two straps to the back of the monitor as shown.

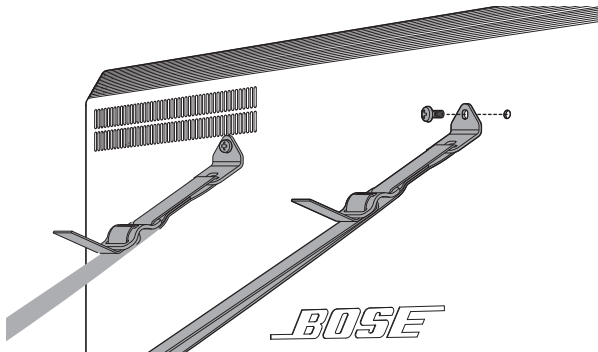

**CAUTION:** The included screws are for use only into wood-studded wall constructions with one-inch (max.) drywall. For all other types of wall construction, please contact a professional installer. Use caution to avoid any electrical or plumbing lines running through the studs.

- Locate the two wall studs closest to the straps. Each strap should be attached to the wall stud closest to it.  
*DO NOT attach both straps to the same stud.*
- Hold the bracket on the end of each strap against the wall 18-24 inches (46-61 cm) above the tabletop. In the center of each wall stud, mark the location of the two holes in the bracket.

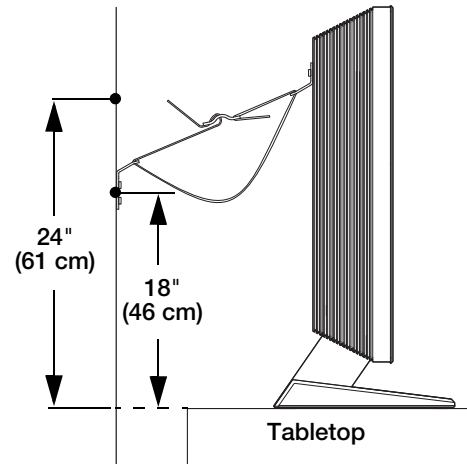

## PHYSICAL SETUP

5. Using a 7/64" (3 mm) drill bit (not included), drill four pilot holes.
6. Secure each bracket to the wall using two of the provided screws.
7. Push monitor back to within 1 -4 in. (2.5 - 10 cm) from the wall.

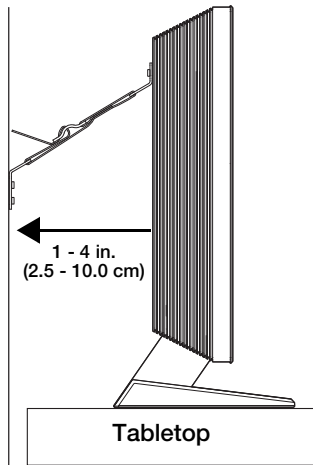

8. Tighten the straps to remove any slack between the monitor and the wall.
9. Bundle the remaining length of the straps and secure them out of reach behind the monitor.

## Wall-mounting the monitor

1. Attach the wall-mounting brackets (not included) to the wall and monitor according to the instructions included with the wall bracket.
2. On the rear panel of the monitor, firmly pull out on the bottom of the connector cover to remove it.

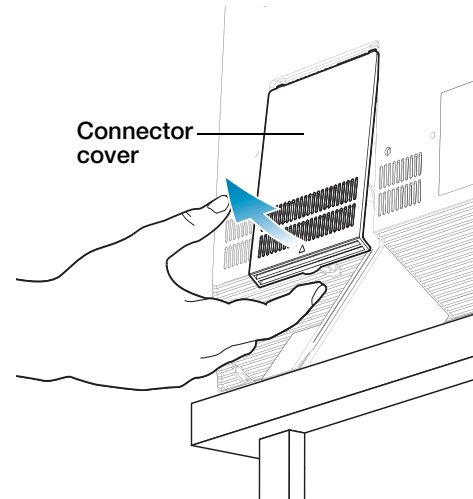

3. Remove the two stand bolts using a 5/32" (4 mm) Allen wrench (not included).



4. Attach the monitor cable and AC power cord to the monitor as shown.

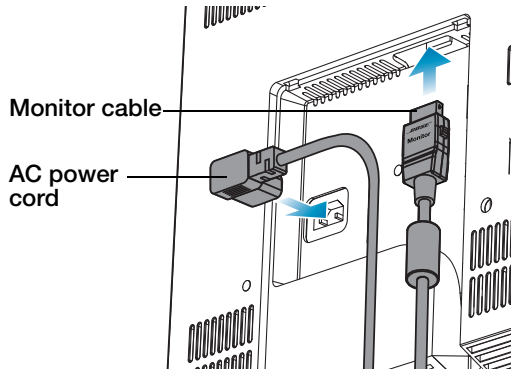

**Note:** You do not need to re-attach the connector cover. Hiding the cables behind the monitor may be easier with the cover removed.

---

**WARNING:** The monitor weighs about 110 lbs. (49.9 kg). To prevent personal injury, a two-person lift is required.

---

5. Lift the monitor off the stand.
6. Attach the monitor to the wall according to the instructions included with the wall bracket.

---

**Note:** If using an AC (mains) outlet that is on the wall behind the monitor, be sure to plug in the power cord before hanging the monitor.

---

7. Go to "Control console placement and connections" on page 14 to continue the physical setup.

## PHYSICAL SETUP

## Control console placement and connections

You need these items from Kit 1:

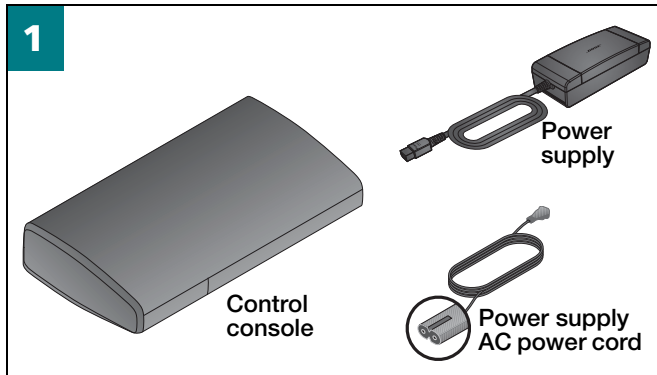

1. Place the control console on a flat, stable surface near the monitor.
  - Make sure the supplied 3-meter monitor cable can reach from the console to the monitor.
  - Until your system setup is complete and your external devices are connected, it is helpful to keep the control console positioned for easy access to its rear connection panel.

**CAUTION:** If using the monitor on the stand, DO NOT place the control console between the legs of the stand or anywhere directly under the bottom edge of the monitor. This will avoid blocking ventilation and audio system openings in the product enclosure.

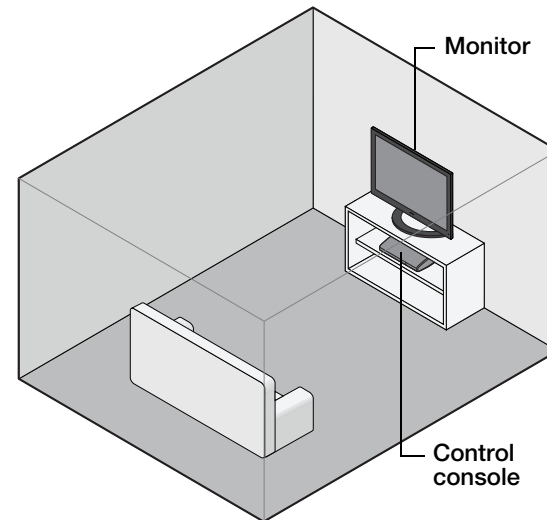

2. Plug the free end of the monitor cable into the connector labeled **A/V OUT to Monitor** on the control console.

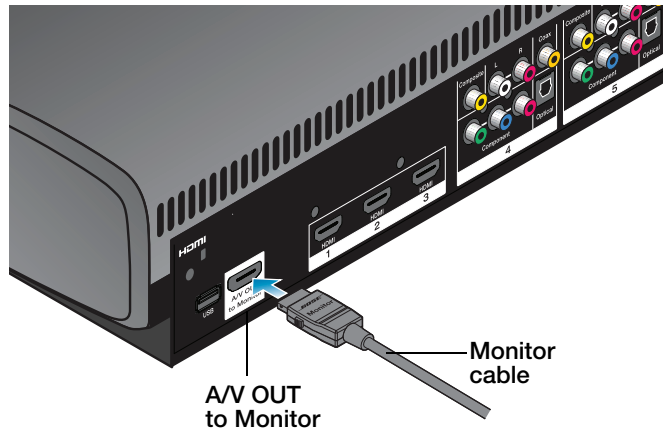

3. Plug the power supply output cord into the control console **Power** connector.

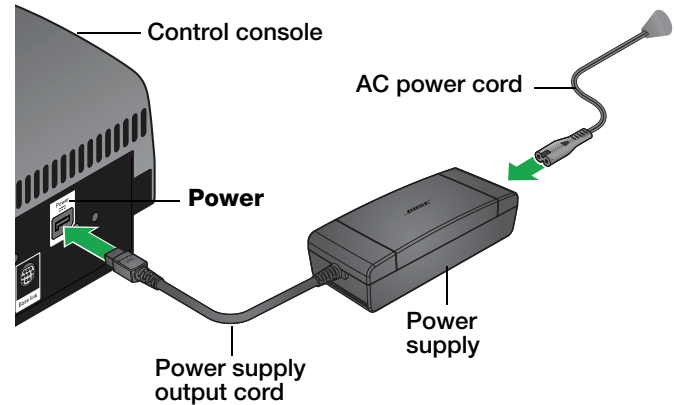

4. Plug one end of an AC power cord into the power supply. Make sure you push the plug in as far as it can go.
5. Plug the other end of the power cord into a live AC (mains) power outlet.
6. Go to “Interactive setup” on page 16 and follow the instructions to start up the system.

# INTERACTIVE SETUP

## Starting the system

You are now ready to turn on your system and complete the setup process using the Unify™ intelligent integration system.

### You need these items from Kit 2:

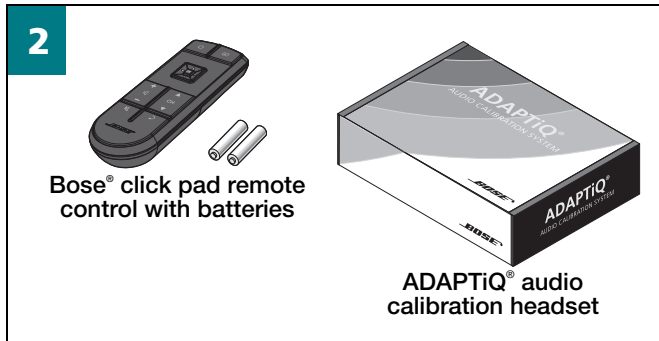

### Kit 2 additional included items:

These are items you may need to connect A/V devices to your system. When it is time to connect your devices, the Unify system will guide you in choosing the right cable.

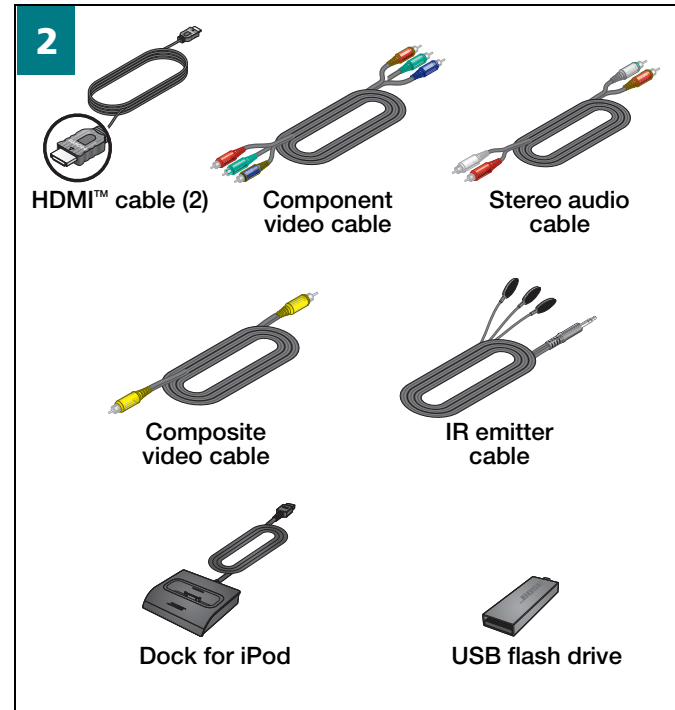



1. Press the power button (⏻) on the control console. The power light on the control console indicates the startup status.

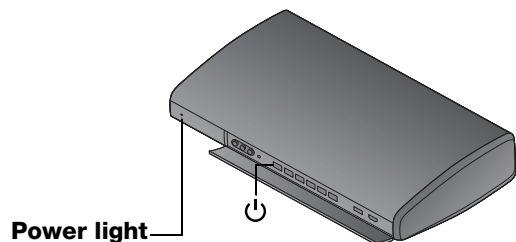

Status	Meaning
Red	Off
Blinking green	Starting up
Steady green	On and ready to use
Orange	Off and charging iPod
Blinking yellow for 30 seconds after shutting system down	Unify™ system setup was started, but is incomplete
Slow blinking red while system is off	Unify system setup is complete, but no sources are present
Red blinking off every 5 seconds	Remote control batteries are low

**Note:** When the system starts up, you will hear a start-up tone, and on the monitor screen you will see the Bose logo with a progress bar under it.

2. Slide the battery compartment cover off the back of the remote control.

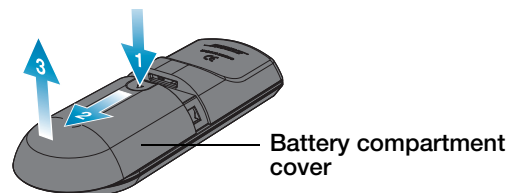

3. Install the two AAA (IEC LR3) batteries (included), matching the polarity markings (+ and -) to the markings inside the battery compartment.

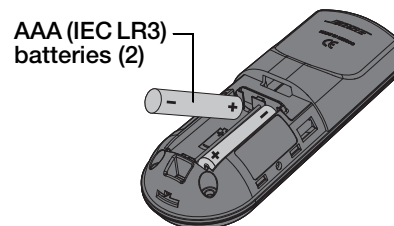

4. Slide the battery cover back into place.

## INTERACTIVE SETUP

5. When the system is started up for the first time the following instruction appears on the monitor in many languages:

“Press and hold the OK button on the Bose remote until the screen turns black.”

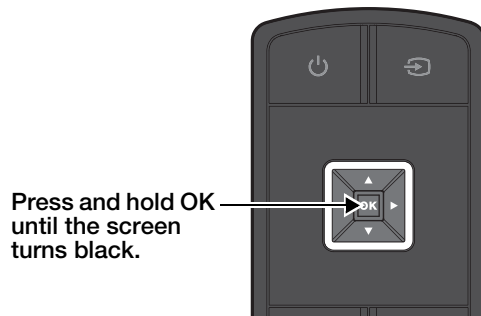

Be sure to perform this step as written. It ensures that the remote can communicate with the control console.

6. Follow the instructions on the monitor screen to complete your system setup.
- The Unify™ intelligent integration system will lead you through the remaining setup steps:
- Select your language.
  - Run the ADAPTiQ® audio calibration system.
  - Connect and set up audio/video devices using the Unify intelligent integration system.

## If you have setup problems

If you experience setup problems, the Unify intelligent integration system can help you identify the issue. Once the issue is addressed, you can return to the Unify setup process at any time. Press the Setup button on the control console to activate the Unify system menu. See “Changing Your System Setup” in your system *Operating Guide*.

For help in trying to resolve any problems, see the troubleshooting table in your system *Operating Guide*.

## Contacting customer service

For additional assistance, contact Bose® Customer Service. See the contact list included with the system in Kit 2.

iPod is a trademark of Apple, Inc., registered in the U.S. and other countries.

HDMI and the HDMI logo are trademarks or registered trademarks of HDMI Licensing LLC in the United States and other countries.



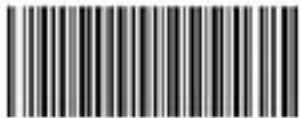

320988-001



***BOSE***<sup>®</sup>  
*Better sound through research*<sup>®</sup>

©2010 Bose Corporation, The Mountain,  
Framingham, MA 01701-9168 USA  
AM320988 Rev.01