

SHARP®

KC-A60J

KC-A50J

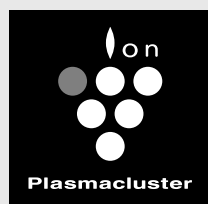

High-Density 7000*

Device of this mark is a trademark of Sharp Corporation.
Plasmacluster is a registered trademark or a trademark of Sharp Corporation.

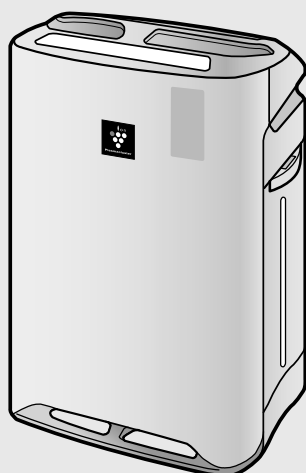

Free standing type

SHARP

SHARP CORPORATION
OSAKA, JAPAN

AIR PURIFIER with Humidifying Function OPERATION MANUAL

* The number in this technology mark indicates an approximate number of ions supplied into air of 1 cm³, which is measured around the center of a room with the "high-density plasmacluster 7000" applicable floor area (at 1.2 m height above the floor) at the medium wind volume in humidifying & air purifying mode, or in air purifying mode, when a humidifier/air purifier or an air purifier using the high-density plasmacluster ion evolving device is placed close to a wall. This product is equipped with a device corresponding to this capacity.

Please read before operating your new Air Purifier

The air purifier draws in room air from the air intake, passes the air through a Pre-Filter, a Washable Deodorizing Filter and a HEPA Filter inside of the unit, then discharges the air through the air outlet. The HEPA Filter can remove 99.97% of dust particles as small as 0.3 microns that pass through the filter and also helps absorb odours.

The Washable Deodorizing Filter gradually absorbs odours as they pass through the filter.

Some odours absorbed by the filters may break down over time, resulting in additional odour. Depending on the usage environment, especially when the product is used in extreme environments (significantly more severe than normal household use), this odour may become strong in a shorter period than expected. If the odour persists, the filters should be replaced.

NOTE

- The air purifier is designed to remove air-suspended dust and odour, but not harmful gases (for example, carbon monoxide contained in cigarette smoke). If the source of the odour still exists, the air purifier may not completely remove the odour.

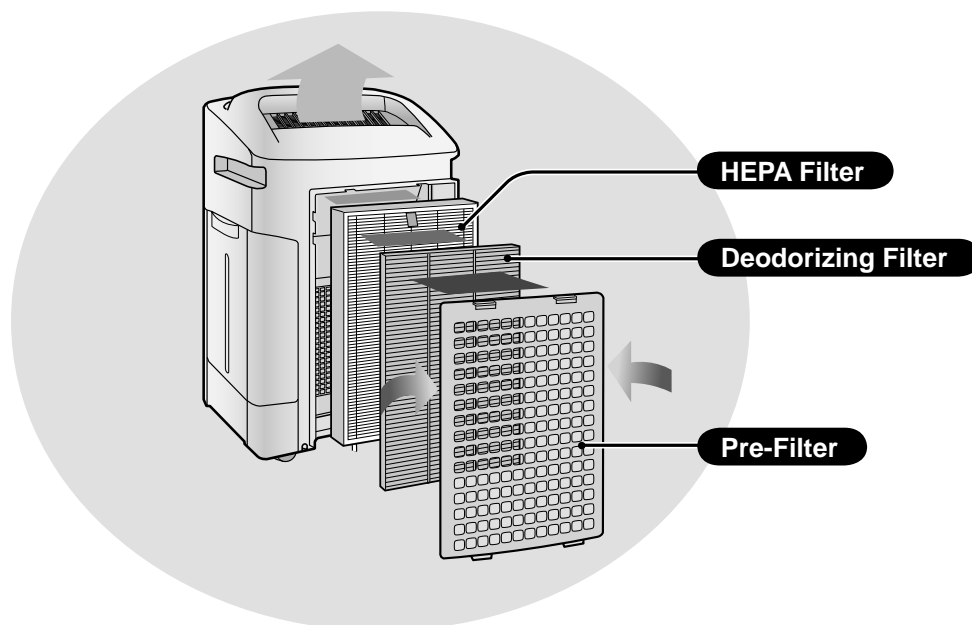

(Common illustration has used "KC-A60J".)

FEATURES

Unique Combination of Air Treatment Technologies

Triple Filtration System + Plasmacluster + Humidification

TRAPS DUST*

Washable pre-filter traps dust and other large airborne particles.

DECREASES ODOURS

Washable deodorizing filter absorbs many common household odours.

REDUCES POLLEN & MOLD*

HEPA filter traps 99.97% of particles as small as 0.3 microns.

FRESHENS

Plasmacluster treats the air similar to the way nature cleans the environment by emitting a balance of positive and negative ions.

HUMIDIFIES

Runs up to 10 hours per filling.**

*When air is drawn through the filter system.

** Room size:

up to 48 m² (KC-A60J)

up to 38 m² (KC-A50J)

(Room height 2.4m)

Sensor Technology continuously monitors air quality, and automatically adjusting operation based on detected air purity and humidity.

CONTENTS

IMPORTANT SAFETY INSTRUCTIONS ...E-2

- WARNING
- CAUTIONS CONCERNING OPERATION
- INSTALLATION GUIDELINES
- FILTER GUIDELINES

PART NAMES.....E-4

- FRONT / BACK
- MAIN UNIT DISPLAY
- ILLUSTRATIVE DIAGRAM

PREPARATION.....E-6

- FILTER INSTALLATION
- REFILLING THE WATER TANK

OPERATIONE-8

- CLEAN AIR & HUMIDIFY
- CLEAN AIR
- CLEAN ION SHOWER
- FAN SPEED
- PLASMACLUSTER ION ON/OFF

USEFUL FUNCTIONE-10

- LIGHTS CONTROL
- CHILD LOCK
- SOUND INDICATOR SETTING
- ADJUSTMENT OF SENSOR DETECTION SENSITIVITY

CARE AND MAINTENANCEE-11

- FILTER INDICATOR
- CARE INDEX
- HUMIDIFYING DISINSTALLATION
- WATER TANK
- HUMIDIFYING FILTER
- HUMIDIFYING TRAY AND COVER
- BACK PANEL
- DEODORIZING FILTER
- UNIT
- FILTER REPLACEMENT

TROUBLESHOOTINGE-16

FOR CUSTOMER ASSISTANCEE-19

SPECIFICATIONS.....E-21

Thank you for purchasing this SHARP Air Purifier. Please read this manual carefully before using the air purifier.
After reading, keep the manual in a convenient location for future reference.

IMPORTANT SAFETY INSTRUCTIONS

When using electrical appliances, basic safety precautions should be followed, including the following:

WARNING – To reduce the risk of electrical shock, fire or injury to persons:

- Read all instructions before using the unit.
- Use only a 220~240 volt outlet.
- **Do not use the unit if the power cord or plug is damaged or the connection to the wall outlet is loosened.**
- Periodically remove dust from the plug.
- **Do not insert fingers or foreign objects into the air intake or air outlet.**
- **When removing the power plug, always hold the plug and never pull on the cord.** Electrical shock and/or fire from a short circuit may result.
- Be careful not to damage the power cord, it may cause electric shock, excess heat or fires.
- **Do not remove the plug when your hands are wet.**
- **Do not use this unit near gas appliances or fireplaces.**
- When refilling the Water Tank, cleaning the unit, or when the unit is not in use, be sure to unplug the unit. Electrical shock and/or fire from a short circuit may result.
- **If the power cord is damaged, it must be replaced by the manufacturer, its service agent, a Sharp authorized Service Centre or similarly qualified person in order to avoid a hazard.**
- Only a Sharp Authorized Service Centre should service this air purifier. Contact the nearest Service Centre for any problems, adjustments, or repairs.
- Do not operate when using aerosol insecticides or in rooms where there is oily residue, incense, sparks from lit cigarettes, chemical fumes in the air, or in locations where the unit may get wet, such as a bathroom.
- Be cautious when cleaning the unit. Strong corrosive cleansers may damage the exterior.
- When carrying the unit, remove the Water Tank and Humidifying Tray first and hold the unit by handles on both sides.
- Do not drink the water in the Humidifying Tray or Water Tank.
- Change the water in the Water Tank daily with fresh tap water and regularly clean the Water Tank and Humidifying Tray. (See E-12 and E-13). When unit is not in use, dispose of the water in the Water Tank and Humidifying Tray. Leaving water in the Water Tank and/or Humidifying Tray may result in mold, bacteria, and bad odours.
In rare cases, this bacteria may cause harmful physical effects.
- This appliance is not intended for use by persons (including children) with reduced physical, sensory or mental capabilities, or lack of experience and knowledge, unless they have been given supervision or instruction concerning use of the appliance by a person responsible for their safety. Children should be supervised to ensure they do not play with the appliance.

NOTE – Radio or TV Interference

If this air purifier should cause interference to radio or television reception, try to correct the interference by one or more of the following measures:

- Reorient or relocate the receiving antenna.
- Increase the separation distance between the unit and radio/TV receiver.
- Connect the equipment into an outlet on a circuit different from that to which the receiver is connected.
- Consult the dealer or an experienced radio/TV technician for help.

CAUTIONS CONCERNING OPERATION

- Do not block the intake and/or air outlet.
- Do not use the unit near or on hot objects, such as stoves or heaters, or where it may come into contact with steam.
- Always operate the unit in an upright position.
- **Hold the unit by using the handles on both sides when moving.**
Do not move when the unit is in operation.
- Do not move or change the direction of the main unit while dragging the casters.
- Lift it up and move such as a tatami mat, a floor which gets damaged easily, an uneven place, and thick-poled carpet.
- When moving by the caster, move it in a horizontal direction.
- Turn the appliance off and remove the water tank before moving, take care not to catch your fingers.
- **Do not operate the unit without the filters, Water Tank, and Humidifying Tray properly installed.**
- **Do not wash and reuse the HEPA filter.**
Not only does it not improve filter performance, it may cause electric shock or malfunction.
- **Clean the exterior with a soft cloth only.**
Do not use volatile fluids and/or detergents.
The unit surface may be damaged or cracked.
In addition, the sensors may malfunction as a result.
- **Frequency of maintenance required (descaling) will depend on the hardness or the impurities of the water that you use; the harder the water the more often descaling will be necessary.**
- **Keep the unit away from water.**

INSTALLATION GUIDELINES

- **When using the unit, place at least 2m away from equipment utilizing electric waves such as televisions or radios to avoid electrical interference.**
- **Avoid a location where the sensor is exposed to direct wind.**
The unit may not operate properly.
- **Avoid use in locations where furniture, fabrics or other items may come in contact with and restrict the air intake and/or air outlet.**
- **Avoid use in locations where the unit is exposed to condensation or drastic temperature changes. Appropriate conditions are when room temperature is between 5 – 35 °C.**
- **Place on a stable surface with sufficient air circulation.**
When placing the unit on a heavily carpeted area, the unit may vibrate slightly.
Place the unit on an even surface to avoid water leakage from the Water Tank and/or Humidifying Tray.
- **Avoid locations where grease or oily smoke is generated.**
The unit surface may crack or the sensor may malfunction as a result.
- **Place the unit about 30 cm(1 ft) away from the wall in order to ensure proper airflow.**
The wall directly behind the air outlet may become dirty over time. When using the unit for an extended period of time in the same location, periodically clean the wall and protect the wall with a vinyl sheet, etc. to prevent the wall from becoming dirty.

FILTER GUIDELINES

- Follow the instructions in this manual for correct care and maintenance of the filters.

PART NAMES

FRONT / BACK

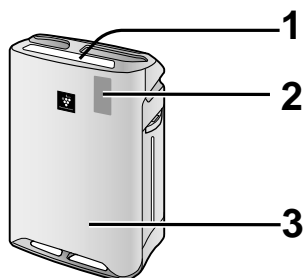

1	Main Unit Display (Ref.E-5)
2	Front Monitor
3	Main Unit

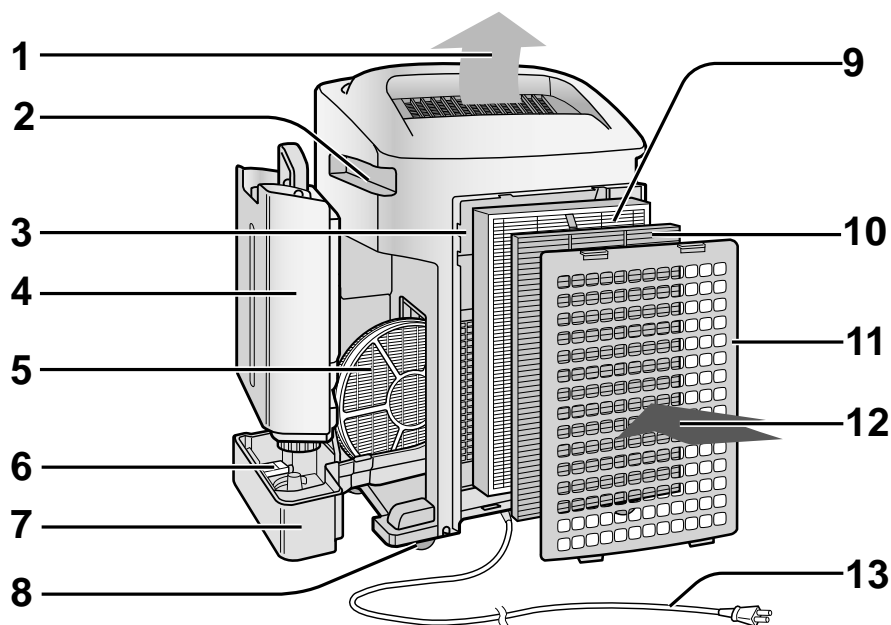

(Shape of plug depends on country.)

1	Air Outlet	6	Float
2	Handle (2 Locations)	7	Humidifying Tray
3	Sensor (Internal) •Dust Sensor •Temperature / Humidity Sensor •Odour Sensor	8	Caster (4 Locations)
4	Water Tank	9	HEPA Filter (white)
5	Humidifying Filter	10	Deodorizing Filter (black)
		11	Back Panel (Pre-Filter)
		12	Air Inlet
		13	Power Cord / Plug

INCLUDED

- Operation manual
- Slipper  x4

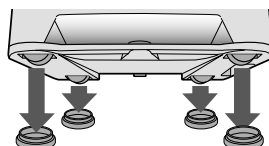

E-4

MAIN UNIT DISPLAY

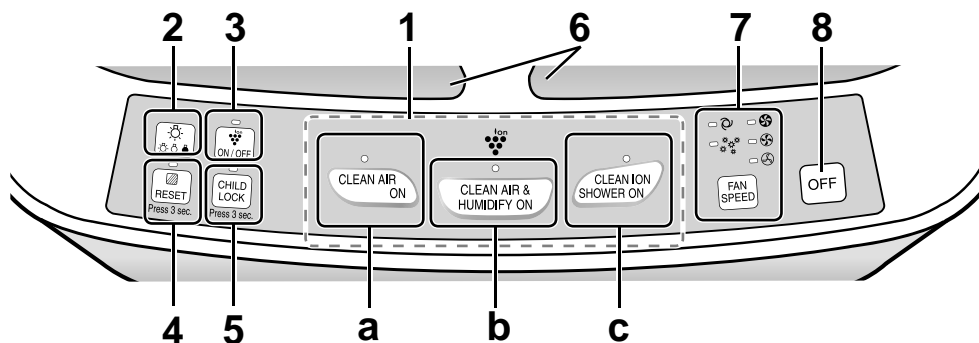

1	POWER ON Button		
a	CLEAN AIR MODE Button / INDICATOR LIGHT (green)		
b	CLEAN AIR & HUMIDIFY MODE Button / INDICATOR LIGHT (green)		
c	CLEAN ION SHOWER MODE Button / INDICATOR LIGHT (green)		
2	LIGHT CONTROL Button	5	CHILD-LOCK Button / INDICATOR LIGHT (green)
3	Plasmacluster Ion ON / OFF Button / INDICATOR LIGHT (green)	6	Plasmacluster Sign
4	FILTER RESET Button / INDICATOR LIGHT (red)	7	FAN SPEED Button / INDICATOR LIGHT (green)
		8	POWER OFF Button

ILLUSTRATIVE DIAGRAM

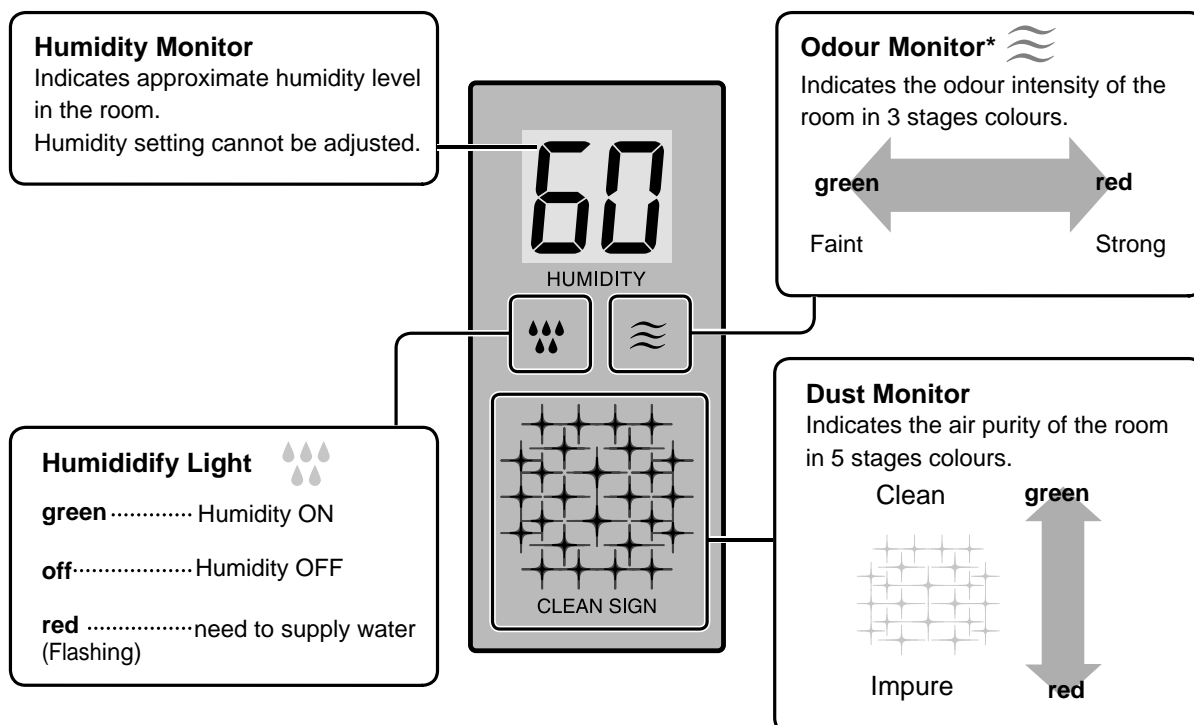

PREPARATION



Be sure to remove the power plug from the wall outlet.

FILTER INSTALLATION

1

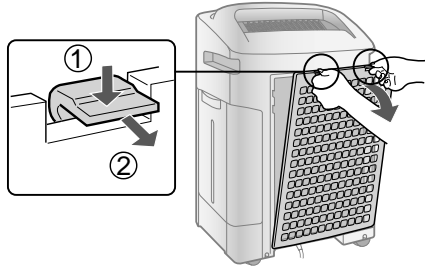

Remove the Back Panel.

2

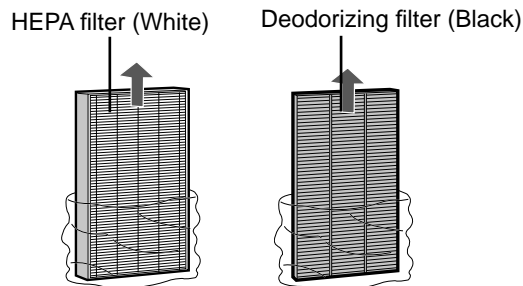

Remove the Filters from the plastic bag.

3

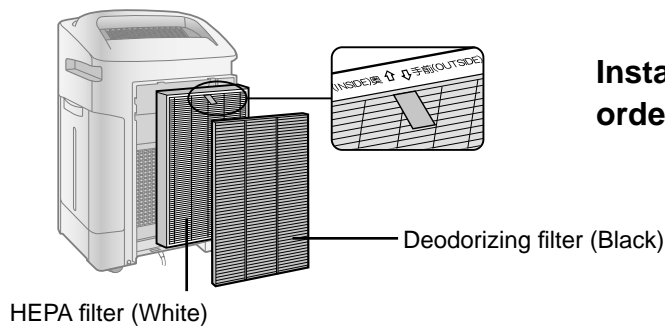

Install the Filters in the correct order as shown.

4

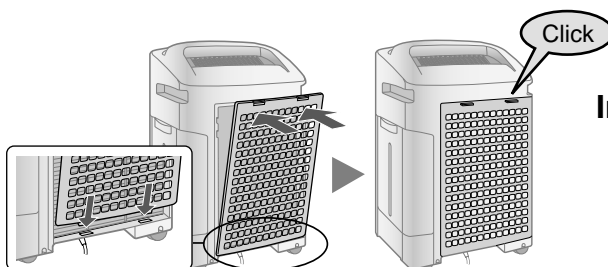

Install the Back Panel.

5

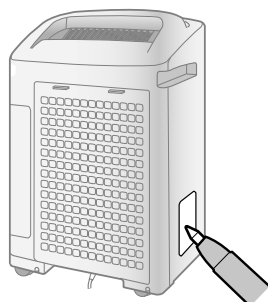

Fill in the usage start date on the Date Label.

REFILLING THE WATER TANK

When using the Clean Air & Humidify Mode, or the Clean ION Shower Mode.

1

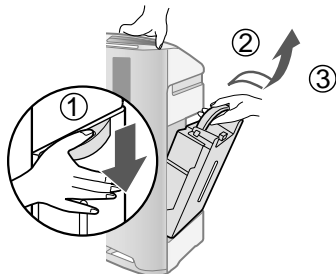

Remove the Water Tank.

2

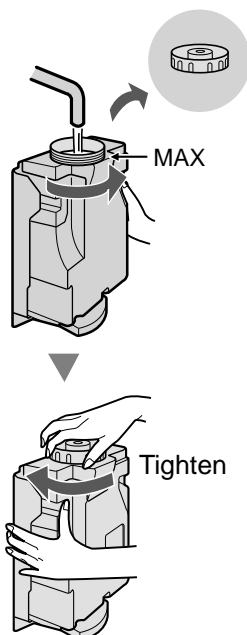

Fill the Water Tank with tap Water.

CAUTION

- Check to see that there is no water leaking.
- Be sure to wipe off any excess water on the outside of the Water Tank.
- When carrying the Water Tank, hold it with both hands so that the Water Tank opening is facing up.

3

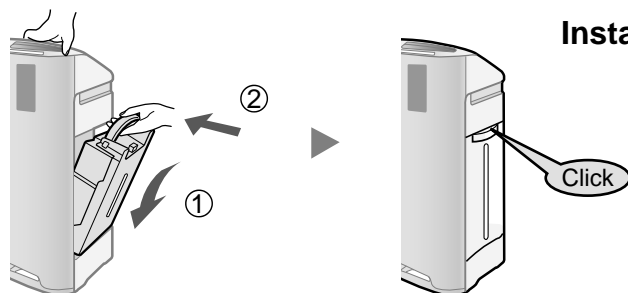

Install the Water Tank.

CAUTION

- Do not expose the unit to water. Short circuit and/or electrical shock may occur as a result.
- Do not use hot water (40 °C), chemical agents, aromatic substances, dirty water, or other damaging substances, deformation and/or malfunction may occur.
- Use only fresh tap water. Use of other water sources may promote the growth of mold, fungus and/or bacteria.

OPERATION

CLEAN AIR & HUMIDIFY

Using to quickly clean the air, reduce odours and to humidify.

START



- Select the desired fan speed. (Ref. E-9)
- Unless the power cord has been unplugged, the operations starts in the previous mode it was operated in.

NOTE

- Fill the Water Tank. (Ref. E-7)
- When the Water Tank is empty, the unit will operate in “CLEAN AIR MODE” and  is flashing (red).

STOP



About Automatic Humidify Mode

The Temperature/Humidity sensors automatically detect and adjust humidity according to changes in room temperature. Depending on the size and humidity of the room, humidity may not reach 55~65 %. In such cases, it is recommended that CLEAN AIR & HUMIDIFY/ MAX MODE be used.

Temperature	Humidity
~18 °C	65 %
18 °C~24 °C	60 %
24 °C~	55 %

CLEAN AIR

Using when additional humidity is not required.

START

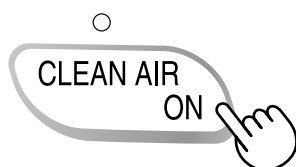

- Select the desired fan speed. (Ref. E-9)
- Unless the power cord has been unplugged, the operations starts in the previous mode it was operated in.

STOP



CLEAN ION SHOWER

Releases high-density Plasmacluster ions and discharges strong air flow for 60 minutes.

START

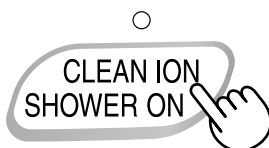

NOTE

- If the “Plasmacluster Ion  ” is OFF, the plasmacluster ion will be not released.
- When the operation finishes, the unit will return to the prior operation mode.
It is possible to switch this mode to another while operating. However, the CLEAN ION SHOWER mode will not function after switching mode.

FAN SPEED

Select the desired fan speed.

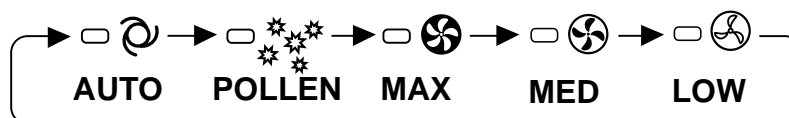

NOTE

AUTO 

The fan speed is automatically switched (between HIGH and LOW) depending on the amount of impurities in the air. The sensors detect impurities for efficient air purification.

POLLEN 

The unit will operate at High Level for 10 minutes, then will alternate between MEDIUM and HIGH.

10 minutes: High fan level
20 minutes: Medium fan level
20 minutes: High fan level

PLASMACLUSTER ION ON/OFF

When Plasmacluster is ON, both the Indicator Light and Plasmacluster Indicator Light turn on.

ON

OFF

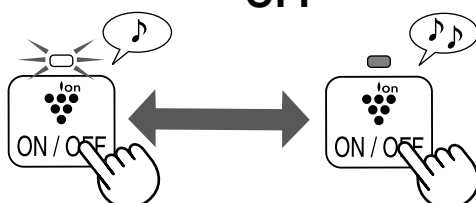

USEFUL FUNCTIONS

LIGHT CONTROL

Use this function to select the desired brightness.

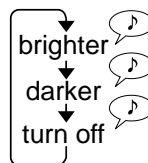
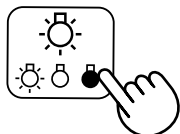

CHILD LOCK

Operation of the unit display will be locked. It is the same method as starting operation.

ON



CANCELLATION



SOUND INDICATOR SETTING

The unit can be set to give an audible signal when the Water Tank is empty.

ON

(with the unit OFF)

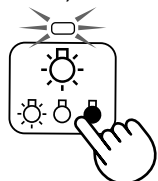

CANCELLATION

(with the unit OFF)

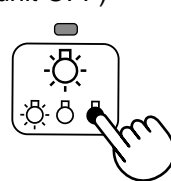

ADJUSTMENT OF SENSOR DETECTION SENSITIVITY

DUST MONITOR and ODOUR MONITOR is constantly red to reduce sensitivity, and set to "high" if the DUST MONITOR and ODOUR MONITOR is constantly green to increase sensitivity.

RED.....SET to "LOW" GREEN...SET to "HIGH"

1

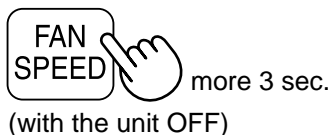

2



3



CAUTION

- If the power OFF Button is not pushed within 8 seconds of adjusting sensor sensitivity, the setting will be saved automatically.
- The sensor sensitivity setting will be saved even if the unit is unplugged.

CARE AND MAINTENANCE



Be sure to remove the power plug from the wall outlet.

FILTER INDICATOR

The Indicator Light will turn on after approximately 720 hours. (30days×24hours=720)



Press 3 sec.

more 3 sec.

Reminder to perform maintenance of parts below.
After performing maintenance, reset the Filter Indicator. (Ref. E-12)

CARE INDEX

- Filter Indicator Light turn on.

Humidifying Filter (Ref. E-12)

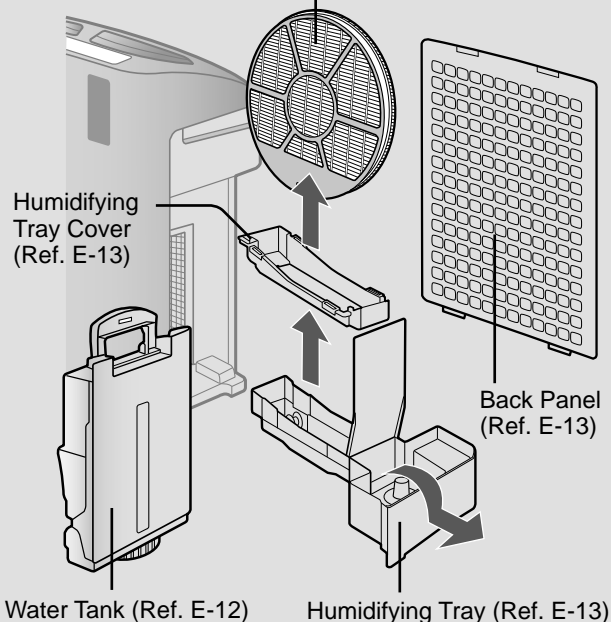

- Notice an unpleasant odour from the air outlet.
- Filter performance appears fall and / or odour persist.

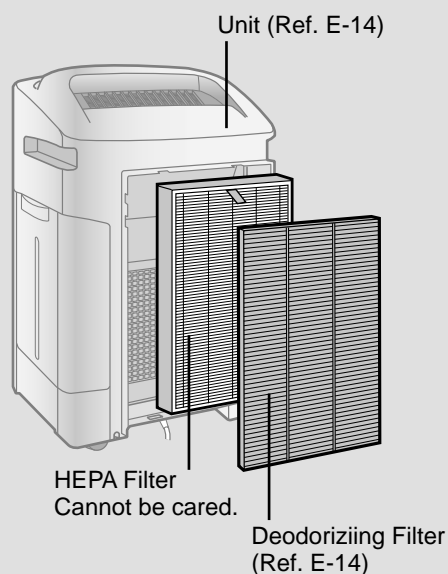

HUMIDIFYING DISINSTALLATION

After maintenance, replace the parts accurately.

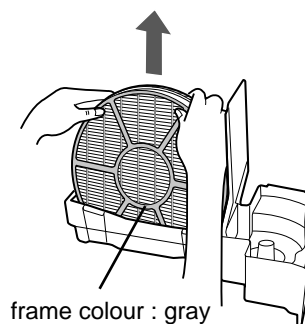
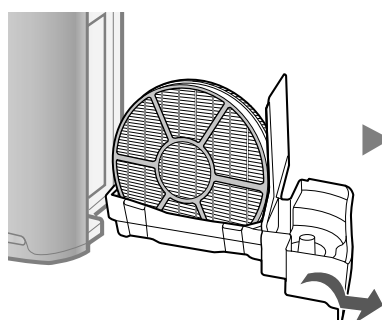
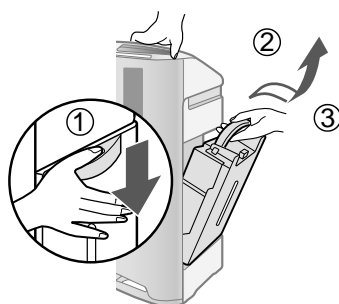

CARE AND MAINTENANCE



WATER TANK

Rinse the inside with a small amount of water.

CAUTION

- Do not shake the Water Tank with holding the carrying handle.

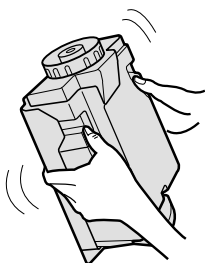

NOTE for stubborn dirt...

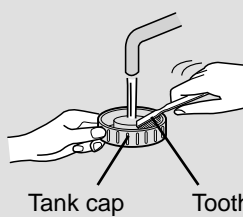
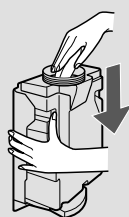

Clean inside of the water tank with a soft sponge and the tank cap with a cotton swab or a toothbrush.

Tank cap

Tooth brushes

HUMIDIFYING FILTER

Rinse with plenty of water.

CAUTION

- Do not remove the Humidifying Filter from a filter frame.
- Avoid spilling water from the Humidifying Tray.

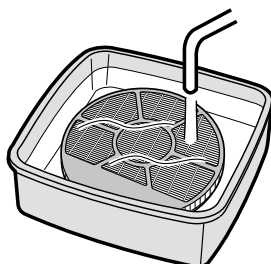

NOTE for stubborn dirt...

1. Soak in water with the descaling solution about 30 minutes.

CAUTION

When using lemon juice, soak time more longer.

2. Remove the descaling solution with plenty of water.

Descaling solution

- Citric acid (available at some drugstores)
- 100% bottled lemon juice with no pulp.

<For using citric acid>

2 ½ cups of water



3 teaspoons

<For using lemon juice>

3 cups of water

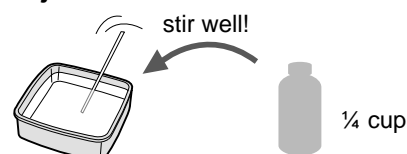

¼ cup

Be sure to remove the power plug from the wall outlet.

HUMIDIFYING TRAY AND COVER

1. Remove the Humidifying Tray Cover.
2. Rinse the inside of the Humidifying Tray and the Humidifying Tray Cover with a tooth brush.

Humidifying Tray Cover

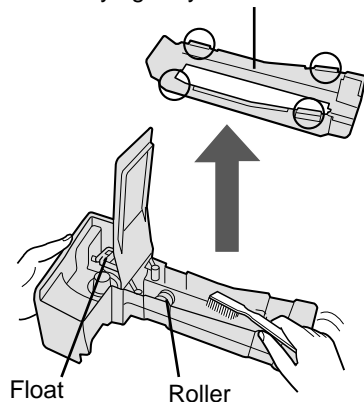

CAUTION

- Do not remove the Float and the Roller.
- If the Float and / or the Roller comes off. (Ref. E-17)

NOTE for stubborn dirt...

TRAY

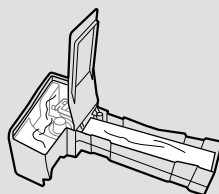

1. Fill the tray half way with water.
2. Add a small amount of kitchen detergent.
3. Soak for 30 minutes.
4. Remove the kitchen detergent with clean water.

COVER

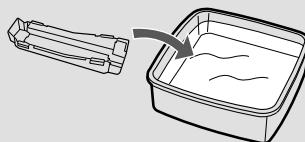

1. Soak in water with a small amount of kitchen detergent about 30 minutes.
 2. Remove the kitchen detergent with clean water.
- Clean difficult to reach parts with a cotton swab or tooth brush.

CAUTION

DO NOT use the detergents shown on E-14.

If cause deformation, tarnishing, cracking (water leakage)

BACK PANEL

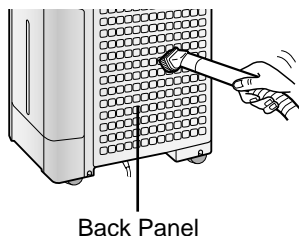

Gently remove dust with a vacuum cleaner attachment or similar tool.

NOTE for stubborn dirt...

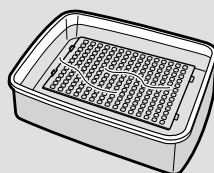

1. Soak in water with kitchen detergent about 10 minutes.

CAUTION

DO NOT scrub the back panel hard.

2. Remove the kitchen detergent with clean water.
3. Dry filter completely in a well ventilated area.

CARE AND MAINTENANCE

DEODORIZING FILTER

HAND WASH ONLY!
DO NOT DRY IN CLOTHES DRYER!

1

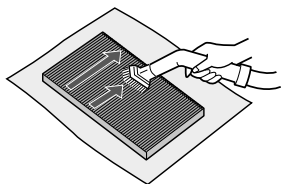

Remove the dust on the DEODORIZING FILTER.

2

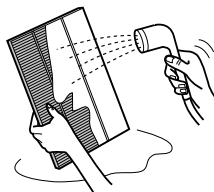

Rinse the DEODORIZING FILTER with water.

CAUTION

- When washing the filter for the first time, the rinse water may be brown.
This does not affect deodorization performance.
- Avoid bending or folding the filter when washing.

3

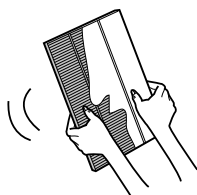

Remove as much of the moisture as possible.

4

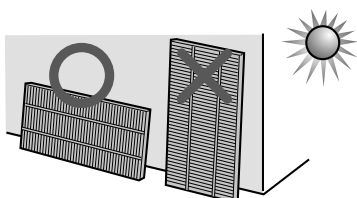

Dry filter completely in a well ventilated area.
When possible, dry outdoors.

(about 6 hours to dry out)

CAUTION

- Avoid drying filter outdoors during inclement weather (e.g. rain or cold temperatures).
- Do not allow filter to freeze.
- If filter is dried indoors, take precautions, such as placing towels, etc under the filter to prevent water damage to the floor.

UNIT

Wipe with a dry, soft cloth.

CAUTION

- **Do not use volatile fluids**
Benzine paint thinner, polish powder, may damage the surface.
- **Do not use detergents**
Detergent ingredients may damage the unit.

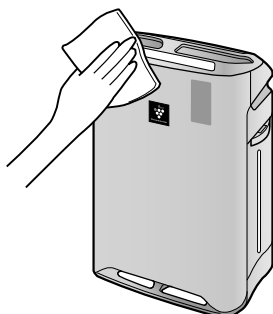

FILTER REPLACEMENT

Replacement timing

Filter life will vary depending on the room environment, usage, and location of the unit. If dust or odour persists, replace the filter.

(Refer to "Please read before operating your new Air Purifier")

The following filter life and replacement period is based on the condition of smoking 5 cigarettes per day and the dust collection/deodorization power is reduced by half compared with that of new filter.

We recommend to replace the filter more frequently if the product is used in a condition significantly severer than normal household use.

•HEPA filter	About 10 years after opening
•Deodorizing filter*	About 10 years after opening
•Humidifying filter	About 10 years after opening

* Washable deodorizing filter can be repeatedly used after washing, or it can be replaced.

Replacement Filter Model

Please consult your dealer for purchase of replacement filter.

AIR PURIFIER MODEL	REPLACEMENT FILTER MODEL		
	HEPA Filter : 1 unit	Deodorizing Filter : 1 unit	Humidifying Filter : 1unit
KC-A50J	FZ-A50HFE	FZ-A50DFE	FZ-A60MFE
KC-A60J	FZ-A60HFE	FZ-A60DFE	

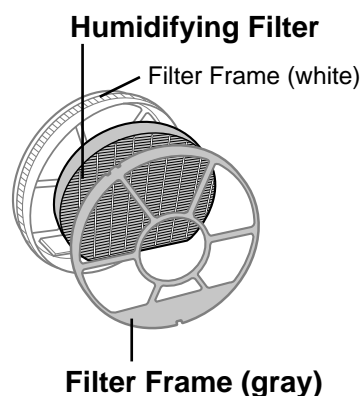

NOTE

Use the date label as a reminder for next replacement.

Disposal of Filters

Please dispose of used filters according to any local laws and regulations.

HEPA Filter material :

- Filter : Polypropylene
- Frame: Polyester

Deodorizing Filter material :

- Deodorizer : Activates charcoal
- Filter : Polyester, Rayon

Humidifying Filter material :

- Filter : Rayon, Polyester

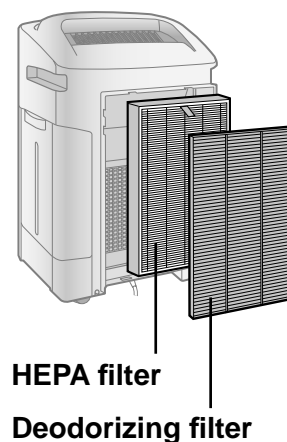

TROUBLESHOOTING

Before calling for service, please review the Troubleshooting chart below, since the problem may not be a unit malfunction.

SYMPTOM	REMEDY (not a malfunction)
Odours and smoke are not removed.	<ul style="list-style-type: none"> • Clean or replace the filters if they appear to be heavily soiled. (Ref. E-11,E-12,E-14)
The Front Monitor illuminates green even when the air is impure.	<ul style="list-style-type: none"> • The air could be impure at the time the unit was plugged in. Unplug the unit, wait one minute, and plug the unit in again.
The Front Monitor illuminates orange or red even when the air is clean.	<ul style="list-style-type: none"> • Sensor operation is affected if the dust sensor openings are dirty or clogged. Gently clean the dust sensors. (Ref. E-4).
A clicking or ticking sound is heard from the unit.	<ul style="list-style-type: none"> • Clicking or ticking sounds may be audible when the unit is generating ions.
The discharged air has an odour.	<ul style="list-style-type: none"> • Check to see if the filters are heavily soiled. • Clean or replace the filters. • Plasmacluster Air Purifiers emit small traces of ozone which may produce an odour.
The unit does not operate when cigarette smoke is in the air.	<ul style="list-style-type: none"> • Is the unit installed in a location that is difficult for the sensor to detect cigarette smoke? • Are the dust sensor openings blocked or clogged? (In this case, clean the openings.) (Ref. E-4)
Filter Indicator Light is illuminated.	<ul style="list-style-type: none"> • After replacing filters, connect the power cord to an outlet and press the Filter Reset Button. (Ref. E-11)
The Front Monitor are turned off.	<ul style="list-style-type: none"> • Check to see if the Lights OFF Mode selected. If so, then press the Lights Control Button to activate the indicator lights. (Ref. E-10)
The Water Supply Indicator Light does not illuminate when the tank is empty.	<ul style="list-style-type: none"> • Check Styrofoam float for impurities. Clean the HumidifyingTray. Ensure unit is located on a level surface.
Water lever in the tank does not decrease or decreases slowly.	<ul style="list-style-type: none"> • Check to see if the Humidifying Tray and Water Tank are correctly installed. Check the Humidifying Filter. • Clean or replace the filter when it is heavily soiled. (Ref. E-14 and E-15).
The Front Monitor lights change colour frequently.	<ul style="list-style-type: none"> • The Front Monitor lights automatically change colours as impurities are detected by the dust sensor and odour sensor.

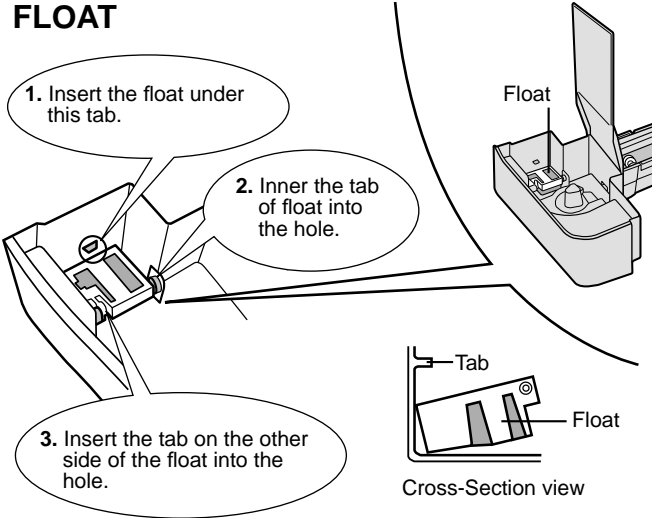
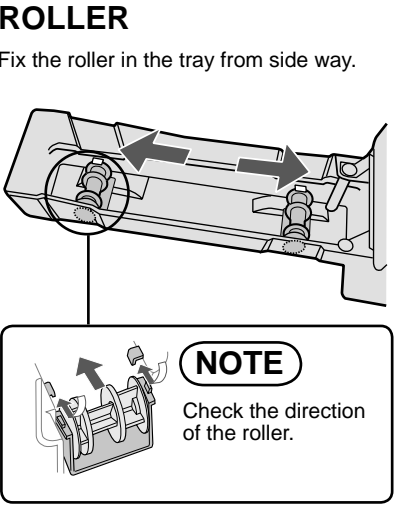
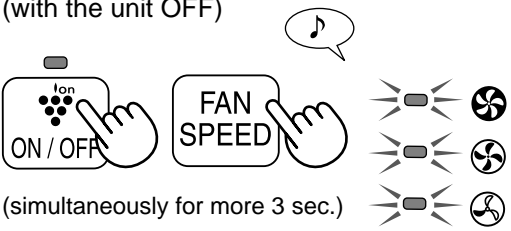
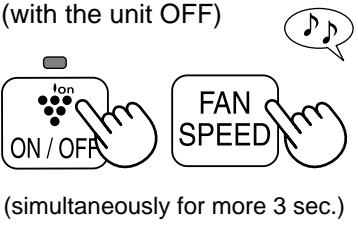
SYMPTOM	REMEDY (not a malfunction)
<p>When the Roller / Float was removed.</p> <div data-bbox="197 415 1336 989" style="border: 1px dashed black; padding: 10px;"> <div style="display: flex; justify-content: space-between;"> <div style="width: 45%;"> <p>FLOAT</p>  <p>1. Insert the float under this tab.</p> <p>2. Inner the tab of float into the hole.</p> <p>3. Insert the tab on the other side of the float into the hole.</p> <p>Cross-Section view</p> </div> <div style="width: 45%;"> <p>ROLLER</p> <p>Fix the roller in the tray from side way.</p>  <p>NOTE</p> <p>Check the direction of the roller.</p> </div> </div> </div>	<ul style="list-style-type: none"> • Install the Roller / Float in order below.
<p>AUTO RESTART</p> <p>After a power failure, automatically resume the operation when the power recovers.</p>	<p>Auto Restart can be set.</p> <ul style="list-style-type: none"> • Even when the plug is unplugged or the breaker is thrown during the operation, the operation resumes at the previous operation mode and settings if the power recovers. <div data-bbox="197 1255 1336 1696" style="border: 1px dashed black; padding: 10px;"> <div style="display: flex; justify-content: space-between;"> <div style="width: 45%;"> <p>ON</p> <p>(with the unit OFF)</p>  <p>(simultaneously for more 3 sec.)</p> </div> <div style="width: 45%;"> <p>CANCELLATION</p> <p>(with the unit OFF)</p>  <p>(simultaneously for more 3 sec.)</p> </div> </div> <p style="text-align: center;">If the , , lamp lights up for 10 seconds, the setting is complete.</p> </div>

TROUBLESHOOTING

ERROR DISPLAY

If error occurs again, contact the Sharp Service Centre.

DIGITAL INDICATION	LAMP INDICATION	ERROR DETAILS	REMEDY
E2	Flashing of the Clean Air & Humidify Indicator Light.	Abnormal humidity filter.	Verify if the Humidifying Filter, Humidifying Tray and Water Tank are properly installed and then turn power ON again.
C1	Flashing of the Fan Speed Indicator Light '☺'.	Abnormal fan motor.	Turn power OFF to cancel the error display, wait one minute, and then turn power ON.
C3	-	Abnormal temperature-humidity sensor.	Unplug the unit, wait one minute, and plug the unit in again.
C4	-		
C5	Flashing of the Clean Ion Shower Indicator Light.	Problem in circuit board.	
C6	Flashing of the Clean Air Indicator Light.		
C7	Flashing of the Fan Speed Indicator Light '☼'.		
C8	Flashing of the Fan Speed Indicator Light '☼'.		

FOR CUSTOMER ASSISTANCE

SHARP WARRANTY

Consumer Electronic Products

Congratulations on Your Purchase!

This Sharp product is warranted against faults in material and manufacture for the period as stated in the table below.

If service is required during the warranty period, please contact your nearest Sharp Approved Service Centre. These repairs would be carried out at no charge to the owner, subject to the conditions specified herein.

This warranty does not extend to defects or injuries caused by or resulting from causes not attributable to faulty parts or the manufacture of the product, including but not limited to, defect or injury caused by or resulting from misuse, abuse, neglect, lack of maintenance, accidental damage, improper voltage, liquid spillage, vermin infestation, software, or any alterations made to the product which are not authorised by Sharp.

Please retain your sales documentation, as this should be produced to validate a warranty claim. This warranty is in addition to and in no way limits, varies or excludes any implied rights and remedies under any relevant legislation in the country of sale.

This warranty does not cover transportation to and from the Sharp Approved Service Centre. Goods presented for repair may be replaced by refurbished goods of the same type rather than being repaired. Refurbished parts may be used to repair the goods. The repair of your goods may result in the loss of user generated data, please ensure that you have saved this data elsewhere prior to repair.

Australian customers: Our goods come with guarantees that cannot be excluded under the Australian Consumer Law. You are entitled to a replacement or refund for a major failure and for compensation for any other reasonably foreseeable loss or damage. You are also entitled to have the goods repaired or replaced if the goods fail to be of acceptable quality and the failure does not amount to a major failure. The criteria of a major failure is defined in the Australian Consumer Law. Should you require any assistance with a major failure please contact Sharp Customer Care.

WARRANTY PERIODS

Home Theatre Projector	12 months (excluding lamps and air filters)
Audio/Home Theatre	12 months
Microwave Oven	12 months
Steam Oven	12 months
Refrigerator	24 months
DVD/Blu-ray	12 months
Air Conditioner	60 months
Portable Air Conditioner	12 months
LCD Television	36 months
Air Purifier	12 months
Vacuum Cleaner	24 months

SHARP
SHARP CORPORATION OF
AUSTRALIA PTY. LIMITED
ABN 40 003 039 405
1 Huntingwood Drive
Huntingwood NSW 2148
SHARP CORPORATION OF
NEW ZEALAND LIMITED
59 Hugo Johnston Drive
Penrose, Auckland

SPform 040 (JUNE 2012)

IMPORTANT NOTICE: This warranty applies only to products sold in Australia & New Zealand

FOR CUSTOMER ASSISTANCE

SHARP

FOR LOCATION ENQUIRIES WITHIN

AUSTRALIA

REGARDING YOUR LOCAL

SHARP APPROVED SERVICE CENTRE

VISIT OUR WEBSITE AT

www.sharp.net.au

OR CALL SHARP CUSTOMER CARE

1300 135 022

(LOCAL CALL COSTS APPLY WITHIN AUSTRALIA)

SHARP CORPORATION OF AUSTRALIA PTY LTD

SHARP

FOR LOCATION ENQUIRIES WITHIN

NEW ZEALAND

REGARDING YOUR LOCAL

SHARP APPROVED SERVICE CENTRE

VISIT OUR WEBSITE AT

www.sharp.net.nz

CONTACT YOUR SELLING DEALER/RETAILER

OR CALL

SHARP CUSTOMER SERVICES

TELEPHONE: 09 573 0111

FACSIMILE: 09 573 0113

SHARP CORPORATION OF NEW ZEALAND LIMITED

SPECIFICATIONS

Model	KC-A60J			KC-A50J		
Power supply	220 ~ 240 V			50 Hz		
Fan Speed Adjustment	MAX	MED	LOW	MAX	MED	LOW
CLEAN AIR	396	270	84	306	216	60
	60	22	5.3	42	18	4.3
	49	40	19	49	41	16
CLEAN AIR & HUMIDIFY	366	270	120	288	216	90
	44	24	9	36	20	7.4
	47	40	24	47	41	23
	730	600	300	600	500	250
Recommended Room Size (m ²)*2	~48			~38		
High density Plasmacluster ion recommended room size (m ²)*3	~35			~28		
Water Tank Capacity (L)	4.0			3.6		
Sensors	Dust/Odour/Temperature & Humidity					
Filter type	HEPA with Microbial control *4					
	Washable Deodorizing					
Cord Length (m)	2.0					
Dimensions (mm)	416 (W) x 295 (D) x 643 (H)			399 (W) x 273 (D) x 603 (H)		
Weight (kg)	11.0			9.2		

*1 •Humidification Amount changes in accordance with indoor and outdoor temperature and humidity.
Humidification Amount increases as temperatures rise or humidity decreases.

Humidification Amount decreases as temperatures decrease or humidity rises.
•Measurement Condition: 20 °C, 30 % humidity (JEM1426)

*2 •The Recommended Room Size is appropriate for operating the unit of maximum fan speed.

*3 •The Recommended Room Size area indicates the space where a certain amount of dust particles can be removed in 30 minutes.

*4 •Size of a room in which approximately 7000 ions can be measured per cubic centimeter in the center of the room (at a height of approximately 1.2 meters from the floor) when the product is placed next to a wall and run at the MED operation position.

•The filter removes more than 99.97% of particles of 0.3-micron dust. (JEM1467)

Standby Power

In order to operate the electrical circuits while the power plug is inserted in the wall outlet, this product consumes about 0.9 W of standby power.
For energy conservation, unplug the power cord when the unit is not in use.



SHARP®

SHARP CORPORATION OF AUSTRALIA PTY.LTD.

A. B. N. 40 003 039 405

1 HUNTINGWOOD DRIVE, HUNTINGWOOD, N.S.W. 2148

P.O.BOX 6827, BLACKTOWN. N.S.W. 2148

SHARP CORPORATION OF NEW ZEALAND LIMITED

59 HUGO JOHNSTON DRIVE PENROSE, AUCKLAND

Printed in China

TINS-A621KKRZ 13A- (CN) ①