

Refrigerator

FNT 1670 XT

D Bedienungsanleitung

Blomberg

Safety first /1
Technical Features /1
Electrical requirements /2
Transportation instructions /2
Installation instructions /2
Temperature control and adjustment /3
Before operating /3
Indicator lights /4
Storing frozen food /4
Freezing fresh food /4
Fast freeze /4
Making ice cubes /5
Defrosting /5
Getting to know your appliance /5
Cleaning and care /6
Repositioning the door /7
Do's and don'ts /7
Trouble - shooting /8

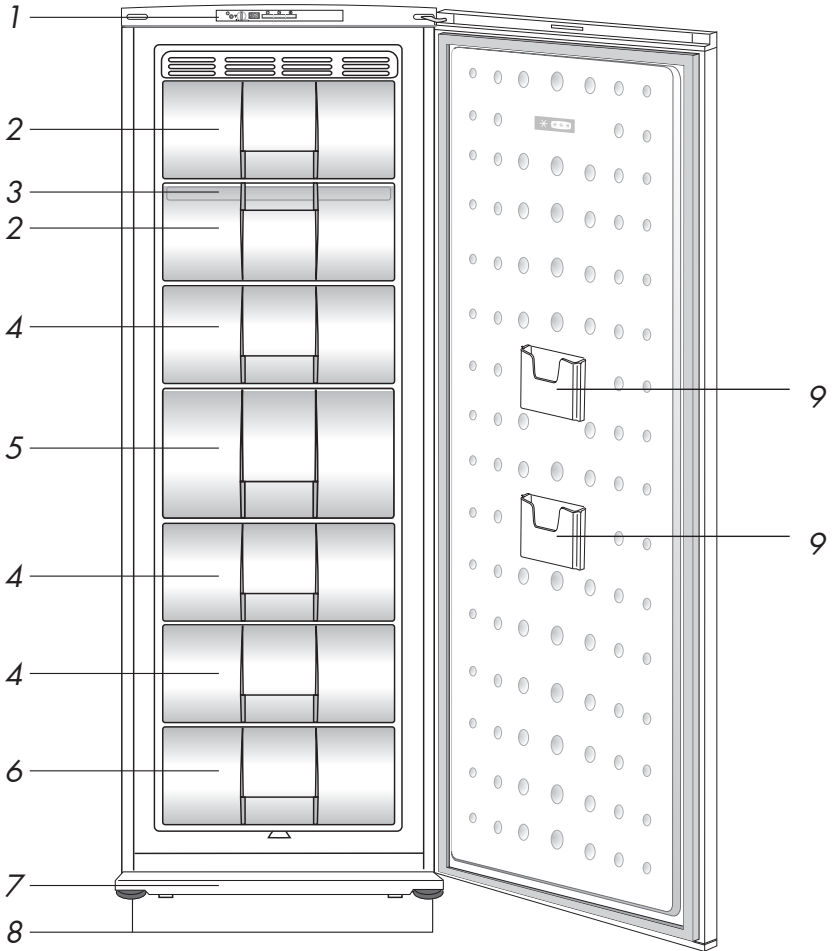

Fig. 1

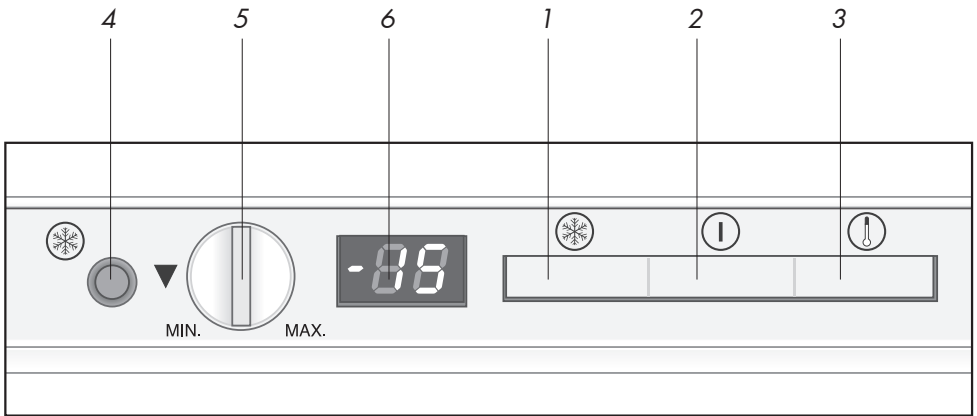

Fig. 2

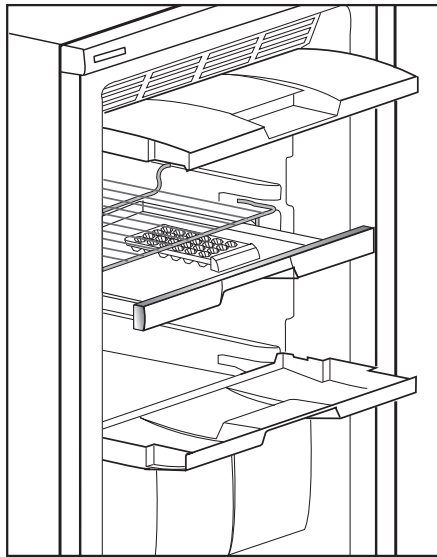

Fig. 3

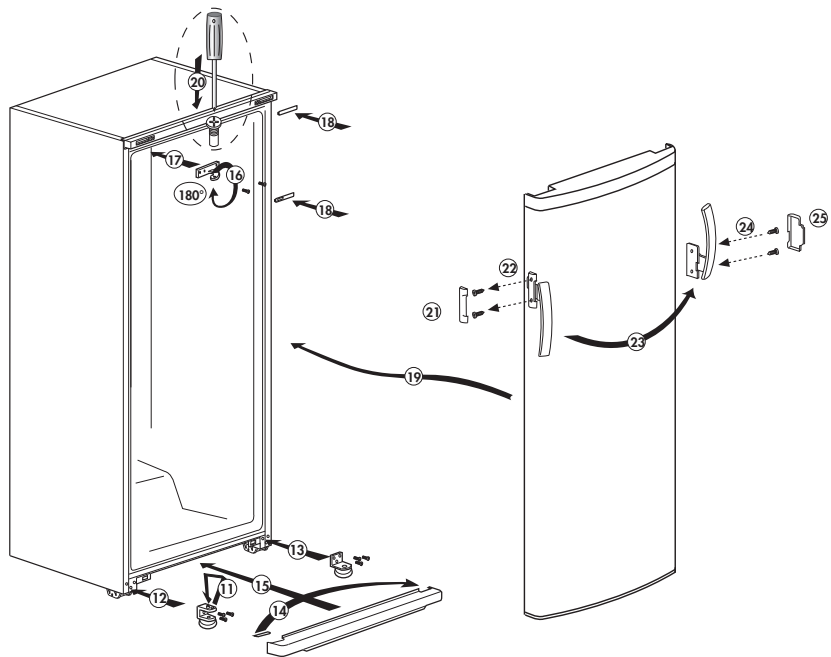
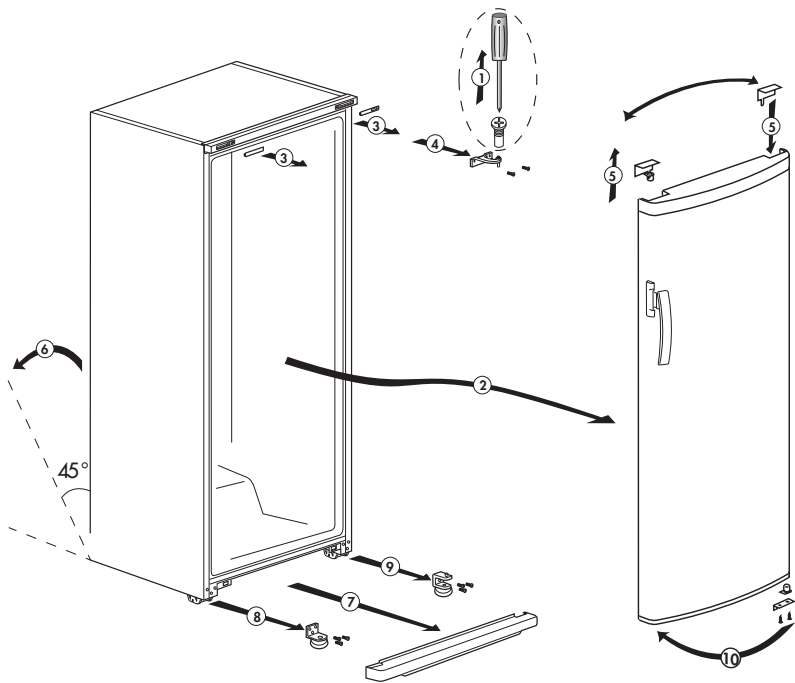

Fig. 4

Congratulations on your choice of a **Blomberg** Quality Appliance, designed to give you many years of service.

Safety first!

Do not connect your appliance to the electricity supply until all packing and transit protectors have been removed.

- Leave to stand for at least 4 hours before switching on, to allow compressor oil to settle, if transported horizontally.
- If you are discarding an old appliance with a lock or latch fitted to the door, ensure that it is left in a safe condition to prevent the entrapment of children.
- This appliance must only be used for its intended purpose i.e. the storing and freezing of edible foodstuff.
- Do not dispose of the appliance on a fire. Your appliance contains non CFC substances in the insulation which are flammable. We suggest you contact your local authority for information on disposal and available facilities.
- We do not recommend use of this appliance in an unheated, cold room. (e.g. garage, conservatory, annex, shed, out-house etc.)

To obtain the best possible performance and trouble free operation from your appliance it is very important to read these instructions carefully. Failure to observe these instructions may invalidate your right to free service during the guarantee period.

Please keep these instructions in a safe place for easy reference.

Technical Features

NOMENCLATURE	UNPACKED	PACKED
Width (cm)	595	665
Depth (cm)	600	680
Height (cm)	1730	1800
Total Gross Volume (lt. / cu.ft.)	232 / 8,5	
Total Net Volume (lt. / cu.ft.)	210 / 7,5	
Climate Class / Star Rating	T / 	
Energy Efficiency Class	B	
Voltage	208-220 V AC, 50 Hz.	
System Cooling Gas	R134a	

Electrical requirements

Before inserting the plug into the wall socket make sure that the voltage and the frequency shown in the rating plate inside the appliance corresponds to your electricity supply. Ensure that the plug remains readily accessible. Do not use multiple adapter bar or extension cable.

Warning! This appliance must be earthed.

Repairs to electrical equipment should only be performed by a qualified technician. Incorrect repairs carried out by an unqualified person carry risks that may have critical consequences for the user of the appliance.

Transportation instructions

1. The appliance should be transported only in upright position. The packing as supplied must be intact during transportation.
2. If during the course of transport the appliance, has been positioned horizontally, it must not be operated for at least 4 hours, to allow the system to settle.
3. Failure to comply with the above instructions could result in damage to the appliance, for which the manufacturer will not be liable for.
4. The appliance must be protected against rain, moisture and other atmospheric influences.

Important!

- Care must be taken while cleaning/carrying the appliance not to touch the bottom of the condenser metal wires at the back of the appliance, as this could cause injury to fingers and hands.
- Do not attempt to sit or stand on top of your appliance as it is not designed for such use. You could injure yourself or damage the appliance.

- Make sure that the mains cable is not caught under the appliance during and after moving, as this could damage the cable.
- Do not allow children to play with the appliance or tamper with the controls.

Installation instructions

1. Do not keep your appliance in a room where the temperature is likely to fall below 10 °C at night and/or especially in winter, as it is designed to operate in ambient temperatures between +10 and +43 °C. At lower temperatures the appliance may not operate, resulting in a reduction in the storage life of the food.
2. Do not place the appliance near cookers or radiators or in direct sunlight, as this will cause extra strain on the appliance's functions. If installed next to a source of heat or freezer, maintain the following minimum side clearances:
 - From Cookers 30 mm
 - From Radiators 300 mm
 - From Freezers 25 mm
3. Make sure that sufficient room is provided around the appliance to ensure free air circulation.
 - Put the back airing lid to the back of your refrigerator to set the distance between the refrigerator and the wall.
4. The appliance should be positioned on a smooth surface. The two front feet can be adjusted as required. To ensure that your appliance is standing upright adjust the two front feet by turning clockwise or anti-clockwise, until firm contact is secured with the floor. Correct adjustment of feet prevents excessive vibration and noise.
5. Refer to "Cleaning and Care" section to prepare your appliance for use.

Temperature control and adjustment

Operating temperatures are controlled by the electronic thermostat knob and may be set any position between MIN and MAX (coldest position) (**Fig. 2**). Max position is $-24\text{ }^{\circ}\text{C}$.

The normal storage temperature of your appliance should be $-18\text{ }^{\circ}\text{C}$ ($0\text{ }^{\circ}\text{F}$). Lower temperatures can be obtained by adjusting the thermostat knob towards Position Max. Please remember that each time the door is opened cold air escapes and the internal temperature rises. Therefore never leave the door open and ensure it is closed immediately after food is put in or removed.

Before operating

Final Check

Before you start using the freezer check that:

- 1.** The feet have been adjusted for perfect levelling.
- 2.** The interior is dry and air can circulate freely at the rear.
- 3.** The interior is clean as recommended under "CLEANING AND CARE."
- 4.** The plug is inserted into the wall socket and the electricity supply is switched on. Avoid accidental disconnection by taping over the switch.

And note that:

- 5.** You will hear a noise as the compressor/fan starts up. The liquid and gases sealed within the refrigeration system may also make some noise, whether the compressor is running or not. This is quite normal.
- 6.** If you are going to freeze fresh food, you must press the fast-freeze button.
- 7.** We recommend setting the thermostat knob at $-18\text{ }^{\circ}\text{C}$ and monitoring the temperature to ensure the appliance maintains desired storage temperatures (see section "Temperature control and adjustment").
- 8.** Do not load the appliance immediately after it is switched on. Wait until the correct storage temperature has been reached. We recommend that you check the temperature with an accurate thermometer (see; Temperature Control and Adjustment).
- 9.** If you find the freezer door difficult to open just after you have closed it, don't worry. This is due to the pressure difference which will equalize and allow the door to open normally after a few minutes.
- 10.** You will hear a vacuum sound just after closing the door. This is quite normal.

Indicator lights

There are three coloured indicator lights located inside the appliance which show the operating mode of the freezer (**Fig. 2**).

Amber Indicator (1)

Illuminates when the **fast-freeze button (4)** is depressed and stays on for 34 hrs until the fast-freeze option is automatically de-activated; unless the button is depressed.

Green Indicator (2)

Illuminates when the appliance is connected to the mains and will glow as long as there is electricity present. The green indicator does not give any indication of the temperature inside the freezer.

Red Indicator (3)

Red indicator light has a built-in delay. Once switched on, it will not come on for 24 hours.

This indicator will glow when the internal temperature rises above -9°C and it will automatically de-activated when the internal temperature rises below -9°C

Thermostat knob (5)

The thermostat knob is located on the indicator light frame.

Important:

When you press the fast-freeze switch, there may be a short delay before the compressor starts to operate. This is normal and not a compressor fault.

- E0 blinks on display if there is a freezer sensor failure.

- E1 blinks on display if there is a defrost sensor failure.

Storing frozen food

Your freezer is suitable for the long-term storage of commercially frozen foods and also can be used to freeze and store fresh food.

Important Note:

If there is a power failure, do not open the door in order to preserve interior temperature. Frozen food should not be affected if the failure lasts for less than 10 hours. If the failure is longer, then the food should be checked and either eaten immediately or cooked and then refrozen.

Freezing fresh food

Please observe the following instructions to obtain the best results.

Do not freeze too much fresh food at the same time. The quality of the food is best preserved when it is frozen quickly.

The maximum amount of fresh food that can be frozen in 24 hrs. should not exceed the freezing capacity of your appliance.

Please avoid loading hot food into your appliance.

Do not close air flow channels while loading.

Fast freeze

If large amounts of fresh food is going to be frozen, push the fast freeze switch 8 hrs. before putting the fresh food in the fast freeze compartment.

It is strongly recommended to keep fast freeze switch on for 24 hrs. to freeze maximum amount of fresh food declared as freezing capacity.

Take special care not to mix frozen food and fresh food.

When fast freeze switch is on -27°C will flash for 5 seconds on **display (6)**. Fast-freeze operation is for freezing fresh food (see Freezing Fresh Food, section).

Making ice cubes

(Fig 3)

Fill the ice - cube tray 3/4 full with water and place it in the freezer. Loosen frozen trays with a spoon handle or a similar implement; never use sharp-edged objects such as knives or forks.

Defrosting

The appliance defrosts automatically. The water drains into a reservoir at the back of the appliance and evaporates automatically through the compressor heat.

Ensure that the reservoir is fixed properly above the compressor.

Getting to know your appliance

(Fig. 1)

1. Control Panel
2. Flap (Fast-Freeze compartment) (190 mm. height)
3. Ice cube tray & Ice bank
4. Big drawer (190 mm. height)
5. Big drawer (250 mm. height)
6. Small drawer (190 mm. height)
7. Air grille
8. Adjustable front feet
9. Slim pack storage pocket

Cleaning and care

1. We recommend that you switch off the appliance at the socket outlet and pull out the mains plug before cleaning.

2. Never use any sharp instruments or abrasive substances, soap, household cleaner, detergent or wax polish for cleaning.

3. Use lukewarm water to clean the cabinet of the appliance and wipe it dry.

4. Use a damp cloth wrung out in a solution of one teaspoon of bicarbonate of soda to one pint of water to clean the interior and wipe it dry.

5. Make sure that no water enters the temperature control box.

6. If the appliance is not going to be used for a long period of time, switch it off, remove all food, clean it and leave the door ajar.

7. We recommend that you polish the metal parts of the product (i.e. door exterior, cabinet sides) with a silicone wax (car polish) to protect the high quality paint finish.

8. Any dust that gathers on the condenser, which is located at the back of the appliance, should be removed once a year with a vacuum cleaner.

9. Check door seals regularly to ensure they are clean and free from food particles.

10. Never:

- Clean the appliance with unsuitable material; e.g. petroleum based products.

- Subject it to high temperatures in any way,
- Scour, rub etc., with abrasive material.

11. Make sure that the special plastic container at the back of the appliance which collects defrost water is clean at all times. If you want to remove the tray to clean it, follow the instructions below:

- Switch off at the socket outlet and pull out the mains plug

- Gently crimp the stud on the compressor, using a pair of pliers, so that the tray can be removed

- Lift it up.
- Clean and wipe it dry
- Reassemble, reversing the sequence and operations

12. To remove a drawer, pull it as far as possible, tilt it upwards and then pull it out completely.

Repositioning the door

Proceed in numerical order (**Fig. 4**).

Do's and don'ts

- Do-** Check contents of the freezer at regular intervals.
- Do-** Clean your freezer regularly (See "Defrosting")
- Do-** Keep food for as short a time as possible and adhere to "Best Before" and "Use By" dates.
- Do-** Store commercially frozen food in accordance with the instructions given on the packets.
- Do-** Always choose high quality fresh food and be sure it is thoroughly clean before you freeze it.
- Do-** Prepare fresh food for freezing in small portions to ensure rapid freezing.
- Do-** Wrap all foods in aluminium foil or freezer quality polyethylene bags and make sure any air is excluded.
- Do-** Wrap frozen food immediately after purchasing and put it in to the freezer as soon as possible.
- Do-** Separate food in the compartments and complete the contents card. This will enable you to find food quickly and avoid excessive door opening. This will save electricity.
- Don't-** Leave the door open for long periods, as this will cause electricity waste and excessive ice formation.
- Don't-** Use sharp-edged objects such as knives or forks to remove the ice.
Put hot food into the freezer. Let it cool down first.
- Don't-** Put liquid-filled bottles or sealed cans containing carbonated liquids into the freezer, as they may burst.
- Don't-** Store poisonous or dangerous substances in the freezer. Your freezer has been designed for the storage of edible foodstuffs only.
- Don't-** Exceed the maximum freezing capacity when freezing fresh food.
- Don't-** Consume ice-cream and water ices direct from the freezer. The low temperature may cause 'freezer burns' on lips.
- Don't-** Freeze fizzy drinks.
- Don't-** Try to keep frozen food which has thawed; it should be eaten within 24 hours or cooked and refrozen.
- Don't-** Remove items from the freezer with wet hands.
- Don't-** Close the door before replacing the fast-freeze compartment cover.
- Don't-** Remove the plastic cover on the rear wall.
- Don't-** Damage the pipes on the appliance.

Trouble - shooting

If the appliance does not operate when switched on, check;

- That the plug is inserted properly in the socket and that the power supply is on. (To check the power supply to the socket, plug in another appliance)*
- Whether the fuse has blown/circuit breaker has tripped/main distribution switch has been turned off.*
- That the temperature control has been set correctly.*
- That the new plug is wired correctly, if you have changed the fitted, moulded plug.*

If the appliance is still not operating at all after above checks, contact the dealer from whom you purchased the unit.

Please ensure that above checks have been done, as a charge will be made if no fault is found.