

Miele

Operating and Installation instructions

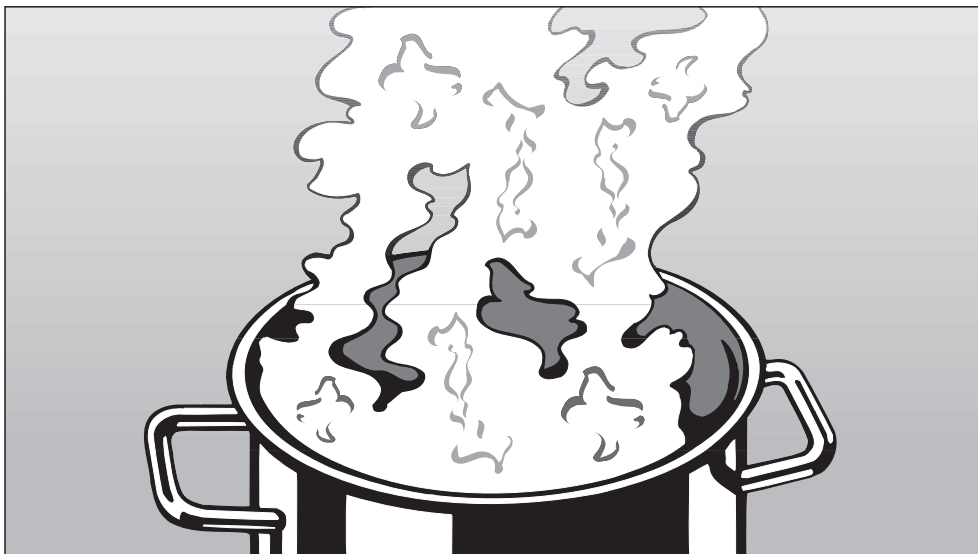

Rangehood DA 5320 W

To avoid the risk of accidents or damage to the appliance, it is **essential** to read these instructions before it is installed and used for the first time.

en - AU, NZ

M.-Nr. 09 730 370

Contents

Caring for the environment	3
Warning and Safety instructions	4
Guide to the appliance	10
Description of the functions	12
Miele@home	13
Con@ctivity	13
Operation	14
To switch the fan on	14
To select a power level	14
Run-on option	15
To switch the fan off	15
To switch the cooktop lighting on	16
To dim the cooktop lighting	16
To switch the cooktop lighting off	16
Filter operating hours counter	17
Cleaning and care	19
Housing	19
Grease filters	20
Changing a halogen lamp	22
After sales service	23
Appliance dimensions	24
Safety distance between cooktop and rangehood (S)	25
Installation	26
Assembly parts	26
Installation instructions	28
Protective foil	28
Dismantling	28
Electrical connection	29
Operation with Control module DSM 400	30
Potential free connection	30
Connection to a light switch	30
Connection for air extraction	31
Technical data	33

Disposal of the packing material

The transport and protective packing has been selected from materials which are environmentally friendly for disposal and can normally be recycled.

Ensure that any plastic wrappings, bags, etc. are disposed of safely and kept out of the reach of babies and young children. Danger of suffocation.

Rather than just throwing these materials away, please ensure they are offered for recycling.

Disposal of your old appliance or machine

Electrical and electronic appliances / machines often contain materials which, if handled or disposed of incorrectly, could be potentially hazardous to human health and to the environment. They are, however, essential for the correct functioning of your appliance or machine. Therefore, please do not dispose of your old machine or appliance with your household waste.

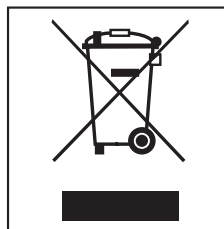

Please dispose of it at your local community waste collection / recycling centre and ensure that it presents no danger to children while being stored for disposal.

It should be unplugged or disconnected from the mains electricity supply by a competent person.

The plug must be rendered useless and the cable cut off directly behind the appliance or the machine to prevent misuse.

Warning and Safety instructions

This appliance complies with all relevant local and national safety requirements. Inappropriate use can, however, lead to personal injury and damage to property.

To avoid the risk of accidents and damage to the appliance, please read these instructions carefully before using it for the first time. They contain important information on the safety, installation, use and maintenance of the appliance.

Keep these instructions in a safe place and ensure that all users are familiar with the contents. Pass them on to any future owner of the appliance.

Correct application

► This rangehood is designed for domestic use and for use in similar environments by guests in hotel or motel rooms, bed & breakfasts and other typical living quarters. This does not include common/shared facilities or commercial facilities within hotels, motels or bed & breakfasts.

► It must only be used to extract vapours and remove odours from cooking.

► This appliance is not suitable for outdoor use.

► This appliance is not intended for use by persons (including children) with reduced physical, sensory or mental capabilities, or lack of experience or knowledge, unless they have been given supervision or instruction concerning its use by a person responsible for their safety.

► This appliance may only be used in mobile installations if a risk assessment of the installation has been carried out by a suitably qualified engineer.

Safety with children

► This appliance is only intended for use by adults who have read these instructions.

► This appliance is not a toy! To avoid the risk of injury keep children well away. Children should be supervised to ensure that they do not play with the appliance.

► Please be aware that on rangehoods with halogen lighting, the lamps will get very hot during use and remain hot for some time after switching off. To safeguard against burning, keep children well away from the lamps at all times.

Technical safety

► Before installation, check the rangehood for visible signs of damage. Do not install and use a damaged appliance. A damaged appliance is dangerous.

► Before connecting the appliance to the mains supply, make sure that the voltage and frequency details given on the data plate correspond with the on-site electricity supply, otherwise the appliance could be damaged. Consult a qualified electrician if in doubt.

► The electrical safety of this appliance can only be guaranteed when continuity is complete between the appliance and an effective earthing system which complies with current local and national safety regulations. It is most important that this basic safety requirement is present and tested regularly and, where there is any doubt, the household wiring system should be inspected by a qualified electrician. The manufacturer cannot be held liable for the consequences of an inadequate earthing system (e.g. electric shock).

► For safety reasons, this appliance may only be used when it has been fully installed.

► Only open the casing as described in the instructions given in the installation sheet and in the Cleaning and care section of this booklet. Under no circumstances should any other parts of the casing be opened. Tampering with electrical connections or components and mechanical parts is highly dangerous to the user, and can cause operational faults.

► Installation, maintenance and repairs may only be carried out by a suitably qualified and competent person in strict accordance with current national and local safety regulations. Repairs and other work by unqualified persons could be dangerous. The manufacturer cannot be held liable for unauthorised work.

► Faulty components must only be replaced by genuine Miele original parts. The manufacturer can only guarantee the safety of the appliance when Miele replacement parts are used.

► During installation, maintenance and repair work, the appliance must be disconnected from the mains electricity supply. It is only completely isolated from the electricity supply when:

- it is switched off at the isolator,
- the screw-out fuse is removed (in countries where this is applicable),
- the mains fuse is disconnected. Do not pull the mains connection cable but the mains plug to disconnect your appliance from the mains electricity supply.

Warning and Safety instructions

► Do not connect the appliance to the mains electricity supply by a multi-socket unit or an extension lead. These do not guarantee the required safety of the appliance (e.g. danger of overheating).

► This rangehood must not be installed and operated in mobile installations (e.g. on a ship).

► In areas which may be subject to infestation by cockroaches or other vermin, pay particular attention to keeping the appliance and its surroundings in a clean condition at all times. Any damage which may be caused by cockroaches or other vermin will not be covered by the warranty.

Using at the same time as other heating appliances that depend on the air from the room

Warning - danger of toxic fumes

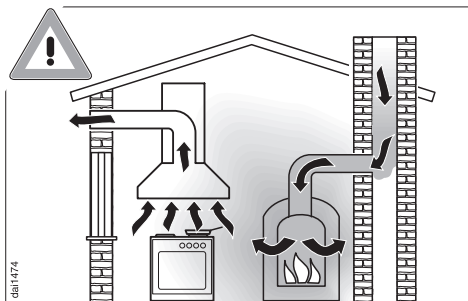

► Great care should be taken when using the rangehood at the same time and in the same room or area of the house as another heating appliance which depends on the air in the room. Such appliances include gas, oil, wood or coal-fired boilers and heaters, continuous flow or other water heaters, gas cooktops or ovens which draw air in from the room and duct exhaust gases out through a chimney or extraction ducting. When used in extraction mode, with or without an external motor fitted, the appliance draws air in from the room in which it is installed **and** from neighbouring rooms. If there is insufficient air, an underpressure will occur. The heating appliance may be starved of oxygen, impairing combustion.

Harmful gases could be drawn out of the chimney or extraction ducting back into the room, with potentially fatal consequences.

Warning and Safety instructions

In order to ensure safe operation, and to prevent gases given off by the heating appliances from being drawn back into the room when the extractor and the heater are in operation simultaneously, an underpressure in the room of 0.04 mbar (4 pa) is the maximum permissible.

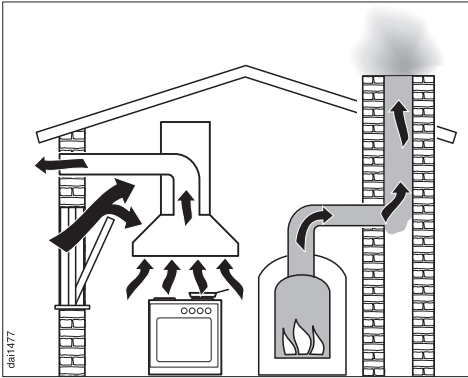

Ventilation can be maintained by air inlets which cannot be blocked, in windows, doors and outside wall vents, or by other technical measures, such as ensuring that the extractor can only be switched on when the heating appliance is switched off or vice versa. A ventilation brick alone is not generally sufficient to ensure safe ventilation.

 The overall ventilation condition of the dwelling must be taken into account. If in any doubt, the advice of a competent builder must be sought.

Warning and Safety instructions

Correct use

► Never use an open flame beneath the rangehood. To avoid the danger of fire, do not flambé or grill over an open flame.

When switched on, the rangehood could draw flames into the filter. Fat particles drawn into the rangehood present a fire hazard.

► When using the rangehood over a gas cooktop, ensure that any burners in use are always covered by a pan. Switch the cooking zone off when a pan is removed, even for a short time. Regulate the flame so that it does not burn up the sides of the pan. Do not allow the pans to overheat excessively (e.g. when using a wok). The rangehood can become damaged when exposed to excessive heat.

► Always switch the rangehood on when a cooking zone is in use, otherwise condensation may collect in the rangehood, which could cause corrosion.

► When cooking with oil or fat, chip pans and deep fat fryers etc, do not leave the pans unattended. Never leave an open grill unattended when grilling. Overheated oil and fat can ignite and could set the rangehood on fire.

► Do not use the rangehood without the filters in place. This way you will avoid the risk of grease and dirt getting into the appliance and hindering its smooth operation.

► The filters should be regularly cleaned or changed as appropriate. Saturated filters are a fire hazard. See "Cleaning and care".

► Do not use a steam-cleaner to clean this appliance. Pressurised steam could reach the electrical components and cause a short circuit.

Correct installation

► Refer to the rangehood or cooktop manufacturer's instructions as to whether a rangehood may be operated above the cooktop.

► The minimum safety distances between the top of the cooktop and the bottom of the rangehood given in the "Appliance dimensions" section of this booklet must be maintained, unless the cooktop manufacturer states that a greater safety distance is required.

► If more than one cooking appliance is fitted beneath the rangehood, and they have different minimum safety distances to the rangehood, select the greater distance.

Warning and Safety instructions

- ▶ Safety regulations prohibit the fitting of a rangehood over solid fuel stoves.
- ▶ All ducting, pipework and fittings must be of non-flammable material. These can be obtained from Miele or from builders' merchants.
- ▶ The appliance must not be connected to a chimney or vent flue which is in use. Neither should it be connected to ducting which ventilates rooms with fireplaces.
- ▶ If exhaust air is to be extracted into a chimney or ventilation duct no longer used for other purposes, seek professional advice.

Accessories

- ▶ Only use genuine Miele spare parts and accessories with this appliance. If spare parts or accessories from other manufacturers are used, this will invalidate the warranty, and Miele cannot accept liability.

The manufacturer cannot be held liable for damage caused by non-compliance with these Warning and Safety instructions.

Guide to the appliance

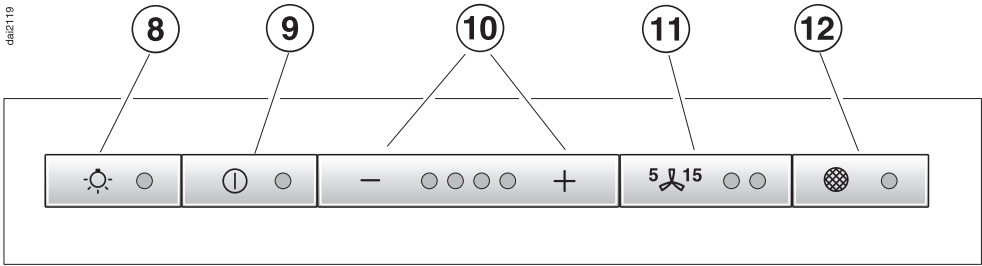
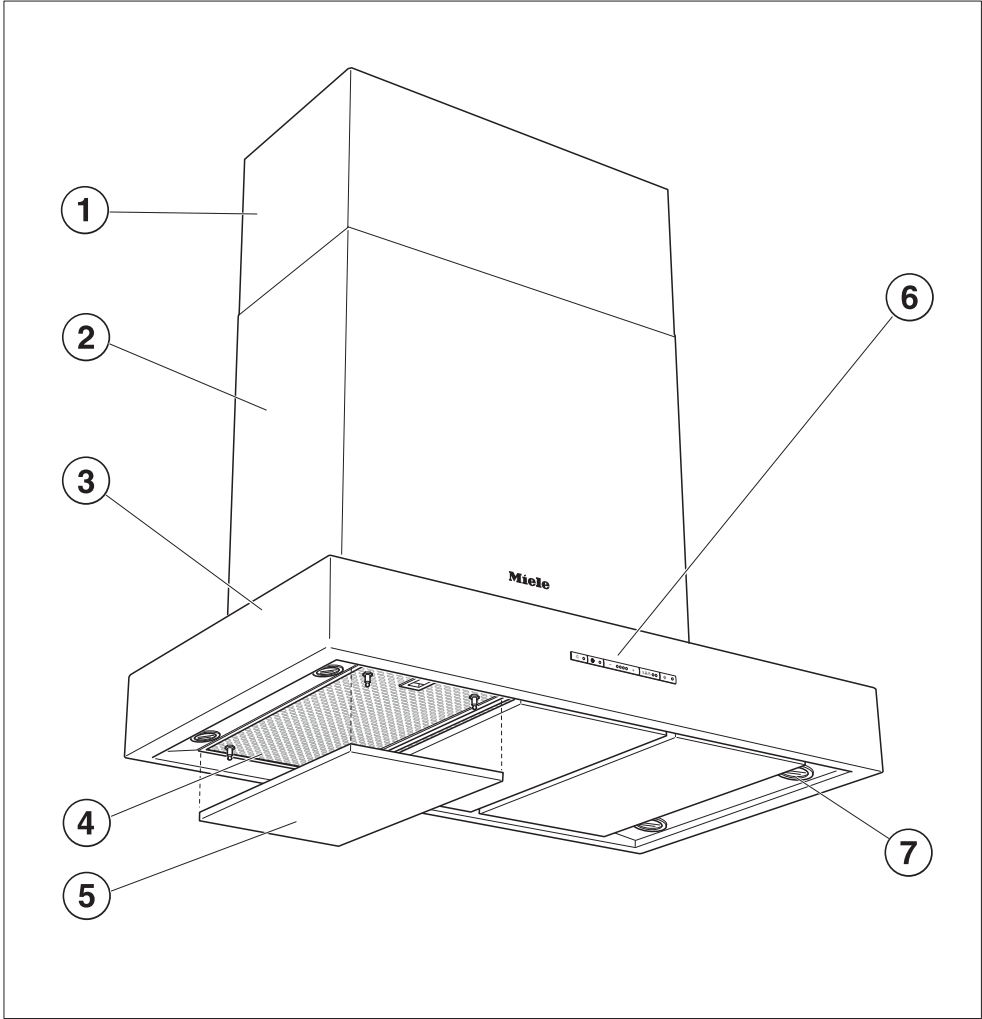

da2119

① **Telescopic extension piece**

② **Tower**

③ **Canopy**

④ **Grease filters**

⑤ **Decor panels** Miele DDW 53x0

(optional accessory)

4 panels are required for the DA 5320 W. These ensure optimum edge extraction of cooking vapours above an induction or ceramic cooktop.

⑥ **Control panel**

⑦ **Cooktop lighting**

⑧ **Touch control for the cooktop lighting**

This control switches the lighting on and off, and is also a dimmer switch.

⑨ **On/Off touch control for the fan**

⑩ **Controls to select fan power level**

⑪ **Touch control for the run-on option**

To activate the run-on option. The fan can be set to continue running, and to switch off automatically after either 5 or 15 minutes.

⑫ **Touch control for the grease filters**

The indicator lamp for the grease filters lights up when the grease filters need to be cleaned.

The touch control is used to reset the operating hours counter every time the grease filters are cleaned (see "Cleaning and care").

It can also be used to check and alter the operating hours counter.

For information about using the appliance, see "Operation".

Description of the functions

The rangehood works with

..... air extraction:

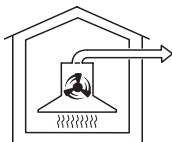

The air is drawn in and cleaned by the grease filters and directed outside.

Having a **non-return flap** fitted in the ducting ensures that air, once ducted to the outside, cannot get back into the room again.

The flap is closed when the rangehood is switched off.

When the rangehood is switched on, the non-return flap opens for the cooking vapours to be blown directly outside.

Please note, the performance of this rangehood hinges greatly on the installed ducting to vent the vapours. Poor choice of ducting results in poor rangehood performance. For ducting recommendations, please refer to the relevant section in these operating instructions or contact a specialised installer.

Con@ctivity

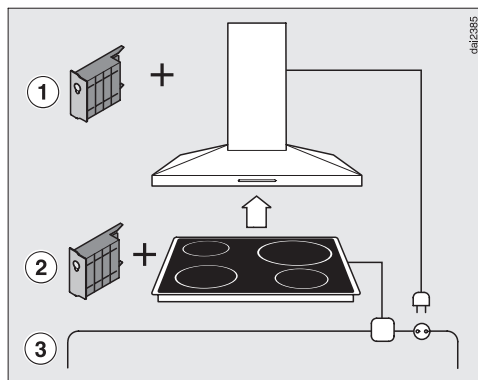

This rangehood is communication enabled.

Communication module XKM 2000 DA ①, available as an optional extra, enables the operation of the rangehood to be automatically controlled by the operating status of a Miele electric cooktop with onset controls.

For communication to take place, the cooktop must be fitted with communication module ②.

The cooktop transmits information about its operating status to the rangehood via the household power supply (Powerline) ③.

- When the cooktop is switched on, the cooktop lighting and the rangehood fan also switch on.
- During cooking the rangehood automatically sets the fan's power level according to the number of cooking zones in operation and their power levels.
- After switching the cooktop off, the fan and the cooktop lighting will switch off automatically after a period of time.

For detailed information about this function, please read the separate instruction booklet supplied with the XKM 2000 DA communication module.

The communication module is fitted to the rangehood in the area of the fan and is connected to the controls of the rangehood.

This module must be installed by a Miele service technician or suitably qualified electrician.

Operation

To switch the fan on



- Press the On/Off control.

The fan runs at power level "II".
The indicator lamp will come on.

To select a power level



- Use the – / + controls to select the power level required.

+ control = higher setting

– control = lower setting

Depending on the intensity of cooking vapours, levels "I" to "III" are usually sufficient for normal cooking.

Intensive setting

When frying or cooking food with a strong aroma, you may wish to select the Intensive setting, level IV for a short period.

Automatic switch-off of the Intensive setting

You can set the Intensive setting so that it only runs for 10 minutes before reverting automatically to level III.

- To set this option, both the fan and the cooktop lighting must be switched off.



- Press the run-on option control for approximately 10 seconds. The first fan setting indicator will light up.
- Then press in turn,



- the cooktop lighting control,



- the – control, and



- the cooktop lighting control again.



The indicator lamps for fan power levels I and IV will flash if the automatic switch-off for the Intensive setting is not activated.

- Press the **+** control to activate the automatic switch-off.

The indicator lamps for fan power levels I and IV will now light up constantly.

Press the **–** control to deactivate the automatic switch-off function.



- Press the run-on option control to confirm your selection.

If you do not confirm your selection within 4 minutes, the rangehood will automatically revert to the original setting.

Run-on option

It is advisable to leave the fan running for a few minutes after cooking has finished to neutralise any lingering odours in the air.

The fan can be set to switch off automatically after either 5 or 15 minutes:



- After cooking has finished, press the run-on option control whilst the fan is still running.
 - Press once = The fan will switch off after 5 minutes (left-hand indicator lamp).
 - Press twice = The fan will switch off after 15 minutes (right-hand indicator lamp).

To switch off the run-on option, press the run-on option control again. The appliance will then not switch off automatically.

To switch the fan off



- Press the On/Off control to switch the fan off.

The indicator lamp will go out.

Operation

To switch the cooktop lighting on

The cooktop lighting can be switched on and off independently of the fan.



- **Briefly** press the cooktop lighting control to switch on the cooktop lighting.

The indicator lamp will come on.

The lighting will switch on at maximum brightness.

To dim the cooktop lighting

The brightness of the lighting can be adjusted.

- With the lighting switched on, press and hold the cooktop lighting control in.
The brightness will gradually dim until you release the control.
- Press the control in again to increase the brightness to the level required, and then release it.

If you keep the control pressed in, the light will continually change between bright and dim.

To switch the cooktop lighting off

- **Briefly** press the cooktop lighting control to switch the lighting off.

The indicator lamp will go out.

Safety cut-out

Should the rangehood be left on, the fan will switch off automatically after 10 hours. The lighting will remain on.



- Pressing the On/Off control will switch the fan back on again.

Filter operating hours counter

The number of hours the appliance has been in operation is stored in memory.

The operating hours counter tells you when the grease filters need to be cleaned.

Resetting the operating hours counter for the grease filters



After 30 hours of operation (or another time if the operating hours counter has been altered), the grease filter indicator lamp will light up. The grease filters must then be cleaned.

Afterwards, the filter operating hours counter must be reset.

- To do this, press and hold the grease filter control in for approximately 3 seconds while the fan is switched on.

The indicator lamp for the control will go out.

Reading the filter operating hours counter

To check the percentage of time set already used:



- Press the On/Off control to switch the fan on.



- Press and hold the grease filter control.



One or more of the indicator lamps for the - / + controls will flash.

The number of flashing lamps shows the percentage of the operating time which has already been used up.

1 lamp	=	25 %
2 lamps	=	50 %
3 lamps	=	75 %
4 lamps	=	100 %

The number of operating hours used remains in the memory, even when the appliance is switched off or there is a power cut.

Operation

Altering the filter operating hours counter

The filter operating hours counter is set at 30 hours. This can be lengthened or shortened to suit the type of cooking you do. You can choose 20, 30, 40 or 50 hours

- Select a short time if you roast or fry a lot.
- If you use very little fat for cooking, select a longer time.
- If you only cook occasionally we recommend that you still select a short time, because grease which has built up gradually over a long period of time will harden on the grease filters and make cleaning more difficult.



- Press the On/Off control to switch the fan off.



- Press the run-on option control and the grease filter control at the same time.

The indicator lamp for the grease filter control and one of the – / + indicator lamps will flash.



The – / + indicator lamps show the time which has been set:

- 1st lamp from the left = 20 hours
- 2nd lamp from the left = 30 hours
- 3rd lamp from the left = 40 hours
- 4th lamp from the left = 50 hours

- Use the – / + controls to select the desired time.



- Confirm the selection by pressing the grease filter control.

All the indicator lamps will go out.

If you do not confirm your selection within 4 minutes, the rangehood will automatically revert to the original setting.

 Before any cleaning or maintenance work is carried out, disconnect the rangehood from the mains supply.

Ensure that:

- it is switched off at the isolator, or
- it is switched off at the wall socket and the plug removed, or
- the mains fuse is withdrawn, or
- the screw-out fuse is removed (in countries where this is applicable).

Do not use too much water when cleaning the controls. Water could penetrate into the electronics and cause damage.

Do not use:

- cleaning agents containing soda, acids, chlorides or solvents,
- abrasive cleaning agents e.g. powder cleaners or cream cleaners, and abrasive sponges, e.g. pot scourers or sponges which have been previously used with abrasive cleaning agents. These will damage the surface material.

A range of Miele branded cleaning and conditioning agents are available to order through your Miele Chartered Agent, from Miele, or via the internet at www.miele-shop.com.

Housing

General notes

The surfaces and controls are susceptible to scratches and abrasions. Please observe the following cleaning instructions.

- All external surfaces and controls can be cleaned using the Original Miele all purpose microfibre cloth or with warm water and a small amount of washing-up liquid applied with a well wrung-out soft sponge or cloth.
- Wipe the surfaces dry using a soft cloth.

Important for appliances with stainless steel housing

(This information does not apply to the controls)

Stainless steel surfaces can be cleaned using the Original Miele all purpose microfibre cloth, or with a proprietary non-abrasive cleaning agent designed specifically for use on stainless steel.

To help prevent re-soiling, a conditioning agent for stainless steel can also be used. Follow the manufacturer's instructions on the packaging.

Cleaning and care

Important for appliances with lacquered housing

(special order finish)

It is very difficult to clean this type of surface without causing minor marks to the surface material. This can become particularly noticeable with darker colours and if there is halogen lighting in the kitchen.

Controls

The controls may suffer discolouration or damage if soiling is left on them for too long. Remove soiling straight away.

Observe the General notes on cleaning earlier in this section.

Do not use stainless steel cleaning agents on the controls.

Grease filters

The re-usable metal grease filters in the appliance remove solid particles (grease, dust, etc.) from the kitchen vapours, preventing soiling of the rangehood.



To avoid a build-up of grease, the grease filters should be cleaned regularly (at least every 3-4 weeks), but always clean immediately if the grease filter indicator lamp comes on.

 An oversaturated filter is a fire hazard.

If decor panels are fitted as an optional extra, these need to be removed first.

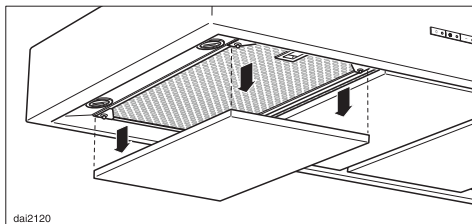

- To do this, disengage them from their catches.
- See the notes under "Housing" for how to clean the decor panels. Like the grease filters, they can be cleaned in the dishwasher.

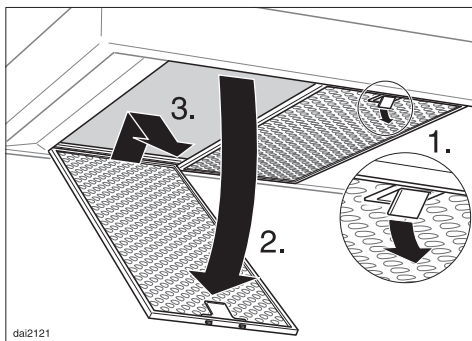

- To take out the grease filters, release the locking clip on the filter, lower the filter 45°, unhook it at the back and remove it.

To avoid damaging the filters or the cooktop below, make sure you hold the filters securely at all times when handling them.

Cleaning the grease filters by hand

- Clean the filters with a soft nylon brush in a mild solution of hot water and a small amount of washing-up liquid.
Do not use undiluted washing up liquid.

Do not use:

- cleaning agents containing descaling agents,
- powder cleaners, cream cleaners or abrasive all-purpose cleaning agents,
- oven sprays.

Cleaning the grease filters in the dishwasher

- Place the filters as upright as possible in the lower basket. Ensure the spray arm is not obstructed.
- Do not wash at more than 65 °C. If a Miele dishwasher is being used, select the Sensor wash programme.
- Use a mild dishwasher detergent.

Depending on the cleaning agent used, cleaning the filters in a dishwasher can cause permanent discolouration to the surface. However, this will not affect the functioning of the filters in any way.

- After cleaning, leave the filters to dry on an absorbent surface before replacing them.

When removing the filters for cleaning, also clean off any residues of oil or fat from the now accessible housing to prevent the risk of these catching fire.

When putting the grease filters back in position, ensure that the locking clips are facing down towards the cooktop.

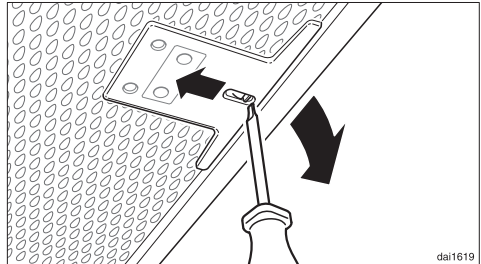

If a grease filter is inadvertently replaced upside down, insert a small screwdriver blade into the slit to disengage the clip.

- After replacing the grease filters, press the grease filter control for approximately 3 seconds to reset the operating hours counter. The indicator lamp will go out.

If the grease filters are cleaned **before** the operating hours counter has reached its maximum, the grease filter control should be pressed for approximately 6 seconds to reset the counter.

Cleaning and care

Changing a halogen lamp

- Before any cleaning or maintenance work, disconnect the rangehood from the mains supply. Ensure that:
 - it is switched off at the isolator, or
 - it is switched off at the wall socket and the plug is withdrawn, or
 - the mains fuse is disconnected, or
 - the screw-out fuse is removed (in countries where this is applicable).

 Exercise caution when changing halogen lamps. They get very hot during use and remain hot for some time after being switched off. Let them cool down before you change them.

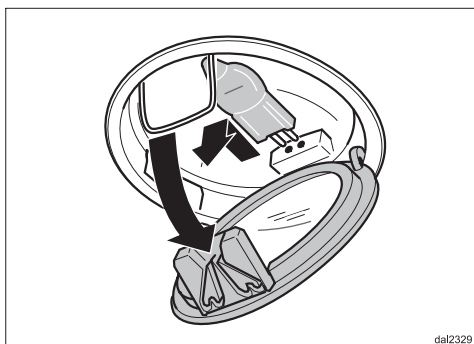
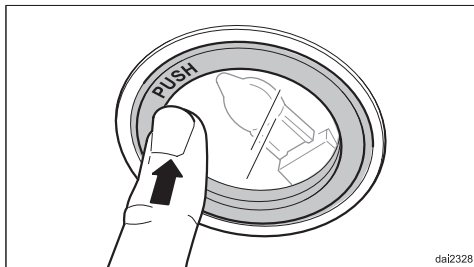

- To access the halogen lamp, push the lamp cover gently upwards. The cover will open and can be pulled down.
- Pull the old halogen lamp out of the connection socket.
- Using a cloth or glove, push the new lamp (12 V, 20 W, G4 cap) carefully into the connection socket. Please follow the manufacturer's instructions.
- Push the cover back up and make sure it clicks into place.

In the event of a fault which you cannot correct yourself, please contact:

– Miele

You will find the telephone number and address of Miele on the back cover of the manual.

Please quote the model and serial number when contacting Miele. These are shown on the data plate which is visible when the grease filters are removed.

Warranty

The warranty for this appliance is 2 years.

For further information, please refer to your warranty booklet.

Appliance dimensions

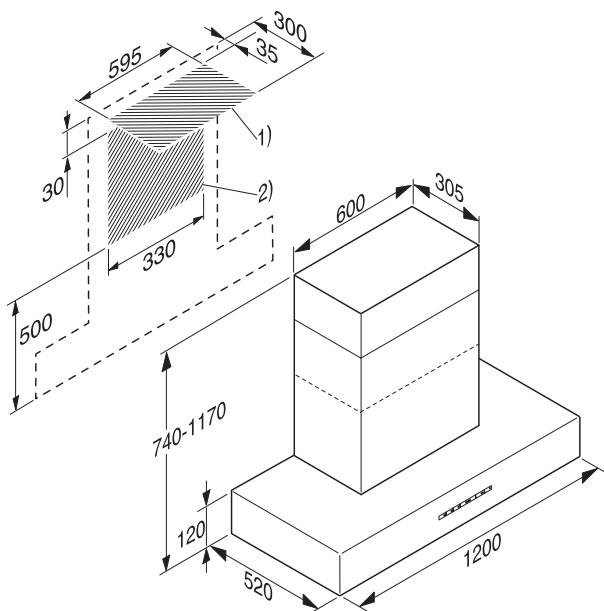

DA 5320 W

The shaded areas 1) and 2) represent the wall or ceiling area for the vent cut-out, for feeding the connection cable through to an external fan and for fitting the connection socket.

Connection for air extraction

Ø 200 mm

Safety distances between cooktop and rangehood (S)

The minimum safety distances between the top of a cooktop and the bottom of the rangehood are as follows, unless a greater distance is specified by the manufacturer of your cooking appliance:

Cooking appliance	Distance S
Electric cooktop	600 mm
Open electric grill	650 mm
Deep fat fryer (electric)	650 mm
Multi-burner gas cooktop with maximum 45.4 MJ/h total output, with no burner having a greater output than 16.2 MJ/h.	650 mm
Multi-burner gas cooktop with total output greater than 45.4 MJ/h, or a gas cooktop including a single burner with an output greater than 16.2 MJ/h.	760 mm
Single gas cooktop with a maximum output of 21.6 MJ/h	650 mm
Single gas cooktop with a maximum output greater than 21.6 MJ/h	760 mm

See "Warning and Safety" instructions for further information.

- Account should also be taken of the height of the person who will be using the rangehood most often. The person should have sufficient space to work comfortably at the cooktop, and also be able to reach the rangehood controls with ease.
- If positioned too high, extraction will be inefficient.
- If you want the top of the rangehood to be mounted flush with the ceiling, make sure there is adequate space below it for working. See maximum/minimum appliance height!

Installation

Assembly parts

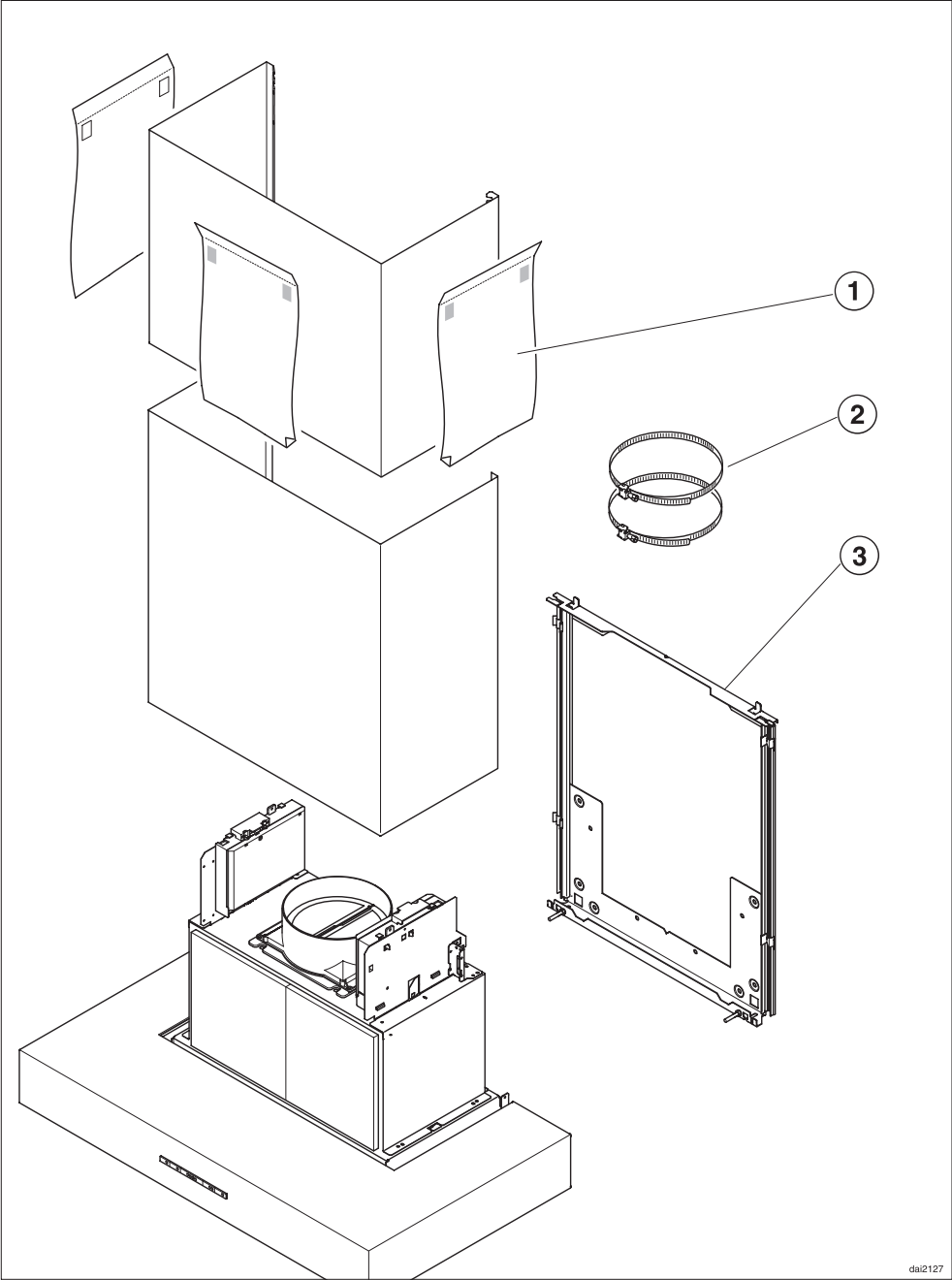

① **3 protective sheets**

for use when fitting the tower.

② **2 hose clips**

for securing the exhaust ducting.

③ **1 reducing collar**

for exhaust ducting Ø 150 mm.

④ **Telescopic wall bracket**

for securing the rangehood to the wall.

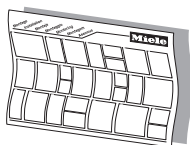

2 screws 3.9 x 7.5 mm

for securing the tower.

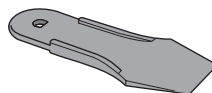

1 lever

for dismantling the tower.

Installation instructions

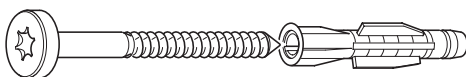

6 screws 5 x 60 mm and

6 plugs 8 x 50 mm for securing the bracket to the wall.

⚠ The screws and plugs are designed for use in solid walls only. For other types of wall construction, alternative fixings will be required. Make sure that the wall is able to take the weight of the rangehood.



2 x M 6 self-tapping nuts

for securing the appliance.

Installation

Before installation, it is important to read the information given on the following pages as well as the "Appliance dimensions" and the "Warning and Safety instructions" at the beginning of this book. This is particularly crucial when using the rangehood at the same time as a heating appliance that relies on air from the same room, as this could result in the build-up of toxic fumes.

Installation instructions

See enclosed Installation sheet for instructions on how to install this appliance.

Protective foil

(on stainless steel appliances)

The housing components have protective foil around them to prevent them being damaged during transport.

Please remove this foil before fitting the housing components. It can be peeled off easily.

Dismantling

Should the appliance ever need to be dismantled, follow the installation instructions in reverse order as described on the installation sheet.

A lever is supplied to assist with the removal of the tower.

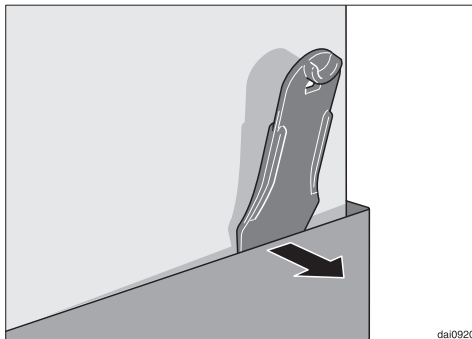

- After loosening the fixing screws on the tower, push the lever between the tower and the extension piece to lever the tower out of its fixings.

All electrical work should be undertaken by a suitably qualified and competent person in strict accordance with current national and local safety regulations.

Installation, repairs and other work by unqualified persons could be dangerous, for which the manufacturer cannot be held liable.

Ensure power is not supplied to the appliance until after installation or repair work has been carried out.

Do not connect the appliance to the mains electricity supply by an extension lead. These do not guarantee the required safety of the appliance.

The connection data is given on the data plate. This is visible when the grease filters have been removed. Ensure that this data matches the household mains supply.

Connection of this appliance should be made via a suitable isolator which complies with national and local safety regulations and the On-Off switch should be easily accessible after the appliance has been built in.

If the switch is not accessible after installation, an additional means of disconnection must be provided for all poles.

For extra safety, it is advisable to install a suitable residual current device (RCD). Contact a qualified electrician for advice.

Important

This appliance is supplied for connection to an AC 230 V single phase 50 Hz supply.

The wires in the mains lead are coloured in accordance with the following code:

Green/yellow	= earth
Blue	= neutral
Brown	= live

WARNING:
THIS APPLIANCE MUST BE
EARTHED

If the connection cable is damaged, it must be replaced by the manufacturer or similarly qualified persons to avoid a hazard.

Operation with Control module DSM 400

The Miele DSM 400 Control module can be used to combine the rangehood with other components.

It enables the following:

Potential free connection

This is used for controlling another appliance with the help of the rangehood's On/Off button ①.

If in any doubt, the advice of a competent builder must be sought.

Connection to a light switch

The control module can be used to switch on the rangehood lighting and also to dim it, depending on model, via a light switch in the house.

Installation

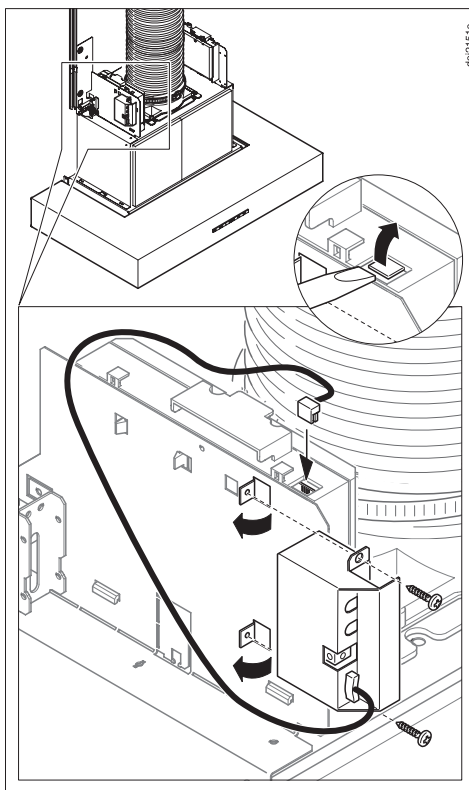

The tower needs to be removed before the control module can be fitted to the fan unit.

All electrical work must be carried out by a competent, qualified electrician.

⚠ Important: To avoid the danger of toxic fumes, please observe the Warning and Safety instructions. This is especially crucial when using the rangehood at the same time as another heating appliance which relies on air from the same room. The rangehood should be installed according to local and national building regulations. Seek approval from the building inspector where necessary.

- All ducting, pipework and fittings must be of non-flammable materials.
- The exhaust ducting should be as short and straight as possible.
- Only use rigid ducting fixed into place.
- To ensure efficient air extraction, the diameter of the exhaust ducting should not be less than 200 mm.

If exhaust ducting with a diameter of less than 200 mm, or if flat ducting is used, the noise level of the rangehood will increase and extraction will be less efficient.

- Only reduce the diameter of the ducting if absolutely necessary, e.g. where narrower ducting has already been installed.
- Only use wide radius bends. Tight bends reduce the air throughput of the rangehood.
- Only use smooth pipes or flexible hoses made from non-flammable materials for extraction connection.

If the exhaust ducting is secured to the exhaust stub by a hose clip, ensure that it is fitted correctly and is not askew. Do not overtighten. Otherwise the exhaust stub could buckle and the non-return flap could become jammed.

- When ducting is horizontal, it must be laid to slope away at at least 1 cm per metre to ensure no condensate drains into the appliance.

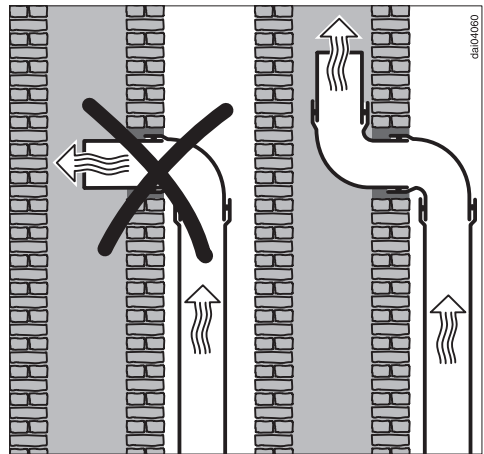

- If the exhaust air is to be ducted into a vent flue, the ducting must be directed in the flow direction of the flue.

Important

If the exhaust ducting is to run through rooms, ceiling space etc. where there may be great variations in temperature between the different areas, the problem of condensation will need to be addressed. The exhaust ducting will need to be suitably insulated.

Connection for air extraction

For exhaust ducting with a diameter of 200 mm, the following accessories are required:

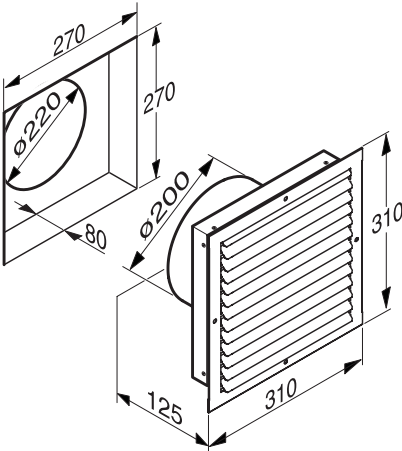

- Exhaust hose DAS 200
- Exhaust grille DFG 200, for mounting on the external wall.

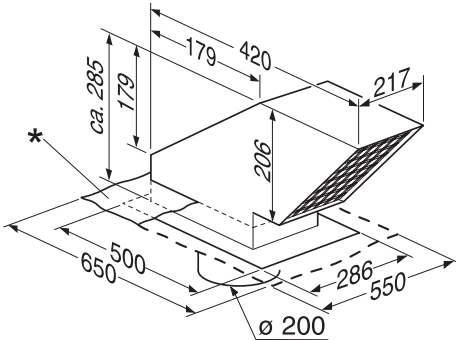

*Lead flashing

- Roof ducting DDF 200, for mounting on a sloping tiled roof.
- Reducing collar for the exhaust stub if using exhaust ducting with a 150 mm diameter.

Total rated load	
- DA 5320 W	600 W
Fan	500 W
Cooktop lighting	
- DA 5320 W	5 x 20 W
Voltage	230 V
Frequency	50 Hz
AUS, NZ:	
Plug rating	10 A
Test marks	Electrical safety C-Tick Mark
Electrical cable length	1.5 m

Fan performance

Extraction power according to
EN 61591

Extraction system Ø 200 mm:

Level I	350 m ³ /h
Level II	600 m ³ /h
Level III	850 m ³ /h
Level IV Intensive Setting	1,300 m ³ /h

Extraction system Ø 150 mm:

Level I	300 m ³ /h
Level II	500 m ³ /h
Level III	700 m ³ /h
Level IV Intensive Setting	1,000 m ³ /h

Miele Australia Pty. Ltd.

ABN 96 005 635 398



Miele Center and Head Office Melbourne:

1 Gilbert Park Drive
Knoxfield, VIC 3180

Miele Center and Office Melbourne:

208-210 Coventry Street
South Melbourne, VIC 3205

Miele Center and Office Sydney:

3 Skyline Place
Frenchs Forest, NSW 2086

Miele Center and Office Brisbane:

39 Harvey Street North
Eagle Farm, QLD 4009

Miele Center and Office Adelaide:

83-85 Sir Donald Bradman Drive
Hilton, SA 5033

Miele Center and Office Perth:

205-207 Stirling Highway
Claremont, WA 6010



www.miele.com.au



Miele New Zealand Limited Miele Center and Head Office

8 College Hill
Freemans Bay
Auckland 1011
New Zealand
Telephone: 0800 264 353
www.miele.co.nz

Miele Global Headquarters Germany

Miele & Cie. KG
Carl-Miele-Straße 29
33332 Gütersloh
Federal Republic of Germany