

RECARO



Child Safety Seats

Performance BOOSTER / ProBOOSTER XL Instruction Manual



High Back Belt-Positioning Booster Child Restraint System

Approved in accordance with Federal Motor Vehicle Safety Standard 213. Tested in accordance to ISO/TC 22/SC 12/WG 1 N538 side impact protection requirements.

Only suitable for use in vehicles with a lap and shoulder (3-point) seat belt system.

Use the child restraint only with children who weigh between 30 and 120 pounds (13.6 and 54.4 kg) and whose height is between 37 and 61 inches (94 and 154cm)

Suitable only for forward-facing installation.

El manual de instrucciones Performance BOOSTER / ProBOOSTER XL esta disponible en español en www.recaro-cs.com. Por favor visite el internet para bajar una versión en español.



Please read instructions prior to installation. Store this manual in the seat base.



Contents

Section 1: Safety Warnings	p. 4-5
Section 2: General Information	p. 6
Section 3: Register your New Performance BOOSTER / ProBOOSTER XL	p. 7
Section 4: Certification	p. 8
Section 5: Use in an Aircraft.....	p. 8
Section 6: Learning about Your Vehicle	p. 9-11
Section 7: Getting to Know Your New Child Seat.....	p. 12-17
Section 8: Adjusting the Child Seat to Fit Your Child Head Restraint Adjustment	p. 18-20
Section 9: Positioning the Child Restraint in Your Vehicle	p. 21
Section 10: Belt Routing and Positioning Around Your Child ...	p. 22-25
Section 11: Care and Maintenance.....	p. 26-27
Section 12: Trim Cover Removal / Installation	p. 28-31
Section 13: Troubleshooting.....	p. 32-33
Section 14: Warranty	p. 34-35
Section 15: Replacement Parts.....	p. 36
Section 16: Additional Contact Information	p. 37
Section 17: Glossary	p. 38-40

Dear Parents,

Welcome to the RECARO family of high quality child safety products and thank you for purchasing your new RECARO child restraint system.

RECARO has over 100 years experience in the design and manufacture of premium automotive products. To assure all products RECARO manufactures are worthy of the name, we've subjected them to a comprehensive development program complying with American FMVSS 213 safety standards. RECARO is also ISO 9001 certified which helps assure the most comprehensive product development system available.

Although each RECARO child restraint system is equipped with state-of-the-art safety features such as Side Impact Protection (SIP), it is not a guarantee that this child restraint will prevent injury or death. However, if you stress careful driving and proper use of your child restraint, it can lower the risk of injury or death.

Therefore, please make sure to carefully review all information in this instruction manual to properly restrain your child. Also, before using your new child restraint for the first time, please review all components carefully to make sure nothing has been damaged during shipping. Failure to follow these instructions and the labels on the seat can result in serious injury or even death.

The RECARO child restraint you have purchased is a high quality product.

Its different settings and its stable ergonomic design ensures that the RECARO child restraint is a safe and comfortable place for your child to sit when traveling in your car. However, before you use it, you need to adjust it to your child's size and then install it carefully so that the child restraint will perform as required. These instructions will help you do this, so please read them carefully.

Remember, parents are a child's best examples. Be sure to ALWAYS buckle your seat belt and your children will be much more likely to do the same. Thank you again for choosing RECARO and enjoy your new car seat! If you have any questions or need assistance of any kind, please contact us at:

RECARO Child Safety, LLC
1600 Harmon Road
Auburn Hills, MI 48326

Tel: 1-888-9RECARO
Internet: www.recaro-cs.com
E-mail: info-usa@recaro-cs.com

El manual de instrucciones Performance BOOSTER / ProBOOSTER XL esta disponible en español en www.recaro-cs.com. Por favor visite el internet para bajar una versión en español.

Yours sincerely,

The RECARO Child Safety Team

Section 1: Safety Warnings

WARNING! DEATH or SERIOUS INJURY can occur

- Do **NOT** place a child in the child seat in the front seat of a vehicle with a passenger airbag. The back seat is the safest place for children under 12 years of age.
- According to accident statistics, children are safer when properly restrained in the rear seating positions than in the front seating positions.
- Use this child restraint **ONLY** with children who weigh between **30 and 120 pounds (13.6 and 54.4 kg)** and whose height is between **37 and 61 inches (94 and 154cm)**.
- Discontinue use of your Performance BOOSTER / ProBOOSTER XL child restraint that is older than **six (6) years** or has been in a severe crash to prevent injury due to deterioration or hidden damage. See manufactured in date located on the restraint.
- Use only the vehicle's 3 point (lap-shoulder) belt when securing the child in this restraint.
- Restraint systems should be securely belted to the vehicle even when they are not occupied, since in a crash an unsecured child restraint system may injure other occupants.
- Before each use, inspect the child restraint. Make sure nothing on the child restraint is damaged, loose or broken. If anything on the restraint appears damaged, loose or broken, do **NOT** use the restraint.
- Do **NOT** use this child restraint system until you have read and understood the instructions in this manual and in your vehicle owner's manual. Do **NOT** let others install or use this child restraint system unless they understand how to use it.
- The Performance BOOSTER / ProBOOSTER XL's owner's manual should be stored in the manual pocket on the side of the child restraint.

WARNING! DEATH or SERIOUS INJURY can occur

- Do **NOT** make any technical modifications to the child restraint system and use it only as outlined in these instructions. Otherwise, the safety function of the seat will be reduced or completely voided.
- This high back belt-positioning booster is only to be used as a complete assembly of the backrest and seat cushion. Do **NOT** use the seat cushion alone without the backrest.
- This restraint is **NOT** certified for aircraft use because this child restraint system requires a lap **AND** shoulder belt.
- This child restraint must **NOT** be used in the home, boats or other non-certified applications.
- Do **NOT** add accessories, toys, padding or other items to this child restraint unless provided by RECARO.
- **NEVER** allow a child to play with this child restraint, it is **NOT** a toy.
- **NEVER** leave a child unattended in the child restraint even when sleeping.
- Do **NOT** lubricate any part of this child restraint.
- If the child restraint was occupied during a crash or vehicle accident, it must be replaced. Do **NOT** use the child restraint again. A crash can cause unseen damage and using it again can cause serious injury or death.
- If the child restraint was in the vehicle unoccupied during a crash and no airbags were deployed, it does not need to be replaced.
- Failure to follow warnings on the child restraint labels could cause serious injury or death.
- There is no guarantee that this child restraint will prevent injury or death in a particular crash. However, if you stress careful driving and proper use of your child restraint, it can lower the risk of injury or death in most crashes.

Section 2: General Information

Extreme Weather

When it is **hot**, RECARO recommends the following tips to reduce possible injury or discomfort to your child:

- Park your vehicle in the shade to help keep the restraint cooler.
- Cover the child restraint with a sheet or blanket when not in use.
- **ALWAYS** check surface temperatures of the child restraint before placing a child in it.

NEVER, EVER leave your child unattended in your vehicle, no matter how long or even if the windows are left open. NHTSA studies show that heat stroke is the leading cause of non-crash vehicle deaths for children.

Section 3: Register Your New Performance BOOSTER / ProBOOSTER XL

Child restraints could be recalled for safety reasons. You must register this restraint to be reached in a recall. Send your name, address, email address if available, and the restraint's model number, serial number and manufacturing date to:



RECARO Child Safety, LLC
1600 Harmon Road
Auburn Hills, MI 48326



or call: 1-888-9RECARO



or register online at: www.registry.recaro-cs.com
E-mail: info-usa@recaro-cs.com

For recall information, call the U.S. Government's Vehicle Safety Hotline at 1-888-327-4236 (TTY: 1-800-424-9153), or go to <http://www.NHTSA.gov>.

ALL information provided to RECARO on the registration card or on the online registry will ***NOT*** be sold, distributed, or used for any purposes other than to contact you in the event of a recall.

Section 4: Certification

This child restraint conforms to all applicable Federal Motor Vehicle Safety Standards.

Section 5: Use in an Aircraft





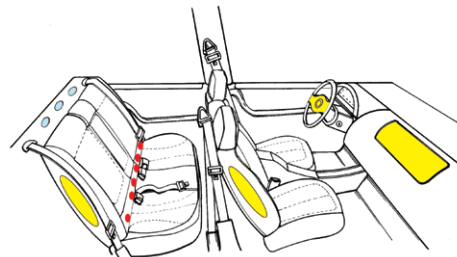

This child restraint is **NOT** certified for use in aircraft. Do **NOT** use this child restraint in an aircraft because it is a high back belt-positioning booster which requires both a lap and shoulder seat belt. Aircraft generally do not provide a shoulder belt.

Section 6: Learning About Your Vehicle

It is important to become familiar with the features of your vehicle so that your child rides as safely as possible. Read the vehicle owner's manual to learn about the safety features and adjustments available for safe travel. Below is a diagram that helps you to identify key features. Not ALL vehicles will have all features described here.



-  Airbags
-  Top Tether Anchorage*
-  Lower Latch Anchorage*
-  Seat Belts

NOTE: Top Tether and Lower latch anchorages are **NOT** used with this high back belt-positioning booster seat. These items are shown for reference only.

Some vehicles may have inflatable seat belts. As this is new technology, please refer to www.recaro-cs.com for updates.

NOTE: Because the design and operation of vehicle belts vary, make sure to observe the following guidelines:



- Warning! Use only the vehicle's lap and shoulder belt (or "3-point") system when restraining the child in this high back belt positioning booster seat.



- Do **NOT** use a lap belt only. The center rear seating position can be used **ONLY** if there is a lap and shoulder belt (3-point) seat belt in that seating position. Do **NOT** use the center rear position if there is a lap belt only.



- Do **NOT** use motorized passive restraint shoulder belt systems.

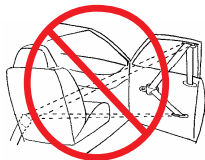

- Do **NOT** use passive restraints lap or shoulder belt mounted on a door.

Forward-facing vehicle seats must **ALWAYS** be used with this child restraint. Do **NOT** install this child restraint into any of the following types of seating positions:



- **ALWAYS** install this child restraint system forward-facing.



- **NEVER** install the BOOSTER rear-facing.



- **NEVER** install the BOOSTER in the rear seat of small extended cab pickups if the BOOSTER seat base is not fully supported.

- **NEVER** install the BOOSTER side-facing.

If your vehicle does not have rear seats, consult your vehicle owner's manual to help identify safety features in your vehicle or contact the vehicle manufacturer.

RECARO and the U.S. Department of Transportation warn that children 12 and under must ride in the rear seats, away from front airbags. The only exception is if the airbag is turned off.

Section 7: Getting to Know Your Performance BOOSTER / ProBOOSTER XL

This child restraint system is known as a high back belt-positioning booster seat. A high back belt-positioning booster seat is designed for use with your vehicle's lap and shoulder (3-point) seat belt system.

A high back belt-positioning booster helps to locate the vehicle seat belt system properly across a child who has out-grown both an infant carrier and a convertible seat. Vehicle seat belts are designed to protect adults and when used on a child without a belt-positioning booster they can do more harm than good.

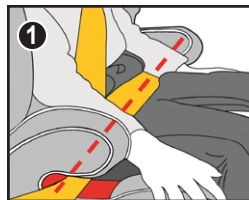

1. A proper high back belt-positioning booster fit should allow the lap portion of the vehicle seat belt system to fit low and snug across the lap or upper thigh area of the child. The lap portion of the vehicle seat belt system should **NEVER** be located across the abdomen or 'belly' area of the child.



2. A proper high back belt-positioning booster fit will also allow the shoulder portion of the vehicle seat belt system to fit snug across the chest and collarbone of the child. The shoulder portion of the vehicle seat belt system should **NEVER** be located across the child's neck.

- **NOTE:** It is important to know the correct use of this high back belt-positioning booster and how to determine the fit of the vehicle seat belt to your child.
- **NEVER** use the child restraint system for a child who is not the height and weight recommended in this instruction manual.

! WARNING! DEATH or SERIOUS INJURY can occur

The information below shows the size of the child suitable for the child restraint. You must check if your child meets **ALL** of the height and weight limitations in order for it to be safe for the child to use the child restraint.

NOTE: If your child does **NOT** meet **ALL** of the height and weight requirements for the Performance BOOSTER / ProBOOSTER XL, please see the other fine child restraint systems that are offered by RECARO.

The Performance BOOSTER / ProBOOSTER XL can **ONLY** be used for a child as a high back belt-positioning booster whose height and weight fall within ALL of the following requirements:

Weight Requirement:

- Your child's weight is between **30 and 120 pounds (13.6 and 54.4 kg)**.

Standing Height Requirement:

- Your child's standing height is between **37 and 61 inches (94 and 154 cm)**.

NOTE: Standing height measures the child's full height to the top of their head. The child should be standing up straight when measured to ensure an accurate measurement.

REMEMBER: A child is always safest in a child restraint system that has a 5-point harness system built in. RECARO cannot recommend what age your child has to be in order to ride in a belt-positioning booster, please refer to your state's law, as each state is different.

! WARNING! DEATH or SERIOUS INJURY can occur

In addition to the child's standing height they must also be able to fit the child restraint correctly when sitting in the child restraint system.



- Do **NOT** use the child restraint when the child's shoulders are above the red shoulder belt routings when the head restraint is adjusted to its highest position.



- Your child's head should **NEVER** be **BELOW** the head restraint in the lowest head restraint position.



- Your child's head should **NEVER** be **ABOVE** the head restraint in the highest position.



- Your child's head **MUST** be centered vertically between the top and bottom of the head restraint.

Performance BOOSTER / ProBOOSTER XL Features:

It is important to become familiar with the features of your child restraint system. These diagrams help you identify key features.

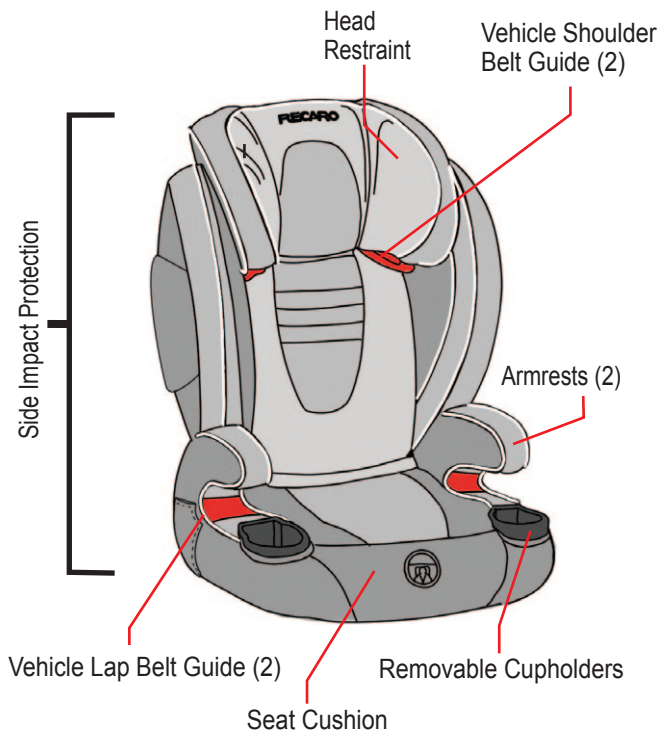

Performance BOOSTER / ProBOOSTER XL Features:

It is important to become familiar with the features of your child restraint system. These diagrams help you identify key features.

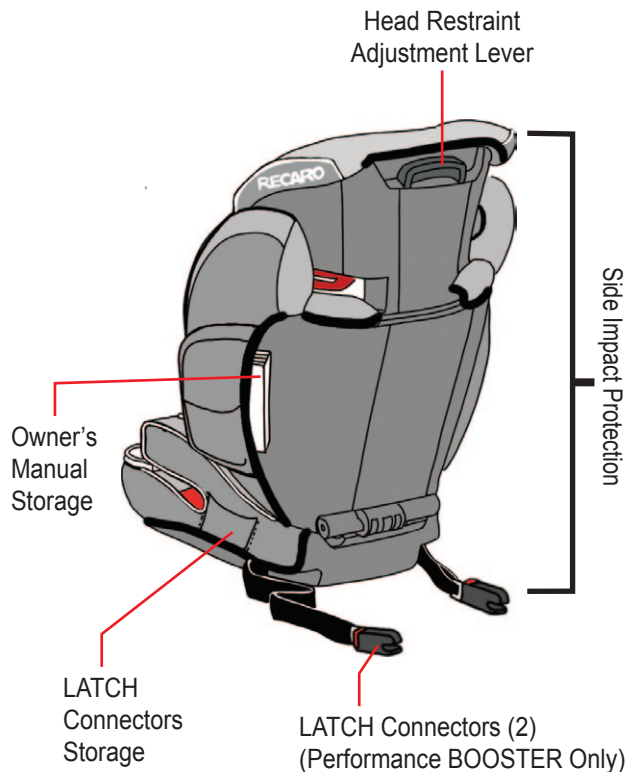

Section 8: Adjusting the Child Restraint to Fit Your Child

Head Restraint Adjustment

The purpose of the head restraint adjustment is to maximize the side impact protection for the child's head and properly position the vehicle shoulder belt across the child's body.

There are eleven (11) height adjustment positions of the head restraint that will allow the child restraint to grow with your child.

Prior to placing and fitting the child restraint system to the vehicle seat, adjust the head restraint to fit the child. After finding the correct position for the head restraint to the child, place the child restraint in the vehicle.

To properly fit your child, the head restraint should be positioned as follows:



- Your child's head must be centered vertically between the top and bottom of the head restraint.

-AND-



- The red shoulder belt guide on the child restraint system must be above the child's shoulder to allow for correct vehicle belt positioning.

To adjust the head restraint:

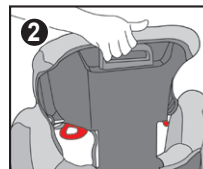

1. Have your child sit in the child restraint before it is placed in the vehicle.

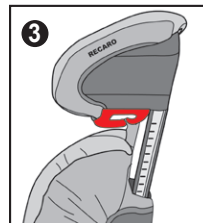

2. Adjust the head restraint by lifting up on the head restraint adjustment handle located at the top rear of the head restraint.
3. There are (11) height adjustment positions of the head restraint on the child restraint.
4. Once the head restraint adjustment handle is lifted either pull up or slide the head restraint down until the head restraint is in the proper position detailed on page 18.

It is important to always check that the position of the head restraint height is correct for your child as your child continues to grow.



Your child is too TALL for the Performance BOOSTER / ProBOOSTER XL when:

- The child's shoulders are even with or above the red shoulder belt guides when the head restraint is adjusted to its highest position.
- The child's ear is above the top edge of the head restraint when the head restraint is adjusted to its highest position.



Your child is too SHORT for the Performance BOOSTER / ProBOOSTER XL when:

- The child's ear is below the bottom edge of the head restraint when the head restraint is adjusted to its lowest position.



Section 9: Positioning the Child Restraint in Your Vehicle

For Performance BOOSTER Only: Unattended Booster LATCH Installation

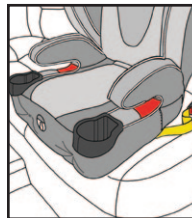

1. Place the child restraint on the vehicle seat. If the vehicle's backrest is adjustable, adjust the backrest into the upright position.
2. Locate the LATCH connectors in the storage pockets on each side of the seat.
3. Connect each LATCH connector to the anchor in the vehicle. Make sure the arrows molded on the LATCH connectors are facing up.

NOTE: The LATCH strap will remain loose to allow movement of the seat. The LATCH is there purely to prevent a tossed object in case of a car crash.

For ProBOOSTER XL: Unattended Booster Installation

To prevent a tossed object in case of a car crash, the car vehicle seat belt must be used while the child is not occupying the booster.

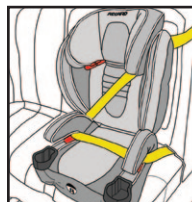

1. Install the seat belt through the red belt guides.
2. Buckle the belt so that the seat is secured in place.

Section 10: Belt Routing and Positioning Around Your Child

You must **ALWAYS** secure your child in the child restraint using your lap and shoulder (3-point) vehicle belt system.

The child restraint must always be used forward-facing in the vehicle.

You **MUST** always repeat the following steps each time you secure your child in the child restraint using the lap and shoulder belt system in your vehicle.

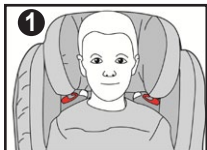

1. Place your child in the child restraint and confirm the correct head restraint location (see Section 8: Adjusting the Performance BOOSTER / ProBOOSTER XL to Fit Your Child, pages 18-20).

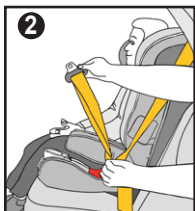

2. Pull the vehicle's lap and shoulder belt out and around your child and the child restraint.

Be certain that the vehicle seat belt is not twisted.

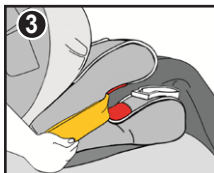

3. Position the lap portion of the vehicle seat belt system through the red lower lap belt guides.

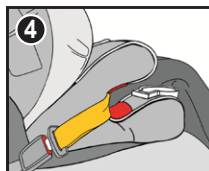

4. Fasten the vehicle seat belt to the vehicle buckle. Ensure the buckle is engaged by gently pulling on the seat belt.

The vehicle buckle should be below the red lap belt guide.

Position the lower portion of the vehicle shoulder belt by routing the lower portion of the vehicle belt closest to the vehicle buckle under the arm rest.



5. Position the top portion of the shoulder belt into the red shoulder belt routing guide near the child's ear.

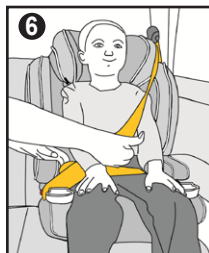

6. Remove the slack from the seat belt system but **DO NOT** lock the seat belt, it should be free to move. First remove the slack from the lap portion of the vehicle seat belt and then the shoulder portion for the most comfortable fit.



7. The lap belt should be positioned flat across the child's lap or thigh area. It should not be lying against the child's abdomen or 'belly'.



8. The shoulder belt should be flat against the child's chest and collarbone. The shoulder portion of the vehicle seat belt system should **NEVER** be located across the child's neck.



9. Double check the seat to make certain that it is squarely positioned on the vehicle seat and that the child is not pinched, squeezed or experiencing discomfort.

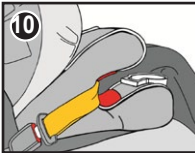

10. Confirm that the vehicle belt buckle is below the red lap belt guide. **NEVER** use a buckle that is too long and interferes with the red lap belt guide.



NOTE: These steps must be followed every time a child is using the child restraint. Never allow your child to "slide" in and out of the seat belt.

WARNING! DEATH or SERIOUS INJURY can occur

- The vehicle's lap and shoulder seat belt system must **ALWAYS** be adjusted snugly (but **NOT LOCKED**) around the child.
- A snug seat belt system does NOT press on the child or position them unnaturally.
- The vehicle's lap and shoulder belt should not have any excess webbing or it is too loose.
- The vehicle's lap and shoulder seat belt system must **NOT** be twisted.
- **NEVER** place the shoulder belt under the child's arm.
- **NEVER** secure a child with a lap only vehicle seat belt. Your child could be seriously injured in a vehicle crash.
- Do **NOT** use anything to raise the booster seat off of the vehicle seat.
- Use caution when adjusting the Performance BOOSTER / ProBOOSTER XL head restraint or backrest as fingers may become pinched during the adjustment.
- Avoid bulky clothing so the vehicle belt fits snugly around the child.

Section 11: Care and Maintenance

The Performance BOOSTER / ProBOOSTER XL has been engineered for long life and trouble-free usage. The fabric has been designed to resist stains and soiling. With proper care and maintenance, this premium fabric will retain its beauty for years to come.

To clean the trim cover “on the go”, follow these easy steps:

- Remove any soiling immediately.
- Blot area with a dry cloth.
- To remove remaining stain, spray a light mist of a soap solution and rub gently in a circular motion with a clean cloth or toothbrush so not to damage the fabric.
- Pat dry with cloth.
- When dry, use a soft brush to regain fabric's smooth feel.

To clean the trim cover in the home, follow these steps:

- Remove the trim cover as detailed in Section 12: Trim Cover Removal.
- **HAND WASH** using cold water and mild soap.
- Line dry to avoid shrinkage of the trim cover.
- Do **NOT** bleach, machine wash or machine dry.



Heavily soiled areas can be spot-treated using non-solvent commercial cleaners. Use only water soluble cleaning agents.

NEVER use solutions that contain a petroleum or alcohol base.

Though RECARO tests many cleaning solutions, we cannot test them all – we suggest you **ALWAYS** test in a discrete area first to ensure that the cleaner does not damage the fabric.

To clean the child restraint's plastic housing, follow these tips:

- Clean by hand with a sponge or soft cloth using warm water and a mild soap.
- Dry off thoroughly with a soft towel.
- Do **NOT** use harsh chemicals, abrasive cleaners or solvents to clean the plastic.
- Do **NOT** disassemble this restraint in any way.

To clean the child restraint's cup holder inserts:

- Clean by hand with a sponge or soft cloth using warm water and a mild soap.
- Dry off thoroughly with a soft towel.
- Do NOT use harsh chemicals, abrasive cleaners or solvents to clean the insert.

Section 12: Performance BOOSTER / ProBOOSTER XL Trim Cover Removal / Installation

Trim Cover Removal

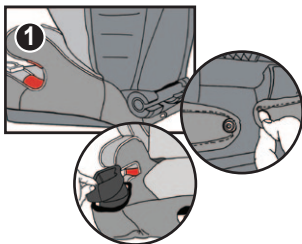

1. Remove the (2) cup holder inserts. Unsnap the button located in the back of the base.

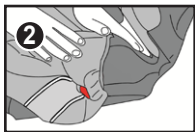

2. Pull the cushion trim cover out until it is free from the armrests.

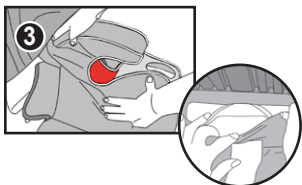

3. Pull the cover forward, off the armrests, and then off the cushion frame and remove cushion foam. Do not wash or submerge the foam in water.

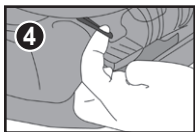

4. Unhook the (2) elastic loops that attach the backrest trim cover to backrest frame located behind on the backside of the frame.

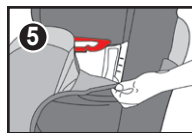

5. Position the head restraint into the highest position and then remove the button holes located in top/back of the backrest cover from the hooks in the backrest frame.



6. Remove the backrest cover by "peeling" it from the bottom up towards the head restraint.

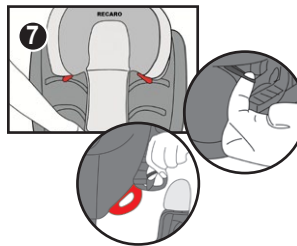

7. Unhook the (4) elastic loops that attach the head restraint cover to head restraint frame (2) of the elastic loops are located behind the 3-point belt guides. The other (2) elastic loops are located on the backside of the frame.

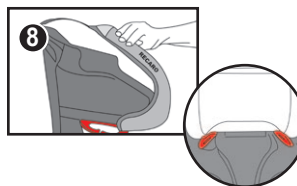

8. Carefully remove the head restraint cover from the head restraint frame by "peeling" it from the back of the frame, forward and off the frame.

Trim Cover Installation



1. Carefully position the head restraint cover onto the head restraint frame/foam.

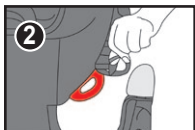

2. Hook the (2) elastic loops on the head restraint cover to head restraint frame hooks located behind the 3-point belt guides.

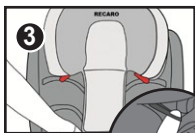

3. Hook the (2) elastic loops located in the lowest corners of the head restraint cover to the hooks located on the back of the backrest frame near the base of the seat.



4. Position the head restraint into the highest position and then carefully position the backrest cover over the upper most points of the backrest frame/foam and slide the cover down until it reaches the base of the backrest frame.



5. Hook the button holes located in top/back of the backrest cover onto the hooks in the backrest frame.



6. Hook the (2) elastic loops located in the lowest corners of the backrest cover to same hooks used to attach the bottom of the head restraint cover.



7. Place seat cushion foam on seat frame with the thin layer side up.

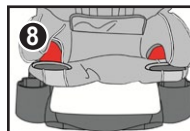

8. Position the seat cushion cover over the armrests of the cushion frame and then slide the (2) opening onto the armrests.

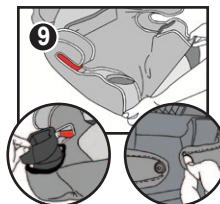

9. Pull the front edge of the cushion cover down and around the front of the cushion frame. Snap the button located in the back of the back rest. Replace the cup holder inserts.

Section 13: Troubleshooting

In certain vehicle applications, you may encounter challenges to safely install and position a child in the restraint system. This section gives ideas on how to solve some of these situations.

If you do not find an adequate solution, please contact us at 1-888-9RECARO for help.

Customer Service Contact Information:

Phone Toll Free: 1-888-9RECARO

Email Address: info-usa@recaro-cs.com

Website: www.recaro-cs.com

Problem: The seat belt is twisted.

Solution: Unbuckle the seat belt, pull the seat belt away from the child restraint remove it from the child restraint routings and allow it to retract into the vehicle (it might help to slowly guide it back into the vehicle's seat belt retractor to prevent binding). Route the entire seat belt around the restraint and child once again.

Problem: The seat belt is not tight around the child.

Solution: Press downward on the child restraint and firmly pull all slack out of the seat belt. This will allow the child restraint to compress the vehicle's seat and allow the seat belt to be further tightened.

Problem:

Solution:

The child restraint is not stable when driving.

Check to see if there are items under the booster. Remove anything found. Some vehicle seats are deeply contoured making it difficult to safely install a child restraint. If the restraint is not stable due to the vehicle seat cushions, move it to another seating location. If no seating location is suitable, the Performance BOOSTER / ProBOOSTER XL may not be used in this particular vehicle.

Section 14: Warranty

RECARO Child Safety, LLC warrants this product against defects in materials or workmanship to the original purchaser for a period of 12 months. You must have the original purchase receipt for a warranty claim to be accepted.

The upholstery fabric is subject to a certain degree of wear even from normal use. This kind of normal wear is not covered under warranty.

Exclusions: A Product will not be considered “defective” and this Warranty will not apply, where the claimed defect is attributable to:

- a) Improper installation;
- b) Modification or alteration of the Product;
- c) Failure to comply with RECARO's instructions for service and maintenance;
- d) Accident, unauthorized repairs or unauthorized use;
- e) Any attachment or replacement part that was manufactured, supplied or added by others and was not part of the Product;
- f) Exposure to corrosive materials, the elements (including, but not limited to, cold or freezing temperatures, excessive heat, fire, humidity, and sunlight), or other acts of God;
- g) Ordinary wear and tear (including fading and discoloration);

- h) Improper loads (including passenger weight in excess of design limits);
- i) Removal of the Product from the original application or reinstallation of the Product in the original or another application; or
- j) Any other neglect, abuse or misuse.

Section 15: Replacement Parts

RECARO offers a variety of replacement parts for your child restraint system. Please call us at 1-888-9RECARO and speak to one of our customer service representatives for more information on what is available for purchase.

Customer Service Contact Information:

Phone Toll Free: 1-888-9RECARO

Email Address: info-usa@recaro-cs.com

Website: www.recaro-cs.com

Section 16: Additional Contact Information

If you need help with installation or usage, please use the following contact information:

RECARO Child Safety, LLC

1600 Harmon Road

Auburn Hills, MI 48326

Toll Free: 1-888-9RECARO (1-888-973-2276)

E-mail: info-usa@recaro-cs.com

Website: www.recaro-cs.com

For personal assistance in your local area, please contact a Child Passenger Safety (CPS) technician. You can find a CPS technician in your area at www.NHTSA.gov. Click on “Child Passenger Safety” and select “Certified Child Passenger Safety Technician Locator.”

Many community groups, fire and police stations schedule car seat checks that you can visit with your child. More information about car seat check-ups is available at www.NHTSA.gov under “Child Safety Seat Inspection Station Location” or at www.seatcheck.org. You can also call 1-866-SEAT-CHECK to find the next and closest seat check event.

Section 17: Glossary

3-Point Seat Belt: A seat belt with both a lap and a shoulder portion, having three contact points (one shoulder, two hips).

2-Point Seat Belt: A seat belt system with two contact points, (two hip points) also referred to as a lap belt.

Airbag: A passive (idle) restraint system that automatically deploys during a crash to act as a cushion for the occupant. It creates a broad surface on which to spread the forces of the crash, to reduce head and chest injury. It is considered “supplementary” to the lap/shoulder belts because it enhances the protection the belt system offers in frontal crashes. Also known as SRS - Supplemental Restraint System; SIR - Supplemental Inflatable Restraint; IC - Inflatable Curtain; SIAB - Side Impact AirBag.

Belt-Positioning Booster: A platform that raises the child (provides a taller sitting height) so adult lap and shoulder belts fit better; some have high backs as well. Never use with a lap belt only across the child. Also called a “Booster Seat.”

Belt Routings: The manufacturer’s required place where the safety belt passes around or through the child restraint. Indicated in red on this child restraint.

Child Restraint System: Common term for a specially designed device that secures a child in a motor vehicle, meets federal safety standards and increases child safety in a crash. Also called a “Car Seat.”

Federal Motor Vehicle Safety Standard (FMVSS) 213: Federal Motor Vehicle Safety Standard that pertains to all restraint systems intended for use as crash protection in vehicles for children. Required for child restraints sold in the USA.

Head Restraint: Structure at the top of the backrest which is designed to keep the child’s head in the proper position and provide protection for the child’s head during a crash.

ISO 9001: Is focused on meeting customer expectations and delivering customer satisfaction. Through the continuous improvement process and review of our quality system, we identify and implement product improvements through the entire product life cycle.

ISO/TC 22/SC 12/WG 1 N538: Side impact test requirements for child restraints. Not required for child restraints sold in the USA.

LATCH: Lower **A**nchors and **T**ethers for **C**hildren. Acronym for standardized vehicle anchorage system. Method to affix child restraint systems to vehicles independent of the vehicle seat belts. Most booster seats do not use LATCH.

Side Impact Protection (SIP): Extra safety feature of RECARO child restraints having energy absorbing foam and structure design strategically placed in areas on the child restraint where it is especially important to protect the child in a crash.

Top Tether Anchorage: Attachment point in the vehicle for child safety seat tether strap. Refer to vehicle owner's manual regarding anchor location. A tether strap is an additional belt that anchors the child restraint system top to the vehicle frame; keeping the restraint from tipping forward on impact.

inside back cover left blank



RECARO Child Safety, LLC

1600 Harmon Road, Auburn Hills, MI 48326

Tel: 1-888-9RECARO

Internet: www.recaro-cs.com, E-mail: info-usa@recaro-cs.com

In the interest of product development, RECARO reserves all rights to make changes to the construction and design of its products without prior notification.

RECARO does not assume the liability in case of misprint. Pictures may include extras.

P/N 7220102 REV000