Contact Details

Please note that some of the contact details on this PDF document may not be current.

Please use the following details if you need to contact us:

Telephone: 0844 879 3588

Email: customer.services@gdcgroup.co.uk

The Help Centre section of this website also features a wide range of information which may be of use to you and is available 24 hours a day. It includes:

- Operating and installation instructions downloads
- Request a repair
- Where to buy our products
- Literature downloads
- Heating requirement calculator

www.credaheating.co.uk/help-centre

Installation and operating manual
To be retained by the user

Newera Towel Rails

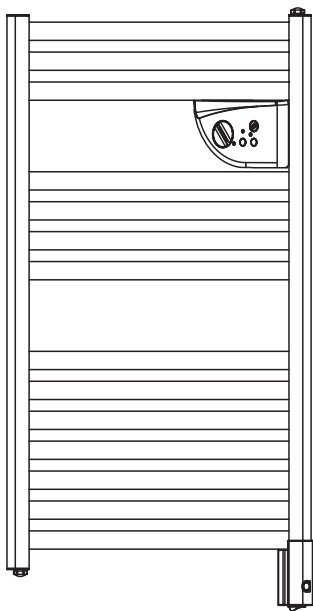

OUTLINE
(Model: OTRW)

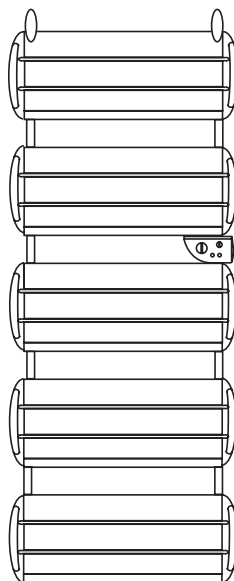

SKYLINE
(Model: STRW)

Creda

A few recommendations:

Read the instructions before installing the device.

Isolate from the mains before working on it, and check the power supply voltage.

Store the instructions, even after installing the device.

Characteristics of the device: (shown on the rating label)

IP24: Device protected against water projections.

Class II : Double insulation.

INSTALLING THE DEVICE

1) Location of the device

- This device was designed to be installed in residential premises. In any other case, please call your distributor.

- Installation must be ensured according to the wiring rules and in compliance with the standards currently enforced in the country of installation.

Locate the device beyond minimum distances from obstacles

Do not install the device:

 In a draught likely to upset its regulation

 Under a fixed mains outlet.

 Inside zone 1 in bathrooms.

 Inside zone 2 if the controls are accessible to persons using the shower or the bath tub.

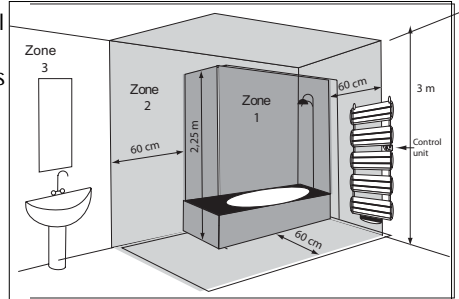

2) How to install the device

1) Position according to the diagrams below:

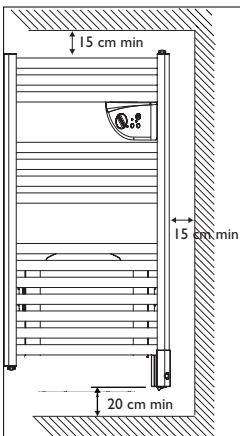

Outline

Version	Power (W)	Height with control box (mm)	Width (mm)
OUTLINE	500W	656	400
	750W	1066	400
SKYLINE	600W	984	470
	750W	1035	470

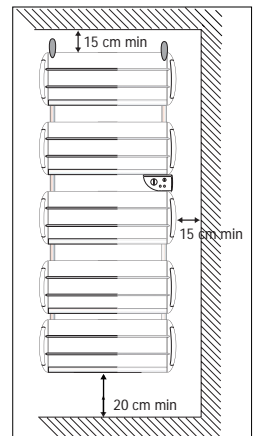

Skyline

WARNING

- Prevent children from climbing on the device. Do not insert objects or paper in the device.
- Any work on the electrical parts must be performed by skilled staff.
- During first warming, a slight smell may be evident, due to the evacuation of compounds used during the device's manufacturing.
- The casing may be hot, even when the device is off.

MAINTENANCE

- To maintain the performance of the device, about twice per year, clear the dust.
Do not use abrasive products.

- Every five years, have the machine's interior checked and cleaned by a professional.

Model Outline Only

- You are recommended to have the appliance and the amount of fluid checked by a professional technician after 6 years of use and replace it if necessary. The amounts of fluid to be introduced into the appliances are: for 500W models 3.8 litres and for 750W models 5,9 litres.
- Any deteriorated fluid must be disposed of at a waste oil collection station.

IN CASE OF PROBLEM

Problem	Check
The device does not heat	<ul style="list-style-type: none">- Check that the premises circuit breakers are ON or that the shedder (if you have one) has not interrupted the device's power supply.- Check the air temperature in the room.- Switch the device off, then back on (ⓐ switch):<ul style="list-style-type: none">☞ If the ⑦ indicator blinks 3 times: the measurement probe is damaged. Call your electrician to ensure its replacement.☞ If the ⑦ indicator blinks 5 times: power surge in device supply. Power off the device (fuse, circuit breaker...), and call your electrician.
The heating device heats constantly	Check that the device is not located in a draught or that the temperature setting has not been altered.

Model with programmer only

The appliance does not follow the programming instructions.	Ensure that you use the programming unit correctly (refer to the instructions manual), that the programmer is correctly fitted in its housing and that it is operating normally (check the condition of the batteries).
---	---

- 2) Carefully mark the drilling points with a pencil (draw a cross, 4cm wide).
- 3) Drill the four holes.
- 4) Position the four hooks and screw them tight.
- 5) Attach the appliance and 6) lock it in place with the grub screw.

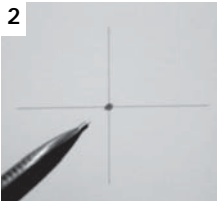

OUTLINE

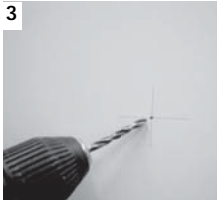
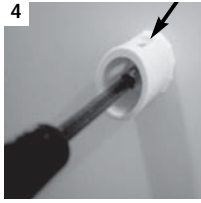

SKYLINE

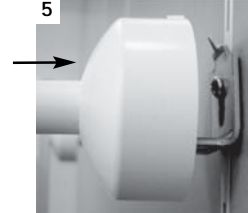
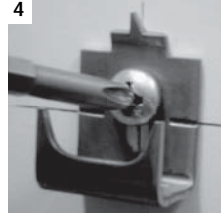

Note: The screws supplied are of a standard type. In case of particular fixing needs, use appropriate screws.

3) Connecting the device

- The device must be supplied with 230-240V, 50Hz.
- Mains connection must be ensured using a 3-wire cable (Brown=Live, Blue=Neutral, Black=Pilot wire), through a connecting box. In damp premises, such as bathrooms and kitchens, install the connecting box at least 25cm from the ground.
- A means for disconnection in all poles must be provided in the fixed wiring in accordance with the wiring rules.
- Do not connect to Earth.

Do not connect the pilot wire (black) to Earth.

- If power cable is damaged or too short, to avoid any danger it must be replaced by a qualified electrician using special tools.
- If a device is protected by a 30mA RCD (e.g. bathroom), the pilot wire supply must also be protected by this RCD .

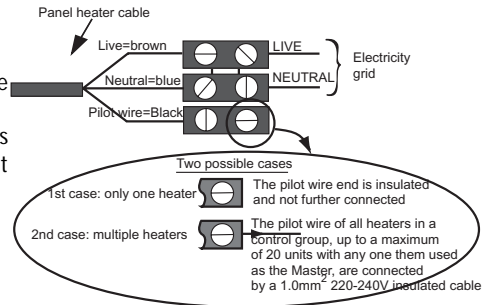

4) Fitting and removing the brackets

Skyline Only

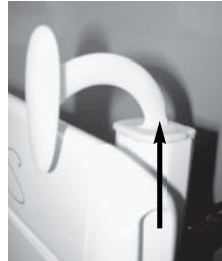
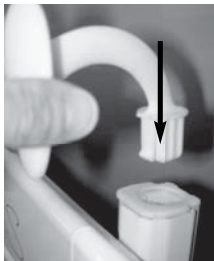



4) Programming

With a pilot wire:

The appliance can be controlled remotely if its pilot wire is connected to an appliance fitted with a programmer, to a central programming unit or to an energy control system.

Chart indicating the orders the device can receive over its pilot wire

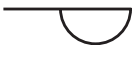
(to be measured between the pilot wire and the neutral).

Orders received	No signal	Full wave 230V	Negative half-wave	Positive half-wave
Ref/neutral oscilloscope	—			
Mode achieved	COMFORT	ECO	STANDBY	STOP
Heating temperature	COMFORT setting	3°C to 4°C below COMFORT setting	Standby temperature, about 7°C	Instant device stop.

With a separate programmer:

The appliance can also be programmed independently by inserting a programmer in the housing at the rear of the control box. This programmer will create the ECO and COMFORT modes just as you have set them on the programmer.

USING THE DEVICE

1) Description of the control panel



- 1 Temperature setting knob with Anti-Frost ❄️ position and ability to restrict the range.
- 2 Time adjustment knob TURBO 1/4h, 1/2h, 1h, 2h.
- 3 Power On indicator
- 4 TURBO indicator
- 5 TURBO control
- 6 ON/OFF switch
- 7 Heating indicator

2) Setting the COMFORT temperature

This is the temperature desired when the room is occupied.

- a) Set the switch **6** to the ON position, and the **3** indicator lights.
- b) Set knob **1**, the indicator **7** lights when the ambient temperature is below that desired.
- c) Wait a few hours for the temperature to stabilise.

If the temperature setting does not suit you, adjust it using the adjusting knob **1**.

GUARANTEE

We guarantee that should this heater prove to be defective by reason of faulty workmanship or material within 24 months of the date of purchase or commencement of hire purchase we will replace the defective parts FREE OF CHARGE on condition that:

The appliance has been correctly installed and used only on the supply circuit or voltage stamped on the rating plate.

The appliance has been used in accordance with these instructions and has not been tampered with or otherwise subject to misuse, neglect or accident.

The appliance has not been taken apart, modified or repaired except by a person authorised by us.

EVIDENCE of the date of purchase in the form of an invoice, receipt (or hire purchase document) is included with the Appliance if returned under guarantee.

TYPE OF APPLIANCE*:
SERIAL NUMBER*:
CUSTOMER'S NAME AND ADDRESS:
.....

* This information can be found on the information plate situated on the left-hand side of the appliance.

Applied Energy Products Limited
Morley Way, Peterborough PE2 9JJ
www.applied-energy.com

INSTALLER'S STAMP

