

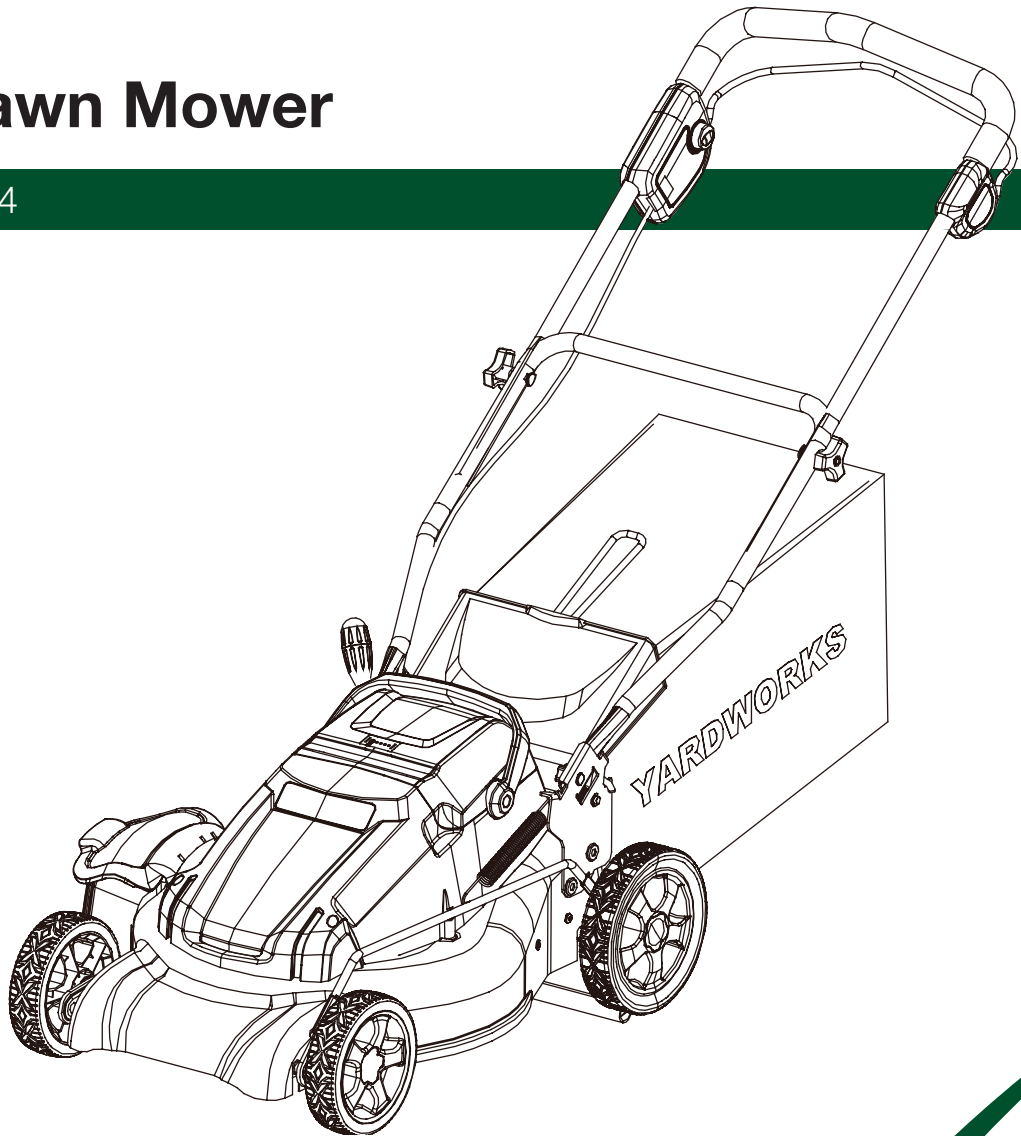

Cordless Lawn Mower

model no. 060-1776-4



Toll-free: 1-866-523-5218

IMPORTANT:

Read and follow all safety rules and operating instructions before using this product.

Instruction
Manual



model no. 060-1776-4 | contact us: 1.866.523.5218

Table of Contents

| | |
|--------------------|----|
| SPECIFICATIONS | 2 |
| KNOW YOUR MOWER | 3 |
| EXPLODED VIEW | 4 |
| PARTS LIST | 5 |
| ASSEMBLY | 7 |
| OPERATION | 11 |
| MAINTENANCE | 17 |
| TROUBLESHOOTING | 21 |
| SYMBOLS | 22 |
| BATTERY & CHARGER | 23 |
| SAFETY INFORMATION | 26 |
| WARRANTY | 31 |

Specifications

| | |
|---------------------|---|
| Battery type: | 36 V, 10 Ah sealed lead-acid |
| Charger time: | 10-13 hours |
| No-load speed: | 3300 RPM |
| Height adjustments: | 1 1/4 - 3 1/2" (3.2 - 8.9 cm) |
| Functions: | 3-in-1: Mulch, side discharge or rear bag |
| Unit weight: | 74 lb (33.5 kg) |



model no. 060-1776-4 | contact us: 1.866.523.5218

1. Power lever
2. Upper handle
3. Grass catcher bag
4. Rear chute cover
5. Wheel
6. Safety lock-out button
7. Lower handle
8. Height adjustment lever
9. Battery
10. Side discharge cover
11. Isolator key
12. Mulching plug
13. Side discharge chute
14. Charger

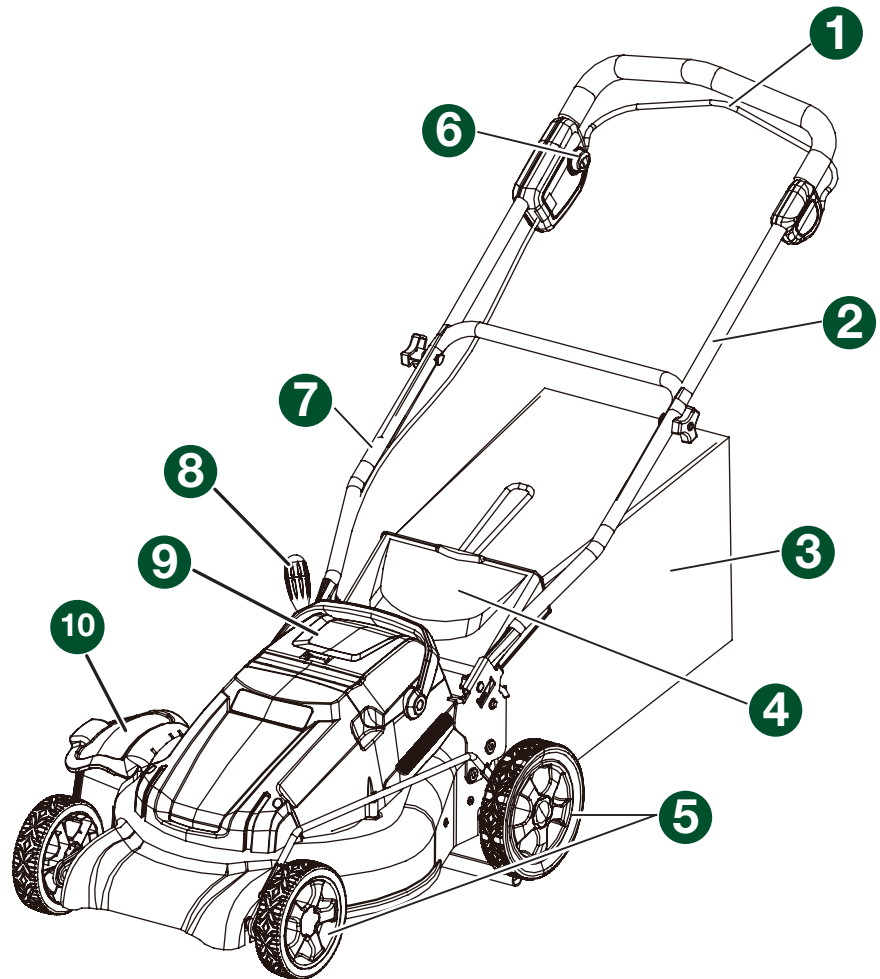
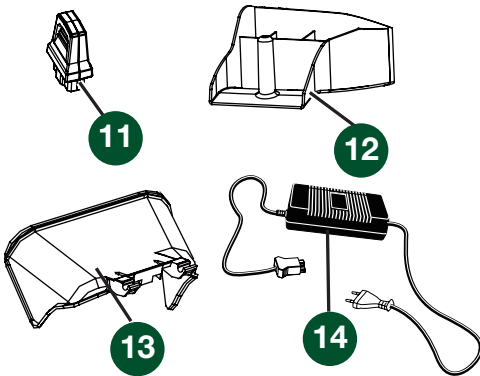

Know Your Mower

KNOW YOUR MOWER

- Carefully remove the product and any accessories from the box. Make sure that all items listed in the packing list are included.
- Inspect the product carefully to make sure no breakage or damage occurred during shipping.
- Do not discard the packing material until you have carefully inspected and satisfactorily operated the product.
- If any parts are damaged or missing, please call 1-866-523-5218 for assistance.



WARNING: If any parts are damaged or missing do not operate this product until the parts are replaced. Using a product with damaged or missing parts could result in serious personal injury.



WARNING: Do not attempt to modify this product or create accessories not recommended for use with this product. Any such alteration or modification is misuse and could result in a hazardous condition leading to possible serious personal injury.

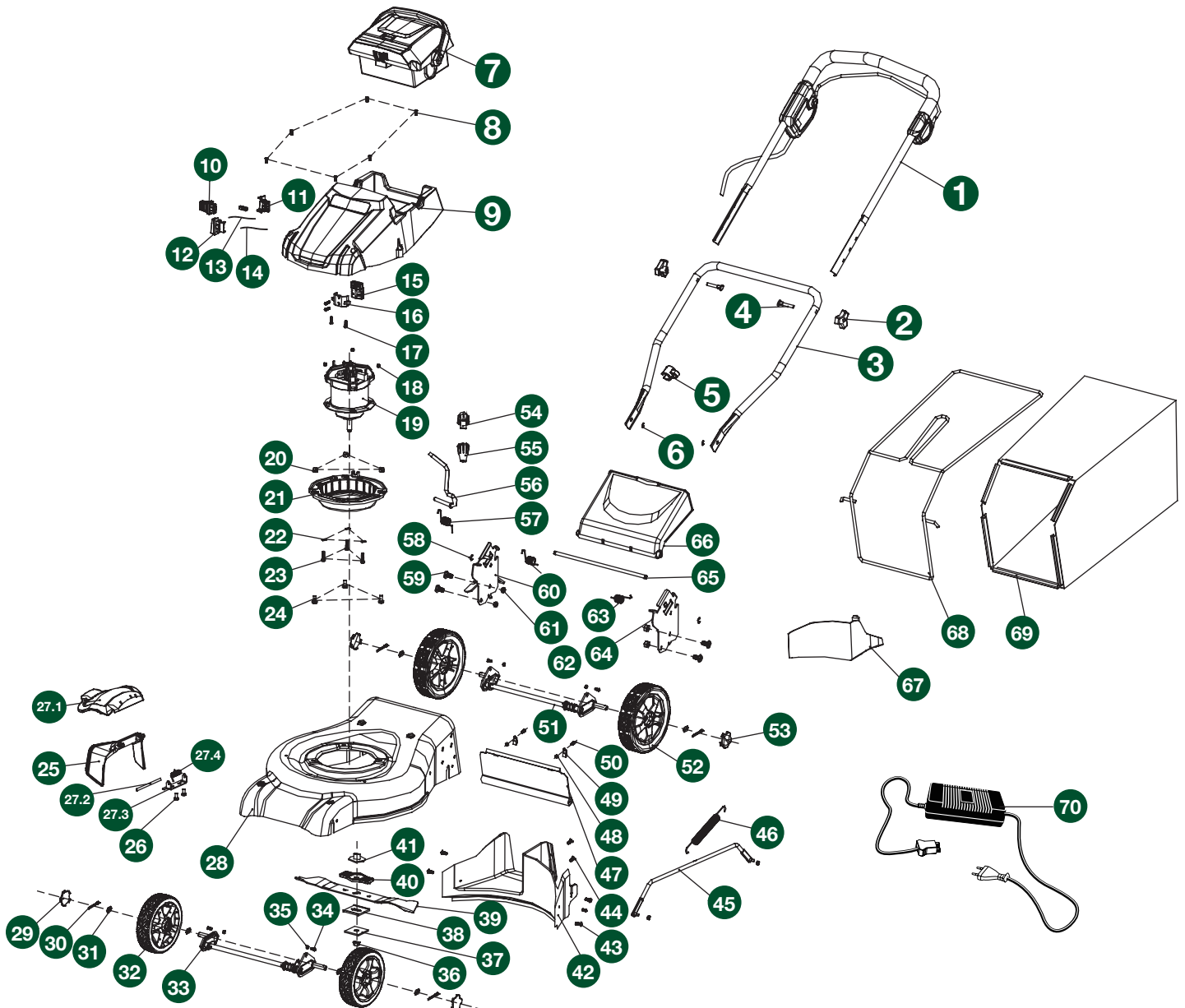



model no. 060-1776-4 | contact us: 1.866.523.5218

| Item | Description | Drawing | QTY |
|------|-------------------------------|-------------|-----|
| 1 | Upper handle assy. | 31102496 | 1 |
| 2 | Knob | 3410835-4 | 2 |
| 3 | Lower handle | 33301467-1 | 1 |
| 4 | Bolt | 3220436-1 | 2 |
| 5 | Cord guide | 34135469 | 2 |
| 6 | Retaining ring | 32901131 | 2 |
| 7 | Battery, 36 V 10 Ah | 31101496 | 1 |
| 8 | M5×15 screw | 3220435 | 6 |
| 9 | Motor cover | 34102496 | 1 |
| 10 | Key | 31201470-1 | 1 |
| 11 | Key holder B | 34107492 | 1 |
| 12 | Key holder A | 34106492 | 1 |
| 13 | Cord, black | 31127469 | 1 |
| 14 | Cord, red | 36503487 | 1 |
| 15 | Connector | 36501229 | 1 |
| 16 | Retaining seat | 34105462 | 1 |
| 17 | ST4×14-F screw | 32210131 | 2 |
| 18 | M6 lock nut | 3220537 | 5 |
| 19 | Motor | 36101487 | 1 |
| 20 | M8 nut | 32208261 | 3 |
| 21 | Motor holder | 34105467-1 | 1 |
| 22 | Washer | 32207115 | 3 |
| 23 | M6×25 bolt | 3220135 | 3 |
| 24 | M8×16 bolt | 3220406 | 3 |
| 25 | Side discharge chute | 34103467 | 1 |
| 26 | M6×8 bolt | 3220136 | 2 |
| 27 | Side discharge cover assy. | 31104467 | 1 |
| 27.1 | Side discharge cover | 34102467 | 1 |
| 27.2 | Side discharge axle | 33308250 | 1 |
| 27.3 | Side discharge bracket | 33307250 | 1 |
| 27.4 | Side discharge torsion spring | 33331250 | 1 |
| 28 | 19" Deck | 31301491-1 | 1 |
| 29 | 7" Wheel cover | 34203229-13 | 2 |
| 30 | Pin | 3290135 | 4 |
| 31 | Washer | 3220898 | 8 |
| 32 | 7" Wheel | 31104463 | 2 |
| 33 | Front wheel axle | 33901234-1 | 1 |



model no. 060-1776-4 | contact us: 1.866.523.5218

Part List

| Item | Description | Drawing | QTY |
|------|---------------------------------|-------------|-----|
| 34 | M5 lock nut | 3220439 | 12 |
| 35 | M5×12 screw | 32206250 | 8 |
| 36 | M10×1.25 nut | 3221037 | 1 |
| 37 | Spacer | 3331435 | 1 |
| 38 | Blade insulator | 3410535 | 1 |
| 39 | 19" Blade | 33301487 | 1 |
| 40 | Blade holder | 34117470 | 1 |
| 41 | Spindle bushing | 3320238 | 1 |
| 42 | Rear baffle | 34102238-1 | 1 |
| 43 | ST6.3×16-F screw | 32205234 | 4 |
| 44 | ST6.3×12-F screw | 32210234 | 3 |
| 45 | Link bar | 33302234-2 | 1 |
| 46 | Tension spring | 33312234 | 1 |
| 47 | Rear shield | 34101467 | 1 |
| 48 | M4 lock nut | 3221237 | 3 |
| 49 | Wire clip | 3330490-1 | 2 |
| 50 | M4×12 screw | 3220518 | 3 |
| 51 | Rear wheel axle | 33903487-1 | 1 |
| 52 | 10" Wheel | 34202227-20 | 2 |
| 53 | 6" Wheel cover | 3411799C-4 | 2 |
| 54 | Height adjustment knob (upper) | 34113227-1 | 1 |
| 55 | Height adjustment knob (lower) | 34114227-1 | 1 |
| 56 | Height adjustment lever | 31103222 | 1 |
| 57 | Torsion spring | 33401222 | 1 |
| 58 | Retaining ring 8 | 3290506 | 2 |
| 59 | Bolt | 32207234 | 4 |
| 60 | Torsion spring (left) | 33310234 | 1 |
| 61 | Height adjustment plate (right) | 33901487-2 | 1 |
| 62 | M10 nut | 32910131 | 4 |
| 63 | Torsion spring (right) | 33313234 | 1 |
| 64 | Height adjustment plate (left) | 33905234 | 1 |
| 65 | Rear cover rod | 33201234 | 1 |
| 66 | Rear door | 34101234-2 | 1 |
| 67 | Mulch plug | 34106463-2 | 1 |
| 68 | Bag frame | 33907234-2 | 1 |
| 69 | Grass bag | 34902234-2 | 1 |
| 70 | 36 V charger | 36601492 | 1 |



model no. 060-1776-4 | contact us: 1.866.523.5218

UNFOLDING AND ADJUSTING HANDLE

1. Fully loosen the handle knobs on both sides of the handle.
2. Pull up and back on the upper handle to raise the handle into operating position. Make certain the lower handles snap into place securely.
3. Tighten the handle knobs (1) on both sides of the handle to secure.

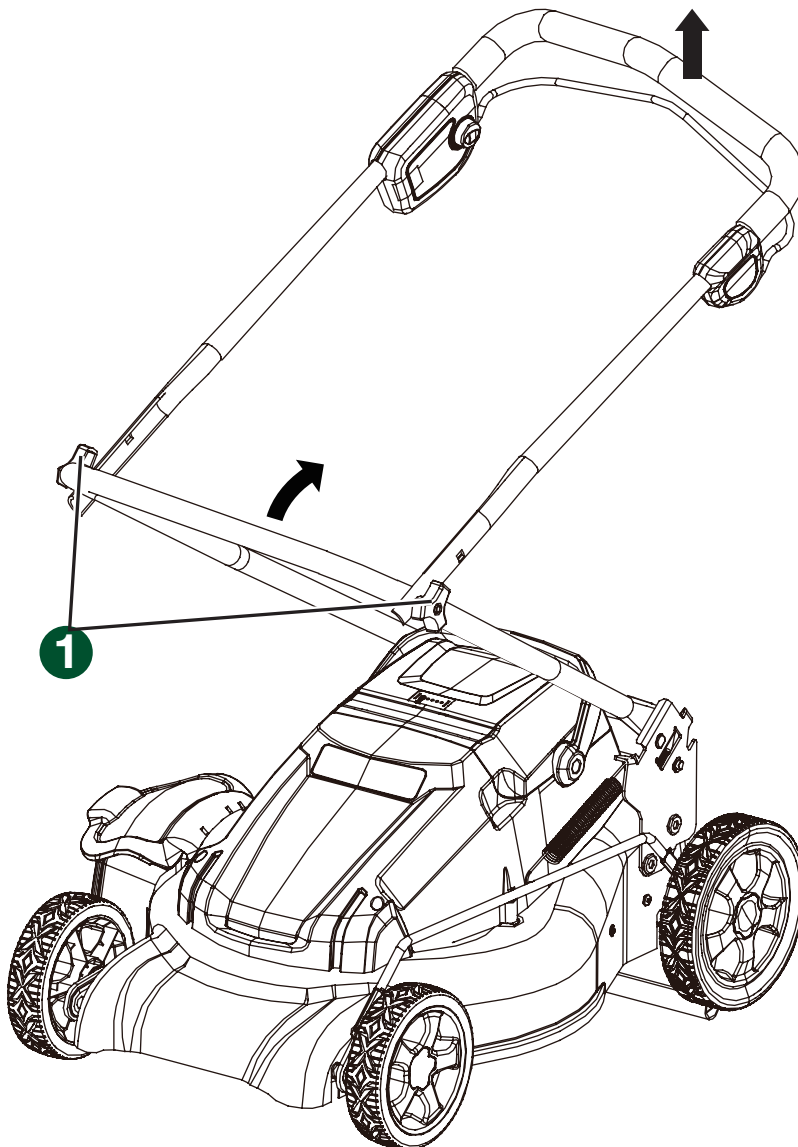

Assembly



NOTE: Do not completely tighten knobs until assembly is complete.

INSTALLING THE GRASS CATCHER BAG

1. Lift the rear discharge door (1).
2. Lift the grass catcher by its handle (2) and place under the rear door so that the hooks (3) on the grass catcher frame are seated into the slots (4) in the handle bracket.
3. Release the rear door. When installed correctly, the hooks on the grass catcher will rest securely in the slots on the handle brackets.

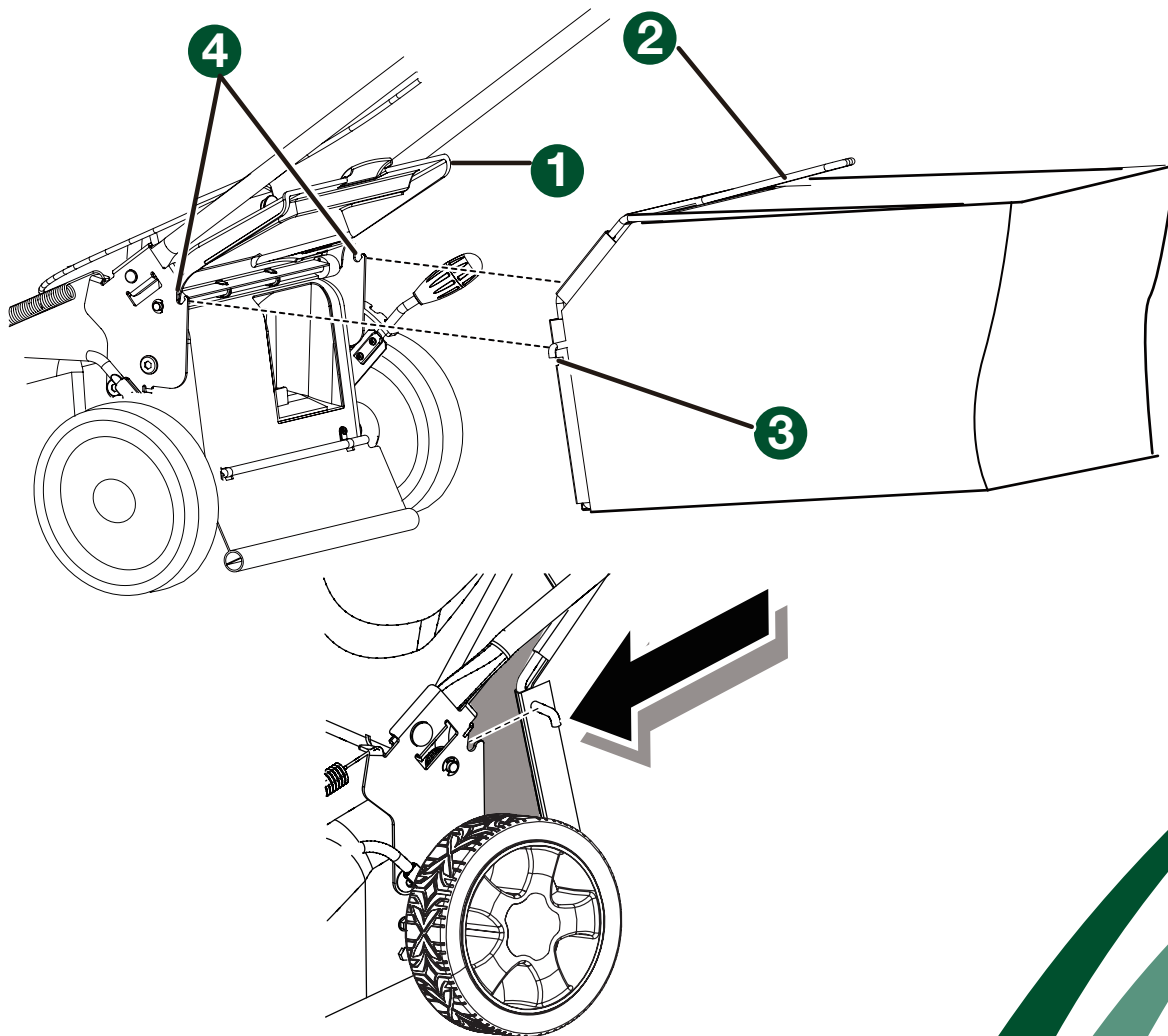

NOTE: When using the grass catcher, do not install either the side discharge chute or the mulching plug. Also, ensure side discharge door is closed securely.



model no. 060-1776-4 | contact us: 1.866.523.5218

INSTALLING SIDE DISCHARGE CHUTE

1. Lift the side discharge cover (1).
2. Align the grooves on the discharge chute (2) with the pins on the underside of the discharge cover (1).
3. Lower the discharge chute (2) until the hooks on the mower deck are secured in the openings in the discharge chute (2).
4. Release the side discharge cover (1).

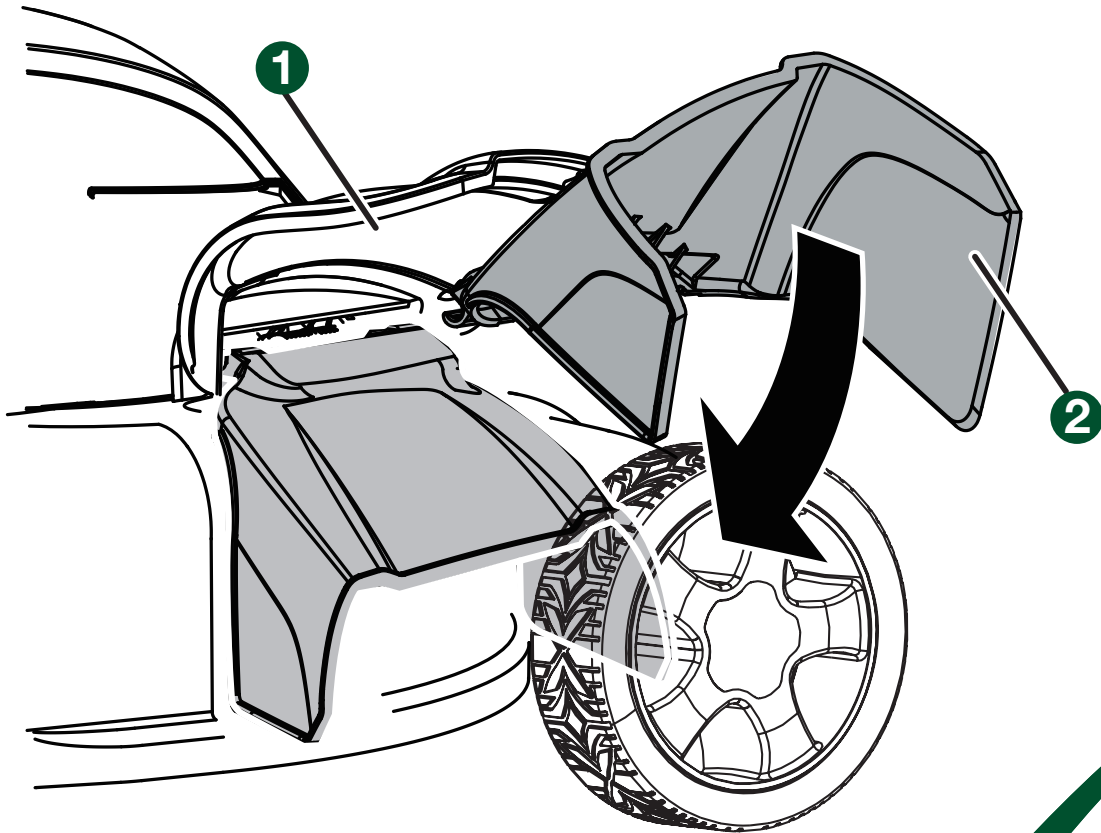

Assembly

INSTALLING THE MULCHING PLUG

1. To remove the mulching plug, lift the chute cover (1).
2. Grasp the handle (2) of the mulching plug and pull the mulching plug out using the handle.
3. The mulching plug (3) is inserted on an angle, so it requires some force to remove it.
4. The mulching plug must be removed in order to install the grass catcher bag.
5. The mulching plug must be re-installed when the grass catcher bag is removed.

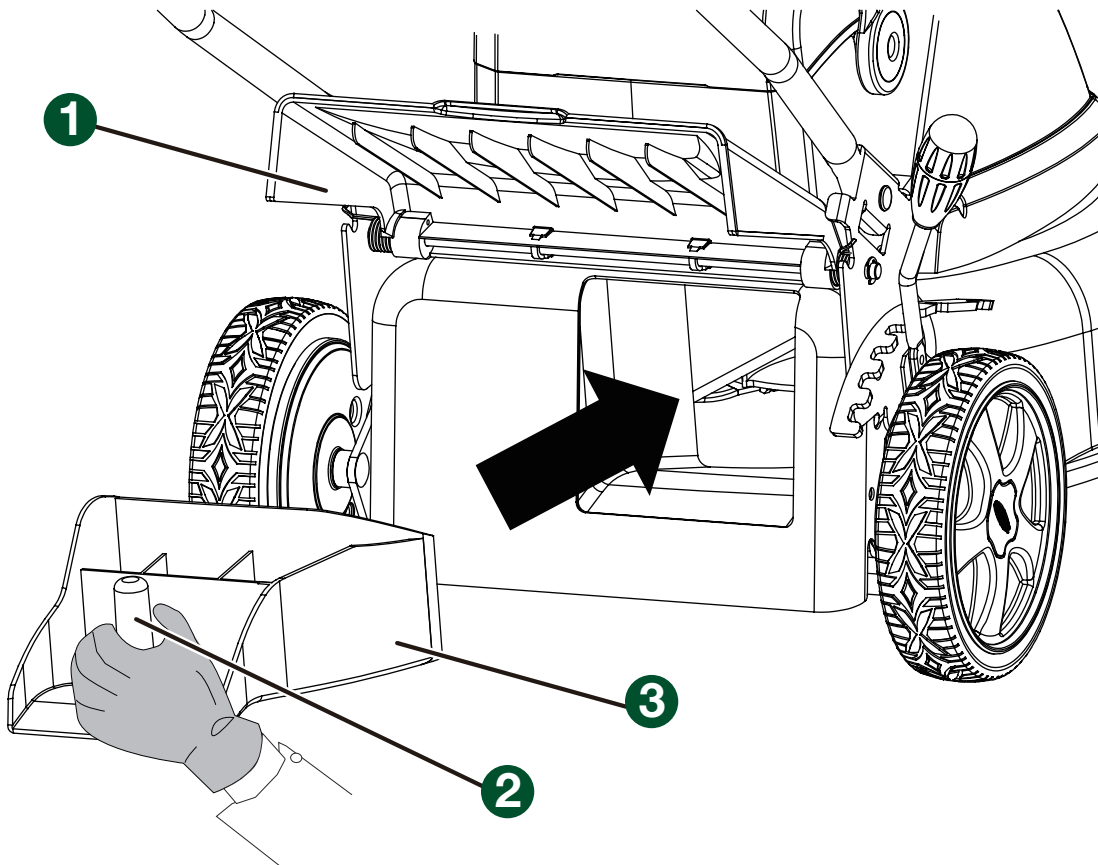

WARNING: Never operate the mower without the proper safety devices in place and working. Never operate the mower with damaged safety devices. Operation of this product with damaged or missing parts could result in serious personal injury.



model no. 060-1776-4 | contact us: 1.866.523.5218

STARTING/STOPPING THE MOWER

1. Insert the isolator key (1) into the slot on the motor/shroud assembly.
2. Press and hold the start button (2). Pull the power lever (3) toward the handle and release the button to start the mower.
3. To stop the mower, release the power lever.
4. For starting in thick grass conditions, it may be necessary to press down on the handlebars and slightly raise the front wheels until the motor reaches full speed.
5. Never lift the rear wheels as this can cause debris to be thrown towards you and increase risk of injury.

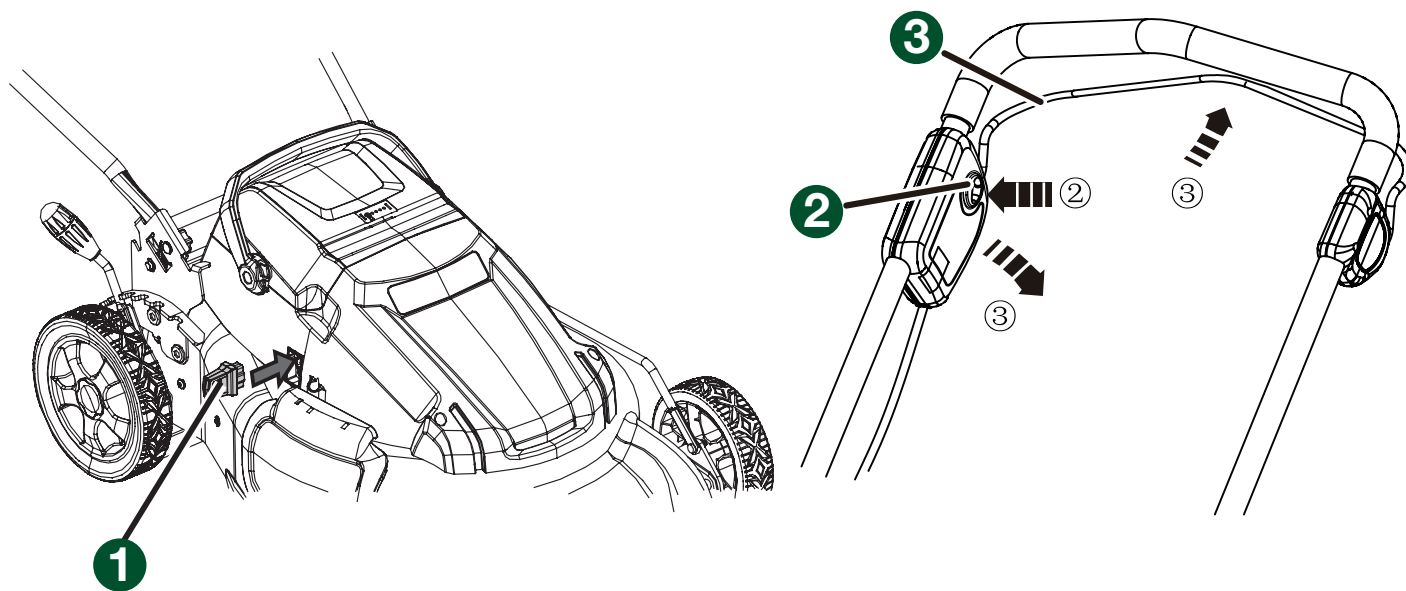

INSPECT THE CUTTING AREA

Remove all stones, sticks, wire, and other debris that might be thrown by the rotating blades.



CAUTION: Do not attempt to override the operation of the isolator key or lever.



WARNING: The operation of any mower can result in foreign objects being thrown into the eyes, which can cause severe eye damage. Always wear safety glasses that comply with ANSI Z87.1 while operating the mower and while performing any adjustments or repairs.



WARNING: Ensure that other people and pets remain at least 100' (30 m) away when the mower is in use.

CUTTING HEIGHT ADJUSTMENT

When shipped, the wheels on the mower are set to a low-cutting position. Before using the mower for the first time, raise the cutting position to the height best suited for your lawn. The average lawn should be approximately 1 1/2 to 2" (3.8 to 5 cm) during cool months, and between 2 and 3 3/4" (5 to 8.9 cm) during hotter months.

To adjust the blade height:

1. To raise the blade height, grasp the height adjustment lever (1) and move it toward the back of the mower.
2. To lower the blade height, grasp the height adjustment lever (1) and move it toward the front of the mower.

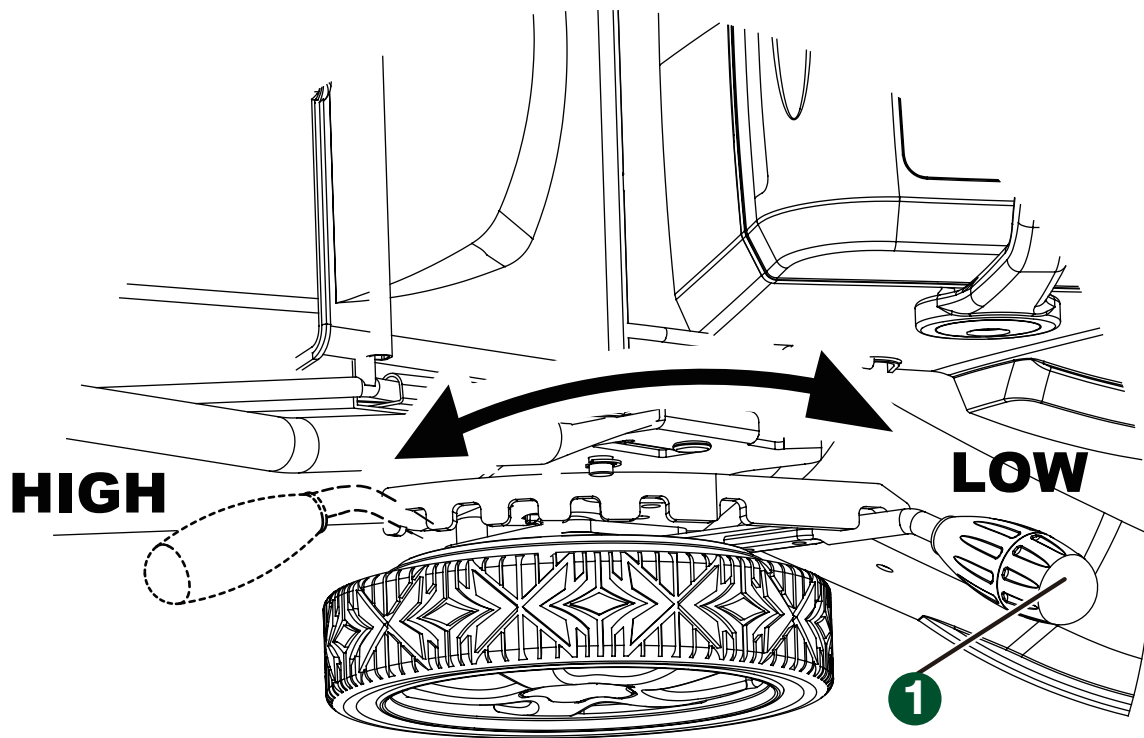



model no. 060-1776-4 | contact us: 1.866.523.5218

ADJUST THE UPPER HANDLE HEIGHT

1. Loosen the upper handle knob (1).
2. Adjust the upper handle to the most comfortable of the 3 positions.
3. Snug the upper handle knob to secure.

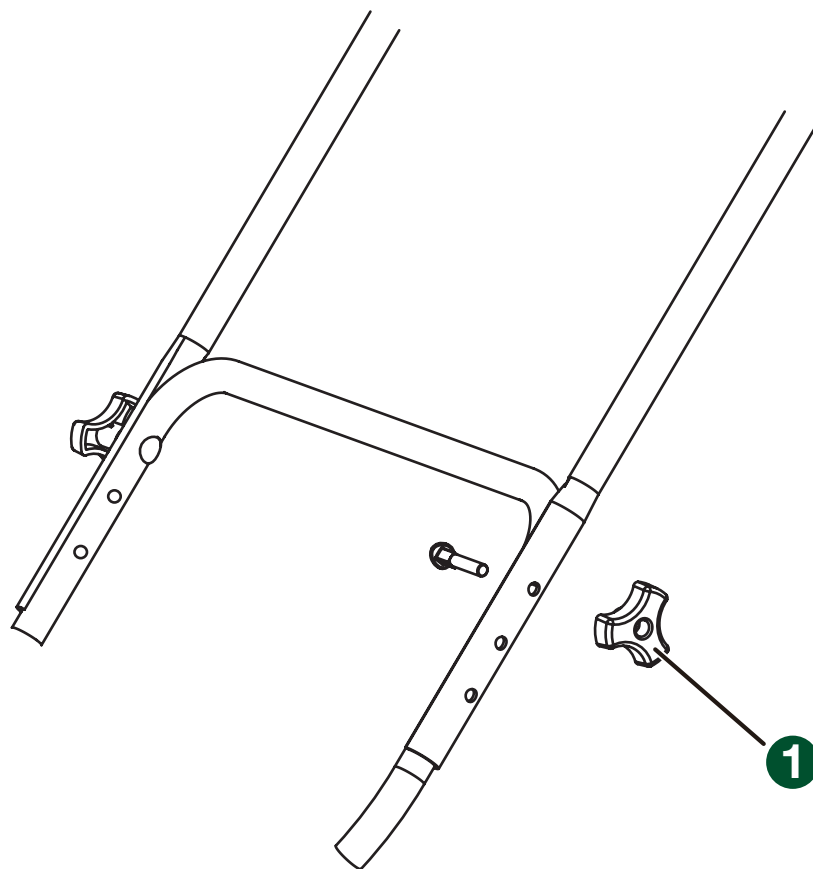

EMPTYING THE GRASS CATCHER BAG

1. Stop mower, allow blades to completely stop, and remove key.
2. Lift the rear chute cover.
3. Lift the grass catcher bag by its handle to remove from mower.
4. Empty grass clippings.
5. Lift the rear chute cover and reinstall the grass catcher bag as described earlier in this manual.





model no. 060-1776-4 | contact us: 1.866.523.5218

SLOPE OPERATION

- Slopes are a major factor related to slip and fall accidents that can result in severe injury. Operation on slopes requires extra caution. If you feel uneasy on a slope, do not mow it. For your safety, do not attempt to mow slopes greater than 15°.
- Mow across the face of slopes, not up and down. Exercise extreme caution when changing direction on slopes.
- Watch for holes, ruts, rocks, hidden objects, or bumps which can cause you to slip or trip. Tall grass can hide obstacles. Remove all objects such as rocks, tree limbs, etc., which could be tripped over or thrown by the blade.
- Always be sure of your footing. A slip and fall can cause serious personal injury. If you feel you are losing your balance, release the switch control lever immediately.
- Do not mow near drop-offs, ditches, or embankments; you could lose your footing or balance.

Operation



WARNING: Do not mow a slope that has an angle of greater than 15° (a rise of approximately 2-1/2' [75 cm] every 10' [3 m]). Mow across the face of a slope, and never up and down.



model no. 060-1776-4 | contact us: 1.866.523.5218

MOWING TIPS

- Verify that the lawn is free of stones, sticks, wires, and other objects that could damage the blades or the motor. These objects could be accidentally thrown by the mower in any direction, and could cause serious personal injury to the operator and to others.
- In order to prevent electric shock, do not operate the mower in damp or wet conditions.
- Do not mow in circles. Travel back and forth across the lawn.
- When cutting thick grass, reduce walking speed in order to allow for a more effective cut and a proper discharge of the clippings. For a healthy lawn, always cut off one-third or less of the total length of the grass. The lawn height should be approximately 1-1/2 to 2" (3.8 to 5 cm) during cooler months, and 2-3 3/4" (5 to 8.9 cm) long during hotter months. If there is growth, the lawn should be cut in the fall.

MULCHING TIPS

- Release switch to turn mower OFF when crossing any graveled area (stones can be thrown by the blade).
- Set mower at highest cutting height when mowing on rough ground or in tall weeds.
- For effective mulching, do not cut wet grass, as it tends to stick to the underside of the deck preventing proper mulching of grass clippings. New or thick grass may require a narrower cut. The ground speed should be adjusted to the condition of the lawn. If mowing has been delayed and the grass has been allowed to grow in excess of 4", mow twice to reduce the grass height to 3 3/4" maximum.
- Walk at a good, steady pace. Overlap your rows. Don't let the grass get too tall. If the grass gets too long, start at the highest cutting position and work down to the desired cutting height.



NOTE: A sharp blade will greatly enhance the performance of the mower, especially when cutting high grass. Be sure to check the blade and to sharpen it at least once a year, as described in the Maintenance section.



NOTE: ALWAYS INSPECT AREA WHERE MOWER IS TO BE USED AND REMOVE ALL STONES, STICKS, WIRE, BONES AND OTHER DEBRIS WHICH MIGHT BE THROWN BY THE ROTATING BLADE.



WARNING: If you strike a foreign object, stop the motor and Remove the battery. Thoroughly inspect the mower for any damage. Repair any damage before operating the mower. Excessive vibration of the mower during operation is an indication of damage.



model no. 060-1776-4 | contact us: 1.866.523.5218

REPLACING THE CUTTING BLADE

Use only a YARDWORKS replacement blade.

1. REMOVE BATTERY.
2. While wearing leather padded gloves, wedge a block of wood between the blade and the mower deck in order to prevent the blade from turning when the nut is being removed.
3. Using a 15 mm wrench or socket, loosen the blade nut (1) and remove the blade (4). Turn the nut COUNTER-CLOCKWISE to loosen it and CLOCKWISE to tighten it.
4. Remove the blade nut (1), the square washer (2), the insulator washer (3), and the blade.
5. To re-install the blade, position the blade with the cutting edges toward the ground. Assemble the blade nut, the square washer, and the insulator washer as shown. Using a 15 mm socket or wrench, turn the blade nut CLOCKWISE in order to secure the blade.

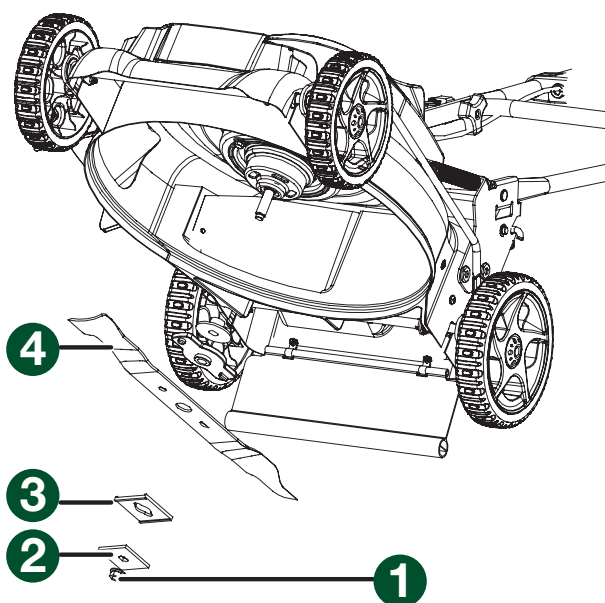
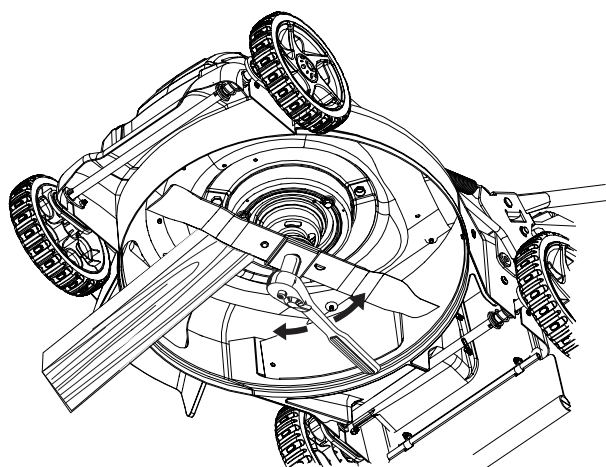

WARNING: Always protect your hands by wearing heavy gloves and/or wrapping the cutting edges with rags or other materials when performing any maintenance on the blades. **ALWAYS** remove the isolator key when servicing or transporting the mower.



NOTE: Be sure to replace the parts in the exact order in which they were removed. When installing the cutting blade, verify that it is installed with the curved ends pointing toward the mower deck, and not toward the ground. Refer to the schematic drawing on page 4 of this manual.



REPLACING THE BATTERY

The mower battery is designed for maximum life; however, like all batteries, it will eventually need to be replaced.

Charge the new battery pack before use. See Battery & Charger section of this manual.

TO INSTALL A NEW BATTERY:

1. Remove the isolator key.
2. Carefully lift the old battery by the handle.
3. Install the new battery pack.
4. Take the old battery pack to a recycling centre that accepts lead acid/lithium ion batteries. Never dispose of battery in fire or regular household trash.

CLEANING THE MOWER

The underside of mower deck should be cleaned after each use as grass clippings, leaves, dirt and other debris will accumulate, causing rust and corrosion.

- Remove any buildup of grass and leaves on or around the motor cover (do not use water). Occasionally wipe the mower clean with a dry cloth.
- If debris build up on the underside of the unit while in use, stop the motor and remove the battery. Tilt the mower forward or on its side, and scrape it clean with an appropriate tool.



WARNING: To reduce the risk of electric shock, do not expose the mower to water.



model no. 060-1776-4 | contact us: 1.866.523.5218

STORING THE MOWER

The following steps should be taken in order to prepare the lawn mower for storage.

1. Clean the mower as described in the previous section.
2. Inspect the blade, and replace it or sharpen it, if required (refer to the Maintenance section).
3. Lubricate the mower (refer to the Maintenance section).
4. Store the mower in a dry, clean location. Do not store it next to corrosive materials, such as fertilizer or rock salt.
5. Store the mower indoors, in a cool, dry place, out of the reach of children. Do not cover the lawn mower with a solid plastic sheet. Plastic coverings trap moisture around the mower, which causes rust and corrosion.
6. Remove the battery and store it in a cool dry location, if possible. Charge the battery every two months when not in use in order to extend its life.
7. Remove the key and store in a secure location out of the reach of children. Removal of the battery is not required for storage.

The handle may be folded away completely for storage.

- Fully loosen the handle knobs on the sides of the handle and fold the upper handle down.
- Push inward on each side of the lower handle, and lift the sides of the lower handle past the edges of the handle mounting brackets. Avoid pinching or trapping any cables.



WARNING: This battery must be charged when in storage to maintain running life.



model no. 060-1776-4 | contact us: 1.866.523.5218

SERVICE

- When servicing the mower, use only replacement parts that are available from the manufacturer. In order to obtain replacement parts, call the toll-free helpline, at 1-866-523-5218. The use of parts that do not meet the original equipment specifications may lead to improper performance, and may compromise safety.
- Before cleaning, repairing, or inspecting, verify that the blade and all moving parts have come to a complete stop. Remove the battery when making any adjustments or when any of the four wheels must be lifted off the ground.
- Follow the instructions for lubricating and changing accessories.
- Keep the handles dry, clean, and free of oil and grease.
- In order to reduce the risk of fire, keep the motor free of grass, leaves, and debris build-up.
- Frequently check the blade and motor mounting bolts for proper tightness frequently. Visually inspect blade for damage (e.g., bends, cracks or wear).
- For best and safest performance, maintain the mower with care. Keep the mower blade sharp and clean. Mower blades are sharp, and can cut. Wrap the blades or wear gloves, and use extra caution when servicing.
- Keep all nuts, bolts, and screws tight in order to be sure that the equipment is in safe working condition.
- Never tamper with safety devices. Check them regularly for proper operation.
- After striking a foreign object, stop the motor and remove the isolator key. Thoroughly inspect the mower for any damage. Repair any damage before operating the mower.
- The grass catcher components, discharge cover, and trail shield are subject to wear and damage, which could expose moving parts or allow objects to be thrown. As a safety precaution, check these components frequently, and immediately replace any parts that show signs of wear, or that are cracked or broken. Use original equipment manufacturer's (OEM) parts only, as listed in this manual.
- When it is not in use, store the mower indoors in a dry area, and out of the reach of children.



**WARNING: ALWAYS REMOVE KEY AND BATTERY WHEN
SERVICING OR TRANSPORTING THE MOWER.**



model no. 060-1776-4 | contact us: 1.866.523.5218











| PROBLEM | POSSIBLE CAUSE | SOLUTION |
|--|--|---|
| The mower does not start. | The battery is not charged. | Charge the battery. |
| | The switch is defective. | Replace the switch (call the toll free helpline, at 1-866-523-5218) |
| | Grass jammed at blade. | Remove battery; check under deck for jams. |
| | The battery is not attached to the motor. | Check the connection between the motor connector and the battery. |
| | Battery may require service or replacement. | Call toll free helpline, at 1-866-523-5218 or replace battery. |
| | Isolator key is not installed. | Insert the isolator key. |
| The mower cuts the grass unevenly. | The lawn is rough or uneven. | Check the mowing area. |
| | The cutting height is not set properly. | Move the wheels to a higher setting. |
| The mower does not mulch properly. | Wet grass clippings are sticking to the underside of the deck. | Wait until the grass dries before mowing. |
| | The mulching plug is missing. | Install the mulching plug. |
| The mower is hard to push. | The grass is too tall, or the cutting height is too low. | Raise the cutting height. |
| | The rear of the mower housing and the blade are dragging in thick grass. | Empty the grass clippings from the grass catcher bag. |
| The mower is excessively noisy and vibrates. | The motor shaft is bent. | Stop the motor, and inspect for damage. |
| | The blade is unbalanced. | Repair before restarting. If vibration persists, call the toll free helpline (1-866-523-5218) |



model no. 060-1776-4 | contact us: 1.866.523.5218

Symbols

Some of the following symbols may be used on this product. Please study them and learn their meaning. Proper interpretation of these symbols will allow you to operate the product better and safer.

| Symbol | Name | Designation/Explanation |
|---|----------------------------|--|
| V | Volts | Voltage. |
| A | Amperes | Current. |
| Hz | Hertz | Frequency (cycles per second). |
| W | Watts | Power. |
| min | Minutes | Time. |
|  | Alternating Current | Type of current. |
|  | Direct Current | Type or a characteristic of current. |
| n_0 | No Load Speed | Rational speed, at no load |
|  | Class II Construction | Double-insulated construction. |
| /min | Per Minute | Revolutions, strokes, surface speed, orbits etc., per minute. |
|  | Wet Conditions Alert | Do not expose to rain or use in damp locations. |
|  | Read The Operator's Manual | To reduce the risk of injury, user must read and understand operator's manual before using this product. |
|  | Eye Protection | Wear eye protection when operating this equipment. |
|  | Ricochet | Thrown objects can ricochet and result in personal injury or property damage. |
|  | Sharp Blade | Danger – Keep hands and feet away from blade. |
|  | Operating on a slope | Do not mow a slope that has an angle of greater than 15°. |
|  | Keep Bystanders Away | Keep all bystanders at least 100' away. |

ENVIRONMENTAL PROTECTION



Waste electrical products should not be disposed of with household waste. Please recycle where facilities exist. Check with your local authority or retailer for recycling advice.

The battery contains material which is hazardous to you and the environment. It must be removed and disposed of separately at a facility that accepts lead-acid batteries.

SAVE THESE INSTRUCTIONS!



model no. 060-1776-4 | contact us: 1.866.523.5218

The lawn mower comes with a maintenance-free, spill-proof, sealed 36 V battery pack.

- The battery charger is only for use indoors, it must not be used in wet or damp environments. Do not operate the charger near petrol/gasoline or other explosive gases or vapours.
- The battery should be charged in a cool, dry place. The battery charger should be operated in temperatures between 0 and 40°C.
- Only charge the battery pack only with the charger provided.
- The battery pack may be charged while it is connected to the mower, or while it is disconnected from the mower.
- Allow at least 10-13 hours of charge time before initial use of the mower.
- For optimal performance, recharge the battery every 2 months, even when it is not in use, and prior to each usage.
- To improve battery life, store battery indoors in a controlled climate.
- The battery does not have to be fully discharged before recharging.
- Two to three initial charging/discharging cycles may be required to achieve maximum run time/capacity.
- When fully charged, the battery can be safely stored in environment of 25°C for a period of up to two months, before it requires charging.



WARNING: Always remove the isolator key and store it in a separate location out of the reach of children when the mower is charging or not in use. Failure to remove the isolator key may result in accidental starting or unauthorized use and cause serious personal injury

CHARGING THE BATTERY PACK

- Make sure the power supply is normal household voltage, 120 V, 60 Hz, AC only.
- Remove the isolator key and store in separate location out of reach of children.
- **Method 1:** Remove the isolator key, then plug the charger connector into the slot on the right vent when the battery is on the mower.

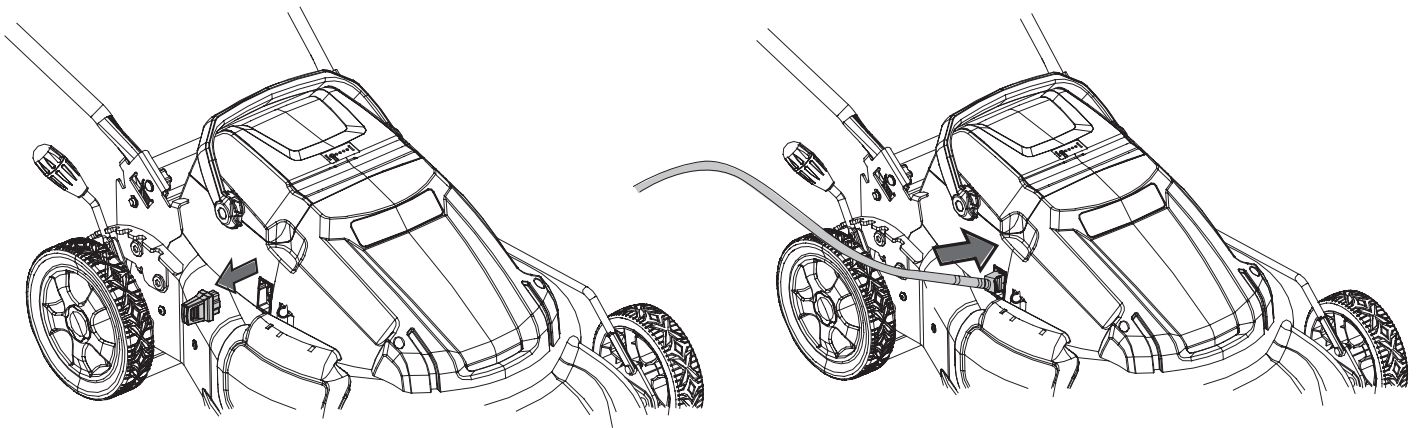

- **Method 2:** After parting the battery from the mower, plug the charger connector into the receptacle on the battery.
- Plug the charger into the wall receptacle.
- When the light is red, the battery is charging. When the light switches to green, the battery is fully charged. A fully discharged mower will charge in approximately 10-13 hours.
- When charging is complete, disconnect the charger from the battery, or the slot from the right vent.

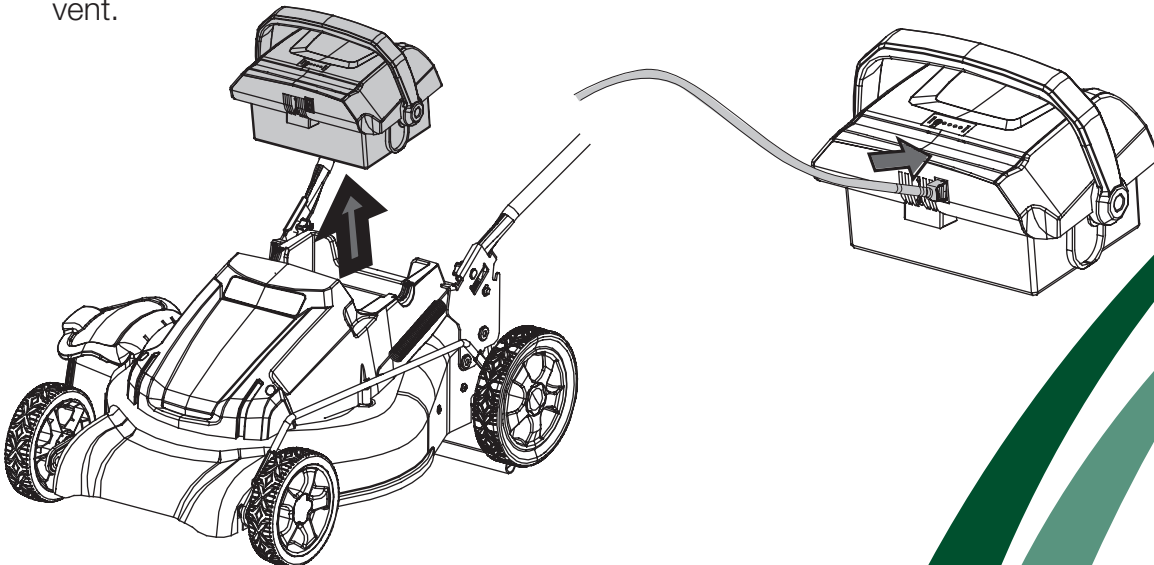
**NOTE: The battery can be charged in or out of the mower.**



model no. 060-1776-4 | contact us: 1.866.523.5218

Since the mower battery is shipped in a low charge condition, the battery must be charged before use. The battery has four LED lights to indicate battery capacity. These lights will illuminate when the button is pressed.

If four LED lights illuminate, the battery is 100% charged and ready for use. Three lights indicate a 50-80% charge.

Two lights indicate a 30-50% charge.

If one light illuminates, the battery will soon require charging. It is recommended that the battery be charged at this point. The battery is at 5-30% charge when one light illuminates.

If no light illuminates, the battery must be charged immediately before use. There is less than 5% of battery charge remaining if none of the lights are on.

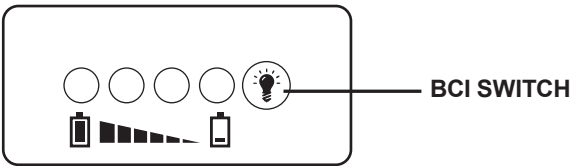

LIGHTS

CAPACITY

| | |
|----------------|--------------------|
| 4 green lights | At full capacity |
| 3 green lights | At 50-80% capacity |
| 2 green lights | At 30-50% capacity |
| 1 green light | At 5-30% capacity |



NOTE: When none of the lights are on, you must stop the mower and charge the battery immediately, or it will reduce the life of the battery.



model no. 060-1776-4 | contact us: 1.866.523.5218

GENERAL SAFETY RULES

READ ALL INSTRUCTIONS CAREFULLY

- Carefully read all instructions on the mower and in the manual before attempting to assemble and operate the mower. Keep this manual in a safe place for future reference, and consult it regularly.
- Become familiar with all controls and their proper operation. Know how to stop the mower and how to disengage the power in an emergency.
- In order to avoid contact with the blade or injury caused by a thrown object, stay in the operating zone behind the handles, and keep children and bystanders at least 100' (30 m) away from the mower while it is in operation. Stop the motor immediately if someone enters the mowing area.
- Thoroughly inspect the area where the mower is to be used. Remove all stones, sticks, wire, bones, toys, and other objects that could be tripped over or thrown by the blade. Thrown objects can cause serious personal injury.
- Plan your mowing pattern in such a way as to avoid discharging material toward roads, sidewalks, bystanders, etc. Do not discharge material against a wall or obstruction. Doing so may cause the discharged material to ricochet back toward the operator.
- Always wear proper eye protection in order to protect your eyes while operating or performing any adjustment or repair. Thrown objects that ricochet can cause serious eye injury.
- Always wear a face mask or a dust mask when operating the mower in a dusty environment.
- Dress properly. Do not wear loose clothing or jewellery that can get caught in moving parts. The wearing of protective gloves and safety footwear is recommended.



WARNING: Use of this mower should be restricted to individuals who have read and understood and will follow the warnings and instructions that are printed in this manual and on the mower.



WARNING: Basic safety precautions should always be followed when using electric lawn mowers, in order to reduce the risk of fire, electric shock, and personal injury.



DANGER: This mower was built to be operated according to the rules for safe operation that are contained in this manual. As with any type of power equipment, carelessness or error on the part of the operator can result in serious injury. This mower is capable of amputating body parts and throwing objects. Failure to observe the following safety rules could result in serious injury or death.



WARNING: This symbol indicates important safety instructions. If these instructions are not followed, it could endanger the personal safety and/or property of the operator and others. Read and understand all instructions in this manual before attempting to operate the mower. Failure to comply with these instructions may result in personal injury.



model no. 060-1776-4 | contact us: 1.866.523.5218

Safety information

- Ground Fault Circuit Interrupter (GFCI) protection should be provided on the circuit(s) or outlet(s) that will be used to charge the lawn mower battery. Outlets with built-in GFCI protection are available, and may be used as an added safety measure.
- Many injuries occur as a result of the mower being pulled over the operator's foot during a fall caused by slipping or tripping. Do not operate this mower in bare feet, or while wearing sandals or lightweight (e.g., canvas) shoes. Do not hold on to the mower if you are falling. Release the handle immediately.
- Never pull the mower back toward you while you are walking. If you must back the mower away from a wall or an obstruction, first look down and behind in order to avoid tripping, and then follow these steps:
 - Step back from the mower in order to fully extend your arms.
 - Be sure that you are well balanced.
 - Pull the mower back slowly.
- Do not use the mower for any job except that for which it is intended. Do not force the mower.
- Do not operate the mower while under the influence of alcohol or drugs.
- Stay Alert: Do not operate the mower when you are tired. Pay attention to what you are doing. Use common sense.
- Do not put hands or feet near rotating parts or under the cutting deck. Contact with the blade can amputate hands and feet.
- Do not attempt to adjust the wheels or the cutting height while the motor is running.
- Avoid dangerous environments. Do not operate the mower in the rain or in wet or damp grass.
- Mow only in daylight or in good artificial light. Do not rush a mowing job.
- Stop the blade when crossing gravel driveways, walkways, or roads.
- If the mower starts to vibrate excessively, stop the motor and check for the cause immediately. Vibration is generally a warning of trouble.
- Stop the motor and wait until the blade comes to a complete stop before removing the grass catcher or unclogging the chute. The cutting blade will continue to rotate for a few seconds after the motor is shut off. Do not place any part of your body in the blade area until you are sure that the blade has stopped rotating.
- Never operate mower without a proper trail shield, discharge cover, grass catcher, switch control, or other safety device in place and in working order. Do not operate the mower with damaged safety devices. Doing so can result in injury.



CHILD SAFETY

Tragic accidents can occur if the operator is not aware of the presence of children.

- Keep children out of the mowing area and under the watchful care of a responsible adult.
- Do not allow children under the age of 14 to operate this mower. Children who are 14 years of age and older must read and understand the operating instructions and safety rules in this manual, and must be trained and supervised by a parent.
- Stay alert, and turn the mower off if a child or any other person enters the mowing area.
- Look behind and down for small children before and while moving backwards.
- Use extreme care when approaching blind corners, doorways, shrubs, trees, or other objects that may obscure your view of a child who may run into the path of the mower.

BATTERY & CHARGER

BATTERY RULES FOR SAFETY

- Battery operated units do not have to be plugged into an electrical outlet; therefore, they are always in operating condition. Be aware of possible hazards even when unit is not operating.
- Remove the battery pack before making any adjustments, cleaning, or removing material from the unit.
- Ensure the isolator key is removed before inserting battery pack.
- A battery pack must be recharged only with the charger specified by the manufacturer. Using a charger with an incompatible battery pack may create a risk of fire. Use battery pack only with charger listed.
- Use only battery pack intended specifically for the machine. Use of any other battery packs may result in a risk of fire, electric shock, or injury to persons.
- When battery pack is not in use, keep it away from other metal objects like: paper clips, coins, keys, nails, screws, or other small metal objects that can make a connection from one terminal to another. Shorting the battery pack terminals together may cause sparks, burns, or a fire.
- Do not place battery products or their batteries near fire or heat. This will reduce the risk of explosion and possibly injury.
- Do not open or mutilate the battery pack. Released electrolyte is corrosive and may cause damage to the eyes or skin. It may be toxic if swallowed.
- Do not short-circuit the battery pack. There is danger of explosion.
- Protect the battery pack against moisture and water. Do not charge unit in a damp or wet location. Following this rule will reduce the risk of electric shock.



CAUTION: USE ONLY YARDWORKS APPROVED REPLACEMENT BATTERIES, AS OTHER BATTERIES MAY CAUSE INJURY OR DAMAGE TO THE MOWER. Use with YARDWORKS 36 V 10 Ah battery.



model no. 060-1776-4 | contact us: 1.866.523.5218

- If electrolyte contacts the skin, wash it off immediately with water.
- If electrolyte contacts the eyes, flush thoroughly and immediately with water. Seek medical attention.
- In case of damage and improper use of the battery, vapour may be emitted. Provide for fresh air and seek medical help in case of complaints. The vapour can irritate the respiratory system.
- Do not leave the battery pack in the car in the summer.
- Do not incinerate the battery.

SAFETY RULES FOR CHARGER

- Use of an attachment not recommended by the manufacturer may result in a risk of fire, electric shock, or injury to persons. Following this rule will reduce the risk of electric shock, fire, or serious personal injury.
- Do not clean machine with isolator key or charger installed.
- Do not use the charger when the ambient temperature is above 40°C or below 0°C.
- Do not operate charger with a damaged cable or plug, which could cause shorting and electric shock. Return to authorised service centre for repair or replacement.
- Do not operate charger if it has received a sharp blow, been dropped, or otherwise damaged in any way. Take it to an authorised service center for electrical check to determine if the charger is in good working order.
- Do not disassemble charger, take it to an authorised service station if repair is required. Incorrect reassembly may result in a risk of electric shock or fire.
- Unplug charger from outlet before attempting any cleaning to reduce the risk of electric shock.
- Disconnect charger from the power supply when not in use to prevent damage to the charger during a power surge.
- Do not expose machine to rain or wet conditions. Water entering charger will increase the risk of electric shock.
- Make sure cable is located so that it will not be stepped on, tripped over, come in contact with sharp edges or moving parts, or be otherwise subjected to damage or stress. This will reduce the risk of accidental wash, which could cause injury, and damage to the cable, which could result in electric shock.
- Keep cable and charger away from heat to prevent damage to housing or internal parts.
- Do not let gasoline/petrol, oils, petroleum-based products, etc. come in contact with plastic parts. They contain chemicals that can damage, weaken, or destroy plastic.



model no. 060-1776-4 | contact us: 1.866.523.5218

Safety information

- An extension cord should not be used for the charger unless absolutely necessary. Use of improper extension cord could result in a risk of fire or electric shock. If extension cord must be used, make sure:
 - That pins on plug of extension cord are the same number, size and shape as those of plug on charger.
 - That extension cord is properly wired and in good electrical condition.



WARNING: If any parts are missing, do not operate unit until the missing parts are replaced. Failure to do so could result in possible serious personal injury.



WARNING: When transporting or servicing unit, always remove the key and battery.



WARNING (PROPOSITION 65): Some dust created by power sanding, sawing, grinding, drilling and other construction activities contains chemicals known to the state of California to cause cancer, birth defects or other reproductive harm. Some examples of these chemicals are:

Lead from lead-based paints,

Crystalline silica from bricks and cement and other masonry products, and

Arsenic and chromium from chemically-treated lumber.

Your risk from these exposures varies, depending on how often you do this type of work. To reduce your exposure to these chemicals: work in a well ventilated area, and work with approved safety equipment, such as those dust masks that are specially designed to filter out microscopic particles.



model no. 060-1776-4 | contact us: 1.866.523.5218

2-YEAR LIMITED WARRANTY

For TWO YEARS from the date of purchase within Canada, YARDWORKS® CANADA will, at its option, repair or replace for the original purchaser, free or charge, any part or parts that are found to be defective in material or workmanship.

- 7-day over-the-counter replacement for initial defects for unused product (RA # required for used product)
- 2-year repair warranty
- 1-year repair warranty on 36 V battery

This warranty does not cover:

1. Any part that has become inoperative due to misuse, commercial use, abuse, neglect, accident, improper maintenance, or alteration; or
2. The unit, if it has not been operated and/or maintained in accordance with the Owner's Manual; or
3. Normal wear;
4. Routine maintenance items such as lubricants, blades, 36 V battery;
5. Normal deterioration of the exterior finish due to use or exposure.

How to Obtain Service: Warranty service is available by calling the Toll-Free Helpline, at 1-866-523-5218. YARDWORKS® CANADA will not accept the return of a complete unit unless prior written permission has been extended by YARDWORKS® CANADA.

Transportation Charges: Transportation charges for the movement of any power equipment unit or attachment are the responsibility of the purchaser. The purchaser must pay transportation charges for any part submitted for replacement under this warranty, unless such return is requested, in writing, by YARDWORKS® CANADA.

Other Warranties: All other warranties, whether express or implied, including any implied warranty of merchantability, are limited in their duration to that set forth in this express limited warranty. The provisions as set forth in this warranty provide the sole and exclusive remedy of YARDWORKS® CANADA obligations arising from the sale of its products.

Imported by YardWorks Canada, Toronto, Canada
M4S 2B8

YARDWORKS CANADA will not be liable for incidental or consequential loss or damage.

