



4-247-475-21
030108AMI-H-B

Micro Hi-Fi Component System

XR-EM200

OPERATING INSTRUCTIONS

En (English)

COMPACT
disc
DIGITAL AUDIO

WARNING

To prevent fire or shock hazard, do not expose the unit to rain or moisture.

To avoid electrical shock, do not open the cabinet. Refer servicing to qualified personnel only.

Do not install the appliance in a confined space, such as a bookcase or built-in cabinet.

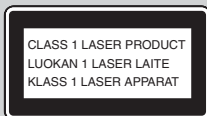

This appliance is classified as a CLASS 1 LASER product.

This label is located on the exterior.

To prevent fire, do not cover the ventilation of the apparatus with newspapers, table-cloths, curtains, etc. And don't place lighted candles on the apparatus.

To prevent fire or shock hazard, do not place objects filled with liquids, such as vases, on the apparatus.

PRECAUTIONS

On operating voltage

Before operating the system, check that the operating voltage of your system is identical with the voltage of your local power supply.

On safety

- The unit is not disconnected from the AC power source (mains) as long as it is connected to the wall outlet, even if the unit itself has been turned off.
- Unplug the system from the wall outlet (mains) if it is not to be used for an extended period of time. To disconnect the cord (mains lead), pull it out by the plug. Never pull the cord itself.
- Should any solid object or liquid fall into the component, unplug the stereo system and have the component checked by qualified personnel before operating it any further.
- The AC power cord must be changed only at a qualified service shop.

On placement

- Place the unit in a location with adequate ventilation to prevent heat build-up the unit.
- Do not place the unit in an inclined position.
- Do not place the unit in locations where it is:
 - Extremely hot or cold
 - Dusty or dirty
 - Very humid
 - Vibrating
 - Subject to direct sunlight.

On heat buildup

- Although the unit heats up during operation, this is not malfunction.
- Place the unit in a location with adequate ventilation to prevent heat build-up in the unit.

If you continuously use this unit at a large volume, the cabinet temperature of the top, side and bottom rises considerable. To avoid burning yourself, do not touch the cabinet.

On operation

- If the system is brought directly from a cold to a warm location, or is placed in a very damp room, moisture may condense on the lens inside the CD player. Should this occur, the system will not operate properly. Remove the CD and leave the system turned on for about an hour until the moisture evaporates.
- When you move the system, take out any discs.

Notes on discs

- Discs recorded on CD-R/RW drives may not be played back because of scratches, dirt., recording condition or the drive's characteristics.
- CD-R/RW discs which are not finalized at the end of recording cannot be played back.
- Do not attach adhesive label, etc. to either side of a CD-R/RW disc, as doing so may cause malfunction.
- Do not load an unrecorded CD-R/RW disc. The disc may be damaged.
- Discs with non-standard shapes (e.g., heart, square, star) cannot be played on this unit. Attempting to do so may damage the unit. Do not use such discs.
- DVD, SACD, CD-ROM, VCD, and CD with MP3 files cannot be played on this unit.

Music discs encoded with copyright protection technologies

This product is designed to playback discs that conform to the Compact Disc (CD) standard. Recently, various music discs encoded with copyright protection technologies are marketed by some record companies. Please be aware that among those discs, there are some that do not conform to the CD standard and may not be playable by this product.

If you have any questions or problems concerning your stereo system, please consult your nearest Aiwa dealer.

TABLE OF CONTENTS

PRECAUTIONS	2
PREPARATIONS	4
PARTS AND CONTROLS	5
ADJUSTMENTS BEFORE OPERATION	7
CD OPERATIONS	8
TUNER OPERATIONS	10
SOUND ADJUSTMENTS	11
TAPE PLAYBACK	12
TAPE RECORDING	13
TIMER OPERATIONS	14
REFERENCE	16

PREPARATIONS

Connection

Plug in the AC power cord to the AC power socket after all other connections are made.

- 1 Connect the speakers to the main unit.
Connect the right speaker to the SPEAKERS R terminals and the left to the SPEAKERS L terminals. The speaker cords with the black stripes go to the \ominus terminals.

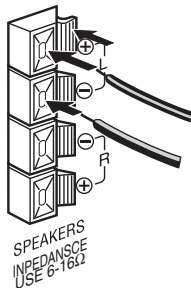

- 2 Connect the supplied antennas.
Connect the FM antenna to the FM 75 Ω terminal and the AM antenna to the AM jack.

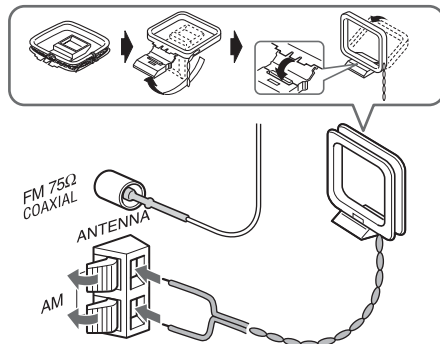

- 3 Connect the AC power cord to an AC power socket.
The clock will appear in the display.
For setting the clock, see page 7.

Speakers

- Do not short-circuit the \oplus and \ominus speaker cord leads.
- Do not leave objects generating magnetism or objects affected by magnetism near the speakers.

Antennas

Keep antennas away from metallic objects, electrical equipment and cords.

- **FM antenna:** Extend fully and position for the best reception. If reception is poor, connect an optional outdoor antenna to the FM 75 Ω terminal. Note that, when connecting an optional outdoor antenna, use an adaptor as required.
- **AM antenna:** Rotate to find best reception.

Remote commander

Detach the battery compartment lid at the rear of the remote commander and insert two R6 (size AA) batteries with correct polarity.

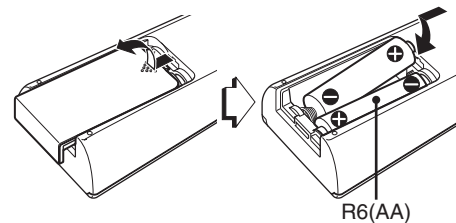

- Replace the batteries with new ones when the operational distance between the remote commander and main unit becomes shorter.
- Remove the batteries if the unit is not going to be used for an extended period of time.
- The remote commander may not operate if it is used under intense sunlight or if its line of sight is obstructed.

PARTS AND CONTROLS

Main unit: front

Refer to the pages indicated in parentheses for details.

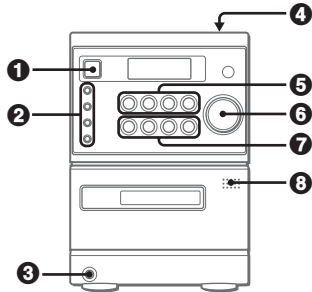

1 POWER ϕ STANDBY/ON (7)

Switches the unit on and off (standby).

2 ECO (7)

Sets the ECO mode on or off.

SYNCHRO REC (13)

Starts recording and CD play simultaneously.

REC START/REC PAUSE (13)

Starts and pauses recording.

DISPLAY (8)

Changes the display in CD playback mode.

3 PHONES jack

Plug in optional headphones set with a stereo mini plug ($\phi 3.5$ mm). Speaker output is cancelled.

4 OPEN (8)

Opens or closes the disc compartment.

5 \blacktriangleright ||CD (7-9)

Starts and pauses CD play.

TUNER/BAND (7, 10)

Selects tuner function and the tuner band.

\blacktriangleright TAPE (REC MUTING) (7, 12, 13)

Starts playback.

Also used to enter 4-second blank spaces during recording.

AUX (7)

Selects the function of external equipment connected to AUX IN jacks.

6 VOLUME (11, 14)

Adjusts the volume.

7 \blacktriangleleft /| \blacktriangleleft \blacktriangleleft , \blacktriangleright | \blacktriangleright / \blacktriangleright (8, 10-12, 14, 15)

CD: skips to a previous or a succeeding track when pressed, searches a track in fast forward or reverse playback when held down.
Tape: rewinds or fast forwards the tape.

Tuner: manually tunes up or down within the band.

\blacksquare STOP (8, 9, 12, 13)

CD and tape: stops playback.
Tuner: clears a preset station.

TONE (11)

Adjusts the bass or treble level.

8 \blacktriangle PUSH EJECT (12, 13)

Opens or closes the cassette holder.

Main unit: rear

Refer to the pages indicated in parentheses for details.

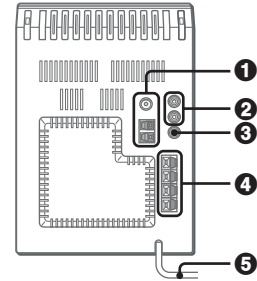

1 AM jack and FM 75 Ω terminal (4)

Plug in the supplied AM and FM antennas.

2 AUX IN jacks

Accept analogue sound signals from external equipment. Connect external equipment using an optional connecting cable with RCA phono plugs (red plug to R jack, white plug to L jack). Refer also to the operating instructions for your equipment.

To switch function to external input, press AUX.

To change a source name in the display of the AUX function.

Hold down AUX and press POWER while the power is on.



3 SUB WOOFER jack

Connect optional powered sub woofer with a built-in amplifier to the jack.

4 SPEAKER terminals (4)

Connect the speaker cords of the supplied speakers.

5 AC power cord (4)

Remote commander

Refer to the pages indicated in parentheses for details.

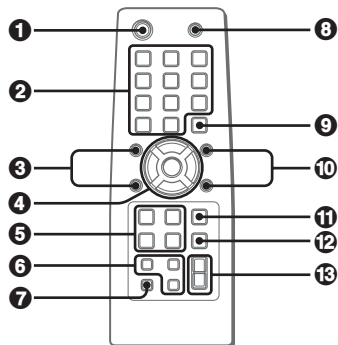

Buttons with the same or similar names on the main unit basically have the same function.

❶ POWER (7)

❷ 1-10/0, >10 (8-10)

CD: selects a track of the specified number.

Tuner: tunes in the station with the specified preset number.

The numbered buttons take on these functions when pressed with SHIFT held down:

CLOCK (7)

Selects clock mode.

TIMER (14)

Selects timer mode.

TUNER MODE (10)

Switches between stereo or monaural FM reception.

❸ SHUFFLE/PROGRAM (8, 9)

Selects shuffle or programmed CD playback mode.

REPEAT (8)

Selects repeat CD playback mode.

❹ PRESET \wedge , \vee (10)

$\lll/I\lll, \ggg/I\ggg$ (8, 10-12, 14, 15)

ENTER (7, 10, 14, 15)

Determines the mode.

Stores the received station to preset.

❺ \ggg CD (7-9)

TUNER/BAND (7, 10)

\lll TAPE (7, 12)

Starts playback but cannot change the playback side.

AUX (7)

❻ DISPLAY (8)

Changes the display in CD playback mode.

DIMMER (7)

Adjusts the display window brightness.

SLEEP (14)

Selects sleep-timer mode.

❼ SHIFT

Hold down when pressing a numbered button to change its function to that printed above the number.

❽ MUTING (11)

To turn off the sound temporarily.

❾ CLEAR (9, 10, 15)

CD: Clears a CD program.

Tuner: Clears a preset station.

❿ TREBLE (11)

Adjusts the treble level.

BASS (11)

Adjusts the bass level.

⓫ \blacksquare (8, 9, 12, 13)

⓬ FUNCTION (13)

Switches the active function among TAPE, TUNER, AUX (VIDEO or TV) and CD.

⓭ VOLUME \pm , $-$ (11)

ADJUSTMENTS BEFORE OPERATION

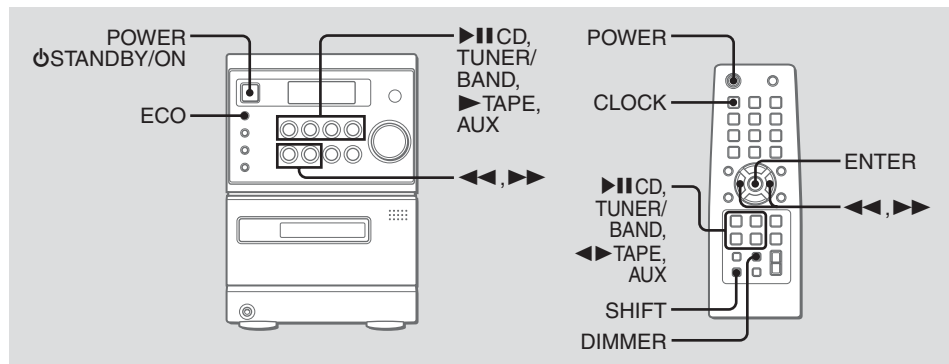

Power

Turning the unit on

Press POWER \mathcal{O} STANDBY/ON (POWER on the remote). Alternatively, press \blacktriangleright TAPE, TUNER/BAND, AUX or \mathbb{H} CD. Playback will start automatically if a disc or tape is loaded.

Turning the unit off

Press POWER \mathcal{O} STANDBY/ON again. The unit goes into standby.

Dimmer

The display window brightness can be selected.

Press DIMMER on the remote repeatedly.

Each press of the button changes the following three levels: "DIMMER 1", "DIMMER 2" and "DIMMER 0".

"DIMMER 0" is the brightest.

ECO mode

Reduces power consumption in standby mode with the following operations.

Press ECO.

Each press of the button changes the mode as follows:

ECO ON: Power economizing mode is activated.

When the unit turns off, everything in the display disappears and only the red indicator above POWER lights to show that the power is being supplied.

ECO OFF: Power economizing mode is cancelled.

When the unit turns off, the clock display appears.

Initial mode is ECO OFF.

Standby power consumption

ECO ON: 0.3 W

ECO OFF: 6 W

Setting the clock

- 1 In stop mode, hold down SHIFT and press CLOCK on the remote.
Go to step 3 when the hour of the clock display flashes.
- 2 Within 6 seconds, press ENTER.
The hour flashes in the display.
- 3 Press \blacktriangleleft or \blacktriangleright to set the hour, then press ENTER.
- 4 Press \blacktriangleleft or \blacktriangleright to set the minute.
Each press changes the time in 1-minute steps.
- 5 Press ENTER.
The time display stops flashing and the clock starts from 00 seconds.

To display the time while the power is on

Hold down SHIFT and press CLOCK on the remote. The time will be displayed for 6 seconds.

If "-: -:" appears when the unit is turned off

There has been a power interruption. Reset the clock.

CD OPERATIONS

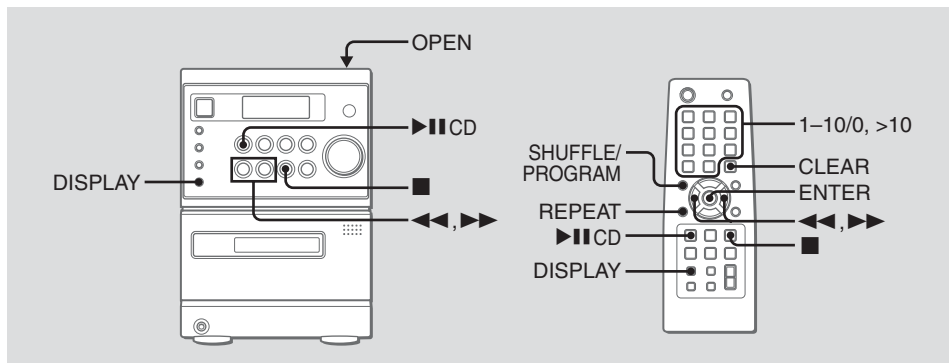

This unit plays back finalized CD-R/RW discs as well as audio CDs.

Playing a CD

- 1 Press OPEN to open the disc compartment. Place a disc with the label side up. Then close the disc compartment by pressing OPEN.
- 2 Press ▶||CD to start play.

To stop play

Press ■.

To pause play

Press ▶||CD. Press again to resume play.

To select a track

Press ◀◀ or ▶▶ repeatedly.

To search (playback in fast forward or reverse)

Hold down ◀◀ or ▶▶. Release at the desired point.

To select a track with the remote (Direct play)

- Press the numbered buttons to select a track.
- To select the 25th track, press >10, 2 and 5.
 - To select the 10th track, press 10/0.

To change the display in playback mode

Press DISPLAY repeatedly during play.

The display changes in the following order:

- Track number and elapsed playing time
- Track number and remaining time of current track
- Remaining time of disc

Shuffle play

In shuffle play mode the unit plays all the tracks in random order.

- 1 In stop mode, press SHUFFLE/PROGRAM on the remote repeatedly so that "SHUFFLE" indicator is displayed.
- 2 Press ▶||CD to start play.

To cancel shuffle play

In stop mode, press SHUFFLE/PROGRAM on the remote repeatedly until "SHUFFLE" and "PRGM" indicators disappear.

Repeat play

In repeat play mode it plays repeatedly all the tracks or the track being played. You can select shuffle and repeat play at the same time.

Press REPEAT on the remote repeatedly.

The mode changes as follows:

"↺": Plays all the tracks repeatedly.

"↺1": Plays one track repeatedly. Select the track with ◀◀ or ▶▶.

To cancel repeat play

Press REPEAT on the remote repeatedly until "↺" and "↺1" disappear.

Programmed play

Plays back up to 30 selected tracks in programmed order.

- 1 In stop mode, press SHUFFLE/PROGRAM on the remote repeatedly so that "PRGM" indicator is displayed.
- 2 Press the numbered buttons on the remote to program a track.
 - To select the 15th track, press >10, 1 and 5.
 - To select the 20th track, press >10, 2 and 10/0.The selected track number lights up on the display.
- 3 Repeat step 2 to program other tracks.
The total number of selected tracks and total playing time will be displayed.
- 4 Press ►|| CD to start play.
The track number for the current track flashes on the display.
 - During programmed play, you cannot select a track with the numbered buttons.
 - If the total playing time of the program exceeds 99 minutes and 59 seconds, or if a track with a track number exceeding 30 is programmed, the playing time is displayed as "- :- -".
 - You cannot program more than 30 tracks. "FULL" is displayed.

To clear a track

Press CLEAR on the remote. Each time you press the button, a track is cleared from the end of the program.

To clear the entire program

Press ■ in stop mode.

To add tracks to the program

Repeat step 2 before starting playback. The tracks are added to the end of the program.

To cancel programmed play

Press SHUFFLE/PROGRAM repeatedly until "PRGM" disappears.

- The program contents are retained even if the program cancelled or after programmed playback finishes. The same program plays back if you carry out step 1 and 4.

Notes on CDs

- Do not place more than one disc.
- Do not tilt the unit with a disc loaded.

TUNER OPERATIONS

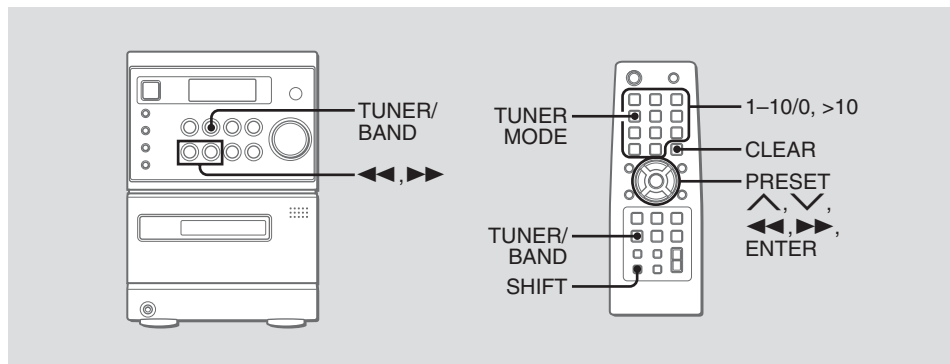

Manual tuning

- 1 Press TUNER/BAND repeatedly to select a band. The unit switches to the tuner from any other function and alternates between FM and AM.
- 2 Press ◀◀ or ▶▶ repeatedly to tune in a station. "TUNE" is displayed when a station is tuned in. "(((Ⓜ)))" is displayed for FM stereo reception.

To search for a station automatically (Auto search)

Hold down ◀◀ or ▶▶.

The unit searches for a station and stops at reception.

To stop the search manually, press ◀◀ or ▶▶.

- Auto search may not stop at stations with weak signals.

Preset tuning

Preset up to 32 of your favourite stations and tune them in directly.

Presetting stations

- 1 Tune in the desired station.
 - 2 Press ENTER on the remote to store the station. The preset number, beginning from "1" flashes in the display.
 - 3 Repeat steps 1 and 2 to preset other stations. The next station will not be stored if a total of 32 preset stations have already been stored. ("FULL" is displayed.)
- If power is interrupted for more than approximately 12 hours, all settings stored in memory after purchase need to be reset.

Tuning in preset stations

- 1 Select the band.
- 2 Press PRESET ^, v on the remote repeatedly. With each press, the station with the succeeding or preceding preset number is tuned in. You can tune in the desired preset station directly by pressing the numbered buttons on the remote.
 - To select preset number 7, press 7.
 - To select preset number 12, press >10, 1 and 2.

To clear a preset station

- 1 Tune in the station by preset tuning.
- 2 Press CLEAR, then press ENTER on the remote within 6 seconds. Preset station numbers in the band which are higher than the cleared number decrease by one.

SOUND ADJUSTMENTS

Adjustments

To switch to monaural FM reception

Hold down SHIFT and press TUNER MODE on the remote so that "MONO" is displayed.

To cancel, repeat the above so that "STEREO" is displayed.

Tip:

When FM stereo reception is poor, switching to monaural reduces noise.

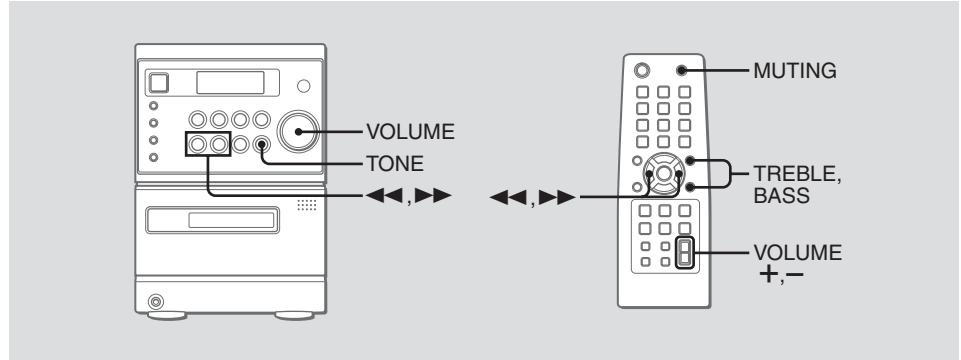

Volume

Turn VOLUME (press VOLUME +, - on the remote).
Adjust from 0 (minimum) to 26 and MAX (maximum).

Muting

Press MUTING on the remote.
Playback continues without sound and "MUTING" appears in the display.

Bass and treble

- 1 Press TONE repeatedly (BASS or TREBLE on the remote) to display "BAS" or "TRE".
"BAS" : Adjusts the bass level
"TRE" : Adjusts the treble level
- 2 Press ◀◀ or ▶▶ to adjust the level within 6 seconds.
Each level can be adjusted from "-2" to "+5".
 - If the sound becomes distorted, lower the level.

TAPE PLAYBACK

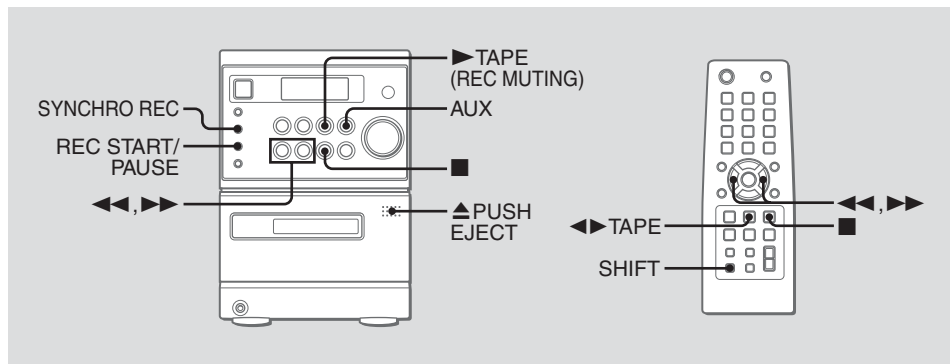

Notes on cassettes

- Use of a tape longer than 90 minutes is not recommended since they are extremely thin and easily damaged. If you should use one, do not change the tape operations such as play and stop frequently.
- Take up any slack in the tape with a pencil or similar tool before use. Slack tape may get entangled in the deck mechanism and become damaged.

Playback

Use only type I (normal) tapes.

- 1 Press ▲PUSH EJECT to open the cassette holder.
- 2 Insert the tape.
Insert with the exposed side down, and press ▲PUSH EJECT to close the cassette holder.

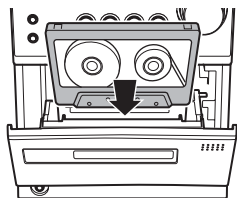

- 3 Press ►TAPE (REC MUTING) (◀◀TAPE on the remote) to start play.

To stop playback

Press ■.

To rewind or fast forward

Press ◀◀ or ▶▶.

To reset the tape counter

Press ■ in stop mode, and the tape counter in the display is reset to "0000".

Opening and closing the cassette holder will also reset the tape counter.

To eject the tape

Press ▲PUSH EJECT after the deck stops completely.

TAPE RECORDING

To record a CD

Use only type I (normal) tapes.

- 1 Press ▲PUSH EJECT to open the cassette holder.
 - 2 Insert the recordable tape.
Insert with the exposed side down, and the side to be recorded on first facing out from the unit. Press ▲PUSH EJECT to close the cassette holder.
 - 3 Press FUNCTION on the remote repeatedly to select the CD function, and load the disc.
To record only one track, start play of the track.
 - 4 Press SYNCHRO REC.
The unit enters the recording pause mode, and "REC" indicator flashes on the display.
 - 5 Press REC START /PAUSE to start recording.
"MUTING" flashes in the display for 10 seconds and recording starts.
When only a track is to be recorded, CD playing returns to the beginning of the current track and recording starts.
- Volume or tone adjustment(s) does not affect recording.
 - "NO TAB" is displayed if you attempt to record a tape with the tab broken off.
 - Only one side of the tape can be recorded at a time.

To record a selected set of tracks from a CD

Program the desired tracks (see "Programmed play" on page 9) and then press SYNCHRO REC.

To record radio programs and external equipment

Use only type I (normal) tapes.

- 1 Press ▲PUSH EJECT to open the cassette holder.
- 2 Insert the recordable tape.
- 3 Prepare the source.
To record radio programs, press TUNER/BAND and tune in the desired station.
To record from connected external equipment, press AUX and prepare the equipment.
- 4 Press REC START/PAUSE twice to start recording.
When recording input from connected equipment, manually start playback of the source.

To stop recording

Press ■.

To pause recording (only for TUNER or AUX source)

Press REC START/PAUSE. Press again to resume.

To record a 4-second blank space (only for TUNER or AUX source)

Inserting 4-second blank spaces may help you locate the beginning of the track on other equipment with the "Music Sensor" function.

- 1 Press ►TAPE (REC MUTING) on the unit during recording or in recording pause mode.
"MUTING" flashes in the display for 4 seconds (a blank space is added) and then the unit enters recording pause mode.
- 2 Press REC START/PAUSE to resume recording.

To record a blank space shorter than 4 seconds, press again while "MUTING" flashes.

To record a blank space longer than 4 seconds, press again after the unit enters recording pause mode.

Each time the button is pressed, a 4-second blank space is added.

To erase a tape

- 1 Insert the tape. Set the tape to the desired point if needed.
- 2 Press AUX.
If optional equipment is connected to the AUX IN jacks, turn it off.
- 3 Press REC START/PAUSE twice.

To prevent accidental erasure

Remove the plastic tab of the cassette tape with a screwdriver or other pointed tool. To record on the tape again, cover the detection slot with adhesive tape.

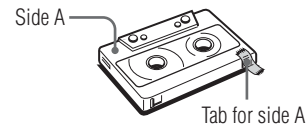

TIMER OPERATIONS

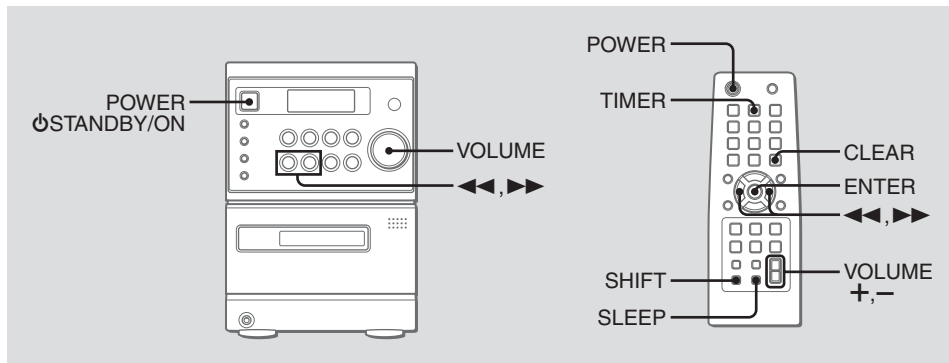

Sleep timer

Turns off the unit automatically after a specified time.

Press SLEEP on the remote.

"SLEEP" flashes in the display.

With each press, the timer duration changes as follows:

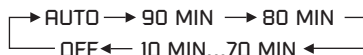

If you set to "AUTO", the unit turns off automatically when the current CD or tape finishes playback or elapsed 100 minutes.

To check the remaining time until the unit turns off

Press SLEEP on the remote. The remaining time is displayed for 6 seconds.

To cancel the sleep timer

Press SLEEP on the remote repeatedly so that "OFF" is displayed.

Timer playback

Turns on the unit at a specified time for the specified duration.

Make sure the clock is set correctly.

- 1 Press VOLUME +, - to set the volume level.
- 2 Hold down SHIFT and press TIMER on the remote repeatedly so that "⌚" and "PLAY" are displayed.
- 3 Within 6 seconds, press ENTER.
"ON TIME" is displayed.
- 4 Press ◀ or ▶ to set the timer start hour, and press ENTER.
- 5 Press ◀ or ▶ to set the minute, and press ENTER.
"OFFTIME" is displayed.
- 6 Set the time to stop playback by following the same procedures as steps 4 and 5.

7 Press ◀ or ▶ to select the source (CD, TAPE and TUNER), and press ENTER.

8 Prepare the source.

To play CD, load a disc.

To play a tape, insert a tape.

To play the radio, select the band and tune in the desired station.

9 Press POWER ⏻/STANDBY/ON (POWER) to turn the unit off.

"⌚" remains in the display to indicate the timer standby mode (when ECO mode is deactivated).

At timer-on time, the unit turns on and plays the selected source. After the specified timer-activated duration, the unit turns off again.

- To stop timer setting in steps 4 to 6, press CLEAR. Timer standby mode is also cancelled.
- The timer playback is not activated when the clock is not set. ("SET NG" is displayed.)
- Timer playback will not begin unless the unit is turned off first.
- Timer playback for AUX source is not possible.

Timer recording

Timer recording is available only for TUNER sources.

- 1 Hold down SHIFT and press TIMER on the remote repeatedly so that "⊖" and "REC" are displayed.
- 2 Within 6 seconds, press ENTER.
"ON TIME" is displayed.
- 3 Press ◀ or ▶ to set the timer start hour, and press ENTER.
- 4 Press ◀ or ▶ to set the minute, and press ENTER.
"OFFTIME" is displayed.
- 5 Set the time to stop recording by following the same procedure as steps 3 and 4.
- 6 Select the band and tune in the desired station.
- 7 Insert a recordable tape and then turn the unit off.
"⊖" and "REC" remains in the display to indicate the timer standby mode (when ECO mode is deactivated).
At timer-on time, the unit turns on and records the selected source. After the specified timer-activated duration, the unit turns off again.

- To stop timer setting in steps 1 to 4, press CLEAR.
Timer standby mode is also cancelled.
- The timer recording is not activated when the clock is not set. ("SET NG" is displayed.)
- The timer recording will not begin unless the unit is turned off first.
- Volume level is automatically set to 0 (minimum) when the timer recording is activated.

To check the timer setting

Hold down SHIFT and press TIMER on the remote repeatedly so that "PLAY" or "REC" appears in the display.
The timer-on time, the time to stop playback/recording and the source are displayed for 6 seconds.

To change the timer setting

Reset the timer again.

To cancel the timer

Hold down SHIFT and press TIMER on the remote repeatedly until "OFF" is displayed. "⊖" and "REC" disappear from the display.

Tip:

Your timer setting is retained even if the timer is cancelled.
Next time the timer is activated, you can change your previous setting, or simply use the same setting again.

Notes

- The timer playback performs every day at the specified time unless you cancel it.
- You cannot set the same time for timer-on time and timer-off time. "SET NG" is displayed if you do that. In this case, reset the time.
- The timer playback will not begin unless the unit is turned off first.

REFERENCE

Care and maintenance

Occasional care and maintenance of the unit and the software are needed to optimize the performance of your unit.

To clean the cabinet

Use a soft and dry cloth. If the unit surfaces are extremely dirty, use a soft cloth lightly moistened with mild detergent solution. Do not use strong solvents such as alcohol, benzine or thinner.

To clean the tape heads

Dirty tape heads cause sound deterioration. After every 10 hours of use, clean the tape heads by using a commercially available dry-type or wet-type head cleaning cassette separately. Refer to the instructions of the cleaning cassette.

To demagnetize the tape heads

Use a demagnetizing cassette after every 20 to 30 hours of use. Refer to the instructions of the demagnetizing cassette.

Care of CDs

When a CD becomes dirty, wipe it from the centre out with a cleaning cloth. Please do not use solvents. After playing a CD, store it in its case. Do not expose a CD to direct sunlight or heat sources.

Care of tapes

Store tapes in their cases after use. Do not leave tapes near magnets, motors, television sets, or any source of magnetism. Do not expose tapes to direct sunlight, or leave them in a car parked in direct sunlight.

Troubleshooting

If your unit fails to perform properly, check the following guide and the relevant sections of the Operating Instructions.

First check that the AC power cord and the speakers are connected correctly and firmly.

Should any problem persist, consult your nearest Aiwa dealer.

General

There is no sound

- Are the speakers and AC power cord connected properly?
- Turn VOLUME clockwise and hold.
- The headphones are connected.
- Insert only the stripped portion on the speaker cord into the SPEAKER terminal. Inserting the vinyl portion of the speaker cord will obstruct the speaker connections.

The display shuts off suddenly

- Possibly a short circuit in the speaker terminals. Disconnect the AC power cord from the AC power socket and reconnect the speaker cords correctly.

The unit blacks out when the unit is turned off.

- Is ECO mode set to on? (see "ECO mode" on page 7)

Erroneous display

- Reset the unit. (see "Resetting the unit" on page 17)

There is severe hum or noise.

- A TV or VCR is placed too close to the stereo system. Move the stereo system away from the TV or VCR.

The clock indication does not show the correct time.

- A power interruption occurred. Set the clock and timer settings again.

The clock setting/radio presetting/timer is cancelled.

- The AC power cord is disconnected or a power failure occurs longer than half a day.
Redo the following:
 - "Setting the clock" on page 7
 - "Preset tuning" on page 10
- If you have set the timer, also redo "Timer playback/recording" on page 14 and 15.

The timer does not function.

- Set the clock correctly.

The remote does not function.

- There is an obstacle between the remote and the unit.
- The remote is not pointing in the direction of the unit's sensor.
- The batteries have run down. Replace the batteries.

Tuner

Poor reception

- Check antenna connection. Adjust the antenna to find the best reception.
- For FM, move the FM antenna to reduce the noise.
- For AM, re-rotate the AM antenna to reduce the noise.
- Move the unit and antenna away from other electric appliances and cords.

CD player

The sound drops out.

- The lens is dirty. Clean it with a commercially available blower.

The CD does not play.

- The CD is not lying flat in the disc compartment.
- The CD is dirty.
- The CD is inserted label side down.
- Moisture condensation has built up. Remove the CD and leave the system turned on for about an hour until the moisture evaporates.

Tape deck

The tape does not record.

- No tape in the deck.
- The tab has been removed from the cassette tape.
- The tape has reeled to the end.

The tape does not record nor play or there is decrease in sound level.

- The heads are dirty. Clean them (see "To clean the tape heads" on page 16).
- The record/playback heads are magnetized. Demagnetize them (see "To demagnetize the tape heads" on page 16).

The tape does not erase completely.

- The record/playback heads are magnetized. Demagnetize them (see "To demagnetize the tape heads" on page 16).

There is excessive wow or flutter, or the sound drops out.

- The capstans or pinch rollers are dirty. Clean them (see "To clean the tape heads" on page 16).

Noise increases or the high frequencies are erased.

- The record/playback heads are magnetized. Demagnetize them (see "To demagnetize the tape heads" on page 16).

Poor tape sound.

- Use TYPE I (normal) tapes.

Speakers

Sound comes from one channel or unbalanced left and right volume occurs.

- Check the speaker connection and speaker placement.

Sound lacks bass.

- Check that the speaker's ⊕ and ⊖ terminals are connected correctly.

Resetting the unit

If an unusual condition occurs in the display window or the cassette deck, reset the unit as follows:

1 Press POWER to turn off the power.

If the power cannot be turned off, disconnect the AC power cord, then plug it in again.

2 Hold down ■ and press POWER on the main unit.

Everything stored in memory after purchase is cleared.

Specifications

MAIN UNIT CX-LEM200

TUNER

FM tuning range	87.5 MHz to 108 MHz
FM usable sensitivity (IHF)	16.8 dBf
FM antenna terminal	75 ohms (unbalanced)
MW tuning range	531 kHz to 1602 kHz
AM usable sensitivity	350 μ V/m
AM antenna	Loop antenna

AMPLIFIER

Power output	Rated: 8 W + 8 W(6 Ω , T.H.D. 1 %, 1 kHz/DIN 45500) Reference: 10 W + 10 W(6 Ω , T.H.D. 10 %, 1 kHz/DIN 45324)
--------------	---------------------------------------------------------------------------------------------------------------------------------

MUSIC POWER

20 W + 20 W

Input	AUX IN: 800 mV
Outputs	SPEAKERS: 6 Ω or more PHONES: 32 Ω or more

CASSETTE DECK

Track format	4 tracks, 2 channels stereo
Frequency response	50 Hz – 10000 Hz
Recording system	AC bias
Heads	Recording/playback \times 1, erase \times 1

CD PLAYER

Laser	Semiconductor laser ($\lambda = 780$ nm) Emission duration: continuous
D/A converter	1 bit dual
Signal-to-noise ratio	95 dB (1 kHz, 0 dB)
Wow and flutter	Unmeasurable

SPEAKER SYSTEM SX-LEM200

Speakers system	1 way, bass-reflex type (magnetic shielded)
Speaker units	Full range: 100 mm, cone type
Normal impedance	6 Ω
Dimensions (w/h/d)	Approx. 140 \times 230 \times 169 mm
Mass	Approx. 1.4 kg net per speaker

GENERAL

Power requirements	230 V AC, 50/60 Hz
Power consumption	40 W
Power consumption in standby mode	with ECO mode on: 0.3 W with ECO mode off: 6 W
Dimensions (w/h/d)	Approx. 163 \times 230.5 \times 243 mm
Mass	Approx. 3.0 kg
Supplied accessories:	FM antenna (1) AM antenna (1) Remote commander (1) Batteries (2)

Specifications and external appearance are subject to change without notice.

COPYRIGHT

Check copyright laws relevant to recordings from discs, radio or tape for the country where the unit is to be used.

