

clarion®

Owner's manual
Mode d'emploi
Bedienungsanleitung
Istruzioni per l'uso
Gebruiksaanwijzing
Manual de instrucciones
Bruksanvisning
Manual de instruções

CZ109E

CZ109ER

CZ109EG

CD/MP3/WMA RECEIVER
AUTORADIO CD/MP3/WMA
CD/MP3/WMA-RECEIVER
SINTOLETTORE CD/MP3/WMA
CD/MP3/WMA-RADIO-COMBINATIE
RECEPTOR CD/MP3/WMA
CD/MP3/WMA-RADIO
RECEPTOR CD/MP3/WMA

CAUTIONS:

This appliance contains a laser system and is classified as a "CLASS 1 LASER PRODUCT". To use this model properly, read this Owner's Manual carefully and keep this manual for your future reference. In case of any trouble with this player, please contact your nearest "AUTHORIZED service station". To prevent direct exposure to the laser beam, do not try to open the enclosure.

!CAUTION

USE OF CONTROLS OR ADJUSTMENTS OR PERFORMANCE OF PROCEDURES OTHER THAN THOSE SPECIFIED IN THE OWNER'S MANUAL MAY RESULT IN HAZARDOUS RADIATION EXPOSURE.

ADVARSEL.

Denne mærking er anbragt udvendigt på apparatet og indikerer, at apparatet arbejder med laserstråler af klasse 1, hvilket betyder, at der anvendes laserstråler af svageste klasse, og at man ikke på apparatets yderside kan blive udsat for utilladelig kraftig stråling.

APPARATET BØR KUN ÅBNES AF FAGFOLK MED SÆRLIGT KENDSKAB TIL APPARATER MED LASERSTRÅLER!

Indvendigt i apparatet er anbragt den her gengivne advarselsmærkning, som advarer imod at foretage sådanne indgreb i apparatet, at man kan komme til at udsætte sig for laserstråling.

OBS!

Apparaten innehåller laserkomponenten som avger laserstråling överstigande gränsen för laserklass 1.

VAROITUS

Suojakoteloa si saa avata. Laite sisältää laserdiodin, joka lähettää näkymätöntä silmille vaarallista lasersäteilyä.

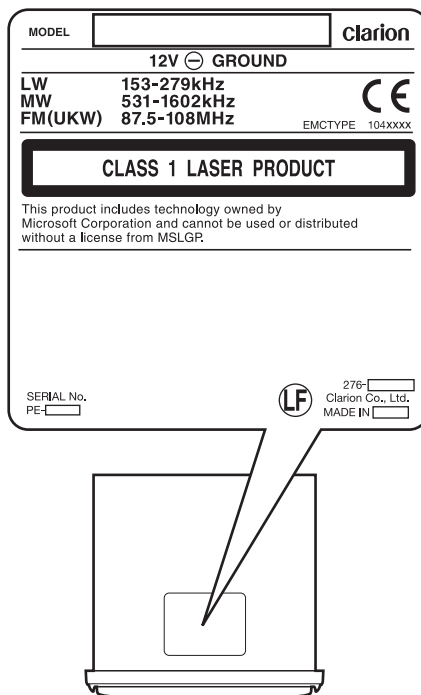

Thank you for purchasing this **Clarion** product.

- * Please fully read this owner's manual before operating this equipment.
- * Check the contents of the enclosed warranty card and store it in a safe place with this manual.

Contents

1. FEATURES	3
2. PRECAUTIONS	3
3. CONTROLS	4
Names of the Buttons and Their Main Functions	4
4. DCP (DETACHABLE CONTROL PANEL)	5
5. OPERATIONS	6
Basic Operations	6
Radio Operations	8
RDS Operations	9
CD/MP3/WMA Operations	11
Operations Common to Each Mode	13
6. TROUBLESHOOTING	15
7. ERROR DISPLAYS	16
8. SPECIFICATIONS	16

1. FEATURES



- MP3/WMA compatible with ID3-TAG display
- Front-panel auxiliary input & 2ch RCA output
- “Z-Enhancer Plus” with 2 Band Parametric Equalizer & “MAGNA BASS EX” dynamic bass enhancement

2. PRECAUTIONS

This unit is applicable for on-road 4 wheel vehicle purpose only. Use for tractor, fork truck, bulldozer, off road vehicle, 2 or 3 wheel motor bicycle, marine boat or other special purpose vehicle is not appropriate.

INFORMATION FOR USERS:

CHANGES OR MODIFICATIONS TO THIS PRODUCT UNAPPROVED BY THE MANUFACTURER WILL VOID THE WARRANTY.

Handling Compact Discs

- Compared to ordinary music CDs, CD-R and CD-RW discs are easily affected by high temperatures and humidity, potentially making them unplayable. Therefore, do not to leave them in the car for a long time.
- Do not stick labels on compact discs or mark the surface with pens or pencils.

Display Screen

- In extreme cold, the screen movement may slow down and the screen may darken, but this is normal.
The screen will recover when it returns to normal temperature.

3. CONTROLS

Names of the Buttons and Their Main Functions

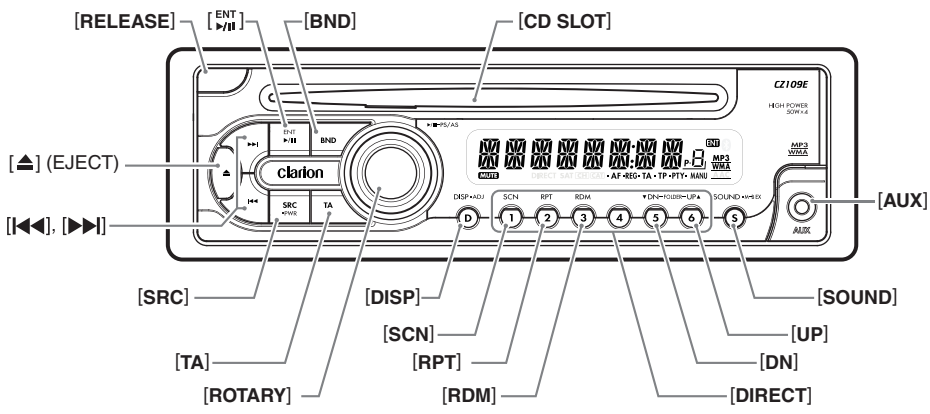

[RELEASE] button

- Press to unlock DCP.

[ENT] button

- Perform preset scan while in the radio mode.
- Play or pause a track while in CD/MP3/WMA mode.

[BND] button

- Change bands, or select seek tuning or manual tuning while in radio mode.

[CD SLOT]

- Insert CDs here.

[AUX] input jack

- Input jack for connecting external device.

[SOUND] button

- Press to switch to the sound adjust mode.

[UP], [DN] buttons

- Select folders while in MP3/WMA mode.

[DIRECT] buttons

- Store radio stations in memory or recall it directly while in radio mode.

[RDM] button

- Perform random play while in CD/MP3/WMA mode.

[RPT] button

- Perform repeat play while in CD/MP3/WMA mode.

[SCN] button

- Perform scan play in CD/MP3/WMA mode.

[DISP] button

- Switch display mode.

[ROTARY] knob

- Rotate to adjust the volume.

[TA] button

- Press to set the TA (Traffic Announcement) standby mode.

[SRC] button

- Turn the power on/off.

[<<<], [>>>] buttons

- Commence fast-forward/fast-reverse mode.

[▲] (EJECT) button

- Press to eject disc.

4. DCP (DETACHABLE CONTROL PANEL)

Removing the DCP

1. Press and hold the [SRC] button (1 sec.) to switch off power.
2. Press the [RELEASE] button.

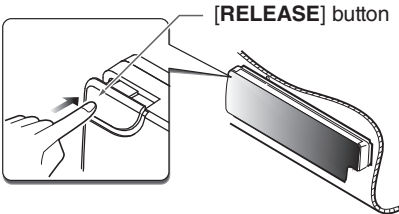

* DCP is unlocked.

3. Remove DCP.

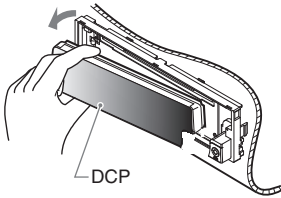

Attaching the DCP

1. Insert the right end of DCP into main unit.
2. Press left end of DCP into main unit.

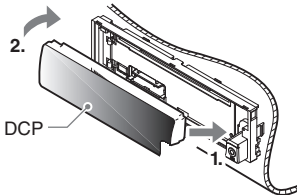

⚠ CAUTION

- After removal, be careful not to drop the DCP or subject it to strong impacts, to prevent damage.
- Once the [RELEASE] button is pressed and the DCP is unlocked, car vibrations can cause the DCP to fall.
- The connector for the main unit and DCP is extremely important. Be careful not to damage it by pressing with fingernails or sharp objects.

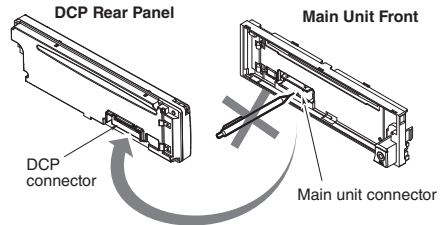

Note:

- If the DCP is dirty, wipe off with a soft, dry cloth only.

5. OPERATIONS

Note:

- Refer to the diagrams in "3. CONTROLS" (page 4) when reading this chapter.

Basic Operations



Be sure to lower the volume before switching off the unit power or car's ignition key. The unit remembers its last volume setting.

Turning power on/off

1. Press the [SRC] button to turn on power.
2. Press and hold the [SRC] button (1 sec.) to turn off power.

Selecting modes

1. Press the [SRC] button to change operation mode.
2. Each time the [SRC] button is pressed, the operation mode changes as follows:
Radio → CD/MP3/WMA → AUX → Radio...

Adjusting the volume

1. Turn the [ROTARY] knob clockwise to increase volume; turn counterclockwise to decrease volume.
- * Volume range is 0 (minimum) to 33 (maximum).

Switching the display

Press the [DISP] button to select desired display.

Sound Adjustment

Sound effects and tone can be adjusted as desired.

To change sound settings

1. Press the [SOUND] button to switch to the sound adjustment display.
 - * The factory default sound setting is "Z-EHCR+".
2. Press [◀◀] or [▶▶] to select the sound adjustment mode.

Each time [◀◀] or [▶▶] is pressed, the sound adjustment mode changes as follows:

"Z-EHCR+" ↔ "BASS" ↔ "TREBLE" ↔ "BALANCE" ↔ "FADER"

 - * When "ENT" is flashing in the display, press the [ENT] button to adjust the setting value.
 - * The sound adjustment mode is displayed for 2 seconds before showing the sound setting.
3. Turn the [ROTARY] knob to adjust the selected audio mode.
4. After completing settings, press the [SOUND] button to return to the previous mode.

● Setting the Z-Enhancer Plus

This unit has 4 sound tone effects stored in memory.

Select the effect you prefer.

- * The factory default setting is "OFF".

2-1. Select "Z-EHCR+".

3-1. When you turn the [ROTARY] knob, the tone effect changes as follows:

"OFF" ↔ "B-BOOST" ↔ "IMPACT" ↔ "EXCITE" ↔ "CUSTOM"

OFF : No sound effect

B-BOOST : Enhanced bass

IMPACT : Enhanced bass and treble

EXCITE : Enhanced bass, mid, and treble

CUSTOM : User customized

When set to "B-BOOST/IMPACT/EXCITE":

3-2. Press the [ENT] button.

3-3. Turn the [ROTARY] knob to adjust the setting (Setting range: -3 to +3).

- * The factory default setting is "0".

3-4. Press the [ENT] button to return to the previous mode.

When set to “CUSTOM”:

- 3-2. Press and hold the [ENT] button (1 sec.).
Bass/treble characteristics become flat and “**FLAT**” is show in the display.
- 3-3. Turn the [ROTARY] knob to change to the “**OFF**” mode.

● Adjusting the bass

This adjustment is supported only when Z-Enhancer Plus is set to “**CUSTOM**”.

- 2-1. Select “**BASS**”.
- 3-1. Press the [ENT] button.
- 3-2. Press [◀◀] or [▶▶] to change and select settings as follows:
“**B<G 0>**” ↔ “**B<F 60>**” ↔ “**Q 1**”
- 3-3. Turn the [ROTARY] knob to adjust values for gain, F (center frequency) and Q curve.
- B<G 0>** : The factory default setting is “**0**”.
(Adjustment range: +7 to -7)
- B<F 60>** : The factory default setting is “**60**”.
(Adjustment range: 60/80/100/200)
- Q 1** : The factory default setting is “**1**”.
(Adjustment range: 1/1.25/1.5/2)

- 3-4. Press the [ENT] button to return to the previous mode.

● Adjusting the treble

This adjustment is supported only when Z-Enhancer Plus is set to “**CUSTOM**”.

- 2-1. Select “**TREBLE**”.
- 3-1. Press the [ENT] button.
- 3-2. Press [◀◀] or [▶▶] to change and select settings as follows:
“**T<G 0>**” ↔ “**T<F 10K>**”
- 3-3. Turn the [ROTARY] knob to adjust values for gain and F (center frequency).
- T<G 0>** : The factory default setting is “**0**”.
(Adjustment range: +7 to -7)
- T<F 10K>**: The factory default setting is “**10K**”.
(Adjustment range: 10K/12.5K/15K/17.5K)
- 3-4. Press the [ENT] button to return to the previous mode.

● Adjusting the balance

- 2-1. Select “**BALANCE**”.
- 3-1. Turn the [ROTARY] knob to adjust balance between right and left speakers.
* The factory default setting is “**CENTER**”.
(Adjustment range: RIGHT12 to LEFT12)

● Adjusting the fader

- 2-1. Select “**FADER**”.
- 3-1. Turn the [ROTARY] knob to adjust balance between front and rear speakers.
* The factory default setting is “**CENTER**”.
(Adjustment range: FRONT12 to REAR12)

Note:

- When in the sound adjustment mode, if no operation is performed for 10 seconds or more, the mode is cancelled and the unit returns to the previous mode.

Setting the MAGNA BASS EXTEND

The MAGNA BASS EXTEND function does not adjust low frequencies like normal sound adjustments, but emphasizes the deep bass range with dynamic sound.

- * The factory default setting is “**OFF**”.
1. Press and hold the [SOUND] button (1 sec.) to enable MAGNA BASS EXTEND.
 2. Press and hold the [SOUND] button (1 sec.) to disable MAGNA BASS EXTEND.

CT (Clock Time) function

The CT function receives CT data sent from an RDS station and displays the time.

- * If a CT data is not being received, “**CT--:--**” appears in the display.

Note:

- CT data is not transmitted in some countries and by some broadcast stations. Also, in some areas, the CT may not display accurately.

Radio Operations

Listening to broadcasts

1. Press the [SRC] button and select radio mode.
 - * PS: Programme service name
 - * PTY: Programme type
2. Press the [BND] button and select the reception band. Each time the button is pressed, the band changes as follows:
F1 (FM1) → F2 (FM2) → F3 (FM3) → AM (MW/LW) → F1 (FM1)...

Tuning

3 tuning modes are available: seek tuning, manual tuning and preset tuning.

Seek tuning

2 seek tuning modes are available: DX SEEK and LOCAL SEEK.

DX SEEK can automatically tune to receivable broadcast stations; LOCAL SEEK can tune to only broadcast stations with a good reception sensitivity.

- * If "MANU" is appeared in the display, press [BND] (1 sec.).
"MANU" in the display goes off and seek tuning is now available.
- * If "TA" is appeared in the display, TP stations are automatically sought.

● DX SEEK

Press [◀◀] or [▶▶] to automatically seek stations.

When the [▶▶] button is pressed, the station is sought in the direction of higher frequencies; if the [◀◀] button is pressed, the station is sought in the direction of lower frequencies.

● LOCAL SEEK

If [◀◀] or [▶▶] is pressed and held in position (1 sec.), local seek tuning will be enabled. Broadcast stations with good reception sensitivity are selected.

Manual tuning

2 modes are available: Quick tuning and step tuning.

● Quick tuning

Press and hold [◀◀] or [▶▶] (1 sec.) to tune a station.

● Step tuning

Press [◀◀] or [▶▶] to manually tune a station.

- * If no operation is performed for 7 seconds or more, manual tuning is cancelled and the display returns to the previous mode.

Recalling a preset station

A total of 24 preset positions (6-FM1, 6-FM2, 6-FM3, 6-AM) can be used to store broadcast stations in memory. Press the corresponding [DIRECT] button to automatically recall the stored frequency.

Manual memory

1. Use seek tuning or manual tuning to select the desired station.
2. Press and hold one of the [DIRECT] buttons (2 sec.) to store the current station in preset memory.

Auto store

The auto store function stores up to 6 stations automatically tuned in sequential order. If 6 stations cannot be found, any previously stored station remains in its memory position.

1. Press the [BND] button and select the desired band (FM/AM (MW/LW)).
2. Press and hold the [ENT] button (2 sec.). The stations with good reception are stored automatically to the preset channels.
 - * If auto store is performed in the FM bands, the stations are stored in FM3 even if FM1 or FM2 was chosen for storing stations.

Preset scan

Preset scan sequentially receives stations stored in preset memory. This function is useful when searching for a station stored in the memory.

1. Press the [ENT] button.
2. When the desired station is received, press the [ENT] button again to continue receiving that station.

Note:

- Do not press and hold the [ENT] button (2 sec.), or the auto store function will begin and the unit will begin storing stations.

RDS Operations

RDS (Radio Data System)

This unit has a built-in RDS decoder system that supports broadcast stations transmitting RDS data.

When using the RDS function, always set the radio to FM mode.

AF function

The AF function switches to a different frequency on the same network in order to maintain optimum reception.

* The factory default setting is "ON".

1. Press and hold the [DISP] button (1 sec.) to switch to the RDS adjustment selection display.
2. Press [◀◀] or [▶▶] to select "AF".
3. Turn the [ROTARY] knob to select "ON" or "OFF".

- **ON:**

"AF" appears in the display and AF function will be enabled.

- **OFF:**

"AF" turns off in the display and AF function will be disabled.

4. Press the [DISP] button to return to the previous mode.

* If the reception of the current broadcast station deteriorates, "SEARCH" appears in the display and radio searches for the same programme on another frequency.

REG (Regional programme) function

When the REG function is ON, the optimum regional station can be received. When this function is OFF, if the regional station area switches as you drive, a regional station for that region is received.

* The factory default setting is "OFF".

Notes:

- This function is disabled when a national station such as BBC R2 is being received.
- The REG function ON/OFF setting is valid when the AF function is ON.

1. Press and hold the [DISP] button (1 sec.) to switch to the RDS adjustment selection display.
2. Press [◀◀] or [▶▶] to select "REG".
3. Turn the [ROTARY] knob to select "ON" or "OFF".
 - **ON:**
"REG" appears in the display and REG function will be enabled.
 - **OFF:**
"REG" turns off in the display and REG function will be disabled.
4. Press the [DISP] button to return to the previous mode.

Manually tuning a regional station in the same network

1. This function is valid when the AF function is ON and the REG function is OFF.

Note:

- This function can be used when a regional broadcast of the same network is received.
2. Press any of the [DIRECT] buttons to call out the regional station.
 3. If the reception condition of the called out station is bad, press same [DIRECT] button. The unit receives a local station on same network.

TA (Traffic Announcement)

In the TA standby mode, when a traffic announcement broadcast starts, the traffic announcement broadcast is received as top priority regardless of the function mode so you can listen to it. Traffic programme (TP) automatic tuning is also available.

* This function can only be used when "TP" appears in the display. When "TP" appears, this means that the RDS broadcast station being received has traffic announcement programmes.

● Setting the TA standby mode

If you press the [TA] button when only “TP” appears in the display, “TP” and “TA” appear in the display and the unit is set into the TA standby mode until a traffic announcement is broadcast. When a traffic announcement broadcast starts, “TRA INFO” appears in the display. If you press the [TA] button while a traffic announcement broadcast is being received, the traffic announcement broadcast reception is cancelled and the unit goes into the TA standby mode.

● Cancelling the TA standby mode

As “TP” and “TA” appears in the display, press the [TA] button. The “TA” in the display goes off and the TA standby mode is cancelled.

* If “TP” is not appeared, pressing the [TA] button searches for a TP station.

● Searching for a TP station

When “TP” is not appeared, if you press the [TA] button, “TA” appears in the display and the unit automatically receives a TP station.

Auto store function for TP stations

You can automatically store up to 6 TP stations into preset memory. If the number of TP can be received less than 6, broadcast stations already stored in memory and left without being overwritten.

As “TA” appears in the display, press and hold the [ENT] button (2 sec.). The TP stations with the good reception sensitivity are stored into preset memory.

* Even if you select FM1 or FM2, a TP station is stored in memory for FM3.

PTY (Programme Type)

This function enables you to listen to a broadcast of the selected programme type even if the unit is on a function mode other than radio.

- * Some countries do not yet have PTY broadcast.
- * In the TA standby mode, a TP station has priority over a PTY broadcast station.
- * The factory default setting is “OFF”.

1. Press and hold the [DISP] button (1 sec.) to switch to the RDS adjustment selection display.
2. Press [◀◀] or [▶▶] to select “PTY”.
3. Turn the [ROTARY] knob to select “ON” or “OFF”.

• ON:

“PTY” appears in the display and PTY standby mode is enabled. When the selected PTY broadcast starts, the PTY item name appears in the display.

• OFF:

“PTY” turns off in the display and PTY standby mode is cancelled.

4. Press the [DISP] button to return to the previous mode.

● Cancelling a PTY interrupt broadcast

Press the [TA] button during the PTY interrupt broadcast, the PTY interrupt is cancelled and the unit returns to PTY standby mode.

Selecting PTY

1. Press and hold the [DISP] button (1 sec.) to switch to the RDS adjustment selection display.
2. Press [◀◀] or [▶▶] to select “PTY SEL”.
3. Press the [ENT] button.
4. Press any of the [DIRECT] buttons.
Alternatively, turn the [ROTARY] knob to select the desired PTY.
5. Press the [DISP] button to return to the previous mode.
 - * 6 types of PTY are stored for the [DIRECT] buttons.
 - * The PTY select mode is cancelled automatically 7 seconds after a PTY is selected.

PTY seek

1. Press and hold the [DISP] button (1 sec.) to switch to the RDS adjustment selection display.
2. Press [◀◀] or [▶▶] to select “PTY SEL”.
3. Press the [ENT] button.
4. Press the [▶▶] button to search for a PTY broadcast in the direction of higher frequencies; press the [◀◀] button to search in the direction of lower frequencies.
 - * If no station with the selected PTY broadcast can be received, the unit returns to the PTY select mode.

PTY preset memory

1. Press and hold the [DISP] button (1 sec.) to switch to the RDS adjustment selection display.
2. Press [◀◀] or [▶▶] to select "PTY SEL".
3. Press the [ENT] button.
4. Turn the [ROTARY] knob to select the desired PTY.
29 types of PTY can be selected.
5. If you press and hold any of the [DIRECT] buttons (2 sec.), the selected PTY is stored into that preset channel memory.

Emergency broadcast

If an emergency broadcast is received, all the function mode operations are stopped.

"ALARM I" appears in the display and the emergency broadcast can be heard.

● Cancelling an emergency broadcast

If you press the [TA] button, emergency broadcast reception is cancelled.

Switching the PTY display language

You can select one of 4 languages (English, German, Swedish or French) for the PTY in the display.

* The factory default setting is "ENGLISH".

1. Press and hold the [DISP] button (1 sec.) to switch to the adjustment selection display.
2. Press [◀◀] or [▶▶] to select "LANGUAGE".
3. Turn the [ROTARY] knob to select the language.
4. Press the [DISP] button to return to the previous mode.

Volume setting of TA, emergency broadcast (Alarm) and PTY

The volume for TA, Alarm and PTY interrupts can be set during TA, Alarm or PTY interrupt.

* The factory default setting is "15".

During a TA, Alarm or PTY interrupt, turn the [ROTARY] knob to set volume to desired level (0 to 33).

* When the TA, Alarm or PTY interrupt ends, the volume returns to the previous level.

CD/MP3/WMA Operations

MP3/WMA

This unit supports to play MP3/WMA files.

Notes:

- If you play a WMA file with active DRM (Digital Rights Management), no audio is output (WMA indicator flashes).
 - Windows Media™, and the Windows® logo are trademarks, or registered trademarks of Microsoft Corporation in the United States and/or other countries.
- #### ● To disable DRM (Digital Rights Management)
1. In Windows Media Player 9/10/11, click on TOOL → OPTIONS → MUSIC RECORD tab. Under Recording settings, unclick the check box for RECORD PROTECTED MUSIC. Then reconstruct files.
Use personally constructed WMA files at your own responsibility.

Precautions when creating MP3/WMA files

● Usable sampling rates and bit rates

1. MP3: Sampling rate: 8 kHz-48 kHz,
Bit rate: 8 kbps-320 kbps / VBR
2. WMA: Bit rate: 48 kbps-192 kbps

● File extensions

1. Always add a file extension ".MP3" or ".WMA" to MP3 or WMA files using single byte characters. If a different or no file extension is appended, the file cannot be played.
2. Files without MP3/WMA data will not play. Instead, "--:--" will appear in the play time display.

● Logical format (File system)

1. When writing MP3/WMA files on a CD-R or CD-RW disc, select "ISO9660 level 1, 2, or JOLIET or Romeo" as the software format. Normal playback may not be possible if recorded in other formats.
2. The folder name and file name can be displayed as the title during MP3/WMA play. However titles must be within 64 single byte alphabetical letters and numbers (including extension).
3. Do not affix a name to a file inside a folder with the same name.

● Number of files or folders

1. Up to 256 files can be recognized per folder.
Up to 578 files can be played.
2. Tracks are played in the order they were recorded onto the disc. (Tracks may not always be played in the order displayed on the PC.)
3. Some noise may occur depending on the type of encoder software used for recording.

Ejecting a CD

1. Press the [▲] button to eject the CD. Take it out from the ejected position. "EJECT" appears in the display.

Notes:

- If you force a CD in before auto reloading, you may damage the CD.
- If a CD (12 cm) is left ejected for 15 seconds, it will be automatically reloaded (auto reload).

Listening to a disc already loaded in the unit

Press the [SRC] button to select CD/MP3/WMA mode.



When the unit enters this mode, playback starts automatically.

If no disc is loaded, "NO DISC" appears in the title display.

Loading a CD

1. Insert a CD into the centre of the CD SLOT with label facing up. The CD plays automatically after loading.

Notes:

- Never insert foreign objects into the CD SLOT.
- If the CD does not enter easily, another CD may be in the unit, or the unit may require service.
- Discs without the  or  mark and CD-ROMs are not supported.
- Some CD-R/CD-RW discs may not be usable.

Pausing play

1. Press the [ENT] button to pause play. "PAUSE" appears in the display.
2. To resume CD play, press the [ENT] button again.

Displaying CD titles

This unit can display title data for CD-text/MP3/WMA discs.

1. Each time the [DISP] button is pressed, the title display will change.

● CD-TEXT discs

Track → Disc → Artist → Track ...

● MP3/WMA discs

Track → Folder → Title → Album → Artist → Track ...

Notes:

- If the CD playing is not a CD-text disc, "NO TITLE" appears in the display.
- If an MP3/WMA disc has no Tag input, "NO TITLE" appears in the display.
- This unit supports MP3 ID3 Tags V2.3 / 2.2 / 1.1 / 1.0.
- Tag display gives priority to V2.3 / 2.2.
- For WMA album Tags, the information written into the extension header is displayed.
- ISO8859-1, ASCII, S-JIS characters can be displayed in Tags.
UNKNOW characters can be turned into ISO8859-1 characters.
- Titles up to 32 bytes can be displayed in CD/MP3/WMA mode.

Selecting a track

● Track advance

1. Press the [▶▶] button to move to the beginning of the next track.
2. Each time the [▶▶] button is pressed, the track advances to the beginning of the next track.

● Track back

1. Press the [◀◀] button to return to the beginning of the current track.
2. Press the [◀◀] button twice to return to the beginning of the previous track.

Fast-forward/fast-reverse

● Fast-forward

1. Press and hold the [▶▶] button (1 sec.).

● Fast-reverse

1. Press and hold the [◀◀] button (1 sec.).

* For MP3/WMA discs, some time is required until to initiate movement between tracks. Also, some error may occur in the playing time.

Folder select

Select a folder containing MP3/WMA files and begins playing the first track in the folder.

1. Press [UP] or [DN].
Press the [UP] button to move to the next folder. Press the [DN] button to move to the previous folder.
2. To select a track, press [◀◀] or [▶▶].

Other play modes

● Scan play

This function locates and plays the first 10 seconds of all tracks recorded on a disc.

1. Press the [SCN] button for scan play.

● Folder scan play

This function locates and plays the first 10 seconds of the first tracks of all folders on an MP3/WMA disc.

1. Press and hold the [SCN] button (1 sec.) for folder scan play.

● Repeat play

This function plays the current track repeatedly.

1. Press the [RPT] button for repeat play.

● Folder repeat play

Repeatedly plays all tracks of the current folder on an MP3/WMA disc.

1. Press and hold the [RPT] button (1 sec.) for folder repeat play.

● Random play

This function plays all tracks recorded on a disc in random order.

1. Press the [RDM] button for random play.

● Folder random play

This function plays all the tracks of all the folders recorded on an MP3/WMA disc in random order.

1. Press and hold the [RDM] button (1 sec.) for folder random play.

● To cancel play modes

1. Press the button previously selected.
- * The play mode is canceled and the off mode appears in the display for 2 seconds.
 - * If the error display “- -: - -” appears, these modes (Scan/Repeat/Random) can be canceled while still in play mode.

Operations Common to Each Mode

To change settings

1. Press and hold the [DISP] button (1 sec.) to switch to the adjustment display.
2. Press [◀◀] or [▶▶] to select the “item name” as follows:
“SETTINGS” ↔ “SCRN SVR”
↔ “SCROLL” ↔ “DIMMER” ↔ “TEL-SP”
↔ “TEL-SW”
* The adjustment item will be displayed for 2 seconds before showing the desired value.
3. Turn the [ROTARY] knob to select the desired value.
* When “ENT” is flashing in the display, press the [ENT] button to adjust setting value.
4. After completing settings, press the [DISP] button to return to the previous mode.

● Displaying the settings

You can see the state of current settings at any operation mode.

- 2-1. Select “SETTINGS”.

- 3-1. Turn the [ROTARY] knob to display the current settings.

* When the setting is selected, the current state will be displayed after 1 second.

Example:

After 1 second:

M-3 EX

M-3 ON

● Turning the screen saver on/off

This unit has a screen saver function in which various patterns and random characters can be displayed on the operation status indication area. This function can be turned on/off. If a button is pressed while the screen saver is on, the corresponding operation display is shown for about 30 seconds, and then the display returns to the screen saver.

* The factory default setting is “ON”.

- 2-1. Select “SCRN SVR”.

- 3-1. Turn the [ROTARY] knob to select “ON” or “OFF”.

● Setting title scroll method

Set how to scroll in CD-TEXT and MP3/WMA titles.

* The factory default setting is "ON".

2-1. Select "SCROLL".

3-1. Turn the [ROTARY] knob to select "ON" or "OFF".

- **ON:** Scroll automatically.
- **OFF:** Scroll 1 time only.

● Setting dimmer control

Dimmer control can be set "ON" or "OFF".

* The factory default setting is "ON".

2-1. Select "DIMMER".

3-1. Turn the [ROTARY] knob to select "ON" or "OFF".

● Setting car speaker output for cell phones

When the AUX input jack is used to connect an AUX BLUETOOTH BB (BLT373) (sold separately):

* The factory default setting is "RIGHT".

* To output the telephone calls, set cell phone interrupt to "ON".

2-1. Select "TEL-SP".

3-1. Turn the [ROTARY] knob to select "RIGHT" or "LEFT".

- **RIGHT:** Telephone calls can be heard on the front right speaker connected to this unit.
- **LEFT:** Telephone calls can be heard on the front left speaker connected to this unit.

● Cell phone interrupt setting

If you connect this unit and your cell phone with an optional cable, you can listen to your calls on your car speakers.

When the AUX input jack is used to connect an AUX BLUETOOTH BB (BLT373) (sold separately):

* The factory default setting is "OFF".

2-1. Select "TEL-SW".

3-1. Turn the [ROTARY] knob to select setting.

When turning the [ROTARY] knob, the setting changes as follows:

"OFF" ↔ "ON" ↔ "MUTE"

- **OFF:** This unit continues normal operation even when the cell phone is used.
- **ON:** Telephone calls can be heard from the speakers connected to the unit.
 - * When listening to calls on your car speakers, turn the [ROTARY] knob to adjust the volume.
- **MUTE:** The sound from this unit is muted during telephone calls.

Note:

- If connecting a hands-free kit, make sure the setting is ON to receive telephone audio through the system.

AUX function

An external input jack (AUX) is provided on the front panel to allow playback of sound and music from external devices.

● Selecting AUX IN sensitivity

Make the following settings to adjust sensitivity when the sound from an external device is difficult to hear even after adjusting the volume.

* The factory default setting is "MID".

1. Press and hold the [DISP] button (1 sec.).
2. Select "AUX SENS".
3. Turn the [ROTARY] knob to select "HIGH", "MID" or "LOW".

Note:

- When AUX mode is selected, AUX IN sensitivity can be set.

6. TROUBLESHOOTING

	Problem	Cause	Measure
General	Power does not turn on. (No sound)	Fuse is blown.	Replace with a fuse of the same amperage. If the fuse blows again, consult your dealer.
		Incorrect wiring.	Consult your dealer.
	No sound when operating the unit with amplifiers or power antenna attached.	Power antenna lead is short circuited, or excessive current is required for remotely powering on the amplifiers or power antenna.	1. Turn the unit off.
			2. Remove all wires attached to the power antenna lead. Check each wire for possible short circuits using an ohm meter. 3. Turn the unit back on. 4. Reconnect each amplifier remote wire to the power antenna lead one by one. If the amplifiers turn off before all wires are attached, use an external relay to provide remote power-on voltage (excessive current required).
Nothing happens when buttons are pressed. Display is not accurate.	Microprocessor malfunction due to noise, etc.	1. Turn off power, then press the [RELEASE] button and remove the DCP.	
		2. Use a thin rod to hold reset button depressed (2 sec.). If the reset button is pressed when a disc is loaded, please eject the disc and load it once again before attempting to play it.	
	DCP or main unit connectors are dirty.	Wipe dirt off with a soft cloth dampened with cleaning alcohol.	
No sound	The speaker protection circuit is operating.	1. Turn down sound volume. Function can also be restored by turning power off and on again. (Speaker volume is reduced automatically when the speaker protection circuit operates). 2. If the sound is still muted, consult your dealer.	
CD/MP3/WMA	No sound	MP3/WMA files are absent on disc.	Write MP3/WMA files onto disc properly.
		Files are not recognized as MP3/WMA files.	Use properly encoded MP3/WMA files.
		File system is not correct.	Use ISO9660 level 1, 2 or JOLIET or Romeo file system.
	Sound skips or is noisy.	CD is dirty.	Clean the CD with a soft cloth.
		CD is heavily scratched/warped.	Replace with a CD without scratches.
	Sound cuts out or skips. Noise is generated/noise is mixed with sound.	MP3/WMA files are not encoded properly.	Use properly encoded MP3/WMA files.
	Sound is poor when power is first turned on.	Condensation may form on the internal lens when the car is parked in a humid place.	Let dry for about 1 hour with power on.
	Wrong file name	File system is not correct.	Use ISO9660 level 1, 2 or JOLIET or Romeo file system.

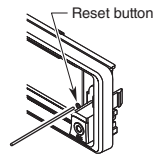

7. ERROR DISPLAYS

If an error occurs, one of the following messages is displayed.

Take the measures described below to eliminate the problem.

	Error Display	Cause	Measure
CD/MP3/WMA	ERROR 2	A CD is caught inside the CD deck and is not ejected.	This is a failure of the CD deck mechanism. Consult your dealer.
	ERROR 3	A CD cannot be played due to scratches, etc.	Replace with a non-scratched, non-warped disc.
	ERROR 6	A CD is loaded upside-down inside the CD deck and does not play.	Eject the disc and reload properly.

If an error display other than the ones described above appears, press the reset button. If the problem persists, turn off the power and consult your dealer.

8. SPECIFICATIONS

Radio section

Tuning System: PLL synthesizer tuner

Receiving Frequencies:

FM : 87.5 to 108 MHz (0.05 MHz steps)

MW : 531 to 1602 kHz (9 kHz steps)

LW : 153 to 279 kHz (3 kHz steps)

CD player section

System: Compact disc digital audio system

Frequency Response: 5 Hz to 20 kHz (± 1 dB)

Signal to Noise Ratio: 90 dB (1 kHz)

Dynamic Range: 85 dB (1 kHz)

Distortion: 0.01%

General

Output Power: 25 W \times 4 (DIN 45324, +B=14.4V)

Power Supply Voltage:

14.4 V DC (10.8 to 15.6 V allowable),
negative ground

Power Consumption: Less than 15 A

Speaker Impedance: 4 Ω (4 to 8 Ω allowable)

Weight:

Main unit: 1.15 kg

Dimensions:

Main unit:

178 (W) \times 50 (H) \times 155 (D) mm

Note:

- Specifications and design are subject to change without notice for further improvement.



TEL :+49-6105-977-0
FAX :+49-6105-977-399

CE DECLARATION of CONFORMITY

We Clarion Europa GmbH

(supplier's name)

Hessenring 19-21, 64546 Mörfelden-Walldorf, GERMANY
(address)

declare under our sole responsibility that the product

CAR RADIO with CD PLAYER

MODEL: CZ109E, CZ109ER, CZ109EG

Product code: PE3160 (difference: illumination)

TYPE: 1043207A

(name, type or model, possibly sources and numbers of items)

to which this declaration relates is in conformity with the following
standard(s) or other normative document(s)

EN 55013:2001 + A1, EN 55020:2002 + A1

(title and/or number and date of issue of the standard(s) or
other normative document(s))

(if applicable) following the provisions of 2004/108/EC Directive.

And following the provisions of 2004/104/EC Directive,
according to paragraph 3.2.9 of Annex I,
meets the limits defined in paragraph 6.5, 6.6, 6.8 and 6.9 of Annex I

(supplier's comment)

Mörfelden-Walldorf, GERMANY

21. OCT. 2008

(Place and date of issue)

Akihiko Nadabe

President

(name and signature or equivalent
marking of authorized person)

RefNo 08ROC002C3 *D.FDQC08A134*

Clarion Co., Ltd.

All Rights Reserved. Copyright © 2008: Clarion Co., Ltd.

Printed in China / Imprimé en Chine / Gedruckt in China / Stampato in Cina
Gedruckt in China / Impreso en China / Tryckt i Kina / Impreso na China

2008/12

[Downloaded from Caradio-Manual.com Manuals](http://www.Caradio-Manual.com/Manuals)

PE-3160E
280-8723-00