



## IMPORTANT INFORMATION FOLLOWING AN ALARM

**If the alarm indicates a gas leak or you can smell gas:**

 **DANGER OF EXPLOSION!**

- Extinguish all open flames, embers and burning tobacco! 
- Do not under any circumstances switch electrical devices on or off! 
- Do not disconnect any electric plugs (including that of the alarm unit)!
- Warn any persons at risk in the danger zone.
- Shut off the gas supply at the gas tap.
- Air all affected rooms.
- Deal with the cause with a qualified/authorized expert.

**Replace after 5 years use.**

Installation date :

(Please display this page in a visible position next to the gas alarm)



Introduction .....	Page	4
Proper use .....	Page	4
Pack contents .....	Page	4
Features .....	Page	4
Technical data.....	Page	5
Safety instructions .....	Page	5
Initial operation .....	Page	8
Power supply .....	Page	9
Installation .....	Page	10
Operation.....	Page	10
Function test.....	Page	11
Fault indicator .....	Page	11
Troubleshooting .....	Page	12
Maintenance and cleaning .....	Page	13
Disposal.....	Page	13
Warranty.....	Page	13
Service .....	Page	14
Declaration of conformity .....	Page	14



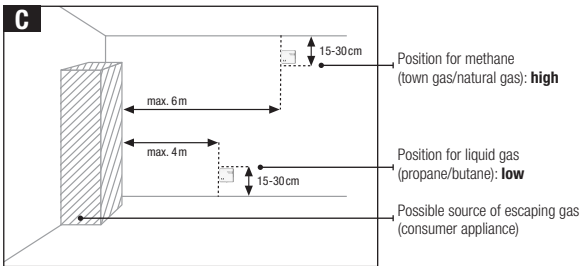
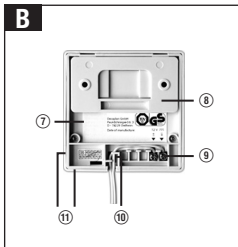
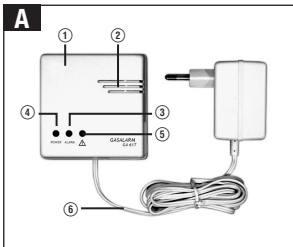

## Introduction

Please read these operating instructions thoroughly and carefully. They are part of this product and contain important instructions relating to its operation and handling. Please always observe all safety instructions. Before initial operation, please check that all parts are fitted correctly. If you have any questions or are unsure about handling of the device, please contact the dealer or the service office. Please keep these instructions in a safe place and pass them on to anyone else intending to use the device.

## Proper use

The gas alarm indicates a leakage of methane, propane or butane gas from appliances, lines, etc. with a high-frequency tone and a flashing red ALARM LED ③. It is intended for use in dry areas inside buildings, vehicles, caravans and boats. The power supply is either by way of the supplied 12 V DC mains adapter connected to the 230 V ~ 50 Hz mains electricity or by connection to the 12 V DC on-board power supply system of a car, caravan or boat. The device is for private use only. Any other use or modification of the device constitutes improper use and poses a serious risk of accident. The manufacturer is not liable for dam-

age caused by improper use or incorrect operation of the device. Before initial operation, please read all operating instructions carefully and refer to the page showing the illustrations. Keep these operating instructions in a safe place. Please pass on all supplied documents along with the device to anyone else intending to use it.

## Pack contents

We supply the gas alarm with the following components (see Fig. A):

- 1x gas alarm
- 1x 12 V DC mains adapter
- 1x mounting fixture
- 2x fastening screws
- 2x wall plugs
- 1x operating instructions

## Features

**On the front of the casing (see Fig. A):**

- ① Front of casing
- ② Piezo siren opening
- ③ ALARM LED
- ④ POWER LED
- ⑤ FAULT LED
- ⑥ 12 V DC mains adapter connecting cable

## On the rear of the casing (see Fig. B):

- ⑦ Rear of casing
- ⑧ Mounting fixture
- ⑨ 12 V DC terminal screws
- ⑩ Cable guide
- ⑪ Side and lower sensor openings

## Technical data

### Gas alarm:

Power supply:	12 Volt DC ( $\pm 10\%$ ) mains adapter (delivered with the gas alarm) or on-board power supply system
Current consumption:	max. 150 mA
Gas sensor:	hot-wire method
Sensitivity/alarm threshold:	corresponds to a concentration of approx. 12 % of the relevant lower explosive limit
Propane:	0.2 %
Butane:	0.17 %
Methane (town gas/natural gas):	0.53 %
Alarm signal:	loud high-frequency tone
Volume:	85 dB(A) 3m

Operating temperature:	-10 °C to +40 °C
Relative air humidity:	max. 95 %
Material:	ABS plastic
Dimensions:	35 x 85 x 85 mm (h x w x l)
Weight:	approx. 100 g
Protection class:	III



## Mains adapter (delivered with the gas alarm):

Power supply:	230 V ~ 50 Hz
Current consumption:	60 mA
Current output:	12 Volt DC 300 mA
Connecting cable length:	approx. 2 m

## Safety instructions

The following instructions are for your own safety and satisfaction when operating the GA 617 gas alarm. Please note that non-compliance with these safety instructions can lead to a serious risk of accident.

## Explanation of the symbols and terms used:

-  **Danger!** Failure to observe this instruction endangers life and health.
-  **Caution!** Failure to observe this instruction poses a risk to property.

### **Danger!**

- Do not leave small children unsupervised with the packaging material. Danger of suffocation.
- Do not leave children unsupervised with the device. Danger to life and risk of injury.
- Do not damage any gas, electricity or telecommunication lines when fitting the device. Danger to life and risk of injury and damage.
- Never expose the device to fire, heat or to temperatures of over 50° C for any length of time. Danger to life from explosion.
- Make sure that your hearing is not exposed to the loud alarm signal for any length of time. This can cause serious damage to the hearing.
- Make sure that the alarm signal is not triggered close to the ears. This can cause serious damage to the hearing.
- Handle the connecting cable with care. Install it so that it cannot get damaged and does not create a stumbling hazard. Otherwise there is danger to life and a risk of injury and fire.

### **What to do in the event of a gas leak**

Please proceed as follows if the gas alarm signals a gas leak or if you smell gas:

- Do not ignite any naked lights. Extinguish any burning tobacco or candles etc. immediately.
- In the event of a gas leak, do not switch any electrical devices (light switch, torch, door bell, telephone, intercom, or other electric consumers) on or off.
- Do not under any circumstances disconnect the gas alarm from the power supply.
- Immediately warn all people at risk and make sure that they evacuate the area to safety.
- Shut off the gas supply on the main gas tap or bottle valve.
- Open the windows and doors and air the room, the house, the caravan, etc. thoroughly.
- Note on airing rooms: certain gases (propane and butane) are heavier than the ambient air, and some are lighter (methane). When airing, please make sure that the intake of air is suitable for the properties of the gas.
- If leaking gas is indicated constantly or repeatedly, please contact your energy provider. Do not use the telephone or any other electrical device near or around the gas leak to notify the provider.
- The gas leak must only be dealt with by a qualified and authorized expert.

### **Caution**

- If you are uncertain which type of gas you use or you have problems installing the gas alarm you must have the device installed by a suitably qualified person.
- Only connect the device to 12V DC! Check before connecting the 12 V DC adapter to the mains that the electricity supply to the device is protected by the appropriate fuse or trip in accordance with the applicable regulations.
- This device does not serve as primary explosion protection as defined by the guidelines of the employer's liability insurance associations.
- Do not cover the device with any object. This could diminish the performance of the sensor.
- Make sure that the device does not come into contact with moisture.
- Protect the device from strong magnetic or electric fields.
- Protect the device from heavy mechanical strain and shocks.
- Only use the device with the supplied original parts or parts that are designed for it.
- Check before initial operation that all components are assembled in accordance with the operating instructions.
- Before assembly and initial operation of the device, check that the contents are

complete and undamaged.

- The device must only be repaired by authorized and skilled specialists. Failure to observe this instruction risks damage resulting from improper use and loss of the warranty.
- Position the device so that the sensors can detect escaping gas.
- Only use within the temperature range specified in the „Technical Data“ section. Higher or lower temperatures can diminish performance.
- Do not open the device. Opening the device will lead to expiry of the warranty.
- For connection in cars, caravans or on boats, fit the (12 V DC) power supply cable with a switch approved for this purpose.
- Connect the 12 V DC terminal screws ⑨ either to the mains adapter supplied with the gas alarm or a 12 V DC power supply source in cars, caravans and boats. Dual connection (parallel connection) will damage the mains adapter.
- For connection to the 12 V DC battery, fit the 12 V DC connecting cable with a fuse (250 mA).
- Detach the page containing the information "IMPORTANT ADVICE" from the operating manual. Fix this page where it can be easily seen on the wall directly adja-

cent to the gas alarm and write on it the date you first used the alarm.

- Write the date of first use in the space provided on the label on the side of the gas alarm.

## Initial operation

### Preparation and materials required:

The stated materials are not included in the delivery scope. The information provided here is non-binding and intended as a guide. The material depends on individual local requirements. You will need:

- Power supply: 12 V DC mains adapter connection to a 230 V~50 Hz socket, or 12 V DC on-board power supply system.
- A crosstip screwdriver for installation with the fastening screws.
- A pen to mark the installation points.
- A drill for the mounting holes.
- An in-line fuse holder (250 mA/slow-acting fuse) – only for connection to on-board supply system.

### Selecting the installation position

When there is an escape of gas, the gas detector can only give the alarm if it is reached by the escaping gas. Anything which prevents gas from entering the alarm housing can result in the

alarm being given only after a delay or not at all. Select an installation position that is as close as possible to the gas appliance, but not farther away than 4 m (liquefied petroleum gases) or 6 m (methane) (see Fig. C). Make sure that the mains socket for connection of the 12 V DC mains adapter is located max. 2 m away from the installation position of the gas alarm. To detect town, natural and methane gas, the installation position should be as far up on the wall as possible. The gas alarm should be mounted 15-30 cm below the room ceiling and must be higher than the highest door or window opening. The gases in question are lighter than air and therefore rise.

To detect propane and butane gas, choose a low installation position on the wall. It should be 15-30 cm above the floor. Liquid gases are heavier than air and therefore sink to the floor and spread from there.

**⚠ Do not under any circumstances install the gas alarm in any of the following places:**

- Outside buildings, e.g. to guard open crates of bottled gas.
- Enclosed spaces (e.g. in cupboards or behind curtains), which could prevent the alarm from responding in the event of a gas leak.

- Directly next to an oven.
- Directly above a washbasin or drain.
- Next to a door, window, ventilation, fan, air conditioning unit, etc.
- Areas in which the temperature can fall below  $-10^{\circ}\text{C}$  or rise above  $+50^{\circ}\text{C}$  or in which air humidity can rise above 95%.
- Areas in which dust or dirt can clog the sensor.
- Any position in which it could accidentally get damaged or pulled down.
- Areas under the risk of explosion.

## Power supply

**⚠ Danger!** Ensure that no voltage is present when connecting to the power supply and during installation.

- Only operate the gas alarm connected to a 12 V DC power supply. Connect it either with the 12 V DC mains adapter (included in the delivery scope) or to a 12 V DC on-board power supply system of a car, caravan or boat.
- Check before connecting the 12 V DC adapter to the mains that the electricity supply to the device is protected by the appropriate fuse or trip in accordance with the applicable regulations.

## 12 V DC mains adapter

- Lead the bare cable ends (approx. 8 mm) of the 12 V DC connecting cable ⑥ from the 12 V DC mains adapter to the terminal screws ⑨ in the cable guide ⑩. The cable guide provides strain relief.
- Attach each cable end to a terminal screw ⑨. The polarity is not important for this connection.

## 12 V DC on-board power supply system

- Remove the connecting cable of the mains adapter from the terminal screws ⑨.
- Equip the connecting cable for the power supply (12 V DC) in cars, caravans or boats with a switch.
- Lead the bare cable ends (approx. 8 mm) of the 12 V DC connecting cable of the 12 V DC power source to the terminal screws ⑨ in the cable guide ⑩. The cable guide helps to prevent strain on the connections.
- Attach each cable end to a terminal screw ⑨. The polarity is not important for this connection.
- Important information regarding on-board operation: only one power supply may be connected to the terminal screws ⑨, even if the mains adapter is not plugged in. The mains adapter will be damaged if

a dual connection (parallel connection) is made.

## Installation

**⚠ Danger:** make sure that the gas alarm is not powered during installation.

- Remove the mounting fixture ⑧ from the rear side of the casing ⑦ by sliding it downwards (see Fig. B).
- Mark the installation position with the aid of the two round holes in the mounting fixture ⑧.
- Install the mounting fixture ⑧ in the chosen and marked position using the fastening screws and wall plugs supplied with the gas alarm.
- Push the gas alarm flush from above onto the mounting fixture ⑧.

## Operation

Once the power supply has been connected properly, an automatic self-test is carried out: the gas alarm emits several loud alarm signals and at the same time the red ALARM LED ③ on the front of the casing ① flashes. The green POWER LED ④ then lights up to indicate that the device is ready for operation (see Fig. A)

### 12 V DC mains adapter

Switching on:

- Plug the mains adapter directly and fully into a 230 V~50 Hz mains socket. Do not use any type of tabletop socket or extension cable, since these can cause interruptions in the power supply.

Switching off:

- Remove the mains adapter from the mains socket.

### 12 V DC on-board supply system

Switching on:

- Switch the 12 V DC on-board power supply on.

Switching off:

- Switch the 12 V DC on-board power supply off.

### Alarm in the event of a gas leak

The gas alarm detects a gas leak with the sensor. If the concentration of gas at the sensor exceeds the pre-set sensitivity threshold on the gas alarm, the alarm responds: the red ALARM LED ③ flashes and the loud alarm signal is emitted.

The alarm continues until the gas concentration falls back to below the pre-set sensitivity level.

### Follow the instructions in the section „What to do in the event of a gas leak“

## Function test

Use a gas lighter to test the function of the gas alarm.

- Allow gas to escape from the gas lighter directly next to the lower or side sensor opening ⑪.
- Make sure that there is no flame on the lighter. The gas alarm detects the gas with the sensor. If the gas concentration at the sensor exceeds the pre-set sensitivity threshold, the alarm responds: the red ALARM LED ③ flashes and the loud alarm signal is emitted.
- Do not allow any more gas to escape from the lighter once the gas alarm has responded.

The alarm continues until the gas concentration falls back to below the pre-set sensitivity level.

### Fault indicator

The device carries out a self-checking routine for your safety. Possible errors are displayed by the FAULT-LED ⑤ flashing and a coincident beeping noise from the device.

This fault indicator may also be triggered by the gas alarm's surroundings or by an internal problem inside the device.

If a fault is indicated you must check first:

- Whether the ambient temperature is outside the specified range (-10° C to +40° C).
- Whether chemicals present in the air may have caused the fault, e.g. a high concentration of acid or alcohol. If this cannot be confirmed, then try the device in another room. If no fault is indicated there then the problem lies in the surroundings.

If the fault indicator is still active then the problem lies within the device itself:

- The gas alarm has suffered internal damage.
- The gas alarm can be used for approximately 5 years.

Then it should be replaced.

## Troubleshooting

Fault	Cause	Remedy
<b>The gas alarm responds when there is no actual gas leak.</b>	The gas alarm will respond to fumes from cleaning agents, paint, lacquers, sprays, cooking fumes, tobacco smoke and smoke from candles.	Remove the source of the fumes.
<b>The gas alarm fails the function test.</b>	The service life of the gas alarm expires after approx. 5 years of operation.	Replace the gas alarm.
<b>The gas alarm does not work.</b>	The power supply is faulty.	Make sure that the power supply is free of faults.
<b>FAULT-LED flashes</b>	See section on "Fault display"	See section on "Fault display"

## Maintenance and cleaning

 **Danger:** make sure that the gas alarm is not live when maintaining or cleaning the device.

- Clean the casing of the gas alarm with a dust cloth or a damp cloth. Use a mild detergent (no solvents) to clean the plastic surface.
- Remove all deposits of dust from the sensor openings regularly with a brush.
- Check regularly that the device is working properly (see section „Function test“).
- Replace the gas alarm after it has been in use for approximately 5 years.

## Disposal

Please take all packaging materials to a disposal facility in your city or district. In accordance with European Directive 2002/96/EC on used electrical and electronic appliances and its implementation in national law, used electrical appliances must be collected separately and recycled in an ecologically compatible manner.

Please dispose of the alarm at the end of its useful life at a disposal facility in your city or district.

## Warranty

This device has a warranty of 3 years from the date of purchase. The device was manufactured with care and inspected thoroughly before delivery. Please keep your receipt as proof of purchase. If you have a claim under the warranty, please contact the service office for your country. This is the only way to ensure that your device can be sent in free of charge. This warranty is only valid for the first purchaser and is not transferable.

The warranty furthermore covers material or manufacturing defects only. It does not apply to wear parts or damage to fragile parts. The product is solely intended for private use and not for commercial use. No claim for damages may be brought in the event of fire or explosion. An alarm is no substitute for insurance cover and does not replace your duty of care. In the event of incorrect and/or improper handling, the use of force or any work on the device that is not performed by the service office, the warranty shall expire. This warranty does not restrict your statutory rights.

## Service

Information on dealing with problems can be found under [www.dexaplan.com](http://www.dexaplan.com).

If you have any questions, please contact our service office by email ([service@dexaplan.de](mailto:service@dexaplan.de)) or by telephone (☎ ☎ 0870 241 3029 ☎ ☎ 1890 851 851; Monday - Friday between 08.30 and 17.00).

Here you can obtain all necessary information on service questions such as returns, etc.

## Declaration of conformity CE

This product satisfies the requirements of the valid European and national directives (Electromagnetic Compatibility 89/336/EEC and Low-Voltage Directive 73/23/EEC). Its conformity has been verified.



