

# AG SHIELD



**12" Cross Auger for MacDon FD 70 headers**

**FD70 35 foot asm part# 405767**

**FD70 40 foot asm part# 405769**

**OPERATOR'S HANDBOOK AND PARTS MANUAL**

Ag Shield Manufacturing  
Box 9, Benito, Manitoba R0L 0C0  
phone 800-561-0132 or 204-539-2000  
fax 204-539-2130  
e-mail address [sales@agshield.com](mailto:sales@agshield.com)  
Please visit web site at <http://www.agshield.com>

Printed in Canada

Sept 5 , 2011

REV 2

-Part No 405906a



## WARRANTY REGISTRATION-YIELD SHIELD

RETURN TO



### AG SHIELD MANUFACTURING

BOX 9, BENITO, MB, R0L 0C0

PHONE 800-561-0132 or 204-539-2000 FAX 204-539-2130

e-mail sales @agshield.com

**This form must be filled out by the dealer(if applicable) and signed by both the dealer and customer at the time of delivery, and returned to Ag Shield within 10 days to validate warranty.**

Customer \_\_\_\_\_

Dealer \_\_\_\_\_

Address \_\_\_\_\_

Address \_\_\_\_\_

City, \_\_\_\_\_

City, \_\_\_\_\_

Prov. \_\_\_\_\_ Code \_\_\_\_\_

Prov. \_\_\_\_\_ Code \_\_\_\_\_

phone(\_\_\_\_\_) \_\_\_\_\_

phone(\_\_\_\_\_) \_\_\_\_\_

fax \_\_\_\_\_

fax \_\_\_\_\_

Model and size \_\_\_\_\_ Cross Auger

Model and size \_\_\_\_\_ Cross Auger

\_\_\_\_\_ 25 ft \_\_\_\_\_ 30 ft \_\_\_\_\_ 36 ft.

Serial no \_\_\_\_\_

Delivery Date \_\_\_\_\_

Delivery Date \_\_\_\_\_

Used for - ☐ farm ☐ custom pushing

Used for - ☐ farm ☐ custom pushing

#### DEALER INSPECTION REPORT

#### SAFETY

\_\_\_\_\_ Hydraulic connections all sealed

\_\_\_\_\_ All decals installed

\_\_\_\_\_ Reflectors clean

\_\_\_\_\_ Guards and shields installed

\_\_\_\_\_ Tire pressure 15psi for cushion

\_\_\_\_\_ Review operating and safety instructions

\_\_\_\_\_ Retainer pins installed as required

I have thoroughly instructed the customer on the above described equipment, including the content of the Owner's Handbook, equipment care, adjustments, safe operation, and applicable warranty policy.

Date \_\_\_\_\_ Dealer signature \_\_\_\_\_

The equipment was complete with all parts in good working order except as noted below. I have received the owner's handbook, and I have been thoroughly instructed in the use of it. I have been instructed in the care, adjustments, the safe operation of the machine, and the applicable warranty policy.

Date \_\_\_\_\_ Customer signature \_\_\_\_\_

Except \_\_\_\_\_

# 1.TABLE OF CONTENTS

1.	TABLE OF CONTENTS.....	4
2.	INTRODUCTION AND SIGN-OFF FORM .....	5
3.	SAFETY .....	6
3.1.	SAFETY OVERVIEW.....	7
3.2.	GENERAL SAFETY .....	7
3.3.	MAINTENANCE SAFETY .....	8
3.4.	HYDRAULIC SAFETY .....	8
3.5.	SHEAR SAFETY .....	8
3.6.	STORAGE SAFETY .....	8
3.7.	TRANSPORT SAFETY .....	8
3.8.	REFUELING SAFETY .....	9
3.9.	TIRE SAFETY.....	9
3.10.	OPERATING SAFETY.....	9
3.11.	CROSS AUGER SAFETY .....	9
3.12.	SAFETY DECALS .....	10
4.	SETUP FROM SHIPPING MODE .....	11
4.1.	HYDRAULIC INSTALLATION FD70 MODELS .....	14
5.	OPERATIONS .....	16
5.1.	FIELD SETTING THE CROSS AUGER-.....	16
5.2.	ALTERNATE SYSTEM FOR SPEED CONTROL USING A BRAND MOTOR SPEED CONTROL VALVE.....	16
6.	CROSS AUGER PARTS .....	17
6.1.	MOTOR MOUNT LEFT END DRIVE FD 70 35-40 FT.....	17
6.2.	CENTER FLEX ASSEMBLY FD 70 / CASE 2162 .....	18
6.3.	INTERNAL PARTS CENTER SECTION MACDON FD70 / CASE2162.....	19
6.4.	RIGHT END PARTS MACDON FD70 / CASE 2162- ALL MODELS .....	20
6.5.	FD70 40 FT AUGER PARTS .....	21
7.	SPECIFICATIONS—.....	22
8.	WARRANTY .....	23

## 2.INTRODUCTION AND SIGN-OFF FORM

**Congratulations!** on your choice of an Ag Shield cross auger. This equipment has been designed and manufactured to meet the harvesting needs of the discerning farmers and custom harvesters.

**OPERATOR ORIENTATION** - The directions left, right, front and rear, as mentioned throughout this manual, are as seen from the tractor driver's seat and facing in the normal direction of travel.

Ag Shield follows the general safety standards specified by the American Society of Agricultural Engineers (ASAE) and the Occupational Safety and Health Administration OSHA). Anyone who will be operating and/or maintaining the Ag Shield Yield Shield must read and clearly understand ALL Safety, Operating, and Maintenance information presented in this manual.

Do not operate or allow anyone else to operate this equipment until such information has been reviewed. Review this information annually before season start-up. Make these reviews of safety and operation a standard practice for all of your equipment. An untrained operator is **not qualified** to operate this machine.

A sign off sheet is provided for your record keeping to show that all personnel who will be working with the equipment have read and understood the information in the Operators Handbook and have been instructed in the operation of the equipment.

### SIGN-OFF FORM

DATE	OPERATORS SIGNATURE	EMPLOYERS SIGNATURE

### 3. SAFETY

## SAFETY ALERT SYMBOL

This Safety Alert symbol means:  
**ATTENTION! BECOME ALERT!**  
**YOUR SAFETY IS INVOLVED!**

The Safety Alert symbol identifies important safety messages on the Ag Shield Yield Shield and in the manual. When you see this symbol, be alert to the possibility of personal injury or death. Follow the instructions in the safety message.



### 3 Big Reasons

**Accidents Disable and Kill**  
**Accidents Cost**  
**Accidents Can Be Avoided**

#### SIGNAL WORDS:

Note the use of the signal words **DANGER**, **WARNING** and **CAUTION** with the safety messages. The appropriate signal word for each message has been selected using the following guide-lines:

- DANGER -** An immediate and specific hazard which **WILL** result in severe personal injury or death if the proper precautions are not taken.
- WARNING -** A specific hazard or unsafe practice which **COULD** result in severe personal injury or death if proper precautions are not taken.
- CAUTION -** Unsafe practices which **COULD** result in personal injury if proper practices are not taken, or as a reminder of good safety practices.

### 3.1. SAFETY OVERVIEW

**YOU** are responsible for the **SAFE** operation and maintenance of your Ag Shield Yield Shield. **YOU** must ensure that you and anyone else who is going to operate, maintain or work around the canola pusher be familiar with the operating and maintenance procedures and related **SAFETY** information contained in this manual. This manual will take you step-by-step through your working day and alerts you to all good safety practices that should be adhered to while operating the canola pusher.

Remember, **YOU** are the key to safety. Good safety practices not only protect you but also the people around you. Make these practices a working part of your safety program. Be certain that **EVERYONE** operating this equipment is familiar with the recommended operating and maintenance procedures and follows all the safety precautions. Most accidents can be prevented. Do not risk injury or death by ignoring good safety practices.

- Yield Shield owners must give operating instructions to operators or employees before allowing them to operate the Yield Shield, and at least annually thereafter per OSHA regulation 1928.57.
- The most important safety device on this equipment is a **SAFE** operator. It is the operator's responsibility to read and understand **ALL** Safety and Operating instructions in the manual and to follow these. All accidents can be avoided.
- A person who has not read and understood all operating and safety instructions is not qualified to operate the machine. An untrained operator exposes himself and bystanders to possible serious injury or death.
- Do not modify the equipment in any way. Unauthorized modification may impair the function and/or safety and could affect the life of the equipment.
- Think **SAFETY!** Work **SAFELY!**

### 3.2. GENERAL SAFETY

1. Read and understand the Operator's Manual and all safety signs before operating, maintaining, adjusting the Yield Shield.
2. Only trained competent persons shall operate the reconitioner. An untrained operator is not qualified to operate the machine.



3. Have a first-aid kit available for use should the need arise and know how to use it.



4. Have a fire extinguisher available for use should the need arise and know how to use it.



5. Do not allow riders.

6. Wear appropriate protective gear. This list includes but is not limited to:

- A hard hat
- Protective shoes with slip resistant soles
- Protective glasses or goggles
- Heavy gloves
- Hearing protection

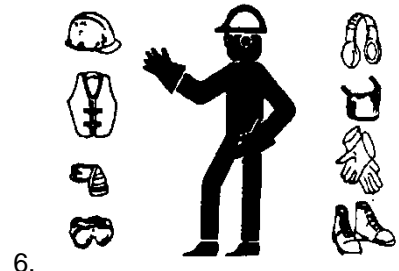

7. Stop the engine, place all controls in neutral, set park brake, remove ignition key and wait for all moving parts to stop before servicing, adjusting, repairing or unplugging.
8. Review safety related items with all personnel annually.

### 3.3. MAINTENANCE SAFETY

1. Review the Operators Manual and all safety items before working with, maintaining or operating the Yield Shield.
2. Stop the tractor engine, place all controls in neutral, set park brake, remove ignition key, wait for all moving pads to stop before servicing, adjusting, or repairing.
3. Before applying pressure to a hydraulic system, make sure all components are tight and that steel lines, hoses and couplings are not damaged.
4. Relieve pressure from hydraulic circuit before servicing or disconnecting from tractor.
5. Keep hands, feet, clothing and hair away from all moving and/or rotating parts.
6. Clear the area of bystanders, especially children, when carrying out any maintenance and repairs or making any adjustments.
7. Place stands or blocks under the frame before working beneath the machine.

### 3.4. HYDRAULIC SAFETY

1. Always place all tractor hydraulic controls in neutral before dismounting.
2. Make sure that all components in the hydraulic system are kept in good condition and are clean.
3. Replace any worn, cut, abraded, flattened or crimped hoses and steel lines.
4. Do not attempt any makeshift repairs to the hydraulic lines, fittings or hoses by using tape, clamps or cements. The hydraulic system operates under extremely high-pressure. Such repairs will fail suddenly and create a hazardous and unsafe condition.
5. Wear proper hand and eye protection when searching for a high-pressure hydraulic leak. Use a piece of wood or cardboard as a backstop instead of hands to isolate and identify a leak.
6. If injured by a concentrated high-pressure stream of hydraulic fluid, seek medical attention immediately. Serious infection or toxic reaction can develop from hydraulic fluid piercing the skin surface.

7. Before applying pressure to hydraulic system make sure that all connections are tight and that all hoses and fittings are in good condition.

### 3.5. SHEAR SAFETY

The operator must obey all safety labels.

1. Keep operators and bystanders away from all moving parts.
2. Shut off tractor engine and remove key before coming close to the implement or doing any maintenance
3. Never service or unplug shears while they are running, a single slip and you could be badly hurt or killed.

### 3.6. STORAGE SAFETY

1. Store unit in an area away from human activity.
2. Do not permit children to play on or around the stored Yield Shield.

### 3.7. TRANSPORT SAFETY

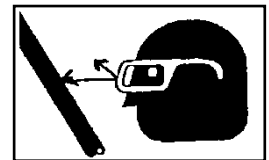

1. Read and understand ALL the information in the Operator's Manual regarding procedures and SAFETY when operating the Yield Shield in the field and/or on the road.
2. Check with local authorities regarding machinery transport on public roads. Obey all applicable laws and regulations.
3. Always travel at a safe speed. Use caution when making corners or meeting traffic.
4. Make sure the SMV (Slow Moving Vehicle) emblem and all the lights and reflectors that are required by the local highway and transport authorities are in place, are clean and can be seen clearly by all overtaking and oncoming traffic. Daybreak and dusk are particularly dangerous and pilot vehicles are recommended.



5. Ensure that the trailer is hitched positively to the towing vehicle. Always use a safety chain between the trailer and the tractor.
6. Keep to the right and yield the right-of-way to allow faster traffic to pass. Drive on the road shoulder, if permitted by law.
7. Always use hazard warning flashers on the Yield Shield when transporting unless prohibited by law.

### 3.8. REFUELING SAFETY

1. Handle fuel with care. It is highly flammable.



2. Do not refuel the machine while smoking or when near open flame or sparks.

3. Stop engine before refueling. Clean up spilled fuel before restarting engine.

### 3.9. TIRE SAFETY

1. Failure to follow proper procedures when mounting a tire on a wheel or rim can produce an explosion, which may result in serious injury or death.
2. Do not attempt to mount a tire unless you have the proper equipment and experience to do the job.
3. Have a qualified tire dealer or repair service perform required tire maintenance.
4. Operate the tires at the pressures, loads, and speeds suggested by the manufacturer.

### 3.10. OPERATING SAFETY

1. Read and understand the Operator's Manual and all safety signs before using.
2. Stop engine place all controls in neutral, set park brake, remove ignition key, wait for all moving parts to stop before servicing, adjusting, repairing or unplugging.
3. Before conditioning a field, be familiar with all potential hazards: trees, rocks ditches, gullies, etc. Plan your route to avoid hazards. Keep Yield Shield width in mind when maneuvering to avoid obstacles.

4. Keep hands, feet, hair and clothing away from all moving and/or rotating parts.
5. Keep all shields and guards in place when operating.
6. Do not allow riders on the Yield Shield or tractor during operation or transporting.
7. Clear the area of all bystanders, especially children, before starting.
8. Stay away from machine when folding deflectors. Keep others away.
9. Before applying pressure to the hydraulic system, make sure all components are tight and that steel lines, hoses and couplings are not damaged.
10. Review safety instructions annually

### 3.11. CROSS AUGER SAFETY

The cross auger has sufficient power to sever limbs and cause serious to fatal injury. Always stop the cross auger before dismounting. Always be certain that no one is in front of combine header Shield before engaging the auger drive.

When greasing the auger, do so with the combine motor shut off and the park brake securely set.

Never attempt to help the crop move along the canvases with a wrench or other item that might get into the auger and draw the wrench holder into the auger.

### 3.12. SAFETY DECALS

Become familiar with these decals and the hazards they are marking.



part #113522

part #113524



part # 113552

## 4.Setup from Shipping Mode

Operator's handbook for Ag Shield Cross auger to fit on to MacDon FD70 /Case 2162 – 35 and 40 foot

Installation sequence

1. Bolt on left hand end motor mount.
2. Bolt on the center mount
3. Assemble the left hand auger and center mount. Lift into position
4. Bolt on the right hand end mount.

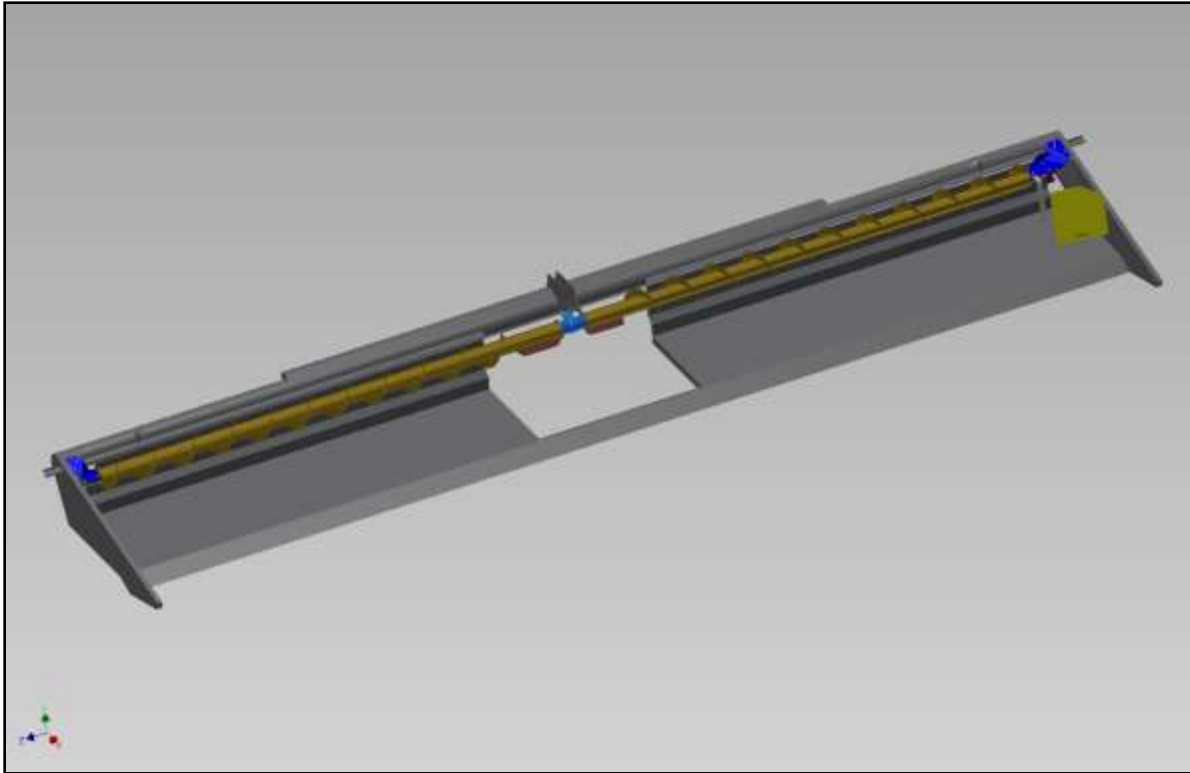

FIGURE 1 35-40 FT HEADER OVERVIEW

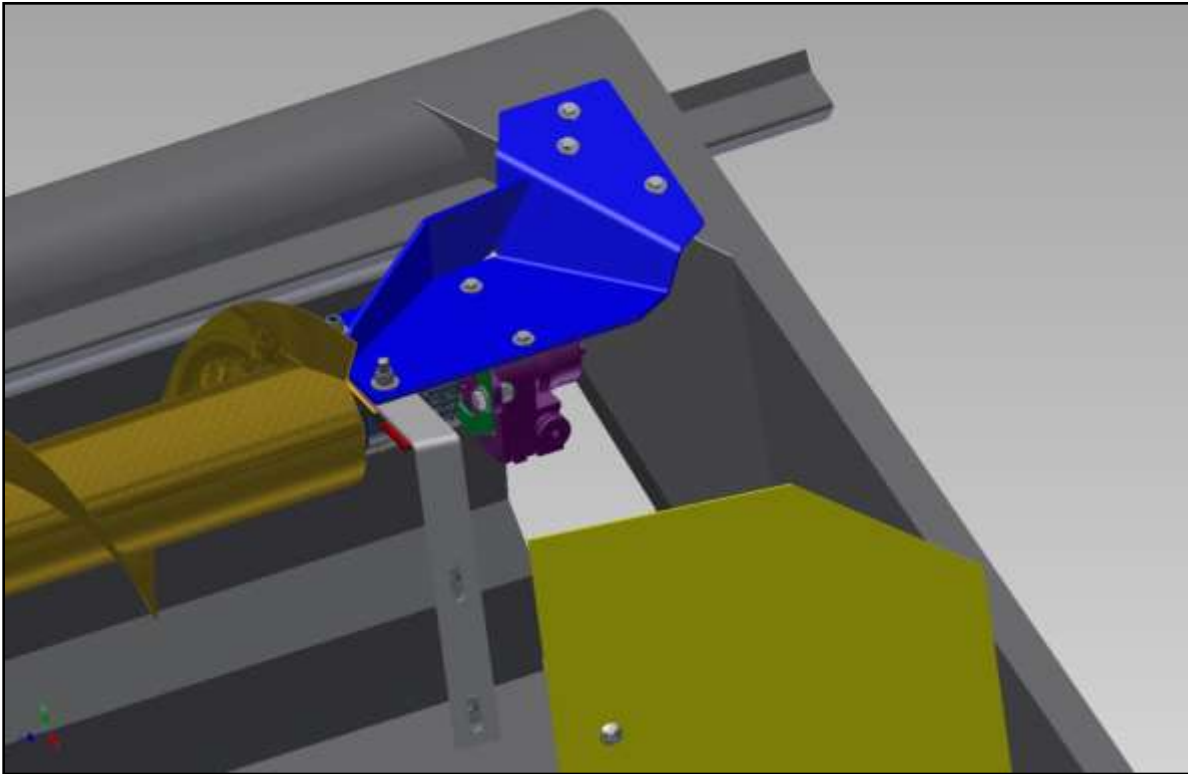

FIGURE 2 ASSEMBLY LEFT END WITH MOTOR

Assemble motor end first, then inner end of the left auger with square shaft protruding to place left auger over later, then lift left auger into place,

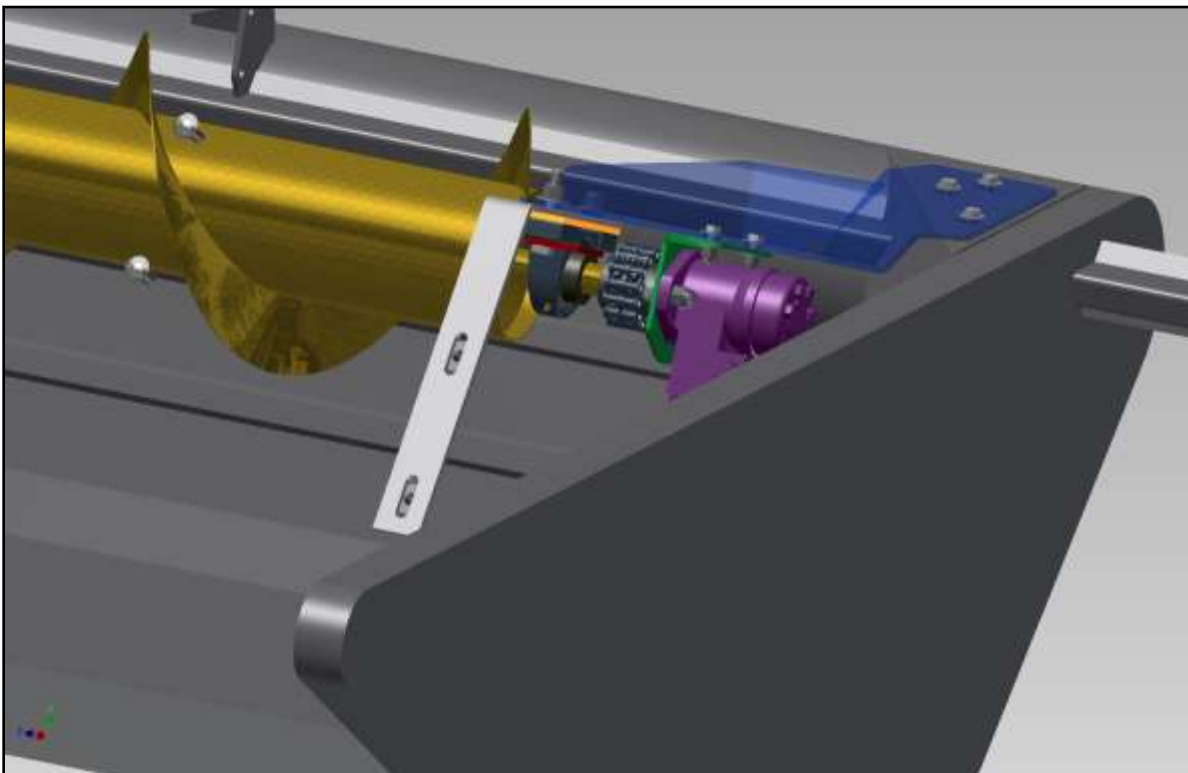

FIGURE 3 ASSEMBLY VIEW MOTOR END MOUNT

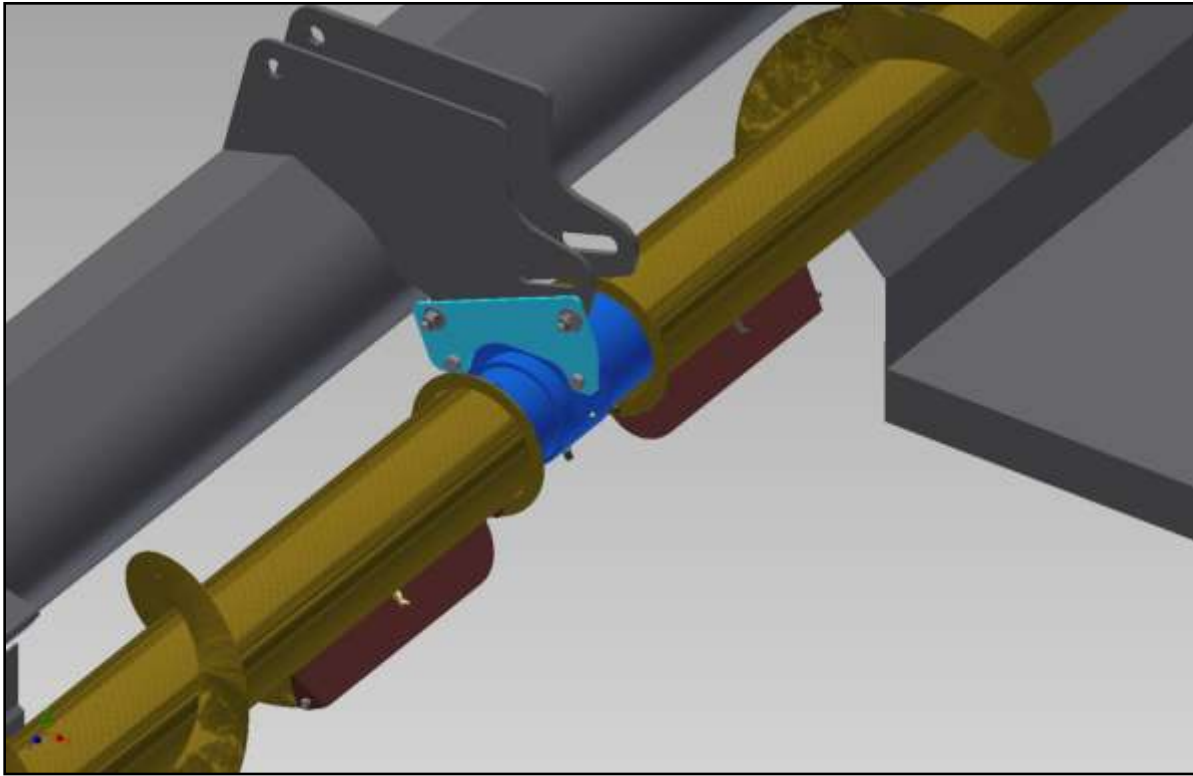

FIGURE 4 CENTER MOUNT EXTERNAL VIEW

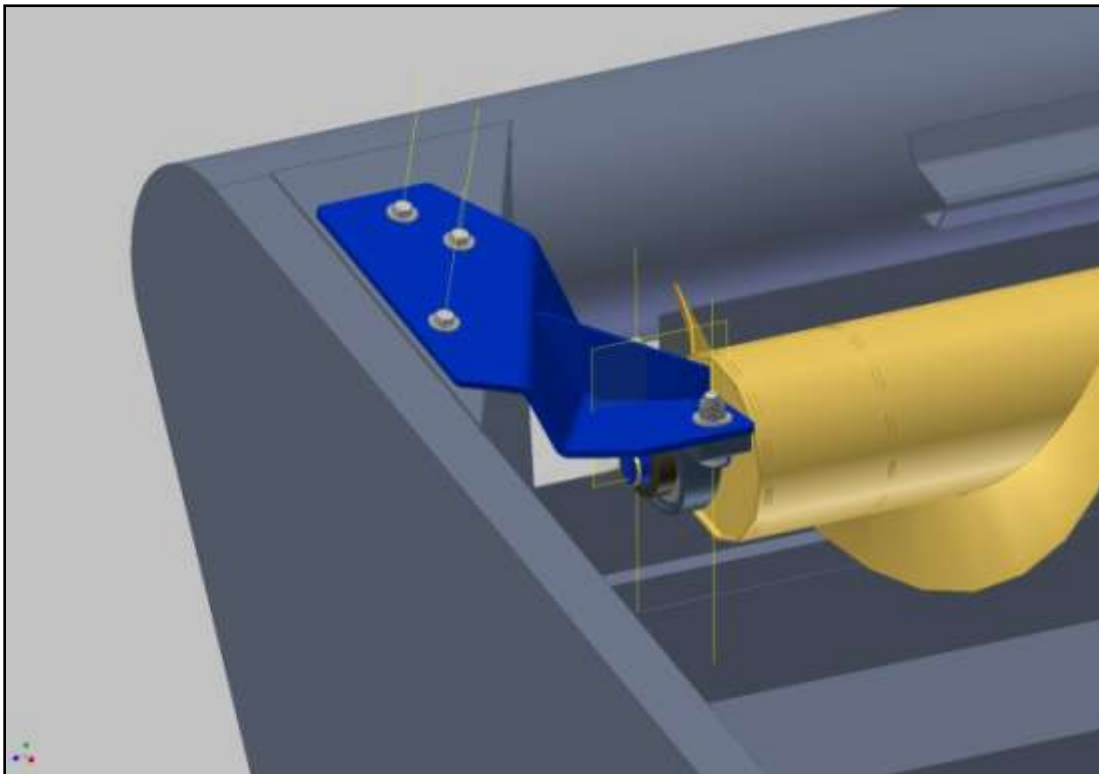

FIGURE 5 FD70 35-40 FOOT RIGHT END



## 4.1. HYDRAULIC INSTALLATION FD70 MODELS

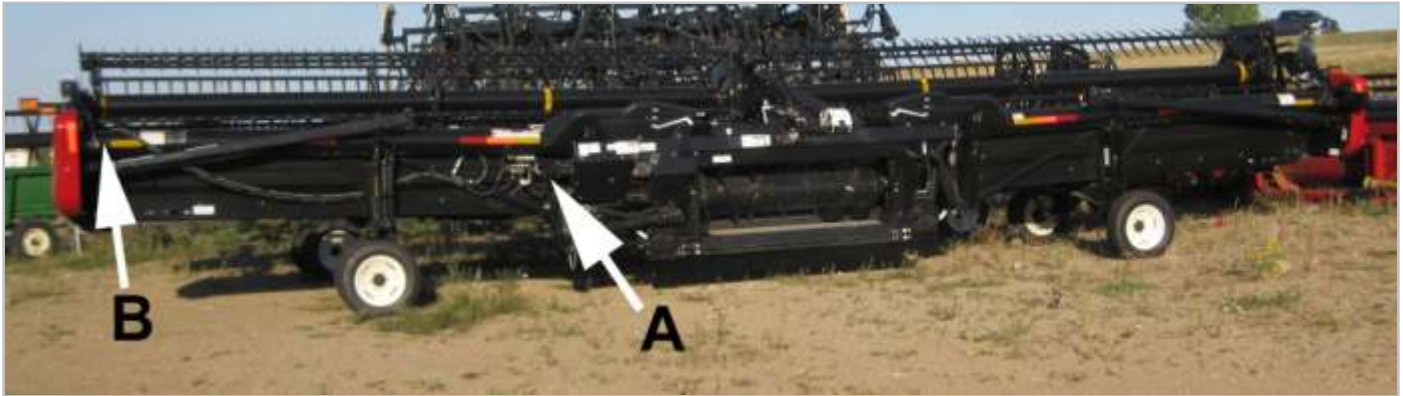

FIGURE 6 2011 HYDRAULIC HOSES ON FD70 / CASE 2162

The auger drive pressure hose runs from the return line from the right hand canvas drive motor at A to the Ag Shield auger motor at B – and the return hose runs from the forward port of the motor back to the fitting to which the canvas motor was originally attached. The hoses extend the series loop of motors by one additional motor.

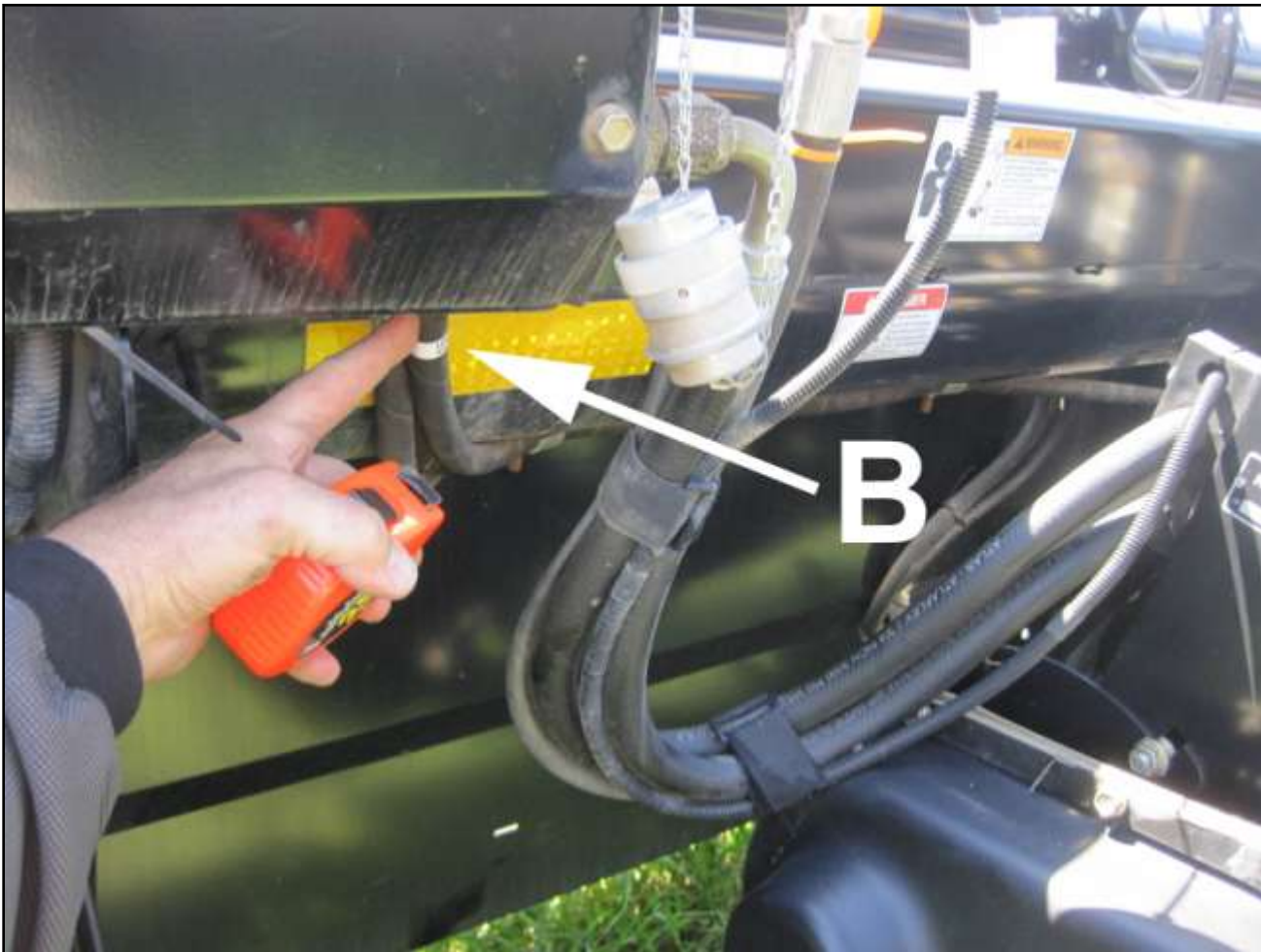

FIGURE 7 CANVAS RETURN HOSE LEFT SIDE OF CENTER PRE 2010 MODELS

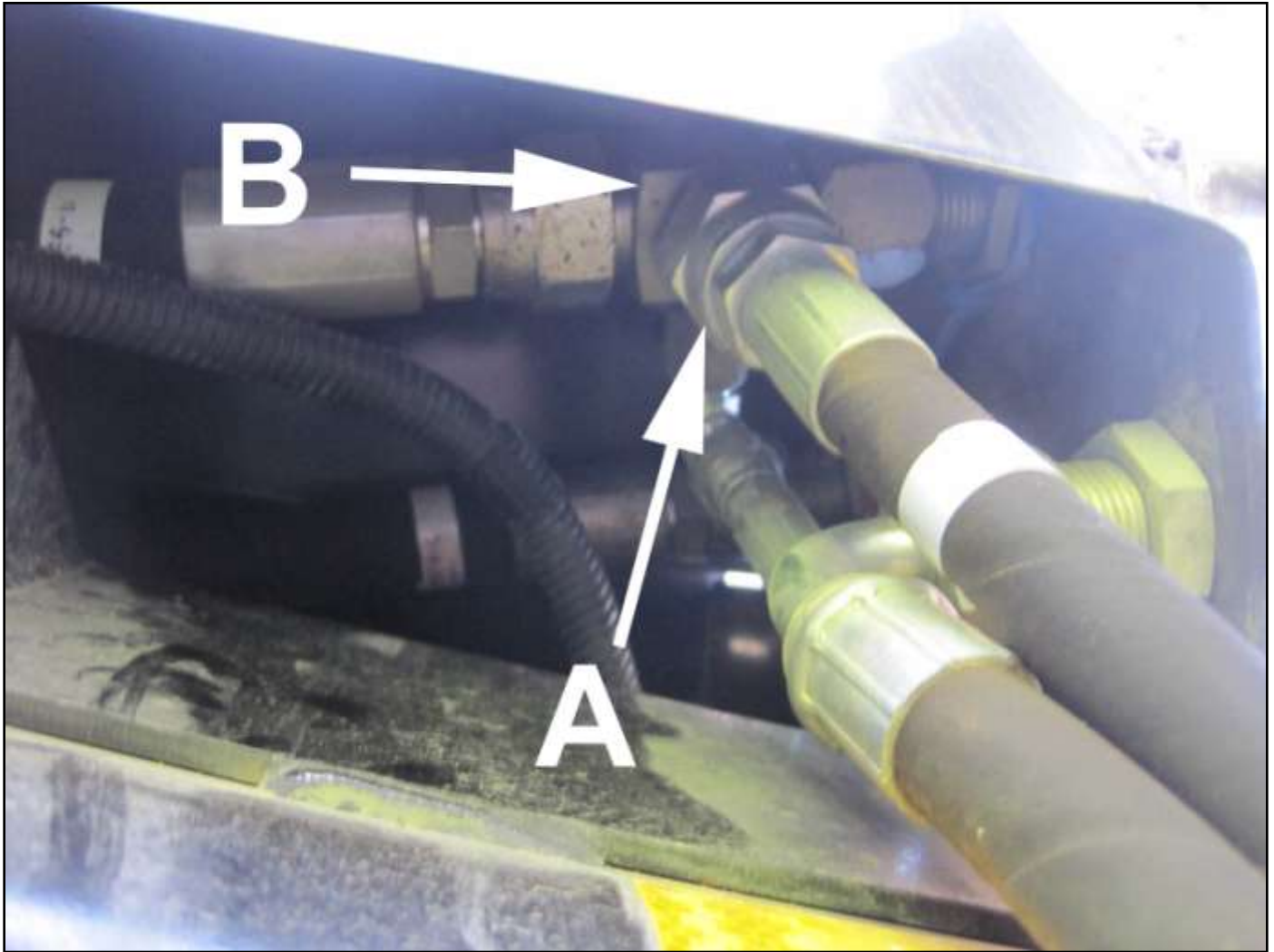

FIGURE 8 HOSE ATTACHMENT FROM BOTTOM UP

1. Disconnect hoses end "A" from the fitting "B" The pressure hose "A" comes from the return line from the right hand canvas motor
2. Connect the Ag Shield Pressure hose to the hose end A,
3. Connect the other end of pressure hose to the rear port of the Ag Shield motor. (The oil will take the long way around the motor , and exit out the front port of motor)
4. Connect the Ag Shield "Return" hose to forward port of motor
5. Connect the other end of the return hoses to the fitting B in photo above, the right hand canvas motor return is shown in picture . The return hose comes from the forward port of Ag Shield cross auger motor, and returns to the #12 JIC male tee left open at B

## 5. OPERATIONS



### **DANGER**

Stay clear of auger whenever it is running

#### **5.1. FIELD SETTING THE CROSS AUGER-**

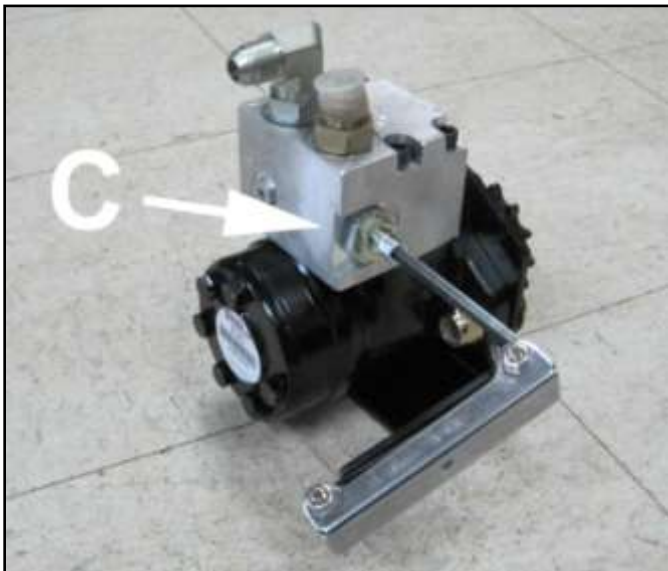

FIGURE 9 SAUER MOTOR SPEED CONTROL FIGURE 10 CHARLYNN MOTOR SPEED CONTROL

Cross augers can only be adjusted for speed of rotation. The correct speed for many crops would be to have the flighting advancing the crop along the canvas 5% or slightly faster than the canvas speed. To increase auger speed, rotate the flow control “C” or “D” clockwise to reduce the bypass of oil around the hydraulic motor. Observe the auger from the combine/ swather operating platform. Focus your eye on one auger flighting and compare to a particular canvas slat. The two items can be adjusted to run at the same rate in feet per minute, As desired, slightly increase the cross auger speed to have it pulling ahead harder than the canvas.

In shorter peas, augers can often be operated at a very slow speed--- 30% of canvas speed, and still feed as much crop into combine. When augers turn slower, there is less tendency to wrap.

#### **5.2. ALTERNATE SYSTEM FOR SPEED CONTROL USING A BRAND MOTOR SPEED CONTROL VALVE.**

Turn dial on motor speed control to have changes in auger speed.



## 6.Cross Auger Parts

### 6.1. MOTOR MOUNT LEFT END DRIVE FD 70 35-40 FT

Parts 35 ft FD70- 2162 Case Ag Shield #405768

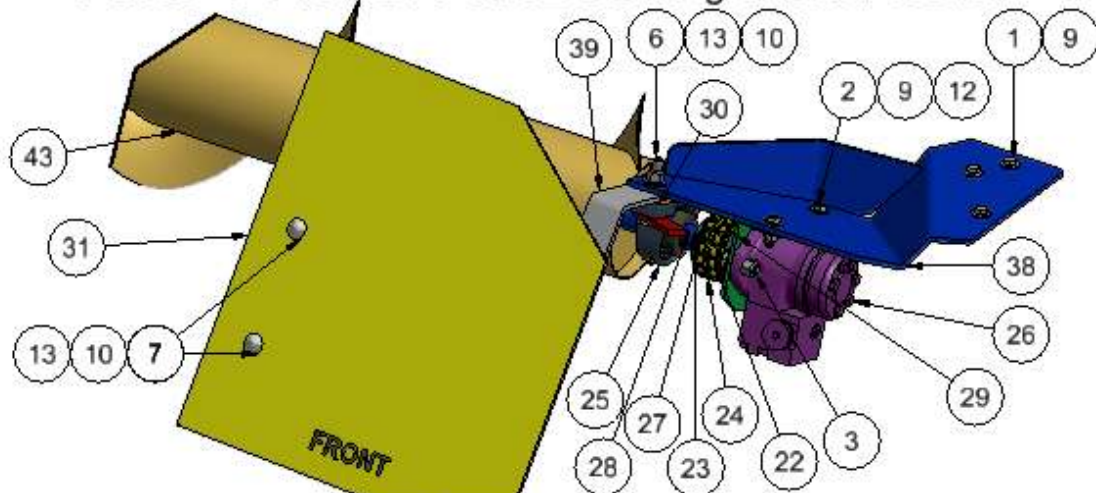

ITEM	QT	PART NUMBER	ITEM	QT	PART NUMBER
1	6	100602 bolt 3/8" x 1" gr5 pltd nc	25	2	114471 Pillow Block Bearing Assy P207-SA207
2	2	100603 bolt 3/8 X 1 1/4 gr5 pltd nc	26	1	117170 Orbit Motor Danfoss 5 9
3	6	100702 bolt 1/2 X 1 1/2 gr5 pltd nc	27	1	405361 key 1/4" x 1/4" x 1"
4	2	100703 bolt 1/2" X 2" gr5 pltd nc	28	1	405794 tab stop auger rotation
5	1	100704 bolt 1/2" x 2 1/2" gr5 pltd nc	29	1	406121 Motor Mount 2-Hole
6	1	100705 bolt 1/2 X 3 gr5 pltd nc	30	1	406136 Drive End Bearing Spacer
7	2	100948 carriage bolt 1/2 X 1 1/4 NC	31	1	406143 Macdon Plastic Motor Cover
8	4	100966 Carriage Bolt 1/4 X 3/4 NC	32	1	406174 MD974 Paddle Wldmt RH
9	16	101105 flat washer 3/8"	33	1	406175 MD974 Paddle Wldmt LH
10	15	101106 flat washer 1/2"	34	1	406179 MD 974 Yoke Shaft Wldmt RH
11	4	102121 nut nylok 1/4" nc gr5 pltd	35	1	406180 Yoke Shaft Wldmt LH
12	8	102123 nut nylok 3/8" nc gr5 pltd	36	2	406196 MD974 Bearing Retainer Wldmt
13	12	102125 nut nylok 1/2" nc gr5 pltd	37	1	406353 MD D60D Bearing End Support RH
14	3	102131 nut jam 3/8 nc gr5 1/2 HGT	38	1	406354 MD D60D Drive End Support Wldmt LH
15	1	103304 spring pin 3/8"x2" lg	39	1	406363 MD D-Series Motor Shield Mount Bar
16	3	105105 Set Screw 3/8 x 1in	40	1	406405 MD FD70 Center Bearing Mount Wldmt
17	1	105602 grease nipple 1/4 x28 nf str	41	1	406408 MD FD70 Center Mount Adapter Plate
18	1	111981 u-joint bearing WSL 200-1200	42	1	407000 MD FD70 35ft Auger Wldmt RH
19	2	111982 bearing 80mm x 1-1/8 sqr RBL W208PP5	43	1	407003 MD FD70 35ft Auger Wldmt LH
20	1	111983 Bearing Plain Spherical GE 80 ES 2RS - inner	45	2	zerk grease nipple 1 8 PTF -- 1649-B Alemite
21	1	111983 Bearing Plain Spherical GE 80 ES 2RS - outer			
22	1	114467 CHAIN COUPLING HSOB14 1 ECC			
23	1	114468 chain coupler 1-1/4" ID			
24	1	114469			

## 6.2. CENTER FLEX ASSEMBLY FD 70 / CASE 2162

### Parts 35 ft FD70- 2162 Case Ag Shield #405768

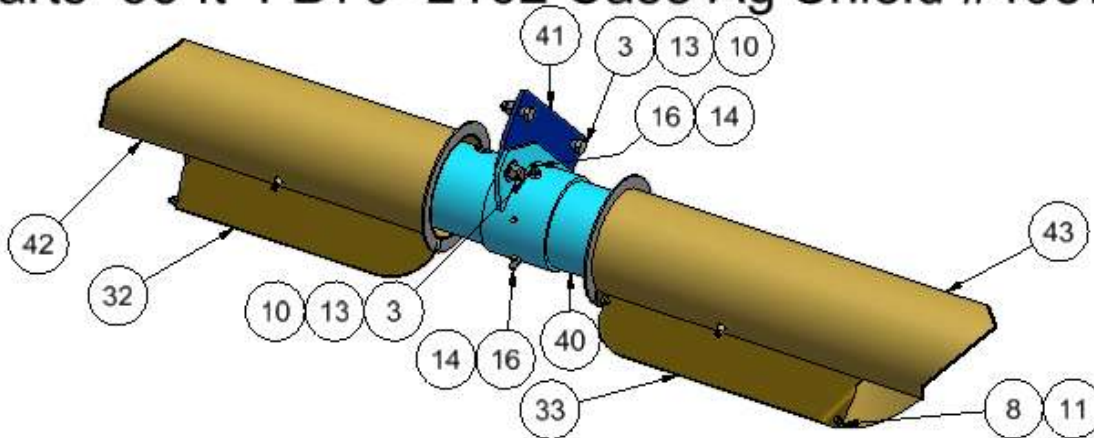

Parts List			Parts List		
ITEM	QTY	PART NUMBER	ITEM	QTY	PART NUMBER
1	6	100602 bolt 3/8" x 1" gr5 pltd nc	25	2	114471 Pillow Block Bearing Assy P207-SA207
2	2	100603 bolt 3/8 X 1 1/4 gr5 pltd nc	26	1	117170 Orbit Motor Danfoss 5_9
3	6	100702 bolt 1/2 X 1 1/2 gr5 pltd nc	27	1	405361 key 1/4" x 1/4" x 1"
4	2	100703 bolt 1/2" X 2" gr5 pltd nc	28	1	405794 tab stop auger rotation
5	1	100704 bolt 1/2" x 2 1/2" gr5 pltd nc	29	1	406121 Motor Mount 2-Hole
6	1	100705 bolt 1/2 X 3 gr5 pltd nc	30	1	406136 Drive End Bearing Spacer
7	2	100948 carriage bolt 1/2 X 1 1/4 NC	31	1	406143 Macdon Plastic Motor Cover
8	4	100966 Carriage Bolt 1/4 X 3/4 NC	32	1	406174 MD974 Paddle Wldmt RH
9	16	101105 flat washer 3/8"	33	1	406175 MD974 Paddle Wldmt LH
10	15	101106 flat washer 1/2"	34	1	406179 MD 974 Yoke Shaft Wldmt RH
11	4	102121 nut nylok 1/4" nc gr5 pltd	35	1	406180 Yoke Shaft Wldmt LH
12	8	102123 nut nylok 3/8" nc gr5 pltd	36	2	406196 MD974 Bearing Retainer Wldmt
13	12	102125 nut nylok 1/2" nc gr5 pltd	37	1	406353 MD D60D Bearing End Support RH
14	3	102131 nut jam 3/8 nc gr5 1/2 HGT	38	1	406354 MD D60D Drive End Support Wldmt LH
15	1	103304 spring pin 3/8"x2" lg	39	1	406363 MD D-Series Motor Shield Mount Bar
16	3	105105 Set Screw 3/8 x 1in	40	1	406405 MD FD70 Center Bearing Mount Wldmt
17	1	105602 grease nipple 1/4 x28 nf str	41	1	406408 MD FD70 Center Mount Adapter Plate
18	1	111981 u-joint bearing WSL 200-1200	42	1	407000 MD FD70 35ft Auger Wldmt RH
19	2	111982 bearing 80mm x 1-1/8 sqr RBL W208PP5	43	1	407003 MD FD70 35ft Auger Wldmt LH
20	1	111983 Bearing Plain Spherical GE 80 ES 2RS - inner	45	2	zerk grease nipple 1 8 PTF -- 1649-B Alemite
21	1	111983 Bearing Plain Spherical GE 80 ES 2RS - outer			
22	1	114467 CHAIN COUPLING HSOB14 1 ECC			
23	1	114468 chain coupler 1-1/4" ID			
24	1	114469			

### 6.3. INTERNAL PARTS CENTER SECTION MACDON FD70 / CASE2162

#### Center components FD70 models

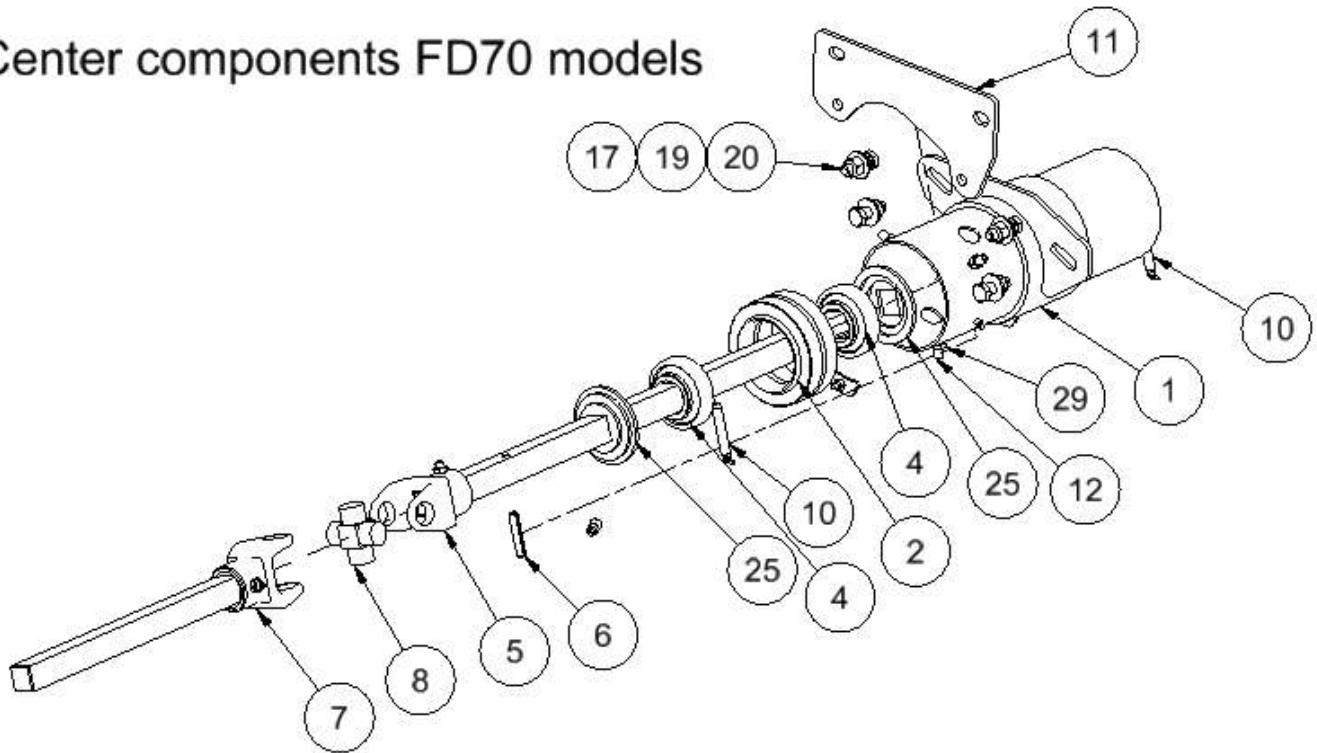

ITEM	QTY	PART NUMBER	ITEM	QTY	PART NUMBER
1	1	406405 MD FD70 Center Bearing Mount Wldmt	13	6	100602 bolt 3/8" x 1" gr5 pltd nc
2	1	111983 Bearing Plain Spherical GE 80 ES 2RS - outer	14	16	101105 flat washer 3/8"
3	1	111983 Bearing Plain Spherical GE 80 ES 2RS - inner	15	8	102123 nut nylok 3/8" nc gr5 pltd
4	2	111982 bearing 80mm x 1-1_8 sqr RBL W208PP5	16	1	100704 bolt 1/2" x 2 1/2" gr5 pltd nc
5	1	406180 Yoke Shaft Wldmt LH	17	15	101106 flat washer 1/2"
6	1	103304 spring pin 3/8"x2" lg	18	1	405794 tab stop auger rotation
7	1	406179 MD 974 Yoke Shaft Wldmt RH	19	12	102125 nut nylok 1/2" nc gr5 pltd
8	1	111981 u-joint bearing WSL 200-1200	20	6	100702 bolt 1-2 X 1 1-2 gr5 pltd nc
9	1	117170 Orbit Motor Danfoss 5_9	21	1	405361 key 1/4" x 1/4" x 1"
10	2	zerk grease nipple 1 8 PTF -- 1649-B Alemite	22	1	105602 grease nipple 1 4 x28 nf str
11	1	406408 MD FD70 Center Mount Adapter Plate	23	4	100966 Carriage Bolt 1-4 X 3-4 NC
12	3	105105 Set Screw 3-8 x 1in	24	4	102121 nut nylok 1/4" nc gr5 pltd
			25	2	406196 MD974 Bearing Retainer Wldmt
			26	2	100948 carriage bolt 1-2 X 1 1-4 NC
			27	2	100703 bolt 1/2" X 2" gr5 pltd nc
			28	1	100705 bolt 1-2 X 3 gr5 pltd nc
			29	3	102131 nut jam 3-8 nc gr5 1-2 HGT
			30	2	100603 bolt 3/8 X 1 1/4 gr5 pltd nc



## 6.4. RIGHT END PARTS MACDON FD70 / CASE 2162- ALL MODELS

### Parts 35 ft FD70- 2162 Case Ag Shield #405768

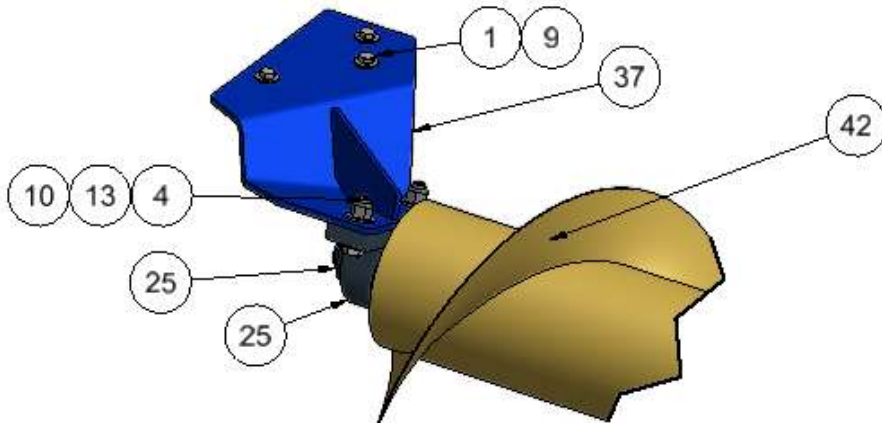

ITEM	QT	PART NUMBER	ITEM	QT	PART NUMBER
1	6	100602 bolt 3/8" x 1" gr5 pltd nc	25	2	114471 Pillow Block Bearing Assy P207-SA207
2	2	100603 bolt 3/8 X 1 1/4 gr5 pltd nc	26	1	117170 Orbit Motor Danfoss 5_9
3	6	100702 bolt 1/2 X 1 1/2 gr5 pltd nc	27	1	405361 key 1/4" x 1/4" x 1"
4	2	100703 bolt 1/2" X 2" gr5 pltd nc	28	1	405794 tab stop auger rotation
5	1	100704 bolt 1/2" x 2 1/2" gr5 pltd nc	29	1	406121 Motor Mount 2-Hole
6	1	100705 bolt 1/2 X 3 gr5 pltd nc	30	1	406136 Drive End Bearing Spacer
7	2	100948 carriage bolt 1/2 X 1 1/4 NC	31	1	406143 Macdon Plastic Motor Cover
8	4	100966 Carriage Bolt 1/4 X 3/4 NC	32	1	406174 MD974 Paddle Wldmt RH
9	16	101105 flat washer 3/8"	33	1	406175 MD974 Paddle Wldmt LH
10	15	101106 flat washer 1/2"	34	1	406179 MD 974 Yoke Shaft Wldmt RH
11	4	102121 nut nylok 1/4" nc gr5 pltd	35	1	406180 Yoke Shaft Wldmt LH
12	8	102123 nut nylok 3/8" nc gr5 pltd	36	2	406196 MD974 Bearing Retainer Wldmt
13	12	102125 nut nylok 1/2" nc gr5 pltd	37	1	406353 MD D60D Bearing End Support RH
14	3	102131 nut jam 3/8 nc gr5 1/2 HGT	38	1	406354 MD D60D Drive End Support Wldmt LH
15	1	103304 spring pin 3/8"x2" lg	39	1	406363 MD D-Series Motor Shield Mount Bar
16	3	105105 Set Screw 3/8 x 1in	40	1	406405 MD FD70 Center Bearing Mount Wldmt
17	1	105602 grease nipple 1/4 x28 nf str	41	1	406408 MD FD70 Center Mount Adapter Plate
18	1	111981 u-joint bearing WSL 200-1200	42	1	407000 MD FD70 35ft Auger Wldmt RH
19	2	111982 bearing 80mm x 1-1/8 sqr RBL W208PP5	43	1	407003 MD FD70 35ft Auger Wldmt LH
20	1	111983 Bearing Plain Spherical GE 80 ES 2RS - inner	45	2	zerk grease nipple 1 8 PTF -- 1649-B Alemite
21	1	111983 Bearing Plain Spherical GE 80 ES 2RS - outer			
22	1	114467 CHAIN COUPLING HSOB14 1 ECC			
23	1	114468 chain coupler 1-1/4" ID			
24	1	114469			

## 6.5. FD70 40 FT AUGER PARTS

Only the augers have different lengths and part numbers than the 35 foot kit.

### Parts 40 ft FD70- 2162 Case Ag Shield #405769

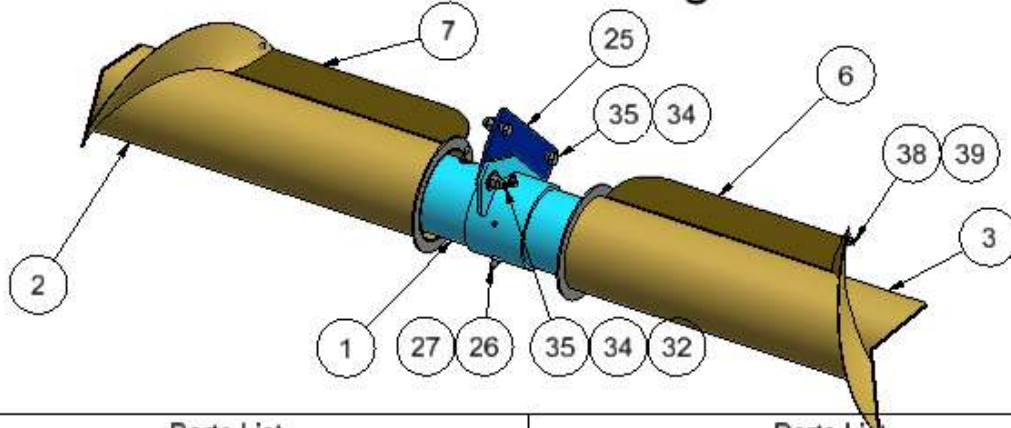

Parts List			Parts List		
ITEM	QTY	PART NUMBER	ITEM	QTY	PART NUMBER
1	1	406405 MD FD70 Center Bearing Mount Wldmt	21	1	114467 CHAIN COUPLING HSOB14 1 ECC
2	1	406399 MD FD70 40ft Auger Wldmt RH	22	1	406136 Drive End Bearing Spacer
3	1	406402 MD FD70 40ft Auger Wldmt LH	23	1	406121 Motor Mount 2-Hole
4	1	406180 Yoke Shaft Wldmt LH	24	2	zerk grease nipple 1/8 PTF -- 1649-B Alemite
5	1	406179 MD 974 Yoke Shaft Wldmt RH	25	1	406408 MD FD70 Center Mount Adapter Plate
6	1	406175 MD974 Paddle Wldmt LH	26	3	105105 Set Screw 3-8 x 1in
7	1	406174 MD974 Paddle Wldmt RH	27	3	102131 nut jam 3-8 nc gr5 1-2 HGT
8	2	406196 MD974 Bearing Retainer Wldmt	28	6	100602 bolt 3/8" x 1" gr5 pltd nc
9	1	406353 MD D60D Bearing End Support RH	29	16	101105 flat washer 3/8"
10	1	406354 MD D60D Drive End Support Wldmt LH	30	8	102123 nut nylok 3/8" nc gr5 pltd
11	2	114471 Pillow Block Bearing Assy P207-SA207	31	1	100704 bolt 1/2" x 2 1/2" gr5 pltd nc
12	1	Macdon FD70 - 40ft Header Mockup from D60D	32	15	101106 flat washer 1/2"
13	1	111983 Bearing Plain Spherical GE 80 ES 2RS - outer	33	1	405794 tab stop auger rotation
14	1	111983 Bearing Plain Spherical GE 80 ES 2RS - inner	34	12	102125 nut nylok 1/2" nc gr5 pltd
15	2	111982 bearing 80mm x 1-1_8 sqr RBL W208PP5	35	6	100702 bolt 1-2 X 1 1-2 gr5 pltd nc
16	1	103304 spring pin 3/8"x2" lg	36	1	405361 key 1/4" x 1/4" x 1"
17	1	111981 u-joint bearing WSL 200-1200	37	1	105602 grease nipple 1/4 x28 nf str
18	1	117170 Orbit Motor Danfoss 5_9	38	4	100966 Carriage Bolt 1-4 X 3-4 NC
19	1	114469	39	4	102121 nut nylok 1/4" nc gr5 pltd
20	1	114468 chain coupler 1-1/4" ID	40	1	406363 MD D-Series Motor Shield Mount Bar
			41	1	406143 Macdon Plastic Motor Cover
			42	2	100948 carriage bolt 1-2 X 1 1-4 NC
			43	2	100703 bolt 1/2" X 2" gr5 pltd nc
			44	1	100705 bolt 1-2 X 3 gr5 pltd nc
			45	2	100603 bolt 3/8 X 1 1/4 gr5 pltd nc

## 7. Specifications—

call Ag Shield

## 8. WARRANTY

1. Ag Shield Manufacturing warrants each new Ag Shield reconditioner to be free from factory defects in material and workmanship under normal use and service, when set up and operated in accordance with factory instructions for one year from the date of delivery to the original purchaser.
2. Ag Shield's obligation under this warranty is limited to the supplying of replacement parts which are defective due to factory workmanship or material.
3. Your Ag Shield Dealer is responsible for providing warranty labour. Credit for required labour is specifically agreed to on an individual case basis.
4. The warranty is void on any unit which has been tampered with, or modified in any way not authorized in writing by the factory.
5. This warranty is void on any unit which is subject to misuse, negligence or accident, or which has had the serial number tampered or removed.
6. A "Warranty Claim Form" (sample at end of handbook) must be submitted to Ag Shield with returned parts in order for parts to be considered for warranty examination.
7. A warranty registration page from the front of this manual must be returned to the factory in order to qualify for warranty examination.
8. All returned parts must be sent to the factory freight prepaid, and warranty parts will be returned to you freight collect.
9. Replacement parts shipped pending receipt of parts for examination will be invoiced, and remain on your account until such time as examination indicates that a credit for those parts be issued or that payment is due.
10. Parts not returned for warranty examination within 30 days must be paid for at that time. Ag Shield will immediately reimburse any cash paid for items that are later determined defective.
11. Warranty terms and conditions are subject to provincial and state legislation.





WARRANTY CLAIM FORM

Dealer		
Address		
City	State/Province	Zip/Postal

**Ag Shield Mfg**  
Box 9, Benito,  
MB, R0L 0C0  
ph 800-561-0132  
fax 204-539-2130  
ph 204-539-2000i

End User		
Address		
City	State/Province	

DATE OF SALE	DATE FAILED	REPAIR DATE	ACRES/HOURS	MODEL	SERIAL NUMBER
--------------	-------------	-------------	-------------	-------	---------------

LABOUR HOURS	LABOUR RATE	LABOUR AMOUNT	PARTS MUST BE RETURNED TO BENITO MB FREIGHT PREPAID TO BE CONSIDERED FOR WARRANTY. DATE SHIPPED		
--------------	-------------	---------------	---	--	--

QUANTITY ITEM	PART NUMBER	DESCRIPTION	PRICE EACH	TOTAL PRICE	DESCRIBE THE CAUSE OF FAILURE AND CORRECTIVE ACTION TAKEN	APPROVE /REJECT
1						
2						
3						
4						
5						
6						
7						
8						

I CERTIFY THAT THE INFORMATION IS ACCURATE AND THAT THE PARTS WERE REPLACED ON THE MACHINE	PARTS		DATE PARTS RECD	RECD BY
	LABOUR		ITEMS TO SUPPLIERS	
	TOTAL			

SHADED AREAS AG SHIELD USE ONLY ---PLEASE ADD DETAILS FOR ITEM NUMBERS ON BACK

---

---

---

---

---

[illegible]

---

---

---

---

---

---