

WORX®

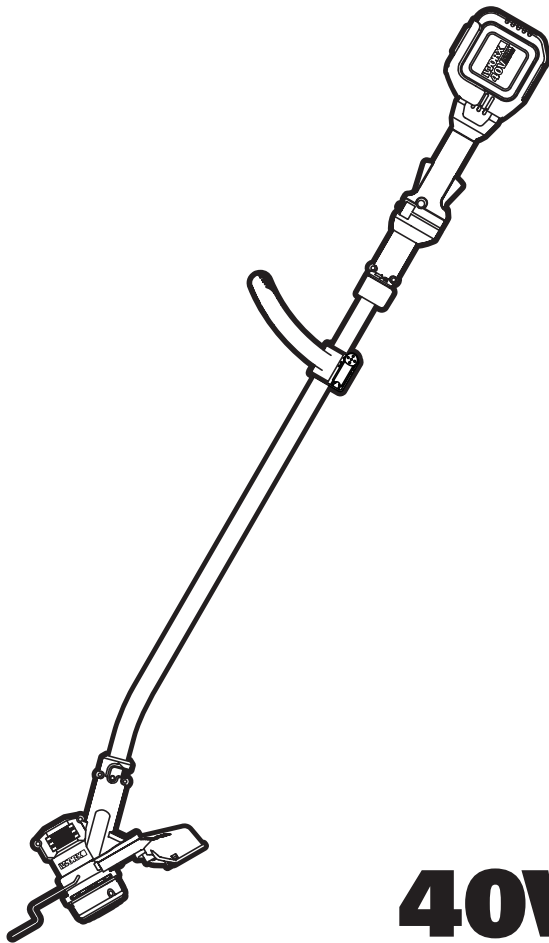

**40V^{MAX}*
LITHIUM**

2-in-1 Grass Trimmer/Edger

EN

P06

Coupe gazon/Taille-bordure 2 en 1

F

P14

2 en 1 Cortadora de cesped/Ribeteadora

ES

P25



HELPLINE NUMBER
1-866-354-WORX (9679)

WG168



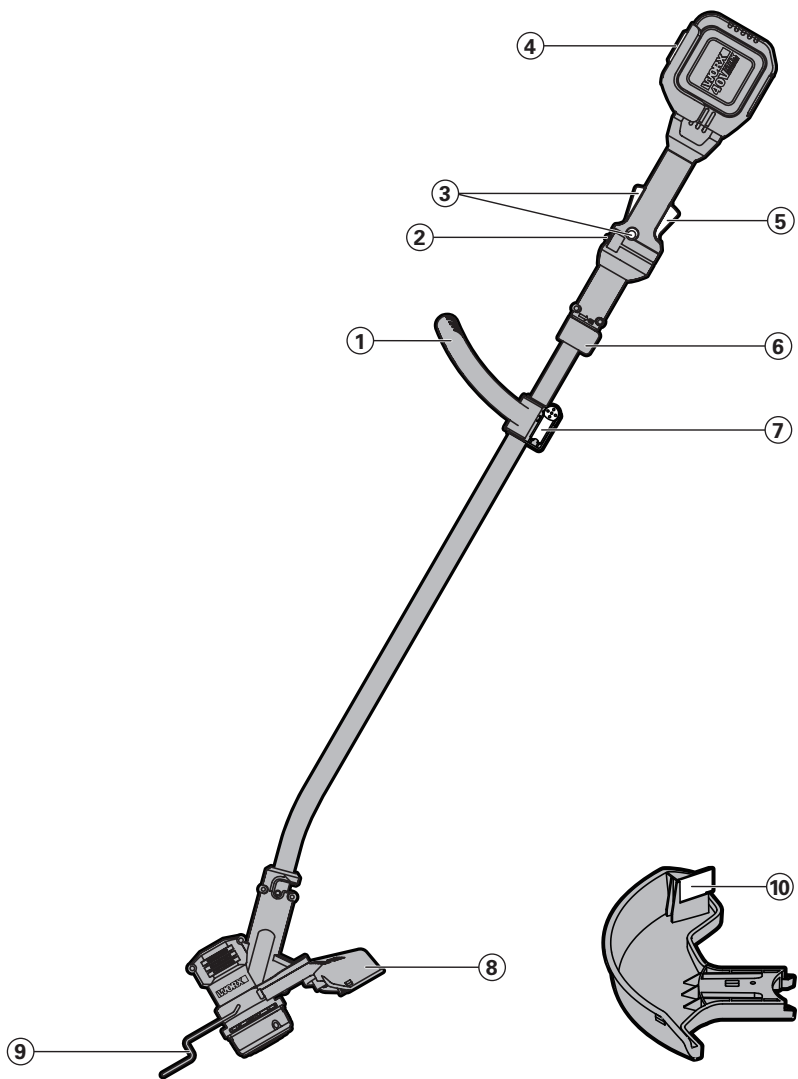

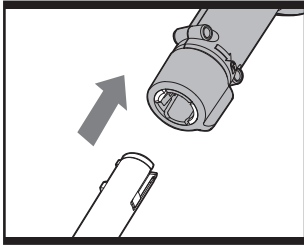

A1

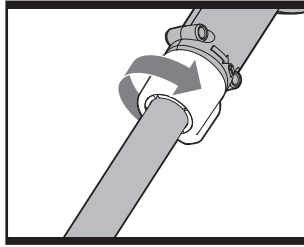

A2

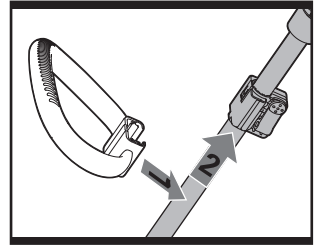

B1

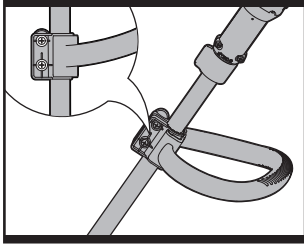

B2

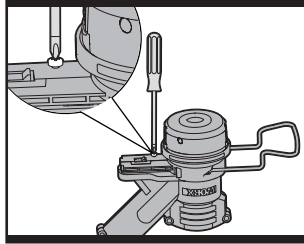

C1

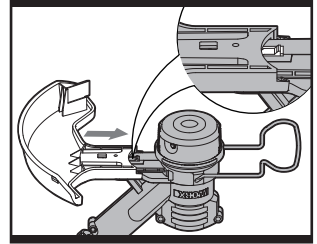

C2

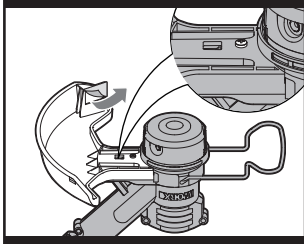

C3

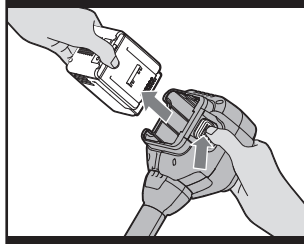

D1

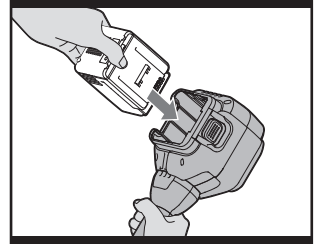

D2

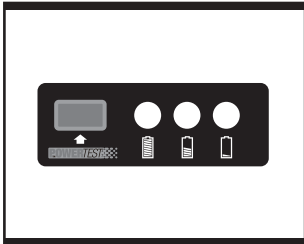

E

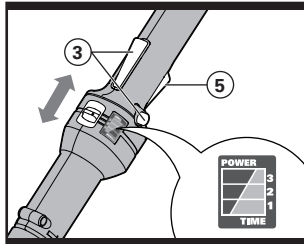

F

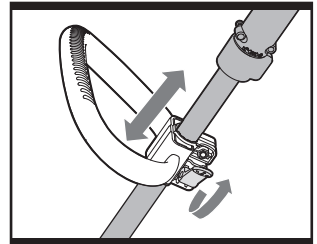

G

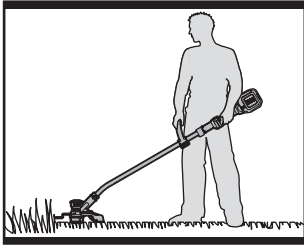

H1

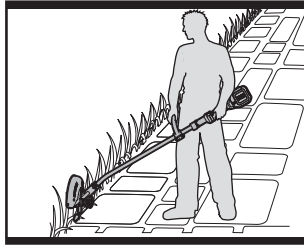

H2

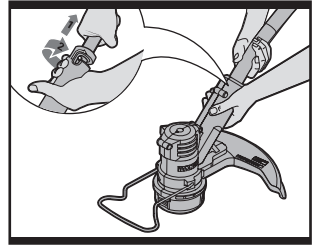

H3

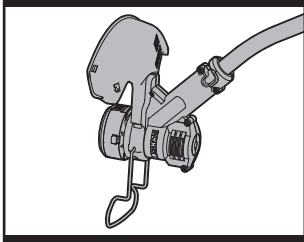

H4

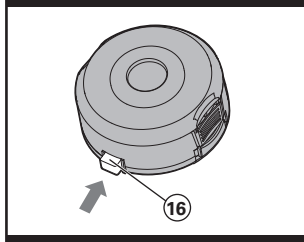

I1

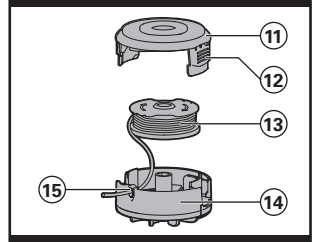

I2

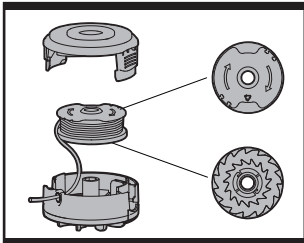

J

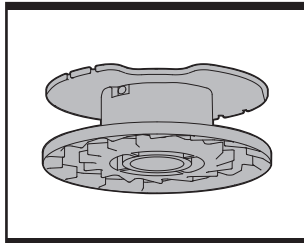

K1

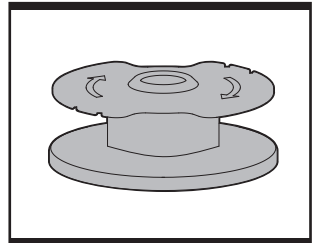

K2

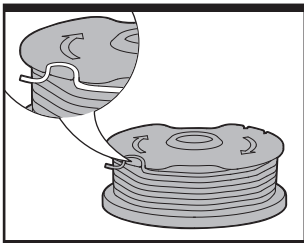

K3

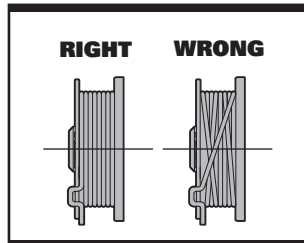

K4

-
- 1. AUXILIARY HANDLE**

 - 2. THREE SPEED SETTINGS**

 - 3. LOCK OFF SWITCH**

 - 4. BATTERY PACK**

 - 5. ON/OFF LEVER**

 - 6. SHAFT LOCKING KNOB**

 - 7. AUXILIARY HANDLE LOCKING CLAMP**

 - 8. SAFETY GUARD**

 - 9. EDGE GUIDE**

 - 10. LINE CUTTER**

 - 11. TRIMMER HEAD COVER (See Fig. I2)**

 - 12. CAP RELEASE LATCH (See Fig. I2)**

 - 13. SPOOL (See Fig. I2)**

 - 14. TRIMMER HEAD (See Fig. I2)**

 - 15. EYELET (See Fig. I2)**

 - 16. LINE FEED BUTTON (See Fig. I1)**
-

6

Not all the accessories illustrated or described are included in standard delivery.

TECHNICAL DATA

Voltage	40V  Max*
No load speed	8300/min
Cutting diameter	13"(330mm)
Line diameter	0.08"(2.0mm)
Charging time	1hr
Machine weight	7.7 lbs(3.5kg)

* Voltage measured without workload. Initial battery voltage reaches maximum of 40 volts.
Nominal voltage is 36 volts.

ACCESSORIES

Charger (WA3734)	1
Battery pack (WA3536)	1
Spool (WA0014)	1

We recommend that you purchase your accessories from the same store that sold you the tool. Use good quality accessories marked with a well-known brand name. Choose the type according to the work you intend to undertake. Refer to the accessory packaging for further details. Store personnel can assist you and offer advice.

GENERAL SAFETY WARNINGS

IMPORTANT SAFETY INSTRUCTIONS

 **WARNING!** When using electric gardening appliances, basic safety precautions should always be followed to reduce the risk of fire, electric shock, and personal injury, including the following:

 **WARNING: Read all instructions**

FOR ALL APPLIANCES

- 1) Avoid Dangerous Environment - Don't use appliances in damp or wet locations.
- 2) Don't Use In Rain.
- 3) Keep Children Away - All visitors should be kept at a distance from work area.
- 4) Dress Properly - Do not wear loose clothing or jewelry. They can be caught in moving parts. Use of rubber gloves and substantial footwear is recommended when working outdoors. Wear protective hair covering to contain long hair.
- 5) Use Safety Glasses - Always use face or dust mask if operation is dusty.
- 6) Use Right Appliance - Do not use appliance for any job except that for which it is intended.
- 7) Don't Force Appliance - It will do the job better and with less likelihood of a risk of injury at the rate for which it was designed.
- 8) Don't Overreach - Keep proper footing and balance at all times.
- 9) Stay Alert - Watch what you are doing. Use common sense. Do not operate appliance when you are tired.
- 10) Store Idle Appliances Indoors - When not in use, appliances should be stored indoors in dry, and high or locked-up place - out of reach of children.
- 11) Maintain Appliance With Care - Keep line cutter sharp and clean for best performance and to reduce the risk of injury. Follow instructions for lubricating and changing accessories. Inspect appliance cord periodically, and if damaged, have it repaired by an authorized service facility. Inspect extension cords periodically and replace if damaged. Keep

handles dry, clean, and free from oil and grease.

- 12) Check Damaged Parts - Before further use of the appliance, a guard or other part that is damaged should be carefully checked to determine that it will operate properly and perform its intended function. Check for alignment of moving parts, binding of moving parts, breakage of parts, mounting, and any other condition that may affect its operation. A guard or other part that is damaged should be properly repaired or replaced by an authorized service center unless indicated elsewhere in this manual.

SAVE THESE INSTRUCTIONS

FOR ALL BATTERY - OPERATED GARDENING APPLIANCES

1. The instruction manual for all battery-operated gardening appliances shall contain the following or equivalent instructions:

- 1) Do not charge appliance in rain, or in wet locations.
- 2) Do not use battery-operated appliance in rain.
- 3) When replacing batteries, all batteries should be replaced at the same time. Mixing fresh and discharged batteries could increase internal cell pressure and rupture the discharge battery(ies).
- 4) When inserting batteries into this product, the proper polarity or direction must be observed. Reverse insertion of batteries can result in leakage or explosion.

 Always remove or disconnect battery pack before adjusting, cleaning, servicing or transporting the lawn trimmer.

2. The instruction manual for all battery-operated products employing a detachable or separable battery shall contain the following or equivalent instructions:

- 1) Use only the following type and size battery(ies).
- 2) Do not dispose of the battery(ies) in a fire. The cell may explode. Check with local codes for possible special disposal instructions.

- 3) Do not open or mutilate the battery(ies). Released electrolyte is corrosive and may cause damage to the eyes or skin. It may be toxic if swallowed.
- 4) Exercise care in handling batteries in order not to short the battery with conducting materials such as rings, bracelets, and keys. The battery or conductor may overheat and cause burns.

3. Avoid Unintentional Starting – Do not insert battery with finger on switch. Be sure switch is off when inserting battery.

SAVE THESE INSTRUCTIONS

ADDITIONAL SAFETY RULES FOR LAWN TRIMMER AND EDGE TRIMMER

1. Keep guards in place and in working order.
2. Do not use this product without the guard being fitted.
3. Keep hands and feet away from cutting area.
4. Do not use heavier lines than recommended in this manual.
5. Do not use line materials of other types – for example, metal wire, rope, and the like.

SAVE THESE INSTRUCTIONS

SYMBOLS



BATTERY PACK REMOVAL AND PREPARATION FOR RECYCLING

To preserve natural resources, please recycle or dispose of batteries properly. This product contains lithium-ion batteries. Local, state or federal laws may prohibit disposal of lithium-ion batteries in ordinary trash. Consult your local waste authority for information regarding available recycling and/or disposal options.

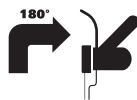

Edging



Trimming

ASSEMBLY

1. ASSEMBLY OF THE MAIN HANDLE

(See Fig. A1, A2)

Align and insert the shaft into the upper housing until a click can be heard. Make sure the grooves are correctly matched. (See Fig. A1). Tighten the shaft locking knob in the direction indicated to lock  (See Fig. A2).

NOTE: Make sure that the handle is firmly locked in place.

2. ASSEMBLY OF THE AUXILIARY HANDLE

(See Fig. B1, B2)

Slide the auxiliary handle onto the grooves of auxiliary handle support until a click can be heard. And make sure the auxiliary handle locking clamp is closed. (See Fig. B1)

NOTE: Make sure the handle is firmly secured in place.

If the handle is loose then tighten the 2 side screws. (See Fig. B2)

3. ASSEMBLY OF THE SAFETY GUARD

(See Fig. C1, C2, C3)

Remove the screw from the bottom of the trimmer head - then attach the safety guard to the housing.

Secure the guard in place by the refitting of the screw.

Remove the line cutter protection tape.

(See Fig. C3)

NOTE: Make sure the Guard is firmly secured in place.

OPERATION INSTRUCTIONS



WARNING! The charger and battery pack are specially designed to work together so do not attempt to use any other devices. Never insert or allow metallic objects into your charger or battery pack connections because of an electrical failure and hazard will occur.

1. BEFORE USING YOUR CORDLESS GRASS TRIMMER

The battery pack included is shipped UNCHARGED. You must charge before first use. The battery charger supplied was designed to

only charge the Li-Ion battery also supplied. Do not use another battery charger.

2. CHARGING YOUR BATTERY PACK

The Li-Ion battery is protected against deep discharging. When the battery is empty, the machine will switch off by means of a protective circuit: The trimmer head no longer rotates.

In a warm environment or after heavy use, the battery pack may become too hot to permit charging. Allow time for the battery to cool down before recharging.

3. TO REMOVE OR INSTALL BATTERY PACK

(See Fig. D1, D2)

Depress the battery release button to release battery pack from your trimmer (See Fig. D1). After recharging, insert the battery pack into trimmer's battery port (See Fig. D2). A simple push and slight pressure will be sufficient until a click is heard.

NOTE: When removing the battery pack, hold it firmly to avoid dropping and injury.

4. BATTERY STATUS LED'S (See Fig. E)

NOTE: The Status LED's will indicate the battery condition when the button on the battery is pressed.

The LED's constantly senses and displays the battery condition as follows:

Press the button "POWERTEST"; the light button is illuminated.

When the three green lights are illuminated, the battery is in a highly charged condition.

When two lights () are illuminated, the battery is in a moderately charged condition.

When only one green light () is illuminated, the battery charge is depleted.

IMPORTANT:

When only one light is illuminated, your battery is overly discharged, even though the trimmer may still be capable of cutting grass. Continuing to operate your trimmer with the battery in this discharged condition may reduce the life and performance of your battery.

5. SAFETY ON/OFF SWITCH (See Fig. F)

Your trimmer has two Lock OFF switches (3) to

prevent accidental starting. Depress the Lock OFF switches and the On/OFF lever (5) to start your trimmer. To switch off, just release the on/off switch.

 **WARNING! The cutting head continues to rotate after the trimmer has been switched off; wait until it has completely stopped then lay down the tool.**

6. THREE SPEED SETTINGS (See Fig. F)

Your machine is fitted with a 3 Speed selector button.

Speed 1 –Used for basic light trimming of short grass.

Speed 2 –Used for medium / longer grass trimming –ie. trimming against walls/fences etc.

Speed 3 –Used for tough over grown areas of long grass.

7. ADJUSTMENT OF AUXILIARY HANDLE (See Fig. G)

Release the auxiliary handle locking clamp, move the the auxiliary handle to the most comfortable and balanced position. Close the clamp to tighten the handle.

NOTE: Make sure the handle is firmly secured in place.

OPERATION

 **WARNING:** Always wear the eye protection. Never lean over the trimmer head. Rocks or debris can ricochet or be thrown into eyes and face and cause blindness or other serious injury. When operating unit, check for the following:

Wear eye protection and heavy clothing. Hold front handle with one hand and auxiliary handle with the other hand. Keep unit below waist level. Work only from your right to your left to ensure debris is thrown away from you. Without bending over, keep line near and parallel to the ground (perpendicular when edging) and not crowded into material being cut.

 **WARNING: Make sure that line is fed out before operation. Make sure motor is up to full speed before trimming**

 **WARNING: Use only 0.08”(2.0mm) diameter cutting line.** Other sizes of line will not feed properly and will result in improper cutting head function or can cause serious injury. Do not use other material such as wire, string, rope, etc. Wire can break off during cutting and become a dangerous projectile that can cause serious injury.

Trimming

Position the trimmer head as shown in Fig. H1 for trimming.

Keep the bottom of the trimmer head just above the ground and at an angle. Allow only the tip of line to make contact. Do not force trimmer line into work area.

Edging (See Fig. H1, H2, H3, H4)

 **ALWAYS REMOVE THE BATTERY PACK BEFORE ADJUSTING THE TRIMMER HEAD POSITION.**

For edging, position the trimmer head as Fig.H2. To rotate the trimmer head to edging—first hold the trimmer shaft as shown in Fig H3--- then with your other hand hold the trimmer head - Push down and rotate 180 degrees and then release- the trimmer will then lock into the edging position automatically—Fig H4

NOTE: The trimmer head will only rotate in one direction. While rotating, please remove the battery from your tool for your safety. The edge guide helps protect the unit and keeps the unit from contacting the ground. Take extra caution while edging as objects can be thrown from the trimmer line.

AUTOMATIC LINE FEED SYSTEM

When initially switching ON the trimmer, a small length of line is fed out.

A ‘clattering’ noise will be heard when the lines hit the line cutter. **DO NOT BE ALARMED**, this is normal. After about 5 seconds the line will be cut to the correct length and the noise will reduce as the motor receives full speed.

If the noise of the line being cut can’t be heard, more line will need to be fed out.

To feed more line, it is first necessary to allow the trimmer to stop completely, then restart, allowing the motor to reach full speed.

Repeat above until you hear the lines hitting against the line cutter.

TO MANUALLY FEED THE LINE

(See Fig. I1)

 **ALWAYS REMOVE THE BATTERY PACK BEFORE ADJUSTING THE TRIMMER HEAD POSITION.**

If required, line can be feed out manually. To operate, press and release manual line feed button (16), while gently pulling out the line until it is long enough to reach the line cutter. If the line extends past the line cutter, too much line has been fed out. If too much line is fed out, remove the spool cap and turn spool counter-clockwise until the line is at the desired length.

TO REMOVE THE CAP (See Fig. I2)

- Press and hold the two latches (12).
- Pull cap away from the spool holder
- When refitting the spool cap, keep all areas of the cap and spool holder clean.
- Replace the cap, pressing firmly down towards the spool holder to ensure cap is fully located into position.
- Check that the cap is correctly fitted by trying to remove it without depressing the two latches.

REPLACE THE TRIMMER LINE AND SPOOL (See Fig. J).

 **ALWAYS REMOVE THE BATTERY PACK BEFORE ADJUSTING THE TRIMMER HEAD POSITION.**

- Remove Spool Cap Cover.
- For your convenience it is recommended you buy replacement spools with the trimmer line preinstalled.
- Remove the old Spool from Spool Holder. Clear any broken line or cutting debris from the spool area.
- Pull the line from the new replacement Spool through the eyelet of the Spool Holder.
- Place new Spool into the holder with the cut out areas of the Spool facing inward or down. When installed into the Spool Holder, the smooth side of the Spool should be visible.
- Release line from cleat on the Spool.
- Refit the Spool Cap Cover.

TO MANUALLY WIND LINE

(See Fig. K1-K4)

Take approximately 20ft (6m) of line. Insert 0.8" (2mm) of line into the Spool holes and wind line in the direction of the arrows on the top of the Spool.

Leave approximately 4" (100mm) of line unwound and place into the cleat.

Ensure that the line is neatly coiled on the Spool. Failure to do so will impair the efficiency of the automatic line feed.

Then fit the Spool as described above in **"Replace the trimmer line and Spool"**

STORING YOUR GRASS TRIMMER

 **Always remove the battery pack from your trimmer after use.**

Store in a dry place where the trimmer and battery can be protected from damage.

MAINTENANCE

 **Always remove the battery pack from your trimmer after use.**

Always check the product prior to being used for any damage.

Never operate your product if it is damaged. Your power tool requires no additional lubrication or maintenance. There are no user serviceable parts in your power tool. Never use water or chemical cleaners to clean your power tool. Wipe clean with a dry cloth. Always store your power tool in a dry place. Keep the motor ventilation slots clean. Keep all working controls free of dust.

TROUBLESHOOTING

The following table gives checks and actions that you can perform if your machine does not operate correctly. If these do not identify and correct the problem, contact your service agent.



WARNING: Switch the machine off and remove the battery prior to any troubleshooting.

Problems	Possible Causes	Corrective Action
Trimmer fails to operate.	Battery discharged. Battery too hot/cold. Motor is broken. Internal wiring of machine damaged.	Recharge battery; also see the content in charger manual. Allow to cool/warm. Contact Service Agent. Contact Service Agent.
Trimmer runs intermittently.	Motor is broken. Battery not fully charged. On/Off switch defective.	Contact Service Agent. Recharge battery. Contact Service Agent.
Excessive vibrations/noise.	Machine defective. Line spool is not wound well.	Contact Service Agent. Rewind the line. See "To fit spool and line assembly."
Cutting time per battery charge too low.	Battery has not been used for long period or only charged for short term. Grass too high. Battery defective.	Fully charge battery; also see the content in charger manual Cut in stages. Replace the battery.
Machine does not cut.	Line broken. Battery not fully charged. Motor is broken (speed is too low). Grass entangled around cutting head.	Replace the line. Recharge battery; also see the content in charger manual. Contact Service Agent. Remove grass.
Continuous lighting of the battery charge indicator No charging procedure possible.	Battery not (properly) inserted. Battery contacts contaminated. Battery defective.	Properly insert battery into battery charger. Clean the battery contacts (e.g. by inserting and removing the battery several times) or replace the battery. Replace the battery.
Battery charge indicator does not light up.	Plug of battery charger not plugged in (properly). Socket outlet, mains cable or battery charger defective.	Insert mains plug (fully) into the socket outlet. Check the mains voltage; have the battery charger checked by an authorized after-sales service agent.
Auto feed does not work	Cutting line is not wound well. The line is tangled. Line is used up.	Manually feed the line, if still can not feed out, remove the Spool out and rewind the line. Replace with a new line spool.