

# 2.4 GHz Cordless Telephone

## with Headset Jack

43-3556

**11-Number Memory Dialing** — lets you store up to 11 numbers (1 one-touch and 10 speed-dial) in memory for easy dialing.

**20 Channels** — you can automatically select a clear channel when you make or answer a call, or you can manually change channels.

**Ample Talk and Standby Time** — the supplied battery (when fully charged) provides about 7 hours of talk time or 14 days of standby time.

**Page** — lets you send a paging signal from the base to the handset to page someone or locate the handset.

**Auto Talk** — lets you answer a call by simply lifting the handset from the base.

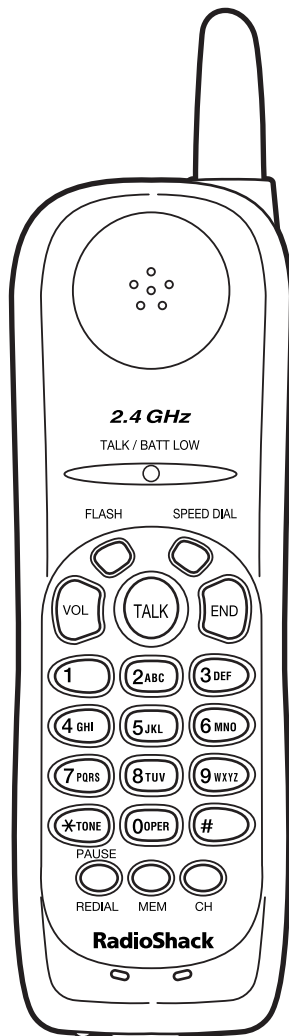

### ! IMPORTANT !

If an icon appears at the end of a paragraph, go to the box on that page with the corresponding icon for pertinent information.

⚠ — Warning

! — Important  
📝 — Note

⚡ — Caution



**RadioShack®**

www.radioshack.com™

## OWNER'S MANUAL

Please read before using this equipment.

© 2004 RadioShack Corporation.  
All Rights Reserved.

RadioShack and RadioShack.com are trademarks used by RadioShack Corporation.  
ENERGYSTAR and the ENERGYSTAR certification mark are registered US marks.

## CONTENTS

Introduction .....	2
Important Information .....	2
FCC Statement .....	2
Surge Protection .....	3
Important Safety Instructions .....	3
Installation .....	4
On a Desk Top .....	4
On a Wall Plate or Wall .....	5
Connecting and Charging the Battery Pack .....	5
Recharging the Battery Pack .....	6
Choose the Dialing Mode .....	6
Using Your Phone .....	7
Making and Receiving Calls .....	7
Adjusting the Ringer Tone and Volume .....	7
Adjusting the Earpiece Volume .....	8
Ringer Mute .....	8
Tone Dialing Switch-over .....	8
Selecting a Different Channel .....	8
Page .....	8
Flash and Call Waiting .....	8
Memory Dialing .....	8
Storing a Phone Number in Memory .....	8
Dialing a Memory Number .....	9
One-touch Speed Dial .....	9
Chain Dialing .....	9
Erasing a Stored Number from Memory .....	9
Changing the Digital Security Code .....	10
Testing Stored Emergency Numbers .....	10
Installing The Beltclip .....	10
Headset Installation .....	10
Troubleshooting .....	11
Care .....	12
Service and Repair .....	12

**WARNING:** To reduce the risk of fire or shock hazard, do not expose this product to rain or moisture.



**CAUTION:** TO REDUCE THE RISK OF ELECTRIC SHOCK, DO NOT REMOVE COVER OR BACK. NO USER-SERVICEABLE PARTS INSIDE. REFER SERVICING TO QUALIFIED PERSONNEL.

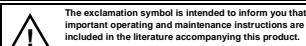
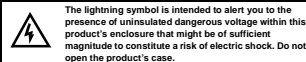

As an **ENERGYSTAR** Partner, RadioShack Corporation has determined that this product meets the **ENERGYSTAR** guidelines for energy efficiency.

## INTRODUCTION

Thank you for purchasing a RadioShack 2.4 GHz Cordless Telephone. Your phone uses the 2.4 GHz band for less interference and greater range than many other cordless telephones. Its headset jack lets you connect an optional headset for hands-free convenience.

## IMPORTANT INFORMATION

This telephone has been tested and found to comply with all applicable UL and FCC standards.

## FCC STATEMENT

Your telephone complies with Part 68 of the FCC Rules. Upon request, you must provide the phone's FCC registration number and REN to your phone company. These numbers are on the base unit.

Your phone is not intended to be used with party-line systems. Connection to party line service is subject to state tariffs. Contact the state public utility commission, public service commission, or corporation commission for information.

We have designed your phone to conform to federal regulations, and you can connect it to most telephone lines. However, each phone (and each device, such as a telephone or answering machine) that you connect to the telephone line draws power from the telephone line. We refer to this power draw as the device's ringer equivalence number, or REN on the back of your phone.

If you use more than one phone or other device on the line, add up all of the RENs. If the total is more than five (three in rural areas), your telephones might not ring. If ringer operation is impaired, remove a device from the line.

In the unlikely event that your phone causes problems on the phone line, the phone company can temporarily discontinue your service. If this happens, the phone company attempts to notify you in advance. If advance notice is not practical, the phone company notifies you as soon as possible and advises you of your right to file a complaint with the FCC.

Also, the phone company can make changes to its lines, equipment, operations, or procedures that could affect the operation of this phone. The telephone company notifies you of these changes in advance, so you can take the necessary steps to prevent interruption of your telephone service.

You must not connect your phone to:

- coin-operated systems
- most electronic key telephone systems

This device complies with part 15 of the FCC rules. Operation is subject to the following two conditions: (1) This device may not cause harmful interference, and (2) This device must accept any interference received, including interference that may cause undesired operation. Privacy of communications, may not be ensured when using this phone. !

## **SURGE PROTECTION**

Your phone has built-in protection circuits to reduce the risk of damage from surges in telephone line and power line current. These protection circuits meet or exceed the FCC requirements. However, lightning striking the phone or power lines can damage your phone.

Lightning damage is not common.

Nevertheless, if you live in an area that has severe electrical storms, we suggest that you unplug your phone when storms approach to reduce the possibility of damage.

## **IMPORTANT SAFETY INSTRUCTIONS**

When using your telephone equipment, basic safety precautions should always be followed to reduce the risk of fire, electric shock and injury to persons, including the following:

1. Do not use this product near water, for example, near a bathtub, wash bowl, kitchen sink, or laundry tub, in a wet basement or near a swimming pool.
2. Avoid using a telephone (other than a cordless type) during an electrical storm. There may be a remote risk of electric shock from lightning.
3. Do not use the telephone to report a gas leak in the vicinity of the leak.
4. Use only the power cord and batteries indicated in this manual. Do not dispose of batteries in a fire. They may explode. Check with local codes for possible special disposal instructions.

## **SAVE THESE INSTRUCTIONS**

### **! IMPORTANT !**

- Cordless phones such as this one require AC power to operate. When the power is off, you cannot make or receive calls using your phone. To be safe, you should also have a phone that does not need AC power to operate (not a cordless phone), so you can still make and receive calls if there is an AC power failure.
- When AC power is lost, the phone loses the digital security code connection between the base and the handset. When power is restored, put the handset on the base briefly to restore this connection so you can use the handset.
- Your phone operates on standard radio frequencies as allocated by the FCC. It is possible for other radio units operating nearby on similar frequencies to unintentionally intercept your conversation or cause interference. This possible lack of privacy can occur with any cordless phone.

## NOTES

- If your home has specially wired alarm equipment connected to the telephone line, be sure that installing the system does not disable your alarm equipment. If you have questions about what will disable alarm equipment, contact your telephone company or a qualified installer.
- The USOC number of the jack to be installed is RJ11C (or RJ11W for a wall plate jack).

## CAUTION



You must use a Class two power source that supplies 9V DC and delivers at least 210 mA. Its center tip must be set to positive and its plug must fit the phone's **DC IN 9V** jack. The supplied adapter meets these specifications. Using an adapter that does not meet these specifications could damage the phone or the adapter.

# INSTALLATION

You can place the phone on a desk or table, or mount it on a standard wall plate or directly on a wall. Select a location that is:

- near an accessible AC outlet
- near a telephone line jack
- out of the way of normal activities
- away from electrical machinery, electrical appliances, metal walls or filing cabinets, wireless intercoms, alarms, and room monitors
- away from other cordless phones

The base's location affects the handset's range. If you have a choice of several locations, try each to see which provides the best performance.

Your telephone connects directly to a modular telephone line jack. If your telephone wiring does not have a modular jack, you can update the wiring yourself using jacks and adapters (available at your local RadioShack store or online at RadioShack.com), or have the telephone company update the wiring for you. You must use compatible modular jacks that are compliant with Part 68 of *FCC Rules* and the requirements adapted by the ACTA. The telephone cord and modular plug provided is Part 68 compliant for connecting to the telephone company network.

## ON A DESK TOP

1. Plug one end of the supplied modular cord into the **TEL LINE** jack on the back of the base.
2. Insert the supplied AC adapter's barrel plug into the **DC IN 9V** jack on the back of the base and route the adapter's cord through the strain relief slot on the base.
3. Plug the other end of the modular cord into a modular phone line jack.
4. Plug the adapter into a standard AC outlet.

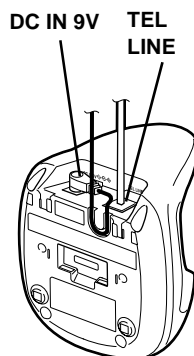

## ON A WALL PLATE OR WALL

To mount the phone directly on a wall, you need two screws (not supplied) with heads that fit into the keyhole slots on the base. Drill two holes  $3\frac{15}{16}$  inches apart. Thread a screw into each hole, letting the heads extend about  $\frac{1}{8}$  inch.

1. Insert the two of upper tabs of the supplied bracket into the base's upper tab slots. Then slide down the bracket so that two of the lower tabs would be inserted into the lower slots.

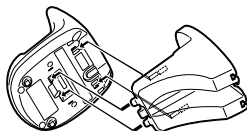

2. Plug one end of the supplied modular cord into the **TEL LINE** jack on the base's back.
3. Plug the supplied AC adapter's barrel plug into the **DC IN 9V** jack.
4. Route the adapter and modular cords through the bracket's grooves.
5. For a wall plate, align the bracket's keyhole slots with the wall plate studs and slide the base downward to secure it.

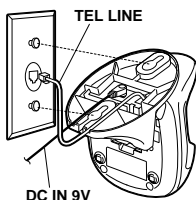

For direct wall mounting, align the bracket's keyhole slots with the mounting screws and slide the base downward to secure it.

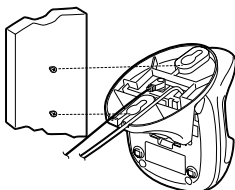

6. Plug the adapter into a standard AC outlet. And plug the modular cord's other end into a modular phone line jack.

## CONNECTING AND CHARGING THE BATTERY PACK

The phone comes with a rechargeable nickel-cadmium battery pack in the handset, but not connected. Before using your phone, you must connect the battery pack. Then charge it for about 15–20 hours. !

1. Press down and slide off the battery compartment cover to remove it.
2. Lift the battery pack out of the compartment.
3. Plug the battery pack's connector into the socket in the compartment (the connector fits only one way). Then place the battery pack in the compartment.
4. Replace the cover.

### ! IMPORTANT !

The EPA certified RBRC® Battery Recycling Seal on the nickel-cadmium (Ni-Cd) battery indicates RadioShack is



voluntarily participating in an industry program to collect and recycle these batteries at the end of their useful life, when taken out of service in the United States or Canada. The RBRC program provides a convenient alternative to placing used Ni-Cd batteries into the trash or the municipal waste stream, which may be illegal in your area. Please call 1-800-THE-SHACK (1-800-843-7422) for information on Ni-Cd battery recycling and disposal bans/restrictions in your area. RadioShack's involvement in this program is part of the company's commitment to preserving our environment and conserving our natural resources.



### WARNING

Dispose of the old battery pack promptly and properly.

Do not burn or bury it.

There is a risk of explosion if battery is replaced by an incorrect type. Dispose of used batteries according to the instructions.

To charge the battery pack, place the handset on the base with the keypad facing forward. The CHARGE/IN USE indicator on the base lights. Recharge the battery pack when the handset beeps during talk and TALK/BATT LOW flashes. ⚠

## Recharging the Battery Pack

- If the CHARGE/IN USE indicator does not light when you place the handset on the base, be sure the battery pack and AC adapter are correctly and securely connected. Also, check the charging contacts on the handset. If the contacts are dirty or tarnished, clean them with a damp cloth.
- When you first use the phone after charging or recharging the battery pack, the phone might not work and you might hear an error tone. Return the handset to the base to change the digital security code.
- If the battery pack becomes weak during a call, the handset beeps every 3 seconds and TALK/BATT LOW flashes. When this happens, recharge the battery pack.
- If TALK/BATT LOW does not light and the phone does not work, recharge the battery pack. (The battery power might be too low to light TALK/BATT LOW.)
- About once a month, fully discharge the battery by keeping the handset off the base until TALK/BATT LOW flashes. Otherwise, the battery pack loses its ability to fully recharge.
- The handset loses its digital security code if the battery pack is completely discharged. Place the handset on the base to recharge the battery pack and change the code.
- If you are not going to use your phone for an extended period, disconnect the battery pack. This increases the battery pack's usable life.
- The supplied battery pack should last for about a year. If the battery pack does not hold a charge for more than 2 hours after an overnight charge, replace it with a new 3.6-volt, 600 mAh battery pack with a connector that fits the socket in the battery compartment. You can order a replacement battery pack through RadioShack. Install the new battery pack and charge it for about 15–20 hours. If you have trouble replacing the battery pack, take the phone to your local RadioShack for assistance.



### NOTE

Make sure your battery pack is fully charged before choosing the dial mode.

## CHOOSE THE DIALING MODE

Most phone systems use tone dialing which sends DTMF tones through the phone lines. However some phone systems still use pulse dialing such as in rural areas. The default setting is tone dialing. Depending on your dialing system, set the mode as follows: ✓

1. Press and hold **FLASH** until you hear a confirmation tone.
2. To set the dial mode for pulse dialing, press **#**. Or to set the dial mode for tone dialing, press **\*/TONE**.  
A confirmation tone sounds to indicate the setting is complete.
  - If you are not sure of your dialing system, set for tone dialing. Make a trial call. If the call connects, leave the setting as is, otherwise set for pulse dialing.
  - If your phone dialing system requires pulse dialing and you need to send DTMF tones for certain situations during a call, you may “switch-over” to tone dialing (refer to “Tone Dialing Switch-over” on page 8).

# USING YOUR PHONE

## MAKING AND RECEIVING CALLS

	Handset On Base	Handset Off Base
Answer call	When the phone rings, remove the handset from the base (Auto Talk).	Press <b>TALK</b> , any number key, <b>*/TONE</b> , or <b>#</b> .
Make call	1) Remove the handset from the base and press <b>TALK</b> . ✓ 2) The TALK/BATT LOW flashes and turns on. 3) Listen for the dial tone. 4) Dial the number.	1) Press <b>TALK</b> . 2) The TALK/BATT LOW flashes and turns on. 3) Listen for the dial tone. 4) Dial the number.
Hang up	Press <b>END</b> or return the handset to the base.	
Redial	1) Remove the handset from the base and press <b>TALK</b> . 2) Listen for the dial tone. 3) Press <b>PAUSE/REDIAL</b> to dial the last dialed number. ✓	1) Press <b>TALK</b> . 2) Listen for the dial tone. 3) Press <b>PAUSE/REDIAL</b> to dial the last dialed number.
Ringer Mute	None	Press <b>END</b> when ringing.

# ADJUSTING THE RINGER TONE AND VOLUME

When the phone is in standby mode, press **VOL** repeatedly to listen to the four ringer tones and volume combinations. The phone keeps the last ringer tone setting selected.

## NOTES

- During a call, as you begin to move your handset too far from your base unit, noise increases. If you pass the range limits of the base unit, your call will terminate within one minute.
- The **PAUSE/REDIAL** key redials the last number dialed.
- The redialed number can be up to 24 digits long.

## NOTES

### ***Tone Dialing Switch-over***

The tone feature only applies when the dial mode is set to pulse.

### ***Page***

You can cancel paging by pressing **PAGE** on the base.

### ***Flash and Call Waiting***

You must subscribe through your local telephone company to receive Call Waiting Service.

## ADJUSTING THE EARPIECE VOLUME

The handset earpiece volume settings (Low, Medium and High) can only be adjusted during a call. Press **VOL** repeatedly to select Low, Medium and High. When you hang up, the phone keeps the last volume setting selected.

## RINGER MUTE

The **END** key can be used to temporarily mute the ringer tone. When the handset is off the base and the phone is ringing, press the **END** key and the ringer tone will be temporarily silenced. The ringer tone will return to normal starting with the next incoming call.

## tone dialing switch-over

Some telephone companies use equipment that requires pulse dialing (sometimes referred to as rotary dialing). If you need to enter tone dialing digits, you can switch-over to tone dialing during the call. For example, entering your bank account number after you have called your bank. Initially make your call with the pulse dialing mode. Once your call connects, press **\*TONE**. Enter the desired number. These digits will be sent as tone dialing. This special number can be stored in a memory location. This is referred to as Chain Dialing. Once the call ends, the tone mode is cancelled and pulse dialing mode resumes. ✓

## SELECTING A DIFFERENT CHANNEL

If you encounter interference while using your phone, you can manually change the phone's channel for clear operation. This function works only when the phone is in use. Press **CH**. The TALK/BATT LOW flashes, indicating the phone is changing to another channel.

## PAGE

To locate the handset (while it's off the base), press **PAGE** on the base. The handset beeps for 60 seconds. Paging is cancelled when pressing any key on the handset, or return the handset to the base. ✓

## FLASH AND CALL WAITING

If you have "Call waiting" service and a call waiting tone sounds while you are on a call, press **FLASH** to accept the waiting call. There is a short pause. Then you will hear the new caller. To return to the original caller, press **FLASH** again. ✓

## MEMORY DIALING

### **Storing a Phone Number in Memory**

Your cordless phone has one speed dial memory location and 10 additional memory locations for storing important telephone numbers. You can store your most frequent dialed number in the one-touch speed dial location.

1. Remove the handset from the base.



2. Press **MEM**. The TALK/BATT LOW flashes. ✓
3. Enter the phone number, up to 20 digits. If a pause is needed during the dialing sequence, press **PAUSE/REDIAL** to insert a pause. Each pause counts as a digit and represents a two second delay in time between digits as they are sent.
4. Press **MEM** again.

To actually store a number in it's designated location;

5. Press **SPEED DIAL** or memory location (**0-9**) on the keypad to store a number.

A tone indicates that the number is stored. If you enter a number in a location that has a previously stored number, it will overwrite the existing number without warning.

## Dialing a Memory Number

1. Press **TALK**. Then press **MEM**.
2. Enter the memory location (**0-9**) on the keypad. The stored number automatically dials. ✓

## One-touch Speed Dial

Your phone is equipped with "One-touch speed dial" for instant dialing. It is used to dial the phone number stored in the one-touch speed dial location (See "Storing a Phone Number in Memory" on page 8).

To instantly dial the phone number stored in the one-touch speed dial location, simply press **SPEED DIAL**. (There is no need to press **TALK**. The phone will automatically dial). If you press **SPEED DIAL** and a phone number is not stored in the one-touch speed dial location, the handset will beep rapidly and the phone will not dial.

## Chain Dialing

The memory locations on the handset are not limited to phone numbers. You can also store a group of numbers (up to 20 digits) that you need to enter once your call connects. This is referred to as Chain Dialing.

An example of this is a bank account number. Once you have called your bank, and are prompted to enter the account number, simply press **MEM** and the location number (**0-9**) where the special number has been stored.

Store your special number in memory as you would store a phone number (Refer to "Storing a Phone Number in Memory" on page 8).

## Erasing a Stored Number from Memory

1. Remove the handset from the base unit.
2. Press **MEM** twice.
3. Press **SPEED DIAL** or the memory location (**0-9**). A tone indicates that the stored number is erased from memory.



### NOTES

#### Storing a Phone Number in Memory

- The pause button counts as one digit. Pressing **PAUSE/REDIAL** more than once increases the length of pause between numbers.
- You have 30 seconds after pressing **MEM** to enter the number you wish to store. Otherwise, the handset will beep rapidly.
- Memory location for the speed dial is independent from the memory location for Memory Dial.

#### Dialing a Memory Number

If you select a memory location that does not have a stored number, the handset will beep rapidly and the phone will not dial.



### **Changing the Digital Security Code**

If the handset battery pack is completely discharged or the battery pack is removed, the digital security code will be lost. If this happens, a new security code is set automatically next time the battery pack is charged.

### **Headset Installation**

- If you place the handset on the base to recharge it while the headset is connected, be sure the handset seats properly.
- You can use a handset holder (available from RadioShack) to hang the handset on your belt for greater convenience when using a headset.
- Connecting a headset disconnects the handset's earpiece and microphone.
- **VOL** on the handset also controls the headset's volume.

## **Changing the Digital Security Code**

The digital security code is an identification code used to connect the handset and the base unit. Normally, setting the code is not necessary.

The first time you charge your handset, the security code is automatically set. In the rare situation that you suspect another cordless telephone is using the same security code, you can change the code. ✓

1. Remove the handset from the base unit. Press and hold **PAGE** on the base.
2. While holding **PAGE**, place the handset on the base unit. Leave the handset on the base for more than three seconds. A new random security code is set.

## **Testing Stored Emergency Numbers**

If you store an emergency service's number (police department, fire department, ambulance) and you choose to test the stored number, make the test call during the late evening or early morning hours to avoid peak demand periods. Also, remain on the line to explain the reason for your call.

## **INSTALLING THE BELTCLIP**

### **To attach the beltclip**

Insert the beltclip into the holes on each side of the handset. Press down until it clicks.

### **To remove the beltclip**

Pull both sides of the beltclip to release the tabs from the holes.

## **HEADSET INSTALLATION**

You can connect an optional headset with a  $\frac{3}{32}$ -inch (2.5-mm) plug. Contact RadioShack for a suitable headset. ✓

To connect the headset, open the rubber cover on the side of the handset. Then insert the headset's plug into the jack.

When you finish using the headset, disconnect it from the handset and close the rubber cover to protect the jack.

# TROUBLESHOOTING

Problem	Suggestions
Low volume or unusual sounds.	Someone has picked up another phone on the same line. Hang up the other phone. If you are using the headset, make sure the headset's plug is properly connected to the jack.
Severe noise interference.	Keep the handset away from microwave ovens, computers, remote control toys, wireless microphones, alarm systems, intercoms, room monitors, fluorescent lights, and electrical appliances. Move the base to another location or turn off the source of interference. Press <b>CH</b> to change the channel. Hang up and redial the number.
The phone does not work properly.	Be sure the base's phone line cord and AC adapter are correctly and securely connected. Be sure the battery pack in the handset is connected and charged. Return the handset to the base to change the digital security code.
The handset battery pack does not charge.	Check the charging contacts on the handset. If they are dirty, clean them with a damp cloth. Be sure the battery pack is connected correctly. Be sure the handset is properly seated on the base.
The handset stops working or works poorly during a call.	Move the handset closer to the base. Be sure the handset's battery pack is charged.
The handset's range has decreased and the phone cannot be operated at a useful distance from the base because the signal becomes weak or noisy.	Be sure the handset's antenna is not touching a metal surface.
The handset does not ring or receive a page.	Move the handset closer to the base. Return the handset to the base to recharge the battery pack. Move the base away from other electrical devices.

If you still have problems, disconnect the phone. If other phones on the same line work properly, the fault is in this phone or its installation. If you cannot find the problem, take the phone to your local RadioShack store for assistance.

# CARE

Keep the phone dry; if it gets wet, wipe it dry immediately. Use and store the phone only in normal temperature environments. Handle the phone carefully; do not drop it. Keep the phone away from dust and dirt, and wipe it with a damp cloth occasionally to keep it looking new.

## SERVICE AND REPAIR

If your phone is not performing as it should, take it to your local RadioShack store for assistance. To locate your nearest RadioShack, use the store locator feature on RadioShack's website ([www.radioshack.com](http://www.radioshack.com)), or call 1-800-The Shack (843-7422) and follow the menu options.

Modifying or tampering with the phone's internal components can cause a malfunction and might invalidate its warranty and void your FCC authorization to operate it.

### Limited One-Year Warranty

This product is warranted by RadioShack against manufacturing defects in material and workmanship under normal use for one (1) year from the date of purchase from RadioShack company-owned stores and authorized RadioShack franchisees and dealers. EXCEPT AS PROVIDED HEREIN, RadioShack MAKES NO EXPRESS WARRANTIES AND ANY IMPLIED WARRANTIES, INCLUDING THOSE OF MERCHANTABILITY AND FITNESS FOR A PARTICULAR PURPOSE, ARE LIMITED IN DURATION TO THE DURATION OF THE WRITTEN LIMITED WARRANTIES CONTAINED HEREIN. EXCEPT AS PROVIDED HEREIN, RadioShack SHALL HAVE NO LIABILITY OR RESPONSIBILITY TO CUSTOMER OR ANY OTHER PERSON OR ENTITY WITH RESPECT TO ANY LIABILITY, LOSS OR DAMAGE CAUSED DIRECTLY OR INDIRECTLY BY USE OR PERFORMANCE OF THE PRODUCT OR ARISING OUT OF ANY BREACH OF THIS WARRANTY, INCLUDING, BUT NOT LIMITED TO, ANY DAMAGES RESULTING FROM INCONVENIENCE, LOSS OF TIME, DATA, PROPERTY, REVENUE, OR PROFIT OR ANY INDIRECT, SPECIAL, INCIDENTAL, OR CONSEQUENTIAL DAMAGES, EVEN IF RadioShack HAS BEEN ADVISED OF THE POSSIBILITY OF SUCH DAMAGES.

Some states do not allow limitations on how long an implied warranty lasts or the exclusion or limitation of incidental or consequential damages, so the above limitations or exclusions may not apply to you.

In the event of a product defect during the warranty period, take the product and the RadioShack sales receipt as proof of purchase date to any RadioShack store. RadioShack will, at its option, unless otherwise provided by law: (a) correct the defect by product repair without charge for parts and labor; (b) replace the product with one of the same or similar design; or (c) refund the purchase price. All replaced parts and products, and products on which a refund is made, become the property of RadioShack. New or reconditioned parts and products may be used in the performance of warranty service. Repaired or replaced parts and products are warranted for the remainder of the original warranty period. You will be charged for repair or replacement of the product made after the expiration of the warranty period.

This warranty does not cover: (a) damage or failure caused by or attributable to acts of God, abuse, accident, misuse, improper or abnormal usage, failure to follow instructions, improper installation or maintenance, alteration, lightning or other incidence of excess voltage or current; (b) any repairs other than those provided by a RadioShack Authorized Service Facility; (c) consumables such as fuses or batteries; (d) cosmetic damage; (e) transportation, shipping or insurance costs; or (f) costs of product removal, installation, set-up service adjustment or reinstallation.

This warranty gives you specific legal rights, and you may also have other rights which vary from state to state.

RadioShack Customer Relations,  
200 Taylor Street, 6th Floor, Fort Worth, TX 76102

12/99